

**Register Now**   
[www.delonghi.com/register](http://www.delonghi.com/register)



---

ESAM03.12X

BEAN TO CUP ESPRESSO  
AND CAPPUCCINO  
MACHINE  
Instruction for Use



---

**De'Longhi**

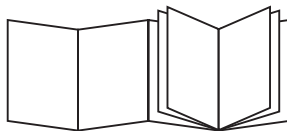

## ELECTRICAL REQUIREMENTS

Before using this appliance ensure that the voltage indicated on the product corresponds with the main voltage in your home, if you are in any doubt about your supply contact your local electricity company.

The flexible mains lead is supplied connected to a B.S. 1363 fused plug having a fuse of 13 amp capacity.

Should this plug not fit the socket outlets in your home, it should be cut off and replaced with a suitable plug, following the procedure outlined below.

**Note:** Such a plug cannot be used for any other appliance and should therefore be properly disposed of and not left where children might find it and plug it into a supply socket - with the obvious consequent danger.

**N.B.** We recommend the use of good quality plugs and wall sockets that can be switched off when the machine is not in use.

**IMPORTANT:** the wires in the mains lead fitted to this appliance are coloured in accordance with the following code:

GREEN AND YELLOW  
BLUE  
BROWN

EARTH  
NEUTRAL  
LIVE

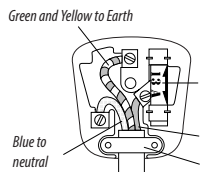

As the colours of the wires in the mains lead of this appliance may not correspond with the coloured markings identifying the terminals in your plug, proceed as follows:

- The wire which is coloured green and yellow must be connected to the terminal in the plug which is marked with the letter E or by the earth symbol  or coloured green or green and yellow.
- The wire which is coloured blue must be connected to the terminal which is marked with the letter N or coloured black.
- The wire which is coloured brown must be connected to the terminal which is marked with the letter L or coloured red.

When wiring the plug, ensure that all strands of wire are securely retained in each terminal. Do not forget to tighten the mains lead clamp on the plug. If your electricity supply point has only two pin socket outlets, or if you are in doubt, consult a qualified electrician.

Should the mains lead ever require replacement, it is essential that this operation be carried out by a qualified electrician and should only be replaced with a flexible cord of the same size.

After replacement of a fuse in the plug, the fuse cover must be refitted. If the fuse cover is lost, the plug must not be used until a replacement cover is obtained. The colour of the correct replacement fuse cover is that of the coloured insert in the base of the fuse recess or elsewhere on the plug. Always state this colour when ordering a replacement fuse cover.

Only 13amp replacement fuses which are as approved to B.S. 1362 should be fitted.

This appliance conforms to the Norms EN 55014 regarding the suppression of radio interference.

**Warning - this appliance must be earthed**

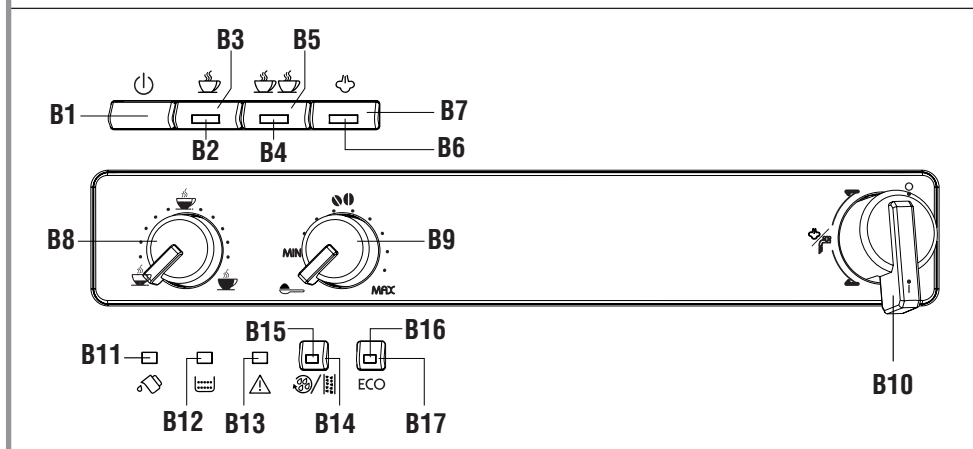
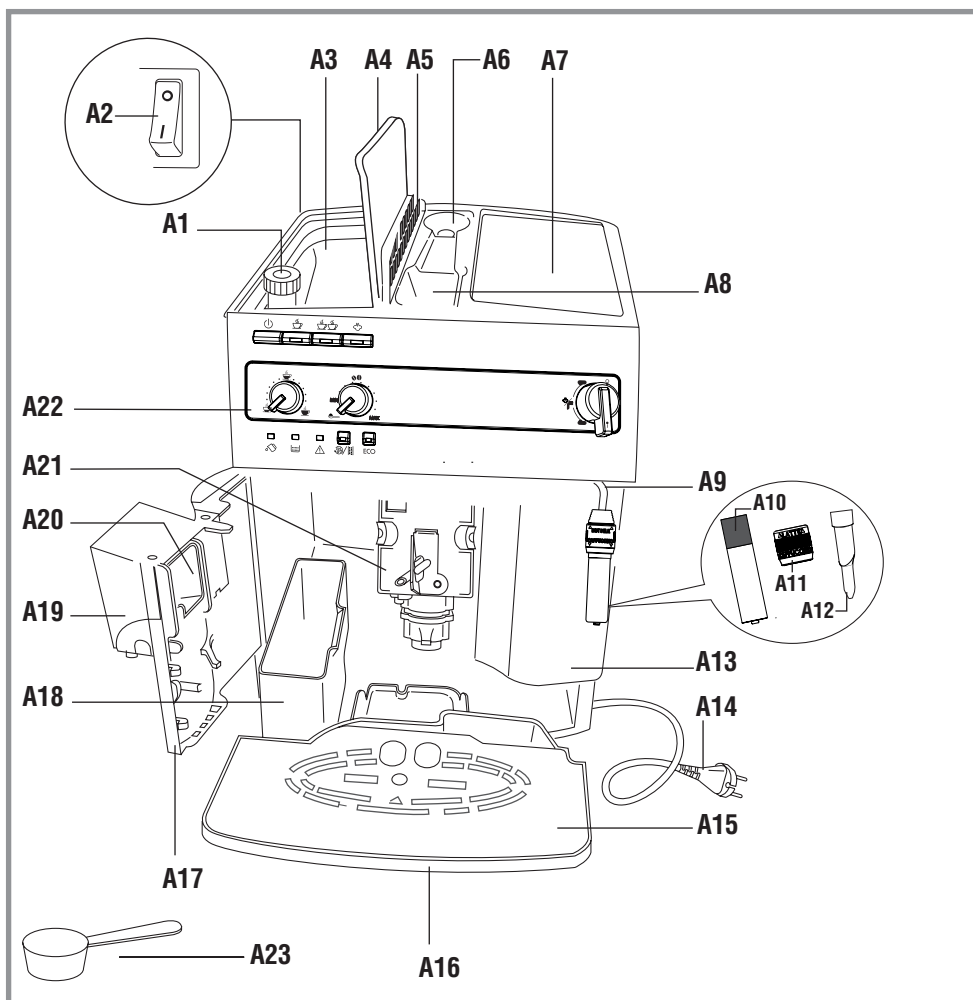

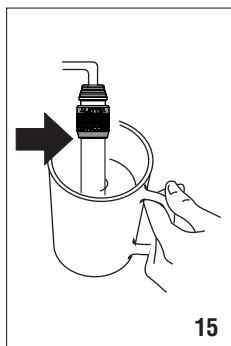
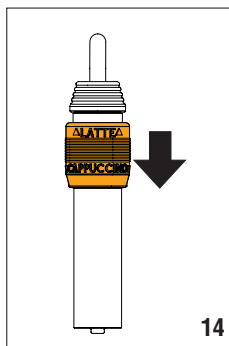
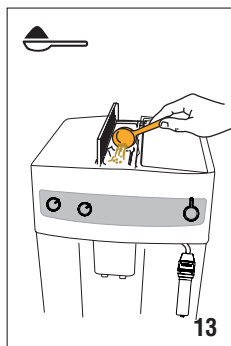
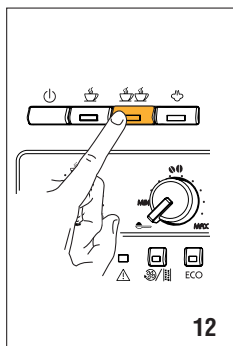
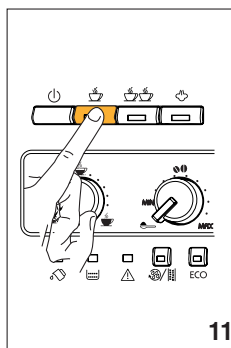
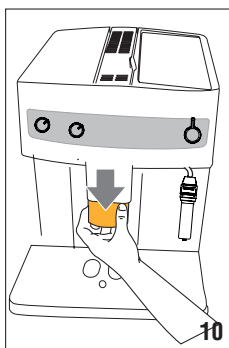
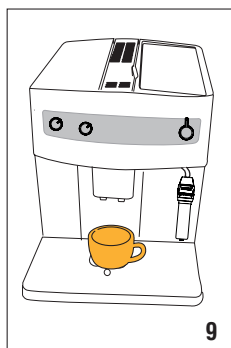
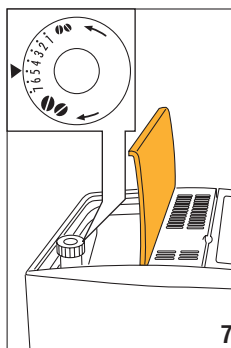
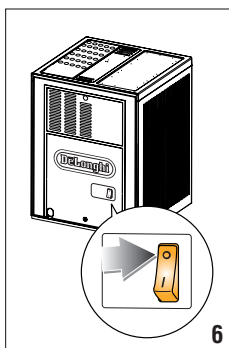
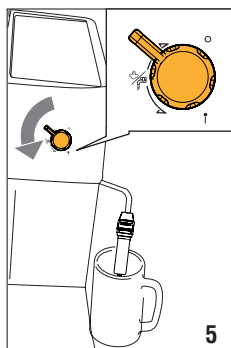
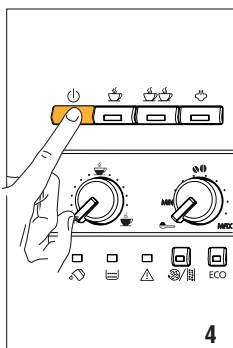
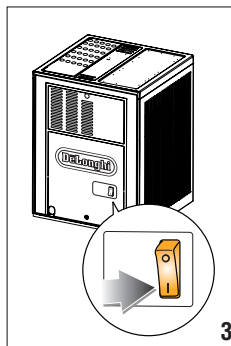
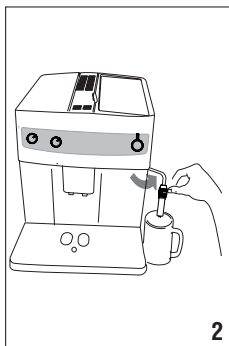
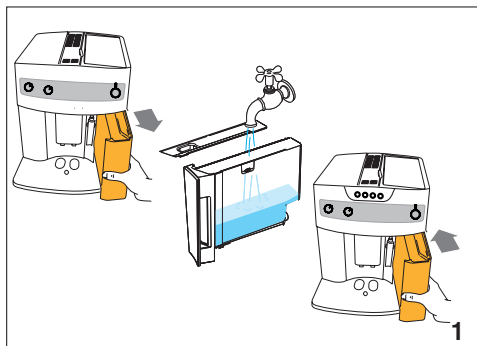

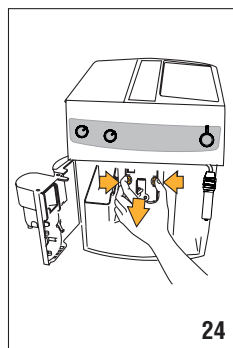
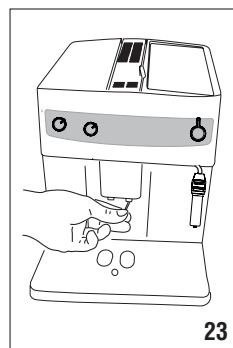
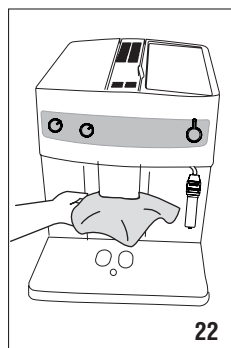
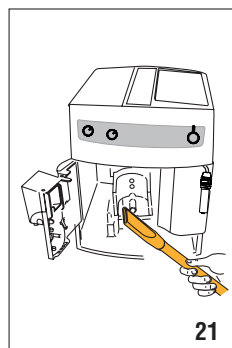
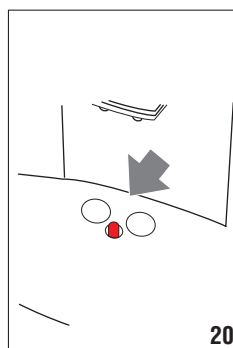
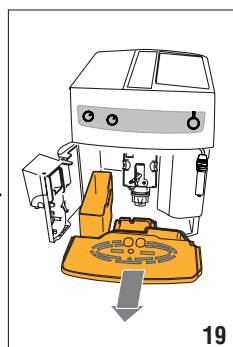
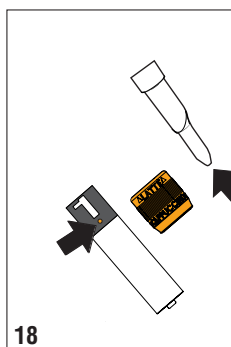
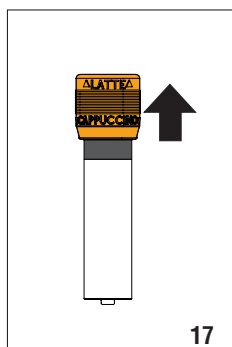
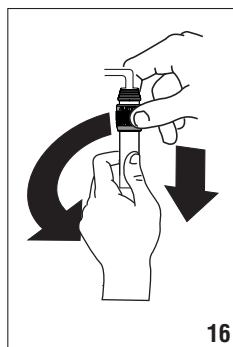

## CONTENTS

---

<b>ELECTRICAL REQUIREMENTS .....</b>	<b>2</b>
<b>FUNDAMENTAL SAFETY WARNINGS.....</b>	<b>7</b>
<b>IMPORTANT SAFEGUARDS .....</b>	<b>8</b>
Symbols used in these instructions .....	8
Designated use .....	8
Instruction for Use.....	8
<b>INTRODUCTION .....</b>	<b>8</b>
Letters in brackets.....	8
Troubleshooting and repairs .....	8
<b>DESCRIPTION .....</b>	<b>9</b>
Description of the appliance .....	9
Description of control panel .....	9
<b>PRELIMINARY CHECKS .....</b>	<b>9</b>
Checking the appliance.....	9
Installing the appliance .....	9
Connecting the appliance .....	9
Using the coffee maker for the first time .....	9
<b>TURNING THE APPLIANCE ON .....</b>	<b>10</b>
<b>TURNING THE APPLIANCE OFF .....</b>	<b>10</b>
<b>SETTING THE AUTO-OFF (STAND BY) .....</b>	<b>10</b>
<b>ENERGY SAVING.....</b>	<b>10</b>
<b>MAKING COFFEE .....</b>	<b>11</b>
Selecting the coffee taste.....	11
Selecting the quantity of coffee in the cup.....	11
Adjusting the coffee mill .....	11
However, if after making the first few coffees you find that the coffee is either too weak and not creamy enough or delivery is too slow (a drop at a time), this can be corrected by adjusting the grinding adjustment dial (fig. 7).....	11
Tips for a hotter coffee: .....	11
Making coffee using coffee beans.....	11
Making coffee using pre-ground coffee .....	12
<b>MAKING CAPPUCCINO .....</b>	<b>12</b>
Making hot milk (without froth) .....	12
Cleaning the cappuccino maker after use.....	12
<b>HOT WATER .....</b>	<b>13</b>
<b>CLEANING .....</b>	<b>13</b>
Cleaning the coffee maker .....	13
Cleaning the coffee grounds container.....	13
Cleaning the drip tray .....	13
Cleaning the inside of the machine.....	13
Cleaning the water tank.....	14
Cleaning the coffee spouts.....	14
Cleaning the pre-ground coffee funnel .....	14
Cleaning the infuser.....	14

<b>DESCALING.....</b>	<b>14</b>
<b>SETTING WATER HARDNESS.....</b>	<b>15</b>
Measuring water hardness.....	15
Set water hardness .....	15
<b>SETTING THE TEMPERATURE.....</b>	<b>15</b>
<b>MEANING OF LIGHTS DURING NORMAL OPERATION</b>	<b>16</b>
<b>TECHNICAL SPECIFICATION .....</b>	<b>16</b>
<b>DISPOSAL.....</b>	<b>16</b>
<b>MEANING OF THE ALARM LIGHTS .....</b>	<b>17</b>
<b>TROUBLESHOOTING .....</b>	<b>18</b>

## **FUNDAMENTAL SAFETY WARNINGS**

---

- The appliance is not intended for use by persons (including children) with reduced physical, sensory or mental capabilities, or lack of experience and knowledge, unless they have been given supervision or instruction concerning use of the appliance by a person responsible for their safety.
- Children should be supervised to ensure that they do not play with the appliance.
- Designated use: this appliance is designed and made to prepare coffee and milk based beverages and hot water. Any other use is considered improper and thus dangerous. The manufacturer is not liable for damage deriving from improper use of the appliance.
- The surface of the heating element remains hot after use and the outside of the appliance may retain the heat for several minutes depending on use.
- To clean, follow the instructions in the section "CLEANING" on page 13.
- Cleaning and user maintenance shall not be made by children without supervision.
- Never clean by immersing the appliance in water.
- CAUTION: To prevent damage to the appliance do not use alkaline cleaning agents when cleaning, use a soft cloth and a mild detergent
- This is a household appliance only. It is not intended to be used in: staff kitchen areas in shops, offices and other working environments; farm houses; by clients in hotels, motels and other residential type environments; bed and breakfast type environments.
- If the plug or cord is damaged, it must be replaced by Customer Services only to avoid all risk.
- Appliances with removable cord: avoid splashes of water on the power cord connector or socket at the back of the appliance.

### **FOR EUROPEAN MARKETS ONLY:**

- This appliance can be used by children aged from 8 years and above if they have been given supervision or instruction concerning use of the appliance in a safe way and if they understand the hazard involved. Cleaning and user maintenance shall not be made by children unless they are older than 8 and supervised.  
Keep the appliance and its cord out of the reach of children aged less than 8 years.
- Appliances can be used by persons with reduced physical, sensory or mental capabilities or lack of experience and knowledge if they have been given supervision or instruction concerning use of the appliance in a safe way and if they understand the hazards involved.
- Children shall not play with the appliance.



- When not in use and before putting on or taking off parts or cleaning, always unplug the appliance.



Surfaces marked with this symbol become hot during use (the symbol is present in certain models only).

## IMPORTANT SAFEGUARDS

### Symbols used in these instructions

Important warnings are identified by these symbols. It is vital to respect these warnings.



*Danger!*

Failure to observe the warning may result in life threatening injury by electric shock.



*Important!*

Failure to observe the warning could result in injury or damage to the appliance.



*Danger of burns!*

Failure to observe the warning could result in scalds or burns.



*Please note:*

This symbol identifies important advice or information for the user.



*Danger!*

This is an electrical appliance and may cause electric shock. You should therefore follow these safety warnings:

- Never touch the appliance with damp hands or feet.
- Never touch the plug with damp hands.
- Make sure the socket used is freely accessible at all times, enabling the appliance to be unplugged when necessary.
- Unplug directly from the plug only. Never pull the cord as you could damage it.
- To disconnect the appliance completely you must unplug it from the mains socket.
- If the appliance is faulty, do not attempt to repair. Turn it off, unplug from the mains socket and contact Customer Services.
- Before cleaning the appliance, turn it off, unplug from the mains socket and allow to cool.



*Important:*

Keep all packaging (plastic bags, polystyrene foam) away from children.



*Danger of burns!*

This appliance produces hot water and steam may form while it is in operation.

Avoid contact with splashes of water or hot steam.

When the appliance is in operation, the cup shelf could become very hot.

### Instruction for Use

Read this Instruction for Use carefully before using the appliance. Failure to follow this Instruction for Use may result in burns or damage to the appliance.

The manufacturer is not liable for damage deriving from failure to respect this Instruction for Use.



*Please note:*

Keep this Instruction for Use. If the appliance is passed to other persons, they must also be provided with this Instruction for Use.

## INTRODUCTION

Thank you for choosing this bean to cup espresso and cappuccino machine.

We hope you enjoy using your new appliance. Take a few minutes to read this Instruction for Use. This will avoid all risks and damage to the appliance.

### Letters in brackets

The letters in brackets refer to the legend in the description of the appliance on page 2-3.

### Troubleshooting and repairs

In the event of problems, first try and resolve them following the information given in the sections "Meaning of the alarm lights" on page 17 and "Troubleshooting" on page 18.

If this does not resolve the problem or you require further information, you should consult Customer Services by calling the number given on the annexed "Customer Service" sheet.

If your country is not among those listed on the sheet, call the number given in the guarantee. If repairs are required, contact De'Longhi Customer Services only. The addresses are given in the guarantee certificate provided with the machine.

## DESCRIPTION









### Description of the appliance

(page 3 - A )

- A1. Grinding adjustment dial
- A2. Main switch
- A3. Beans container
- A4. Beans container lid
- A5. Pre-ground coffee funnel lid
- A6. Compartment for measure
- A7. Cup shelf
- A8. Pre-ground coffee funnel
- A9. Steam spout
- A10. Cappuccino maker (removable)
- A11. Ring for selection CAPPUCCINO/LATTE
- A12. Steam nozzle (removable)
- A13. Water tank
- A14. Power cable
- A15. Cup tray
- A16. Drip tray
- A17. Infuser door
- A18. Coffee grounds container
- A19. Coffee spout (adjustable height)
- A20. Coffee guide
- A21. Infuser
- A22. Control panel
- A23. Measure

### Description of control panel

(page 3 - B )

- B1.  button: turns the appliance on and off. (stand by).
- B2. Temperature OK or 1 cup coffee light
- B3.  button: to make 1 cup of coffee
- B4. Temperature OK or 2 cup coffee light
- B5. Tasto : to make 2 cups of coffee
- B6. Temperature OK for steam light
- B7.  button: to select the steam function
- B8. Coffee quantity selection dial (short, standard or long)
- B9. Selection dial to choose the coffee taste (for a mild, standard or strong coffee) or to use pre-ground coffee .
- B10. Steam dial/hot water
- B11.  light: no water or water tank not inserted
- B12.  light: grounds container full or missing
- B13.  light: general alarm
- B14. Rinsing or descaling button
- B15. Descaling light
- B16. **ECO** energy saving mode button
- B17. Energy saving mode light

## PRELIMINARY CHECKS

### Checking the appliance

After removing the packaging, make sure the product is complete and undamaged and that all accessories are present.

Do not use the appliance if it is visibly damaged.

Contact Customer Service (see enclosed guarantee leaflet).

### Installing the appliance



*Important!*

When you install the appliance, you should follow the following safety warnings:

- The appliance gives off heat.  
After positioning the appliance on the worktop, leave a space of at least 3 cm between the surfaces of the appliance and the side and rear walls and at least 15 cm above the coffee maker.
- Water penetrating the appliance could cause damage.  
Do not place the appliance near taps or sinks.
- The appliance could be damaged if the water it contains freezes.  
Do not install the appliance in a room where the temperature could drop below freezing point.
- Arrange the power cable in such a way that it cannot be damaged by sharp edges or contact with hot surfaces (e.g. electric hot plates).

### Connecting the appliance



*Important!*

Check that the mains power supply voltage corresponds to the value indicated on the rating plate on the bottom of the appliance.

Connect the appliance to an efficiently earthed and correctly installed socket with a minimum current rating of 10A only.







If the power socket does not match the plug on the appliance, have the socket replaced with a suitable type by a qualified professional.

### Using the coffee maker for the first time



*Please note:*

- Coffee has been used to factory test the appliance and it is therefore completely normal for there to be traces of coffee in the mill. The machine is, however, guaranteed to be new.
  - You should customise water hardness as soon as possible following the instructions in the section "Setting water hardness" on page 15.
1. Plug the appliance into the mains socket.
  2. Remove the water tank, fill to the MAX line with fresh water then replace in the appliance (fig. 1).

3. Turn the cappuccino maker outwards and place a container with a minimum capacity of 100 ml underneath (fig. 2).
4. Place the main switch on the back of the appliance in the I position (fig. 3).
5. The lights , ,  flash.
6. Turn the steam dial anticlockwise as far as it will go (fig. 5). This is priming the water system. (It is normal for the machine to make some noise).
7. Wait for delivery of hot water to stop automatically. The lights , ,  flash to indicate that you must close the steam tap by turning the steam dial to the 0 position.
8. Turn the steam dial to the 0 position. The appliance goes off automatically.

To use the appliance, turn it on.

 **Please note :**

- When using the appliance for the first time, you need to make 4-5 cups of coffee or 4-5 cappuccinos before the appliance starts to give satisfactory results.

## TURNING THE APPLIANCE ON

 **Please note:**

Before turning the appliance on, make sure the main switch on the back of the appliance is in the I position (fig. 3).



Each time the appliance is turned on, it performs an automatic preheat and rinse cycle which cannot be interrupted.

The appliance is ready for use only after completion of this cycle.

 **Danger of burns!**

During rinsing, a little hot water comes out of the coffee spouts and is collected in the drip tray underneath.

Avoid contact with splashes of water.

- To turn the appliance on, press the  button (fig. 4). The  and  lights flash while the appliance is heating up and performing an automatic rinse cycle. By circulating the hot water, the appliance heats both the boiler and the internal circuits.

When the  and  lights remain on steadily, the appliance is at temperature.

## TURNING THE APPLIANCE OFF

Each time the appliance is turned off, it performs an automatic rinse cycle which cannot be interrupted.

 **Danger of burns!**

During rinsing, a little hot water flows from the coffee spouts.

Avoid contact with splashes of water.

To turn the appliance off, press the  button (fig. 4). The appliance performs a rinse cycle.

 **Please note:**

If the appliance is not used for an extended period, place the main switch in the 0 position (fig. 6).

 **Important!**

To avoid damaging the appliance, never place the main switch (fig. 6) in the 0 position while the appliance is on.

## SETTING THE AUTO-OFF (STAND BY)

The appliance is set by default to go off if not used for two hours. The time can be changed so that the appliance switches off after 15 or 30 minutes, or after 1, 2 or 3 hours.

1. With the appliance in stand-by (the main switch has to be turned to I position) (fig. 3), Press and hold the ECO button until the lights at the back of the control panel come on (see fig. after step 2).
2. Select the required period of time (15 or 30 minutes or 1, 2 or 3 hours) by pressing the  button (see the light/time table).

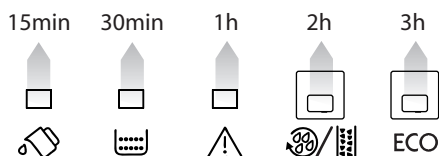

3. Press the **ECO** button to confirm the selection: auto-off is programmed.

 **Please note:**

To disconnect the appliance completely, place the main switch at the back of the appliance in the 0 position (fig. 6).

## ENERGY SAVING

Use this function to enable or disable energy saving mode. Energy saving mode reduces energy consumption in compliance with current European regulations.

To activate or deactivate this mode, press the **ECO** button. After a period of inactivity, if ECO mode is active the **ECO** button light comes on.

This mode is active by default.

 **Please note:**

A few seconds may elapse between energy saving mode and delivery of the first coffee.

## MAKING COFFEE

### Selecting the coffee taste

Turn the dial (B8) to select the required taste. Turning it clockwise increases the quantity of coffee beans the appliance will grind and therefore the strength of the coffee obtained.

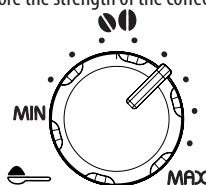

#### Please note :

- The first time you use the appliance, you will need to make a number of coffees to identify the correct dial position through trial and error.
- Make sure not to turn the dial too far clockwise, otherwise the coffee may be delivered too slowly (a drop at a time), particularly when making two cups of coffee.

### Selecting the quantity of coffee in the cup

Select the required quantity of coffee (B9) by turning the dial:



Turning it clockwise increases the amount of coffee obtained.

#### Please note :

The first time you use the appliance, you will need to make a number of coffees to identify the correct dial position through trial and error.

### Adjusting the coffee mill

The coffee mill is set by default to prepare coffee correctly and should not require regulating initially.

However, if after making the first few coffees you find that the coffee is either too weak and not creamy enough or delivery is too slow (a drop at a time), this can be corrected by adjusting the grinding adjustment dial (fig. 7).

#### Please note :

The grinding adjustment dial must only be turned when the coffee mill is in operation.

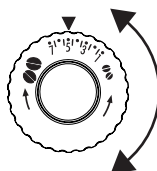

If the coffee is delivered too slowly or not at all, turn one click clockwise towards "7". For fuller bodied creamier coffee, turn one click anticlockwise towards "1" (do not turn more than one click at a time otherwise the coffee could be delivered a drop at a time).

These adjustments will only be evident after at least 2 cups of coffee have been delivered. If this adjustment does not obtain the desired result, turn the dial another click.

### Tips for a hotter coffee:





For hotter coffee, you should:

- before delivering the coffee, perform a rinse cycle by pressing the  button. Hot water is delivered from the spout, heating the internal circuits of the appliance and thus raising the coffee temperature.
- warm the cups by rinsing them with hot water (using the hot water function).





### Making coffee using coffee beans

#### Important!

Do not use caramelised or candied coffee beans as they could stick to the coffee mill and make it unusable.

1. Fill the container with coffee beans (fig. 8).
2. Place under the coffee spouts:
  - 1 cup, if you want 1 coffee (fig. 9);
  - 2 cups, if you want 2 coffees.
3. Lower the spouts as near as possible to the cup. This makes a creamier coffee (fig. 10).
4. Press the button corresponding to the number of coffees required (1 cup  or 2 cups  , fig. 11 and 12).
5. Preparation begins and the  and  lights flash.

#### Please note:

- While the machine is making coffee, delivery can be interrupted at any moment by pressing one of the two coffee buttons ( or  ).
- At the end of delivery, to increase the quantity of coffee in the cup, just press (within 3 seconds) one of the coffee buttons ( or  ).

Once the coffee has been made, the appliance is ready to use again.

#### Please note:

For hotter coffee, see the section "Tips for a hotter coffee".

#### Important!

- If the coffee is delivered a drop at a time, too weak and not creamy enough or too cold, read the tips in the “Trouble-shooting” section on page 18.
- Some light will switch: the relative meaning is explained in par. “Meaning of lights” (page 17).

### Making coffee using pre-ground coffee



**Important!**

- Never add pre-ground coffee when the machine is off or it could spread through the inside of the machine and dirty it. This could damage the appliance.
- Never use more than one level measure or it could dirty the inside of the machine or block the funnel.



**Please note:**

If you use pre-ground coffee, you can only make one cup of coffee at a time.

1. Turn the coffee taste selection dial to the ☞ position.
2. Make sure the funnel is not blocked, then add one level measure of pre-ground coffee (fig. 13).
3. Place a cup under the coffee spouts.
4. Press the ☞ 1 cup coffee button (fig. 11).
5. Preparation begins and can be interrupted by pushing one of the two delivery buttons (☞ or ☞☞).

To deactivate the pre-ground coffee function, turn the dial to one of the other positions.



**Please note:**

A few seconds may elapse between energy saving mode and delivery of the first coffee.

## MAKING CAPPUCCINO



**Important! Danger of burns**

During preparation, steam is given off. Take care to avoid scalds.

1. When preparing cappuccino, make the coffee in a large cup;
2. Fill a container with about 100 grams of milk for each cappuccino to be made. In choosing the size of the container, bear in mind that the milk doubles or triples in volume;



**Please note:**

For a richer denser froth, use skimmed or partially skimmed milk at refrigerator temperature (about 5°C).

To avoid milk with poor froth or large bubbles, always clean the cappuccino maker as described in the section “Cleaning the cappuccino maker”.

3. Press the ☞ button. The corresponding light flashes,

indicating that the appliance is heating up;

4. Make sure the ring on the cappuccino maker is positioned in the CAPPUCCINO position (fig. 14).
5. Turn the cappuccino maker outwards, immersing it in the milk container (fig. 15);
6. Once the ☞ light stops flashing, turn the steam dial to the I position. Steam is delivered from the cappuccino maker, giving the milk a creamy frothy appearance and making it more voluminous;
7. For a creamier froth, rotate the container with slow movements in an upward direction. (You should not discharge steam for more than 3 minutes at a time);
8. When you have obtained the required froth, stop steam delivery by turning the steam dial back to the 0 position.



**Important! Pericolo di scottature**

Always turn the dial in 0 position before removing the container with the frothed milk to avoid burns caused by splashes of boiling milk.

9. Add the milk froth to the cup of coffee prepared previously. The cappuccino is ready. Sweeten to taste and, if desired, sprinkle the froth with a little cocoa powder.



**Please note:**

- If immediately after making cappuccino and deactivating the steam function by pressing the steam button ☞ you press the ☞ or ☞☞ button because you want to make another coffee, the coffee maker will be too hot (the ☞ and ☞☞ lights flash to indicate an unsuitable temperature). You must wait about ten minutes for the appliance to cool down sufficiently.

To cool it down more quickly, after deactivating the steam function, open the steam knob and let the water flow out of the cappuccino maker into a container until the lights ☞ and ☞☞ stop flashing.



**Danger of burns**

Avoid contact with splashes of water.

### Making hot milk (without froth)

To make hot milk without froth, proceed as described in the above section, making sure the ring on the cappuccino maker is positioned upwards in the “LATTE” position.

### Cleaning the cappuccino maker after use.

Clean the cappuccino maker each time you use it to avoid the build-up of milk residues or blockages.



**Important! Danger of burns**

When cleaning the cappuccino maker, a little hot water is delivered. Avoid contact with splashes of water.

1. Deliver a little water for a few seconds by rotating the steam knob to the I position.  
Then turn the steam knob to the 0 position to stop the flow of hot water.
2. Wait for a few minutes for the cappuccino maker to cool down. Grip the handle of the cappuccino maker tube firmly in one hand and with the other rotate the cappuccino maker anticlockwise and remove by pulling downwards (fig. 16).
3. Remove the ring upwards (fig. 17).
4. Wash all parts of the cappuccino maker thoroughly with a sponge and warm water.
5. Make sure the holes shown by the arrows in fig. 18 are not blocked. If necessary, clean with a pin.
6. Carefully wash all the parts of the cappuccino maker with a sponge and warm water.
7. Replace the inner section by inserting it carefully onto the adjustable tube, then insert the steam nozzle and lock it in place.

## HOT WATER



**Important! Danger of burns.**

Never leave the machine unsupervised while delivering hot water.

As shown below, stop delivery of hot water when the cup is full. The cappuccino maker becomes hot while water is being delivered and must be held by the handle only.

1. Place a container under the cappuccino maker (as close as possible to avoid splashes).
2. Check that the and lights are on steadily.
3. Turn the steam knob a half turn anticlockwise as far as it will go. Delivery begins.
4. Stop by turning the steam knob to the 0 position



**Please note:**

- If "Energy Saving" mode is active, you may have to wait a few seconds before the hot water is delivered.
- If you want to make steam after preparing hot water, it is recommended to empty the water circuits opening the steam knob for a few seconds.

## CLEANING

### Cleaning the coffee maker

The following parts of the machine must be cleaned regularly:

- coffee grounds container (A18),
- drip tray (A16),
- water tank (A13),

- coffee spouts (A19),
- pre-ground coffee funnel (A8),
- inside of the machine, accessible after opening the infuser door (A19),
- infuser (A21).



**Important!**

- Do not use solvents, abrasive detergents or alcohol to clean the coffee maker. With De'Longhi superautomatic coffee makers, you need not use chemical products to clean the machine.
- None of the components can be washed in a dishwasher.
- Do not use metal objects to remove encrustations or coffee deposits as they could scratch metal or plastic surfaces.

### Cleaning the coffee grounds container

When the light flashes, the coffee grounds container needs emptying. Unless you clean the grounds container, the light will continue to flash and the appliance cannot be used to make coffee.

To clean (with the machine on):

- Open the service door on the front of the appliance, extract the drip tray (fig. 19), empty and clean.
- Empty the grounds container and clean thoroughly to remove all residues left on the bottom.



**Important!**

When removing the drip tray, the grounds container **must** be emptied, even if it contains few grounds.

If this is not done, when you make the next coffees, the grounds container may fill up more than expected and clog the machine.

### Cleaning the drip tray



**Important!**

If the drip tray is not emptied regularly, the water could overflow from the edge and seep inside or around the machine.

This could damage the machine, the surface it rests on or the surrounding area.

The drip tray is fitted with a level indicator (red) showing the level of water it contains (fig. 20). Before the indicator protrudes from the cup tray, the drip tray must be emptied and cleaned. To remove the drip tray:

1. Remove the drip tray and the grounds container (fig. 19);
2. Empty the drip tray and grounds container and wash them;
3. Replace the drip tray and grounds container.

### Cleaning the inside of the machine



**Danger of electric shock!**

Before cleaning internal parts, the machine must be turned off

(see "Turning off") and unplugged from the mains power supply. Never immerse the coffee maker in water.

1. Check regularly (about once a month) that the inside of the appliance (accessible after removing the drip tray) is not dirty.  
If necessary, remove coffee deposits with a brush and a sponge.
2. Aspirare tutti i residui con un aspirapolvere (fig. 21).

### Cleaning the water tank

1. Clean the water tank (A12) regularly (about once per month and, if fitted, every time you change the water filter) using a wet sponge and mild soapy water.
2. Remove the residues with a vacuum cleaner

### Cleaning the coffee spouts

1. Clean the coffee spouts with a sponge or cloth (fig. 22).
2. Check the holes in the coffee spout are not blocked. If necessary, remove coffee deposits with a toothpick (fig. 23).

### Cleaning the pre-ground coffee funnel

Check regularly (about once a month ) that the pre-ground coffee funnel (A8) is not blocked. If necessary, remove coffee deposits with a brush.

### Cleaning the infuser

The infuser (A20) must be cleaned at least once a month.



**Important!**

The infuser must not be extracted when the machine is on.

1. Make sure the machine is correctly turned off (see Turning off).
2. Open the service door
3. Extract the drip tray and the grounds container (fig. 19).
4. Press the two red release buttons inwards and at the same time pull the infuser outwards (fig. 24).



**Important!**

**RINSE WITH WATER ONLY**

**NO WASHING UP LIQUID - NO DISH WASHER**

Do not use washing up liquid to clean the infuser as it could cause damage.

5. Soak the infuser in water for about 5 minutes, then rinse under the tap.
6. After cleaning, replace the infuser by sliding it onto the internal support and pin at the bottom, then push the PUSH symbol fully in until it clicks into place.

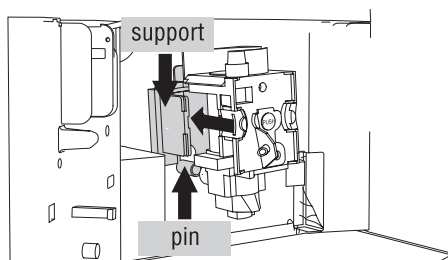

**Please note!**

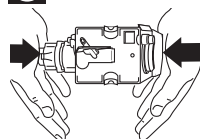

If the infuser is difficult to insert, before insertion, adapt it to the right size by pressing the two levers shown in the figure.

7. Once inserted, make sure the two red buttons have snapped out.
8. Close the infuser door.
9. Replace the water tank.

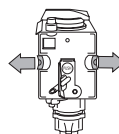

## DESCALING

Descale the appliance when the ☕/🚰 light on the panel flashes.



**Important!**

- Descaler contains acids which may irritate the skin and eyes. It is vital to respect the manufacturer's safety warnings given on the descaler pack and the warnings relating to the procedure to follow in the event of contact with the skin and eyes.
- You should use De'Longhi descaler only. Using unsuitable descaler and/or performing descaling incorrectly may result in faults not covered by the manufacturer's guarantee.

1. Turn the machine on.
2. Empty the water tank(A13).
3. Pour the descaler diluted with water (respecting the proportions indicated on the descaler pack) into the water tank.  
Place an empty container with a minimum capacity of 1.5 litres under the hot water spout.
4. Wait for the ☕ and ☕🚰 lights to come on steadily.



**Important! Danger of burns**

Hot water containing acid flows from the cappuccino maker. Avoid contact with splashes of water.

5. Press the ☕/🚰 button and hold it down for at least 5 seconds to confirm that you have added the solution and begin the descaling procedure. The light in the button remains on steadily to indicate that the descaling pro-





## TECHNICAL SPECIFICATION

Voltage:	220-240 V~ 50/60 Hz max. 10 A
Absorbed power:	1450 W
Pressure:	15 bar
Water tank capacity:	1,7 L
Size: LxHxD:	280x364x400 mm
Cable length:	1500 mm
Weight:	10,8 kg



This product complies with European regulation no. 1935/2004 on materials and articles intended to come into contact with food.

## DISPOSAL























The appliance must not be disposed of with household waste, but taken to an authorised waste separation and recycling centre.

## MEANING OF LIGHTS DURING NORMAL OPERATION

LIGHTS	DESCRIPTION	MEANING
<b>1</b>	The lights flash	The water is not yet at the ideal temperature. Wait for the lights to come on steadily before making coffee
<b>2</b>	The lights are on steadily	The appliance is ready to make coffee
<b>3</b>	The light is on steadily	The appliance is delivering one cup of coffee
<b>4</b>	The light is on steadily	The appliance is delivering two cups of coffee
<b>5</b>	The steam light is flashing	The appliance is heating up to make steam. Wait for the light to remain on steadily before using the steam function.
<b>6</b>	The steam light is on steadily	The appliance is ready to make steam.
<b>7</b>	The lights flash alternately	The appliance is turning off.
<b>8</b>	The lights flash	It is necessary to turn to pos. I the steam dial.
<b>9</b>	The lights flash alternately	It is necessary to turn to pos. 0 the steam dial.
<b>10</b>	The light is on steadily	The appliance is in energy saving mode
<b>11</b>	The light is on steadily	The automatic descaling programme is underway

## MEANING OF THE ALARM LIGHTS

LIGHTS	DESCRIPTION	MEANING	WHAT TO DO
<b>1</b>     	The light is on steadily	Insufficient water in the tank or the tank is not correctly inserted	Fill the tank with water and insert it correctly, pushing it as far as it will go until it clicks into place.
		The tank is dirty or clogged with limescale	Rinse or descale the tank
<b>2</b>     	The light flashes	The grinding is too fine and the coffee is delivered too slowly or not at all.	Repeat coffee delivery and turn the grinding adjustment knob (fig. 10) one click clockwise towards "7" while the coffee mill is in operation. If after making at least 2 coffees delivery is still too slow, repeat the correction procedure, turning the grinding adjustment knob another click until delivery is correct (see the section: Adjusting the coffee mill).
		The appliance can't make coffee	Turn the steam dial in I position and deliver a small amount of water
<b>3</b>     	The light is on steadily	After cleaning, the grounds container has not been replaced.	Empty the grounds container and drip tray, clean and replace (fig. 18). Important: when removing the drip tray, the grounds container <b>MUST</b> be emptied, even if it contains few grounds. If this is not done, when you make the next coffees, the grounds container may fill up more than expected and clog the machine
<b>4</b>      	The light flashes	The "pre-ground coffee" function has been selected without placing any pre-ground coffee in the funnel.	Place pre-ground coffee in the funnel or deselect the "pre-ground" function
		The coffee beans have run out.	Fill the beans container
		If the coffee mill is very noisy, this means a small stone in the coffee beans has blocked the mill.	Contact Customer Services

<b>5</b>	The light flashes	The machine must be descaled	The descaling procedure described in the section “Descaling” needs to be performed as soon as possible
<b>8</b>	The lights flash	The pre-ground coffee funnel is clogged	Empty the funnel with the help of a brush as described in the section “Cleaning the pre-ground coffee funnel”.
<b>6</b>	There is an unusual noise and the lights flash alternately	The infuser has not been replaced after cleaning	Leave the service door closed and the infuser out of the coffee maker. Press the  or  buttons together until the four lights go off. Only when all four lights are off can the door be opened and the infuser inserted.
<b>7</b>	The lights flash alternately	The coffee maker has just been turned on, the infuser is not inserted correctly and the service door is not correctly closed.	Press the word PUSH on the infuser until it clicks into place. Make sure the two red buttons have snapped out. Close the service door and turn the appliance on again
<b>9</b>	The light is on steadily	The infuser has not been replaced after cleaning.	Insert the infuser as described in the paragraph “Cleaning the infuser”
		The inside of the appliance is very dirty	Clean the appliance thoroughly
<b>10</b>	The light flashes	The service door is open	If you cannot close the door, make sure the infuser is correctly inserted
<b>11</b>	The lights flash alternately	The coffee maker has been switched on with the steam knob in the open position	Turn the steam knob clockwise until delivery stops

## TROUBLESHOOTING

Below is a list of some of the possible malfunctions.

If the problem cannot be resolved as described, contact Customer Services.

PROBLEM	POSSIBLE CAUSE	SOLUTION
The coffee is not hot	The cups were not preheated.	Warm the cups by rinsing them with hot water (Note: you can use the hot water function).
	The infuser has cooled down because 2/3 minutes have elapsed since the last coffee was made.	Before making coffee, heat the infuser by pressing the  button.

The coffee is weak or not creamy enough.	The coffee is ground too coarsely.	Turn the grinding adjustment knob one click anticlockwise towards "1" while the coffee mill is in operation (fig. 7). Continue one click at a time until coffee delivery is satisfactory. The effect is only visible after delivering 2 coffees (see the section: "Adjusting the coffee mill" on page 11).
	The coffee is unsuitable.	Use coffee beans suitable for espresso coffee makers
The coffee is delivered too slowly or a drop at a time.	The coffee is ground too finely.	Turn the grinding adjustment knob one click clockwise towards "7" while the coffee mill is in operation (fig. 7). Continue one click at a time until coffee delivery is satisfactory. The effect is only visible after delivering 2 coffees (see the section: "Adjusting the coffee mill" on page 11).
Coffee does not come out of one of the spouts.	The spouts are blocked.	Clean the spouts with a toothpick.
The coffee does not come out of the spouts, but from around the service door.	The holes in the spouts are clogged with dry coffee dust	The coffee guide inside the service door is blocked and cannot swing.
	Clean the spouts with a toothpick, sponge or hard bristled kitchen brush.	Thoroughly clean the coffee guide, particularly near the hinges.
The frothed milk has large bubbles	The milk is not cold enough or is not semi-skimmed.	You should ideally use skimmed or semi-skimmed milk at refrigerator temperature (about 5°C). If the result is not as you wished, try changing brand of milk.
The milk is not frothed	Cappuccino maker dirty.	Clean as described in the section "Cleaning the cappuccino maker after use".
	The ring is not in CAPPUCINO position	Push the ring in CAPPUCINO position
Steam delivery stops	A safety device stops steam delivery after 3 minutes.	Wait, then activate the steam function again.
The appliance does not come on.	It is not plugged into the mains socket.	Plug into the mains socket.
	The main switch (A8) is not turned on.	Place the main switch in the I position (fig. 3).
When the steam/hot water knob is turned to the I position, steam/hot water is not delivered from the cappuccino maker	The holes in the cappuccino maker and/or steam nozzle are blocked	Clean the cappuccino maker as described in the section "Cleaning the cappuccino maker after use".
The infuser assembly cannot be removed for cleaning.	The appliance is on or has not completed the turning off cycle.	The infuser can only be removed when the appliance has been turned off correctly (see the section "Turning off").