

ECAM23.12X - ECAM25.12X

BEAN TO CUP ESPRESSO
AND CAPPUCCINO
MACHINE
Instruction for use

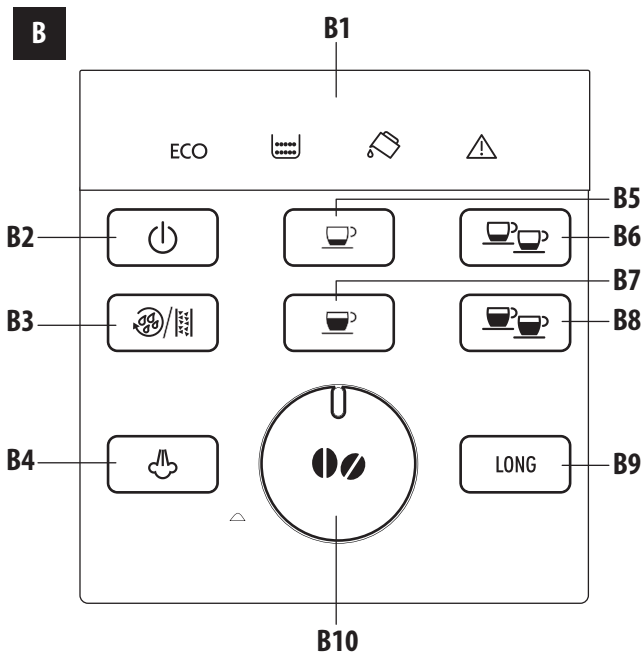

De'Longhi

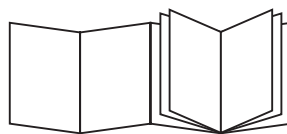

C

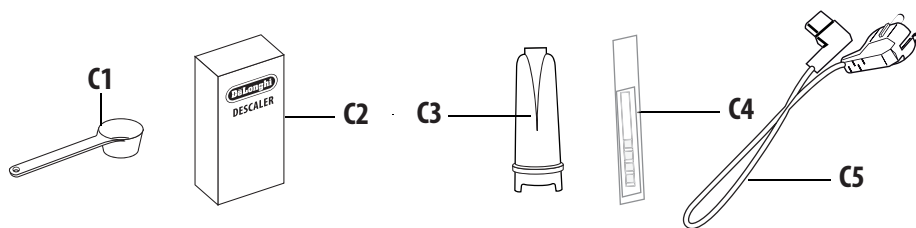

A

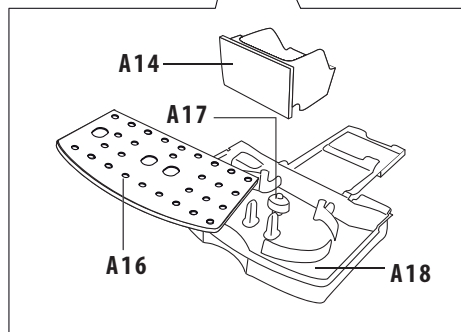
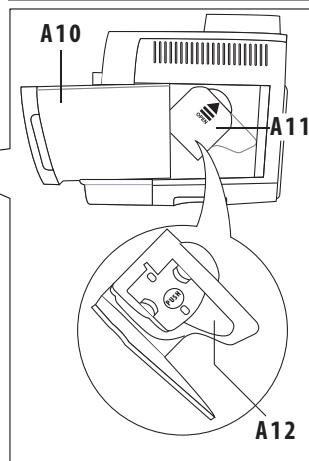
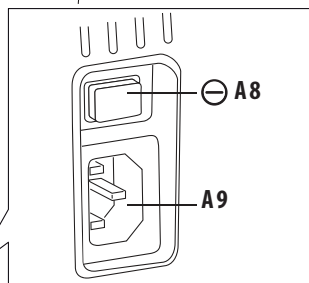
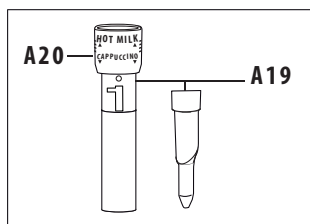
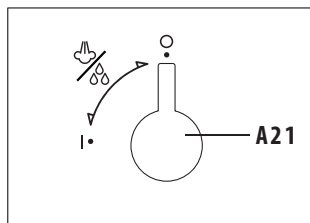
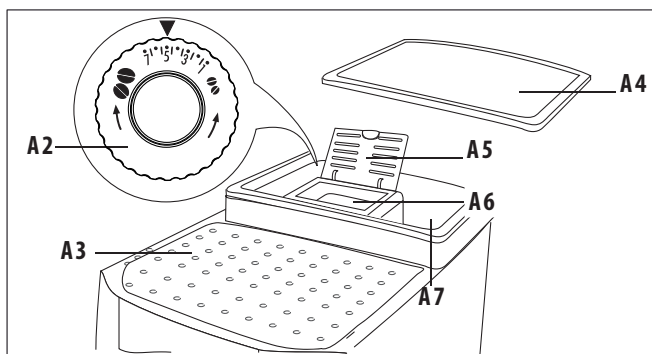

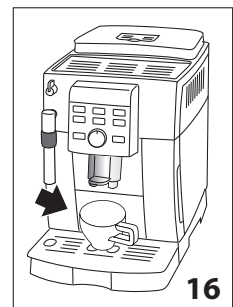
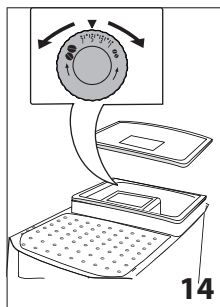
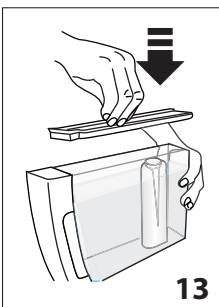
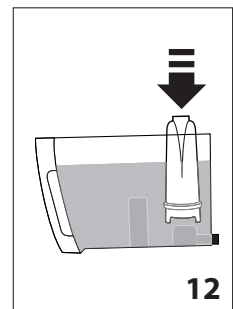
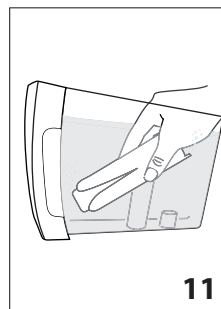
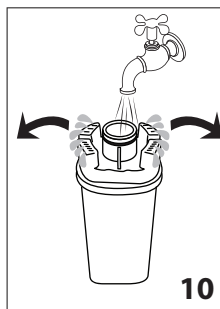
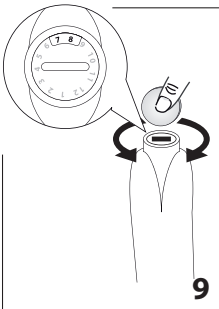
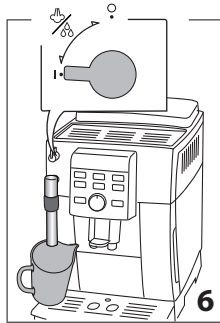
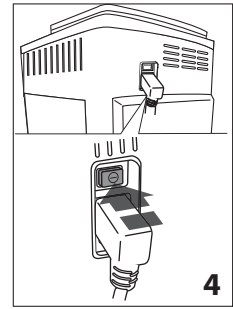
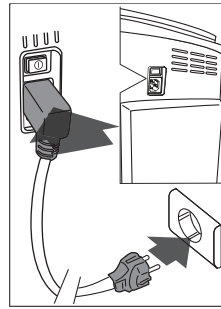
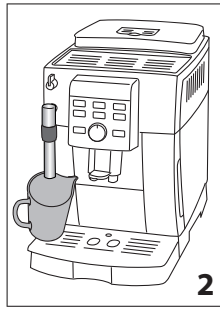
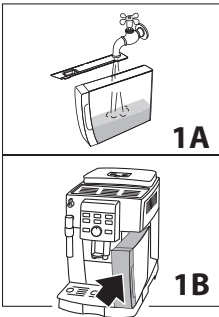

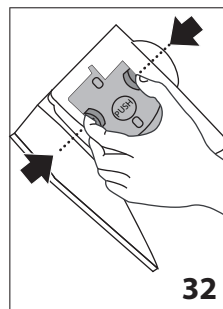
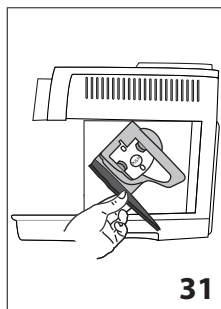
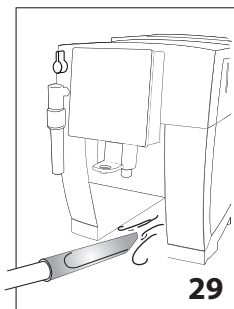
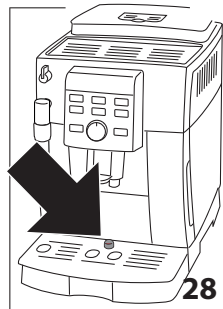
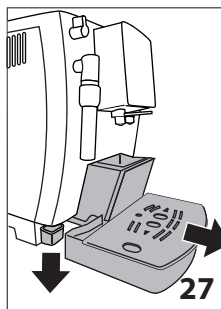
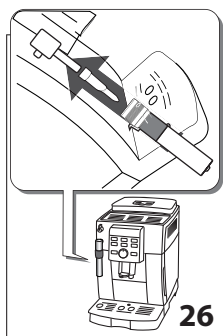
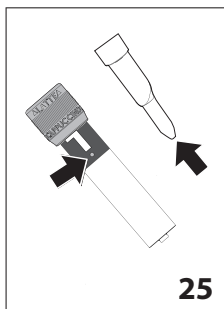
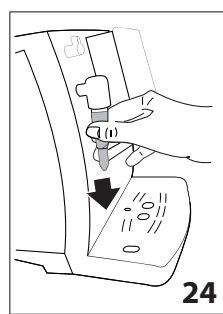
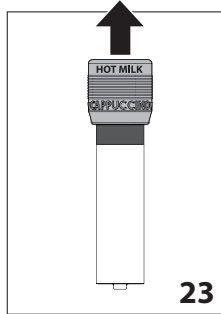
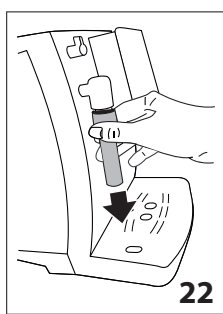
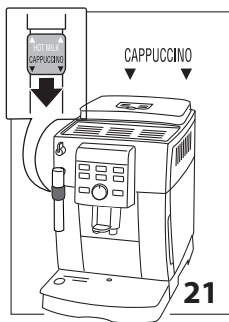
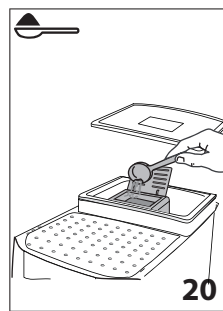
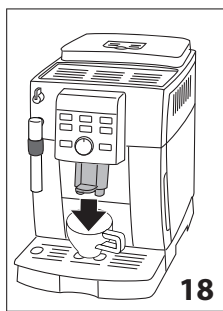
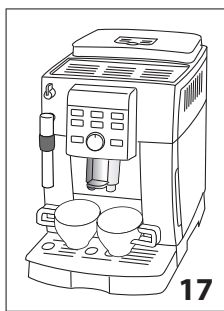

CONTENTS

INTRODUCTION	7
Symbols used in these instructions	7
Letters in brackets	7
Troubleshooting and repairs	7
SAFETY	7
Fundamental safety warnings.....	7
Designated use	7
Instruction for Use.....	8
DESCRIPTION	8
Description of the appliance	8
Description of the control panel	8
Description of the accessories	8
Description of indicators	8
BEFORE USE	9
Checking the appliance	9
Installing the appliance	9
Connecting the appliance	9
Setting up the appliance	9
TURNING THE APPLIANCE ON	9
TURNING THE APPLIANCE OFF	10
AUTO-OFF	10
ENERGY SAVING	10
WATER SOFTENER FILTER	10
Installing the filter	10
Removal and replacement of the water softener filter ...	11
MAKING COFFEE	11
Selecting the coffee strength	11
Selecting the quantity of coffee in the cup	11
Programming the quantity of coffee	11
Adjusting the grinder.....	11
Setting the temperature	12
Tips for a hotter coffee	12
Making coffee using coffee beans	12
Making coffee using pre-ground coffee	12
MAKING LONG COFFEE.....	12
MAKING CAPUCCINO AND HOT MILK (NOT FROTHED)	13
Making hot milk (not frothed)	13
Cleaning the cappuccino maker after use.....	13
MAKING HOT WATER	13

CLEANING	13
Cleaning the machine	13
Cleaning the coffee grounds container.....	14
Cleaning the drip tray and condensate tray.....	14
Cleaning the inside of the coffee machine	14
Cleaning the water tank.....	14
Cleaning the coffee spouts	14
Cleaning the pre-ground coffee funnel	14
Cleaning the infuser	14
DESCALING	15
SETTING WATER HARDNESS	16
Measuring water hardness.....	16
Set water hardness	16
TECHNICAL DATA.....	16
DISPOSAL.....	16
WARNING INDICATORS.....	17
TROUBLESHOOTING	18
ELECTRICAL CONNECTION (UK ONLY).....	19

INTRODUCTION

Thank you for choosing this automatic espresso and cappuccino machine.

We hope you enjoy using your new appliance.

Take a few minutes to read this Instruction for Use.

This will avoid all risks and damage to the appliance.

Symbols used in these instructions

Important warnings are identified by these symbols. It is vital to respect these warnings.



Danger!

Failure to observe the warning may result in life threatening injury by electric shock.



Important!

Failure to observe the warning could result in injury or damage to the appliance.



Danger of burns!

Failure to observe the warning could result in burns or scalding.



Please note:

This symbol identifies important advice or information for the user.

Letters in brackets

The letters in brackets refer to the legend in the Description of the Appliance on pages 2 and 3.

Troubleshooting and repairs

In the event of problems, first try and resolve them following the information given in the sections "Displayed messages" on page 18 and "Troubleshooting" on page 19.

If this does not resolve the problem or you require further information, you should consult Customer Services by calling the number given on the annexed "Customer Service" sheet.

If your country is not among those listed on the sheet, call the number given in the guarantee. If repairs are required, contact De'Longhi Customer Services only. The addresses are given in the guarantee certificate provided with the machine.

SAFETY

Fundamental safety warnings



Danger!

This is an electrical appliance and may cause electric shock.

You should therefore follow these safety warnings:

- Never touch the appliance with damp hands or feet.
- Never touch the plug with damp hands.
- Make sure the socket used is freely accessible at all times, enabling the appliance to be unplugged when necessary.

- Unplug directly from the plug only. Never pull the power cable as you could damage it.
- To disconnect the appliance completely, unplug it from the mains socket.
- If the appliance is faulty, do not attempt to repair. Turn it off, unplug from the mains socket and contact Customer Services.

If the plug or power cable is damaged, it must be replaced by De'Longhi Customer Services only to avoid all risk.

Never immerse the appliance in water when cleaning. It is an electrical appliance.

- Before cleaning the outside of the appliance, turn it off, unplug from the mains socket and allow to cool.



Important:

Keep all packaging (plastic bags, polystyrene foam) away from children.

This appliance can be used by children aged from 8 years and above and persons with reduced physical, sensory or mental capabilities or lack of experience and knowledge if they have been given supervision or instruction concerning use of the appliance in a safe way and understand the hazards involved.

Children shall not play with the appliance.

Cleaning and user maintenance shall not be made by children without supervision.



Danger of burns!

This appliance produces hot water and steam may form while it is in operation.

Avoid contact with splashes of water or hot steam.

When the appliance is in operation, do not touch the cup warmer shelf, as it is hot.



Surfaces marked with this symbol become hot during use (the symbol is present on certain models only).

Designated use

This appliance is designed and made to prepare coffee and heat drinks.

This is a household appliance only.

It is not intended to be used in:

- staff kitchen areas in shops, offices and other working environments;
- farm houses;
- by clients in hotels, motels and other residential type environments;
- bed and breakfast type environments.

Any other use is considered improper and thus dangerous.

The manufacturer is not liable for damage deriving from improper use of the appliance.

Instruction for Use

Read these instructions carefully before using the appliance. Failure to respect these instructions may result in burns or damage to the appliance.

The manufacturer is not liable for damage deriving from failure to respect this Instruction for Use.



Please note:

Keep this Instruction for Use.

If the appliance is passed to other persons, they must also be provided with this Instruction for Use.

DESCRIPTION

Description of the appliance







(page 3 - A)

- A1 Control panel
- A2 Grind coarseness dial
- A3 Cup shelf
- A4 Beans container lid
- A5 Pre-ground coffee funnel lid
- A6 Pre-ground coffee funnel
- A7 Beans container
- A8 Main power switch
- A9 Socket for power cable connector
- A10 Water tank
- A11 Infuser door
- A12 Infuser
- A13 Coffee spout (adjustable height)
- A14 Coffee grounds container
- A15 Condensate tray
- A16 Cup rest
- A17 Drip tray water level indicator
- A18 Drip tray
- A19 Cappuccino maker (milk frothing arm)
- A20 Cappuccino/hot milk toggle
- A21 Steam/hot water dial

Description of the control panel

(page 2 - B)

The buttons have incorporated indicators which either light up or flash as appropriate: the meanings are indicated in brackets in the description.

- B1. Indicator display (see "Description of indicators")
- B2.  button: to turn the appliance on and off (*indicator flashing - the appliance is heating up; indicator on - the appliance is ready for use.*)
- B3.  button: to rinse or descale the appliance (*white indicator on - the appliance is rinsing; red and white alternate flashing indicators - appliance needs descaling*)
- B4.  button: to deliver steam to make cappuccino and milk based coffees (*light on - the "steam" function has been selected; light flashing - you must turn the steam dial; indicator fading - the appliance is heating up*)
- B5.  button: to make 1 cup of short espresso coffee (*indicator on - this setting has been selected*)
- B6.  button: to make 2 cups of short espresso coffee (*indicator on - this setting has been selected*)
- B7.  button: to make 1 cup of long espresso coffee (*indicator on - this setting has been selected*)
- B8.  button: to make 2 cups of long espresso coffee (*indicator on - this setting has been selected*)
- B9. **LONG** button: to make 1 cup of LONG coffee (*indicator on - this setting has been selected*)
- B6. Selection dial: turn to select coffee strength or to use pre-ground coffee.

Description of the accessories

(page 2 - C)

- C1 Pre-ground coffee measure
- C2 Descaler
- C3 Water softener filter (certain models only)
- C4 Total Hardness Test indicator paper
- C5 Power cable

Description of indicators



A warning is displayed on the control panel (see the section "Warning indicators" on page 17).

Indicator on: that the coffee grounds container must be inserted;

Indicator flashing: the coffee grounds container is full and must be emptied.



Indicator on: the water tank must be inserted;
Indicator flashing: insufficient water in the tank.

ECO indicates that "Energy Saving" mode is active.

BEFORE USE

Checking the appliance

After removing the packaging, make sure the product is complete and undamaged and that all accessories are present.

Do not use the appliance if it is visibly damaged.

Contact De'Longhi Customer Services.

Installing the appliance



Important!

When you install the appliance, you should observe the following safety warnings:

- The appliance could be damaged if the water inside it freezes.
Do not install the appliance in a room where the temperature could drop below freezing point.
- The appliance gives off heat.
After positioning the appliance on the worktop, leave a space of at least 3 cm between the surfaces of the appliance and the side and rear walls and at least 15 cm above the coffee machine.
- Water penetrating the appliance could cause damage.
Do not place the appliance near taps or sinks.
- Arrange the power cable in such a way that it cannot be damaged by sharp edges or contact with hot surfaces (e.g. electrical hot plates).

Connecting the appliance



Important!

Check that the mains power supply voltage corresponds to that indicated on the rating plate on the bottom of the appliance.

Connect the appliance to an efficiently earthed and correctly installed socket with a minimum current rating of 10A only.

If the power socket does not match the plug on the appliance, have the socket replaced with a suitable type by a qualified professional.

Setting up the appliance



Please note:

- Coffee has been used to factory test the appliance and it is therefore completely normal for there to be traces of coffee in the grinder.

The machine is, however, guaranteed to be new.

- You should customise water hardness as soon as possible following the instructions in the section "Setting water hardness" on page 16).

Follow these instructions:

1. Remove the water tank, fill to the MAX line with fresh water (fig. 1A) then insert back into the appliance (fig. 1B).
2. Place a container with a minimum capacity of 100 ml under the cappuccino maker (fig. 2).
3. Insert the power cable connector into the socket at the back of the appliance and connect the appliance to the mains electricity supply (fig. 3). Make sure the main power switch at the back of the appliance is pressed down (fig. 4).
4. The  indicator should flash on the control panel (fig. 5).
5. Turn the steam dial to the "I" position (fig. 6). Water is delivered by the cappuccino maker, then the appliance switches itself off.
6. Turn the steam dial to the "0" position.

The coffee machine is now ready for normal use.



Please note:

- When setting up the appliance, you need to make 4-5 cups of coffee or 4-5 cappuccinos before the appliance starts to give satisfactory results.

TURNING THE APPLIANCE ON



Please note:

- Before turning the appliance on, make sure the main power switch at the back of the appliance is pressed down (fig. 4).
- Each time the appliance is turned on, it performs an automatic preheat and rinse cycle which cannot be interrupted. The appliance is ready for use only once this cycle is complete.



Danger of scalding!

During rinsing, a little hot water comes out of the coffee spouts and is collected in the drip tray underneath.

Avoid contact with splashes of water.

- To turn the appliance on, press the  button (fig. 7): the indicator flashes while the appliance is heating up and performing the automatic rinse cycle. By circulating hot water, the appliance heats both the boiler and the internal circuits.

The appliance as reached the correct temperature once all the indicators on the buttons are on - indicating that any function can now be selected.

TURNING THE APPLIANCE OFF

Each time the appliance is turned off, it performs an automatic rinse cycle which cannot be interrupted.



Danger of scalding!

During rinsing, a little hot water comes out of the coffee spouts. Avoid contact with splashes of water.

To turn the appliance off, press the  button (fig. 7).

The appliance performs a rinse cycle then turns off (stand-by).



Please note:

If you will not be using the appliance for some time, unplug it from the mains socket:

- first turn the appliance off by pressing the  button (fig. 7);
- press the main power switch (fig. 4).





Important!

Never press the main power switch while the appliance is switched on.

AUTO-OFF

Auto-off can be set so that the appliance turns off after 15 or 30 minutes, or after 1, 2 or 3 hours.

To re-set Auto-off, proceed as follows:

1. With the appliance turned off but with the main power switch pressed down, press the  button and hold it down until the indicators on the control panel come on.
2. Press the  button until the indicators corresponding to the amount of time before the appliance turns off automatically come on:

15 minutes **ECO**

30 minutes **ECO** 

1 hour **ECO**  

2 hour **ECO**   





3 hour **ECO**    

3. Press the  button to confirm the selection. The indicators go off.

ENERGY SAVING

Use this function to enable or disable Energy Saving. When enabled, the function reduces energy consumption in compliance with EU regulations.

Energy saving mode is active when the **ECO** indicator is on.

1. With the appliance turned off but with the main power switch pressed down, press the  button and hold it down until the **ECO** indicator comes on (fig. 8).
2. To deactivate this function off, press the  button until the **ECO** indicator flashes.
3. To re-activate this function, press the  button again: the **ECO** indicator should come on.
4. Press the  button to confirm the selection. The **ECO** indicator goes off.



Please note:

When in energy saving mode, a few seconds may elapse before the first coffee is delivered as the appliance must heat up again.

WATER SOFTENER FILTER

Certain models are fitted with a water softener filter. If this is not the case with your model, you are recommended to purchase one from authorised De'Longhi Service Centres.



Important:

- Keep in a cool dry place out of direct sunlight.
- After opening the packaging, use the filter at once.
- Remove the filter before descaling the machine.

To use the filter correctly, follow the instructions below.

Installing the filter

1. Remove the filter from the packaging.
2. Turn the date indicator disk until the next two months of use are displayed (fig 9).



Please note:

The filter lasts about two months if the appliance is used normally. If the coffee machine is left unused with the filter installed, it will last a maximum of three weeks.

3. To activate the filter run tap water into the hole as indicated in the diagram letting the water run out of the side openings for at least one minute (fig. 10).
4. Take out the tank from the appliance and fill with water (fig. 1A).
5. Place the filter in the water tank and submerge it completely, tilting it to enable the air bubbles to escape (fig. 11).
6. Insert the filter into the filter housing and press as far as it will go (fig.12).

7. Close the tank with the lid (fig. 13), and then replace the tank in the machine.
8. Place a container with a minimum capacity of 100 ml under the cappuccino maker.
9. Turn the steam dial to the I position to deliver hot water.
10. Let the machine dispense hot water for a few seconds until the flow of water is steady, then turn the steam dial back to the 0 position.



Please note:

Occasionally one delivery of hot water is not enough to install the filter and the following indicators will come on during installation:



If this happens repeat the installation procedure from point 9. The filter is now active and you can use the coffee machine.

Removal and replacement of the water softener filter

After two months (see date indicator disk), or if the appliance has not been used for 3 weeks, the filter must be removed from the tank and replaced with a new one. Then the installation procedure above must be repeated.

MAKING COFFEE

Selecting the coffee strength

Turn the selection dial (B10) to set the required coffee strength. Turning it clockwise increases the quantity of coffee beans the appliance will grind and therefore increases the coffee strength. Turn the dial to MIN for an extra mild coffee and to MAX for an extra strong coffee.

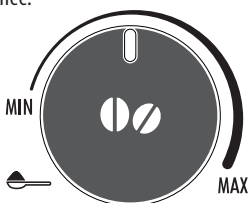

Please note:

- The first time you use the appliance, you will need to make a number of coffees to identify the correct dial position through trial and error.
- Do not turn the dial too far towards MAX, otherwise the coffee may be delivered too slowly (in drops), particularly when making two cups of coffee at the same time.

Selecting the quantity of coffee in the cup

The appliance is set by default to automatically make the following quantities of coffee:

- short espresso coffee, when the button is pressed (≈40ml);
- long espresso coffee when the button is pressed (≈120ml);
- two short espresso coffees when the button is pressed;
- two long espresso coffees when the button is pressed.

Programming the quantity of coffee

To change the quantity of coffee the appliance delivers automatically into the cup, proceed as described below:

- press the button corresponding to the quantity to be modified and hold it down until the indicator for short espresso coffee or long espresso coffee flashes. The appliance starts delivering coffee. Release the button;
- when the coffee in the cup reaches the desired level, press the same button again to memorise the new amount.

The machine is now reprogrammed with the new quantities.



Please note:

It is possible to memorise just the single cup quantity. The two cup quantity reprogrammes automatically.

Adjusting the grinder

The grinder is set by default to prepare coffee correctly and should not require regulating initially.

However, if after making the first few coffees you find that the coffee is either too weak and with not enough crema or delivery is too slow (in drops), this can be corrected by adjusting the grind coarseness (fig. 14).



Please note:

The grind coarseness dial must only be turned while the grinder is in operation.

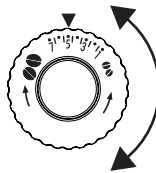

If the coffee is delivered too slowly or not at all, turn one click clockwise.



For fuller bodied coffee with more crema, turn one click anticlockwise (do not turn more than one click at a time otherwise the coffee could be delivered in drops).

These adjustments will only be evident after at least 2 cups of coffee have been delivered.

If this adjustment does not obtain the desired result, turn the dial another click.

Setting the temperature

To modify the temperature of the water used to make the coffee, proceed as follows:

1. With the appliance turned off but with the main power switch pressed down (fig. 3), press the  button and hold it down until the indicators on the control panel come on;
2. Press the  button to select the required temperature:



3. Press the  button to confirm the selection. The indicators will go off.

Tips for a hotter coffee

For hotter coffee, you should:

- before delivering the coffee, perform a rinse cycle by pressing the  button. Hot water is delivered from the spout, heating the internal circuits of the appliance and thus raising the coffee temperature;
- warm the cups by rinsing them with hot water (using the hot water function).
- set a hotter coffee temperature (see section on "Setting the temperature").

Making coffee using coffee beans



Do not use caramelised or candied coffee beans as they could stick to the grinder and damage it.

1. Fill the container with coffee beans (fig. 15).
2. Place under the coffee spouts:
 - 1 cup, if you want to make 1 coffee (fig. 16);
 - 2 cups, if you want 2 coffees (fig. 17).
3. Lower the spout as close as possible to the cup(s). A coffee with more crema is obtained in this way (fig. 18).
4. Press the button for delivery of the required coffee.

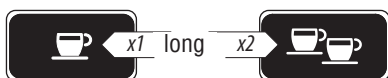
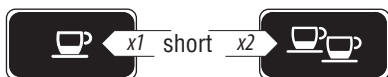

5. Delivery begins and the indicator corresponding to the selected button comes on on the control panel.

Once the coffee has been made, the appliance is ready to be used again.



- While the machine is making coffee, delivery can be interrupted at any moment by pressing one of the illuminated coffee buttons.
- At the end of delivery, to increase the quantity of coffee in the cup, just press and hold (within 3 seconds) one of the coffee buttons.



For hotter coffee, see the section "Tips for a hotter coffee".



- If the coffee is delivered in drops, too weak and with not enough crema or too cold, read the tips in the "Troubleshooting" section on page 18.
- Indicators may be displayed on the control panel during use. Their meaning is given in the section "Warning indicators" on page 17.



Making coffee using pre-ground coffee



- Never place coffee beans in the pre-ground coffee funnel as this could damage the appliance.
- Never add pre-ground coffee when the machine is turned off or it could spread through the inside of the appliance and dirty it. This could damage the appliance.
- Never use more than 1 level measure or it could dirty the inside of the appliance or block the funnel.



If you use pre-ground coffee, you can only make one cup of coffee at a time.

1. Make sure the appliance is turned on.
2. Turn the coffee selection dial anticlockwise as far as it will go to the  position (fig. 19).
3. Make sure the funnel is not blocked, and then add one level measure of pre-ground coffee (fig. 20) using the measure provided (C1).
4. Place a cup under the coffee spouts.
5. Press the required 1 cup ( or ) button.
6. Delivery begins.

MAKING LONG COFFEE

LONG coffee can be made using either coffee beans or pre-ground coffee.

Follow the directions above to prepare the machine and press the **LONG** button.

MAKING CAPPUCCINO AND HOT MILK (NOT FROTHED)



Danger of scalding!

Be careful of scalding as steam escapes during preparation of these drinks.



1. When preparing cappuccino, make the coffee in a large cup;
2. Fill a container (preferably one with a handle to avoid scalding) with about 100 grams of milk for each cappuccino. In choosing the size of the container, bear in mind that the milk will double or triple in volume;



Please note:

For a richer denser froth, use skimmed or partially skimmed milk at refrigerator temperature (about 5°C).

To avoid milk with poor froth or large bubbles, always clean the cappuccino maker as described in the section "Cleaning the cappuccino maker after use".

3. Make sure the cappuccino/hot milk toggle is positioned downwards in the CAPPUCCINO position (fig. 21);
4. Press the  button: the fading indicator indicates that the appliance is heating up.
5. Immerse the cappuccino maker in the milk container.
6. After a few seconds, when the  indicator flashes, turn the steam dial to the I position (fig. 6). Steam is delivered from the cappuccino maker, heating the milk, giving the milk a creamy frothy appearance and making it more voluminous;
7. For a creamier froth, rotate the container with slow movements in an upward direction. (You should not discharge steam for more than 3 minutes at a time);
8. When you have obtained the required froth, stop steam delivery by turning the steam dial back to the 0 position.



Danger of scalding!

Stop steam delivery before removing the container with the frothed milk to avoid burns caused by splashes of boiling milk.

9. Add the milk froth to the coffee prepared previously.
The cappuccino is ready. Sweeten to taste and, if desired, sprinkle a little cocoa powder on the froth.

Press any button to exit the steam function.

Making hot milk (not frothed)

To make hot milk without froth, proceed as described in the above section, making sure the cappuccino/hot milk toggle of the cappuccino maker is positioned upwards in the "HOT MILK" position.

Cleaning the cappuccino maker after use.

Clean the cappuccino maker each time you use it to avoid the build-up of milk residues or blockages.



Danger of scalding!

When cleaning the cappuccino maker, a little hot water is delivered.

Avoid contact with splashes of water.

1. Let a little water run for a few seconds by rotating the steam dial to the I position.
Then turn the steam dial to the 0 position to stop the flow of hot water.
2. Wait a few minutes for the cappuccino maker to cool down. Turn the cappuccino maker from right to left and then pull downwards to remove it (fig. 22).
3. Move the cappuccino/hot milk toggle upwards (fig. 23).
4. Slide the nozzle downwards (fig. 24).
5. Make sure the two holes shown by the arrows in fig. 25 are not blocked. If necessary, clean with a pin.
6. Replace the nozzle, move the toggle downwards and put the cappuccino maker back on the nozzle (fig. 26), inserting it upwards and turning it left to right until it is attached.

MAKING HOT WATER



Danger of scalding!

Never leave the machine unsupervised while hot water is being delivered.

The hot water spout becomes hot while water is being delivered and must be held by the handle only.

1. Place a container under the cappuccino maker (as close as possible to avoid splashes).
2. Turn the steam dial to the I position. Hot water starts to be delivered
3. Stop by turning the steam dial to the 0 position.



Please note:

If "Energy Saving" mode is active, you may have to wait a few seconds before the hot water is delivered.

CLEANING

Cleaning the machine

The following parts of the machine must be cleaned regularly:

- coffee grounds container (A14),
- drip tray (A18) and condensate tray (A15),
- water tank (A10),
- coffee spouts (A13),
- pre-ground coffee funnel (A6),

- inside of the machine, accessible after opening the infuser door (A11),
- infuser (A12).

Important!

- Do not use solvents, abrasive detergents or alcohol to clean the machine. You do not need to use chemical products to clean De'Longhi bean to cup coffee machines. The descaler recommended by De'Longhi is made from natural and completely biodegradable substances.
- None of the components can be washed in a dishwasher.
- Do not use metal objects to remove encrustations or coffee deposits as they could scratch metal or plastic surfaces.

Cleaning the coffee grounds container

When the  indicator flashes, the coffee grounds container must be emptied and cleaned. Unless you clean the grounds container, the indicator will continue to flash and the appliance cannot be used to make coffee.

To clean (with the machine turned on):

- Remove the drip tray (fig. 27), empty and clean.
- Empty the grounds container and clean thoroughly to remove all residues left on the bottom.
- Check the red condensate tray and empty if necessary.

Important!

When removing the drip tray, the grounds container must be emptied, even if it contains few grounds.

If this is not done, when you make the next coffees, the grounds container may fill up more than expected and clog the machine.

Cleaning the drip tray and condensate tray

Important!

If the drip tray is not emptied regularly, the water could overflow and seep inside or around the machine.

This could damage the machine, the surface it rests on or the surrounding area.

The drip tray is fitted with a level indicator (red) showing the level of water it contains (fig. 28).

Before the indicator protrudes from the cup rest, the drip tray must be emptied and cleaned.

To remove the drip tray:

1. Remove the drip tray and the grounds container (fig. 27);
2. Empty the drip tray and grounds container and wash them;
3. Check the condensate tray and empty if necessary.
4. Replace the drip tray and grounds container.

Cleaning the inside of the coffee machine

Danger of electric shock!

Before cleaning internal parts, the machine must be turned off (see "Turning off") and unplugged from the mains power supply. Never immerse the machine in water.

1. Check regularly (about once a month) that the inside of the appliance (accessible after removing the drip tray) is not dirty. If necessary, remove coffee deposits with a sponge.
2. Remove the residues with a vacuum cleaner (fig. 29).

Cleaning the water tank

Clean the water tank (A10) regularly (about once a month) with a damp cloth and a little mild washing up liquid.

Cleaning the coffee spouts

1. Clean the coffee spouts with a sponge or cloth (fig. 30A).
2. Check the holes in the coffee spout are not blocked. If necessary, remove coffee deposits with a toothpick (fig. 30B).

Cleaning the pre-ground coffee funnel

Check regularly (about once a month) that the pre-ground coffee funnel is not blocked. If necessary, remove coffee deposits.

Cleaning the infuser

The infuser (A12) must be cleaned at least once a month.

Important!

The infuser may not be extracted when the machine is on.

1. Make sure the machine is correctly turned off (see the section "Turning off" on page 10).
2. Remove the water tank.
3. Open the infuser door (fig. 31) positioned on the right side of the machine.
4. Press the 2 red release buttons inwards and at the same time pull the infuser outwards (fig. 32).

Important!

Do not use washing up liquid to clean the infuser as it may damage it.

5. Soak the infuser in water for about 5 minutes, then rinse under the tap.
6. Clean coffee residues from the support where the infuser rests.
7. After cleaning, replace the infuser by sliding it onto the internal support (fig. 33), then push the PUSH symbol fully in until it clicks into place.

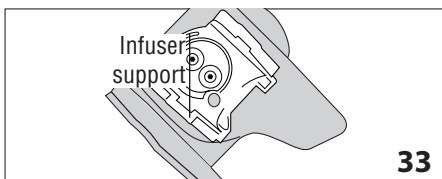

Please note:

If the infuser is difficult to insert, before insertion, squeeze the two levers shown in the figure to make it smaller.

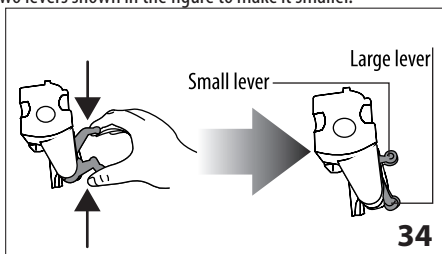

8. Once inserted, make sure the two red buttons have popped out again (fig. 35).

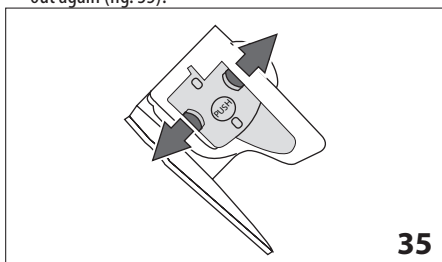

9. Close the infuser door.
10. Replace the water tank.

DESCALING

Descale the appliance when the indicator on the control panel flashes.



Important!

Descaler contains acids which may irritate the skin and eyes. It is essential that you observe the manufacturer's safety warnings indicated on the descaler packet and the warnings relating to the procedure to follow in the event of contact with the skin and eyes.



Please note:

Use De'Longhi descaler only.

Under no circumstances should you use sulphamic or acetic based descalers. Their use invalidates the guarantee.

Failure to descale the appliance as described also invalidates the guarantee.

1. Turn the appliance on and wait until it is ready for use.

2. Empty the water tank (A12) and remove the water softener filter (if present).

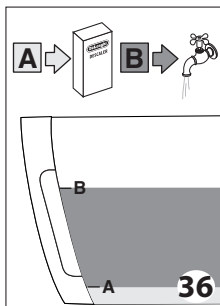

4. Wait for the coffee indicators to come on.



Important! Danger of scalding

Hot water containing acid is delivered from the cappuccino maker. Avoid contact with splashes of water.

5. Press the button and hold it down for at least 5 seconds to confirm that you have added the solution and begin the descaling procedure. The button indicator remains on to indicate that the descaling programme has begun. The indicator flashes telling you to turn the steam dial to the I position.
6. Turn the steam dial anticlockwise to the I position. Descaler flows out of the cappuccino maker and starts to fill the container below. The descaling programme automatically performs a series of rinses and pauses to remove all the scale. It is normal for several minutes of inactivity to elapse between rinses.

After about 30 minutes, the water tank is empty and the and indicators flash. Turn the steam dial clockwise as far as it will go to the 0 position.

The appliance is now ready for rinsing through with clean water.

7. Empty the container used to collect the descaler solution and replace it empty under the cappuccino maker.
8. Remove the water tank, empty, rinse under running water, fill with clean water and replace. The indicator should be flashing.
9. Turn the steam dial anticlockwise to the I position (fig. 6). Hot water comes out of the spout.
10. When the water tank is completely empty, the indicator flashes.
11. Turn the steam dial to the 0 position. The indicator goes off.

Fill the water tank again and the machine is ready for use.

SETTING WATER HARDNESS

Descaling is necessary after a period of operation established according to the water hardness set.

The machine is set by default for a hardness value of 4.

The machine can also be programmed according to the hardness of the mains water in the various regions so that the machine needs to be descaled less often.

Measuring water hardness

1. Remove the TOTAL HARDNESS TEST indicator paper attached to this manual from its pack.
2. Immerse the paper completely in a glass of water for about one second.
3. Remove the paper from the water and shake lightly. After about a minute, 1, 2, 3, or 4 red squares form, depending on the hardness of the water. Each square corresponds to one level.

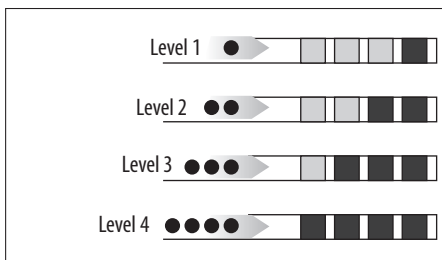

Set water hardness

1. Make sure the appliance is off (but connected to the mains electricity supply and with the main power switch in the I position);
2. Press the button and hold it down for at least 6 seconds. The indicators come on together;
3. Press the button to set the actual water hardness (as measured by the indicator paper).

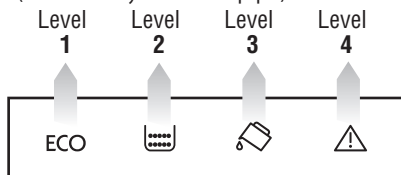

4. Press the button to confirm the selection. The machine is now reprogrammed with the new water hardness setting.

TECHNICAL DATA

Voltage:	220-240 V ~ 50/60 Hz max. 10A
Absorbed power:	1450W
Pressure:	15 bar
Max. capacity water tank:	1.8 litres
Size: LxHxD:	238x340x430 mm
Cable length:	1.15 m
Weight:	9.1 Kg
Max. capacity beans container	250 g



The appliance complies with the following EU directives:









- EC Regulation 1275/2008 for standby;
- Low Voltage Directive 2006/95/EC and subsequent amendments;
- EMC Directive 2004/108/EC and subsequent amendments
- All materials and accessories coming into contact with food conform to EC regulation 1935/2004.













DISPOSAL



In compliance with European directive 2002/96/EC, the appliance must not be disposed of with household waste, but taken to an authorised waste separation and recycling centre.

WARNING INDICATORS



INDICATOR	MÖGLICHE URSACHE	ABHILFE
 FLASHING	Insufficient water in the tank.	Fill the tank with water and/or insert it correctly, pushing it as far as it will go until it clicks into place.
	The tank is not correctly in place.	Insert the tank correctly and press as far as it will go.
 FLASHING	The grounds container (A14) is full.	Empty the grounds container and drip tray, clean and replace. Important: When removing the drip tray, the grounds container must be emptied, even if it contains few grounds. If this is not done, when you make the next coffees, the grounds container may fill up more than expected and clog the machine.
	After cleaning, the grounds container has not been replaced.	Remove the drip tray and insert the grounds container.
 FLASHING	The grind coarseness is too fine and the coffee is delivered too slowly or not at all.	Repeat coffee delivery and turn the grind coarseness dial (fig. 14) one click clockwise towards "7" while the grinder is in operation. If after making at least 2 coffees delivery is still too slow, repeat the correction procedure, turning the grinding dial another click until delivery is correct (see the section "Adjusting the grinder" on page 11). If the problem persists, turn the steam dial to the I position and let some water run from the cappuccino maker.
 FLASHING	The "pre-ground coffee" function has been selected without placing any pre-ground coffee in the funnel.	Place pre-ground coffee in the funnel or deselect the pre-ground function.
 RED AND WHITE ALTERNATE FLASHING	The machine must be descaled.	The descaling procedure described in the "Descaling" section needs to be performed as soon as possible.
 FLASHING	Too much coffee has been used.	Select a milder strength or reduce the quantity of pre-ground coffee, then make the coffee again.

    <p>FLASHING</p>	The coffee beans have run out.	Fill the beans container
	The pre-ground coffee funnel is clogged.	Empty the funnel with the help of the handle of the measuring spoon, as described in the section "Cleaning the pre-ground coffee funnel".
    <p>FLASHING</p>	The infuser has not been properly replaced after cleaning.	Insert the infuser as described in the section "Cleaning the infuser".
	The inside of the appliance is very dirty.	Clean the inside of the appliance thoroughly, as described in the section "Cleaning and maintenance" If the message is still displayed after cleaning, contact a service centre.
   		

TROUBLESHOOTING

Below is a list of some of the possible malfunctions.

If the problem cannot be resolved as described, contact a Service Centre.

PROBLEM	POSSIBLE CAUSE	SOLUTION
The coffee is not hot.	The cups were not preheated.	Warm the cups by rinsing them with hot water. The hot water or rinse function can be selected.
	The infuser has cooled down because 2/3 minutes have elapsed since the last coffee was made.	Before making coffee, heat up the infuser by pressing the  /  rinse button.
The coffee is weak or not enough crema.	The coffee is ground too coarsely.	Turn the grind coarseness dial one click anticlockwise while the grinder is in operation (fig. 14). Continue one click at a time until coffee delivery is satisfactory. The effect is only visible after 2 coffees have been made (see the section "Adjusting the grinder" on page 11).
	Different blends of coffee can also affect this.	Try a different blend of coffee.
The coffee is delivered too slowly or in drops.	The coffee is ground too finely. Even if large bubbles are present it is recommended to knock the large bubbles out by gently tapping the milk container against a hard surface and swirling the milk around.	Turn the grinding dial one click clockwise while the grinder is in operation (fig. 14). Continue one click at a time until coffee delivery is satisfactory. The effect is only visible after 2 coffees have been made (see the section "Adjusting the grinder" on page 11).
Coffee does not come out of one or both spouts.	The spouts are blocked.	Clean the spouts with a toothpick.

The frothed milk has large bubbles	The milk is not cold enough or is not semi-skimmed.	You should ideally use skimmed or semi-skimmed milk at refrigerator temperature (about 5°C). If the result is not as you wished, try changing brand of milk.
The milk is not frothed	Cappuccino maker is dirty.	Clean as described in the section "Cleaning the cappuccino maker after use" (page 13).
Steam delivery stops	A safety device stops steam delivery after 3 minutes.	Wait, and then enable the steam function again.
The appliance does not turn on.	It is not plugged into the mains socket.	Plug into the mains socket.
	The main power switch (A8) is not turned on.	Push the main power switch (fig. 4).

ELECTRICAL CONNECTION (UK ONLY)

Before using this appliance ensure that the voltage indicated on the product corresponds with the main voltage in your home, if you are in any doubt about your supply contact your local electricity company.

The flexible mains lead is supplied connected to a B.S. 1363 fused plug having a fuse of 13 amp capacity.

Should this plug not fit the socket outlets in your home, it should be cut off and replaced with a suitable plug, following the procedure outlined below.

Note: Such a plug cannot be used for any other appliance and should therefore be properly disposed of and not left where children might find it and plug it into a supply socket - with the obvious consequent danger.

Please note: We recommend the use of good quality plugs and wall sockets that can be switched off when the machine is not in use.

IMPORTANT: The wires in the mains lead fitted to this appliance are coloured in accordance with the following code:

GREEN AND YELLOW
BLUE
BROWN

EARTH
NEUTRAL
LIVE

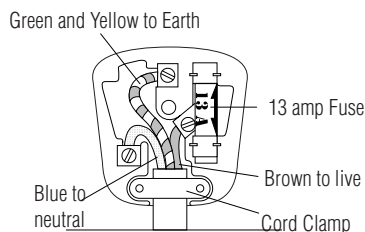

As the colours of the wires in the mains lead of this appliance may not correspond with the coloured markings identifying the terminals in your plug, proceed as follows:

- The wire which is coloured green and yellow must be connected to the terminal in the plug which is marked with the letter E or by the earth symbol  or coloured green or green and yellow.
- The wire which is coloured blue must be connected to the terminal which is marked with the letter N or coloured black.
- The wire which is coloured brown must be connected to the terminal which is marked with the letter L or coloured red.

When wiring the plug, ensure that all strands of wire are securely retained in each terminal. Do not forget to tighten the mains lead clamp on the plug. If your electricity supply point has only two pin socket outlets, or if you are in doubt, consult a qualified electrician.

Should the mains lead ever require replacement, it is essential that this operation be carried out by a qualified electrician and should only be replaced with a flexible cord of the same size.

After replacement of a fuse in the plug, the fuse cover must be refitted. If the fuse cover is lost, the plug must not be used until a replacement cover is obtained. The colour of the correct replacement fuse cover is that of the coloured insert in the base of the fuse recess or elsewhere on the plug. Always state this colour when ordering a replacement fuse cover.

Only 13amp replacement fuses which are as approved to B.S. 1362 should be fitted.

This appliance conforms to the Norms EN 55014 regarding the suppression of radio interference.

Warning - this appliance must be earthed