



---

# ESAM6900

## COFFEE MAKER MACHINE À CAFÉ CAFETERA

Instructions for use. Keep these instructions

Mode d'emploi . Conservez cette notice

Repase y guarde estas instrucciones.  
Lea cuidadosamente este instructivo antes de usar  
su aparato.



Visit [www.delonghiregistration.com](http://www.delonghiregistration.com) to register  
your product

Visit [www.delonghi.com](http://www.delonghi.com) for a list of service centers  
near you.

Visitez [www.delonghiregistration.com](http://www.delonghiregistration.com) pour  
enregistrer votre produit en ligne.

Visitez [www.delonghi.com](http://www.delonghi.com) pour y voir une liste des  
centres de réparation proches de chez vous.

Visite [www.delonghiregistration.com](http://www.delonghiregistration.com) para registrar  
su producto en línea.

Visite [www.delonghi.com](http://www.delonghi.com) para ver la lista de  
centros de servicios cercanos a usted.

ELECTRIC CHARACTERISTICS  
CARACTÉRISTIQUES ÉLECTRIQUES  
CARACTERÍSTICAS ELÉCTRICAS:  
120 V ~ 60 Hz 1350W

---

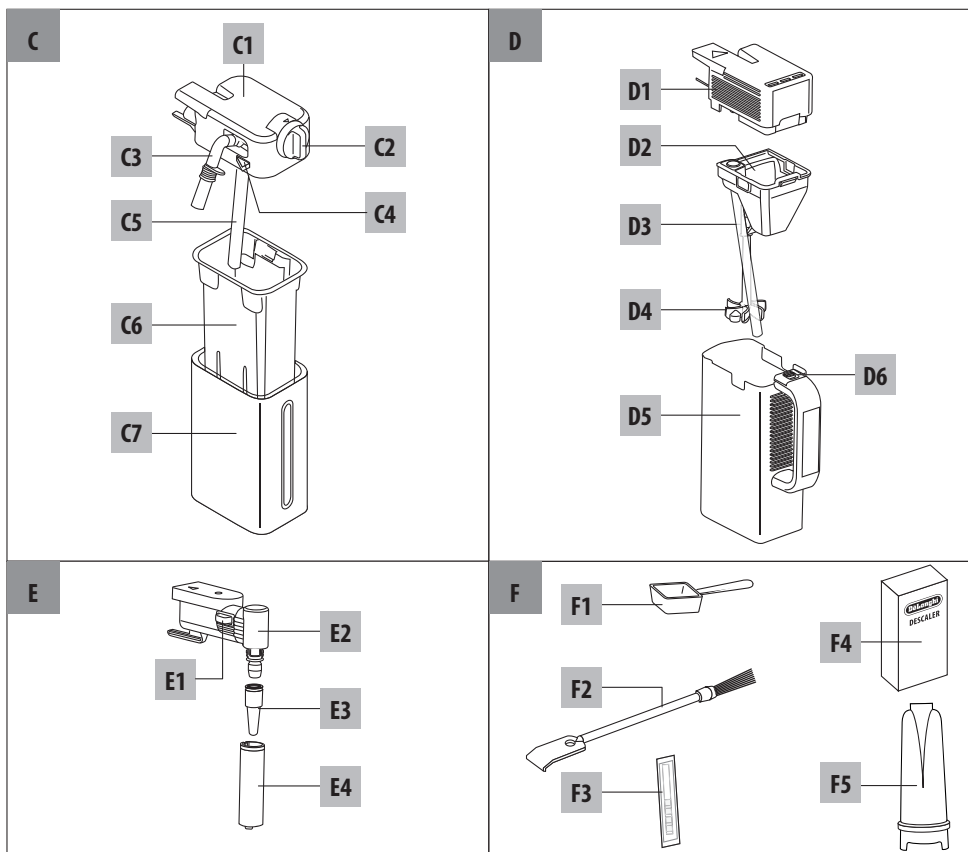
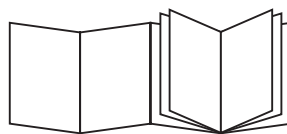

**A**

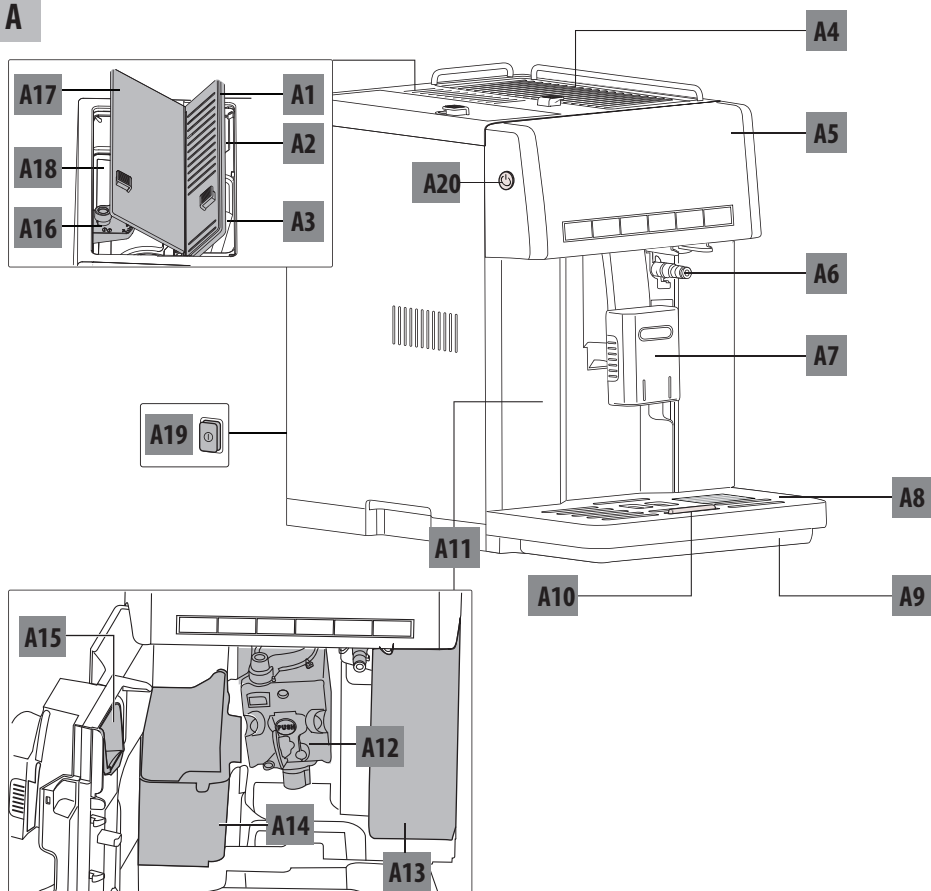

**B**

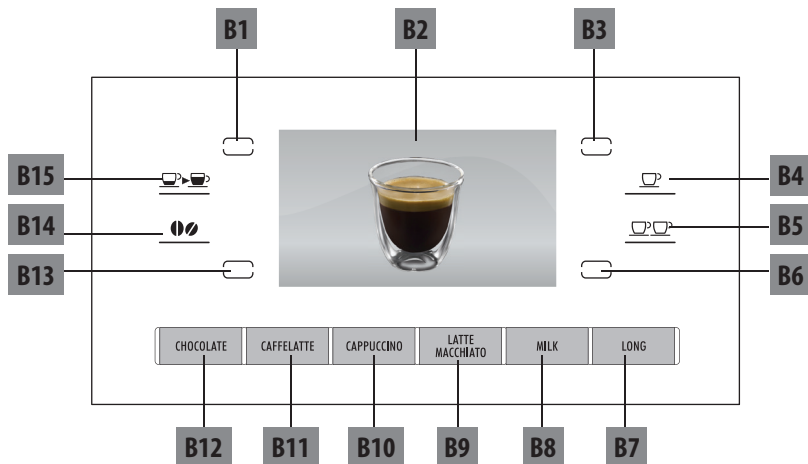

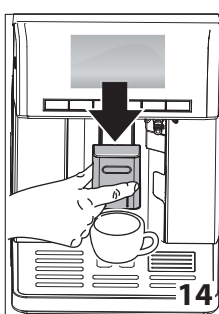
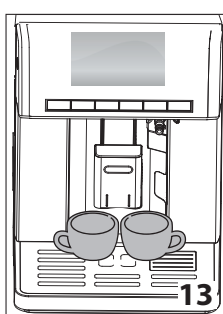
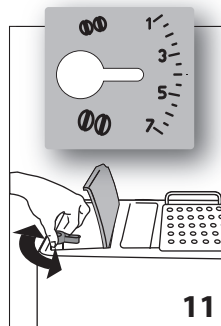
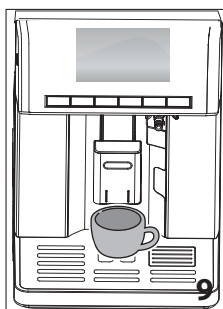
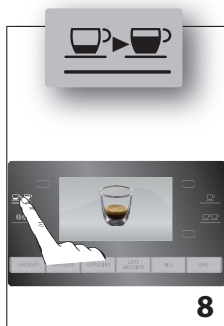
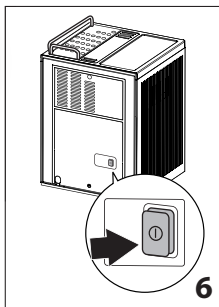
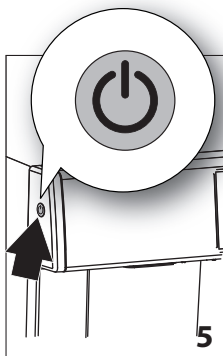
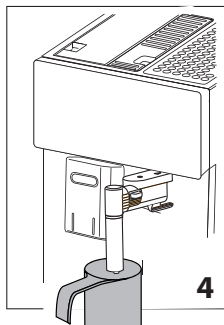
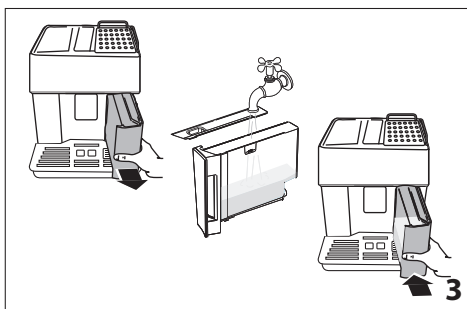
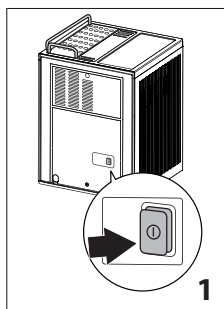

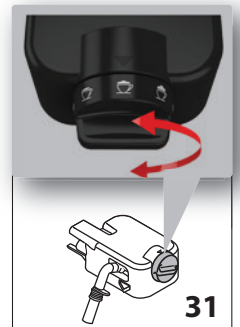
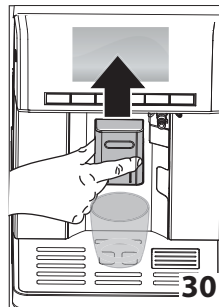
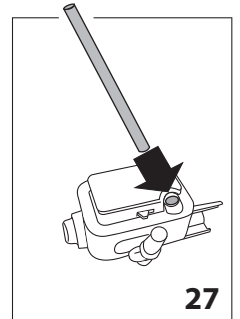
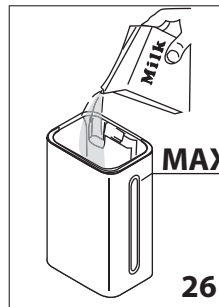
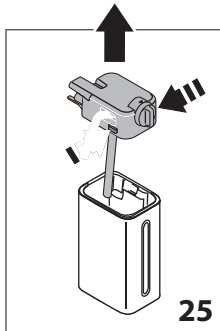
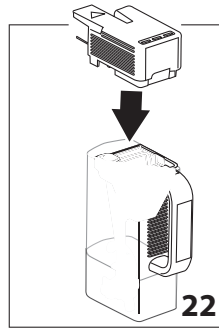
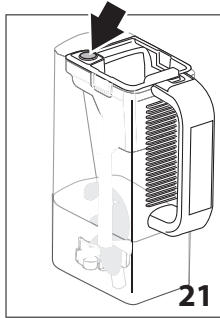
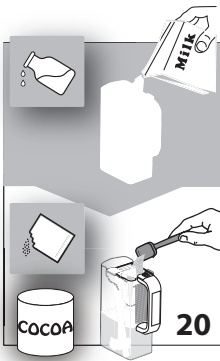
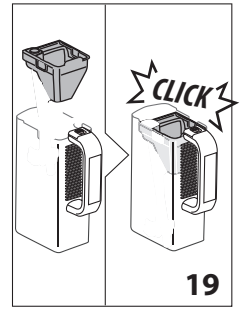
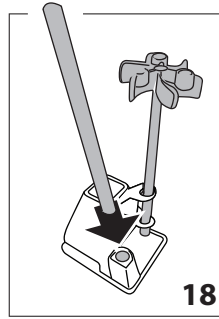
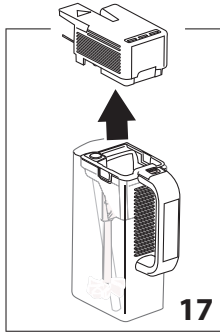
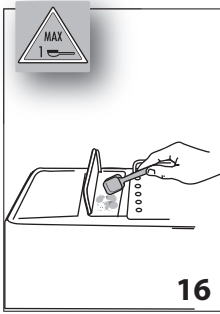

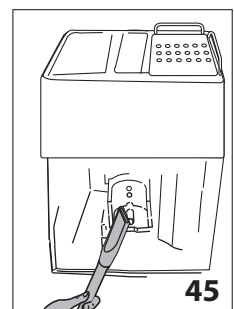
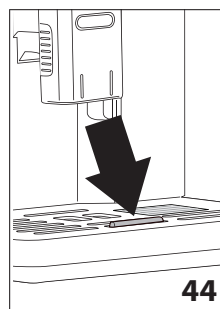
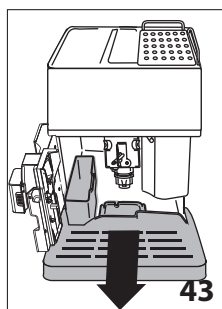
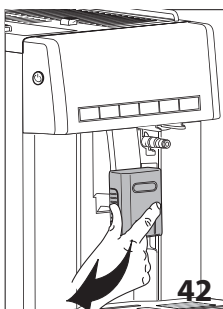
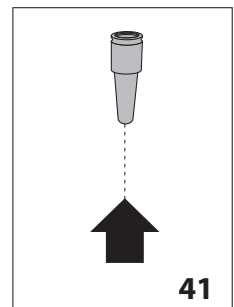
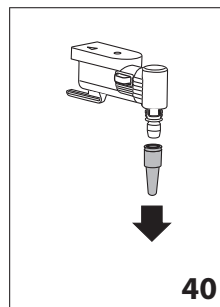
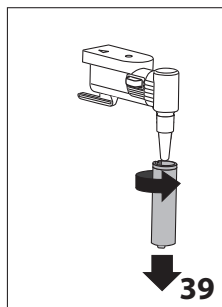
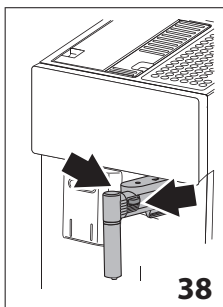
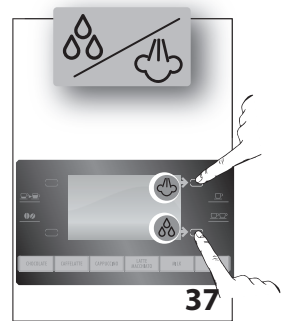
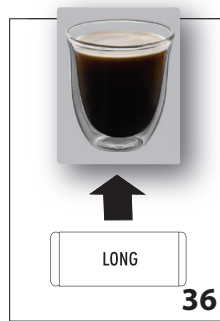
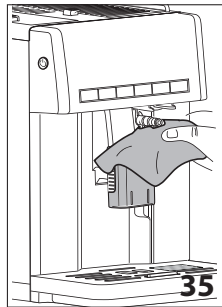
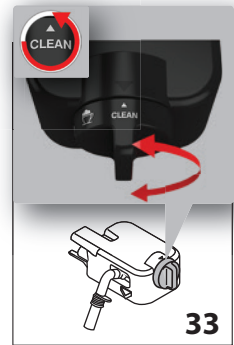

## CONTENTS

<b>IMPORTANT SAFEGUARDS .....</b>	<b>8</b>
SAVE THESE INSTRUCTIONS .....	8
<b>SHORT CORD INSTRUCTIONS.....</b>	<b>8</b>
<b>INTRODUCTION .....</b>	<b>9</b>
Symbols used in these instructions .....	9
Letters in brackets .....	9
Troubleshooting and repairs .....	9
<b>DESCRIPTION .....</b>	<b>9</b>
Description of the appliance .....	9
Description of touch screen .....	9
Description of milk container .....	10
Description of hot chocolate carafe .....	10
Description of hot water/steam spout.....	10
Description of the accessories .....	10
<b>PRELIMINARY CHECKS .....</b>	<b>10</b>
Checking the appliance .....	10
Installing the appliance .....	10
Connecting the appliance .....	10
Using the appliance for the first time .....	10
<b>TURNING THE APPLIANCE ON .....</b>	<b>11</b>
<b>TURNING THE APPLIANCE OFF .....</b>	<b>11</b>
<b>MENU SETTINGS .....</b>	<b>11</b>
Rinsing.....	11
Select background .....	11
Descalc .....	12
Install water filter (some models only) .....	12
Set time .....	12
Auto-start .....	12
Auto-Off (Standby) .....	12
Energy Saving .....	12
Coffee temperature.....	12
Setting water hardness .....	12
Beep .....	12
Default values (reset).....	12
Statistics .....	13
Setting the language .....	13
<b>MAKING COFFEE .....</b>	<b>13</b>
Selecting the coffee taste.....	13
Selecting the quantity of coffee in the cup .....	13
Customizing the “My coffee” quantity .....	13
Adjusting the coffee mill .....	13
Tips for a hotter coffee .....	14
Making espresso coffee using coffee beans.....	14
Making espresso coffee using pre-ground coffee .....	14
<b>MAKING HOT CHOCOLATE .....</b>	<b>14</b>
Preparing and attaching the hot chocolate carafe (D)14	
<b>MAKING MILK DRINKS .....</b>	<b>15</b>
Filling and attaching the milk container .....	15
Adjusting the amount of froth .....	15
Making caffelatte/cappuccino/latte macchiato/milk 16	
Programming the quantities of coffee and milk in the	
cup .....	16
Cleaning the milk container after use .....	16
<b>MAKING LONG COFFEE .....</b>	<b>16</b>
Making long coffee using pre-ground coffee.....	16
Customizing the “My LONG coffee” quantity .....	17
<b>DELIVERING HOT WATER AND STEAM .....</b>	<b>17</b>
Delivering hot water .....	17
Change the quantity of water delivered automatically	
17	
Steam delivery .....	17
Tips for using steam to froth milk .....	17
Clean the steam/hot water spout after use .....	17
<b>MEMORISING YOUR PERSONAL PROFILE .....</b>	<b>18</b>
<b>CLEANING .....</b>	<b>18</b>
Cleaning the machine .....	18
Cleaning the coffee grounds container.....	18
Cleaning the drip tray .....	18
Cleaning the inside of the machine.....	19
Cleaning the water tank .....	19
Cleaning the coffee spouts .....	19
Cleaning the pre-ground coffee funnel .....	19
Cleaning the infuser .....	19
Cleaning the hot chocolate carafe (D) .....	20
Cleaning the milk container (C) .....	20
<b>DESCALING .....</b>	<b>20</b>
<b>SETTING WATER HARDNESS .....</b>	<b>21</b>
Measuring water hardness .....	21
Set water hardness .....	21
Installing the filter .....	21
Replacing the filter .....	22
Removing the filter .....	22
<b>TECHNICAL DATA .....</b>	<b>22</b>
<b>DISPLAYED MESSAGES .....</b>	<b>23</b>
<b>TROUBLESHOOTING.....</b>	<b>25</b>
PROBLEM .....	25
POSSIBLE CAUSE.....	25
SOLUTION.....	25
<b>LIMITED WARRANTY .....</b>	<b>28</b>
How does country law apply? .....	28



# IMPORTANT SAFEGUARDS

When using electrical appliances, basic safety precautions should always be followed, including the following.

- Read all instructions carefully.
- Make sure the voltage of your electrical system corresponds to the voltage shown on the bottom of the machine.
- Do not touch hot surfaces. Use handles or knobs.
- To protect against fire, electrical shock and personal injury, do not immerse cord, plug or appliance in water or other liquid.
- Never allow the appliance to be used by children. Keep the appliance out of the reach of children and do not leave appliance unattended while in operation.
- Unplug from the outlet when not in use and before cleaning. Allow to cool before fitting or taking off parts, and before cleaning the appliance.
- Do not operate with a damaged cord or plug, or after the appliance malfunctions, or has been damaged in any manner. Return the appliance to the nearest authorized service facility for examination, repair or adjustment.
- The use of accessory attachments not recommended by the manufacturer may result in fire, electrical shock, or personal injury.
- Do not use outdoors.
- Do not let the cord hang over the edge of the table or counter or touch hot surfaces.
- Do not place the appliance or its electrical parts on or near electric stoves, cooking surfaces, or gas burners.
- Plug cord into the wall outlet. To disconnect, first turn machine "off", then remove plug from wall outlet.
- Do not use the appliance for other than the intended use. This appliance is to be utilized for domestic use only. The manufacturer declines all responsibility for any damage caused by improper, incorrect, or irresponsible use.

**WARNING: To reduce the risk of fire or electric shock, do not remove the cover or the exterior of the unit. Don't attempt to repair or modify the machine, doing so will void the warranty. Repair should be done by authorized service personnel only!**

## SAVE THESE INSTRUCTIONS

THIS APPLIANCE IS FOR HOUSEHOLD USE ONLY

## SHORT CORD INSTRUCTIONS

- A short power cord is provided to reduce risks resulting from becoming entangled in or tripping over a longer cord.
- Longer, detachable power supply cords or extension cords are available and may be used if care is exercised in their use.
- If an extension cord is used, the marked electrical rating should be at least as great as the electrical rating of the appliance. If the appliance is provided with 3- wire, grounding type cord, the extension should be a GROUNDING TYPE 3 - WIRE CORD. The longer cord should be arranged so that it will not drape over the counter-top or table top where it can be pulled on by children or tripped over.
- Your product is equipped with a polarized alternating current line plug (a plug having one blade wider than the other). This plug will fit into the power outlet only one way. This is a safety feature. If you are unable to insert the plug fully into the outlet, try reversing the plug. If the plug should still fail to fit, contact your electrician to replace your obsolete outlet. Do not defeat the safety purpose of the polarized plug.

## INTRODUCTION

Thank you for choosing the ESAM6900 automatic coffee, cappuccino and hot chocolate machine.

We hope you enjoy using your new appliance.

Take a few minutes to read these instructions.

This will avoid all risks and damage to the appliance.

### Symbols used in these instructions

Important warnings are identified by these symbols.

It is vital to respect these warnings.



#### ***Danger!***

Failure to observe the warning may result in life threatening injury by electric shock.



#### ***Important!***

Failure to observe the warning could result in injury or damage to the appliance.



#### ***Danger of burns!***

Failure to observe the warning could result in scalds or burns.



#### ***Please note:***

This symbol identifies important advice or information for the user.

### Letters in brackets

The letters in brackets refer to the legend in the Description of the Appliance on page 2 and 3.

### Troubleshooting and repairs

In the event of problems, first try to resolve them following the information given in the section "Displayed messages" on page 23 and "Troubleshooting" on page 25.

If this does not resolve the problem or you require further information, you should consult Customer Experience by calling the number given on the annexed "Customer Experience" sheet. If your country is not among those listed on the sheet, call the number given in the guarantee.

If repairs are required, contact De'Longhi Customer Service.

Contact details are given in the Limited Warranty provided with the appliance.

## DESCRIPTION

### Description of the appliance









(page 3 - A )

- A1. Funnel and measure compartment cover
- A2. Measure compartment
- A3. Pre-ground coffee funnel
- A4. Cup shelf (cup warmer when Energy Saving is disabled)
- A5. Touch screen (B)
- A6. Hot water and steam nozzle
- A7. Coffee spout (adjustable height)
- A8. Cup tray
- A9. Drip tray
- A10. Drip tray water level indicator
- A11. Service door
- A12. Infuser
- A13. Water tank
- A14. Grounds tray
- A15. Coffee guide
- A16. Grinding adjustment dial
- A17. Beans container lid
- A18. Beans container
- A19. Main switch (on back of machine)
- A20. ON/STANDBY button

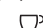
### Description of touch screen

(page 3 - B )

Only the icons relating to the controls enabled for the particular function currently being used will be lit on the touch screen.

- B1.  icon: changes function according to the text displayed alongside the icon
- B2. Display: guides the user in using the appliance.
- B3.  icon: changes function according to the text displayed alongside the icon
- B4.  icon: to deliver one cup of espresso coffee.
- B5.  icon: to deliver two cups of espresso coffee.
- B6.  icon: changes function according to the text displayed alongside the icon
- B7. **LONG** icon: to deliver a cup of LONG coffee.
- B8. **MILK** icon: to deliver a cup of milk.
- B9. **LATTE MACCHIATO** icon: to deliver a cup of latte macchiato.
- B10. **CAPPUCCINO** icon: to deliver a cappuccino.
- B11. **CAFFELATTE** icon: to deliver a caffelatte.
- B12. **CHOCOLATE** icon: to make hot chocolate.
- B13.  icon: changes function according to the text displayed alongside the icon
- B14.  icon: to select the coffee taste.
- B15.  icon: to select the coffee quantity.

**Please note :**

A light touch is enough to activate the icon.

**Description of milk container**

(page 2 - C )

- C1. Lid with milk frother
- C2. Froth adjustment and CLEAN dial
- C3. Frothed milk spout (adjustable)
- C4. Lid release buttons
- C5. Milk intake tube
- C6. Milk container
- C7. Thermal casing

**Description of hot chocolate carafe**

(page 2 - D )

- D1. Hot chocolate carafe lid
- D2. Funnel
- D3. Steam pipe
- D4. Stirrer
- D5. Hot chocolate carafe
- D6. Funnel release button

**Description of hot water/steam spout**

(page 2 - E )

- E1. Release button
- E2. Spout
- E3. Steam nozzle
- E4. Cappuccino maker

**Description of the accessories**

(page 2 - F )

- F1. Pre-ground coffee and hot chocolate powder measuring spoon
- F2. Cleaning brush
- F3. "Total Hardness Test" indicator paper
- F4. Descaler
- F5. Water softener filter

**PRELIMINARY CHECKS****Checking the appliance**

After removing the packaging, make sure the product is complete and undamaged and that all accessories are present.

Do not use the appliance if it is visibly damaged.

Contact De'Longhi Customer Services.

**Installing the appliance****Important!**

When you install the appliance, you should respect the following safety warnings:

- The appliance gives off heat.  
After positioning the appliance on the worktop, leave a space of at least 1.18 in / 3 cm between the surfaces of the appliance and the side and rear walls and at least 5.9 in/ 15 cm above the coffee maker.
- Water infiltration could damage the appliance and cause electric shock.  
Do not place the appliance near taps or sinks.
- The appliance could be damaged if the water it contains freezes.  
Do not install the appliance in a room where the temperature could drop below freezing point.
- Arrange the power cable in such a way that it cannot be damaged by sharp edges or contact with hot surfaces (e.g. electric hot plates).

**Connecting the appliance****Important!**

Check that the mains power supply voltage corresponds to the value indicated on the rating plate on the bottom of the appliance.

If the power socket does not match the plug on the appliance, have the socket replaced with a suitable type by a qualified professional.

**Using the appliance for the first time****Please note :**

- Coffee has been used to factory test the appliance and it is therefore completely normal for there to be traces of coffee in the grinder.  
The machine is, however, guaranteed to be new.
  - You should customise water hardness as soon as possible following the instructions in the section "Setting water hardness" (page 21).
1. Plug the appliance into the mains socket and place the main switch on the back of the appliance in the **I** position (fig. 1).  
You must first choose the language (the languages scroll through at intervals of about 3 seconds):
  2. When "English" appears, press and hold the **OK** icon (fig. 2) for a few seconds until "English set" is displayed.

Follow the instructions indicated by the appliance:

3.  **FILL WATER TANK!™**: remove the water tank, fill to the MAX line with fresh water then replace in the appliance (fig. 3).

4.  **INSERT WATER SPOUT™**: Check that the hot water spout is fully inserted on the nozzle and place a container with a minimum capacity of 100 ml underneath (fig. 4).

5.  **“Water delivery PRESS OK”**: press the OK icon on the display.

6. The appliance starts delivering water from the hot water spout.

7. The appliance ends the first start up procedure and goes off automatically.

The coffee machine is now ready for normal use.

### **Please note:**

- When using the appliance for the first time, you need to make 4-5 cups of coffee or 4-5 cappuccinos before it starts to give satisfactory results.

## TURNING THE APPLIANCE ON

### **Please note:**

Before turning the appliance on, make sure the main switch on the back of the appliance is in the **I** position (fig. 1).

Each time the coffee machine is turned on, it performs an automatic preheat cycle and, if necessary, a rinse cycle which cannot be interrupted. The appliance is ready for use only after completion of this cycle.

### **Danger of burns!**

During rinsing, a little hot water comes out of the coffee spouts and is collected in the drip tray underneath. Avoid contact with splashes of water.

- To turn the appliance on, press and hold the  button for a few seconds (fig. 5):



The message “Heating up, please wait” is displayed.



When heating is complete, the message changes to “RINSING”.



The appliance is ready for use when an espresso coffee cup appears on the display.

## TURNING THE APPLIANCE OFF

Whenever the coffee machine is turned off after being used to make coffee, it performs an automatic rinse cycle.



### **Danger of burns!**

During rinsing, a little hot water flows from the coffee spouts. Avoid contact with splashes of water.



### **Please note:**

If you will not be using the appliance for some time, unplug from the mains socket:

- first turn the appliance off by pressing the  button (fig. 5);
- place the main switch in the 0 position (fig. 6).



### **Important!**

Never place the main switch in the 0 position while the appliance is on.

## MENU SETTINGS

To access the settings menu, press the MENU icon. Scroll through the menu by pressing the  or  icon.

To exit the menu, press the **ESC** icon.

The following can be selected from the menu: Rinsing, Select background, Descale, Install water filter, Set time, Auto-start, Auto-off, Energy Saving, Set temperature, Water hardness, Beep, Default values, Statistics, Set language.

### Rinsing

Use this function to deliver hot water from the spout to heat the internal circuit and make the coffee delivered hotter.

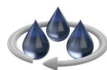

Press the **OK** icon to select the function. Press **OK** again to confirm and start rinsing.

After rinsing, the appliance is automatically ready to make the next drink.



### **Please note!**

During rinsing, a little hot water comes out of the coffee spouts and is collected in the drip tray underneath.

Avoid contact with splashes of water.

### Select background

Use this function to change the color of the display background.



Press the **OK** icon to select the function. Press the  or  icon to select the required background, then press **OK** again to confirm the choice.



### **Please note!**

This menu item can be customised in all profiles (see “Memorising your personal profile” on page 18).

## Descale



For instructions on descaling, see page 20.

## Install water filter (some models only)

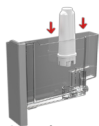

For instructions on the water filter, see page 21.

## Set time

To adjust the time on the display, proceed as follows:



Press the **OK** icon to select the function. Set the hour using the **▲** symbol to increase and the **▼** symbol to decrease, then press **OK** again to confirm, then adjust the minutes. Finally press **OK**

to memorise the time set.



### **Please note!**

Hold the **▲** or **▼** symbol down to run through the hours and minutes quickly.

## Auto-start

You can set the auto-start time in order to have the appliance ready at a certain time (for example in the morning) so you can make coffee immediately.



### **Please note!**

- For the appliance to come on at the set time, **the time must be set correctly.**
- To set the auto-start time, the hour must first have been set.



Press the **OK** icon to select the function, then press **OK** again to enable.

Adjust the time as described in the previous section and confirm with **OK**. The grey symbol indicates that the function is not active.



### **Please note!**

- When the function is active, the  symbol appears alongside the current time.
- To disable the function, access the menu and select the function as described above. "DISABLE?" is displayed. Press **OK** to confirm. The symbol alongside the current time disappears.
- When the main switch is turned off, the "Auto-Start" setting is reset.

## Auto-Off (Standby)

The auto-off time can be changed so that the appliance switches off after 15 or 30 minutes, or after 1, 2 or 3 hours.



Press the **OK** icon to select the function. Press the **▲** or **▼** icon to select the required time, then press **OK** again to confirm.

## Energy Saving

Use this function to enable or disable Energy Saving.

When enabled, the function reduces energy consumption in compliance with European regulations.



Press the **OK** icon to select the function, then press **OK** again to enable or disable Energy Saving.



### **Please note!**

- When the function is active, the  symbol appears alongside the current time.
- A few seconds may elapse between Energy Saving and delivery of the first drink.
- When Energy Saving is disabled, the appliance turns the cup warmer on automatically.

## Coffee temperature

To modify the temperature of the water used to make the coffee, proceed as follows:



Press the **OK** icon to select the function. Press the **▲** or **▼** icon to select the required temperature, then press **OK** again to confirm.



### **Please note!**

- This menu item can be customised in all profiles (see "Memorising your personal profile" on page 18).

## Setting water hardness



For instructions on setting water hardness, see page 21.

## Beep

This enables or disables the beep emitted by the machine each time an icon is pressed or an accessory is inserted/removed. The beep is active by default.



- Press the **OK** icon to select the function. Press **OK** again to enable or disable the beep. The grey symbol indicates that the function is not active.

## Default values (reset)

This resets all menu settings and programmed quantities back to the default values (with the exception of the language which remains as set).



Press the **OK** icon to select the function. Press **OK** again to confirm and reset to the default values.

## Statistics



This displays statistics relating to the machine. Press the **▲** or **▼** symbol to display the available data:

- number of coffees delivered;
- number of milk drinks delivered (CAPPUCCINO, LATTE MACCHIATO, CAFFELATTE, MILK);
- number of hot chocolates delivered;
- total litres of water delivered;
- number of water filters used;
- how many times the machine has been descaled.

## Setting the language

To modify the language of the display, proceed as follows:

Press the **OK** icon to select the function. Press the **▲** or **▼** icon to select the required language, then press **OK** to confirm the choice.

## MAKING COFFEE

### Selecting the coffee taste

The appliance is set by default to make coffee with a standard taste. You can select one of the following tastes displayed under the glass:

- Extra-mild taste
- Mild taste
- Standard taste
- Strong taste
- Extra-strong taste

To change the taste, press the icon (fig. 7) repeatedly until the required taste is displayed.

### Selecting the quantity of coffee in the cup

The appliance is set by default to make a standard quantity of coffee.

To select the quantity of coffee, press the icon (fig. 8) repeatedly until the message corresponding to the required quantity of coffee is displayed:

Corresponding coffee	ESPRESSO (fl. oz/ml)
My coffee	≈ 1.01 /30 (program. from ≈0.68/20 to ≈6.09/180)

Short	≈1.7/50
Standard	≈ 2.37/70
Long	≈ 3.38/100
Extra long	≈ 4.4/130

## Customizing the “My coffee” quantity



The appliance is set by default to automatically deliver 30 ml of “My coffee”. To modify this quantity, proceed as follows:

1. Place a cup under the coffee spouts (fig. 9).
2. Press the icon repeatedly (fig. 8) until “My coffee” is displayed.
3. Press the 1 cup icon (fig. 10). The appliance starts making the coffee;
4. Press the **PROG** icon. The appliance starts programming;
5. As soon as the coffee in the cup reaches the required level, press the **STOP** or icon again.

The quantity set has now been programmed.



### Please note :

- You can programme a single cup of coffee only.
- To cancel programming of “My coffee”, press the **EXIT PROG** icon.



### Please note!

“My coffee” can be customised in all profiles (see “Memorising your personal profile” on page 18).

## Adjusting the coffee mill

The coffee mill is set by default to prepare coffee correctly and should not require regulating initially.

However, if after making the first few coffees you find that delivery is either too fast or too slow (a drop at a time), this can be corrected by adjusting the grinding adjustment dial (fig. 11).



### Please note!

The grinding adjustment dial must only be turned when the coffee mill is in operation.

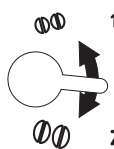

For fuller bodied creamier coffee, turn one click counter clockwise towards “1” (finer ground coffee).

For faster delivery (not a drop at a time), turn one click clockwise towards “7” (coarser ground coffee).

These adjustments will only be evident after at least 2 cups of coffee have been delivered.

If delivery is still too fast or too slow, repeat the correction, turning the dial another click.

## Tips for a hotter coffee

For hotter coffee, you should:

- perform a rinse cycle before delivering the coffee, using the “Rinsing” function in the menu;
- if Energy Saving is disabled, place the cups on the cup warmer until they are warm;
- warm the cups by rinsing them with hot water (using the hot water function);
- set a higher coffee temperature in the menu.

## Making espresso coffee using coffee beans



### Important!

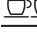

Do not use caramelized, chocolate or candied coffee beans as they could stick to the coffee mill and make it unusable.

1. Fill the container with coffee beans (fig. 12).
2. Place under the coffee spouts:
  - 1 cup, if you want to make 1 coffee (fig. 9);
  - 2 cups, if you want 2 coffees (fig. 13).
3. Lower the spout as near as possible to the cup. This makes a creamier coffee (fig. 14).
4. Press the icon corresponding to the number of coffees required (one cup  or two cups ) (fig. 10 and 15).
5. The appliance starts making coffee. An image corresponding to the type of preparation chosen is displayed together with a progress bar which fills as preparation proceeds.

Once the coffee has been made, the appliance prepares for use again.

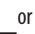

### Please note:

- While the appliance is making coffee, delivery can be interrupted at any moment by pressing the **STOP** icon or one of the coffee icons (  or  ).
- At the end of delivery, to increase the quantity of coffee in the cup, just press one of the coffee icons (  or  ) within 3 seconds.



### Important!

If the coffee is delivered a drop at a time, too fast and not creamy enough or too cold, read the tips in the “Troubleshooting” section on page 25).

Various alarm messages could be displayed while using the machine. Their meaning is explained in the section “Displayed messages” (page 23).

## Making espresso coffee using pre-ground coffee





### Important!

- Never add pre-ground coffee when the machine is off or it could spread through the inside of the machine and dirty it. This could damage the appliance.
- Never use more than one level measure or it could dirty the inside of the machine or block the funnel.
- Do not put chocolate powder down the pre-ground funnel.



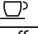

### Please note!

If you use pre-ground coffee, you can only make one cup of coffee at a time.

1. Press the  icon (fig. 7) repeatedly to select the pre-ground coffee symbol .
2. Put one level measure of pre-ground coffee into the funnel (A3) (fig. 16).
3. Place a cup under the coffee spouts (fig. 9).
4. Press the 1 cup coffee icon .
5. The appliance starts making coffee. An image corresponding to the type of preparation chosen is displayed together with a progress bar which fills as preparation proceeds.

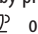
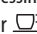

### Please note:

- While the appliance is making coffee, delivery can be interrupted at any moment by pressing the **STOP** icon or one of the coffee icons (  or  ).
- To increase the quantity of coffee in the cup, just press the coffee icon  within 3 seconds.

Once the coffee has been made, the appliance prepares to make the next drink.



### Please note!

A few seconds may elapse between Energy Saving and delivery of the first drink.

## MAKING HOT CHOCOLATE

### Preparing and attaching the hot chocolate carafe

(D)



### Please note!

You can make one or two cups of hot chocolate.



1. Lift the carafe lid (fig. 17).
2. Make sure the steam pipe is inserted in the chocolate funnel and the stirrer is inserted in both the holes in the funnel (fig. 18).
3. Attach the funnel to the carafe (fig. 19).
4. To make one cup of hot chocolate, pour milk at refrigerator temperature (about 41°F/5°C) (or fresh water) into the funnel up to the  level and add 2 scoops (0.88oz/25g) of hot chocolate powder or cocoa. To make two cups or one mug of hot chocolate, pour milk (or water) into the fun-

nel up to the  level and add 4 scoops of powder (1.76oz/50 g) (fig. 20).

### **Important!**

- Make sure the hole in the funnel shown in fig. 21 is clean.

### **Please note!**

- The milk must be poured into the funnel when the steam pipe and stirrer are already in place. Do not exceed the MAX level marked on the carafe. Increase or reduce the quantity of hot chocolate powder according to taste.
  - To use water instead of milk, follow the instructions for milk.
  - To prepare hot chocolate correctly, first pour the milk or water into the funnel, then add the hot chocolate or cocoa powder as shown on the hot chocolate carafe lid.
5. Close the lid (fig. 22).
  6. Attach the carafe to the nozzle and push as far as it will go (fig. 23). The machine emits a beep (if the beep function is enabled).
  7. Press the **CHOCOLATE** icon (B12).
  8. Select one or two cups ( -  ) by pressing the corresponding icon.
  8. Press the + or - icon to select the required density:



If the hot chocolate powder used does not contain thickener, there will be any change adjusting the density.

9. Press the **CHOCOLATE** icon to start making hot chocolate (fig. 24). The appliance starts mixing the drink and then delivers steam to heat it.

Once the coffee has been made, the appliance prepares for use again. The chocolate is ready to be poured into the cup.

### **Danger of burns!**

While making the chocolate, the carafe and lid become very hot. Hold by the handle only to remove the carafe and pour the chocolate.

The chocolate is ready to be poured into the cup.

### **Please note!**

- To interrupt making the chocolate, press the **CHOCOLATE** icon again or the **STOP** icon.

### **Danger of burns!**

- While making the hot chocolate, it is normal for steam to come out of the holes in the chocolate carafe lid.
- Heating the milk causes splashes inside the carafe. This is normal.
- The hot chocolate quantity in the cup will vary varying the density: if you choose thick density, there will be more chocolate than that contained in the cup if choosing the other densities.

## MAKING MILK DRINKS

### **Please note!**

A few seconds may elapse between Energy Saving and delivery of the first drink.

### Filling and attaching the milk container

1. Press the release buttons and lift the milk container lid (fig. 25).
2. Fill the milk container with a sufficient quantity of milk, not exceeding the MAX level (fig. 26).

### **Please note!**

For a richer denser froth, use skimmed or partially skimmed milk at refrigerator temperature (about 41°F/5°C).

To avoid milk with poor froth or large bubbles, always clean the milk lid and hot water nozzle as described in the section "Cleaning the milk container" on page 20.

3. Make sure the milk intake tube is correctly inserted in the bottom of the milk container lid (fig. 27).
4. Attach the lid back on the milk container.
5. Attach the container to the nozzle, pushing as far as it will go (fig. 28).
6. Place a sufficiently large cup under the coffee spouts and frothed milk spout (fig. 29). To use particularly tall cups/glasses, lift the coffee and milk spouts (fig. 30).
7. Follow the instructions below for each function.

### Adjusting the amount of froth

Turn the froth adjustment dial on the milk container lid to adjust the amount of froth on the milk delivered while making milk drinks (fig. 31). Follow the tips given in the following table:

Dial position	Description	Recommended for...
	No froth	CAFFELATTE / MILK (hot milk)
	Min. froth	latte macchiato
	Max. froth	CAPPUCCINO / MILK (frothed milk)



## Making caffelatte/cappuccino/latte macchiato/ milk

1. Press the icon corresponding to the required drink.
2. After a few seconds, frothed milk is delivered from the milk spout into the cup below. Delivery of milk stops automatically and (if needed for the drink), coffee delivery starts. An image of the drink being prepared is displayed (fig. 32) together with a progress bar which fills gradually.

### **Please note!**

Milk or coffee delivery can be interrupted by pressing the **STOP** icon. To stop preparation altogether, press the **ESC** icon.

## Programming the quantities of coffee and milk in the cup

The appliance is set by default to automatically deliver standard quantities. To change these quantities, proceed as follows:

1. Place a cup under the coffee spouts and milk spout.
2. Press the icon corresponding to the function to be programmed (caffelatte, cappuccino, latte macchiato, milk). The machine starts delivering milk.
3. Press the **PROG** icon.
4. When the required quantity of milk has flowed into the cup, press the **STOP** icon.
5. If needed for the drink, after a few seconds, the machine starts delivering coffee. When the required quantity of coffee has flowed into the cup, press the **STOP** icon. Coffee delivery stops.

The machine is now reprogrammed with the new quantities.

### **Please note!**

- To cancel programming of the drinks, press the **EXIT PROG** icon.



Milk drinks can be customised in all profiles (see "Memo-  
rising your personal profile" on page 18).

## Cleaning the milk container after use

### **Important! Danger of burns**

When cleaning the internal tubes of the milk container, a little hot water and steam leak out of the frothed milk spout.

Avoid contact with splashes of water.



After preparing a milk drink, the machine must be cleaned to remove the milk residues. Proceed as follows:

1. Leave the milk container in the machine (you do not need to empty it);
2. Place a cup or other recipient under the frothed milk spout.

3. Turn the froth adjustment dial to **CLEAN** (fig. 33): the operation is shown on the display (fig. 34) and stops automatically.
4. Turn the dial back to one of the froth selections.
5. Remove the milk container and always clean the steam nozzle with a sponge (fig. 35).

### **Please note!**

- To prepare a number of milk drinks, clean the milk container after you have prepared the last drink only.
- The milk container can be kept in the refrigerator.
- In some cases, to clean you must wait for the appliance to heat up.

## MAKING LONG COFFEE

1. Choose the length and taste required, following the same procedure as for espresso coffee.

Corresponding coffee	LONG (fl.oz/ml)
My coffee	≈ 3.38/100 (program. from 0.68/20 to 8.45/250)
Short	≈ 4.23/125
Standard	≈ 5.92/175
Long	≈ 7.10/210
Extra long	≈ 8.45/250

2. Press the **LONG** icon (fig. 36).
3. The appliance starts making coffee. An image corresponding to the type of drink chosen is displayed together with a progress bar which fills as preparation proceeds.

### **Please note!**

To interrupt delivery, press the **LONG** icon or the **STOP** icon.

## Making LONG coffee using pre-ground coffee

1. Select the pre-ground coffee symbol, as explained in the espresso section.
2. Push the **LONG** icon (fig. 36).
3. The appliance starts making coffee. An image corresponding to the preparation chosen is displayed together with a progress bar which fills as preparation proceeds.

## Customizing the “My LONG coffee” quantity



The appliance is set by default to automatically deliver 3.38 fl.oz/100 ml of “My coffee”. To modify these settings, proceed as follows:

1. Place a sufficiently large cup or glass under the coffee spouts (fig. 9).
2. Press the  icon repeatedly (fig. 8) until “My coffee” is displayed.
3. Press the **LONG** icon. The machine starts delivering coffee;
4. Press the **PROG** icon. The appliance starts programming;
5. As soon as the coffee in the cup reaches the required level, press the **STOP** icon again.

The quantity set has now been programmed.



### **Please note!**

- To cancel programming of “My LONG coffee”, press the **EXIT PROG** icon.



“My LONG coffee” can be customised in all profiles (see “Memorising your personal profile” on page 18).

## DELIVERING HOT WATER AND STEAM



### **Important! Danger of burns.**

Do not leave the appliance unattended while delivering hot water or steam. The spout becomes hot during delivery. Hold by the handle only.



### **Please note!**

If Energy Saving is active, you may have to wait a few seconds before hot water and steam are delivered.

## Delivering hot water

1. Check that the hot water spout is attached correctly.
2. Place a container under the water spout (as close as possible to avoid splashes) (fig. 4).
3. Press the  icon (fig. 37).
4. Hot water delivery begins and then stops automatically. A progress bar fills gradually as preparation proceeds. To interrupt delivery of the hot water manually, press the **STOP** icon again.



### **Please note!**

The quantity of hot water can be customised in all profiles (see “Memorising your personal profile” on page 18).

## Change the quantity of water delivered automatically

The machine is set by default to automatically delivery 8.45 fl.oz/250 ml of hot water. To modify these quantities, proceed as follows:

1. Check that the hot water spout is attached correctly.
2. Position a container under the spout.
3. Press the  icon, then the **PROG** icon.
4. When the hot water in the cup reaches the required level, press the **STOP** icon.

The machine is now reprogrammed with the new quantity.



### **Please note!**

- To cancel programming, press the **EXIT PROG** icon.

## Steam delivery

1. Check that the hot water spout is attached correctly.
2. Fill a container with the liquid to be heated or frothed and immerse the steam spout in the liquid.
3. Press the  icon (fig. 37). After a few seconds, the steam to heat the liquid comes out of the cappuccino maker;
4. When the required temperature is obtained, interrupt steam delivery by pressing the **STOP** icon. (You should not discharge steam for more than 3 minutes at a time).



### **Important!**

Always stop steam delivery before extracting the container containing the liquid to avoid burns from splashes.

## Tips for using steam to froth milk

- When choosing the size of the container, bear in mind that the liquid doubles or triples in volume.
- For a richer denser froth, use skimmed or partially skimmed milk at refrigerator temperature (about 41°F/5°C).
- For a creamier froth, rotate the container with slow movements in an upward direction.
- To avoid milk with poor froth or large bubbles, always clean the spout as described in the following section.

## Clean the steam/hot water spout after use

Always clean the spout after use to avoid the build-up of milk residues and prevent the spout from clogging.

1. Place a container under the cappuccino maker and deliver a little water by pressing the  icon (fig. 37). Stop delivery of hot water by pressing the **STOP** icon again.
2. Wait a few minutes for the cappuccino maker to cool down, then extract the hot water spout (fig. 38) by pressing the button. Hold the spout with one hand and with the other, turn the cappuccino maker and pull it downwards (fig. 39).
3. Also remove the steam nozzle by pulling it downwards (fig. 40).
4. Check the hole in the nozzle shown by the arrow in fig. 41 is not blocked. If necessary, clean using a toothpick.
5. Wash all parts of the spout thoroughly with a sponge and warm water.

6. Insert the nozzle and cappuccino maker on the nozzle by pushing it upwards and turning it clockwise until it is attached.

## MEMORISING YOUR PERSONAL PROFILE

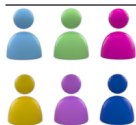

With this appliance, you can memorise six different profiles, each associated with a different color.

In each profile you can customise:

- the quantities of espresso and long "My coffee";
- the quantities for all milk drinks;
- the quantity of hot water;
- the preferred background (from the menu);
- the coffee temperature (from the menu).

To use the function, proceed as follows:

1. Enter the "Profiles" section by pressing the  icon;
2. Choose your color by pressing the **CHANGE** icon and then press the **OK** icon to confirm. The chosen color appears at the bottom left of the display to indicate you are operating with that profile;
3. Proceed to programme the drinks which can be memorised as described above. Each time you access the profile, the machine uses the programmed settings.



### **Please note!**

To change the profile, access profile selection by pressing the icon at the bottom left corresponding to the color in use:

- Press the **CHANGE** icon to enter another profile and **OK** to confirm;
- Press the  icon to exit all profiles.
- When operating in the menu, the selected profile is displayed to the right (for selecting background and temperature).

## CLEANING

### Cleaning the machine

The following parts of the machine must be cleaned regularly:

- coffee grounds container (A14),
- drip tray (A9),
- the inside of the machine, accessible after opening the service door (A11),
- water tank (A13),
- coffee spouts (A7) and hot water nozzle (A6),
- pre-ground coffee funnel (A3),
- infuser (A12),
- touch screen (B)
- milk container (C)
- hot chocolate carafe (D)
- hot water/steam spout (E)



### **Important!**

- Do not use solvents, abrasive detergents or alcohol to clean the appliance. With De'Longhi superautomatic coffee machines, you need not use chemical products to clean the machine.
  - No parts of the appliance are dishwasher safe, apart from the hot chocolate carafe (D) and components of the milk container in contact with the milk.
- The thermal casing C7 cannot be washed in a dishwasher or immersed in water.**
- Do not use metal objects to remove build up or coffee deposits as they could scratch metal or plastic surfaces.

### Cleaning the coffee grounds container



The display indicates when the grounds container is full. The appliance cannot be used to make coffee until you have cleaned the grounds container. Even if not full, the empty grounds container message is displayed 72 hours after the first coffee has been prepared. For the 72 hours to be calculated correctly, the machine must never be turned off with the main switch in the 0 position.

To clean (with the machine on):

- Open the service door on the front of the appliance (fig. 42), extract the drip tray (fig. 43), empty and clean.
- Empty the grounds container and clean thoroughly to remove all residues left on the bottom. This can be done with the spatula on the brush provided.



### **Important!**

When removing the drip tray, the grounds container must be emptied, even if it contains few grounds.

If this is not done, when you make the next coffees, the grounds container may fill up more than expected and clog the machine.

### Cleaning the drip tray



### **Important!**

If the drip tray is not emptied regularly, the water could overflow from the edge and seep inside or around the machine. This could damage the machine, the surface it rests on or the surrounding area.

The drip tray is fitted with a level indicator (red) showing the level of water it contains (fig. 44). As soon as the indicator becomes visible, the tray must be emptied and cleaned.

To remove the drip tray:

1. Open the service door (fig. 42);
2. Remove the drip tray and grounds container (fig. 43);
3. Empty the drip tray and grounds container and wash them;

4. Replace the drip tray complete with grounds container;
5. Close the service door.

## Cleaning the inside of the machine



### **Danger of electric shock!**

Before cleaning internal parts, the machine must be turned off (see "Turning off") and unplugged from the mains power supply. Never immerse the coffee machine in water.

1. Check regularly (about every 100 coffees) that the inside of the appliance (accessible after removing the drip tray) is not dirty. If necessary, remove coffee deposits with the brush supplied and a sponge.
2. Remove the residues with a vacuum cleaner (fig. 45).

## Cleaning the water tank

Clean the water tank about once a month and whenever you replace the water softener filter (if present) as follows:

1. Remove the filter.
2. Clean the water tank with a damp cloth and a little mild washing up liquid. Rinse with running water.
3. Rinse the filter (if present) and put back in the water tank. Fill the tank with fresh water and put back in the appliance.

## Cleaning the coffee spouts

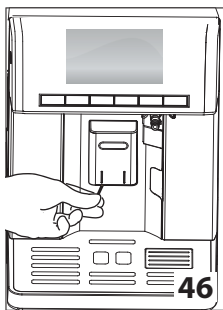

1. Clean the coffee spouts with a sponge or cloth.
2. Check the holes in the coffee spout are not blocked. If necessary, remove coffee deposits with a toothpick (fig. 46).

## Cleaning the pre-ground coffee funnel

Check regularly (about once a month) that the pre-ground coffee funnel is not blocked. If necessary, remove coffee deposits with the brush supplied.

## Cleaning the infuser

The infuser (A12) must be cleaned at least once a month.



### **Important!**

The infuser may not be extracted when the machine is on.

1. Make sure the machine is correctly turned off (see "Turning off").
2. Open the service door (fig. 42).
3. Remove the drip tray and grounds container (fig. 43).

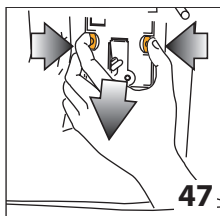

4. Press the two red release buttons inwards and at the same time pull the infuser outwards (fig. 47).



### **Important!**

**RINSE WITH WATER ONLY NO WASHING UP LIQUID - NO DISH WASHER**

Do not use washing up liquid to clean the infuser as it could cause damage.

5. Soak the infuser in water for about 5 minutes, then rinse under the tap.
6. After cleaning, replace the infuser by sliding it onto the internal support and pin at the bottom, then push the PUSH symbol fully in until it clicks into place.

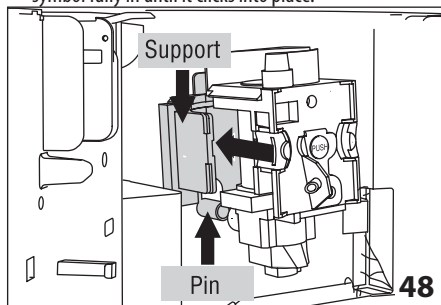

### **Please note!**

If you encounter difficulty inserting the infuser, before inserting it you must adapt it to the right dimension by pressing it forcefully from the bottom and top as shown in fig. 49.

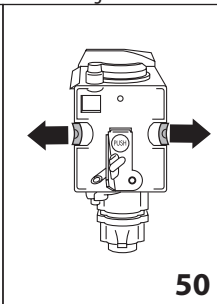
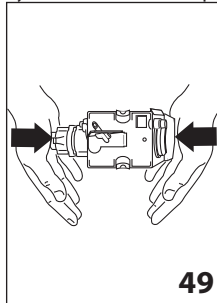

7. Once inserted, make sure the two red buttons have snapped out (fig. 50).
8. Replace the drip tray and grounds container.
9. Close the service door.



### **Please note!**

If the service door cannot be closed, check if infuse has been inserted correctly.

### Cleaning the hot chocolate carafe (D)

Clean the carafe each time you prepare hot chocolate as described below:

1. Lift and remove the lid (D1);

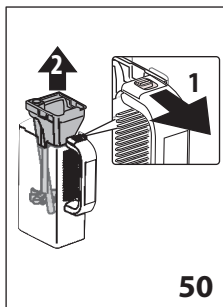

2. Remove the funnel (D2) by pressing the release button (D6) and lifting it (fig. 50);
3. Extract the steam spout (D3) and stirrer (D4);
4. Wash all the components thoroughly with hot water and mild washing-up liquid.

**All components are dishwasher safe, placing them in the top basket of the dishwasher.**

5. Replace all the components.



#### **Please note!**

It is normal to find residues on the stirrer while cleaning. These consist of traces of iron in the cocoa attracted by the magnets in the stirrer.

### Cleaning the milk container (C)

Clean the milk container each time you prepare milk as described below:

1. Lift and remove the lid (C1);
2. Extract the milk container (C5) from the thermal casing (C6), holding it by the two side grips.



#### **Important!**

**The thermal casing must not be filled with or immersed in water.** Clean with a damp cloth only.

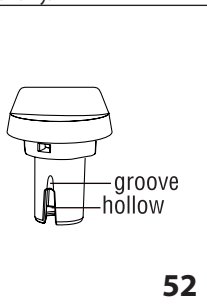
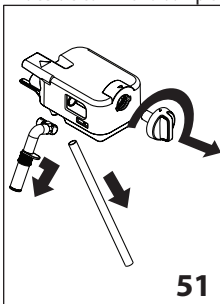

3. Remove the milk spout (C3) and intake tube (C5) (fig. 51).
4. Turn the froth adjustment dial clockwise to the "INSERT" position (see figure 51) and pull off.

5. Wash all the components of the frother thoroughly with hot water and mild washing-up liquid.

All components and the container are dishwasher safe, placing them in the top basket of the dishwasher.

Make sure there are no milk residues on the hollow and groove under the dial (see fig. 52). If necessary, scrape the groove with a toothpick.

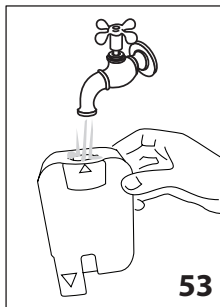

6. Rinse inside the froth adjustment dial seat with running water (see fig. 53) and the hole that connects the lid to the appliance.
7. Check that the intake tube and spout are not clogged with milk residues.
8. Replace the dial (lining up the arrow with the word "INSERT"), the spout and the milk intake tube.

9. Place the milk container in the thermal casing.
10. Place the lid back on the milk container.

### DESCALING



When the symbol appears, you must proceed with the descaling equipment.



#### **Important!**

It is vital to respect the manufacturer's safety warnings given on the descaler pack and the warnings relating to the procedure to follow in the event of contact with the skin and eyes.



#### **Please note!**

Use descaler recommended by De'Longhi only.

Failure to descale the appliance as described above also invalidates the guarantee.

1. Turn the machine on.
2. Access the settings menu by pressing the **MENU** icon. Scroll through the menu pressing the **▲** and **▼** icons to select "Descal".
3. Press the **OK** icon to select the function. Press **OK** again to confirm.
4. "ADD DESCALER, FILL WATER TANK" "INSERT WATER SPOUT" is displayed (fig. 54).
5. Empty the water tank completely and remove the water softener filter (if present).  
Pour the descaler into the tank up to the level **A** (corresponding to a 100 ml pack) marked on the side of the tank, then add water (1 litre) up to level **B** and put the water tank back (fig. 55).

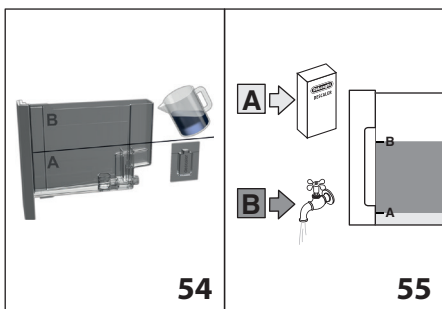

Place an empty container with a minimum capacity of 1.5 litres under the hot water spout.



### **Important! Danger of burns**

Hot water containing acid flows out of the hot water spout. Avoid contact with splashes of water.

6. Start descaling by pressing the **OK** icon.
7. The descale programme starts and the descaler liquid comes out of the water spout. The descale programme automatically performs a series of rinses and pauses at regular intervals to remove limescale deposits from inside the machine. The cycle lasts about 30 minutes and is indicated by a progress bar which fills and empties.
8. "Rinsing" "FILL WATER TANK". The appliance is now ready for rinsing through with clean water. Remove the water tank, empty, rinse under running water, fill with clean water and replace.
9. Empty the container used to collect the descaler solution and replace it under the hot water spout.
10. Press the **OK** icon to start rinsing. Hot water comes out of the spout.
11. When "Descaling complete" "PRESS OK" is displayed, press the **OK** icon. The appliance goes off.
12. Put the water softener filter (if present) back and fill the tank.

To use the appliance, press the  button.

## **SETTING WATER HARDNESS**

Descaling is requested after a period of time established according to water hardness.

The machine is set by default for a hardness value of 4 (very hard water).

The machine can also be programmed according to the actual hardness of the mains water in the various regions, varying the frequency with which the message is displayed.

### **Measuring water hardness**

1. Remove the "TOTAL HARDNESS TEST" indicator paper from its pack.

2. Immerse the paper completely in a glass of water for one second.
3. Remove the paper from the water and shake lightly. After about a minute, 1, 2, 3, or 4 red squares form, depending on the hardness of the water. Each square corresponds to one level.

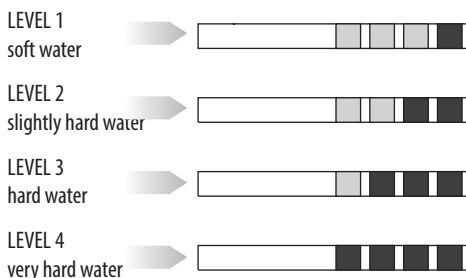

### **Set water hardness**

1.  Access the settings menu by pressing the **MENU** icon. Scroll through the menu pressing the **▲** and **▼** icons to select "Water hardness".
2. Confirm the selection by pressing the **OK** icon.
3. Press **▲** or **▼** to set the water hardness identified using the indicator paper (see figure in the previous section).
4. Press the **OK** icon to confirm the setting.
5. Press the **ESC** icon to exit the menu.

The machine is now reprogrammed with the new water hardness setting.

## **WATER SOFTENER FILTER**

Certain models are fitted with a water softener filter. If this is not the case with your model, you are recommended to purchase one from De'Longhi Customer Services. To use the filter correctly, follow the instructions below.

### **Installing the filter**

1. Remove the filter from the packaging.
2. Turn the date indicator disk until the next two months of use are displayed (fig. 56).

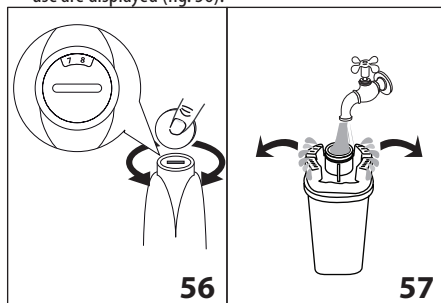

### Please note

The filter lasts about two months if the appliance is used normally. If the coffee machine is left unused with the filter installed, it will last a maximum of three weeks.

3. To activate the filter, let tap water go in the hole of the filter as shown in the figure as long as the water comes out from the side openings for over one minute (min. 500ml) (fig. 57).
4. Extract the tank from the appliance and fill with water.
5. Insert the filter in the water tank and immerse it completely for about 30 seconds, turning it upside down to enable the air bubbles to escape (fig. 58).

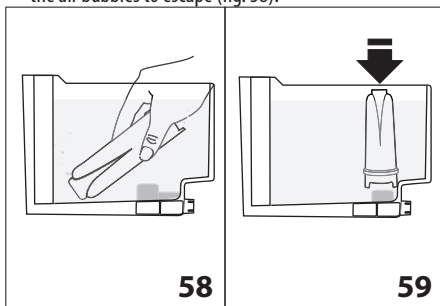

6. Insert the filter in the filter housing and press as far as it will go (fig. 59).

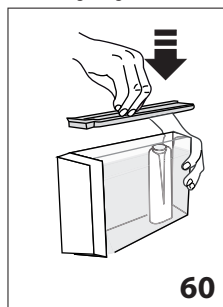

7. Close the tank with the lid, then put the tank back in the machine (fig. 60).

When you install the filter, you must notify the appliance of its presence.

8. Access the menu by pressing the **MENU** icon;
9. Scroll through the menu by pressing the **▲** or **▼** icon until "Install water filter" is displayed.

10. Press the **OK** icon.
11. The message "Install water filter" "CONFIRM?" is displayed.
12. Press the **OK** icon to confirm the selection. The message "INSERT WATER SPOUT" "PRESS OK" is displayed.
13. Position a container under the hot water spout (min. capacity: 100 ml).
14. Press **OK** to confirm the selection. The appliance begins delivering hot water and "Please wait" is displayed.
15. After delivery, the appliance is automatically ready to make the next drink.

The filter is now active and you can use the coffee machine.

### Replacing the filter

 When the filter alarm is displayed, after two months (see date indicator) or if the appliance has not been used for 3 weeks, you should replace the filter:

1. Extract the tank and remove the filter;
2. Remove the new filter from the packaging and proceed as illustrated on the previous paragraph (points 3-4-5-6).
3. Position a container with a minimum capacity of 100 ml under the hot water spout.
4. Access the menu by pressing the **MENU** icon;
5. Scroll through the menu by pressing the **▲** or **▼** icon until "Replace water filter" is displayed.
6. Press the **OK** icon.
7. "CONFIRM?" is displayed.
8. Press the **OK** icon to confirm.
9. "Water delivery" "PRESS OK" is displayed.
10. Press **OK** to confirm the selection. The appliance begins delivering hot water and "Please wait" is displayed.
11. After delivery, the appliance is automatically ready to make the next drink.

The new filter is now active and you can use the coffee machine.

### Removing the filter







If you want to use the appliance without the filter, you must remove it and notify the appliance of its removal. Proceed as follows:

1. Extract the tank and exhausted filter.
2. Put the tank back in the appliance.
3. Access the menu by pressing the **MENU** icon.
4. Scroll through the menu by pressing the **▲** or **▼** icon until "Remove water filter" is displayed.
5. Press the **OK** icon.
6. "CONFIRM?" is displayed;
7. Press the **OK** icon to confirm and the **ESC** icon to exit the menu.

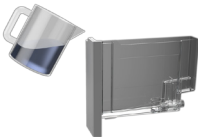









### TECHNICAL DATA



Voltage:	120V~60 Hz
Absorbed power:	1350W
Pressure:	15 bar
Water tank capacity:	47.34 fl. oz. / 1,4 litres
Size: LxHxD:	9.37x 15.75x 16.73 in/ 281x400x425 mm
Max. beans container capacity	8.82 oz / 250 g
Weight of machine (with drip tray)	30.42 lb / 13,8 Kg
Water/steam spout:	2 oz / 57g
Milk container:	25.4 oz / 720g
Hot chocolate carafe:	13.33 oz / 378g
Power cable length:	57.1 in / 1,45m

## DISPLAYED MESSAGES

DISPLAYED MESSAGE	POSSIBLE CAUSE	SOLUTION
 <p>FILL WATER TANK</p>	Insufficient water in tank or tank not inserted correctly	Fill the tank with water and/or insert it correctly, pushing it as far as it will go until it clicks into place.
 <p>GROUND TOO FINE ADJUST MILL</p>	The grinding is too fine and the coffee is delivered too slowly or not at all.	Repeat coffee delivery and turn the grinding adjustment dial one click clockwise towards "7" while the coffee mill is in operation. If after making at least 2 coffees delivery is still too slow, repeat the correction procedure, turning the grinding adjustment dial another click until delivery is correct. If the problem persists, press OK to deliver water from the spout until it flows out normally.
 <p>INSERT WATER SPOUT</p>	The water spout is not inserted or is inserted incorrectly.	Insert water spout as far as it will go.
 <p>EMPTY GROUNDS CONTAINER</p>	The grounds container is too full or more than 3 days have passed since delivery of the first coffee (this guarantees correct hygiene of the machine).	Empty the grounds container and clean, then replace. Important: when removing the drip tray, the grounds container MUST be emptied, even if it contains few grounds. If this is not done, when you make the next coffees, the grounds container may fill up more than expected and clog the machine.
 <p>INSERT GROUNDS CONTAINER</p>	After cleaning, the grounds container has not been replaced.	Open the service door, remove the drip tray and insert the grounds container.
 <p>ADD PRE-GROUND COFFEE</p>	<p>The "pre-ground coffee" function has been selected without placing any pre-ground coffee in the funnel.</p> <p>The funnel (A8) is blocked.</p>	<p>Place pre-ground coffee in the funnel or deselect the "pre-ground" function.</p> <p>Empty the funnel with the help of the cleaning brush as described in the section "Cleaning the pre-ground coffee funnel".</p>



 <p>Descalc</p>	The machine must be descaled.	The descaling procedure described in the “De-scaling” section needs to be performed as soon as possible.
 <p>Replace water filter</p>	The water filter is exhausted.	Replace the filter or remove it as described in the section “Water filter”.
 <p>LESS COFFEE</p>	Too much coffee has been used.	Select a milder taste or reduce the quantity of pre-ground coffee.
 <p>FILL BEANS CONTAINER</p>	The coffee beans have run out.	Fill the beans container
	The pre-ground coffee funnel is clogged.	Empty the funnel with the help of the brush as described in the section “Cleaning the pre-ground coffee funnel”.
 <p>INSERT INFUSER ASSEMBLY</p>	The infuser has not been replaced after cleaning.	Insert the infuser as described in the paragraph “Cleaning the infuser”.
 <p>INSERT MILK CONTAINER</p>	The milk container is not inserted correctly.	Insert the milk container as far as it will go.
 <p>TURN DIAL TO CLEAN</p>	After preparing a milk drink, the lid must be cleaned with the CLEAN function.	Turn the froth adjustment dial to CLEAN
 <p>TURN FROTH ADJUSTMENT DIAL</p>	The froth adjustment dial is not in correct position.	Turn the froth adjustment dial in one of the froth position.
 <p>INSERT CHOCOLATE CARAFE</p>	The hot chocolate carafe is not inserted correctly.	Insert the hot chocolate carafe correctly.
 <p>CLOSE DOOR</p>	The service door is open.	Close the service door.



 GENERAL ALARM	The inside of the appliance is very dirty.	Clean the inside of the appliance thoroughly, as described in the section "Cleaning and maintenance". If the message is still displayed after cleaning, contact customer services.
 EMPTY CIRCUIT FILL CIRCUIT alternating with... Water delivery PRESS OK	The water circuit is empty.	Press OK to deliver water from the spout until it flows out normally.

## TROUBLESHOOTING

Below is a list of some of the possible malfunctions.

If the problem cannot be resolved as described, contact Customer Services.

PROBLEM	POSSIBLE CAUSE	SOLUTION
The coffee is not hot	The cups were not preheated.	<ul style="list-style-type: none"> <li>If Energy Saving is not active, leave the cups on the cup warmer for at least 20 minutes for them to warm up.</li> <li>Warm the cups by rinsing them with hot water (using the hot water function).</li> </ul>
	The infuser has cooled down because 2/3 minutes have elapsed since the last coffee was made.	Before making the coffee, heat the infuser by performing a rinse cycle (see the section "Tips for a hotter coffee").
	A low coffee temperature is set.	Set a higher coffee temperature in the menu.
The coffee is not creamy enough.	The coffee is ground too coarsely.	Turn the grinding adjustment dial one click counter clockwise towards "1" while the coffee mill is in operation (fig. 11). Continue one click at a time until coffee delivery is satisfactory. The effect is only visible after delivering 2 coffees.
	Wrong type of coffee	Use a type of coffee for espresso coffee machines.
The coffee is delivered too slowly or a drop at a time.	The coffee is ground too finely.	Turn the grinding adjustment dial one click clockwise towards "7" while the coffee mill is in operation (fig. 11). Continue one click at a time until coffee delivery is satisfactory. The effect is only visible after delivering 2 coffees.

The coffee does not come out of the spouts, but from around the service door.	The holes in the spouts are clogged with dry coffee dust.	Clean the spouts with a toothpick, sponge or hard bristled kitchen brush.
	The coffee guide inside the service door is blocked and cannot swing.	Thoroughly clean the coffee guide, particularly near the hinges.
The coffee is delivered too quickly.	The coffee is ground too coarsely.	Turn the grinding adjustment dial one click counter clockwise towards "1" while the coffee mill is in operation (fig. 11). Avoid turning the grinding adjustment dial excessively otherwise when you select two cups, the coffee may be delivered a drop at a time.
Coffee does not come out of one of the spouts.	The spouts are blocked.	Clean the spouts with a toothpick .
Water comes out of the spouts instead of coffee.	The pre-ground coffee may be blocked in the funnel (A8)	Empty the funnel with the help of the brush as described in the section "Cleaning the pre-ground coffee funnel".
 <p>The milk does not come out of the milk spout.</p>	The milk container lid is dirty.	Clean the milk container lid as described in the section "Cleaning the milk container".
	The milk is not cold enough or is not semi-skimmed.	Use skimmed or semi-skimmed milk at refrigerator temperature (about 5° C). If the result is not as you wished, try changing brand of milk.
	The froth adjustment dial is incorrectly adjusted.	Adjust following the instructions in the section "Making drinks with milk".
	The milk container lid or froth adjustment dial are dirty	Clean the milk container lid and dial as described in the section "Cleaning the milk container".
	The hot water/steam nozzle is dirty	Clean the nozzle as described in the section "Cleaning the hot water/steam nozzle".
 <p>The milk contains large bubbles and there is little froth</p>	The spout is dirty.	Clean as described in the section "Cleaning the spout after use".
	The milk is not cold enough or is not semi-skimmed.	You should ideally use skimmed or semi-skimmed milk at refrigerator temperature (about 5°C). If the result is not as you wished, try changing brand of milk.
	The steam nozzle has not been inserted after cleaning.	Replace all the spout components correctly.
The appliance does not come on	It is not plugged into the mains socket.	Plug into the mains socket.
	The main switch is not turned on.	Place the main switch in the I position
	The  button has not been pressed sufficiently.	Hold the button down for a few seconds.

The LONG coffee has too much froth	The coffee is ground too finely.	Turn the grinding adjustment dial one click clockwise towards "7" while the coffee mill is in operation (fig. 11). Continue one click at a time until coffee delivery is satisfactory. The effect is only visible after delivering 2 coffees.
"Energy Saving" is enabled, but the cup warmer is hot.	A number of drinks have been prepared in rapid succession.	
The chocolate is not sufficiently dense	The hot chocolate powder used does not contain thickener.	Use a cocoa powder with thickener.
	The highest density has not been selected.	Select the highest density by pressing the + icon.
	The quantities of milk and hot chocolate powder are not correct.	Follow the instructions in the section "Making hot chocolate".
The hot chocolate is cold or there are lumps.	The stirrer and steam spout are not inserted correctly in the funnel.	Insert the stirrer and steam spout in the funnel
	The instructions have not been followed.	Pour the milk/water into the funnel first, followed by the hot chocolate powder.
During cleaning, there are traces of black on the stirrer.	The magnets in the stirrer attract traces of iron naturally present in the hot chocolate powder.	Clean as described in the section "Cleaning the hot chocolate carafe".
The service door cannot be closed	The infuser is not correctly inserted.	Reinsert the infuser following the instruction given in the paragraph "Cleaning the infuser".

## LIMITED WARRANTY

---

This warranty applies to all products with De'Longhi or Kenwood brand names.

What does the warranty cover?

We warrant each appliance to be free from defects in material and workmanship. Our obligation under this warranty is limited to repair at our factory or authorized service center of any defective parts or part thereof, other than parts damaged in transit. In the event of a products replacement or return, the unit must be returned transportation prepaid. The repaired or replacement model will be returned at the company expense.

This warranty shall apply only if the appliance is used in accordance with the factory directions, which accompany it, and on an Alternating current ( AC ) circuit.

How long does the coverage last?

This warranty runs for two years (2) from the purchase date found on your receipt and applies only to the original purchaser for use.

What is not covered by the warranty?

The warranty does not cover defects or damage of the appliance, which result from repairs or alterations to the appliance outside our factory or authorized service centers, nor shall it apply to any appliance, which has been subject to abuse, misuse, negligence or accidents. Also, consequential and incidental damage resulting from the use of this product or arising out of any breach of contract or breach of this warranty are not recoverable under this warranty. Some states do not allow the exclusion or limitation of incidental or consequential damage, so the above limitation may not apply to you.

How do you get service?

If repairs become necessary, see contact information below:

U.S. Residents: Please contact our toll free hotline at 1-866-528-8323 (1-866-Latte-Best) or log onto our website at [www.delonghi.com](http://www.delonghi.com)

Residents of Canada: Please contact our toll free hotline at 1-888-335-6644 or log onto our website at [www.delonghi.com](http://www.delonghi.com)

Residents of Mexico: Please contact our toll free number 01-800-711-8805 for assistance or log onto our website at [www.delonghi.com](http://www.delonghi.com)

The above warranty is in lieu of all other express warranties and representations. All implied warranties are limited to the applicable warranty period set forth above. This limitation does not apply if you enter into an extended warranty with De'Longhi. Some states/ countries do not allow limitations on how long an implied warranty lasts, so the above exclusions may not apply to you. De'Longhi does not authorize any other person or company to assume for it any liability in connection with the sale or use of its appliance.

How does country law apply?

This warranty gives you specific legal rights, and you may also have other rights, which vary from state to state/country to country.