



De'Longhi Appliances
via Seitz, 47
31100 Treviso Italia

Instructions for use
Istruzioni per l'uso

EC220CD EX:1
COFFEE MAKER
MACCHINA DA CAFFÈ



electrical connection (UK only)

- A) If your appliance comes fitted with a plug, it will incorporate a 13 Amp fuse. If it does not fit your socket, the plug should be cut off from the mains lead, and an appropriate plug fitted, as below.

WARNING: Very carefully dispose of the cut off plug after removing the fuse: do not insert in a 13 Amp socket elsewhere in the house as this could cause a shock hazard.

With alternative plugs not incorporating a fuse, the circuit must be protected by a 15 Amp fuse. If the plug is a moulded-on type, the fuse cover must be re-fitted when changing the fuse using a 13 Amp Asta approved fuse to BS 1362. In the event of losing the fuse cover, the plug must NOT be used until a replacement fuse cover can be obtained from your nearest electrical dealer. The colour of the correct replacement fuse cover is that as marked on the base of the plug.

- B) If your appliance is not fitted with a plug, please follow the instructions provided below:

WARNING - THIS APPLIANCE MUST BE EARTHED

IMPORTANT

The wires in the mains lead are coloured in accordance with the following code:

Green and yellow:	Earth
Blue:	Neutral
Brown:	Live



As the colours of the wires in the mains lead may not correspond with the coloured markings identifying the terminals in your plug, proceed as follows:

The green and yellow wire must be connected to the terminal in the plug marked with the letter E or the earth symbol  or coloured green or green and yellow.

The blue wire must be connected to the terminal marked with the letter N or coloured black.

The brown wire must be connected to the terminal marked with the letter L or coloured red.

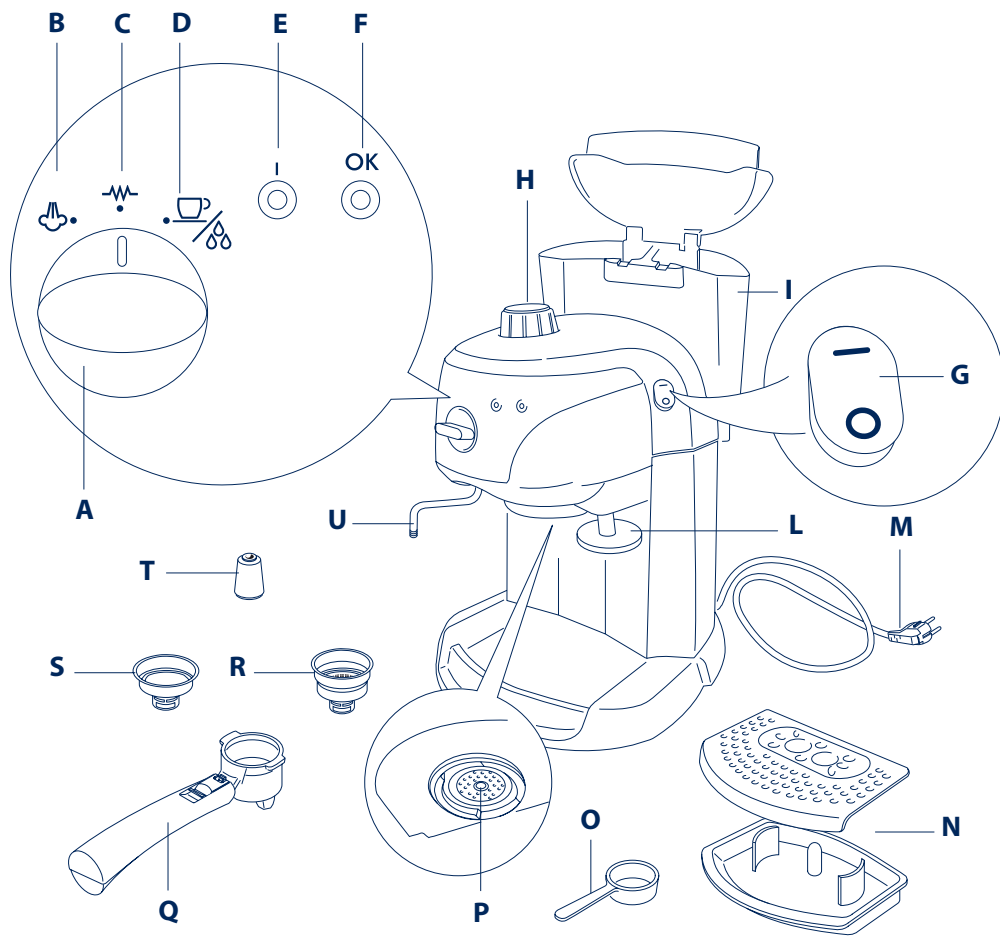

en descriptionpag. 13

it descrizionepag. 16

first use - primo utilizzo

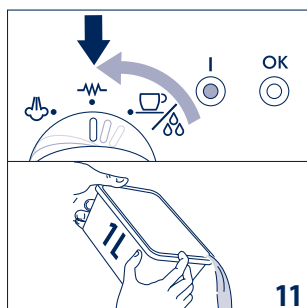
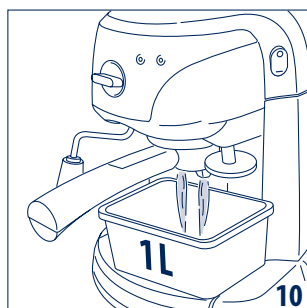
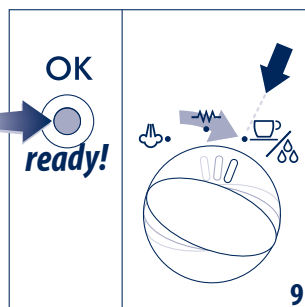
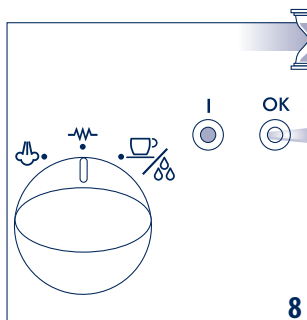
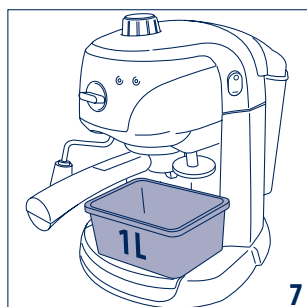
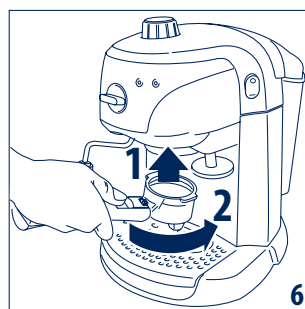
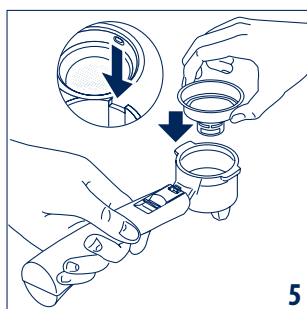
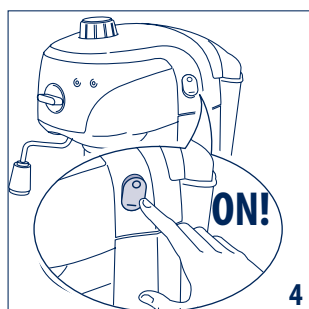
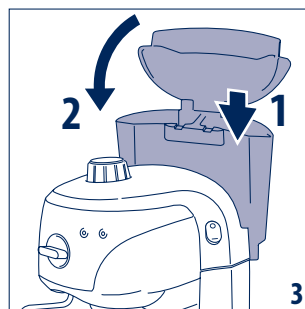
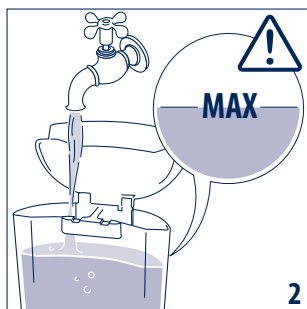
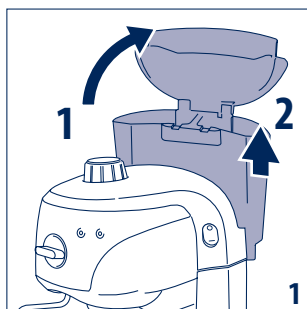

preheating - riscaldamento

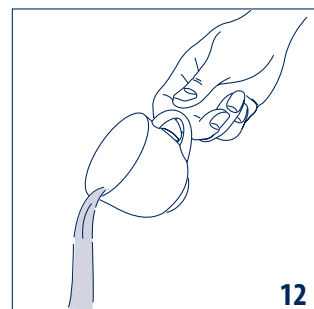
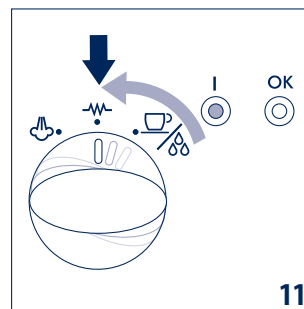
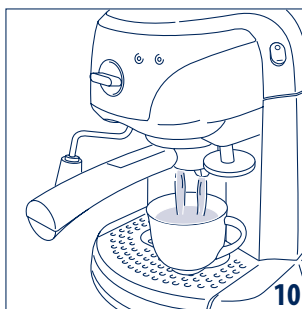
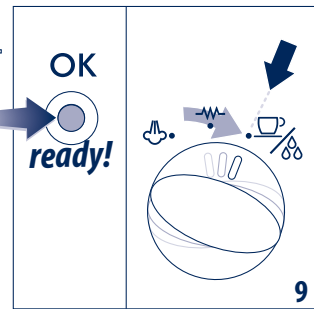
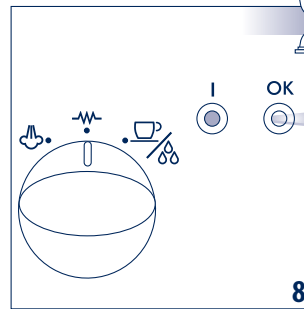
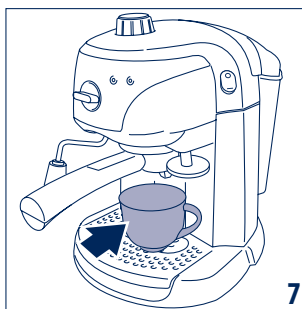
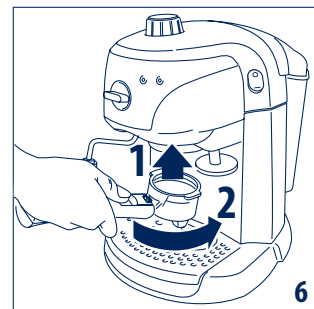
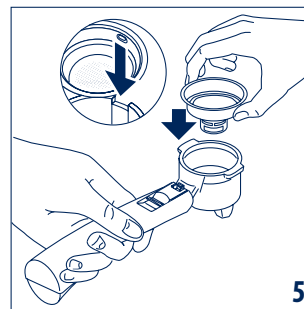
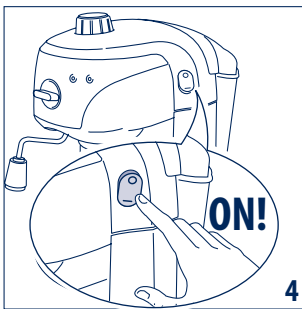
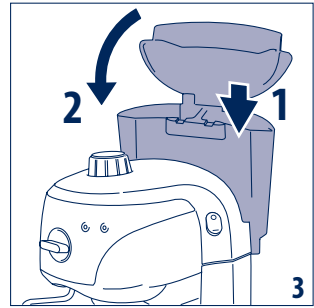
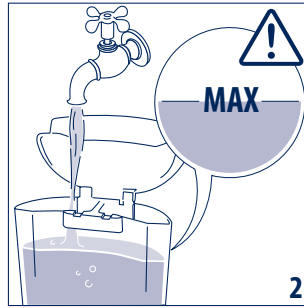
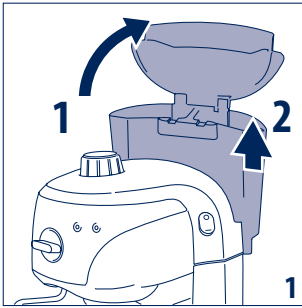

espresso with ground coffee - espresso con caffè macinato

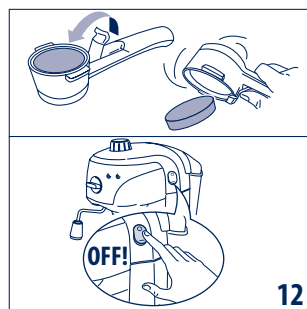
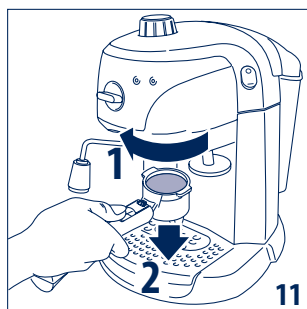
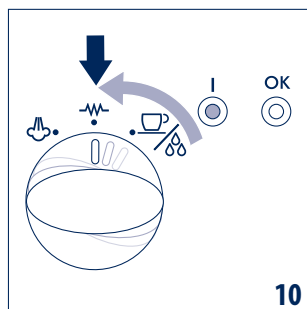
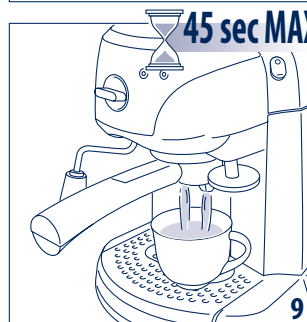
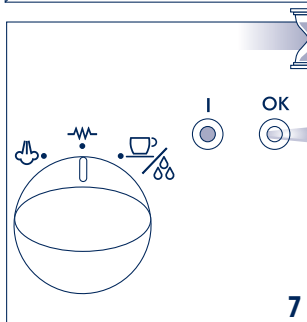
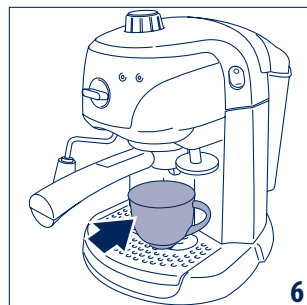
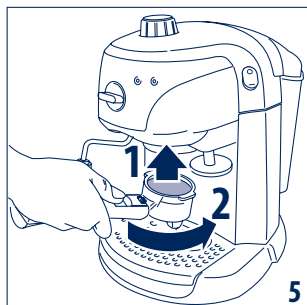
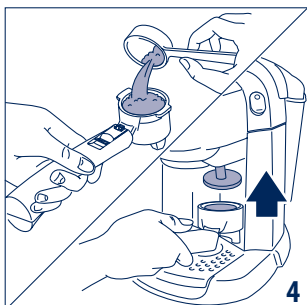
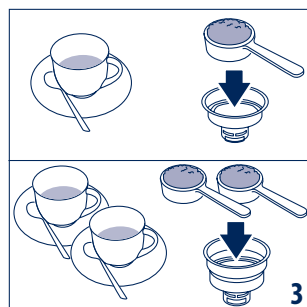
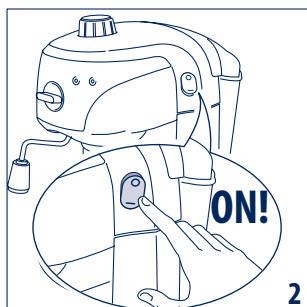
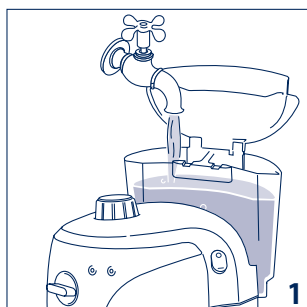

espresso with pods - espresso con cialda

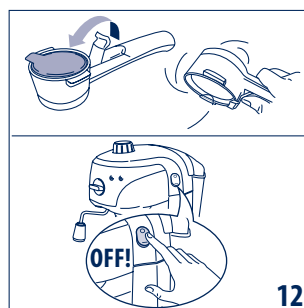
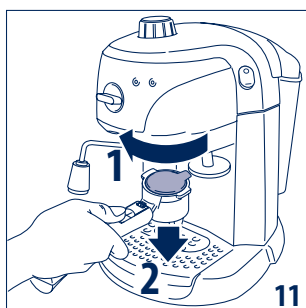
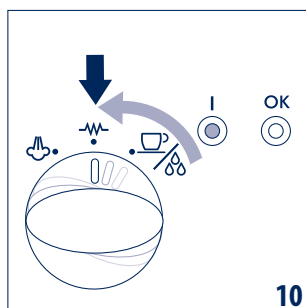
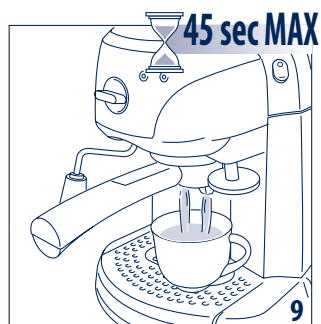
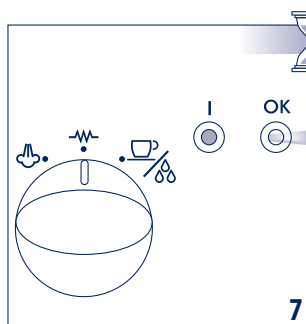
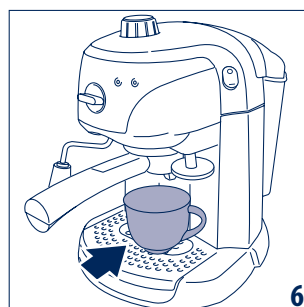
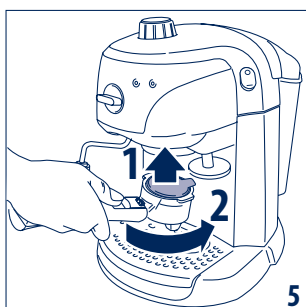
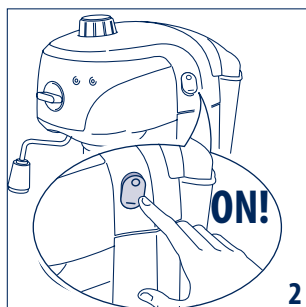
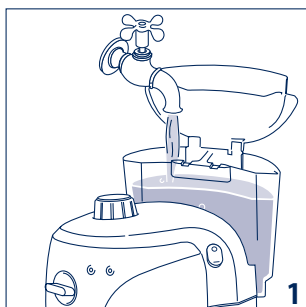



cappuccino

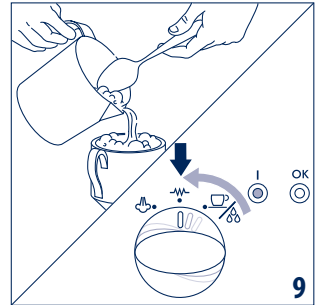
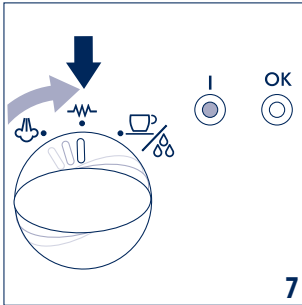
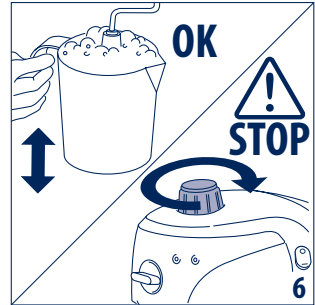
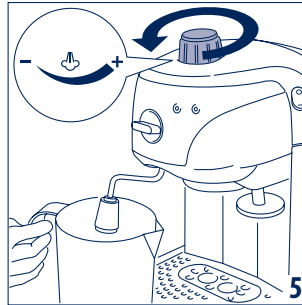
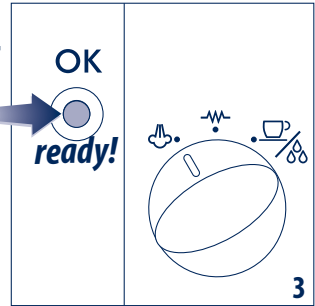
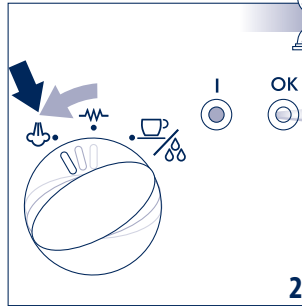
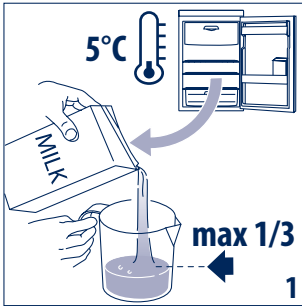

make an espresso pag. 6/7

cleaning the cappuccino maker - pulizia del cappuccinatore

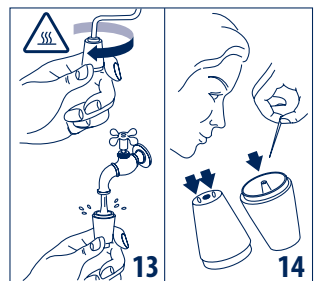
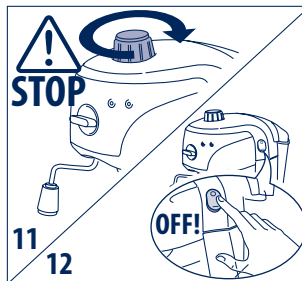
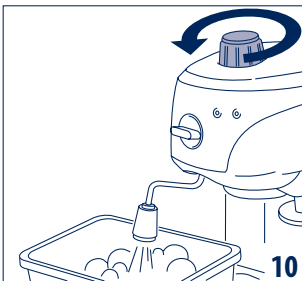

hot water - acqua calda

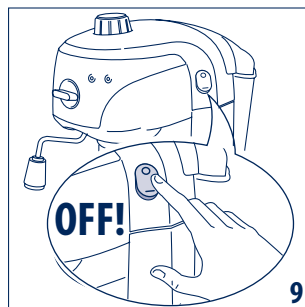
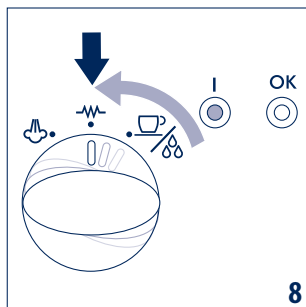
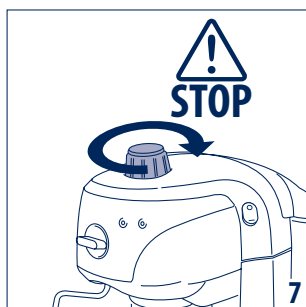
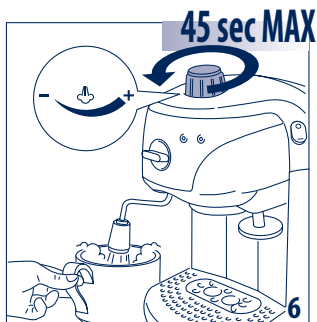
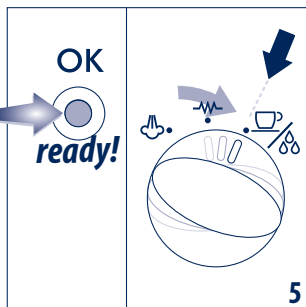
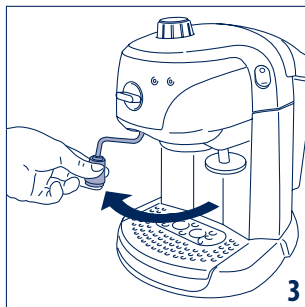
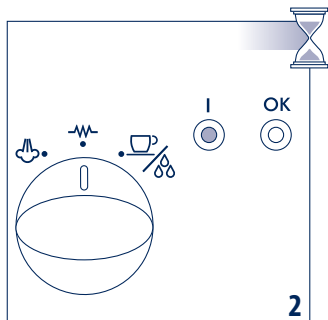
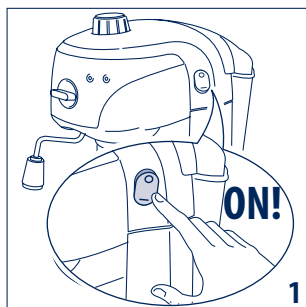

Auto-off - Autospegnimento

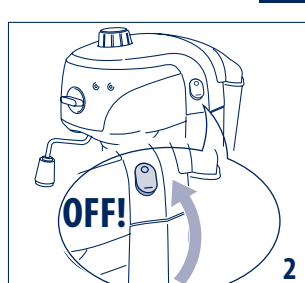
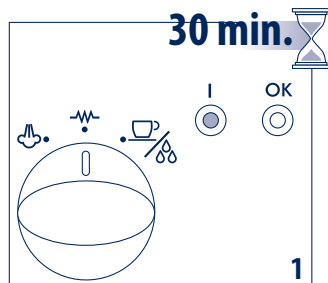

regular cleaning - pulizia

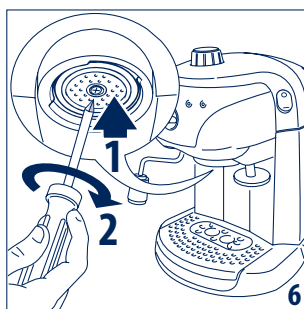
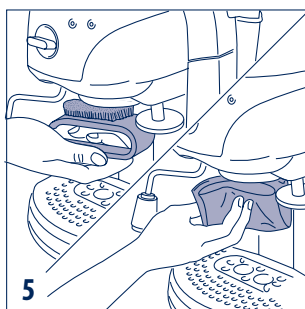
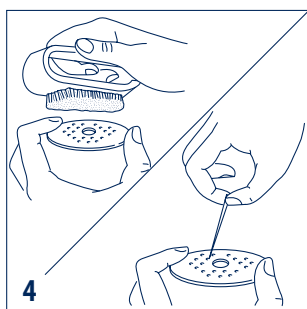
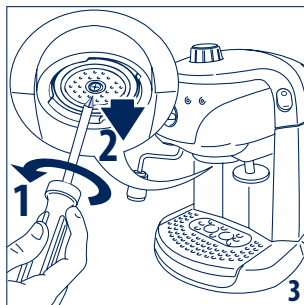
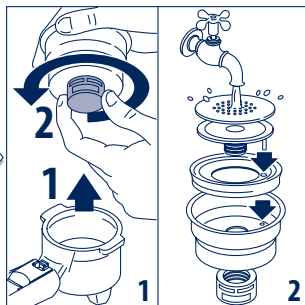
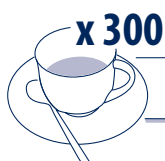

maintenance - manutenzione

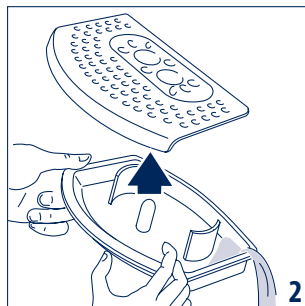
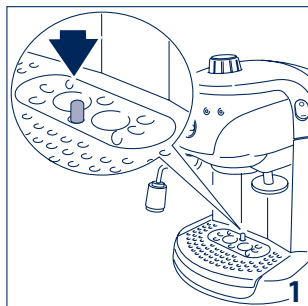

descaling - decalcificazione

descaling every 200 coffees perform step 1 and 2

decalcificazione ogni 200 caffè eseguire step 1 e 2

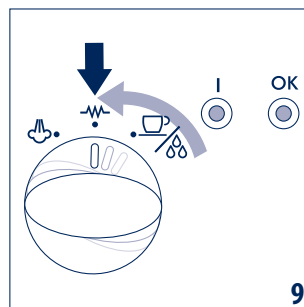
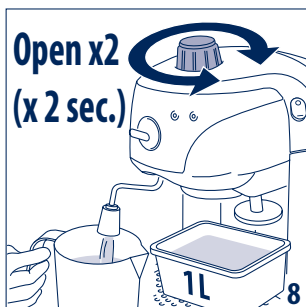
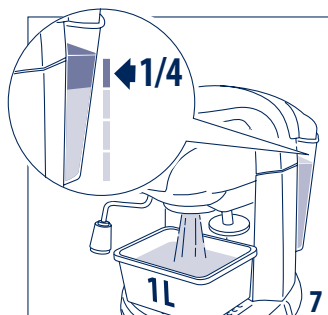
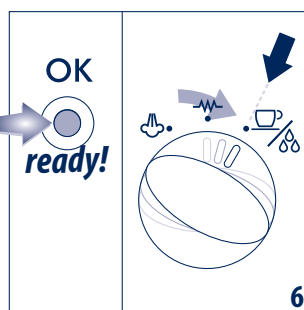
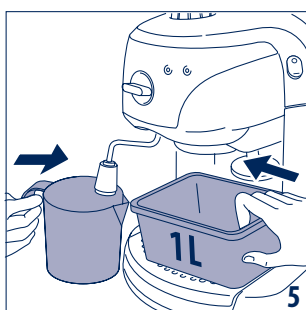
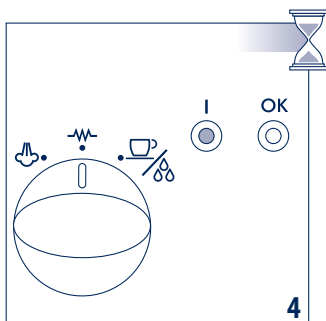
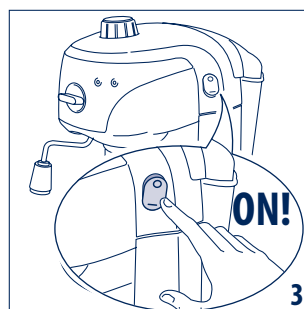
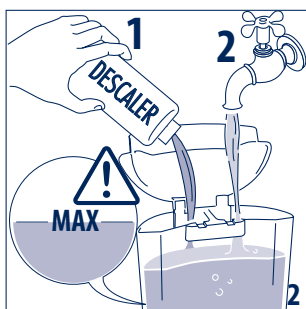
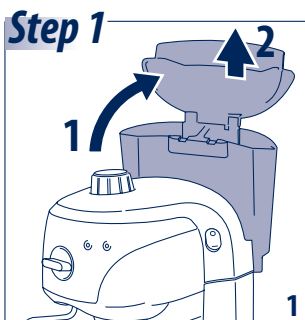



5 min

repeat x3 (fig. 6-9)
ripetere

10

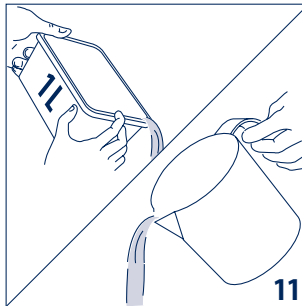

11

Step 2

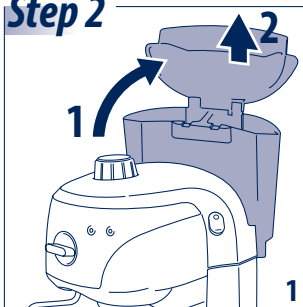

1



2

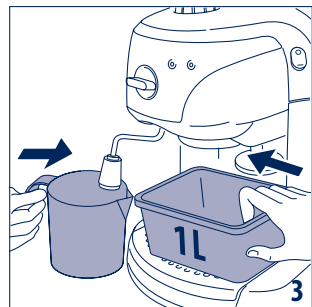

3

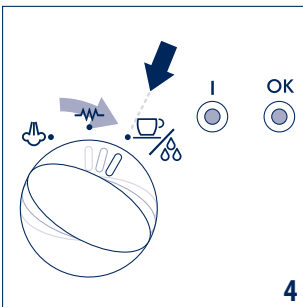

4

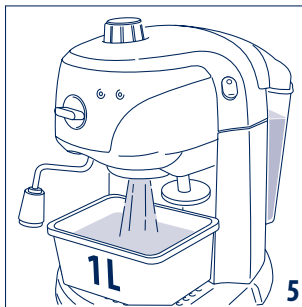

5

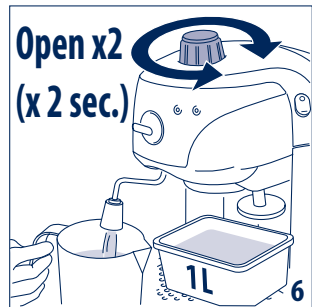

6

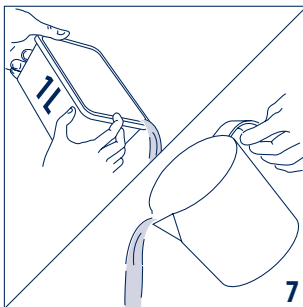

7

repeat x1 (fig. 1-7)
ripetere

8

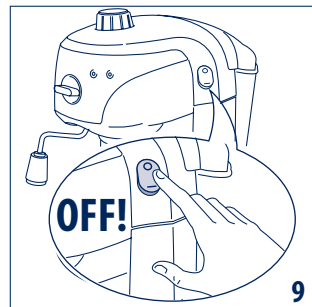

9

Description of appliance

- A Selector knob
- B Steam position
- C Heating position
- D Coffee/hot water dispensing position
- E "ON" light
- F OK light for espresso coffee or steam
- G Main switch (in auto-off, it automatically switches to the 0 position)
- H Steam knob
- I Water tank
- L Coffee tamper
- M Power cable
- N Cup tray
- O Measuring spoon
- P Boiler outlet
- Q Filter-holder cup-
- R 2-cup coffee filter
- S 1-cup coffee filter
- T Cappuccino maker
- U Steam/hot water dispensing tube

Fundamental recommendations regarding safety



Danger of electric shocks!

As the appliance operates using electric current, electric shocks cannot be excluded.

Therefore, follow the safety recommendations given:

- Do not touch the appliance when you have wet hands or feet.
- Never touch the plug with wet hands.
- Make sure that the socket used can always be easily reached, so that the plug can be removed when required.
- If you wish to remove the plug from the socket, act directly on the plug itself. Do not pull the cable as damage could be caused.
- Remove the plug from the socket to disconnect the appliance completely.
- If the appliance is faulty, do not attempt to repair it. Turn the appliance off, unplug from the mains socket and contact the Technical Service Centre.

- If the plug or power cable is damaged, they must be replaced by the De'Longhi Technical Assistance service only to avoid all risk.
- During cleaning, never immerse the machine in water: it is an electric appliance.
- Before performing any cleaning operation of the external parts of the appliance, switch the machine off, remove the plug from the socket and let the machine cool down.



Caution:

Keep the packaging material (plastic bags, polystyrene foam) out of the reach of children.



Caution:

Do not allow the appliance to be used by persons (also children) with reduced psycho-physical-sensorial capacities or that have insufficient experience and knowledge, unless they are carefully monitored and trained by a person responsible for their safety. Watch children, making sure they do not play with the appliance.



Scalding hazard!

This appliance produces hot water and steam may form when it is operating.

Be careful not to come into contact with hot water sprays or steam. Do not touch the cup warmer plate when the appliance is on because it is hot.

Use in compliance with its intended use

This appliance is manufactured to prepare coffee and to heat beverages. This appliance is intended exclusively for domestic use. Its use is not intended in:

- rooms used as kitchens for the staff of shops, offices and other work-places
- farmhouse holiday accommodation
- hotels, motels and other places offering hospitality
- room lets

Any other use must be considered improper and therefore dangerous. The manufacturer is not liable for damage deriving from improper use of the appliance.

Instructions for use

Read these instructions carefully before using the appliance. Failure to comply with these instructions can lead to injury and damage to the machine.

The manufacturer is not liable for damage deriving from the failure to comply with the instructions for use.



Please note:

Keep these instructions carefully. If the appliance should be transferred to other persons, these instructions must accompany it.



Please note: upon first use

Upon first use, rinse the internal ducts of the device, and operate the device like one would to make coffee until at least two water tanks have been emptied; then, proceed to making coffee.



Attention: It is recommended to descale the machine about every 200 coffees.



Attention: do not wash any of the accessories in the dishwasher.

Check after transport

After the packaging has been removed, check the integrity of the appliance and the presence of all accessories.

Do not use the appliance in the presence of obvious damage. Contact the De'Longhi After-Sales Service.

Auto-off

If the appliance is not used for 30 minutes it will switch off automatically (see page 9).

Technical data

Mains voltage:	220-240V~50/60Hz
Absorbed power:	1100W
Sizes LxHxD:	195x285x240 (330) mm
Boiler:	Stainless Steel
Pressure:	15 bar
Water tank capacity:	1 L
Supply lead length:	1.2 m
Weight:	3.3 kg



The appliance is compliant with the following EC Directives:

- Low Voltage Directive 2006/95/EC and subsequent amendments;
- EMC Directive 2004/108/EC and subsequent amendments;
- The materials and objects destined to come into contact with food stuffs are in compliance with the provisions of the 1935/2004 European Standard.

Disposal



Pursuant to European Directive 2002/96/EC, do not dispose of the appliance with household waste, but hand it over to an official separate waste collection centre.

if something does not work... en

Problem	Possible causes	Solution
The machine switches off	The auto-off feature is operating	The appliance switches off automatically if not used for 30 minutes
	When the appliance is switched on the selector knob is not in the ☑ position	Turn the knob to ☑ and turn the appliance back on
Espresso coffee does not flow out	No water in the tank	Fill the water tank
	The holes where the coffee comes out of on the filter-holder are clogged	Clean the holes in the filter-holder spouts
	The espresso boiler outlet is blocked	Carry out the cleaning operation as described in the paragraph headed "Cleaning"
Espresso coffee drips from the edges of the filter-holder instead of through the holes	The filter-holder is inserted incorrectly	Attach the filter-holder correctly and turn it firmly until fully home
	The espresso boiler gasket has lost its elasticity	Obtain a replacement for the espresso boiler gasket from your Service Centre
	The holes in the filter-holder spout are clogged	Clean the holes in the spouts.
The espresso coffee is cold	The espresso OK light is not on when the coffee dispensing button is pressed	Wait for the OK light to switch on
	Pre-heating has not been carried out	Carry out the pre-heating operation as described in the paragraph headed "Pre-heating"
	The cups have not been pre-heated	Pre-heat the cups with hot water
Loud pump noise	The water tank is empty	Fill up the tank
	The tank is improperly inserted and the valve on its base is not open	Gently press on the tank to open the valve on its base
The coffee cream is clear (it flows out quickly from the spout)	The ground coffee is insufficiently tamped	Tamp the ground coffee more
	The quantity of ground coffee is insufficient	Increase the amount of ground coffee
	The coffee is too coarsely ground	Only use ground coffee for espresso coffee machines
	The ground coffee is not the correct type	Change the type of ground coffee used
The coffee cream is dark (it flows out slowly from the spout)	The ground coffee has been tamped too firmly	Tamp the coffee less firmly
	Too much ground coffee is being used	Reduce the quantity of ground coffee
	The espresso boiler outlet is clogged	Carry out the cleaning operation as described in the paragraph headed "Cleaning"
	The filter is clogged	Carry out the cleaning operation as described in the paragraph headed "Cleaning"
	The coffee is too finely ground	Only use ground coffee for espresso coffee machines
	The ground coffee is too fine, or is damp	Only use coffee ground specifically for espresso coffee machines and it must not be too damp
	The ground coffee is not the correct type	Change the type of ground coffee powder
The milk does not froth when making a cappuccino	The milk is not cold enough	Always use milk straight from the refrigerator
	The cappuccino maker is dirty	Clean the small holes in the cappuccino-maker carefully, especially those indicated in the diagram.