



De'Longhi Appliances
via Seitz, 47
31100 Treviso Italia

BEAN TO CUP ESPRESSO AND CAPPUCCINO MACHINE

Instruction for use

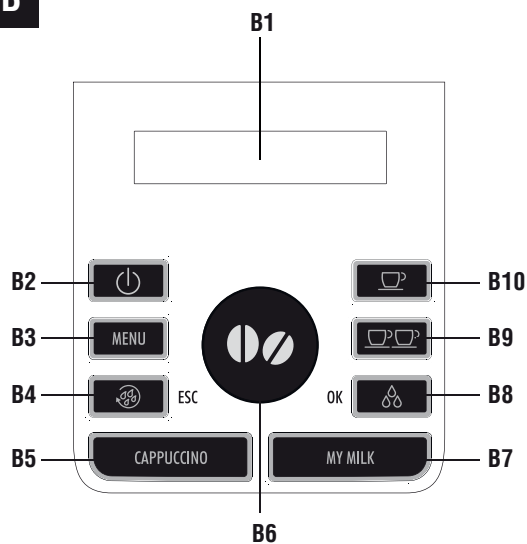
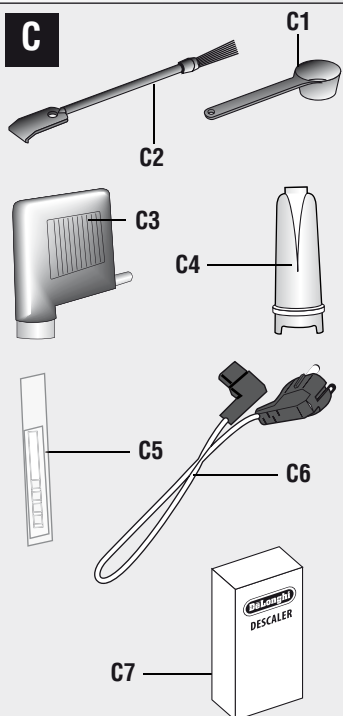
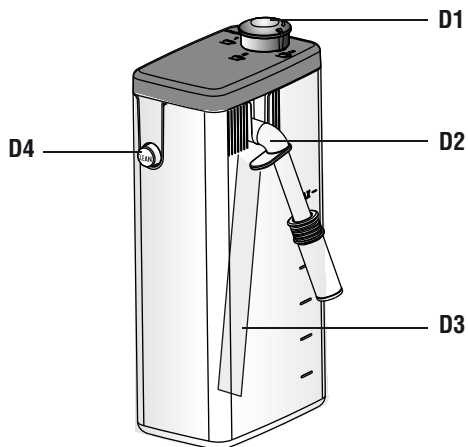

ECAM25452/ECAM25457

B**C****D**

A

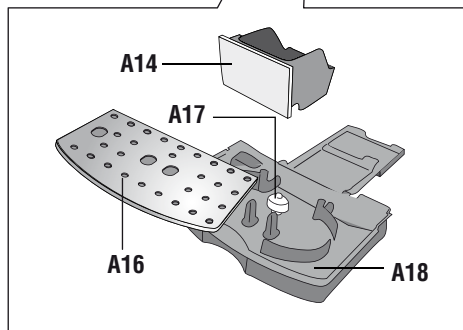
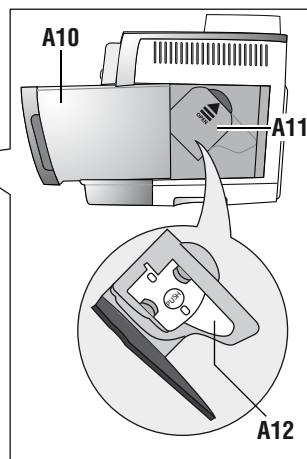
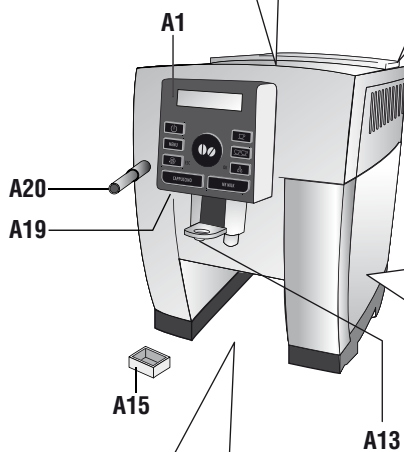
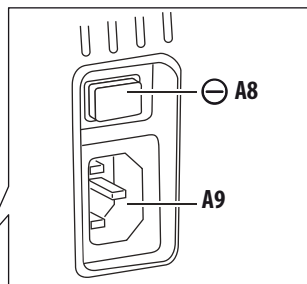
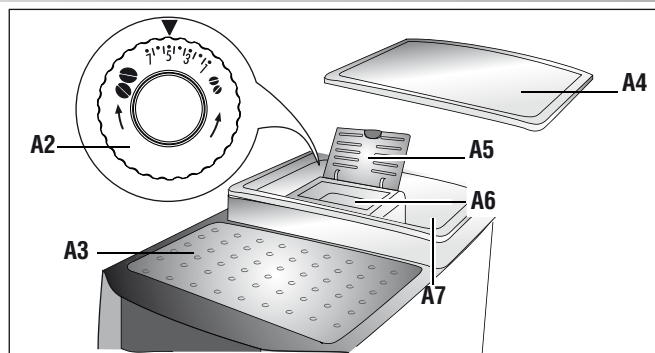

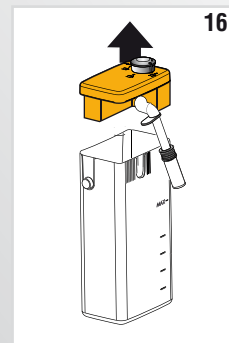
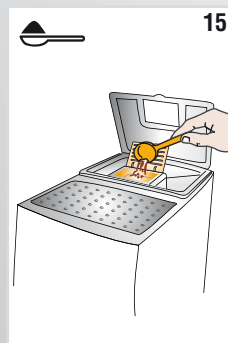
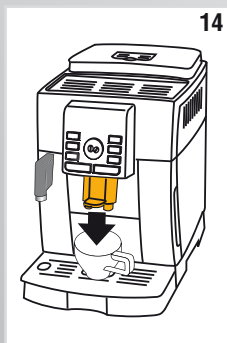
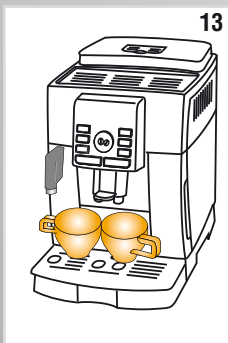
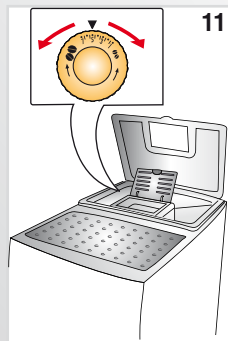
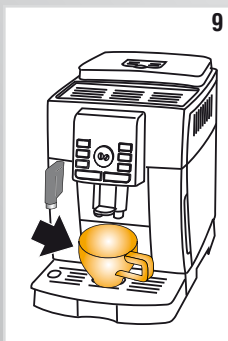
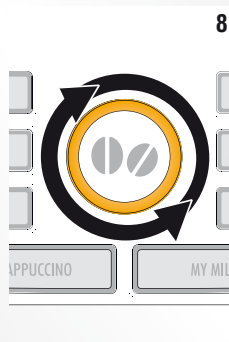
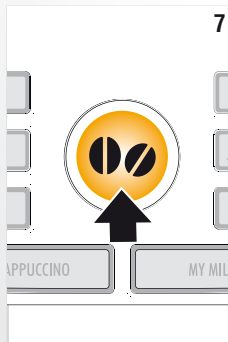
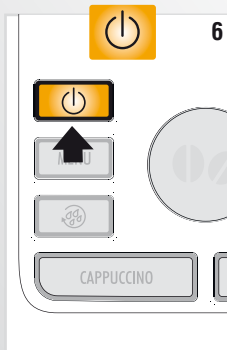
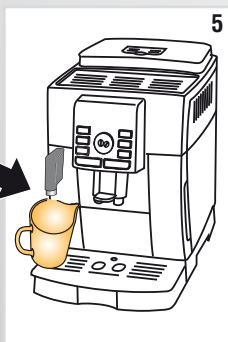
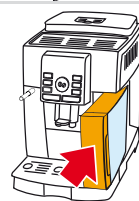
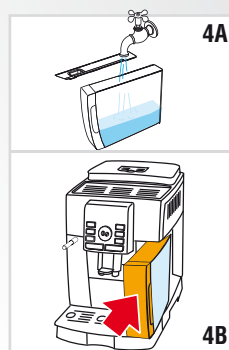
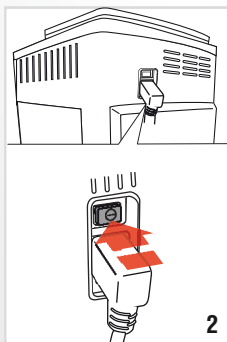
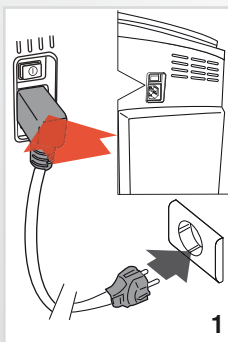

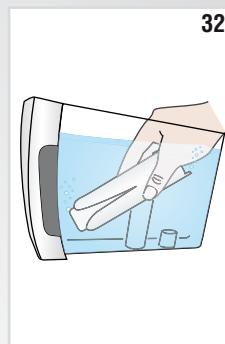
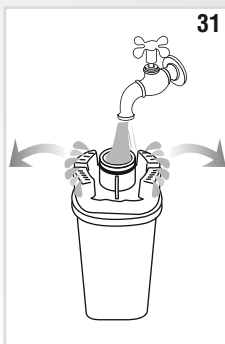
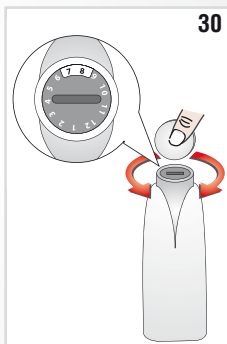
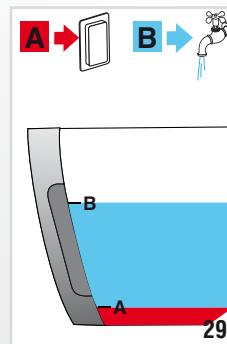
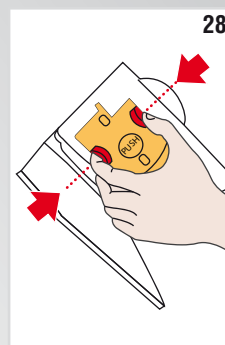
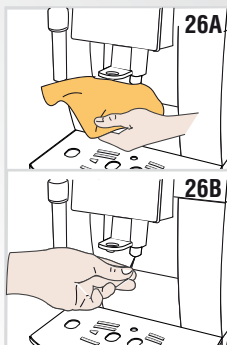
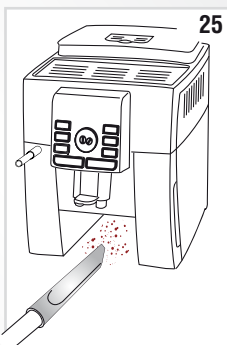
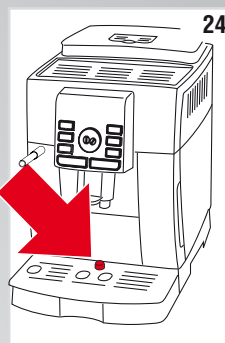
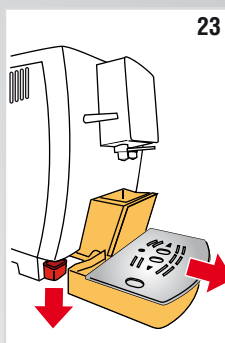
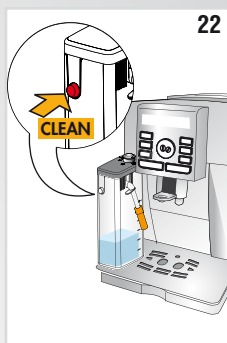
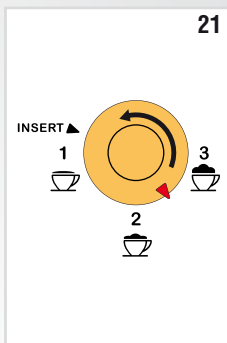
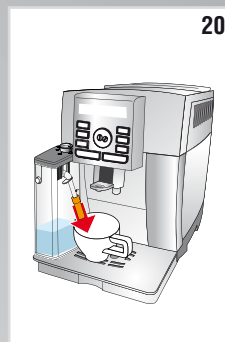
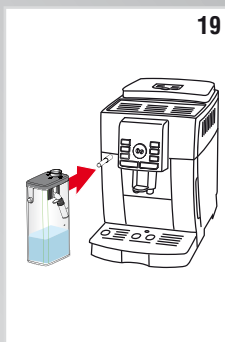
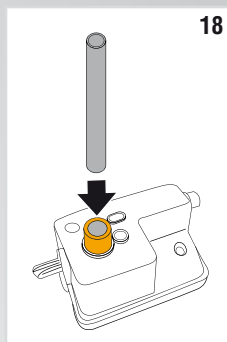
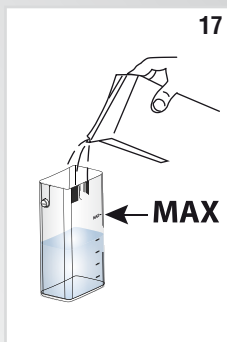

CONTENTS

INTRODUCTION	7	MAKING CAPPUCCINO AND MILK BASED COFFEES	12
Symbols used in this instruction	7	Filling and attaching the milk container	13
Letters in brackets	7	Adjusting the amount of froth	13
Troubleshooting and repairs	7	Making CAPPUCCINO	13
SAFETY	7	Making CAFFELATTE/MACCHIATO/FLAT WHITE/ MILK	13
Fundamental safety warnings	7	Programming the quantities of coffee and milk in the cup	13
DESIGNATED USE	7	Programming cappuccino:	13
INSTRUCTION FOR USE	7	Programming MY MILK drinks:	13
DESCRIPTION	8	CLEANING THE MILK CONTAINER AFTER USE	13
Description of the appliance	8	HOT WATER	14
Description of the control panel	8	Changing the quantity of water delivered automatically	14
Description of the accessories	8	CLEANING	14
Description of milk container	8	Cleaning the machine	14
PRELIMINARY CHECKS	8	Cleaning the coffee grounds container	14
Checking the appliance	8	Cleaning the drip tray and condensate tray	14
Installing the appliance	8	Cleaning the inside of the coffee machine	15
Connecting the appliance	8	Cleaning the water tank	15
Setting up the appliance	9	Cleaning the coffee spouts	15
TURNING THE APPLIANCE ON	9	Cleaning the pre-ground coffee funnel	15
TURNING THE APPLIANCE OFF	9	Cleaning the infuser	15
MENU SETTINGS	9	Cleaning the milk container	16
Descaling	9	Cleaning the hot water/steam nozzle	16
Adjust time	9	DESCALING	16
Auto-Off	10	SETTING WATER HARDNESS	17
Auto-start	10	Measuring water hardness	17
Setting the temperature	10	Set water hardness	17
Energy saving	10	WATER SOFTENER FILTER	17
Cup warmer	10	Installing the filter	17
Setting water hardness	10	Replacing the filter	18
Setting the language	10	Removing the filter	18
Install filter	11	TECHNICAL DATA	18
Replacing the filter	11	DISPOSAL	18
Enable/disable the beep	11	ELECTRICAL REQUIREMENTS	18
Cup lighting	11	DISPLAYED MESSAGES	19
Default values (reset)	11	TROUBLESHOOTING	20
Statistics function	11		
MAKING COFFEE	11		
Selecting the coffee taste	11		
Selecting the quantity of coffee in the cup	11		
Customising the "my coffee" quantity	11		
Adjusting the coffee mill	12		
Tips for a hotter coffee	12		
Making coffee using coffee beans	12		
Making coffee using pre-ground coffee	12		

INTRODUCTION

Thank you for choosing this bean to cup espresso and cappuccino machine.

We hope you enjoy using your new appliance.

Take a few minutes to read these instructions.

This will avoid all risks and damage to the appliance.

Symbols used in this instruction

Important warnings are identified by these symbols.

It is vital to respect these warnings.



Danger!

Failure to observe the warning may result in life threatening injury by electric shock.



Important!

Failure to observe the warning could result in injury or damage to the appliance.



Danger of burns!

Failure to observe the warning could result in scalds or burns.



Please note :

This symbol identifies important advice or information for the user.

Letters in brackets

The letters in brackets refer to the legend in the Description of the Appliance on page 3.

Troubleshooting and repairs

In the event of problems, first try and resolve them following the information given in the sections "Displayed messages" on page 20 and "Troubleshooting" on page 21.

If this does not resolve the problem or you require further information, you should consult customer experience by calling the number given on the annexed guarantee leaflet. If your country is not among those listed on the sheet, call the number given in the guarantee. If repairs are required, contact De'Longhi customer experience only. The addresses are given in the guarantee certificate provided with the machine.

SAFETY

Fundamental safety warnings



Danger!

This is an electrical appliance and may cause electric shock.

You should therefore respect the following safety warnings:

- Never touch the appliance with damp hands or feet.
- Never touch the plug with damp hands.
- Make sure the socket used is freely accessible at all times, enabling the appliance to be unplugged when necessary.

- Unplug directly from the plug only. Never pull the power cable as you could damage it.
- To disconnect the appliance completely, release the main switch at the back of the appliance (fig. 2).
- If the appliance is faulty, do not attempt to repair. Turn it off, unplug from the mains socket and contact customer experience.
- If the plug or power cable is damaged, it must be replaced by De'Longhi customer experience only to avoid all risk.



Important!

- Keep all packaging (plastic bags, polystyrene foam) away from children.
- The appliance is not intended for use by persons (including children) with reduced physical, sensory or mental capabilities, or lack of experience and knowledge, unless they have been given supervision or instruction concerning use of the appliance by a person responsible for their safety. Children should be supervised to ensure that they do not play with the appliance.



Danger: Risk of burns!

This appliance produces hot water and steam may form while it is in operation.

Avoid contact with splashes of water or hot steam.

DESIGNATED USE

This appliance is designed and made to prepare coffee and heat drinks. All other use is considered improper. This appliance is not suitable for commercial use. The manufacturer is not liable for damage deriving from improper use of the appliance. This is an household appliance only. It is not intended to be used in:

- staff kitchen areas in shops, offices and other working environments.
- farm houses
- by clients in hotels, motels and other residential type environments
- bed and breakfast type environments

INSTRUCTION FOR USE

Read these instructions carefully before using the appliance.

- Failure to respect these instructions may result in burns or damage to the appliance.

The manufacturer is not liable for damage deriving from failure to respect these instructions for use.



Please note :

Keep this instruction.

If the appliance is passed to other persons, they must also be provided with these instructions for use.

DESCRIPTION

Description of the appliance





(page 3 - A)

- A1. Control panel
- A2. Grinding adjustment dial
- A3. Cup shelf (cup warmer active when selected from settings menu)
- A4. Beans container lid
- A5. Pre-ground coffee funnel lid
- A6. Pre-ground coffee funnel
- A7. Beans container
- A8. Main switch
- A9. Socket for power cable connector
- A10. Water tank
- A11. Infuser door
- A12. Infuser
- A13. Coffee spout (adjustable height)
- A14. Coffee grounds container
- A15. Condensate tray
- A16. Cup tray
- A17. Drip tray water level indicator
- A18. Drip tray
- A19. Cup lighting
- A20. Hot water and steam connection nozzle

Description of the control panel

(page 2 - B)

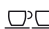
A number of buttons on the panel have a double function. This is indicated in brackets in the description.

- B1. Display: guides the user in using the appliance.
- B2.  button: turns the appliance on and off.
- B3. **MENU** button: to access the menu.
- B4.  button: to perform a rinse cycle.
(When in the settings MENU, it acts as the "ESC" button to exit from the selected function and go back to the main menu).
- B5. **CAPPUCCINO** button: to make cappuccino.
- B6. Selection dial:
 - turn to select the required quantity of coffee.
 - press to select the required taste.*(When in the settings MENU, turn to select the required function).*
- B7. **MY MILK** button: to access preparation of MACCHIATO, CAFFELATTE, FLAT WHITE and MILK.
- B8.  button: to deliver hot water.
(When in the settings MENU: "OK" button to confirm the selection made)
- B9.  button: to make 2 cups of coffee
- B10.  button: to make 1 cup of coffee

Description of the accessories

(page 2 - C)

- C1. Measure
- C2. Cleaning brush
- C3. Hot water spout
- C4. Water softener filter (certain models only)
- C5. "Total Hardness Test" indicator paper
- C6. Power cable
- C7. Descaler

Description of milk container

(page 3 - D)

- D1. Froth adjustment dial
- D2. Frothed milk spout (adjustable)
- D3. Milk intake tube
- D4. CLEAN button

PRELIMINARY CHECKS

Checking the appliance

After removing the packaging, make sure the product is complete and undamaged and that all accessories are present. Do not use the appliance if it is visibly damaged. Contact De'Longhi customer experience.

Installing the appliance



Important!

When you install the appliance, you should respect the following safety warnings:

- The appliance gives off heat. After positioning the appliance on the worktop, leave a space of at least 3 cm between the surfaces of the appliance and the side and rear walls and at least 15 cm above the coffee machine.
- Water penetrating the coffee machine could cause damage. Do not place the appliance near taps or sinks.
- The appliance could be damaged if the water it contains freezes. Do not install the appliance in a room where the temperature could drop below freezing point.
- Arrange the power cable in such a way that it cannot be damaged by sharp edges or contact with hot surfaces.

Connecting the appliance



Important!

Check that the mains power supply voltage corresponds to the value indicated on the rating plate on the bottom of the appliance.

Connect the appliance to an efficiently earthed and correctly installed socket with a minimum current rating of 10A only.

If the power socket does not match the plug on the appliance, have the socket replaced with a suitable type by a qualified professional.



Setting up the appliance



Please note :

- Coffee has been used to factory test the appliance and it is therefore completely normal for there to be traces of coffee in the mill. The machine is, however, guaranteed to be new.
 - You should customise water hardness as soon as possible following the instructions in the section “Setting water hardness” on page 18.
1. Plug the power cable connector into the socket at the back of the appliance and connect the appliance to the mains electricity supply (fig. 1). Make sure the main switch at the back of the appliance is pressed (fig. 2).

You must first choose the language (the languages scroll through at intervals of about 3 seconds):

2. When “English” appears, press and hold the  button (fig. 3) for a few seconds until “ENGLISH set” is displayed. Follow the instructions indicated on the appliance display:
3. “FILL TANK”: remove the water tank, fill to the MAX line with fresh water (fig. 4A), then replace in the appliance (fig. 4B).
4. “INSERT WATER SPOUT”: Check that the hot water spout is inserted on the nozzle and place a container with a minimum capacity of 100 ml under the cappuccino maker (fig. 5).
5. “HOT WATER Confirm?” is displayed;
6. Press the  button (fig. 3) to confirm. The appliance delivers water from the spout then goes off automatically.

The coffee machine is now ready for normal use.



Please note :

- When using the appliance for the first time, you need to make 4-5 cups of coffee or 4-5 cappuccinos before the appliance starts to give satisfactory results.
- When making the first 5-6 cappuccinos, it is normal to hear the noise of boiling water. After this, the noise reduces.

TURNING THE APPLIANCE ON



Please note :

Before turning the appliance on, make sure the main switch on the back of the appliance is pressed (fig. 2).

Each time the appliance is turned on, it performs an automatic preheat and rinse cycle which cannot be interrupted.

The appliance is ready for use only after completion of this cycle.



Danger of burns!

During rinsing, a little hot water comes out of the coffee spouts and is collected in the drip tray underneath.

Avoid contact with splashes of water.

- To turn the appliance on, press the  button (fig. 6). The message “Heating up Please wait” is displayed.

After heating, the message “Rinsing” is displayed. As well as heating the boiler, the appliance also heats the internal circuits by circulating hot water.

The appliance is at temperature when the message indicating the taste and quantity of coffee appears.

TURNING THE APPLIANCE OFF

Each time the appliance is turned off, it performs an automatic rinse cycle which cannot be interrupted.



Danger of burns!

During rinsing, a little hot water flows from the coffee spouts.

Avoid contact with splashes of water.

To turn the appliance off, press the  button (fig. 6). The appliance performs a rinse cycle then goes off (stand-by).



Please note:

If you will not be using the appliance for a long time, unplug from the mains socket:

- first turn the appliance off by pressing the  button (fig. 6);
- press the main switch (fig. 2).



Important!

Never press the main switch while the appliance is on.

MENU SETTINGS

When you access the settings menu by pressing the **MENU** button, the following menu items are available: Descaling, Adjust time, Auto-off, Auto-start, Set temperature, Energy saving, Cup warmer, Water hardness, Set language, Install filter (or Remove filter or Replace filter if the filter has already been installed), Beep, Cup lighting, Default values, Statistics.



Descaling

For instructions on descaling, see page 16.

Adjust time

To adjust the time on the display, proceed as follows:



1. Press the menu button to enter the menu;
2. Turn the selection dial (fig. 8) until “Adjust time” is displayed;
3. Press the  button;
4. Turn the selection dial to change the hours;

5. Press the  button to confirm;
6. Turn the selection dial to change the minutes;
7. Press the  button to confirm.

This sets the time. Press the  button to exit the menu.

Auto-Off

Auto-off can be set so that the appliance goes off after 15 or 30 minutes, or after 1, 2 or 3 hours.

1. Press the MENU button to enter the menu;
2. Turn the selection dial until "Auto-off" is displayed;
3. Press the  button;
4. Turn the selection dial until the desired operation time is displayed (15 or 30 minutes, or 1, 2 or 3 hours);
5. Press the  button to confirm.

Auto-off is now programmed. Press the  button to exit the menu.





Auto-start

You can set the auto-start time in order to have the appliance ready at a certain time (for example in the morning) so you can make coffee immediately.



Please note :

To enable this function, the time must already be set correctly.

1. Press the MENU button to enter the menu;
2. Turn the selection dial until "Auto-start" is displayed;
3. Press the  button. "Enable?" is displayed;
4. Press the  button to confirm;
5. Turn the selection dial to choose the hours;
6. Press the  button to confirm;
7. Turn the selection dial to change the minutes;
8. Press the  button to confirm;
9. Then press the  button to exit the menu.

Once the time has been confirmed, activation of auto-start is indicated by the  symbol displayed alongside the time and under "Auto-start" in the menu.

To disable the function:

1. Select auto-start from the menu;
2. Press the  button. "Disable?" is displayed;
3. Press the  button to confirm.

The  symbol is no longer displayed.

Setting the temperature

To modify the temperature (low, medium, high) of the water used to make the coffee, proceed as follows:

1. Press the MENU button to enter the menu;
2. Turn the selection dial until "Set temperature" is displayed;
3. Press the  button;
4. Turn the selection dial until the required temperature (● = low; ●●●● = high) is displayed;

5. Press the  button to confirm.



The temperature is now programmed. Press the  button to exit the menu.

Energy saving

Use this function to enable or disable Energy saving.

When enabled, the function reduces energy consumption in compliance with current European regulations.

When energy saving mode is active, an asterisk appears below "Energy saving" in the menu.

1. Press the MENU button to enter the menu;
2. Turn the selection dial until "Energy saving" is displayed;
3. Press the  button. "Enable?" or "Disable?" is displayed;
4. Press the  button to enable or disable energy saving mode;

Press the  button to exit the menu.

When the function is active, if the machine is not used for about 1 minute, "Energy saving" is displayed.





Please note :

When in energy saving mode, a few seconds may elapse before the first coffee is delivered as the appliance must heat up again.

Cup warmer

This function enables the cup warmer to be enabled or disabled. Proceed as follows:

1. Press the MENU button to enter the menu;
2. Turn the selection dial until "Cup warmer" is displayed;
3. Press the  button. "Enable?" or "Disable?" is displayed;
4. Press the  button to enable or disable the cup warmer (an asterisk under "Cup warmer" indicates that it is active).
5. Then press the  button to exit the menu.



Warming the cups keeps the coffee hot.

Setting water hardness

For instructions on setting water hardness, see page 17.

Setting the language

To modify the language on the display, proceed as follows:

1. Press the MENU button to enter the menu;
2. Turn the selection dial until "Set language" is displayed;
3. Press the  button;
4. Turn the selection dial until the required language is displayed;
5. Press the  button to confirm;

The language is now set. Then press the  button to exit the menu.

Install filter

For instructions on how to install the filter, see the section "Installing the filter" (page 17).



Replacing the filter

For instructions on how to replace the filter, see the section "Replacing the filter" (page 18).

Enable/disable the beep

This enables or disables the beep emitted by the machine each time an icon is pressed or an accessory is inserted/removed.

To disable or re-enable the beep, proceed as follows:



1. Press the MENU button to enter the menu;
2. Turn the selection dial until "BEEP" is displayed;
3. Press the  button. "Enable?" or "Disable?" is displayed;
4. Press the  button to enable or disable the beep (an asterisk under "Beep" indicates that it is active).

Press the  button to exit the menu.

Cup lighting

This function enables or disables the cup lighting.



When the function is active, the lighting comes on whenever cappuccino or milk based drinks are made or the appliance is rinsed. To disable or re-enable this function, proceed as follows:

1. Press the MENU button to enter the menu;
2. Turn the selection dial until "Cup lighting" is displayed.
3. Press the  button. "Enable?" or "Disable?" is displayed;
4. Press the  button to enable or disable the cup lighting;
5. When the function is active, an asterisk appears after "Cup lighting" in the menu.

Press the  button to exit the menu.

Default values (reset)

This resets all menu settings and programmed quantities back to the default values (with the exception of the language which remains as set).



1. Press the MENU button to enter the menu;
2. Turn the selection dial until "Default values" is displayed;
3. Press the  button;
4. Confirm?" is displayed;
5. Press the  button to confirm and exit.

Statistics function

This displays statistics relating to the machine.

To display, proceed as follows:

1. Press the MENU button to enter the menu;
2. Turn the selection dial until "Statistics" is displayed;

3. Press the  button;
4. Turn the selection dial to verify:
 - how many coffees have been made;
 - how many times the machine has been descaled.
 - the total number of litres of water delivered.
 - how many times the water filter has been replaced;
 - number of drinks with milk delivered (CAPPUCCINO, MACCHIATO, CAFFELATTE, FLAT WHITE and MILK);
5. Press the  button twice to exit the menu.

MAKING COFFEE

Selecting the coffee taste

The appliance is set by default to make coffee with a standard taste.

You can also choose one of these tastes:

Extra-mild taste

Mild taste

Standard taste

Strong taste

Extra-strong taste

To change the taste, press the  dial (fig. 7) repeatedly until the required taste is displayed.



Selecting the quantity of coffee in the cup

To select the quantity of coffee, turn the selection dial (fig. 8) until the message corresponding to the required quantity of coffee is displayed:

Coffee selected	Quantity in cup (ml)
MY COFFEE	≈30 (program. from ≈20 to ≈180)
SHORT	≈40
STANDARD	≈60
LONG	≈90
EXTRA LONG	≈120

Customising the "my coffee" quantity

The appliance is set by default to automatically deliver 30 ml of "MY COFFEE". To modify this quantity, proceed as follows:

1. Place a cup under the coffee spouts (fig. 9).
2. Turn the selection dial (fig. 8) until "MY COFFEE" is displayed.
3. Keep the  button (fig. 10) pressed until the message "1 MY COFFEE Program quantity" is displayed and coffee delivery begins. Release the button.
4. As soon as the coffee in the cup reaches the required level, press the  button (fig. 10) again.

The quantity of coffee in the cup set has now been programmed.

Adjusting the coffee mill

The coffee mill is set by default to prepare coffee correctly and should not require regulating initially.

However, if after making the first few coffees you find that the coffee is either too weak and not creamy enough or delivery is too slow (in drops), this can be corrected by adjusting the grinding adjustment dial (fig. 11).



Please note :

The grinding adjustment dial must only be turned when the coffee mill is in operation.



If the coffee is delivered too slowly or not at all, turn one click clockwise. For fuller bodied creamier coffee, turn one click anticlockwise (do not turn more than one click at a time otherwise the coffee could be delivered in drops).

These adjustments will only be evident after at least 2 cups of coffee have been delivered. If this adjustment does not obtain the desired result, turn the dial another click.

Tips for a hotter coffee

For hotter coffee, you should:

- before delivering the coffee, perform a rinse cycle by pressing the button. Hot water is delivered from the spout, heating the internal circuits of the appliance and thus raising the coffee temperature;
- warm the cups with hot water (using the hot water function);
- enable the cup warmer in the settings menu and leave the cups until they are warm;
- raise the coffee temperature in the settings menu.

Making coffee using coffee beans



Important!

Do not use caramelised or candied coffee beans as they could stick to the coffee mill and damage it.

1. Fill the container with coffee beans (fig. 12).
2. Place under the coffee spouts:
 - 1 cup, if you want to make 1 coffee (fig. 9);
 - 2 cups, if you want 2 coffees (fig. 13);
3. Lower the spouts as near as possible to the cups. This makes a creamier coffee (fig. 14).
4. Press the button corresponding to the number of coffees required (1 cup or 2 cups) (figs. 10 or 13).
5. Preparation begins and information on the coffee selected is displayed.

Once the coffee has been made, the appliance is ready to make the next drink.



Please note :

- while the appliance is making coffee, the flow can be interrupted at any moment by pressing one of the coffee buttons.
- At the end of delivery, to increase the quantity of coffee in the cup, just press and hold one of the coffee buttons (within 3 seconds).



Please note :

For hotter coffee, see the section "Tips for a hotter coffee".



Important!

- If the coffee is delivered in drops, too weak and not creamy enough or too cold, read the tips in the "Troubleshooting" section (page 20).
- Various alarm messages could be displayed while using the machine. Their meaning is explained in the section "Displayed messages" (page 19).

Making coffee using pre-ground coffee



Important!

- Never place coffee beans in the pre-ground coffee funnel as this could damage the appliance.
- Never add pre-ground coffee when the machine is off or it could spread through the inside of the machine and dirty it. This could damage the appliance.
- Never use more than 1 level measure or it could dirty the inside of the coffee machine or block the funnel.



Please note :

When you use pre-ground coffee, you can only make one cup of coffee at a time.

1. Make sure the appliance is on.
2. Press the dial (fig. 7) repeatedly until "Pre-ground" is displayed.
3. Make sure the funnel is not blocked, then add one level measure of pre-ground coffee (fig. 15).
4. Place a cup under the coffee spouts.
5. Press the corresponding coffee button (or).
6. Preparation begins.

MAKING CAPPUCCINO AND MILK BASED COFFEES



Please note!

A few seconds may elapse between Energy saving and delivery of the first drink.

Filling and attaching the milk container

1. Lift the milk container lid (fig. 16).
2. Fill the milk container with a sufficient quantity of milk, not exceeding the MAX level (fig. 17).



Please note!

For a richer denser froth, use skimmed or partially skimmed milk at refrigerator temperature (about 5°C).

To avoid milk with poor froth or large bubbles, always clean the milk lid and hot water nozzle as described in the section "Cleaning the milk container" on page 16.

3. Make sure the milk intake tube is correctly inserted in the bottom of the milk container lid (fig. 18).
4. Attach the lid back on the milk container.
5. Attach the container to the nozzle, pushing as far as it will go (fig. 19).
6. Place a sufficiently large cup under the coffee spouts and frothed milk spout (fig. 20).
7. Follow the instructions below for each function.

Adjusting the amount of froth

Turn the froth adjustment dial on the milk container lid to adjust the amount of froth on the milk delivered while making milk drinks (fig. 21). Follow the tips in the table below:

Dial position	Description	Recommended for...
	No froth	CAFFELATTE / MILK (hot milk)
	Min. froth	LATTE MACCHIATO / FLAT WHITE
	Max. froth	CAPPUCCINO / MILK (frothed milk)

Making CAPPUCCINO

1. Press the **CAPPUCCINO** button.
2. After a few seconds, frothed milk is delivered from the milk spout into the cup below. Delivery of milk stops automatically and coffee delivery starts. A progress bar which fills gradually is displayed.

Making CAFFELATTE/MACCHIATO/FLAT WHITE/ MILK

1. Press the **MY MILK** button.
2. Turn the selection dial until the required drink is displayed (CAFFELATTE, MACCHIATO, FLAT WHITE, MILK);
3. Press the **MY MILK** button to confirm.
4. After a few seconds, milk is delivered from the milk spout into the cup below. Delivery of milk stops automatically and (if needed for the drink), coffee delivery starts. A progress bar which fills gradually is displayed.



Please note!

Milk or coffee delivery can be interrupted at any time by pressing the **CAPPUCCINO** or **MY MILK** button according to the drink selected.

Programming the quantities of coffee and milk in the cup

The appliance is set by default to automatically deliver standard quantities. To change these quantities, proceed as follows:

1. Place a cup under the coffee spouts and milk spout.

Programming cappuccino:

2. Hold the **CAPPUCCINO** button until the message "CAPPUCCINO PROGRAM MILK" is displayed.
3. The appliance starts delivering milk. Release the button.
4. Once the required quantity of milk has been delivered into the cup, press the **CAPPUCCINO** button again.
5. After a few seconds, the appliance starts delivering coffee into the cup and the message "CAPPUCCINO PROGRAM COFFEE" is displayed.
6. Once the required quantity of coffee has been delivered into the cup, press the **CAPPUCCINO** button.

Coffee delivery stops and the machine is "READY FOR USE" again.

This completes programming

Programming MY MILK drinks:

2. Press the **MY MILK** button.
3. Turn the selection dial until the drink you want to programme again is displayed (CAFFELATTE, MACCHIATO, FLAT WHITE, MILK);
4. Hold the **MY MILK** button until the message "(DRINK) PROGRAM MILK" is displayed.
5. The appliance starts delivering milk. Release the button.
6. Once the required quantity of milk has been delivered into the cup, press the button again.
7. After a few seconds, if required by the drink, the appliance starts delivering coffee into the cup and the message "(DRINK) PROGRAM COFFEE" is displayed.
8. Once the required quantity of coffee has been delivered into the cup, press the **MY MILK** button again.

Coffee delivery stops and the machine is "ready for use" again.

This completes programming.

CLEANING THE MILK CONTAINER AFTER USE



Important! Danger of burns

When cleaning the internal tubes of the milk container, a little hot water and steam leak out of the frothed milk spout.

Avoid contact with splashes of water.

After preparing a cappuccino or milk based drink, the machine must be cleaned to remove the milk residues. This panel displays the following message "Press Clean Button". Proceed as follows:

1. Leave the milk container in the machine (you do not need to empty it);
2. Place a cup or other recipient under the frothed milk spout.
3. Press the "CLEAN" button (fig. 22) and hold it until the progress bar which appears on the display together with the message "Cleaning underway" is complete.
4. Release the "CLEAN" button.
5. Remove the milk container and always clean the steam nozzle (A20) with a sponge.



Please note!

- To prepare a number of cappuccinos or milk based drinks, clean the milk container after you have prepared the last drink only.
- The milk container can be kept in the refrigerator.
- In some cases, to clean you must wait for the appliance to heat up.

HOT WATER



Danger of burns!

Never leave the machine unsupervised while hot water is being delivered. As shown below, stop delivery of hot water when the cup is full. The cappuccino maker becomes hot while water is being delivered and must be held by the handle only.

1. Make sure the hot water spout is attached correctly.
2. Place a container under the water spout (as close as possible to avoid splashes) (fig. 5).
3. Press the ☺ button.
4. Hot water delivery begins and then stops automatically. A progress bar fills gradually as preparation proceeds. To interrupt delivery of hot water manually, press the ☺ button again.



Please note :

If "Energy saving" mode is active, you may have to wait a few seconds before the hot water is delivered.

Changing the quantity of water delivered automatically

The machine is set by default to automatically deliver 250 ml of hot water.

To modify these quantities, proceed as follows:

1. Make sure the hot water spout is attached correctly.
2. Position a container under the spout.

3. Press and hold the ☺ button until "HOT WATER Program quantity" is displayed, then release.
4. When the hot water in the cup reaches the required level, press the ☺ button again.

The machine is now reprogrammed with the new quantity.

CLEANING

Cleaning the machine

The following parts of the machine must be cleaned regularly:

- coffee grounds container (A14),
- drip tray (A18) and condensate tray (A15),
- water tank (A10),
- coffee spouts (A13) and hot water nozzle (A20),
- pre-ground coffee funnel (A6),
- inside of the machine, accessible after opening the infuser door (A11),
- infuser (A12).
- milk container (D)



Important!

- Do not use solvents, abrasive detergents or alcohol to clean the coffee machine. With De'Longhi superautomatic bean to cup espresso and cappuccino machines, you need not use chemical products to clean the machine.
- None of the components can be washed in a dishwasher.
- Do not use metal objects to remove encrustations or coffee deposits as they could scratch metal or plastic surfaces.

Cleaning the coffee grounds container

When "EMPTY GROUNDS CONTAINER" is displayed, the grounds container must be emptied and cleaned.

Until the grounds container has been cleaned, the appliance continues to display the message and coffee cannot be made.

To clean (with the machine on):

- Remove the drip tray (fig. 23), empty and clean.
- Empty the grounds container and clean thoroughly to remove all residues left on the bottom.
- Check the condensate tray (red) and empty if necessary.



Important!

When removing the drip tray, the grounds container **must** be emptied, even if it contains few grounds.

If this is not done, when you make the next coffees, the grounds container may fill up more than expected and clog the machine.

Cleaning the drip tray and condensate tray



Important!

If the drip tray is not emptied regularly, the water could overflow from the edge and seep inside or around the machine. This could damage the machine, the surface it rests on or the

surrounding area.

The drip tray is fitted with a level indicator (red) showing the level of water it contains (fig. 24).

Before the indicator protrudes from the cup tray, the drip tray must be emptied and cleaned.

To remove the drip tray:

1. Remove the drip tray and grounds container (fig. 23);
2. Empty the drip tray and grounds container and wash them;
3. Check the red condensate tray and empty if necessary.
4. Replace the drip tray complete with grounds container.

Cleaning the inside of the coffee machine



Danger!

Before cleaning internal parts, the machine must be turned off (see "Turning off") and unplugged from the mains power supply. Never immerse the coffee machine in water.

1. Check regularly (about once a week) that the inside of the appliance (accessible after removing the drip tray) is not dirty. If necessary, remove coffee deposits with the brush supplied and a sponge.
2. Remove the residues with a vacuum cleaner (fig. 25).

Cleaning the water tank

1. Clean the water tank (A10) regularly (about once a month and whenever you replace the water softener filter (if provided) with a damp cloth and a little mild washing up liquid.
2. Remove the filter (if present) and rinse with running water.
3. Replace the filter (if provided), fill the tank with fresh water and replace the tank.

Cleaning the coffee spouts

1. Clean the coffee spouts with a sponge or cloth (fig. 26A).
2. Check the holes in the coffee spout are not blocked. If necessary, remove coffee deposits with a toothpick (fig. 26B).

Cleaning the pre-ground coffee funnel

Check regularly (about once a month) that the pre-ground coffee funnel (A6) is not blocked.

If necessary, remove coffee deposits with the brush supplied.

Cleaning the infuser

The infuser (A12) must be cleaned at least once a month.



Important!

The infuser may not be extracted when the machine is on.

1. Make sure the machine is correctly turned off (see "Turning off", page 9).

2. Remove the water tank.
3. Open the infuser door (fig. 27) on the right side of the appliance.
4. Press the two red release buttons inwards and at the same time pull the infuser outwards (fig. 28).



Important!

RINSE WITH WATER ONLY NO WASHING UP LIQUID - NO DISH WASHER

Clean the infuser without using washing up liquid as it could be damaged.

5. Soak the infuser in water for about 5 minutes, then rinse under the tap.
6. Use the brush to remove any coffee residues left in the infuser housing, visible through the infuser door.
7. After cleaning, replace the infuser by sliding it onto the internal support, then push the PUSH symbol fully in until it clicks into place.

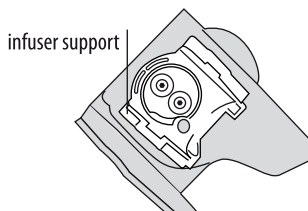

Please note :

If the infuser is difficult to insert, before insertion, adapt it to the right size by pressing the two levers shown in the figure.

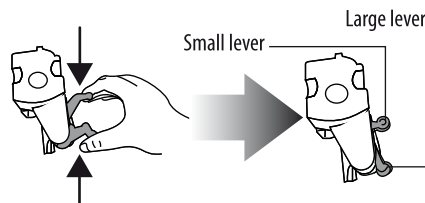

7. Once inserted, make sure the two red buttons have snapped out.

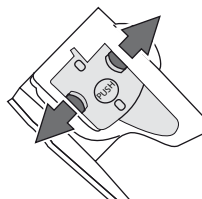

8. Close the infuser door.
9. Replace the water tank.

Cleaning the milk container

Clean the milk container each time you prepare milk as described below:

1. Remove the lid.
2. Remove the milk spout and intake tube.
3. Turn the froth adjustment dial clockwise to the "INSERT" position (see figure) and pull off upwards.

4. Wash all the components thoroughly with hot water and mild washing-up liquid. All components are dishwasher safe, placing them in the top basket of the dishwasher.

Make sure there are no milk residues on the hollow and groove under the dial (see figure alongside). If necessary, scrape the groove with a toothpick.

5. Rinse inside the froth adjustment dial seat with running water (see figure).
6. Check that the intake tube and spout are not clogged with milk residues.
7. Replace the dial (lining up the arrow with the word "INSERT"), the spout and the milk intake tube.
8. Place the lid back on the milk container.

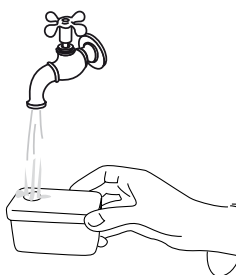
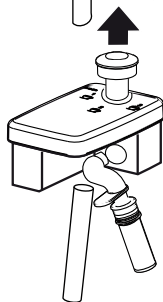
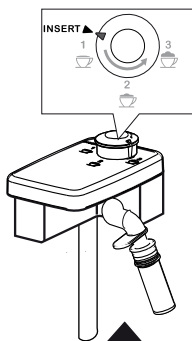

Cleaning the hot water/steam nozzle

Each time you prepare milk, clean the nozzle with a sponge to remove milk residues from the gaskets (see figure alongside).



DESCALING

Descal the machine when the message "DESCALE" flashes on the display.



Important!

Descaler contains acids which may irritate the skin and eyes. It is vital to respect the manufacturer's safety warnings given on the descaler pack and the warnings relating to the procedure to follow in the event of contact with the skin and eyes.



Please note:

Use descaler recommended by De'Longhi only.

Failure to descale the appliance as described also invalidates the guarantee.

1. Turn the coffee maker on.
2. Press the **MENU** button to enter the menu.
3. Turn the selection dial until "Descale" is displayed.
4. Select by pressing the button: "Descale Confirm?" is displayed. Press again to enable the function.
5. The message "Add descaler Confirm?" is displayed, alternating with "EMPTY DRIP TRAY".
6. Empty the water tank (A10) completely and remove the water softener filter (if present). Empty the drip tray (fig. 23) and grounds container, then put them back in the appliance.
7. Pour the descaler into the water tank up to the level **A** (corresponding to a 100 ml pack) marked on the back of the tank (fig. 29), then add water (1 litre) up to level **B** (fig. 29). Put the water tank back.
8. Place an empty container with a minimum capacity of 1.5 litres under the hot water spout (fig. 5).





Danger of burns!

Hot water containing acid flows out of the hot water spout. Avoid contact with splashes of water.

9. Press the button to confirm that you have added the solution.
10. The message "Descale please wait" is displayed. The descale programme starts and the descaler liquid comes out of the water spout. The descale programme automatically performs a series of rinses and pauses to remove limescale deposits from inside the machine.

After about 30 minutes, the message "FILL TANK" is displayed. The appliance is now ready for rinsing through with clean water.

11. Empty the container used to collect the descaler solution and replace it empty under the cappuccino maker.
12. Remove the water tank, empty, rinse under running water, fill with clean water and replace. "Rinsing Confirm?" is displayed.

13. Press the  button to start rinsing. Hot water flows out of the spout and the message "Rinsing" is displayed.
14. When the water tank is completely empty, the message "Descale complete Confirm?" is displayed.
15. Press the  button to confirm.
16. Insert the filter (if present previously) in the tank (see the section "Installing the filter, page 19). Fill the water tank again and the appliance is ready for use.

SETTING WATER HARDNESS

The DESCALE message is displayed after a period of time established according to water hardness.

The machine is set by default for a hardness value of 4.



The machine can also be programmed according to the hardness of the mains water in the various regions so that the machine needs to be descaled less often.

Measuring water hardness

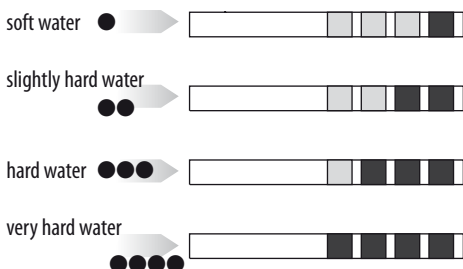
1. Remove the "TOTAL HARDNESS TEST" indicator paper attached to this manual from its pack.
2. Immerse the paper completely in a glass of water for one second.
3. Remove the paper from the water and shake lightly. After about a minute, 1, 2, 3 or 4 red squares appear, depending on the hardness of the water: each square corresponds to one level.



Set water hardness

1. Press the MENU button to enter the menu.
2. Turn the selection dial until "Water Hardness" is displayed;
3. Press the  button.
4. Turn the selection dial and set the number of squares measured by the indicator paper (see figure in previous paragraph).
5. Press the  button to confirm the setting.

The machine is now reprogrammed with the new water hardness setting. Press the **MENU** button to exit the menu.

WATER SOFTENER FILTER

Certain models are fitted with a water softener filter. If this is not the case with your model, you are recommended to purchase one from De'Longhi customer experience.

To use the filter correctly, follow the instructions below.

Installing the filter

1. Remove the filter from the packaging.
2. Turn the date indicator disk (see fig. 30) until the next two months of use are displayed.





Please note :

The filter lasts about two months if the appliance is used regularly. If the coffee machine is left unused with the filter installed, it will last a maximum of three weeks.

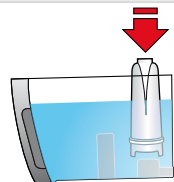
3. To activate the filter, run tap water through the hole in the filter as shown in the figure until water comes out of the openings at the side for more than a minute (fig. 31).
4. Extract the tank from the appliance and fill with water.
5. Insert the filter in the water tank and immerse it completely for about ten seconds, sloping it to enable the air bubbles to escape (fig. 32).
6. Insert the filter in the filter housing and press as far as it will go.
7. Close the tank with the lid, then put the tank back in the machine.



When you install the filter, you must notify the appliance of its presence.

8. Press the **MENU** button to enter the menu;
9. Turn the selection dial until "Install filter" is displayed;
10. Press the  button.
11. "Enable?" is displayed;
12. Press the  button to confirm the selection. "HOT WATER Confirm?" is displayed.
13. Position a container with a minimum capacity of 100 ml under the hot water spout.
14. Press the  button to confirm the selection. The appliance begins hot water delivery and the message "Please wait" is displayed.
15. After delivery, the appliance is automatically ready to make the next drink.

The new filter is active and indicated by an asterisk displayed under "Install filter" in the menu. You can now use the appliance.

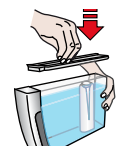

Replacing the filter

When "REPLACE FILTER" is displayed, or after two months (see date indicator) or when the appliance has not been used for 3 weeks, you should replace the filter:

1. Extract the tank and exhausted filter;
2. Remove the new filter from the packaging and proceed as described in points 3, 4, 5, 6 and 7 in the previous section.
3. Position a container with a minimum capacity of 100 ml under the spout.
4. Press the **MENU** button to enter the menu;
5. Turn the selection dial until "Replace filter" is displayed.
10. Press the button.
11. Confirm?" is displayed.
12. Press the button to confirm the selection.
13. "HOT WATER Confirm?" is displayed.
14. Press the button to confirm the selection. The appliance begins hot water delivery and the message "Please wait" is displayed.
15. After delivery, the appliance is automatically ready to make the next drink.

The new filter is now active and you can use the coffee machine.

Removing the filter

If you want to use the appliance without the filter, you must remove it and notify the appliance of its removal. Proceed as follows:

1. Extract the tank and exhausted filter;
2. Press the **MENU** button to enter the menu;
3. Turn the selection dial until "Remove filter" is displayed;
4. Press the button.
5. "Confirm?" is displayed;
6. Press the button to confirm and the button to exit the menu.

TECHNICAL DATA

Voltage:	220-240 V ~ 50/60 Hz max. 10A
Absorbed power:	1450W
Pressure:	15 bar
Max. water tank capacity:	1,8 litres
Size: LxHxD:	238x345x430 mm
Cable length:	1,15 m
Weight:	9,1 Kg
Max. beans container capacity	250 g

The appliance complies with the following EC directives:

- EC Regulation 1275/2008 for standby;
- Low Voltage Directive 2006/95/EC and subsequent amendments;

- EMC Directive 2004/108/EC and subsequent amendments
- Materials and accessories coming into contact with food conform to EC regulation 1935/2004.

DISPOSAL



In compliance with European directive 2002/96/EC, the appliance must not be disposed of with household waste, but taken to an authorised waste separation and recycling centre.

ELECTRICAL REQUIREMENTS

Before using this appliance ensure that the voltage indicated on the product corresponds with the main voltage in your home, if you are in any doubt about your supply contact your local electricity company. The flexible mains lead is supplied connected to a B.S. 1363 fused plug having a fuse of 13 amp capacity. Should this plug not fit the socket outlets in your home, it should be cut off and replaced with a suitable plug, following the procedure outlined below. Note: Such a plug cannot be used for any other appliance and should therefore be properly disposed of and not left where children might find it and plug it into a supply socket - with the obvious consequent danger. N.B. We recommend the use of good quality plugs and wall sockets that can be switched off when the machine is not in use.

IMPORTANT: the wires in the mains lead fitted to this appliance are coloured in accordance with the following code:



As the colours of the wires in the mains lead of this appliance may not correspond with the coloured markings identifying the terminals in your plug, proceed as follows:

- The wire which is coloured green and yellow must be connected to the terminal in the plug which is marked with the letter E or by the earth symbol or coloured green or green and yellow.
- The wire which is coloured blue must be connected to the terminal which is marked with the letter N or coloured black.
- The wire which is coloured brown must be connected to the terminal which is marked with the letter L or coloured red.

When wiring the plug, ensure that all strands of wire are securely retained in each terminal. Do not forget to tighten the mains lead clamp on the plug. If your electricity supply point has only two pin socket outlets, or if you are in doubt, consult a qualified electrician. Should the mains lead ever require replacement, it is essential that this operation be carried out by a qualified electrician and should only be replaced with a flexible cord of the same size. After replacement of a fuse in the plug, the fuse cover must be refitted. If the fuse cover is lost, the plug must not be used until a replacement cover is obtained. The colour of the correct replacement fuse cover is that of the coloured insert in the base of the fuse recess or elsewhere on the plug. Always state this colour when ordering a replacement fuse cover. Only 13amp replacement fuses which are as approved to B.S. 1362 should be fitted. This appliance conforms to the Norms EN 55014 regarding the suppression of radio interference.

Warning - this appliance must be earthed

DISPLAYED MESSAGES

DISPLAYED MESSAGE	POSSIBLE CAUSE	SOLUTION
FILL TANK	There is not enough water in the tank.	Fill the tank with water and/or insert it correctly, pushing it as far as it will go until it clicks into place (fig. 4).
EMPTY GROUNDS CONTAINER	The grounds container (A13) is full.	Empty the grounds container and drip tray, clean and replace (fig. 23). Important: when removing the drip tray, the grounds container must be emptied, even if it contains few grounds. If this is not done, when you make the next coffees, the grounds container may fill up more than expected and clog the machine.
GROUND TOO FINE ADJUST MILL	The grinding is too fine and the coffee is delivered too slowly or not at all.	Repeat coffee delivery and turn the grinding adjustment dial (fig. 11) one click clockwise towards "7" while the coffee mill is in operation. If after making at least 2 coffees delivery is still too slow, repeat the correction procedure, turning the grinding adjustment dial another click until delivery is correct (see the section: "Adjusting the coffee mill on page 12).
INSERT GROUNDS CONTAINER	After cleaning, the grounds container has not been replaced.	Estrarre la vaschetta raccogliogocce e inserire il contenitore dei fondi.
ADD PRE-GROUND COFFEE	With the "pre-ground coffee" function selected, pre-ground coffee has not been poured into the funnel.	Place pre-ground coffee in the funnel or deselect the "pre-ground" function.
DESCALE	The machine must be descaled.	The descaling procedure described in the section "Descaling" needs to be performed as soon as possible (page 17).
REDUCE COFFEE AMOUNT	Too much coffee has been used.	Select a milder taste or reduce the quantity of pre-ground coffee.
FILL BEANS CONTAINER	The coffee beans have run out.	Fill the beans container.
	The pre-ground coffee funnel is clogged.	Empty the funnel with the help of a brush, as described in the section "Cleaning the pre-ground coffee funnel".
INSERT INFUSER ASSEMBLY	The infuser has not been replaced after cleaning.	Insert the infuser as described in the paragraph "Cleaning the infuser" (page 16).
INSERT TANK	The tank is not correctly in place.	Insert the tank correctly and press as far as it will go.
GENERAL ALARM	The inside of the appliance is very dirty.	Clean the inside of the appliance thoroughly, as described in the section "Cleaning" (page 15). If the message is still displayed after cleaning, contact customer services.
REPLACE FILTER	The water softener filter is exhausted.	Replace the filter or remove it as described in the section "Water softener filter" (page 18).
WATER CIRCUIT EMPTY FILL WATER CIRCUIT <i>alternating with...</i> HOT WATER CONFIRM?	The water circuit is empty.	Press OK to deliver water from the spout until it flows out normally.
Press CLEAN	Milk has been delivered recently and the tubes inside the milk container must be cleaned.	Press the CLEAN button (fig. 22) and keep it pressed until the progress bar displayed together with the message "Cleaning underway" is complete.
INSERT WATER SPOUT	The water spout is not inserted or is inserted incorrectly.	Insert the water spout (C3) as far as it will go.
INSERT MILK CONTAINER	The milk container is not inserted correctly.	Insert the milk container (fig. 19) as far as it will go.

TROUBLESHOOTING

Below is a list of some of the possible malfunctions.

If the problem cannot be resolved as described, contact customer services.

POSSIBLE PROBLEM	CAUSE	SOLUTION
The coffee is not hot.	The cups were not preheated.	Warm the cups by rinsing them with hot water (please note: you can use the hot water function). Enable the cup warmer, leave the cups at least 20 minutes to warm up.
	The infuser has cooled down because 2/3 minutes have elapsed since the last coffee was made.	Before making coffee, heat the infuser by pressing the  button.
	A low coffee temperature is set.	Set a high coffee temperature in the menu.
The coffee is weak or not creamy enough.	The coffee is ground too coarsely.	Turn the grinding adjustment dial one click anticlockwise towards "1" while the coffee mill is in operation (fig. 11). Continue one click at a time until coffee delivery is satisfactory. The effect is only visible after delivering 2 coffees (see the section: "Adjusting the coffee mill" on page 12).
	The coffee is unsuitable.	Use pre-ground coffee for espresso machines only.
The coffee is delivered too slowly or in drops.	The coffee is ground too finely.	Turn the grinding adjustment dial one click clockwise towards "7" while the coffee mill is in operation (fig. 11). Continue one click at a time until coffee delivery is satisfactory. The effect is only visible after delivering 2 coffees (see the section: "Adjusting the coffee mill" on page 12).
Coffee does not come out of one or both of the spouts.	The spouts are blocked.	Clean the spouts with a toothpick.
The milk does not come out of the milk spout.	The milk container lid is dirty.	Clean the milk container lid as described in the section "Cleaning the milk container".
The milk contains large bubbles and squirts out of the milk spout or there is little froth.	The milk is not cold enough or is not semi-skimmed.	Use skimmed or semi-skimmed milk at refrigerator temperature (about 5° C). If the result is not as you wished, try changing brand of milk.
	The froth adjustment dial is incorrectly adjusted.	Adjust following the instructions in the section "Making drinks with milkcappuccino and milk based drinks".
	The milk container lid or froth adjustment dial are dirty	Clean the milk container lid and dial as described in the section "Cleaning the milk container".
	The hot water/steam nozzle is dirty	Clean the nozzle as described in the section "Cleaning the hot water/steam nozzle".
The appliance does not come on.	It is not plugged into the mains socket.	Plug into the mains socket.
	The connector is not inserted fully in the socket.	Make sure the connector is correctly connected.
	The main switch (A8) is not turned on.	Press the main switch (fig. 1).