



De'Longhi Appliances
via Seitz, 47
31100 Treviso Italia

BEAN TO CUP ESPRESSO AND CAPPUCCINO MACHINE

Instruction for use



ELECTRICAL REQUIREMENTS

Before using this appliance ensure that the voltage indicated on the product corresponds with the main voltage in your home, if you are in any doubt about your supply contact your local electricity company.

The flexible mains lead is supplied connected to a B.S. 1363 fused plug having a fuse of 13 amp capacity.

Should this plug not fit the socket outlets in your home, it should be cut off and replaced with a suitable plug, following the procedure outlined below.

Note: Such a plug cannot be used for any other appliance and should therefore be properly disposed of and not left where children might find it and plug it into a supply socket - with the obvious consequent danger.

N.B. We recommend the use of good quality plugs and wall sockets that can be switched off when the machine is not in use.

IMPORTANT: the wires in the mains lead fitted to this appliance are coloured in accordance with the following code:

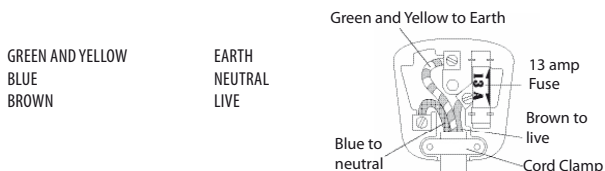

As the colours of the wires in the mains lead of this appliance may not correspond with the coloured markings identifying the terminals in your plug, proceed as follows:

- The wire which is coloured green and yellow must be connected to the terminal in the plug which is marked with the letter E or by the earth symbol  or coloured green or green and yellow.
- The wire which is coloured blue must be connected to the terminal which is marked with the letter N or coloured black.
- The wire which is coloured brown must be connected to the terminal which is marked with the letter L or coloured red.

When wiring the plug, ensure that all strands of wire are securely retained in each terminal. Do not forget to tighten the mains lead clamp on the plug. If your electricity supply point has only two pin socket outlets, or if you are in doubt, consult a qualified electrician.

Should the mains lead ever require replacement, it is essential that this operation be carried out by a qualified electrician and should only be replaced with a flexible cord of the same size.

After replacement of a fuse in the plug, the fuse cover must be refitted. If the fuse cover is lost, the plug must not be used until a replacement cover is obtained. The colour of the correct replacement fuse cover is that of the coloured insert in the base of the fuse recess or elsewhere on the plug. Always state this colour when ordering a replacement fuse cover.

Only 13amp replacement fuses which are approved to B.S. 1362 should be fitted.

This appliance conforms to the Norms EN 55014 regarding the suppression of radio interference.

Warning - this appliance must be earthed

DESCRIPTION OF APPLIANCE

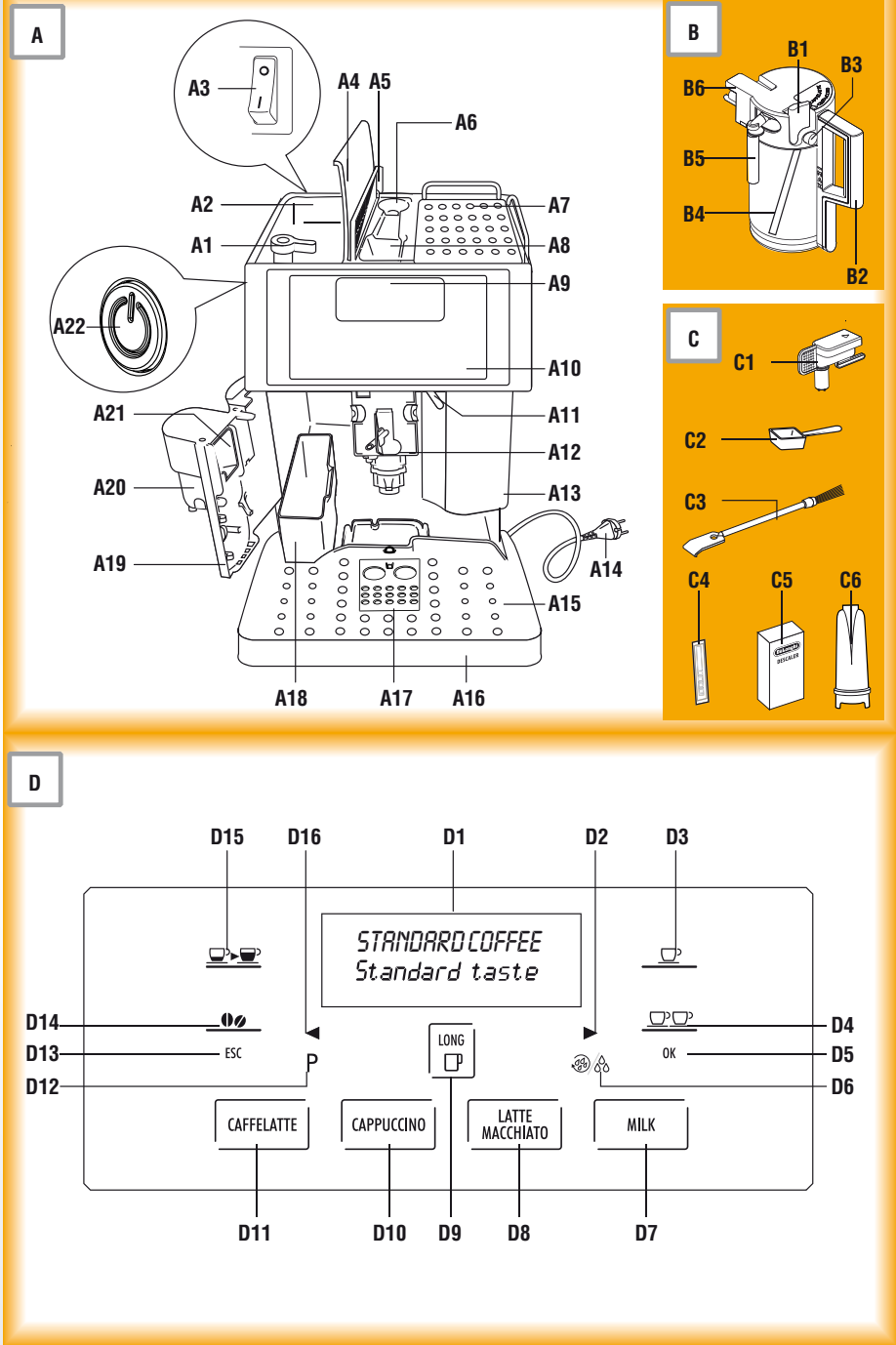

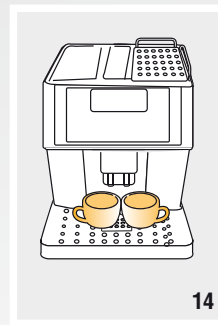
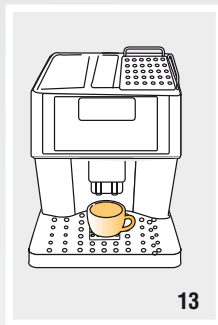
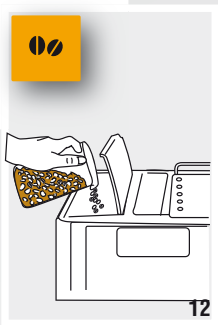
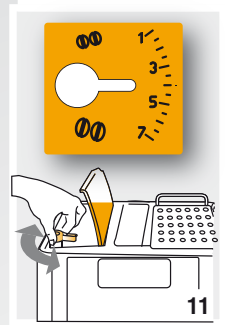
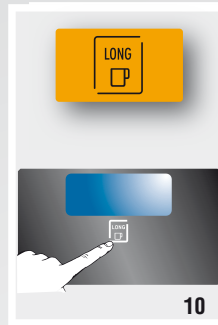
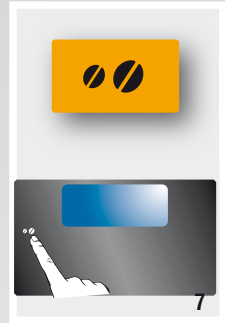
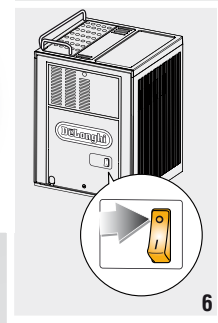
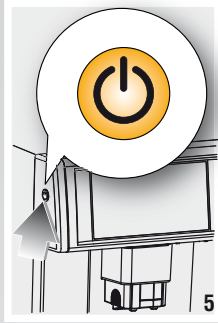
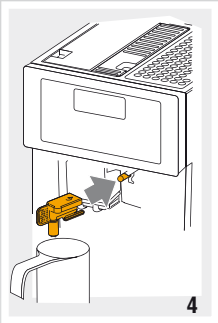
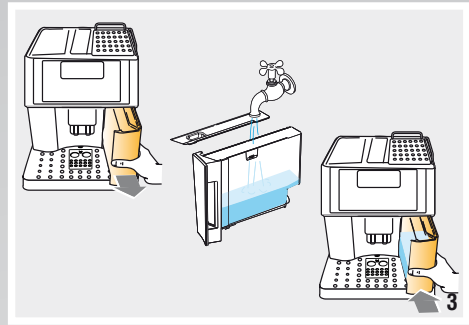
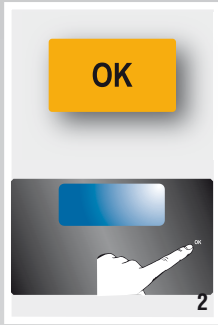
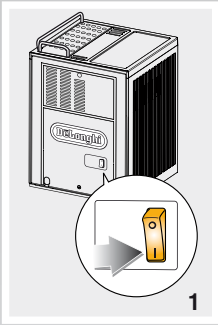

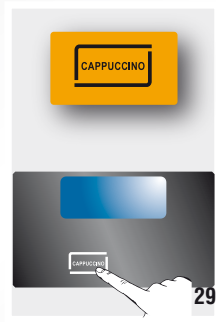
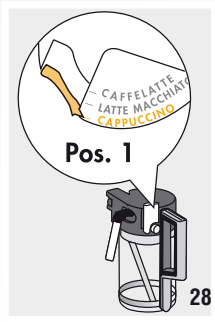
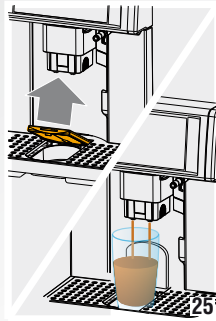
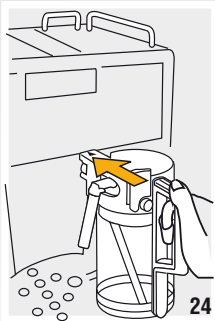
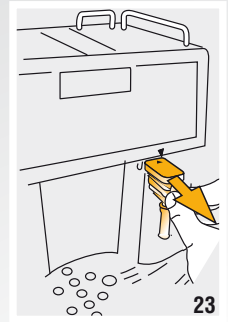
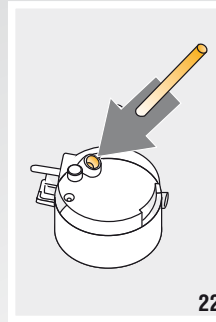
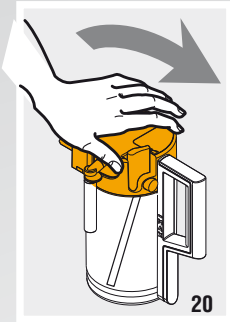
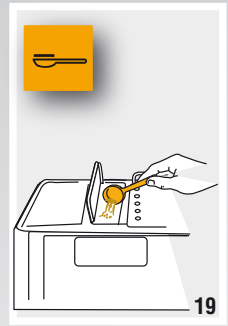
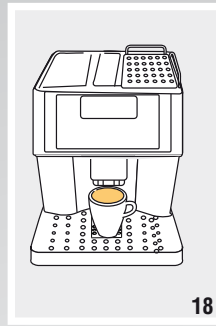
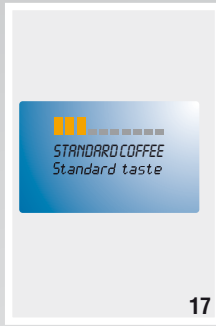

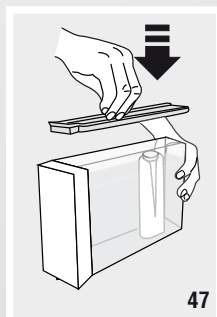
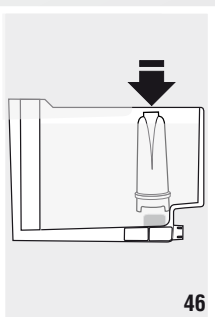
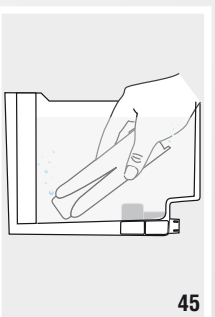
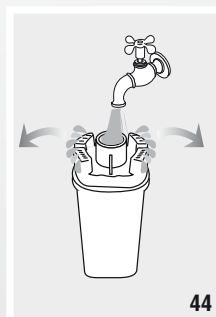
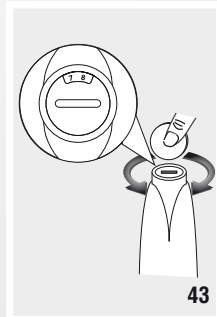
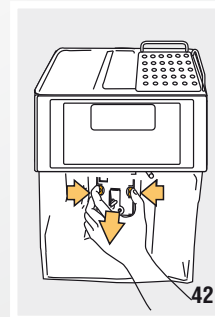
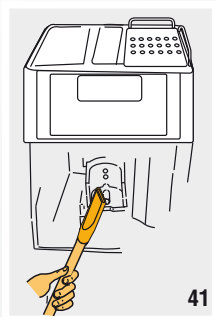
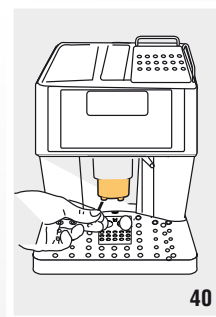
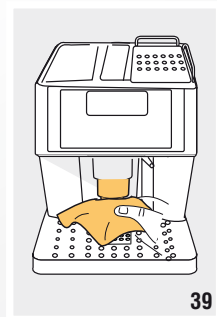
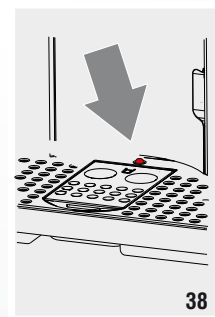
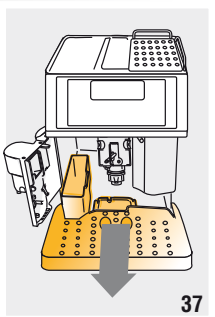
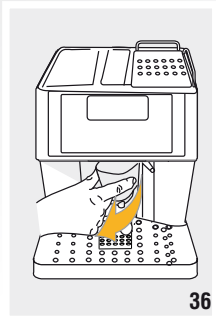
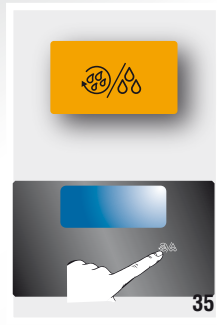
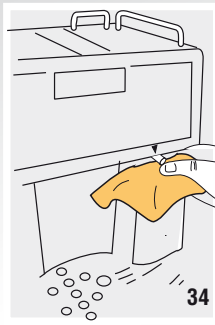
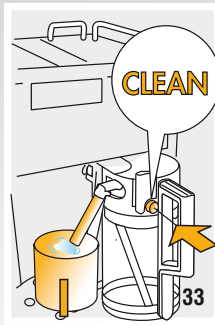

CONTENTS

ELECTRICAL REQUIREMENTS	2
DESCRIPTION OF APPLIANCE	3
INTRODUCTION	8
Symbols used in these instructions	8
Letters in brackets	8
Troubleshooting and repairs	8
SAFETY	8
Fundamental safety warnings	8
DESIGNATED USE	9
INSTRUCTIONS	9
DESCRIPTION	9
Description of the appliance	9
Description of milk container	9
Description of control panel (touch screen)	9
PRELIMINARY CHECKS	10
Checking the appliance	10
Installing the appliance	10
Connecting the appliance	10
Using the coffee maker for the first time	10
TURNING THE APPLIANCE ON	11
TURNING THE APPLIANCE OFF	11
MENU SETTINGS	11
Descaling	11
Setting the language	11
Energy Saving	11
Adjust time	12
Auto-start	12
Auto-off (Stand by)	12
Coffee temperature	12
Beep	13
Statistics function	13
Default values (reset)	13
MAKING COFFEE	13
Selecting the coffee taste	13
Selecting the quantity of coffee in the cup	13
Customising the espresso "my coffee" quantity	13
Programming the long "my coffee" quantity	14
Regulating the coffee mill	14
Tips for a hotter coffee:	14
Preparing espresso coffee using coffee beans	14
Making long coffee using coffee beans	15
Making espresso or long coffee using pre-ground coffee	15
MAKING DRINKS WITH MILK.....	15
Filling and attaching the milk container	15
Making caffe latte	16
Making cappuccino	16
Making macchiato	16
Making milk	16
Cleaning the milk container after use	16
Programming the quantities of coffee and milk in the cup	17
HOT WATER	17
Preparation	17
Changing the quantity	17
CLEANING	18
Cleaning the coffee maker	18
Cleaning the coffee grounds container	18
Cleaning the drip tray	18
Cleaning the inside of the machine	18
Cleaning the water tank	19
Cleaning the coffee spouts	19
Cleaning the pre-ground coffee funnel	19
Cleaning the infuser	19
Cleaning the milk container	19
DESCALING.....	20
SETTING WATER HARDNESS	20
Measuring water hardness	20
Set water hardness	21
TECHNICAL SPECIFICATION.....	21
DISPOSAL.....	21
DISPLAYED MESSAGES	22
TROUBLESHOOTING	23

INTRODUCTION

Thank you for choosing this coffee machine. To get the very best out of your new coffee machine it is advisable to read these instructions before using the appliance. This is the only way to ensure optimum results and maximum safety. The manufacturer is not liable for damage deriving from the failure to comply with the user instructions.

Symbols used in these instructions

Important warnings are identified by these symbols. These warnings must absolutely be respected.

Danger!

Failure to observe the warning could result in possible life threatening injury from electric shock.

Important!

Failure to observe the warning could result in injury or damage to the appliance.

Danger of burns!

Failure to observe the warning could result in scalds or burns.

Please note:

This symbol identifies important advice or information for the user.

Letters in brackets

The letters in brackets refer to the legend in the Description of the Appliance on page 3.

Troubleshooting and repairs

In the event of problems, first try and resolve them following the information given in the section "Displayed messages" on page 21 and "Troubleshooting" on page 22

If this does not resolve the problem or you require further information, you should consult Customer Services. Please see enclosed guarantee leaflet.

If repairs are required, contact De'Longhi Customer Services only.

The addresses are given in the guarantee certificate provided with the appliance.

SAFETY

Fundamental safety warnings



Danger!

This is an electrical appliance and may cause electric shock.

You should therefore respect the following safety warnings:

- Never touch the appliance with damp hands.
- Never touch the plug with damp hands.
- Make sure the socket used is freely accessible at all times, enabling the appliance to be unplugged when necessary.

- Unplug directly from the plug only. Never pull the power cable as you could damage it.
- To disconnect the appliance completely, place the main switch at the back of the appliance in the 0 position.
- If the appliance is faulty, do not attempt to repair. Turn it off, unplug from the mains socket and contact Customer Services. Please see enclosed guarantee leaflet.
- If the plug or power cable is damaged, it must be replaced by De'Longhi Customer Services only to avoid all risk. Please see enclosed guarantee leaflet.



Important!

Keep all packaging (plastic bags, polystyrene foam) away from children.



Important!

The appliance is not intended for use by persons (including children) with reduced physical, sensory or mental capabilities, or lack of experience and knowledge, unless they have been given supervision or instruction concerning use of the appliance by a person responsible for their safety. Children must be supervised to ensure they do not play with the appliance.



Danger of burns!

This appliance produces hot water and steam may form while it is in operation.

Avoid contact with splashes of water or hot steam.

When the appliance is in operation, please be aware that the cup warmer shelf (A7) becomes hot.

DESIGNATED USE

This appliance is designed and made to prepare coffee and heat drinks.

All other use is considered improper.

This appliance is not suitable for commercial use.

The manufacturer is not liable for damage deriving from improper use of the appliance.

This is a household appliance only.

It is not suitable for use in:

- staff kitchen areas in shops, offices and other working environments;
- farm houses;
- by clients in hotels, motels and other residential type environments;
- bed and breakfast type environments.

INSTRUCTIONS

Read these instructions carefully before using the appliance.

- Failure to follow these instructions may result in burns or damage to the appliance.

The manufacturer is not liable for damage deriving from

failure to respect these instructions.

Please note:

Keep these instructions. If the appliance is passed to other persons, they must also be provided with these instructions.

DESCRIPTION

Description of the appliance

(page 3 - **A**)

- A1. Grinding adjustment knob
- A2. Beans container
- A3. Main switch
- A4. Beans container lid
- A5. Cover for funnel and measure compartment
- A6. Measure compartment
- A7. Cup shelf (cup warmer active when Energy Saving is disabled)
- A8. Pre-ground coffee funnel
- A9. Display
- A10. Touch screen (control panel)
- A11. Hot water and steam nozzle
- A12. Infuser
- A13. Water tank
- A14. Power cable
- A15. Cup tray
- A16. Drip tray
- A17. Compartment for macchiato/caffelatte glass
- A18. Grounds tray
- A19. Service door
- A20. Coffee spout (adjustable height)
- A21. Coffee guide
- A22. ON/STAND-BY button

Description of milk container

(page 3 - **B**)

- B1. Froth regulator
- B2. Milk container handle
- B3. CLEAN button
- B4. Milk intake tube
- B5. Frothed milk spout
- B6. Lid with milk frother

Description of the accessories















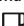

(page 3 - **C**)

- C1. Hot water spout
- C2. Measure
- C3. Cleaning brush
- C4. Indicator paper (total hardness test)
- C5. Descaler
- C6. Water softener filter

Description of control panel (touch screen)

(page 3 - **D**)

Only the icons relating to the controls enabled for the particular function currently being used will be lit on the control panel.

- D1.  Display: guides the user in using the appliance.
- D2.  icon: to scroll forwards through the programming menu.
- D3.  icon: to deliver one cup of espresso coffee.
- D4.  icon: to deliver two cups of espresso coffee.
- D5.  **OK** icon: to enable and confirm the selected function.
- D6.  icon: to rinse or deliver hot water.
- D7.  **MILK** icon: to deliver a cup of milk.
- D8.  **LATTE MACCHIATO** icon: to deliver a cup of macchiato.
- D9.  **LONG** icon: to deliver a cup of LONG coffee.
- D10.  **CAPPUCCINO** icon: to deliver a cappuccino.
- D11.  **CAFFELATTE** icon: to deliver a caffelatte.
- D12.  **P** icon: to access the Programming menu.
- D13.  **ESC** icon: to exit the selected function.
- D14.  icon: to select the coffee taste.
- D15.  icon: to select the coffee quantity.
- D16.  icon: to scroll backwards through the programming menu.



Please note :

A light touch is enough to activate the icon.

PRELIMINARY CHECKS

Checking the appliance

After removing the packaging, make sure the product is complete and undamaged and that all accessories are present. Do not use the appliance if it is visibly damaged. Contact Customer Services (see enclosed guarantee leaflet).

Installing the appliance



Important!

When you install the appliance, you should follow the following safety warnings:

- The appliance gives off heat. After positioning the appliance on the worktop, leave a space of at least 3 cm between the surfaces of the appliance and the side and rear walls and at least 15 cm above the coffee maker.
- Water penetrating the appliance could cause damage. Do not place the appliance near taps or sinks.
- The appliance could be damaged if the water it contains freezes. Do not install the appliance in a room where the temperature could drop below freezing point.
- Arrange the power cable in such a way that it cannot be damaged by sharp edges or contact with hot surfaces (e.g. electric hot plates).

Connecting the appliance



Important!

Check that the mains power supply voltage corresponds to the value indicated on the rating plate on the bottom of the appliance.

Connect the appliance to an efficiently earthed and correctly installed socket with a minimum current rating of 10A only. If the power socket does not match the plug on the appliance, have the socket replaced with a suitable type by a qualified professional.

Using the coffee maker for the first time



Please note:

- Coffee has been used to factory test the appliance and it is therefore completely normal for there to be traces of coffee in the mill.
The machine is, however, guaranteed to be new.
 - You should customise water hardness as soon as possible following the instructions in the section "Setting water hardness" on page 18.
1. Plug the appliance into the mains socket and place the main switch on the back of the appliance in the I position (fig. 1).

You must first choose the language (the languages scroll through at intervals of about 3 seconds).

2. When English appears, press the OK icon for a few seconds (fig. 2). Once the language has been saved, the message "English set" is displayed.

Follow the instructions indicated by the appliance:

3. "FILL TANK!": remove the water tank, fill to the MAX line with fresh water then replace in the appliance (fig. 3).
4. "Insert water spout and press OK!": Check that the hot water spout is inserted on the nozzle and place a container with a minimum capacity of 100 ml underneath (fig. 4).
Press the **OK** icon (fig. 2).
"Please wait." is displayed and the appliance begins to deliver water from the hot water spout. This is priming the water system. (It is normal for the machine to make some noise).

The appliance ends the first start up procedure, then the message "Turning off, Please wait" is displayed and the appliance goes off.

The coffee maker is now ready for normal use.



Please note:

- When using the appliance for the first time, you need to make 4/5 cups of coffee or 4/5 cappuccinos before the appliance starts to give satisfactory results.

TURNING THE APPLIANCE ON



Please note:

Before turning the appliance on, make sure the main switch on the back of the appliance is in the I position (fig. 1).

After setting up the appliance, each time the appliance is turned on, it performs an automatic preheat and rinse cycle which cannot be interrupted.

The appliance is ready for use only after completion of this cycle.



Danger of burns!

During rinsing, a little hot water is delivered from the coffee spouts and collected in the drip tray underneath.

Avoid contact with splashes of water.

- To turn the appliance on, press the  button (fig. 5).
The message "Heating up, Please wait..." is displayed.
After heating, the message "Rinsing..." is displayed. As well as heating the boiler, the appliance also heats the internal circuits by circulating hot water.
The appliance is at temperature when the message "STANDARD COFFEE" "Standard taste" is displayed.

TURNING THE APPLIANCE OFF

Each time the appliance is turned off, it performs an automatic rinse cycle which cannot be interrupted.



Important!

To avoid damaging the appliance, always press the  button (fig. 5) to turn off.



Danger of burns!

During rinsing, a little hot water is delivered from the coffee spouts.

Avoid contact with splashes of water.

- To turn the appliance off, press the  button (fig. 5).
The appliance performs the rinse cycle then goes off.



Please note:

If the appliance is not used for an extended period, place the main switch in the 0 position (fig. 6).

Never place the main switch in the 0 position while the appliance is on.

MENU SETTINGS

When you access the programming menu by pressing the **P** button, the following menu items are available: Descale, Set language, Energy Saving, Adjust time, Auto-start, Auto-off, Coffee temperature, Water hardness, Water filter, Beep, Statistics, Default values.

Descaling

For instructions on descaling, see page 21.

Setting the language

To modify the language on the display, proceed as follows:

1. Press the **P** icon to enter the programming menu;
2. Press the ◀ or ▶ icon until “Set language” is displayed;
3. Press the **OK** icon;
4. Press the ◀ or ▶ icon until the required language is displayed;
5. Press the **OK** icon to confirm;
6. Press the **ESC** icon to exit the menu.

Energy Saving

Use this function to enable or disable energy saving mode. When enabled, the function reduces energy consumption in compliance with European regulations.

1. Press the **P** icon to enter the programming menu;
2. Press the ◀ or ▶ icon until “Energy saving” is displayed;
3. Press the **OK** icon. “Disable?” is displayed, or “Enable?” if the function has already been disabled.
4. Press the **OK** icon to disable or enable the function or **ESC** to exit the menu.

When the function is enabled, if the appliance is not used for about 1 minute, “Energy Saving” is displayed.



Please note!

- A few seconds may elapse between “Energy Saving” mode and delivery of the first drink. This is indicated by the rapid increase then decrease of the progress bar and display of the message “Preparation underway”.
- When “Energy Saving” is disabled, the appliance turns the cup warmer on automatically.

Adjust time

To adjust the time on the display, proceed as follows:

1. Press the **P** icon to enter the programming menu;
2. Press the ◀ or ▶ icon until “Adjust time” is displayed;
3. Press the **OK** icon: the hours flash on the display;
4. Press the ◀ or ▶ icon to change the hours;
5. Press the **OK** icon to confirm. The minutes flash on the display;
6. Press the ◀ or ▶ icon to change the minutes;
7. Press the **OK** icon to confirm;
8. Press the **ESC** icon to exit the programming menu.

Auto-start

You can set the auto-start time in order to have the appliance ready at a certain time (for example in the morning) so you can make coffee immediately.



Please note!

To enable this function, **the time must be set correctly.**

1. Press the **P** icon to enter the programming menu;
2. Press the ◀ or ▶ icon until “Auto-start Disabled” is displayed;
3. Press the **OK** icon. “Enable?” is displayed;
4. Press the ◀ or ▶ icon to choose the hours;
5. Press the **OK** icon to confirm. The minutes flash on the display;
6. Press the ◀ or ▶ icon to change the minutes;
7. Press the **OK** icon to confirm. “Auto-start Enabled” is displayed.
8. Press the **ESC** icon to exit the menu. The  symbol appears next to the clock to indicate that auto-start has been programmed.

To disable the function:

1. Press the **P** icon to enter the programming menu;
2. Press the ◀ or ▶ icon until “Auto-start Enabled” is displayed;
3. Press the **OK** icon. “Disable?” is displayed;
4. Press the **OK** icon to confirm;
5. Press the **ESC** icon to exit the menu. The  symbol is no longer displayed.

Auto-off (Stand by)

Auto-off can be changed so that the appliance goes off after 15 or 30 minutes, or after 1, 2 or 3 hours.

1. Press the **P** icon to enter the programming menu;
2. Press the ◀ or ▶ icon until “Auto-off” is displayed;
3. Press the **OK** icon;
4. Press the ◀ or ▶ icon until the required time appears (15 or 30 minutes, or 1, 2 or 3 hours);
5. Press the **OK** icon to confirm;
6. Press the **ESC** icon to exit the menu.

Auto-off is programmed.

Coffee temperature

To modify the temperature of the water used to make the coffee, proceed as follows:

1. Press the **P** icon to enter the programming menu;
2. Press the ◀ or ▶ icon until “Coffee temperature” is displayed;
3. Press the **OK** icon;
4. Press the ◀ or ▶ icon until the required temperature (● = low; ●●●● = high) is displayed;
5. Press the **OK** icon to confirm;
6. Press the **ESC** icon to exit the menu.

Setting water hardness

For instructions on setting water hardness, see page 21.

Install filter

For instructions on the water filter, see page 20.

Beep

This enables or disables the beep emitted by the machine each time an icon is pressed or an accessory is inserted/removed. The beep is active by default.

1. Press the **P** button to enter the menu;
2. Press the ◀ or ▶ icon until "Beep enabled" is displayed;
3. Press the **OK** icon. "Disable?" is displayed;
4. Press the **OK** icon to disable the beep. "Beep Disabled" is displayed;
5. Press the **ESC** icon to exit the programming menu.

Statistics function

This displays statistics relating to the machine.

To display, proceed as follows:

1. Press the **P** icon to enter the programming menu;
2. Press the ◀ or ▶ icon until "Statistics" is displayed;
3. Press the **OK** icon;
4. By pressing the ◀ or ▶ icon, you can check:
 - how many coffees have been made;
 - the total of drinks with milk made (CAPPUCCINO, MACCHIATO, CAFFELATTE, MILK);
 - how many times the machine has been descaled;
 - the total number of litres of water delivered;
 - how many filters have been used.
5. Press the **ESC** icon twice to exit the menu.

Default values (reset)

This resets all menu settings and programmed quantities back to the default values (with the exception of the language which remains as set).

1. Press the **P** icon to enter the menu;
2. Press the ◀ or ▶ icon until "Default Values" is displayed;
3. Press the **OK** icon;
4. The message "Confirm?" is now displayed.
5. Press the **OK** icon to confirm and exit.

MAKING COFFEE

Selecting the coffee taste

The appliance is set by default to make coffee with a standard taste.

You can choose one of these tastes:

Extra-mild taste

Mild taste

Standard taste

Strong taste

Extra-strong taste

To change the taste, press the  icon (fig. 7) repeatedly until the required taste is displayed.

Selecting the quantity of coffee in the cup



The appliance is set by default to make a standard quantity of coffee.

To select the quantity of coffee, press the  icon (fig. 8) repeatedly until the message corresponding to the required quantity of coffee is displayed:

Corresponding coffee	ESPRESSO (ml)	LONG COFFEE (ml)
MY COFFEE	program. from 20 to 180	program. from 20 to 250
SHORT	≈40	≈ 125
STANDARD	≈60	≈ 175
LONG	≈90	≈ 210
EXTRA LONG	≈120	≈ 250

Customising the espresso "my coffee" quantity

The appliance is set by default to automatically deliver 30 ml of "my coffee". To modify these settings, proceed as follows: The appliance is set by default to automatically deliver 30 ml of "my coffee". To modify these settings, proceed as follows:

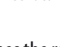
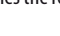
1. Place a cup under the coffee spouts (fig. 13).
2. Press the  icon repeatedly (fig. 8) until "MY COFFEE" is displayed.
3. Press and hold the  icon until "Program Quantity" is displayed, then release. The appliance starts delivering coffee and the  icon flashes;
4. As soon as the coffee in the cup reaches the required level, press the  icon again.

The quantity set has now been programmed.

Programming the long "my coffee" quantity

The appliance is set by default to automatically deliver about 100ml of LONG coffee.

To modify this quantity, proceed as follows:

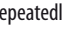
1. Place a cup under the coffee spouts (fig. 18).
2. Press the  icon repeatedly (fig. 8) until "MY COFFEE" is displayed.
3. Press the **LONG** icon (fig. 10) until "Program Quantity" is displayed, then release. The appliance starts delivering

coffee and the **LONG** icon flashes;

4. As soon as the coffee in the cup reaches the required level, press the **LONG** icon again.

The quantity set has now been programmed.

Regulating the coffee mill

The coffee mill is set by default to prepare coffee correctly and should not require regulating initially.

However, if after making the first few coffees you find that delivery is either too fast or too slow (a drop at a time), this can be corrected by adjusting the grinding adjustment knob (fig. 11).



Please note!

The grinding adjustment knob must only be turned when the coffee mill is in operation.

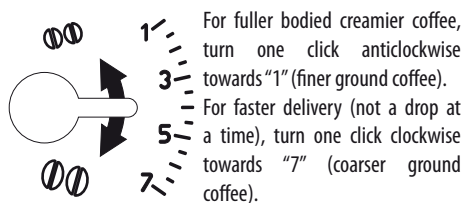

These adjustments will only be evident after at least 2 cups of coffee have been delivered.

If delivery is still too fast or too slow, repeat the correction, turning the knob another click.

Tips for a hotter coffee:

For a hotter coffee, you are recommended to:

- perform a rinse cycle before delivering the coffee: press the  icon to select the "Rinsing..." function (a flashing arrow appears alongside the selected message on the display) and confirm by pressing the OK icon. Hot water is delivered from the spout, heating the internal circuits and making the coffee delivered hotter;
- enable the cup warmer and leave the cups to warm;
- warm the cups by rinsing them with hot water (using the hot water function);
- set the "high" coffee temperature in the menu (●●●●).



Danger of burns!

During rinsing, a little hot water comes out of the coffee spouts and is collected in the drip tray underneath.

Avoid contact with splashes of water.

Preparing espresso coffee using coffee beans



Important!

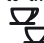

Do not use caramelised or candied coffee beans as they could stick to the coffee mill and make it unusable.

1. Fill the container with coffee beans (fig. 12).
2. Place under the coffee spouts:
 - 1 cup, if you want 1 coffee (fig. 13);
 - 2 cups, if you want 2 coffees (fig. 14);
3. Lower the spouts as near as possible to the cup. This makes a creamier coffee (fig. 15).
4. Press the icon corresponding to the number of coffees required (1 cup  or 2 cups ) (fig. 9 and 16).
5. Preparation begins. The amount of coffee and taste selected are displayed together with a progress bar which gradually fills as preparation progresses (fig. 17).

Once the coffee has been made, the appliance prepares for use again.

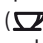
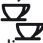

Please note:

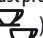
- While the machine is making coffee, delivery can be interrupted at any moment by pressing one of the coffee icons ( or ) .
- At the end of delivery, to increase the quantity of coffee in the cup, just press (within 3 seconds) one of the coffee icons ( or ) .

Once the coffee has been made, the appliance is ready to use again.



Important!

If the coffee is delivered a drop at a time, too fast and not creamy enough or too cold, read the tips in the "Troubleshooting" section on page 24.

Various alarm messages could be displayed while the machine is in use. Their meaning is explained in the section "Displayed messages" (page 23).

Making long coffee using coffee beans



Please note!

When this function is enabled, a long coffee similar to drip coffee is obtained.



Important!

Do not use caramelised or candied coffee beans as they could stick to the coffee mill and make it unusable.

1. Fill the container with coffee beans (fig. 12);
2. Adjust the height of the spout according to the cup used. Put the cup for long coffee under the spouts (fig. 18);
3. Press the **LONG** icon (fig. 10). Preparation begins. A progress bar appears on the display and gradually advances as the procedure progresses.

Once the coffee has been made, the appliance prepares for use again.

 *Please note:*

- While the machine is making coffee, delivery can be interrupted at any moment by pressing the **LONG** icon.
- Only one cup of long coffee can be made at a time.
- When delivering more than 125 ml, the appliance automatically grinds more coffee halfway through delivery.

Making espresso or long coffee using pre-ground coffee

 *Important!*



- Never add pre-ground coffee when the machine is off or it could spread through the inside of the machine and dirty it. This could damage the appliance.



Never use more than one level measure or it could dirty the inside of the machine or block the funnel.

 *Please note!*

If you use pre-ground coffee, you can only make one cup of coffee at a time.

1. Press the  icon repeatedly (fig. 7) until "Pre-ground" flashes on the display.
2. Put one level measure of pre-ground coffee into the funnel (fig. 19).
3. Place a cup under the coffee spouts.
4. To make espresso coffee, press the 1 cup  icon (fig. 9). To make long coffee, press the **LONG** icon (fig. 10).
5. Preparation begins. The amount of coffee and taste selected are displayed together with a progress bar which gradually fills as preparation progresses.

Once the coffee has been made, the appliance prepares for use again.

MAKING DRINKS WITH MILK

 *Please note!*

A few seconds may elapse between energy saving mode and delivery of the first drink.

Filling and attaching the milk container

1. Turn the lid of the milk container clockwise until it becomes noticeably difficult to turn, then remove the lid (fig. 20).
2. Fill the milk container with a sufficient quantity of milk, not exceeding the MAX level marked on the handle (fig.

21).

 *Please note!*

For a richer denser froth, use skimmed or partially skimmed milk at refrigerator temperature (about 5°C). To avoid milk with poor froth or large bubbles, always clean the milk lid and hot water nozzle as described in the section "Cleaning the milk container" on pages 17 and 20.

3. Make sure the milk intake tube is correctly inserted in the bottom of the milk container lid (fig. 22).
4. Replace the milk container lid and turn anticlockwise as far as it will go.
5. Remove the hot water spout from the nozzle (fig. 23).
6. Attach the container to the nozzle and push as far as it will go (fig. 24). The machine emits a beep (if the beep function is enabled).
7. Place a sufficiently large cup under the coffee spouts and frothed milk spout.
To use particularly tall cups/glasses, raise the lid of the special compartment in the cup tray (fig. 25).
8. Follow the instructions below for each function.

Making caffelatte

1. After attaching the milk container, position the froth regulator on CAFFELATTE (fig. 26) printed on the milk container lid.
2. Press the CAFFELATTE icon (fig. 27). "Caffelatte... Froth regulator in position 3" is displayed. After a few seconds, frothed milk is delivered from the milk spout into the cup below. Milk delivery stops automatically and coffee delivery begins.

 *Please note!*

If during delivery you want to stop preparing milk, press the CAFFELATTE icon or interrupt preparation of the coffee by pressing the  icon.

Making cappuccino

1. After attaching the milk container, position the froth regulator on CAPPUCCINO (fig. 28) printed on the milk container lid. **The quality of froth can be adjusted during delivery by moving the regulator slightly towards LATTE MACCHIATO for a denser froth. Moving it towards the word CAPPUCCINO obtains a less dense froth.**
2. Press the **CAPPUCCINO** icon (fig. 29). "Cappuccino... Froth regulator in position 1" is displayed. After a few seconds, frothed milk flows out of the milk spout into the cup below. Milk delivery stops automatically and coffee delivery begins.

 *Please note!*

If during delivery you want to stop preparing milk, press the CAPPUCCINO icon or interrupt preparation of the coffee by pressing the  icon.

Making macchiato

1. After attaching the milk container, position the froth regulator (B1) on LATTE MACCHIATO (fig. 30) printed on the milk container lid.
2. Press the LATTE MACCHIATO icon (fig. 31). "Latte Macchiato... Froth regulator in position 2" is displayed. After a few seconds, frothed milk flows out of the milk spout into the cup below. Milk delivery stops automatically and coffee delivery begins.

 *Please note!*

If during delivery you want to stop preparing milk, press the LATTE MACCHIATO icon or interrupt preparation of the coffee by pressing the  icon.

Making milk

1. After attaching the milk container, position the froth regulator according to the quantity of froth you require (pos. 3 caffelatte = little froth; pos. 1 cappuccino = abundant froth).
2. Press the MILK icon (fig. 32). "MILK" appears on the display. After a few seconds, frothed milk is delivered from the milk spout into the cup below. Delivery of milk stops automatically.

 *Please note!*

If during delivery you want to stop preparing milk, press the MILK icon once.

Cleaning the milk container after use

 *Important! Danger of burns*

When cleaning the internal tubes of the milk container, a little hot water leaks out of the frothed milk tube (B5). Avoid contact with splashes of water.

When "Press CLEAN button" flashes on the display (each time you use a milk function):

1. Leave the milk container in the machine (you do not need to empty it);
2. Place a cup or other recipient under the frothed milk spout.
3. Press the CLEAN button (fig. 33) and keep pressing until the progress bar which appears on the display together

with the message "Cleaning..." is complete.

4. Remove the milk container and always clean the nozzle with a sponge (fig. 34).



 *Nota Bene!*

- When "Press CLEAN button" flashes on the display, you can still prepare any type of coffee or milk. If you have to make a number of drinks with milk, wait until you have delivered the last cup before cleaning the container.
- The milk left in the container can be kept in the refrigerator.
- In some cases, to clean you must wait for the appliance to heat up, holding the CLEAN button down.

Programming the quantities of coffee and milk in the cup

The appliance is set by default to automatically deliver standard quantities.

To change these quantities, proceed as follows:

1. Place a cup under the coffee spouts and milk spout.
2. Press the icon corresponding to the function you want to programme (CAFFELATTE, CAPPUCCINO, LATTE MACCHIATO or MILK) until "Milk for... Program quantity" appears on the display and the icon corresponding to the selected function flashes.
3. Release the icon. The appliance starts delivering milk.
4. When the required quantity of milk has been delivered into the cup, press the icon again.
5. After a few seconds, the appliance starts delivering coffee into the cup and the message "Coffee for... Program quantity" is displayed (with the exception of the MILK function) and the  icon flashes.
6. As soon as the coffee in the cup reaches the required level, press the  icon. Coffee delivery stops.

The machine is now reprogrammed with the new quantities.

HOT WATER



Preparation

 *Important! Danger of burns.*

Never leave the machine unsupervised while delivering hot water.

The hot water spout becomes hot while water is delivering and must be handled by the handle only.

1. Make sure the hot water spout is attached correctly (fig. 4).
2. Place a container under the spout (as close as possible to avoid splashes).
3. Press the  icon (fig. 35). The message "Rinsing" "Hot water..." is displayed.

4. Press the  icon to select the "Hot Water..." function (a flashing arrow appears alongside the selected message on the display) and confirm the selection by pressing the **OK** icon (or cancel the selection by pressing the **ESC** icon).
5. Water flows out of the spout. Delivery stops automatically after 250ml.
6. To interrupt delivery of hot water manually, press the  icon again.





Please note!

- If energy saving has been enabled, delivery could be delayed a few seconds.

Changing the quantity

The appliance is set by default to automatically deliver 250ml of hot water. To modify these quantities, proceed as follows:

1. Position a container under the spouts.
2. Once the "Hot Water" function has been selected, keep pressing the **OK** icon until "Hot Water Program Quantity" appears and the  icon flashes.
3. When the hot water in the cup reaches the required level, press the  icon again.

The machine is now reprogrammed with the new quantities.

CLEANING

Cleaning the coffee maker

The following parts of the machine must be cleaned regularly:

- coffee grounds container (A18),
- drip tray (A16),
- inside the machine, accessible after opening the service door (A19),
- water tank (A13),
- coffee spouts (A20) and hot water nozzle (A11),
- pre-ground coffee funnel (A8),
- infuser (A12),
- milk container (B)
- control panel (D)



Important!

- Do not use solvents, abrasive detergents or alcohol to clean the coffee maker. With De'Longhi superautomatic coffee makers, you need not use chemical products to clean the machine.
- None of the components of the appliance can be washed in a dishwasher with the exception of the milk container (B).
- Do not use metal objects to remove encrustations or coffee deposits as they could scratch metal or plastic surfaces.

Cleaning the coffee grounds container

When "EMPTY GROUNDS CONTAINER" is displayed, the grounds container must be emptied and cleaned.

Until the grounds container has been cleaned, the appliance continues to display the message and coffee cannot be made. Even if not full, the empty grounds container message is displayed 72 hours after the last coffee has been prepared. For the 72 hours to be calculated correctly, the machine must never be turned off with the main switch in the 0 position.

To clean (with the machine on):

- Open the service door on the front of the appliance (fig. 36), extract the drip tray (fig. 37), empty and clean.
- Empty the grounds container and clean thoroughly to remove all residues left on the bottom. This can be done with the spatula on the brush provided.



Important!

When removing the drip tray, the grounds container **must** be emptied, even if it contains few grounds.

If this is not done, when you make the next coffees, the grounds container may fill up more than expected and clog the machine.

Cleaning the drip tray



Important!

If the drip tray is not emptied regularly, the water could overflow from the edge and seep inside or around the machine.

This could damage the machine, the surface it rests on or the surrounding area.

The drip tray is fitted with a level indicator (red) showing the level of water it contains (fig. 38).

Before the indicator protrudes from the cup tray, the drip tray must be emptied and cleaned.

To remove the drip tray:

1. Open the service door (fig. 36);
2. Remove the drip tray and the grounds container (fig. 37);
3. Empty the drip tray and grounds container (A18) and wash them;
4. Replace the drip tray complete with grounds container;
5. Close the service door.

Cleaning the inside of the machine



Danger of electric shock!

Before cleaning internal parts, the machine must be turned off (see "Turning off") and unplugged from the mains power supply.

Never immerse the coffee maker in water.

1. Check regularly (about every 100 coffees) that the inside

of the appliance (accessible after removing the drip tray) is not dirty. If necessary, remove coffee deposits with the brush or a sponge.

2. Remove the residues with a vacuum cleaner (fig. 41).

Cleaning the water tank

1. Clean the water tank (A13) regularly (about once a month) with a damp cloth and a little mild washing up liquid.
2. After cleaning the water tank rinse it thoroughly to remove all washing up liquid residues.

Cleaning the coffee spouts

1. Clean the coffee spouts with a sponge or cloth (fig. 35).
2. Check the holes in the coffee spout are not blocked. If necessary, remove coffee deposits with a toothpick (fig. 40).

Cleaning the pre-ground coffee funnel

Check regularly (about once a month) that the pre-ground coffee funnel is not blocked.

If necessary, remove coffee deposits with the brush.

Cleaning the infuser

The infuser (A12) must be cleaned at least once a month.



Important!

The infuser must not be extracted when the machine is on.

1. Make sure the machine is correctly turned off (see Turning off).
2. Open the service door (fig. 36).
3. Remove the drip tray and grounds container (fig. 37);
4. Press the two red release buttons inwards and at the same time pull the infuser outwards (fig. 42).



Important!

RINSE WITH WATER ONLY

NO WASHING UP LIQUID - NO DISH WASHER

Do not use washing up liquid to clean the infuser as it could cause damage.

5. Soak the infuser in water for about 5 minutes, then rinse under the tap.
6. After cleaning, replace the infuser by sliding it onto the internal support and pin at the bottom, then push the PUSH symbol fully in until it clicks into place.

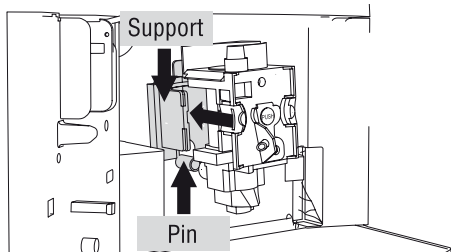

Please note!

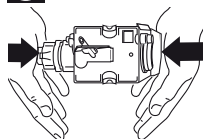

If you encounter difficulty inserting the infuser, before inserting it you must adapt it to the right dimension by pressing it forcefully from the bottom and

top as shown in the figure.

7. Once inserted, make sure the two red buttons have snapped out.
8. Replace the drip tray and grounds container.
9. Close the service door.

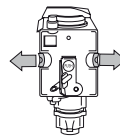

Cleaning the milk container

Clean the milk container each time you prepare milk as described below:

1. Turn the lid of the milk container clockwise then remove it.
2. Remove the milk spout and intake tube.
3. Remove the froth regulator by pulling it outwards.
4. Wash all the components thoroughly with hot water and mild washing-up liquid. **All components can be washed in a dishwasher, placing them in the top basket of the dishwasher.**

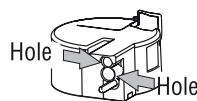
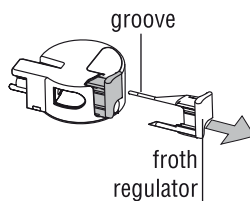
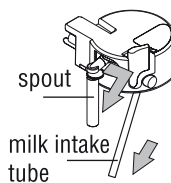

Make sure there are no milk residues left inside the holes and the groove on the fine end of the froth regulator.

5. Check that the intake tube and spout are not clogged with milk residues.
6. Replace the froth regulator, milk spout and intake tube.
7. Replace the lid on the milk container, turning it anticlockwise to hook it in place.

DESCALING

Descalcify the machine when the message "DESCALE!" flashes on the display.



Important!

Descaler contains acids which may irritate the skin and eyes.

It is vital to respect the manufacturer's safety warnings given on the descaler pack and the warnings relating to the procedure to follow in the event of contact with the skin and eyes.



Please note!

Under no circumstances should you use sulphamic or acetic based descalers. Their use invalidates the guarantee.

Failure to descale the appliance as described also invalidates the guarantee.

1. Turn the machine on.
2. Enter the programming menu by pressing the **P** icon.
3. Select by pressing the **OK** icon.
"Descaling Confirm?" is displayed. Press **OK** to enable the function.
4. The message "Add descaler" "Press OK" is displayed.
5. Before confirming, empty the water tank (A13).
Pour the descaler diluted with water (respecting the proportions indicated on the descaler pack) into the water tank.
Place an empty container with a minimum capacity of 1.5 litres under the hot water spout.



Important! Danger of burns

Hot water containing acid flows out of the hot water spout.

Avoid contact with splashes of water.

6. Confirm by pressing the **OK** icon.
7. The message "Descaling..." is displayed.
The descaling programme starts and the descaler liquid comes out of the water spout. The descale programme automatically performs a series of rinses and pauses to remove limescale deposits from inside the machine.

After about 30 minutes, the message "Rinsing FILL TANK!" is displayed.

8. The appliance is now ready for rinsing through with clean water.
Remove the water tank, empty, rinse under running water, fill with clean water and replace. "Rinsing... Press OK" is displayed.
9. Empty the container used to collect the descaler solution and replace it under the hot water spout.
10. Press the **OK** icon to start rinsing. Hot water flows out of the spout and the message "Rinsing..." is displayed.
11. When the water tank is completely empty, the message "Rinsing Complete... Press OK" is displayed.
12. Press the **OK** icon. The appliance goes off.

To use it again, turn the appliance on by pressing the  button.

SETTING WATER HARDNESS

The DESCALE message is displayed after a period of time established according to water hardness.

The machine is set by default for a hardness value of 4 (very hard water).

The machine can also be programmed according to the actual hardness of the mains water in the various regions, varying the frequency with which the message is displayed.

Measuring water hardness

1. Remove the "TOTAL HARDNESS TEST" indicator paper from its pack.
2. Immerse the paper completely in a glass of water for one second.
3. Remove the paper from the water and shake lightly. After about a minute, 1, 2, 3, or 4 red squares form, depending on the hardness of the water. Each square corresponds to one level.

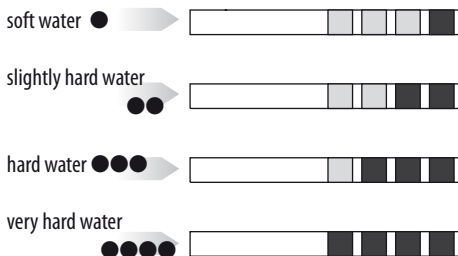

Set water hardness

1. Press the **P** icon to enter the programming menu.
2. Press the ◀ or ▶ icon and select "Water hardness".
3. Confirm the selection by pressing the **OK** icon.
4. Press the ◀ or ▶ icon to set the number of squares formed on the reactive strip (see figure in the previous section).
5. Press the **OK** icon to confirm the setting.
6. Press the **ESC** icon to exit the menu.

The machine is now reprogrammed with the new water hardness setting.

WATER SOFTENER FILTER

Certain models are fitted with a water softener filter. If this is not the case with your model, you are recommended to purchase one from De'Longhi Customer Services. To use the filter correctly, follow the instructions below.

Installing the filter

1. Remove the filter from the packaging.
2. Turn the date indicator disk until the next two months of use are displayed. (fig. 43).

Nota Bene

The filter lasts about two months if the appliance is used normally. If the coffee machine is left unused with the filter installed, it will last a maximum of three weeks.

3. To activate the filter, let tap water go in the hole of the filter as shown in the figure as long as the water comes out from the side openings for over one minute. (fig. 44).
4. Extract the tank from the appliance and fill with water.
5. Insert the filter in the water tank and immerse it completely for about 30 seconds, turning it upside down to enable the air bubbles to escape (fig. 45).
6. Insert the filter in the filter housing and press as far as it will go (fig. 46).
7. Close the tank with the lid, then put the tank back in the machine (fig. 47).

When you install the filter, you must notify the appliance of its presence.

8. Access the menu by pressing the **P** icon;
9. Scroll through the menu by pressing the ◀ or ▶ icon until "Install water filter" is displayed.
10. Press the **OK** icon.
11. The message "Water filter, Install?" is displayed.
12. Press the **OK** icon to confirm the selection. The message "Insert water spout and press OK".
13. Position a container under the hot water spout (min. capacity: 100 ml).
14. Press **OK** to confirm the selection. The appliance begins delivering hot water and "Please wait" is displayed.
15. After delivery, the appliance is automatically ready to make the next drink.

After delivery, the appliance is automatically ready to make the next drink.

Replacing the filter

When "REPLACE FILTER" is displayed, after two months (see date indicator) or if the appliance has not been used for 3 weeks, you should replace the filter:

1. Extract the tank and exhausted filter;
2. Remove the new filter from the packaging and proceed as illustrated on the previous paragraph (points 3-4-5-6).
3. Position a container with a minimum capacity of 100 ml under the hot water spout.
4. Access the menu by pressing the **P** icon;
5. Scroll through the menu by pressing the ◀ or ▶ icon until "Replace filter?" is displayed.
6. Press the **OK** icon.
7. "CONFIRM?" is displayed.
8. Press the **OK** icon to confirm.
9. "Insert water spout and press OK" is displayed;

10. Press **OK** to confirm the selection. The appliance begins delivering hot water and "Please wait" is displayed.
11. After delivery, the appliance is automatically ready to make the next drink.

The new filter is now active and you can use the coffee machine.

TECHNICAL SPECIFICATION

Voltage:	220-240 V ~ 50/60 Hz max. 10A
Absorbed power:	1350W
Pressure:	15 bar
Water tank capacity:	1,7 l
Size: LxHxD:	282x374x441 mm
Cable length:	1,5 m
Weight:	11,4 Kg
Beans container capacity:	250 g

 The appliance complies with the following EC directives:

- EC Regulation 1275/2008 for standby;
- Low Voltage Directive 2006/95/EC and subsequent amendments;
- EMC Directive 2004/108/EC and subsequent amendments
- Materials and accessories coming into contact with food conform to EEC regulation 1935/2004.

DISPOSAL



In compliance with European directive 2002/96/EC, the appliance must not be disposed of with household waste, but taken to an authorised waste separation and recycling centre.

DISPLAYED MESSAGES

DISPLAYED MESSAGE	POSSIBLE CAUSE	REMEDY
FILL TANK	<ul style="list-style-type: none"> Insufficient water in the tank. 	<ul style="list-style-type: none"> Fill the tank with water and/or insert it correctly, pushing it as far as it will go until it clicks into place (fig. 3).
GROUND TOO FINE ADJUST MILL Insert water spout and press OK	<ul style="list-style-type: none"> The grinding is too fine and the coffee is delivered too slowly. 	<ul style="list-style-type: none"> Repeat coffee delivery and turn the grinding adjustment knob one click clockwise towards "7" while the coffee mill is in operation. If after making at least 2 coffees delivery is still too slow, repeat the correction procedure, turning the grinding adjustment knob another click until delivery is correct.
INSERT WATER SPOUT	<ul style="list-style-type: none"> The water spout is not inserted or is inserted incorrectly. 	<ul style="list-style-type: none"> Insert water spout as far as it will go.
EMPTY GROUNDS CONTAINER	<ul style="list-style-type: none"> The grounds container is too full or more than 3 days have passed since you last made coffee (this guarantees correct hygiene of the machine). 	<ul style="list-style-type: none"> Empty the grounds container and clean, then replace. Important: when removing the drip tray, the grounds container must be emptied, even if it contains few grounds. If this is not done, when you make the next coffees, the grounds container may fill up more than expected and clog the machine.
INSERT GROUNDS CONTAINER	<ul style="list-style-type: none"> After cleaning, the grounds container has not been replaced. 	<ul style="list-style-type: none"> Open the service door, remove the drip tray and insert the grounds container.
ADD PRE-GROUND COFFEE	<ul style="list-style-type: none"> The "pre-ground coffee" function has been selected without placing any pre-ground coffee in the funnel. 	<ul style="list-style-type: none"> Place pre-ground coffee in the funnel or deselect the "pre-ground" function.
DESCALE	<ul style="list-style-type: none"> The machine must be descaled. 	<ul style="list-style-type: none"> The descaling procedure described in the "Descaling" section needs to be performed as soon as possible.
LESS COFFEE	<ul style="list-style-type: none"> Too much coffee has been used. 	<ul style="list-style-type: none"> Select a milder taste or reduce the quantity of pre-ground coffee.
FILL BEANS CONTAINER	<ul style="list-style-type: none"> The coffee beans have run out. 	<ul style="list-style-type: none"> Fill the beans container
	<ul style="list-style-type: none"> The pre-ground coffee funnel is clogged. 	<ul style="list-style-type: none"> Empty the funnel with the help of a brush as described in the section "Cleaning the pre-ground coffee funnel".
INSERT INFUSER ASSEMBLY	<ul style="list-style-type: none"> The infuser has not been replaced after cleaning. 	<ul style="list-style-type: none"> Insert the infuser as described in the paragraph "Cleaning the infuser".
INSERT MILK CONTAINER	<ul style="list-style-type: none"> The milk container is not inserted correctly. 	<ul style="list-style-type: none"> Insert the milk container as far as it will go.
CLOSE DOOR	<ul style="list-style-type: none"> The service door is open 	<ul style="list-style-type: none"> Close the service door.
PRESS CLEAN BUTTON	<ul style="list-style-type: none"> Milk has been delivered recently and the tubes inside the milk container must be cleaned. 	<ul style="list-style-type: none"> Press the CLEAN button and keep it pressed until the progress bar which appears on the display together with the message "Cleaning..." is complete.
ADD PRE-GROUND COFFEE Press OK	<ul style="list-style-type: none"> The "pre-ground coffee" function has been selected without placing any pre-ground coffee in the funnel. 	<ul style="list-style-type: none"> Place pre-ground coffee in the funnel.
	<ul style="list-style-type: none"> The funnel (A8) is blocked. 	<ul style="list-style-type: none"> Empty the funnel with the help of a knife, as described in the section "Cleaning the pre-ground coffee funnel".
Energy Saving	<ul style="list-style-type: none"> The function is active and reduces electricity consumption. 	<ul style="list-style-type: none"> Disable the function in the menu.
GENERAL ALARM	<ul style="list-style-type: none"> The inside of the appliance is very dirty. 	<ul style="list-style-type: none"> Clean the inside of the appliance thoroughly, as described in the section "Cleaning and maintenance". If the message is still displayed after cleaning, contact a Customer Service.

TROUBLESHOOTING

Below is a list of some of the possible problems.

If the problem cannot be resolved as described, contact a Customer Service.

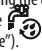
PROBLEM	POSSIBLE CAUSE	SOLUTION
The coffee is not hot	<ul style="list-style-type: none"> The cups were not preheated. 	<ul style="list-style-type: none"> Enable the cup warmer, leave the cups at least 20 minutes to warm up. Warm the cups by rinsing them with hot water (using the hot water function).
	<ul style="list-style-type: none"> The infuser has cooled down because 2/3 minutes have elapsed since the last coffee was made. 	<ul style="list-style-type: none"> Before making the coffee, heat the infuser by pressing the  icon (see the sections "Tips for a hotter coffee").
	<ul style="list-style-type: none"> A low coffee temperature is set. 	<ul style="list-style-type: none"> Set a high coffee temperature in the menu.
The coffee is not creamy enough.	<ul style="list-style-type: none"> The coffee is ground too coarsely. 	<ul style="list-style-type: none"> Turn the grinding adjustment knob one click anticlockwise towards "1" while the coffee mill is in operation (fig. 8). Continue one click at a time until coffee delivery is satisfactory. The effect is only visible after delivering 2 coffees.
	<ul style="list-style-type: none"> Wrong type of coffee 	<ul style="list-style-type: none"> Use a type of coffee for espresso coffee makers.
The coffee is delivered too slowly or a drop at a time.	<ul style="list-style-type: none"> The coffee is ground too finely. 	<ul style="list-style-type: none"> Turn the grinding adjustment knob one click clockwise towards "7" while the coffee mill is in operation (fig. 11). Continue one click at a time until coffee delivery is satisfactory. The effect is only visible after delivering 2 coffees.
The coffee does not come out of the spouts, but from around the service door.	<ul style="list-style-type: none"> The holes in the spouts are clogged with dry coffee deposits. 	<ul style="list-style-type: none"> Clean the spouts with a toothpick, sponge or hard bristled kitchen brush.
	<ul style="list-style-type: none"> The coffee guide inside the service door is blocked and cannot swing. 	<ul style="list-style-type: none"> Thoroughly clean the coffee guide, particularly near the hinges.
The coffee is delivered too quickly.	<ul style="list-style-type: none"> The coffee is ground too coarsely. 	<ul style="list-style-type: none"> Turn the grinding adjustment knob one click anticlockwise towards "1" while the coffee mill is in operation (fig. 11). Avoid turning the grinding adjustment knob excessively otherwise when you select two cups, the coffee may be delivered a drop at a time.
Coffee does not come out of one of the spouts.	<ul style="list-style-type: none"> The spouts are blocked. 	<ul style="list-style-type: none"> Clean the spouts with a toothpick (fig. 40).
Water comes out of the spouts instead of coffee.	<ul style="list-style-type: none"> The pre-ground coffee may be blocked in the funnel (A8). 	<ul style="list-style-type: none"> Empty the funnel with the help of a knife, as described in the section "Cleaning the pre-ground coffee funnel".
The milk contains bubbles or squirts out of the milk spout.	<ul style="list-style-type: none"> The milk is not cold enough or is not semi-skimmed. 	<ul style="list-style-type: none"> You should ideally use skimmed or semi-skimmed milk at refrigerator temperature (about 5°C). If the result is not as you wished, try changing brand of milk.
	<ul style="list-style-type: none"> The froth regulator is incorrectly adjusted. 	<ul style="list-style-type: none"> Adjust following the instructions in the section on preparing drinks with milk.
	<ul style="list-style-type: none"> The milk container lid is dirty. 	<ul style="list-style-type: none"> Clean the milk container lid as described in the section "Cleaning the milk container".
The milk is not frothed.	<ul style="list-style-type: none"> The froth regulator is incorrectly adjusted. 	<ul style="list-style-type: none"> Adjust following the instructions in the section on preparing drinks with milk.
	<ul style="list-style-type: none"> The milk container lid is dirty. 	<ul style="list-style-type: none"> Place the ring in the CAPPUCCINO position.

PROBLEM	POSSIBLE CAUSE	SOLUTION
The appliance does not come on.	• It is not plugged into the mains socket.	• Plug into the mains socket.
	• The main switch is not turned on.	• Place the main switch in the I position (fig. 29).
The LONG coffee has too much froth	• The coffee is ground too finely.	• Turn the grinding adjustment knob one click clockwise towards "7" while the coffee mill is in operation (fig. 11). Continue one click at a time until coffee delivery is satisfactory. The effect is only visible after delivering 2 coffees.
The milk does not come out of the milk spout.	• The milk container lid is dirty.	• Clean the milk container lid as described in the section "Cleaning the milk container".
"Energy Saving" mode is enabled, but the cup warmer is hot	• A number of drinks have been prepared in rapid succession.	