

# Important safeguards

- Use this appliance only as described in this instruction manual.

As with any electrical appliance, the instructions aim to cover as many situations as possible. Caution and common sense should be used when operating and installing this appliance.

- Before operating the product, remove the packaging and check that product is in good condition.
- This appliance has been manufactured to refresh domestic environments and must not be used for other purposes.
- This appliance is for indoor use only!
- It is dangerous to alter or modify the unit's characteristics in any way.
- The appliance must be installed in accordance with the relevant national legislation.
- Always place the unit on a stable level floor.
- Do not use in bathrooms or near water. Do not keep the product where it may fall into a water container.
- Do not run power cord under carpeting, or cover it with rugs or runners. Keep the cord away from areas where it may be tripped over.
- Should repairs be necessary, contact the nearest authorized Repair Service Center. Unauthorized servicing can be dangerous.
- The appliance is not intended for use by persons (including children) with reduced physical, sensory or mental capabilities, or lack of experience and knowledge, unless they have been given supervision or instruction concerning use of the appliance by a person responsible for their safety.  
Children should be supervised to ensure that they do not play with the appliance.
- If the power cord is damaged, it must be replaced by the manufacturer or an authorized technical service center in order to avoid all risk.
- This appliance has a polarized plug (one blade is wider than the other). To reduce the risk of electric shock, this plug is intended to fit in a polarized outlet only one way. If the plug does

not fit fully in the outlet, reverse the plug. If it still does not fit, contact a qualified electrician. Do not attempt to defeat this safety feature.

- Do not use extension cables.
- Always unplug the appliance before refilling the water tank, cleaning, servicing or relocating the unit.
- Do not pull on or place strain on the power cord when moving the appliance.
- The appliance should not be installed where the atmosphere may contain combustible gases, oil or sulphur, or near heat sources.
- Do not rest hot or heavy objects on the appliance.
- Do not insert or allow objects to enter any ventilation or exhaust opening, as this may damage the unit and may cause electrical shock of fire.
- Do not cover the appliance's air inlet or outlet, as this may damage the motor.
- This equipment should be inspected frequently and collected dirt removed from it regularly to prevent excessive accumulation that may result in flashover or a risk of fire.
- Avoid using heaters near the unit.
- The unit should be transported with the tank empty. Therefore, before transporting the appliance, drain the tank.
- Store the unit with water tank empty.
- **WARNING:** Changes or modifications not expressly approved by the party responsible for compliance could void the user's authority to operate the equipment.
- **WARNING:** To reduce the risk of fire or electric shock, do not use this appliance with any solid state speed control device.
- This product complies with the maximum allowable concentration of ozone of 0.050 parts per million by volume (ppmv) in a 24-hour period.

## Read and save these instructions







## This product is for household use only

## 1. DESCRIPTION

### 1.1 Description of the appliance (A)

- A1. Rotating vent
- A2. Water level indicator
- A3. Castors
- A4. Power cord winder
- A5. Handle
- A6. Power cord
- A7. Removable water tank
- A8. Filter housing
- A9. Dust filter
- A10. Cooling pad
- A11. Honeycomb cooling pad
- A12. Ice box/pack

### 1.2 Description of the control panel (B)

- B1. ON/OFF button: to switch the appliance ON and OFF
- B2. Speed fan. Press to selected the desired speed:  MED,  MAX,  MIN
- B3. Cooler/Humidifying. Press to select or deselect the function
- B4. Press to select the fan mode:
  - Natural  : the appliance performs random ventilation cycles at different speeds, interrupted by a few seconds of stop
  - Sleep  : the appliance runs 30 minutes at MAX speed, then 30 minutes at MED speed: then runs at MIN speed
- B5. "Swing" mode: when pressed, the grid rotates
- B6. "AUTO OFF": press to set the delayed auto off (from 1 to 24 hours):
  - When on, the symbol  and the hours flash on the display for 5 seconds: when turn on steady, the auto off time is set
  - To deactivate: press the relative button until "00" is selected, then wait until the symbol and the number switch off.

### 1.3 Description of the display (C)

- C1. "Auto-off" display
- C2. "Cooler/Humidifying" "ON"
- C3. "Ionizer" "ON" (active in every mode)
- C4. "Sleep" fan mode "ON"
- C5. "Natural" fan mode "ON"
- C6. "Auto-off" setting
- C7. "Swing" "ON"
- C8. "MIN" fan speed
- C9. "MED" fan speed
- C10. "MAX" fan speed

### 1.4 Description of the remote control (D)

- D1. ON/OFF: to switch the appliance ON and OFF
- D2. "Swing": when selected, the vent rotates

D3. "AUTO OFF" (see B6)

D4. Fan speed (see B2)



D5. Fan mode selection (see B4)

D6. Cooler/Humidifying. Press to select or deselect the function

## 2. USING THE APPLIANCE

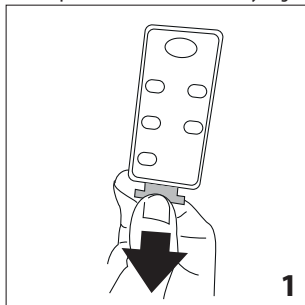

1. Plug the appliance in: you will hear a beep and the appliance is ready to use;
2. Remove the plastic tab from the battery (fig. 1);

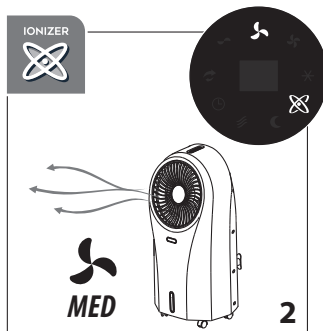

3. To turn the appliance on, press the  button (B1 or D1). The appliance turns on at MED fan speed and the ionizer  is on (fig. 2).

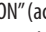

### 2.1 Setting fan speed

1. Press the  button (B2 or D4);
2. When you press the button, the fan speed changes (  MED,  MAX,  MIN) (fig. 3).

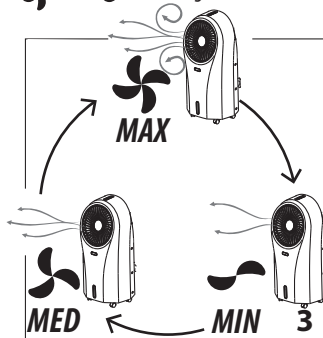

## 2.2 Cooler/Humidifying

Fill the water tank before selecting this function.

1. Extract the water tank (fig. 4) and fill with MAX 4.5L (152 oz) of fresh tap water (do not overload the water tank: see water level indicator A2).

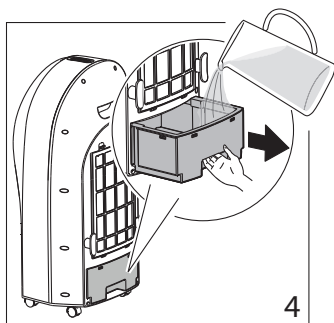

2. Put the tank back in the appliance;
3. Press the  button (B3 or D6): the corresponding light on the display turns on (fig. 5) and the air, flowing through the cooling pad, comes out fresh and contributes to decrease the room temperature;

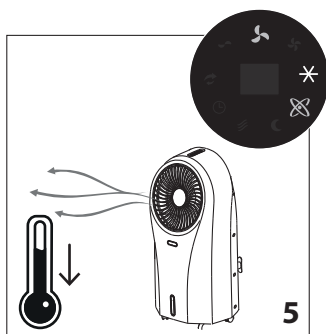

### **Please note:**

At first use, the appliance could emit a strange odor and the water could be discolored: this is part of normal use.

Using the ice box/pack you can increase the efficiency of the appliance.

4. Fill the ice box/pack with tap water (fig. 6);

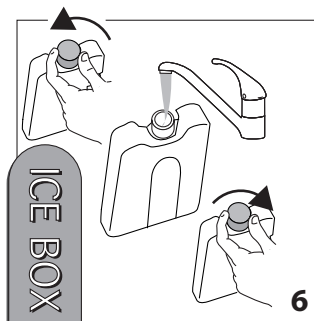

5. Put the ice box/pack in the freezer and leave it in until it is frozen (fig. 7);

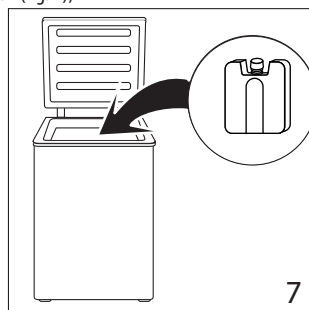

6. Put the ice box/pack vertically in the front left corner of the tank as shown in figure 8;

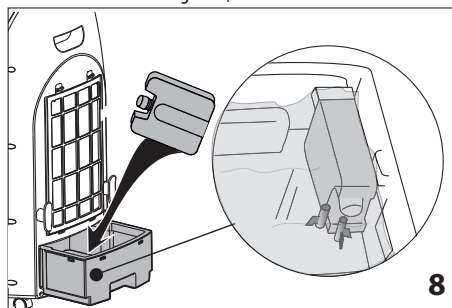

7. Replace the water tank, turn on the appliance and select Cooling/Humidifying: the air flow will be fresher than before (fig. 9).

### **Please note:**

Always check the Ice box/pack is correctly inserted in its housing (see fig. 8).

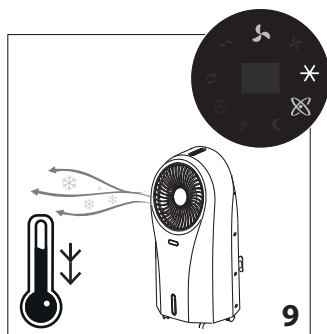

## 2.3 Selecting the fan mode

The appliance can be set for 3 different fan modes:

1. **NORMAL** - Press the button (B2 or D4) to select the fan speed;
2. **NATURAL** - Press the **MODE** button (B4 or D5) once. The appliance performs random ventilation cycles at different speeds, interrupted by a few seconds of stop (fig. 10);

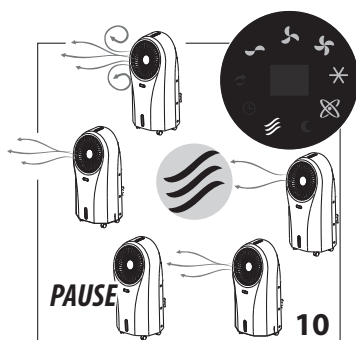

3. **SLEEP** - Press the **MODE** button (B4 or D5) twice. The appliance runs 30 minutes at MAX speed, then 30 minutes at MED speed: then runs continuously at MIN speed (fig. 11).

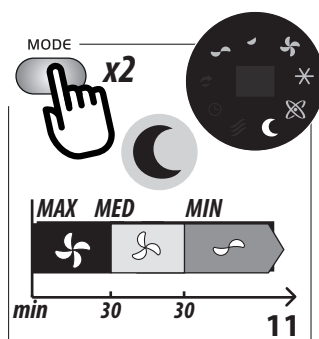

## 2.4 Swing

Press the button (B5 or D2) once to activate the rotating vent (fig. 12).

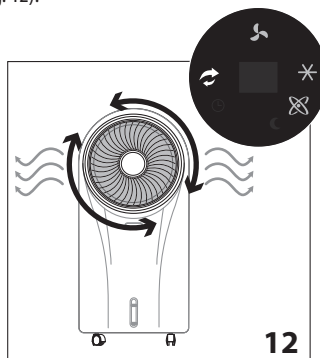

Press again to exit swing mode.

The corresponding LED turns on and off accordingly.

You can also adjust vertically the vent by lightly pushing the vent to orientate the air flow (fig. 13): always adjust the vent when the vent is stationary.

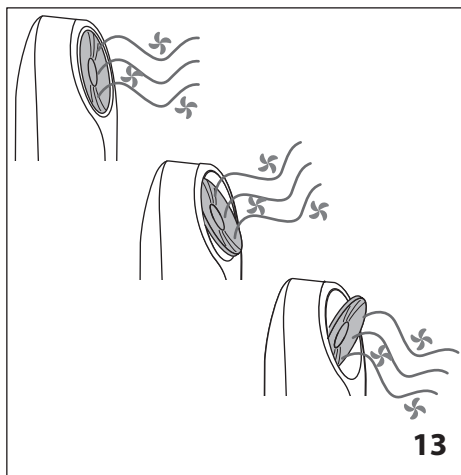



## 2.5 Auto Off

You can set the delayed shut off from 1 to 24 hours by pressing the button (B6 or D3).

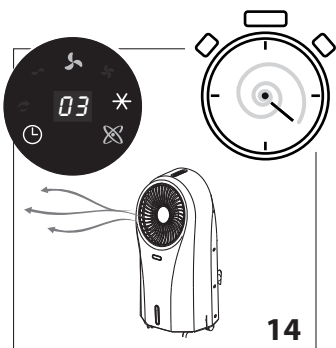
1. Select the number relative to the operating hours desired: the number will be shown on the display (C1);
2. symbol flashes to highlight that you are programming the auto off: when the flashing stops, the auto off is set (fig. 14);



If you want to exit the “Auto off” function, repeatedly press the  button (B6 or D3) until “00” is displayed:  symbol flashes then disappears and “Auto Off” function is disabled.

### 3. REFILLING THE WATER TANK

Before activating the Cooling/Humidification function, always make sure there is water in the tank. If the water finishes during use, the appliance makes an audible signal and the  symbol flashes on the display (fig. 15): the device will nonetheless continue to ventilate.

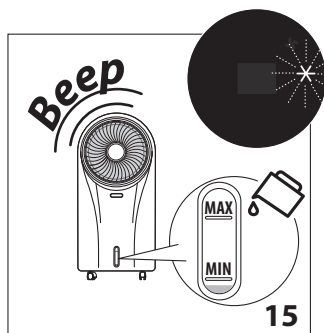

#### Recommended tank filling procedure:

1. Partially extract the water tank (fig. 4) and fill it with MAX 4.5l (152oz) of fresh tap water, using a jug. Always use tap water and never overfill the tank: check the water level indicator (A2);
2. Put the tank back in the appliance.

#### Note:

If you decide to completely extract the tank:

- extract the tank until the pump is raised (fig. 16) and wait a few minutes for the residual water on the honeycomb cooling pad to drip into the tank;

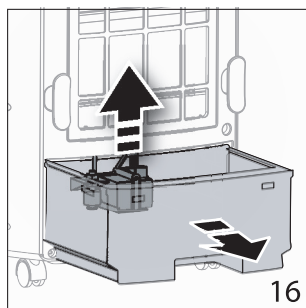

- fully extract the tank and proceed to fill it.
- Once the tank is filled:
- if necessary, dry the tank housing;
  - check that the pump is raised;
  - carefully re-insert the water tank.

### 4. CLEANING AND MAINTENANCE

- Always unplug the appliance before cleaning.
- Never immerse the appliance in water.
- Pouring water on the unit is strictly forbidden.
- Do not use benzine, alcohol or solvents for cleaning.
- Do not spray insecticide liquid or similar since the plastic could be deformed.
- Clean the surface of the unit with a damp cloth, never use an abrasive scourer directly on the outside surface as it might scratch.

#### 4.1 Cleaning the dust filter and the cooling pad

To avoid clogging of the dustproof filter, please clean the filter regularly. The frequency of cleaning is to be related to the working time: if used daily, it is suggested to clean filter weekly.

- Remove the dust filter and cooling pad (fig. 17);

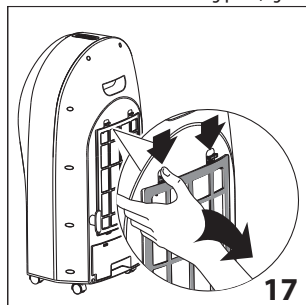

- Remove the dust from the filter and the cooling pad using a vacuum cleaner (fig. 18);

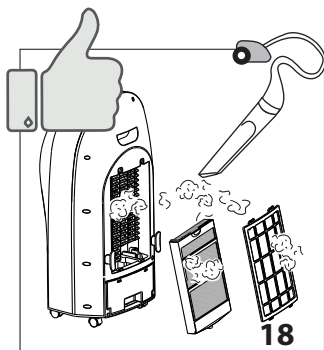

- Wash thoroughly the cooling pad with water; then leave it to completely dry and reassemble the filters in its housing (fig. 19).

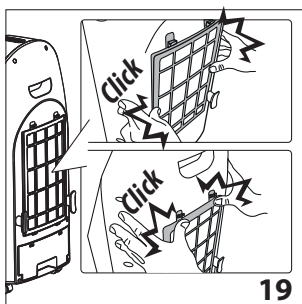

- To maintain the efficiency of the appliance, it is suggested to change the cooling pad every year.

## 4.2 Cleaning the water tank

### **Please note:**

Turn off unit and let sit two minutes before removing drawer to allow excess water to drain back into tank

- Remove the water tank (fig. 4);
- Clean thoroughly with a cleaning sanitizer, easily available in stores (fig. 20).

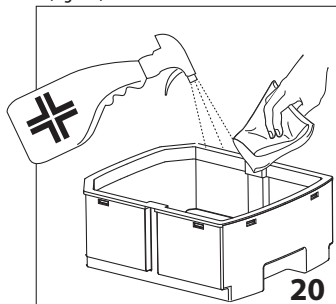

## 4.3 Changing the battery of the remote control

- Remove the battery holder on the back of the remote control (fig. 21);

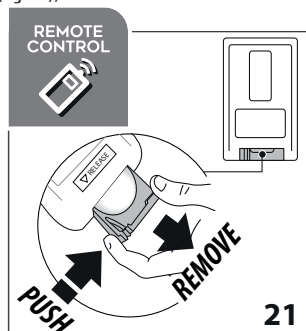

- Insert one 3V CR2025 type lithium battery on the support, checking that the polarity is correct (+ and -) (fig. 22).

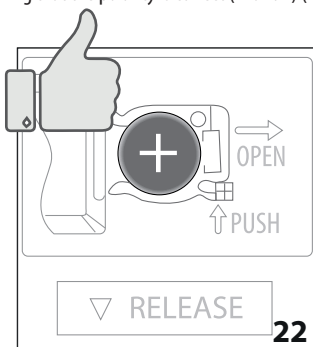

### **Please note:**

- If you change or dispose the remote control, the battery must be removed and disposed of according to local recycling regulations.
- Never throw the battery in fire as it may explode or leak dangerous liquids.
- This equipment has been tested and found to comply with the limits for a Class B digital device, pursuant to part 15 of the FCC Rules. These limits are designed to provide reasonable protection against harmful interference in a residential installation.
- This equipment generates, uses and can radiate radio frequency energy and, if not installed and used in accordance with the instructions, may cause harmful interference to radio communications. However, there is no guarantee that interference will not occur in a particular installation. If this equipment does cause harmful interference to radio or television reception, which can be determined by turning the equipment off and on, the user is encouraged to try to correct the interference by one or more of the following measures:
  - Reorient or relocate the receiving antenna.

- Increase the separation between the equipment and receiver.
- Connect the equipment into an outlet on a circuit different from that to which the receiver is connected.
- Consult the dealer or an experienced radio/TV technician for help.

Changes or modifications not expressly approved by the party responsible for compliance could void the user's authority to operate the equipment.

- This device complies with Part 15 of the FCC Rules. Operation is subject to the following two conditions: (1) this device may not cause harmful interference, and (2) this device must accept any interference received, including interference that may cause undesired operation.
- This Class B digital apparatus complies with Canadian ICES-003.

## 5. TROUBLESHOOTING

Below is a list of some of the possible malfunctions.

If the problem cannot be resolved as described, contact Customer Service.

PROBLEM	CAUSE	SOLUTION
No discharge of air	Cord is not plugged in	Make sure power cord is plugged in and the switch is ON
	Power is not ON	Turn the unit ON by pressing the ⓘ button ( B1 on the control panel or D1 on the remote control)
The appliance switches off	The auto shutoff timer was set	Turn the appliance ON and check that the auto shutoff symbol is off
Presence of water under the tank	When the tank is completely extracted without waiting a couple of minutes, the residual water on the honeycomb cooling pad will drip into the tank housing	Dry the housing before re-inserting the tank. For filling, follow the instructions in chap. 3.
Excessive humidity in the room	In Cooler/Humidifying function, the appliance produces moisture as a result of evaporative cooling. This is normal	The appliance cools best in dry climates. If the ambient humidity level is high (60% or above) refrain from using the cooler/humidifying function
		Make sure the window/doors are open and there is adequate cross ventilation in the room so that the air can circulate better. Utilize the "fan" function
Odors and colored water	When the appliance is new	At first use, the appliance will have an odor, which will dissipate within a few hours of initial use. The color in the water will also dissipate after a few uses.
	Algae or mold due to moisture. In very damp conditions, algae may form due to moisture	Check the Honeycomb Cooling Pad (A12), water tank (A7) and other cooler parts. If you see mold spots or algae issue, use a damp cloth to wipe away the algae until all spots have disappeared. Make sure all parts are clean and dry before storage. Contact Customer Service if problem persists. If the Honeycomb Cooling Pad (A11) has algae or mold, change it with a new one

PROBLEM	CAUSE	SOLUTION
Remote control does not work	Remote control battery is incorrectly inserted in the battery compartment	Check the battery is correctly inserted following the polarity guide inside the battery compartment.
	Remote control battery is exhausted	Replace with a new battery
	Damaged remote control	If replacing new battery in the correct position does not work, contact Customer Service
The unit does not respond	Damaged control panel on unit	Try to activate the unit with the remote control If the unit responds, then the control panel on the unit may be experiencing problems: contact Customer Service
		If neither the remote control or the control panel is working, contact Customer Service
If “Cooler/Humidifier” indicator flashes and unit beeps	Because of no water in the tank	Fill tank above MIN mark with water