



# **FAN HEATER**

## INSTRUCTION



Voltage  
Wattage

See rating plate

#### **ELECTRICAL CONNECTION (U.K. ONLY)**

- A) If your appliance comes fitted with a plug, it will incorporate a 13 Amp fuse. If it does not fit your socket, the plug should be cut off from the mains lead, and an appropriate plug fitted, as below.  
WARNING: Very carefully dispose of the cut off plug after removing the fuse: do not insert in a 13 Amp socket elsewhere in the house as this could cause a shock hazard.  
With alternative plugs not incorporating a fuse, the circuit must be re-fitted when changing the fuse using a 13 Amp Asta approved fuse to BS 1362. In the event of losing the fuse cover, the plug must NOT be used until a replacement fuse cover can be obtained from your nearest electrical dealer. The colour of the correct replacement fuse cover is that as marked on the base of the plug.
- B) If your appliance is not fitted with a plug, please follow the instructions provided below:

#### **IMPORTANT**

The wires in the mains lead are coloured in accordance with the following code:

Blue:	Neutral
Brown:	Live

As the colours of the wires in the mains lead of this appliance may not correspond with the coloured markings identifying the terminals in your plug, proceed as follows:

The wire which is coloured blue must be connected to the terminal which is marked with the letter N or coloured black.  
The wire which is coloured brown must be connected to the terminal which is marked with the letter L or coloured red.

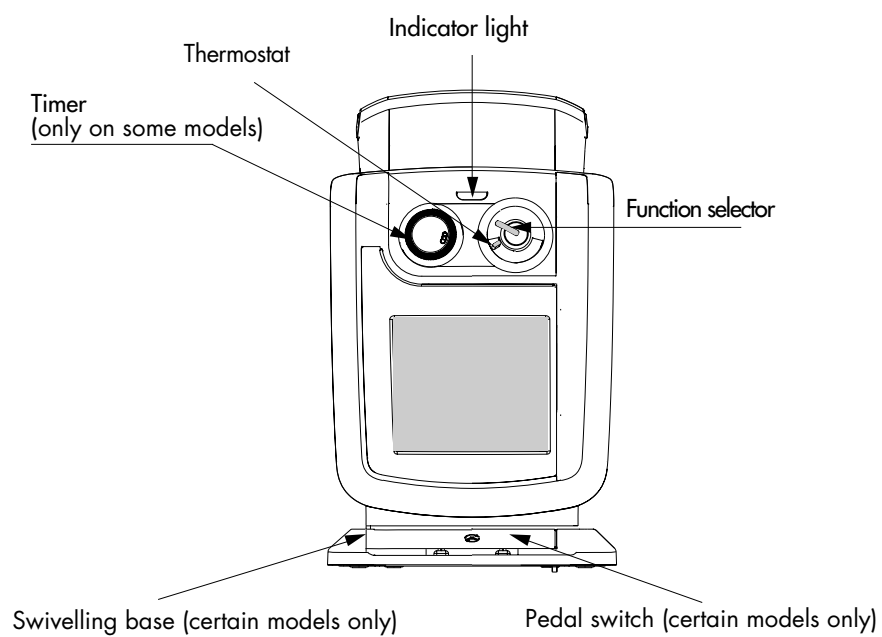
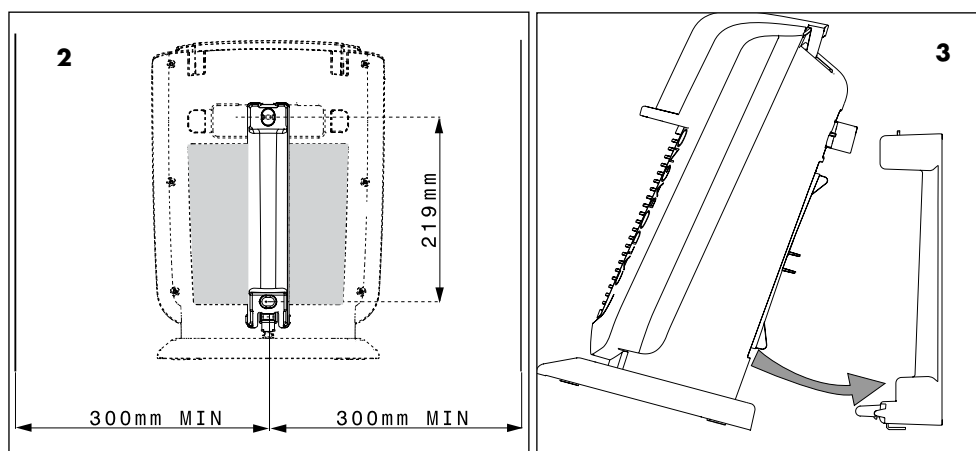
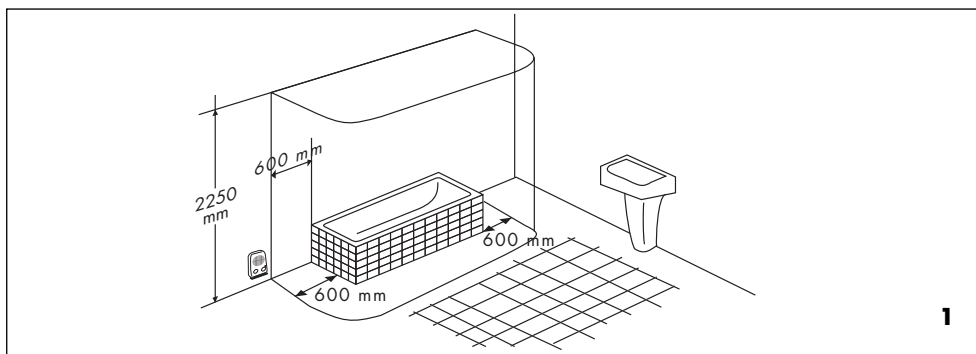

### ELECTRICAL CONNECTION

- Before plugging into the mains, make sure the voltage of your mains supply corresponds to the value in Volts (V) indicated on the appliance and that the socket and power line are appropriate for the load required.
- THIS APPLIANCE COMPLIES WITH DIRECTIVE 2004/108/EC ON ELECTROMAGNETIC COMPATIBILITY.

### INSTALLATION

The appliance may be either portable or wall-mounted (if supplied with a bracket). Models with motorised base cannot be wall mounted. To mount on the wall, proceed as follows:

- Fix the bracket to the wall respecting the minimum measurements indicated in fig. 2. If the appliance is installed in a room with bath or shower, respect the "safety distances" shown in fig. 1 and always install away from taps, basins, showers, etc.
- Attach the appliance to the top hook of the bracket, then rotate gently until it hooks to the bottom tooth of the bracket (fig. 3).
- The appliance must not be placed immediately under a fixed power socket.

**Note:** if you do not intend to wall mount the appliance, do not attach the bracket to the unit.

### FUNCTIONING AND USE

Models with function selector and thermostat. **Make sure the appliance is off before plugging into the mains.**

1. Plug the appliance into the mains. The light comes on. If your appliance has a timer, see the section "Models with 24 hour timer". However, to operate the appliance without programming, place the timer selector in the "I" position.
2. Turn the thermostat dial to maximum.
3. **Summer mode (fan only):** turn the function selector to the ☼ position.
4. **Low power operation:** turn the function selector to position 1 (in models with two fan speeds, the fan operates at minimum).
5. **Medium power operation:** turn the function selector to position 2 (in models with two fan speeds, the fan operates at maximum).
6. **High power operation:** turn the function selector to position 3 (the fan operates at maximum).
7. **Switching off:** turn the function selector to the "0" position. Note: In models with two

power levels, position 2 corresponds to maximum power.

### Setting the thermostat:

Position the thermostat lever on maximum "+". When the room has reached the required temperature, slowly move the thermostat lever towards the "-" position until you hear a click and the fan goes off. The thermostat will then keep room temperature at the selected level automatically.

### FROST PREVENTION MODE

With the function selector in position 3 and the thermostat dial in position ✱, the appliance maintains room temperature at about 5°C, preventing freezing with minimal energy consumption.

### MODELS WITH 24 HOUR TIMER

After setting the thermostat (see above), proceed as follows:

- turn the timer disk clockwise until the arrow on the timer ▲ lines up with the number corresponding to the current time.
- Set the times when you want the appliance to operate by pushing the teeth towards the outside. Each tooth corresponds to 15 minutes.
- place the selector in the ⌚ position. The appliance will now function each day at the times set.

To operate the appliance without the timer programming, place the selector in the "I" position. To go back to timed operation, just move the selector to the ⌚ position.

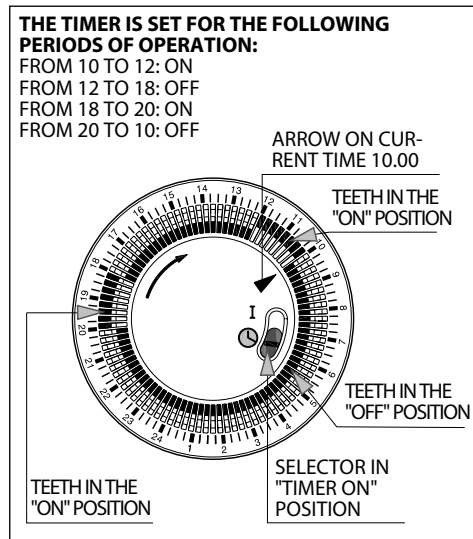

### MODELS WITH SWIVELLING BASE (ON/OFF pedal switch)

A number of models have a swivelling base and ON/OFF pedal switch.

The appliance can be manually oriented to an angle of 30° to the right or left to direct the air flow in the preferred direction.

To turn the appliance on, set the thermostat dial and function selector (and possibly also the timer) as described above, then press the pedal on the base.

To turn the appliance off, just press the pedal again.

**Important:** the appliance will come on only if you press the pedal.

### MODELS WITH MOTORISED ROTATING BASE

Some models have a motorised rotating base.

To distribute the air flow over a larger area, press the pedal. The appliance swings from right to left. To stop the appliance in the desired position, simply press the pedal again.

Models with motorised base are fitted with a tip-over switch which turns the appliance off if it falls over. To restart the appliance, simply place it upright again.

### MAINTENANCE

- Always unplug from the mains socket before cleaning.
- Clean the air intake and outlet grilles regularly.
- Do not use abrasive products or solvents to clean the appliance.

### IMPORTANT

- The appliance is designed and produced for domestic use only.
- Do not use this appliance near showers, baths, swimming pools, etc.
- Always use the heater in an upright position.
- Do not cover the appliance when in operation to avoid the risk of fire.
- Do not use the heater to dry laundry. Never obstruct the intake and outlet grilles (danger of overheating).
- The appliance is not intended for use by persons (including children) with reduced physical, sensory or mental capabilities, or lack of experience and knowledge, unless they have been given supervision or instruction concerning use of the appliance by a person responsible for their safety. Children must be supervised to ensure they do not play with the appliance.

- The heater must be positioned at least 50 cm from furniture, walls, curtains, or other objects.
- When the appliance is used in the portable configuration, do not place it near walls, furniture, curtains etc.
- The use of extension leads is not recommended. However if they cannot be avoided, follow the instructions accompanying the extension lead and never exceed the power limit marked on the extension.
- If the power cable is damaged, it must be replaced by the manufacturer, an authorised service centre or a qualified electrician in order to eliminate all risk.
- Do not use the appliance in rooms measuring less than 4 m<sup>2</sup>.

Models with motorised base are fitted with a tilt-switch which turns the appliance off if it falls over. To restart the appliance, simply place it upright again.

**The heater is fitted with a thermal cutout device** which switches the heater off in case of accidental overheating (eg. obstruction of air intake and outlet grilles, motor turning slowly or not at all). To reset, unplug the appliance from the mains socket for a few minutes, remove the cause of overheating then plug in again.

**CAUTION:** In order to avoid a hazard due to inadvertent resetting of the thermal cutout, this appliance must not be powered through an external switching device such as a timer, or connected to a circuit that is regularly switched on and off by the power provider.



**Important:** Never under any circumstances cover the appliance during operation as this would lead to dangerous overheating of the appliance.



### IMPORTANT INFORMATION FOR CORRECT DISPOSAL OF THE PRODUCT IN ACCORDANCE WITH EC DIRECTIVE 2002/96/EC.

At the end of its working life, the product must not be disposed of as urban waste. It must be taken to a special local authority differentiated waste collection centre or to a dealer providing this service.

Disposing of a household appliance separately avoids possible negative consequences for the environment and health deriving from inappropriate disposal and enables the constituent materials to be recovered to obtain significant savings in energy and resources. As a reminder of the need to dispose of household appliances separately, the product is marked with a crossed-out wheeled dustbin.

