

Proudly distributed by
De'Longhi Australia Pty Limited

P.O. BOX 4540
CASULA MALL NSW 2170
Customer Service Ph: 1800 126 659
Fax: 1800 706932
www.delonghi.com.au
e-mail: info.au@delonghigroup.com

De'Longhi New Zealand Limited

99 Khyber Pass Road
Grafton 1023
Auckland, New Zealand
P.O. Box 58-056 Botany
MANUKAU 2163
Customer Service Ph: 0508 200 300
Fax: 0508 200 301
www.delonghi.co.nz
e-mail: info.nz@delonghigroup.com

Register Now 
www.delonghi.com/register

TRD4 Series

DRAGON 4 OIL FILLED RADIATOR

Instructions for use



DeLonghi

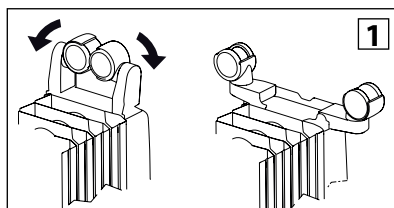
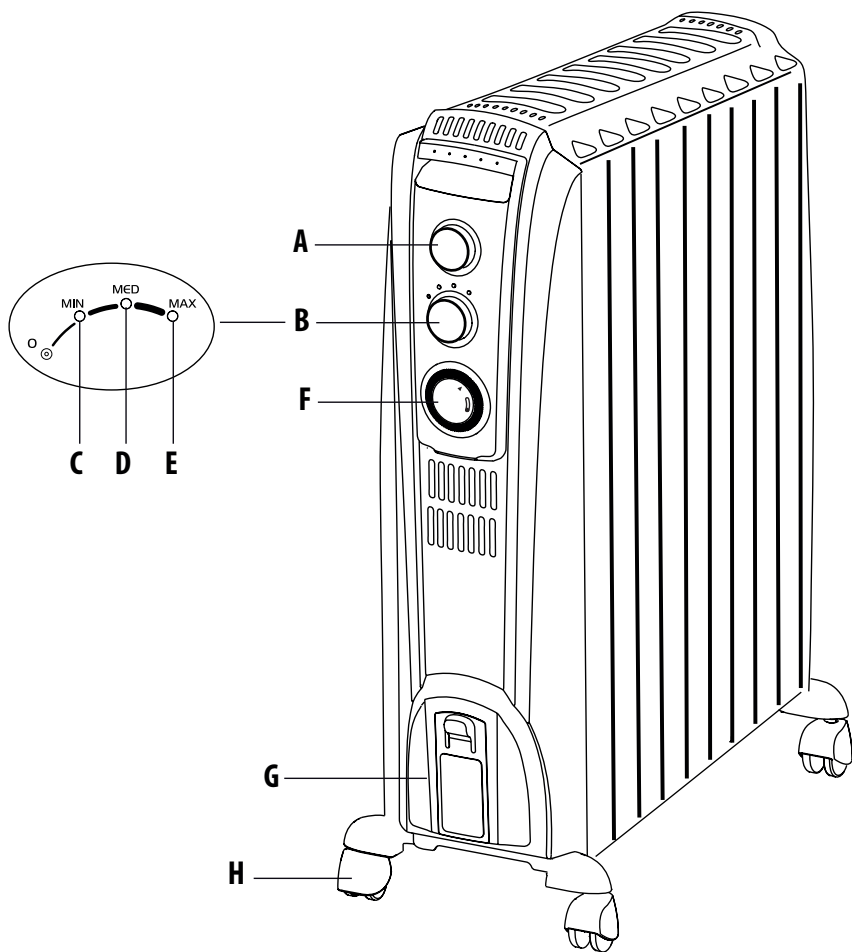

IMPORTANT WARNINGS

Read all the Instruction for Use carefully before using the appliance. Keep this Instructions for Use.



Danger!

Failure to observe the warning may result in life threatening injury by electric shock.

- Do not use the heater in the vicinity of bathtubs, wash basins, showers, sinks and swimming pools.
- Never use the heater to dry laundry.
- If the power cable has been damaged, it must be replaced by the manufacturer or the technical service centre or by a qualified person so as to avoid all risks.



Important!

Failure to observe the warning could result in injury or damage to the appliance.

- This appliance can be used by children aged from 8 years and above and persons with reduced physical, sensory or mental capabilities or lack of experience and knowledge if they have been given supervision or instruction concerning use of the appliance in a safe way and understand the hazards involved.

Children shall not play with the appliance. Cleaning and user maintenance shall not be made by children without supervision.

- Children of less than 3 years should be kept away unless continuously supervised.
- Children aged from 3 years and less than 8 years shall only switch on/off the appliance provided that it has been placed or installed in its intended normal operating position and they have been given supervision or instruction concerning use of the appliance in a

safe way and understand the hazards involved. Children aged from 3 years and less than 8 years shall not plug in, regulate and clean the appliance or perform user maintenance.

CAUTION — Some parts of this product can become very hot and cause burns. Particular attention has to be given where children and vulnerable people are present.

- **WARNING:** Do not use this heater in small rooms when they are occupied by persons not capable of leaving the room on their own, unless constant supervision is provided.
- The body of this radiator is filled with a precise quantity of special oil, so that repairs requiring the opening of the oil body must only be made by the service agent. Any oil leakage must be reported to the Customer Experience, see enclosed guarantee for details.
- When scrapping the heater, follow the regulations concerning the disposal of oil.
- The appliance must not be located immediately below a fixed socket-outlet.
- **CAUTION:** in order to avoid any danger caused by an accidental resetting of the safety system, this appliance must not be powered through an external timer.
- Do not obstruct the air intake and outlet area (danger of overheating).



Danger of burns!!

Failure to observe the warning could result in burns or scalds.

- **WARNING:** In order to avoid overheating, never under any circumstances cover the appliance during operation, as this would



lead to dangerous overheating.

- The use of an extension lead is not recommended, as overheating of the extension lead may occur during the operation of the heater.
- Never place the power cable on top of the heater while it is hot.
- Do not rest anything on the appliance.
- **WARNING:** To reduce the risk of fire, keep textiles, curtains, or any other flammable material a minimum distance of 1 m from the air outlet.



Please note:

This symbol indicates recommendations and important information for the user.

- We recommend that you not place the heater in a draught, because strong draughts of air may adversely affect the equipment's operational efficiency.
- Only use this heater on a horizontal and stable surface.
- Always use the appliance in an upright position.
- Do not use this heater if it has been dropped.
- Do not use if there are visible signs of damage to the heater.
- In order to eliminate the radiator's "new" smell, set it to maximum power for at least two hours when used for the first time. During this operation, the room in which the radiator is located must be ventilated. A little smoke due to the protective substances applied to the heating element before transport may be given off.
- Position the appliance so that the plug and the outlet can be easily reached.
- Do not use the appliance in rooms less than 4 m² in area.

- The appliance is fitted with a safety device which will switch off it in case of accidental overheating.
To reset, please contact Customer Experience, see enclosed guarantee.
- Before putting the appliance away, make sure it is completely cooled and unplugged from the mains socket.
Do not store in dusty atmospheres.
- The appliance must not be hung.

Fundamental safety warnings

Dear customer - the plug on the appliance heats up during use. This is completely normal. This HIGH POWER HEATING APPLIANCE complies with our usual high standards. You should, however, make sure that your power socket is in good condition and that the plug on the appliance is plugged into the socket correctly to avoid accidental overheating. If the appliance is used for long periods of time, we recommend checking the plug and mains socket regularly. If in doubt, consult an electrician.

For non-EU countries only:

This appliance is not intended for use by persons (including children) with reduced physical, sensory or mental capabilities, or lack of experience and knowledge, unless they have been given supervision or instruction concerning use of the appliance by a person responsible for their safety. Children should be supervised to ensure that they do not play with the appliance.

DESCRIPTION

- A** Thermostat
- B** Power selector
- C/D/E** Power indicator lights (MIN, MED, MAX)
- F** Timer
- G** Cord holder
- H** Wheel

USE

"Easy wheel" system

Turn the radiator upside down on a rug or soft surface to prevent damaging the paint finish. Fully unfold the wheels by turning them outwards (Fig. 1). Turn the radiator back to its upright position.

Caution

Always operate the heater in upright position only (wheels on the bottom, controls on top).

Any other position could create a hazardous situation.

Connection

- Before using the appliance check that your supply voltage is the same of that shown on the rating label of the unit and that the power socket and power supply line correspond to the load specified.
- Check also the current capacity of your fuses. **CONNECT YOUR HEATER TO EARTH PROVIDED SOCKET ONLY.**

Keep loose clothing or bedding, furniture and flammable material away from the heater's wall outlet.

Turning on

Insert the plug into an electrical outlet, rotate the thermostat knob to maximum and turn the unit on as follows using the power selector:

- Turn the power selector to position MIN to select minimum output (the min light will be on).
- Turn the power selector to position MED to select medium output (the min/med light will be on).
- Turn the power selector to position MAX to select maximum output (the lights will be on).

Adjusting the thermostat

When the room has reached the desired temperature, turn the thermostat knob slowly in an anti-clockwise direction until you hear a "click" and not beyond it. The thermostat will then adjust the set temperature automatically and keep it constant.

If your unit is a three-output version, in intermediate seasons or on days when temperatures are not particularly cold, select

minimum output to optimize savings and consumption.

Antifreeze function

Turn the thermostat dial to the **✱** position and the power selector to position MAX. The appliance will maintain a minimum room temperature of approximately 5°C, thus preventing freezing while conserving energy. In models that come with a timer, tabs must be set in the inward position.

Reminder

To completely shut the appliance off, turn the power selector to the "0" position and then unplug the appliance from the outlet.

UNITS WITH TIMER

How to use the timer

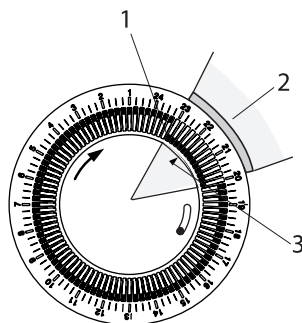

To program heating, proceed as follows:

- Look at the time on your clock or watch. If it is 10 p.m., turn the numbered timer disk clockwise until the number 22 (10 p.m.) on the disk coincides with the pointer **▲ (3)** on the timer. Set the periods of time when you want the appliance to work by pushing the teeth **(1)** inward. Each tooth **(1)** corresponds to a period of 15 minutes. This will leave visible sectors which correspond to the periods of operation **(2)**. When set, the radiator will operate automatically each day during the times programmed (important: the radiator must always be plugged into the socket).
- To change the programming, move the teeth back into the initial position and set the new periods of operation.
- To turn the appliance off completely, as well as turning the knob to the off position, you must also unplug it from the power outlet to avoid continued operation of the timer.

IMPORTANT: DO NOT ROTATE CLOCK DIAL COUNTER-CLOCKWISE.

The timer is like an electric clock, and will only work when

plugged into a power supply. When unplugged, the timer stops and must be later re-set.

Timer override

If you wish to override the timer settings, push the timer switch to position I (fig.2) manual (timer override). To return to timed operation push the switch back to the middle position  (fig.2).

NOTE: if the timer switch is at the 0 position (fig. 2), the heater is off and will not operate).

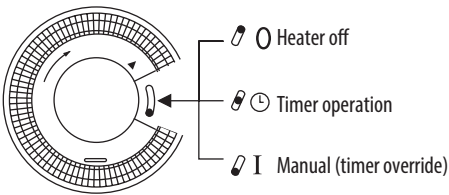

Safety device

A safety device shuts the radiator down in the case of overheating. To start the radiator up again, contact Customer Experience. See enclosed guarantee leaflet.

MAINTENANCE AND SERVICE

Always unplug the heater from the power outlet and allow the radiator to cool. Wipe radiator with a soft damp cloth; do not use detergents or abrasives. Should the radiator not be in use over a certain length of time, wind the cord around the holder

and store it in a dry place. This appliance has been built to last for many years of trouble-free service. In case of malfunction or doubt, do not try to repair the heater by yourself: this might increase the risk of fire and electric shock. Please refer to the enclosed guarantee leaflet for service and assistance details.

TROUBLESHOOTING

PROBLEM	CAUSE	SOLUTION
The appliance doesn't work	Be sure it is plugged in and that the electrical outlet is working.	Plug into the power outlet.
	Check for any obstruction.	Remove the obstruction and let the appliance cool down. If the appliance doesn't work please contact Customer Experience.
	The temperature may be set too low.	Set the temperature to a higher position.