

Register Now 
www.delonghi.com/register

KH77 Series

OIL FILLED RADIATOR

Instructions for use



DeLonghi

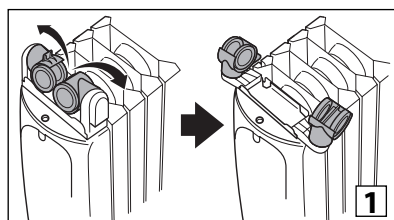
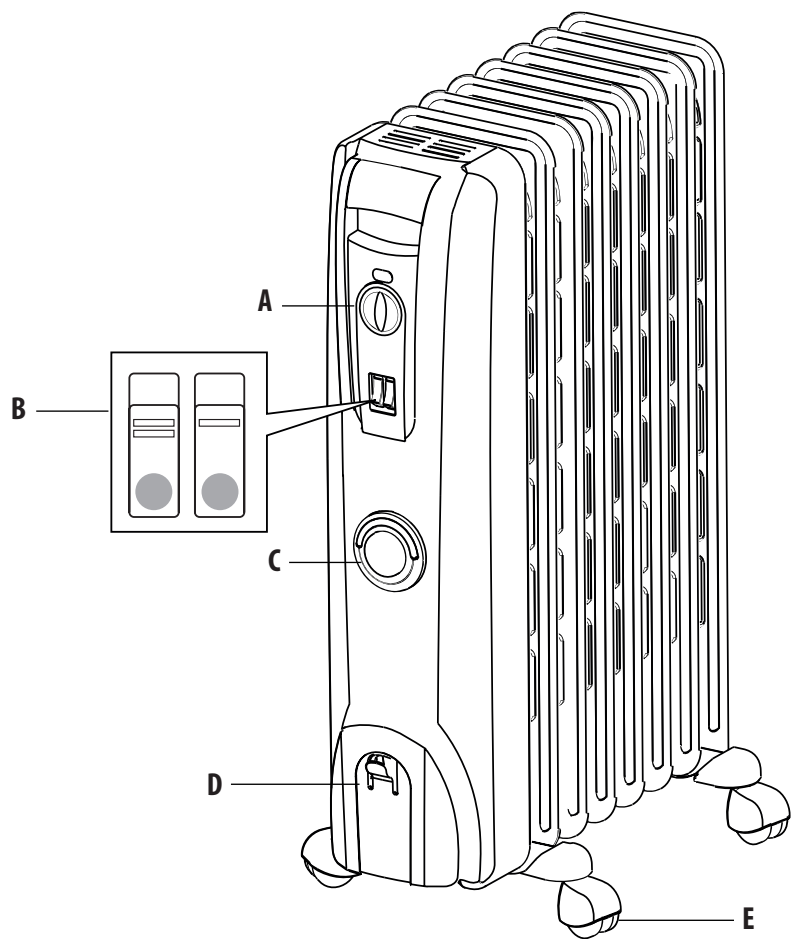

IMPORTANT WARNINGS

Read all the Instruction for Use carefully before using the appliance. Keep this Instructions for Use.



Failure to observe the warning may result in life threatening injury by electric shock.

- Do not use the heater in the vicinity of bathtubs, wash basins, showers, sinks and swimming pools.
- Never use the heater to dry laundry.
- If the power cable has been damaged, it must be replaced by the manufacturer or the technical service centre or by a qualified person so as to avoid all risks.



Failure to observe the warning could result in injury or damage to the appliance.

- This appliance can be used by children aged from 8 years and above and persons with reduced physical, sensory or mental capabilities or lack of experience and knowledge if they have been given supervision or instruction concerning use of the appliance in a safe way and understand the hazards involved.

Children shall not play with the appliance. Cleaning and user maintenance shall not be made by children without supervision.

- Children of less than 3 years should be kept away unless continuously supervised.
- Children aged from 3 years and less than 8 years shall only switch on/off the appliance provided that it has been placed or installed in its intended normal operating position and they have been given supervision or instruction

concerning use of the appliance in a safe way and understand the hazards involved. Children aged from 3 years and less than 8 years shall not plug in, regulate and clean the appliance or perform user maintenance.

CAUTION — Some parts of this product can become very hot and cause burns. Particular attention has to be given where children and vulnerable people are present.

- **WARNING:** Do not use this heater in small rooms when they are occupied by persons not capable of leaving the room on their own, unless constant supervision is provided.
- The body of this radiator is filled with a precise quantity of special oil, so that repairs requiring the opening of the oil body must only be made by the service agent. Any oil leakage must be reported to the Customer Experience, see enclosed guarantee for details.
- When scrapping the heater, follow the regulations concerning the disposal of oil.
- The appliance must not be located immediately below a fixed socket-outlet.
- **CAUTION:** in order to avoid any danger caused by an accidental resetting of the safety system, this appliance must not be powered through an external timer.
- Do not obstruct the air intake and outlet area (danger of overheating).



Failure to observe the warning could result in burns or scalds.

- **WARNING:** In order to avoid overheating, never under any 

circumstances cover the appliances during operation, as this would lead to dangerous overheating.

- The use of an extension lead is not recommended, as overheating of the extension lead may occur during the operation of the heater.
- Never place the power cable on top of the heater while it is hot.
- Do not rest anything on the appliance.
- **WARNING:** To reduce the risk of fire, keep textiles, curtains, or any other flammable material a minimum distance of 1 m from the air outlet.



Please note:

This symbol indicates recommendations and important information for the user.

- We recommend that you not place the heater in a draught, because strong draughts of air may adversely affect the equipment's operational efficiency.
- Use this heater on a horizontal and stable surface.
- Always use the appliance in an upright position.
- Do not use this heater if it has been dropped.
- Do not use if there are visible signs of damage to the heater.
- In order to eliminate the radiator's "new" smell, set it to maximum power for at least two hours when used for the first time. During this operation, the room in which the radiator is located must be ventilated. A little smoke due to the protective substances applied to the heating element before transport may be given off.
- Position the appliance so that the plug

and the outlet can be easily reached.

- Do not use the appliance in rooms less than 4 m² in area.
- The appliance is fitted with a safety device which will switch off it in case of accidental overheating.
To reset, please contact Customer Experience, see enclosed guarantee.
- Before putting the appliance away, make sure it is completely cooled and unplugged from the mains socket.
Do not store in dusty atmospheres.
- The appliance must not be hung.

Fundamental safety warnings

Dear customer - the plug on the appliance heats up during use. This is completely normal. This HIGH POWER HEATING APPLIANCE complies with our usual high standards. You should, however, make sure that your power socket is in good condition and that the plug on the appliance is plugged into the socket correctly to avoid accidental overheating. If the appliance is used for long periods of time, we recommend checking the plug and mains socket regularly. If in doubt, consult an electrician.

For non-EU countries only:

This appliance is not intended for use by persons (including children) with reduced physical, sensory or mental capabilities, or lack of experience and knowledge, unless they have been given supervision or instruction concerning use of the appliance by a person responsible for their safety. Children should be supervised to ensure that they do not play with the appliance.

Disposing of the appliance



The appliance must not be disposed of with household waste, but taken to an authorised waste separation and recycling centre.

DESCRIPTION

- A** Thermostat
- B** Switches
- C** Comfortemp button
- D** Cord holder
- E** Wheel

USE

“Easy wheel” system

Turn the radiator upside-down on a rug or a soft surface in order to prevent damaging the paint finish.

Fully unfold the castors by turning them outwards (Fig.1).

Turn the radiator back to its upright position.



Important!

When in use, the radiator should always be kept vertical (wheels at the bottom, controls at the top). Any other position could be dangerous!

Electrical connection

- Before plugging the radiator into the mains, check that the voltage of your mains electricity supply corresponds to the value V indicated on the appliance and that the socket and power line are appropriately dimensioned.
- CONNECT THE RADIATOR TO EFFICIENTLY EARTHED SOCKETS ONLY.

INSTRUCTIONS FOR USE

Switching on

Insert the plug, turn the thermostat dial clockwise to maximum. Turn on both switches. The lights on the switches remain on irrespective of the cycle set by the thermostat. When the room reaches the required temperature, turn the dial anticlockwise slowly until you hear a click. The appliance will come on and go off automatically to maintain the required temperature.

Economiser

For economy of use, the switches can be used singly:

- button in position «**MIN**» only = minimum power (light on)
- button in position «**MED**» only = medium power (light on)
- buttons in both positions «**MIN**» and «**MED**» = maxi-

mum power (lights on)



Please note: To turn the radiator off completely, place both switches in the OFF position.

Using the thermostat

The thermostat operates on the basis of room temperature and not radiator temperature. Turn the thermostat dial anticlockwise towards the lower numbers to reduce the temperature; turn it clockwise towards the higher numbers to raise the temperature. To turn the appliance off completely, turn the thermostat to minimum  and unplug from the mains.

Frost prevention mode

Turn the thermostat to the  position and press both switches. The appliance will maintain a room temperature of about 5°C, preventing the pipes from freezing while saving energy. In models with timer, push the teeth inwards.

COMFORTEMP BUTTON (only some models)

With the “COMFORTEMP” button and both switches pressed, the appliance is automatically set to reach and maintain what is considered to be the comfort temperature.

A green light comes on to indicate activation of “COMFORTEMP”. In this mode the temperature is automatically set only by the “COMFORTEMP”. To deactivate this mode and return to thermostat operation, press the COMFORTEMP button again (the green light goes off).

MAINTENANCE AND CUSTOMER SERVICES

Before performing any operations on the appliance, always unplug from the mains socket and leave to cool. Dust the radiator with a soft damp cloth without using detergents or abrasives. If the radiator is not used for a long period of time, wrap the cable around the cable tidy and store the appliance in a dry place. This appliance has been made to last many years without problems. In the event of malfunction or doubt, do not try and repair on your own. There would be the danger of fire or electric shock.

TECHNICAL CHARACTERISTICS

Supply voltage

See rating label

Absorbed power

“

TROUBLESHOOTING

PROBLEM	CAUSE	SOLUTION
The appliance does not work	The appliance is not plugged into a mains socket	Plug into the mains socket
	The socket is not working properly	Make sure the socket is working
	There are obstructions.	Remove the obstruction and wait until the appliance has cooled down. If the appliance does not work, contact Customer Services
	The set temperatures may be too low	Set a higher temperature