

# IMPORTANT SAFEGUARDS

When using any electrical appliance, some basic safety precautions should always be observed to reduce the risk of fire, electric shock, and/or injury to persons. Read all instructions carefully before using the appliance. Specifically:



## **Danger!**

Failure to observe the warning may result in life threatening injury by electric shock.

- The appliance must not be placed immediately under a fixed power socket.
- Do not use the appliance outdoors.
- This heater is not intended for use in bathrooms, laundry areas, or similar indoor locations. Never position the appliance where it may fall into a bathtub or come in contact with water.
- If the power cable is damaged, stop using the product. Power cable must be replaced by the manufacturer, an authorised service centre or a qualified electrician in order to eliminate all risk.
- Do not use this heater in the immediate surroundings of a bath, a shower or a swimming pool.
- Do not insert or allow foreign objects to enter any ventilation or exhaust opening as this may cause an electric shock, fire, or damage the heater.



## **Important!**

Failure to observe the warning could result in injury or damage to the appliance.

- The appliance is not intended for use by persons (including children) with reduced physical, sensory or mental capabilities, or lack of experience and knowledge, unless they have been given supervision or instruction concerning use of the appliance by

a person responsible for their safety. Children should be supervised to ensure that they do not play with the appliance.

- **CAUTION — Some parts of this product can become very hot and cause burns. Particular attention has to be given where children and vulnerable people are present.**

- The internal parts of the appliance can become very hot or produce sparks during operation. Do not use the appliance in areas where gasoline, paints, or other flammable liquids are used or stored.
- This heater is filled with a precise quantity of special oil. Repairs requiring opening of the oil container are only to be made by the manufacturer or his service agent who should be contacted if there is an oil leak; when scrapping the heater, follow the regulations concerning the disposal of oil.
- **ATTENTION:** To avoid the safety system resetting accidentally, this appliance must not be powered through an external on/off device such as a timer, or connected to a circuit which is turned off and on regularly by the energy supplier.
- Do not use the appliance in small rooms when they are occupied by persons that are not capable of leaving the room, unless constant supervision is provided.
- Always disconnect the plug from the power outlet when the appliance is not in use.
- Do not wrap the cord around the appliance immediately after use.

- When the appliance is in use unwrap the cord from the cord holder.
- The appliance must not be located immediately below a fixed socket-outlet.



**Danger of burns!!**

Failure to observe the warning could result in burns or scalds.

- **WARNING:** To avoid overheating, never under any circumstances  cover the appliance during operation as this would lead to a dangerous rise in temperature, and risk of fire.  
Do not use the appliance on soft surfaces, such as beds, where the openings may become blocked.
- Do not run the power cord under carpeting. Do not cover cord with throw rugs, runners, or the like. Keep the cord away from any passageways where it could be tripped over.



**Please note:**

This symbol indicates recommendations and important information for the user.

- Always use the appliance in an upright position.
- Do not use this appliance with an extension cord or outlet strip. Connect the appliance directly to a suitable outlet.
- Make sure that the plug is fully inserted into the outlet. Wall outlets may deteriorate with time, so check the plug periodically for signs of overheating or deformation. If the outlet has deteriorated, stop using it and have it repaired.
- To prevent burns, do not touch hot surfaces with bare skin. Use the handle when moving the appliance. Keep all flammable materials, such

as furniture, pillows, bedding, paper, clothing, and curtains at least 90 cm (3 feet) from the front and top of the appliance also avoid contact with the sides and back.

- Do not use the appliance in rooms with a floor area of less than 4m<sup>2</sup>.
- Before putting the appliance away, make sure it is completely off and unplugged from the mains socket. Wrap the cable around the base. Do not store in dusty atmospheres.
- Do not rest anything on the appliance.
- Do not use the appliance to dry laundry. Do not obstruct the air intake and outlet grilles (danger of overheating).
- Do not use the appliance near walls, furniture, curtains, etc.
- Do not place the heater near a bed because objects such as pillows or blankets can fall off the bed and be ignited by the heater.
- Never place the power cable on top of the heater while it is hot.
- We recommend that you not place the heater in a draught, because strong draughts of air may adversely affect the equipment's operational efficiency.
- The first time you use the appliance, operate it of at least 2 hours with the thermostat at maximum to eliminate the "new" smell.  
A little smoke due to the protective substances applied to the heating element before transport may be given off.
- Position the appliance so that the plug and the outlet can be easily reached even after installation.
- The appliance is fitted with a safety

device which will switch off it in case of accidental overheating. To reset, please contact Customer Experience, see enclosed guarantee.

## SAVE THESE INSTRUCTIONS

### THIS PRODUCT IS FOR HOUSEHOLD USE ONLY

#### DESCRIPTION

(see fig. 1)

- A Thermostat
- B Switches
- C Cord holder

#### USE

##### Fitting the wheels

Remove the feet and the wheels from the polystyrene packing. Turn the radiator upside-down on a rug or a soft surface in order to prevent damaging the paint finish.

- Fit the wheels to the spindles on the feet and push firmly until they click into position. Pull each wheel to check that it is correctly inserted.
- The feet with the casters must be fitted with two arc-shaped brackets and fit them using the threaded bar and wing nut provided, only between the 1st and 2nd element and the second to last (see fig. 1 to 3 inclusive).

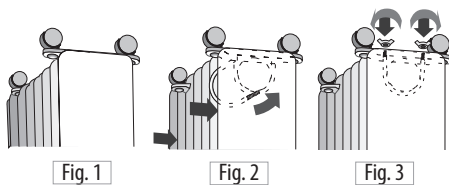

##### Models with "easy wheel" system

Turn the radiator upside-down on a rug or a soft surface in order to prevent damaging the paint finish. Fully unfold the castors by turning them outwards (Fig. 4). Turn the radiator back to its upright position.

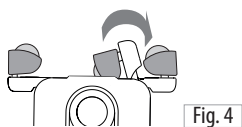

**Please note:** Always operate the heater in upright position only (wheels on the bottom, controls on top). Any other position could create hazardous situation.

##### Watts economizer

For more economical use, the Min. or Med. Watt switches may be used individually, after unit has reached the operating temperature.

With pilot lights ON, the heater is ON.

ON/OFF Switches

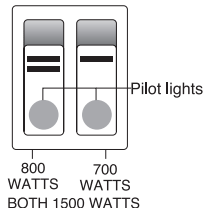

##### Location

Place heater on the floor beneath the coldest window in the room, or any other location. Your heater will reduce the effect of cold drafts. The heater should not be placed immediately below a power outlet.

Do not use this radiator in rooms with a floor area of less than 43 square feet (4 sq. m.).

##### Connection

The radiator should be connected to a properly polarized A/C 120 V household outlet in perfect working conditions. Keep loose clothing or bedding, furniture and flammable material away from the heater's wall outlet.

##### Turning on two-switch models

Turn the thermostat clockwise to its maximum position. Push down both switches. The switch lights stay on independently of the thermostat cycling. When room reaches the desired temperature, turn the thermostat knob counter-clockwise very slowly and carefully until you hear a click. This should set your heater to maintain the desired temperature by cycling on and off as required.



**Please note:** The heater normally requires about 15 minutes to reach the desired temperature.

##### Use of thermostat

The thermostat operates according to room air temperature, rather than radiator temperature.

Turning it counter-clockwise to smaller numbers would decrease the temperature; clockwise to greater numbers would increase the temperature.

**Antifreeze function**

Turn the thermostat dial to the ✖ position and push the switches on.  
The appliance will maintain a minimum room temperature of approximately 5°C (41°F), thus preventing freezing while conserving energy.

 **Please note:** To completely shut the heater off, MIN/MED switches must be set in the “0” position.

**Your product is equipped with a polarized alternating current line plug (a plug having one blade wider than the other). There is only one way it can be plugged into a power supply. This is a safety feature. If you are unable to insert the plug fully into the outlet, try again by turning it the other way. If it would still not go in, it is probably due to an obsolete outlet which should be replaced. Do not temper with the plug or outlet to defeat the purpose of this safety mechanism.**

**A safety device**  
A safety device switches the heater off in the event of overheating. To restart the heater, call the nearest Service center.

**MAINTENANCE AND SERVICE**

Always unplug the heater from the power outlet and allow the radiator to cool. Wipe radiator with a soft damp cloth; do not use detergents and abrasives. Should the radiator not be in use over a certain length of time, roll the cable around the holder and store it in a dry place (see fig. on front page).  
This appliance has been built to last for many years of trouble-free service. In case of malfunction or doubt, do not try to repair the heater by yourself: this might increase the risk of fire and electric shock. Contact the De'Longhi Customer Service.

**TROUBLESHOOTING**

PROBLEM	CAUSE	SOLUTION
The appliance doesn't work	Be sure it is plugged in and that the electrical outlet is working.	Plug into the power outlet.
	Check that the unit is not covered.	Let the appliance cool down. If the appliance doesn't work please contact the De'Longhi Customer Service.
	The temperature may be set too low.	Set the temperature to a higher position.