



De'Longhi Appliances
via Seitz, 47
31100 Treviso Italia
www.delonghi.com

Instructions for use

ICM2.1 ICM4.1 COFFEE MAKER



electrical connection (UK only)

- A) If your appliance comes fitted with a plug, it will incorporate a 13 Amp fuse. If it does not fit your socket, the plug should be cut off from the mains lead, and an appropriate plug fitted, as below.

WARNING: Very carefully dispose of the cut off plug after removing the fuse: do not insert in a 13 Amp socket elsewhere in the house as this could cause a shock hazard.

With alternative plugs not incorporating a fuse, the circuit must be protected by a 15 Amp fuse. If the plug is a moulded-on type, the fuse cover must be re-fitted when changing the fuse using a 13 Amp Asta approved fuse to BS 1362. In the event of losing the fuse cover, the plug must NOT be used until a replacement fuse cover can be obtained from your nearest electrical dealer. The colour of the correct replacement fuse cover is that as marked on the base of the plug.

- B) If your appliance is not fitted with a plug, please follow the instructions provided below:

WARNING - THIS APPLIANCE MUST BE EARTHED

IMPORTANT

The wires in the mains lead are coloured in accordance with the following code:

Green and yellow:	Earth
Blue:	Neutral
Brown:	Live



As the colours of the wires in the mains lead may not correspond with the coloured markings identifying the terminals in your plug, proceed as follows:

The green and yellow wire must be connected to the terminal in the plug marked with the letter E or the earth symbol  or coloured green or green and yellow.

The blue wire must be connected to the terminal marked with the letter N or coloured black.

The brown wire must be connected to the terminal marked with the letter L or coloured red.

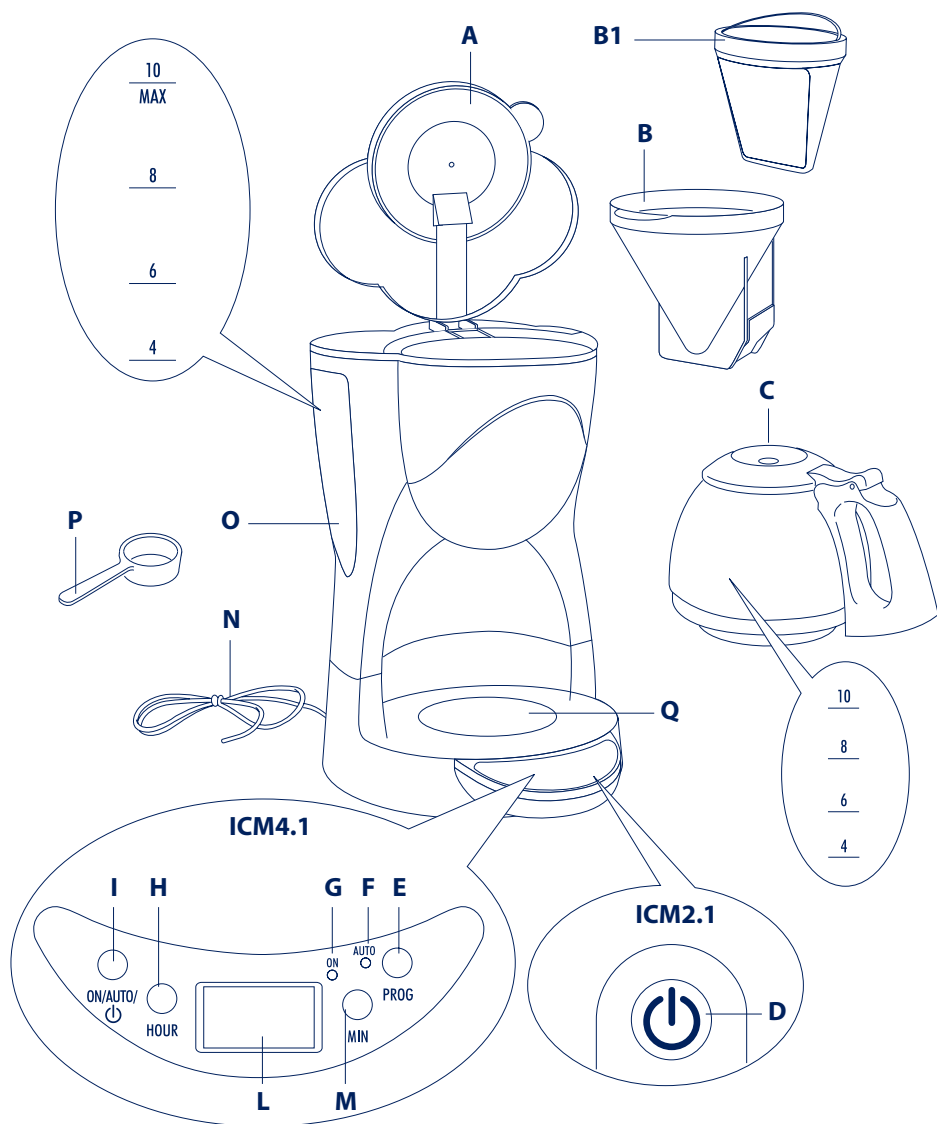

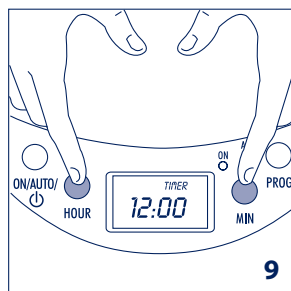
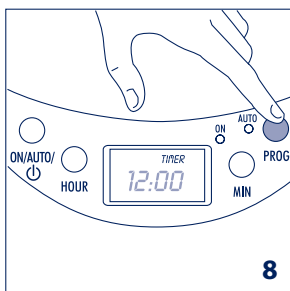
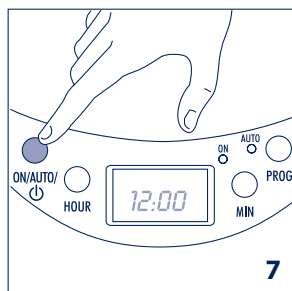
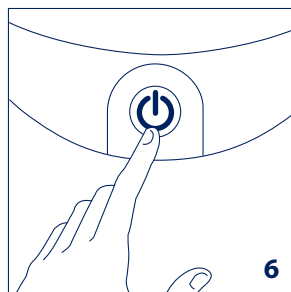
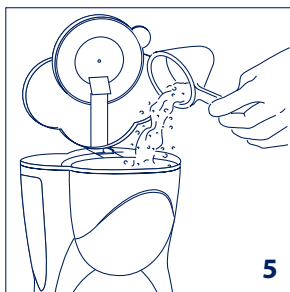
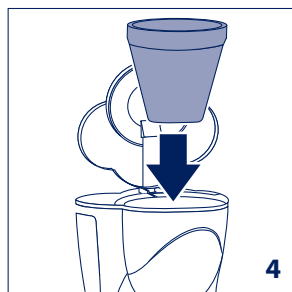
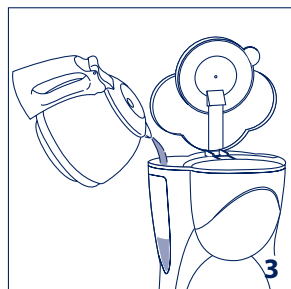
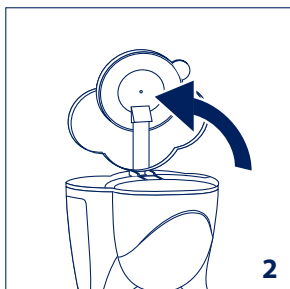
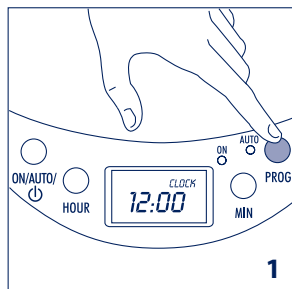



Please note:

This symbol identifies important advice or information for the user.

- Read this instruction booklet carefully before installing and using the appliance. This is the only way to ensure the best results and maximum safety for the user.

- This is a household appliance only.

It is not intended to be used in: staff kitchen areas in shops, offices and other working environment; farm houses; by clients in hotels, motels and other residential type environments; bed and breakfast type environments

Any other use is considered improper and thus dangerous.

- Materials and accessories coming into contact with food conform to EEC regulation 1935/2004.
- After positioning the appliance on the work top, leave a space of at least 5 cm between the surfaces of the appliance and the side and rear walls and at least 20 cm above the coffee maker.



Danger of burns!

Failure to observe the warning could result in scalds or burns.

- This appliance is designed and made to “prepare coffee”. Be careful to avoid being scalded by spraying water or steam or due to improper use of the appliance.
- When using the appliance do not touch the hot surfaces. Use the knobs or handles.
- Never touch the appliance with wet or damp hands or feet.
- The warming plate remains hot after the appliance has been used.



Important!

Failure to observe the warning could result in injury or damage to the appliance.

- The manufacturer is not liable for damage caused by inappropriate, incorrect or irresponsible use.
- In the event of failure or malfunction, unplug the appliance from the mains. If it requires repair, contact De'Longhi Customer Services only and ask for original spare parts to be used. Failure to respect the above could jeopardise the

safety of the appliance.

- This appliance can be used by children aged from 8 years and above and persons with reduced physical, sensory or mental capabilities or lack of experience and knowledge if they have been given supervision or instruction concerning use of the appliance in a safe way and understand the hazards involved.

Children shall not play with the appliance. Cleaning and user maintenance shall not be made by children without supervision.

- After removing the packaging, make sure the appliance is complete and undamaged. If in doubt, do not use the appliance and contact qualified personnel only.
- The packing elements (plastic bags, polystyrene foam, etc.) should be kept out of reach of children as they are a safety hazard.
- Place the appliance on a work surface far away from water taps, basins and sources of heat.
- Never install the appliance in environments where the temperature may reach 0°C or lower (the appliance may be damaged if the water freezes).



Danger!

Failure to observe the warning may result in life threatening injury by electric shock.

- The power cable of this appliance must not be replaced by the user as the operation requires the use of special tools.

If it is damaged or must be replaced, contact De'Longhi Customer Services to avoid all risk.

- Never immerse the coffee maker in water. It is an electrical appliance.
- Unplug the appliance and turn off the main switch when not in use. Do not leave the appliance switched on unnecessarily.
- As with all electrical appliances, use the coffee maker with care and common sense, particularly in the presence of

- children.
- Check that the voltage of the mains power supply corresponds to the value indicated on the appliance rating plate. Connect the appliance to an efficiently earthed electrical socket with a minimum rating of 10A only. The manufacturer declines all liability for any accidents caused by the absence of an efficient earth system.
- If the power socket does not match the plug on the appliance, have the socket replaced with a suitable type by a qualified electrician.
- When filling the water tank or removing the jug from the machine, avoid spilling liquid on the plug or power cable.

Technical data

Mains voltage:	220-240V-50/60Hz
Absorbed power:	1000W
Weight:	1880g

Disposing of the appliance



In compliance with European directive 2002/96/EC, the appliance must not be disposed of with household waste, but taken to an authorised waste separation and recycling centre.



The appliance complies with the following EC directives:

- Low Voltage Directives 2006/95/EC and subsequent amendments;
- EMC Directive 2004/108/EC and subsequent amendments;
- EC Regulation 1275/2008 for standby.

Description of appliance

- A. Lid
- B. Filter holder for drip coffee
- B1. Permanent filter (certain models only)
- C. Jug

Control panel ICM2.1

- D. "ON/STAND-BY" button with on light

Control panel ICM4.1

- E. PROG button
- F. AUTO indicator light
- G. ON indicator light
- H. HOUR button
- I. ON/AUTO/ button

- L. Display
- M. MIN button
- N. Power cable
- O. Water tank
- P. Measure
- Q. Warming plate

Setting the clock (ICM4.1 only)

Plug the appliance into the mains socket.

When switched on for the first time, the display will show "12:00".

To set the exact time, proceed as follows:

- Press the PROG button (E) (fig. 1). The word "CLOCK" appears on the display.
- Press the HOUR button (H) repeatedly until setting the current hour.
- Press the MIN button (M) repeatedly until setting the current minutes.
- Keeping the buttons pressed scrolls the hours and minutes much more quickly.
- To return to the current time, press the PROG button (E) twice or wait 10 seconds.

The time can be set whenever desired.

How to prepare the drip coffee

- Lift the lid (A) (Fig. 2).
- Fill the water tank (O) (the jug (C) gives an indication of the levels) with fresh clean water up to the mark corresponding to the number of cups of coffee to be prepared (fig. 3).
- Place the permanent filter (B1) (if supplied) or paper filter, into the filter holder (B) (fig. 4).
- Place the ground coffee in the filter, using the measuring spoon supplied (P), and level evenly (Fig. 5). As a general rule, use a level measuring spoon of ground coffee for each cup (for example, 10 spoons to make 10 cups). The quantity of ground coffee used may, however, be varied according to personal taste. Use good quality, medium ground coffee, packaged for drip coffee makers.
- Close the lid (A) and place the jug (C) with the lid in place, on the hot plate.
- ICM2.1 only:** Press the button (D) (fig. 6). The light on the switch indicates that the coffee maker is operating. Coffee delivery will start after a few seconds. It is completely normal for the appliance to give off steam while the

coffee is percolating. The coffee maker emits a beep when delivery begins, then three beeps when it ends. If you leave the ☺ button (D) pressed after percolation has finished, the plate will keep the coffee at the ideal temperature. The appliance goes off automatically 40 minutes after coffee delivery ends.

To turn the warming plate off press the ☺ button (D) again.

For a new brewing cycle switch off the appliance pressing ☺ button (D) and restart.

- **ICM4.1 only:** Press the ON/AUTO/☺ button (I) (fig. 7). The light (G) indicates that the coffee maker is operating. Coffee delivery will start after a few seconds. It is completely normal for the appliance to give off steam while the coffee is percolating. The coffee maker emits a beep when delivery begins, then three beeps when it ends. If you leave the ON/AUTO/☺ button (I) pressed after percolation has finished, the plate will keep the coffee at the ideal temperature. The appliance goes off automatically 40 minutes after coffee delivery ends.

To turn the warming plate off press the ON/AUTO/☺ button (I) again.

For a new brewing cycle switch off the appliance pressing ON/AUTO/☺ button (I) and restart.

Programming start-up (ICM4.1 only)

Check that the current time is set correctly. To set the time to start preparing the coffee.

- Press the PROG button (E) twice (fig. 8): the word "TIMER" appears on the display;
- Press the HOUR (H) and MIN (M) buttons (fig. 9) repeatedly until reaching the desired start time;
- Press PROG button again. Keeping the buttons pressed scrolls the hours and minutes much more quickly.
- To return to the current time, press the PROG button (E) twice or wait 10 seconds.

The start-up time is now programmed. To operate in AUTO mode, prepare the appliance to make the coffee then press the ON/AUTO/☺ button (I) twice until the AUTO indicator light (F) comes on.

Cleaning and maintenance

Before performing any cleaning or maintenance operations, turn the machine off, unplug it from the power socket and allow it to cool down.

- When cleaning the coffee maker, do not use solvents or

abrasive detergents. A soft, damp cloth is sufficient.

- Never immerse the coffee maker in water: it is an electrical appliance.

Descaling

If the water in your area is hard, limescale builds up over time. These deposits may affect correct operation of the appliance. You are recommended to descale the coffee maker every 60 coffee making cycles. To descale, always use special commercially available descaling products for drip coffee makers.

1. Dilute the product in the jug, following the instructions on the descaler pack;
2. Pour the solution into the water tank;
3. Place the jug on the warming plate;
4. Press the ☺ button (D) or ON/AUTO/☺ button (I), percolate the equivalent of one cup then turn the appliance off;
5. Leave the solution to work for 15 minutes, then repeat operations 4 and 5.
6. Turn the appliance on and deliver the water until the tank is completely empty.
7. Rinse by operating the appliance with water only at least 3 times (3 complete tanks of water).

Failure to clean as described above invalidates the guarantee.

Troubleshooting

Problem	Probable cause	Solution
The drip coffee takes longer to percolate	The drip coffee maker needs to be descaled	Perform the descaling procedure as described in the paragraph "Descaling"
The coffee has an acid flavour	The coffee maker has not been rinsed sufficiently	Rinse the appliance as described in the chapter "Descaling"