

instructions

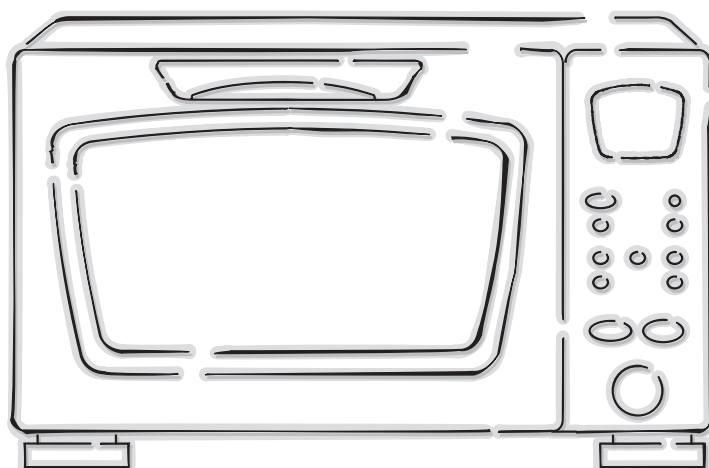

Microwave grill oven with *Pasta* feature MW755



Living innovation

Data and instruction for Performance Tests according to IEC 705 and further Amendment Document 59H/69/CD.

The International Electrotechnical Commission SC 59H, has developed a Standard for comparative testing of heating performances of microwave ovens. The Draft of the new Edition of this Standard has been circulated with Document 59H/69/CD, which also describes the tests marked, in this table, with (*).

We recommend the following for this oven:

Test Nr. on standard	Item	Duration	Function	Power Level	Weight	Standing time	Note
A	Egg custard	16 min.	only mw	900 W	750 gr	5 min	The upper surface shall be evaluated after the standing time. The inner custard evaluation shall be conducted after two hours.
B	Sponge cake	7 min.	only mw	900 W	475 gr	5 min	Use the borosilicate glass container stated in the Standard (max. dia. 210 mm) or a Pyrex® glass container dia. 210 mm, height 50 mm and wall thick 6 mm. Put the container on the low wire rack placed on the turntable.
C	Meat loaf	20 min.	only mw	700 W	900 gr	5 min	Cover the container with cling film and pierce the film. Use the rectangular borosilicate glass container stated in the Standard or the Arcopal® Cat. nr. Z1/B8 (01)10460-1.
Defrosting	Defrosting minced meat	11 min.	only mw		500 gr	15 min	Place the frozen load directly on the turntable (I). Turn the food over halfway through the defrosting time.
D (*)	Potato gratin	20 min.	combi mw + grill (simult.)	900 W	1100 gr	5 min	Use the borosilicate glass container stated in the Standard (max. dia. 210 mm) or a Pyrex® glass container dia. 210 mm, height 50 mm and wall thick 6 mm. Put the container on the lower wire rack (F) placed on the turntable. Do not preheat the oven.
F (*)	Poultry	45 min.	combi mw + grill (simult.)	700 W	1200 gr	5 min	The following instruction shall be strictly observed for this type of load: put the chicken in a pyrex® glass container dia 210 mm, height 50 mm and wall thickness of 6 mm. Turn the food over halfway through the cooking time.

ELECTRICAL CONNECTION (U.K. ONLY)

- A) If your appliance comes fitted with a plug, it will incorporate a 13 Amp fuse. If it does not fit your socket, the plug should be cut off from the mains lead, and an appropriate plug fitted, as below.
WARNING: Very carefully dispose of the cut off plug after removing the fuse: do not insert in a 13 Amp socket elsewhere in the house as this could cause a shock hazard.
 With alternative plugs not incorporating a fuse, the circuit must be protected by a 15 Amp fuse.

WARNING - THIS APPLIANCE MUST BE EARTHED **IMPORTANT**

The wires in the mains lead are coloured in accordance with the following code:

Green and yellow:	Earth
Blue:	Neutral
Brown:	Live



- If the plug is a moulded-on type, the fuse cover must be re-fitted when changing the fuse using a 13 Amp Asta approved fuse to BS 1362. In the event of losing the fuse cover, the plug must NOT be used until a replacement fuse cover can be obtained from your nearest electrical dealer. The colour of the correct replacement fuse cover is that as marked on the base of the plug.
- B) If your appliance is not fitted with a plug, please follow the instructions provided below:

As the colours of the wires in the mains lead may not correspond with the coloured markings identifying the terminals in your plug, proceed as follows:

The green and yellow wire must be connected to the terminal in the plug marked with the letter E or the earth symbol  or coloured green or green and yellow.
 The blue wire must be connected to the terminal marked with the letter N or coloured black.
 The brown wire must be connected to the terminal marked with the letter L or coloured red.

SECTION 1 – SETTING UP

1.1 MICROWAVE OVEN AND CONTROL PANEL DESCRIPTION

Description of appliance

The following terms are used throughout the instruction manual

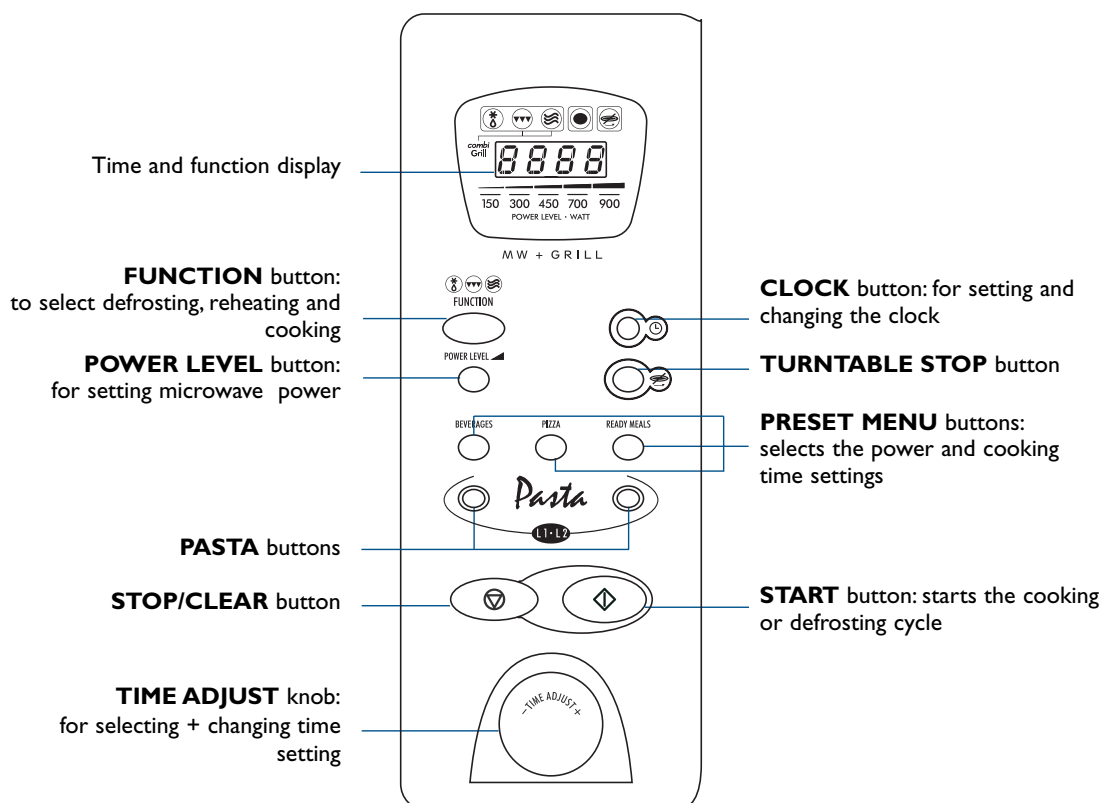

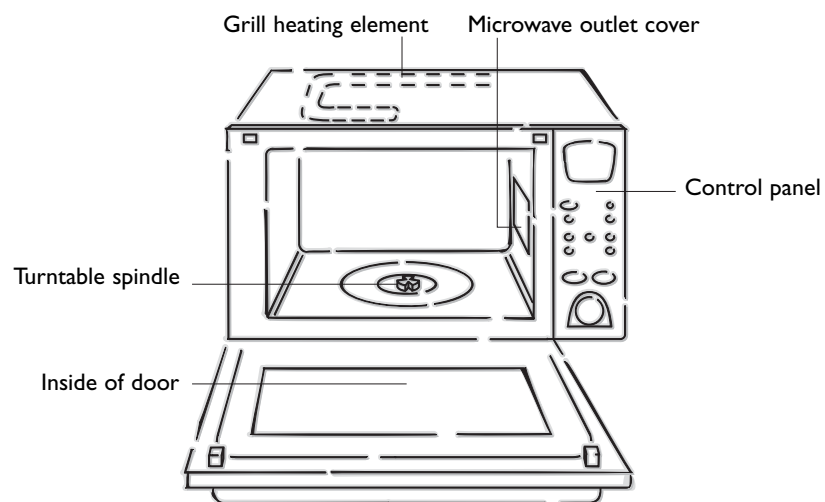
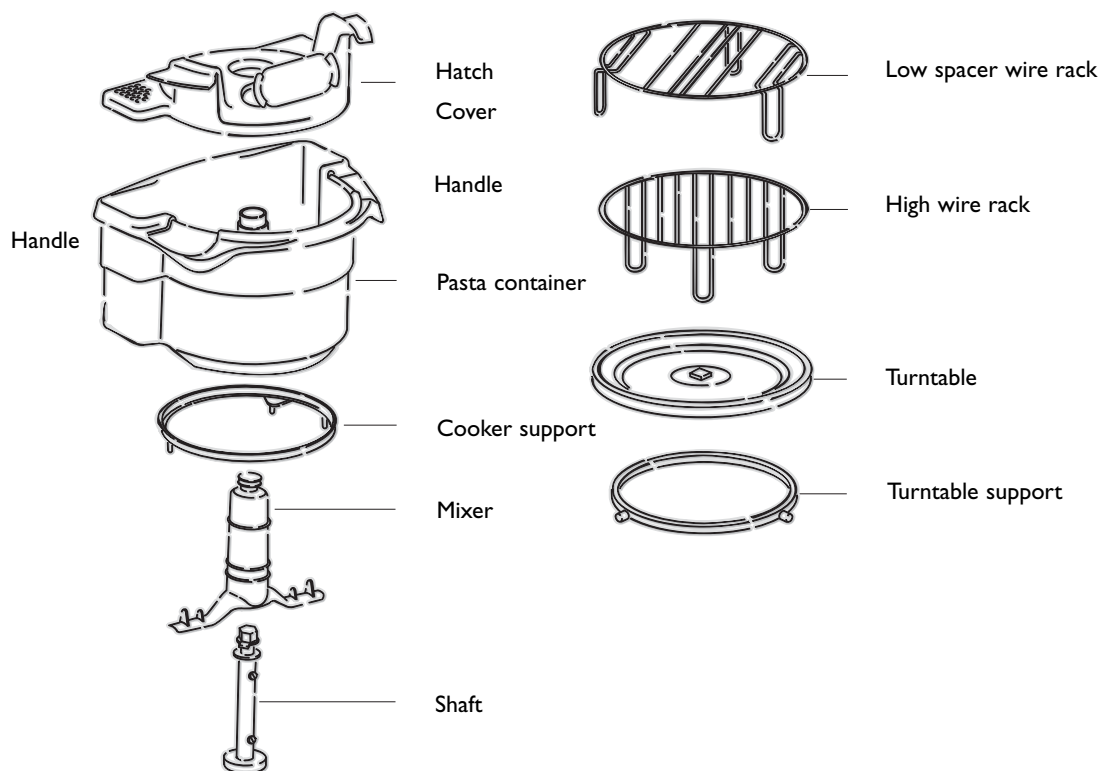

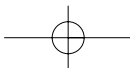

INDEX

SECTION 1 - SETTING UP	1.1 Microwave oven and control panel description.....pag.	4
	1.2 Oven accessories.....pag.	6
	1.3 Unpacking and installation.....pag.	7
	1.4 Utensils and cookware.....pag.	8
	1.5 Guidelines and safetypag.	9
	1.6 Safety warningspag.	10
	1.7 Technical data.....pag.	11
 SECTION 2 – USING THE MICROWAVE OVEN FUNCTIONS		
	2.1 Setting the clockpag.	12
	2.2 Operating your microwave ovenpag.	13
	2.3 Automatic defrosting and cook sequencepag.	15
	2.4 Preset menuspag.	16
	2.5 Quick start cookingpag.	16
	2.6 Child lockpag.	16
	2.7 Turntable stop buttonpag.	16
	2.8 “Memotime” functionpag.	16
SECTION 3 - USING THE <i>Pasta</i> FUNCTION	3.1 Introductionpag.	18
	3.2 Using the cooker and setting the controlspag.	18
	3.3 Important warningspag.	21
 SECTION 4 – USING THE OVEN		
	4.1 Defrostingpag.	22
	4.2 Reheatingpag.	23
	4.3 Cooking antipasti, first coursespag.	24
	4.4 Cooking meatpag.	24
	4.5 Cooking vegetablespag.	25
	4.6 Cooking fish.....pag.	26
	4.7 Cooking desserts and cakespag.	26
	4.8 Preset menus - Programme cookingpag.	27
	4.9 Simultaneous cooking on 2 levelspag.	28
 SECTION 5 – CLEANING AND MAINTENANCE		
	5.1 Cleaning.....pag.	30
	5.2 Problem solving.....pag.	31

