

MACCHINA DA CAFFÉ
COFFEE MAKER
CAFETERIE
KAFFEEAUTOMATEN
KOFFIEZETTER
CAFETERA
CAFETEIRA
ΜΗΧΑΝΗ ΚΑΦΕ
KAHVINKEITIN
ESPRESSOMASKIN
KAFFEMASKINE
ESPRESSOMASKIN
ΚΑΒΕΦΟΖΟΓΕΡ
ΚΑΒΟΒΑΡ
EKSPRES DO KAWY
ΚΟΦΕΒΑΡΚΑ

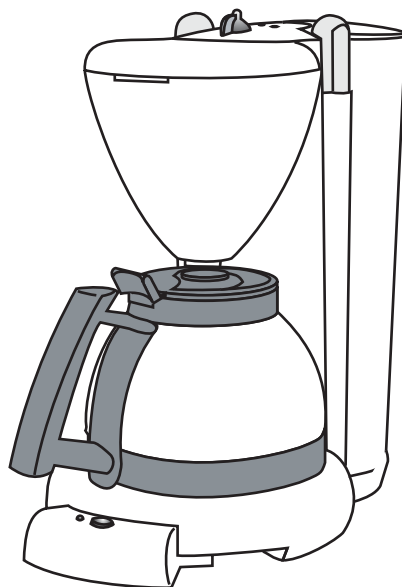

Istruzioni per l'uso
Owner's instructions
Mode d'emploi
Bedienungsanleitung
Gebruiksaanwijzingen
Instrucciones para el uso
Manual de instruções
Οδηγες χρήσης
Instructions for use
Käyttöohjeet
Bruksanvisning
Brugervejledning
Bruksanvisning
Kezelési utasítás
Návod k použití
Instrukcja użytkowania
Инструкция по эксплуатации

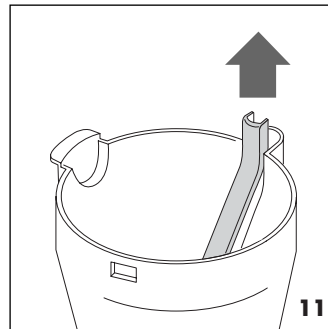

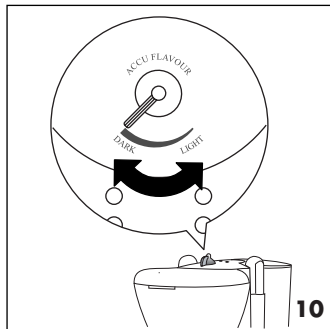
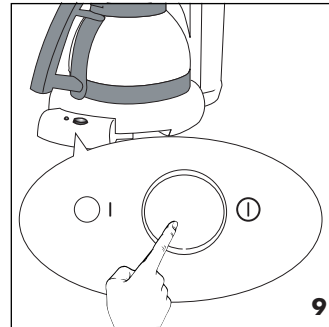
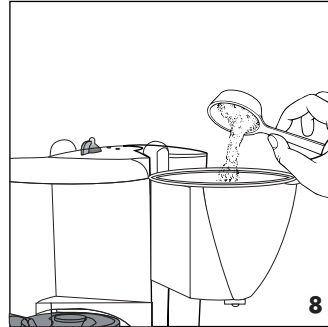
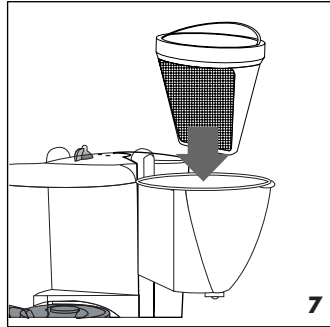
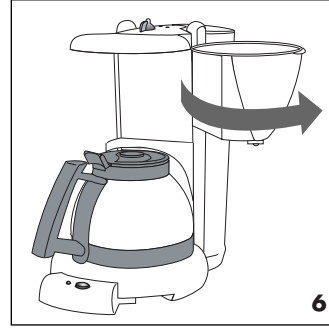
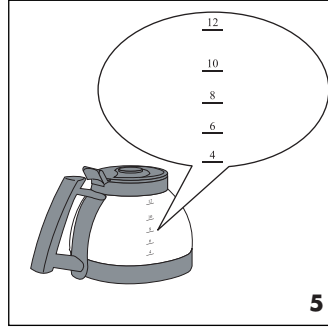
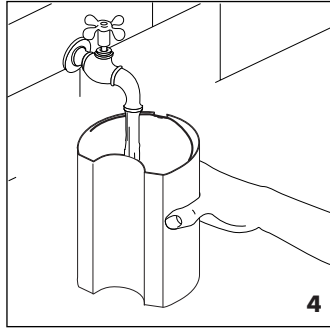
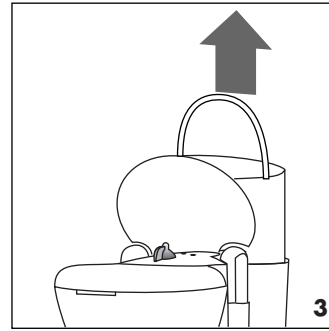
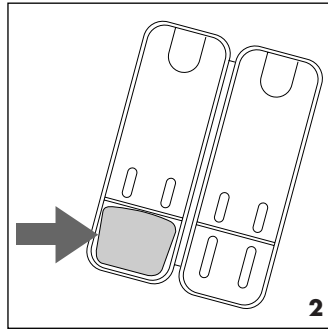
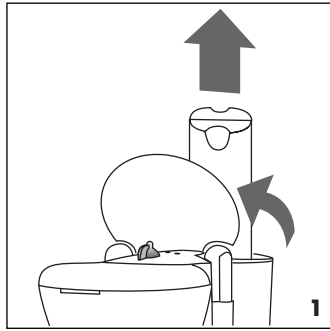
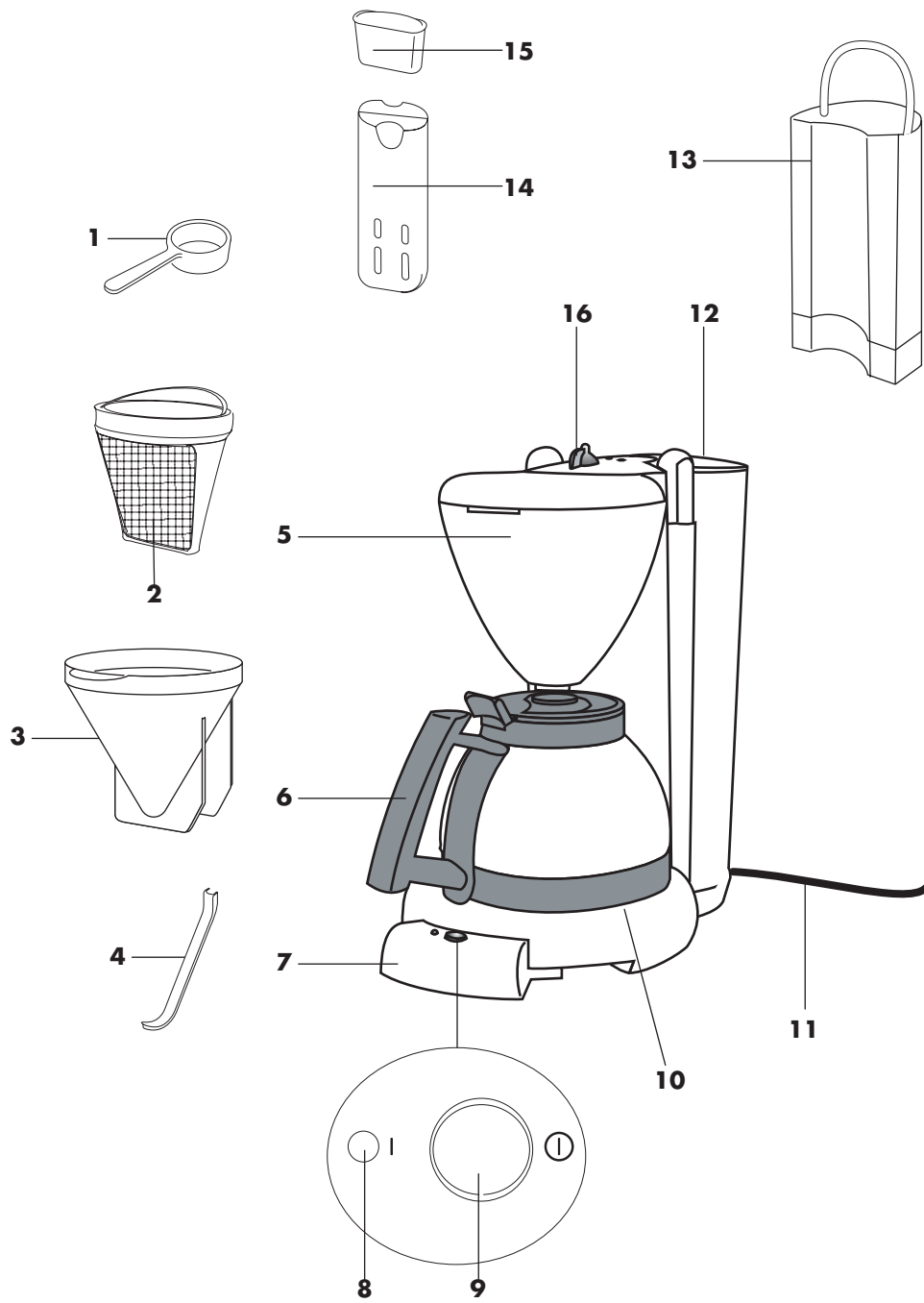

ELECTRICAL CONNECTION (UK ONLY)

- A) If your appliance comes fitted with a plug, it will incorporate a 13 Amp fuse. If it does not fit your socket, the plug should be cut off from the mains lead, and an appropriate plug fitted, as below.

WARNING: Very carefully dispose of the cut off plug after removing the fuse: do not insert in a 13 Amp socket elsewhere in the house as this could cause a shock hazard.

With alternative plugs not incorporating a fuse, the circuit must be protected by a 15 Amp fuse.

WARNING - THIS APPLIANCE MUST BE EARTHED
IMPORTANT

The wires in the mains lead are coloured in accordance with the following code:

Green and yellow:	Earth
Blue:	Neutral
Brown:	Live



If the plug is a moulded-on type, the fuse cover must be re-fitted when changing the fuse using a 13 Amp Asta approved fuse to BS 1362. In the event of losing the fuse cover, the plug must NOT be used until a replacement fuse cover can be obtained from your nearest electrical dealer. The colour of the correct replacement fuse cover is that as marked on the base of the plug.

- B) If your appliance is not fitted with a plug, please follow the instructions provided below:

As the colours of the wires in the mains lead may not correspond with the coloured markings identifying the terminals in your plug, proceed as follows:

The green and yellow wire must be connected to the terminal in the plug marked with the letter E or the earth symbol  or coloured green or green and yellow.

The blue wire must be connected to the terminal marked with the letter N or coloured black.

The brown wire must be connected to the terminal marked with the letter L or coloured red.