

KENWOOD

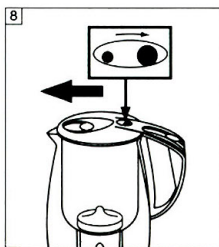

WF194

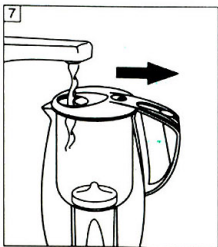
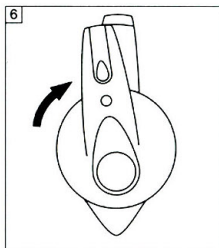
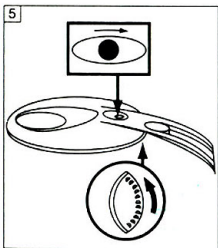
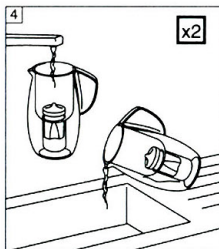
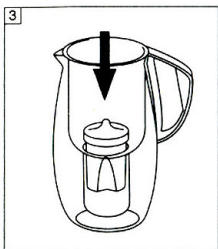
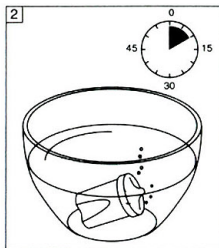
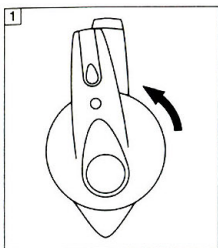

1. Remove lid by turning anti-clockwise. Wash hopper, lid and jug in warm water.
 2. Remove wrapper and immerse cartridge in cold water for 10 minutes.
 3. Insert the cartridge into the hopper and press gently to seal.
 4. Fill the hopper from the tap and allow the water to filter. Discard the filtered water. Do this twice.
 5. Advance the dial on underside of lid to show red dot.
 6. Fit the lid onto the jug and rotate clock-wise to lock.
 7. Your Kenwood water filter is now ready to use. Slide back the shutter to fill.
 8. After filling close the shutter and the usage indicator will automatically advance. The re-appearance of the red dot serves as a reminder to change the cartridge. Always change the cartridge every 30 days or every 150 litres, whichever is sooner.
- **Consume filtered water immediately or store in a refrigerator.**
 - **The filter is for treating mains tap water only.**
 - **Filtered water should be boiled before given to infants under 12 months of age.**
 - **For selected spare parts and advice, telephone the Customer Care Department on 01705 476000.**

KENWOOD LIMITED

New Lane • Havant • Hants • PO9 2NH • U.K.