

KENWOOD

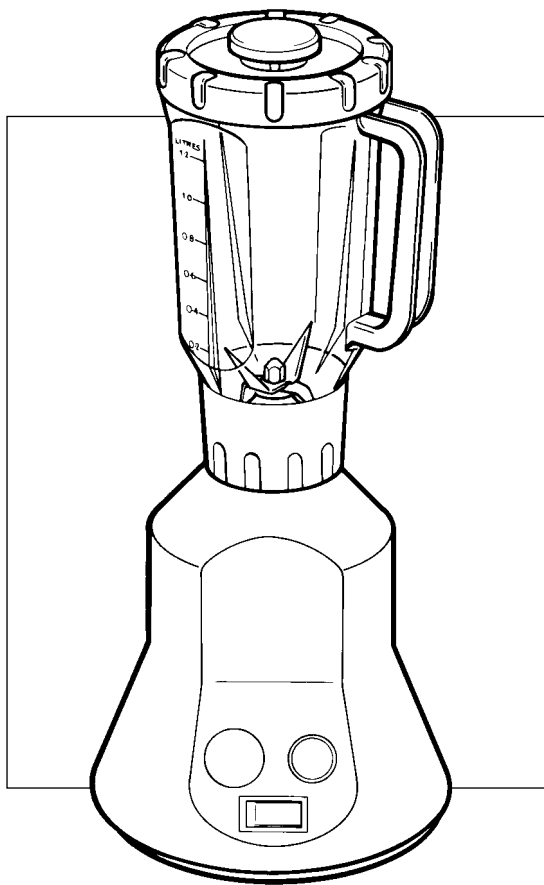

PB500A/PB501A

Your Kenwood Blender

Your new Kenwood Blender is ideal for blending soups, batters, fruit drinks, pâtés, purées and cocktails.

Your model is supplied with either a glass or stainless steel goblet. The maximum capacity of the glass goblet is 1.2 litres and the stainless steel goblet is 1.5 litres. These quantities should not be exceeded.

IMPORTANT SAFEGUARDS

When using electrical appliances consideration should always be given to basic safety precautions including the following:-

1. Read all instructions.
2. Do not immerse the motor base, cord or plug in water.
3. Do not use if there is any visible damage to the appliance or to the supply cord.
4. Do not use this appliance for other than its intended use.
5. Do not stand motor base or goblet on hot or wet surfaces.
6. Do not allow the supply cord to hang over the edge of a table or worktop.
7. The use of attachments not recommended or sold by the manufacturer may cause fire, electric shock or injury.
8. This blender is not intended for use by young children or infirm persons without supervision.
9. Warning - the blades are sharp, handle with care both in use and when cleaning. Keep the blade assembly well out of the reach of children.
10. Keep hands and utensils out of the goblet when blending.
11. Unplug from the power supply when not in use, before putting on or taking off parts, and before cleaning.
12. Avoid contacting moving parts.
13. Always make sure the lid is secure before the motor is switched on.
14. Ensure that the appliance is switched off after each use and that the motor has completely stopped before disassembling.
15. Appliances used in a place of work should be tested and inspected regularly.
16. Do not let children play with the machine.
17. This blender is for domestic use only.

SAVE THESE INSTRUCTIONS

Know your Kenwood Blender

- | | |
|-----------------|---------------------------------|
| 1. Filler cap | 6. Blade hub assembly |
| 2. Lid | 7. Base containing fixed spring |
| 3. Lid washer | 8. Power unit |
| 4. Goblet | 9. On/Off buttons |
| 5. Sealing ring | 10. Two speed switch |

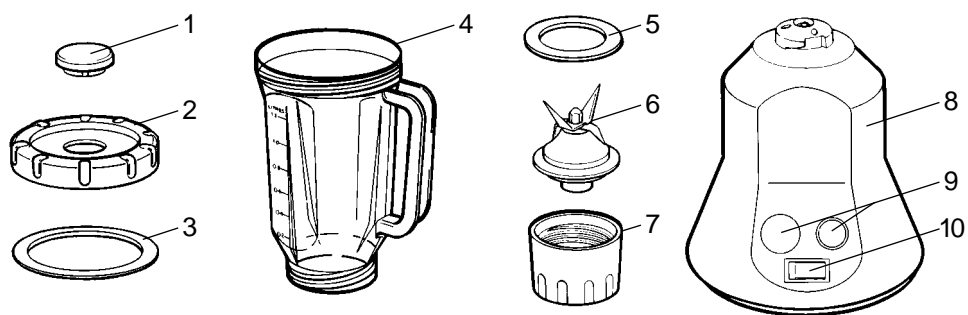

Fig. 1

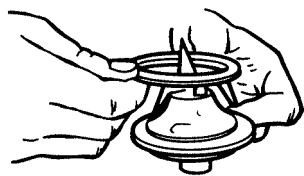

Fig. 2



Fig. 3



Fig. 4

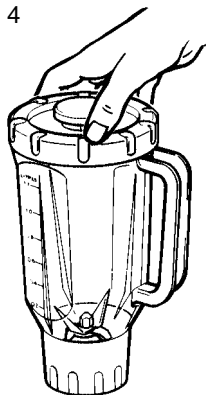

Fig. 5

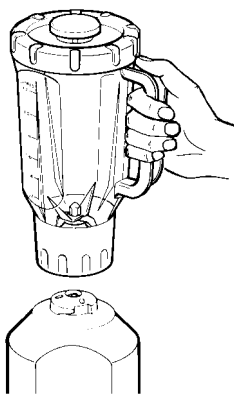
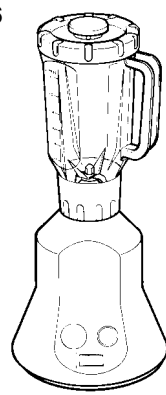

Fig. 6



Connecting to power

Before switching on make sure that the voltage of your electricity supply is the same as that indicated on the rating plate.

IMPORTANT (UK ONLY)

The wires in the mains lead are coloured in accordance with the following code:

BLUE	NEUTRAL
BROWN	LIVE

This appliance complies with European Economic Community Radio Interference Directive 89/336/EEC.

Using your Kenwood Blender

Place the sealing ring on the recess of the Blade Hub Assembly (Fig. 1) ensuring that it is correctly located. Position the Blade Hub Assembly with sealing ring into the base (Fig. 2). Screw the goblet into the base in a clockwise direction until firmly located (Fig. 3). Ensure the lid washer is correctly positioned in the lid recess, then fit the filler cap. For glass goblets locate the lid by turning it in a clockwise direction (Fig. 4). For stainless steel goblets push the lid firmly down to locate.

Place the blender onto the power unit engaging the lugs in the base in the slots provided. Turn the blender clockwise until it locks into position. Turn anti-clockwise to remove.

Operating the Blender

Connect the appliance to the power supply. Press the green button to switch on the blender and to stop the appliance press the red button. Your blender has two speeds. Select the lower speed for lighter blending e.g. milk shakes and the higher speed for harder tasks e.g. pâtés etc.

Safety Note

Your blender incorporates a safety device and should the power to the appliance be interrupted, it will not re-start with the resumption of the power without first pressing the green start button.

To wash and 'run in' your blender, fill with warm water, place onto the unit and switch on for 20-30 seconds. Remove from the power unit, empty out the water and dry. The blender is now ready for use.

Hint

To ensure that there are no leaks from the base, grip the handle and turn the blender when in place on the power unit. After use the goblet may be loosened from the base in the same way, but always ensure that the goblet has been emptied of food first. Wetting the sealing ring will also help to prevent the odd case of leakage.

IMPORTANT

For safety reasons we do not recommend the blending of very hot liquids.

Do not leave the blender soaking with water in the goblet and do not leave the blade assembly soaking in water.

The blender runs at such high speeds that all foods are processed within one minute. Prolonged running should be avoided especially when processing dry ingredients or small quantities. When switching off wait until the blades have stopped revolving before removing the blender. If you do not do this you will damage the coupling of the blender.

The blender goblet is not suitable as a storage container therefore ingredients should not be left to stand in the goblet before processing and should be removed immediately afterwards.

Cleaning

The blender should be disassembled before cleaning. Wash the goblet, lid, filler cap and sealing ring in hot soapy water. The blade assembly should be hand washed by rinsing it under running water. Dry thoroughly.

Take care as the blades are sharp.

Wipe over the power unit with a damp cloth and polish with a dry one.

Service

- If the cord is damaged it must, for safety reasons, be replaced by Kenwood or an authorised Kenwood repairer.

UK

If you need help with:

- using your machine or
 - servicing, spare parts or repairs (in or out of guarantee)
- ☎ call Kenwood on **023 92392333** and ask for Customer Care. **Have your model number ready** – it's on the underside of the power unit. Alternatively, contact your authorised Kenwood repairer: look in YELLOW PAGES under 'Electrical appliance repairs'.

● Eire

See our advertisement in Golden Pages.

● other countries

Contact the shop where you bought your machine.

guarantee

If your blender goes wrong within one year from the date you bought it, we will repair it (or replace it if necessary) free of charge provided:

- you have not misused, neglected or damaged it;
- it has not been modified (unless by Kenwood);
- it is not second-hand;
- it has not been used commercially;
- you have not fitted a plug incorrectly; and
- **you supply your receipt to show when you bought it.**

This guarantee does not affect your statutory rights.

