

# KENWOOD

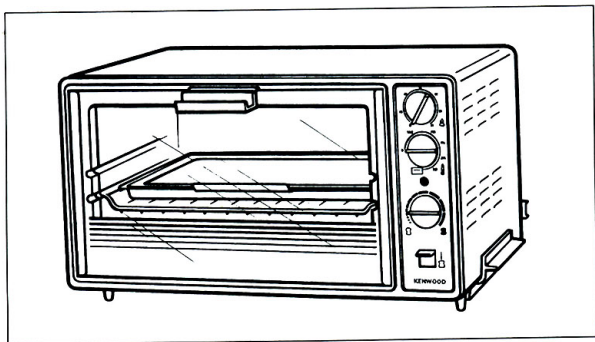

MO300/MO301

## Your Kenwood Mini Oven

Your new Kenwood Mini oven offers you a convenient system for table top cooking. Its size and simplicity make it a useful kitchen accessory, ideal for preparing snacks, grilling, toasting and baking. It is fitted with a hinged crumb tray for ease of cleaning and the cord can be wrapped around cleats at the rear of the appliance for storage. As this appliance operates slightly differently to a traditional oven, read the instructions carefully, some experimentation may be necessary to achieve the desired results.

## IMPORTANT SAFEGUARDS

When using electrical appliances consideration should always be given to basic safety precautions including:

1. Read all instructions.
2. Do not use if there is any visible damage to the appliance or to the supply cord.
3. Do not immerse the appliance, supply cord or plug in water.
4. Do not touch hot surfaces. The outer surfaces on this appliance get hot in use.
5. Do not let the supply cord hang over the edge of the table or worktop, or touch hot surfaces.
6. Close supervision is necessary when any appliance is used by or near children.
7. Do not use the appliance for other than its intended use.
8. Unplug the appliance from the power supply when not in use or before cleaning.

## PLEASE KEEP THESE INSTRUCTIONS

### Connecting to Power

Before switching on make sure that the voltage of your electricity supply is the same as that indicated on the rating plate.

#### **IMPORTANT (UK ONLY)**

The wires in the mains lead are coloured in accordance with the following code:

GREEN and YELLOW  
BLUE  
BROWN

EARTH  
NEUTRAL  
LIVE

## Hints

- Mini oven temperatures tend to be hotter than conventional ovens, please amend usage times and temperatures accordingly. Some trial and error may be needed.
- Most foods will cook better if placed on the bottom shelf in the low position.
- Larger items, such as pies, should be covered with foil to prevent burning. Take care that the foil does not touch the elements.

### Instructions for Use as a Grill

The grill will not operate unless the timer has been set for the required time as explained in the oven section.

It is recommended that the top shelf position is used for grilling.

Do not preheat before grilling. The door should always be ajar (fig.3) and will stay in this position. If the door is opened further the power to the grill is automatically switched off.

1. Place food on the grill pan and place on the oven tray. Slide the oven tray onto the selected shelf position.
2. Turn the temperature control knob to grill this will operate the top elements only (fig. 4).
3. Select the time required on the timer.
4. During grilling the temperature indicator light will remain on.
5. Turn the food regularly to ensure even cooking. The grilling operation will stop if the door is opened fully. Return the door to the ajar position as soon as possible to resume cooking.
6. When grilling is complete, open the door and remove the food.
7. Return the controls to the off position, remove the plug from the power supply and allow the oven to cool.

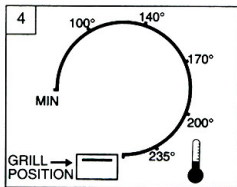
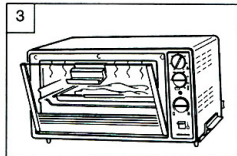

## Hints

- Trim fatty meat to reduce spitting
- Use the grill pan/trivet with the oven tray to prevent spitting inside the oven.
- If the food is cooking too quickly, lower the shelf position.

### Instructions for Use as a Toaster

The temperature control knob must be set to '0'.

It is recommended that the bottom shelf position is used for toasting.

1. Place the bread on the shelf
2. Select the desired browning level on the browning control
3. Close the door.
4. Press the on/off lever down until it locks into position. The temperature indicator light will glow.
5. At the end of the cycle the indicator light will go out and the on/off lever will automatically return to the off position.

The toasting cycle can be stopped at any time, either by opening the door or lifting the lever to the off position.

## Before Use

Open the door and remove any packaging material from the inside of the oven and remove any labels on the outside.

Wash the accessories supplied in hot soapy water and dry thoroughly.

Your Kenwood oven offers three modes of operation - toasting, grilling or roasting/baking.

Before using your mini oven for the first time, please take a few minutes to familiarise yourself with the controls.

Select the operation required and follow the instructions for use.

### IMPORTANT NOTES

This appliance is fitted with a safety interlock. The oven switches off when the door is fully opened. It can be left ajar when grilling which does not activate the safety interlock. The oven will not operate unless the door is closed and a time selected on the timer.

During the initial heating up period, traces of smoke may be visible. This is normal for newly manufactured electrical heating appliances and there should be no cause for alarm.

## Controls

### Timer

The timer can be set between 0-60 minutes cooking time. A bell will sound once the time set has elapsed.

Turn the control clockwise to the 60 shown on the dial, before setting the required time. (Note: This will activate the mechanism for the bell and must be carried out each time before setting the timer).

Now set the required time.

### Temperature Control Knob

The temperature control knob can be set between 0 - 235°C.

### Toaster Browning Control & On/Off Lever

The temperature control knob must be set to zero when using the toaster.

To use your mini oven as a grill, or to toast bread, set the temperature control knob to '0' and turn the browning control to the required level. Press the on/off lever down until it locks into position. The indicator light will glow. The lever will automatically return to the off position when the browning cycle has finished and the indicator light will go out.

## Instructions for Use as an Oven

### OVEN

1. Plug the appliance into the power supply.
2. Select one of the three shelf positions. The shelf can be inverted to give a high or low position. (Fig 2)
3. Pre-heat the oven by selecting the required temperature on the temperature control knob and turning the timer to the 60 shown on the dial.
4. The temperature indicator light will glow. When the desired temperature has been reached the light will go out.
5. Cooking can now commence. Place the items to be cooked into the oven and close the door. Set the timer for the required cooking time.
6. The temperature indicator light will cycle on and off during cooking indicating that the desired temperature is being maintained. Please note both elements will operate when used as an oven.
7. After use, return the controls to the off position, switch off and remove the plug from the power supply, and allow the oven to cool.

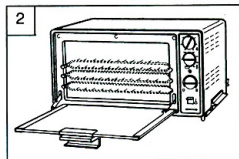

## Know your Kenwood Mini Oven

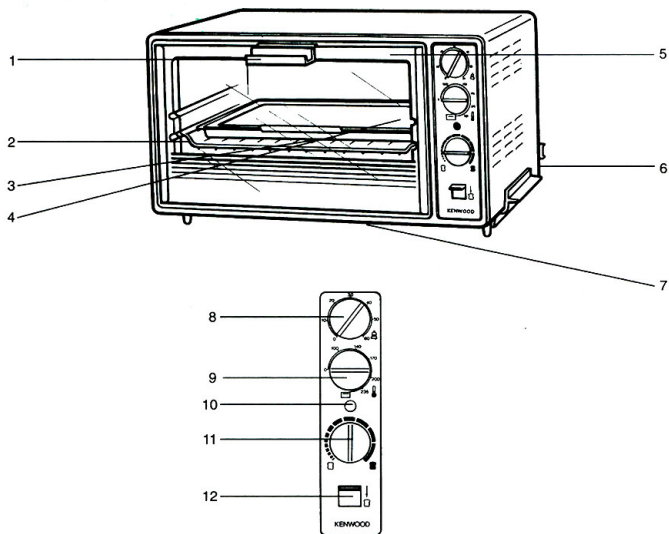

## Key

### Features

1. Door handle
2. Shelf
3. Oven tray
4. Grill pan/trivet
5. Door
6. Supply cord
7. Crumb tray

### Controls

8. Timer
9. Temperature control knob
10. Temperature indicator light
11. Toaster browning control
12. Toaster lever

## Hints

- Best results are obtained by using dry bread. When using fresh bread it is recommended that you use the grill control and toast each side separately.
- On some toast settings best results may be obtained by preheating by toasting without bread until it switches off, and then toasting the required bread as usual.
- Experience will tell you the best settings for various types of bread, buns etc. Some breads may require further toasting, in which case simply reset the toaster as above.

## Cleaning

Switch off the appliance and remove the plug from the power supply.

Allow the oven to cool before cleaning.

The oven and accessories should be cleaned after every use. Stubborn stains or burnt on residues should be removed by using a scouring pad or foam based cleaner. Do not use harsh scourers or any type of caustic or ammonia oven cleaning solutions.

Take care when cleaning around the elements to prevent damage and avoid any sharp edges or corners.

Clean the oven tray and grill pan in hot soapy water and dry. These can also be washed in a dishwasher.

If a major spillage occurs inside the oven compartment, wipe clean as soon as possible with a damp cloth. Do not immerse in water.

The crumb tray on the base of the oven is hinged and can be unclipped for ease of access to the oven compartment (fig 5). To release the tray, tilt the oven backwards, push the knob situated on the tray towards the back of the appliance and then pull down.

Close by pushing back the tray, lifting into position and pulling forward ensuring that both tabs lock into the slot provided.

Wrap the cords round the cleats at the rear of the appliance (fig 6).

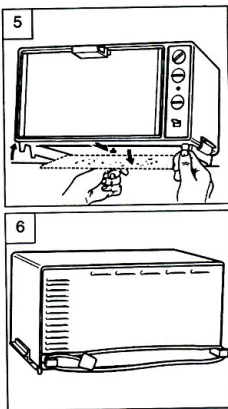

## Service

If the supply cord of this appliance is damaged, it must only be replaced by a Kenwood Authorised Repairer, as special purpose tools are required.

### UK

For any repairs in or out of guarantee, servicing or selected spare parts, contact your Kenwood Authorised Repairer in the **Yellow Pages** under **Electrical Appliance Repairs** or telephone Havant (01705) 476000 extension 2805 Customer Care Department.

### Eire

Contact local repairer from advertisement in **Golden Pages**.

### All Other Markets

Contact the dealer from whom you purchased your appliance.