

KENWOOD

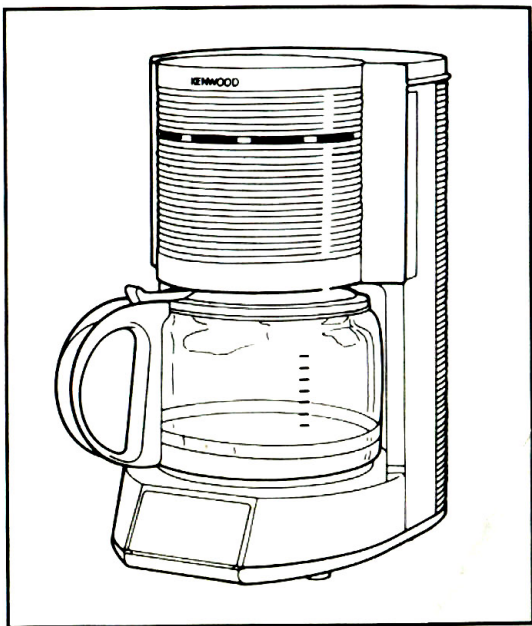

CM600, CM610, CM611, CM620
CM621, CM640, CM641

Know your Kenwood Coffee Maker

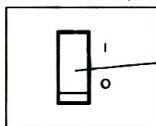
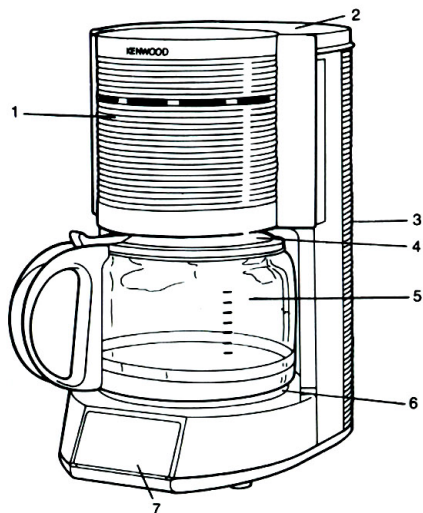

CM600

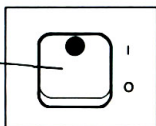

CM610/CM611

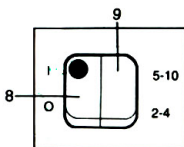

CM620/CM621

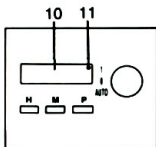

CM640/CM641

Key

- | | |
|-------------------------|----------------------------------|
| 1. Swivel filter holder | 7. Control panel |
| 2. Water reservoir lid | 8. On/Off switch |
| 3. Cord storage | 9. Strength control |
| 4. Anti-drip lever | 10. Digital display |
| 5. Carafe | 11. Keep warm plate ON indicator |
| 6. Keep warm plate | |

Making Coffee

Pour cold water into the reservoir sufficient for the number of cups required, see level indicator inside reservoir. Always use cold water to make coffee, never use warm water or carbonated water or other liquids which could cause damage to the appliance.

Note: If the glass carafe is used to fill the water tank, remember that the markings on the carafe do not coincide with those in the water reservoir due to the coffee absorbing some of the water.

Swing out the filter holder and insert the filter. Put the measured quantity of coffee into the filter and close the holder until it locates into position.

The measure of coffee per cup should be adjusted to suit your taste.

Switch on the coffee maker.

For small quantities select the 2-4 cup position on the strength control (CM620/CM621 only).

When the brewing cycle has completed the glass carafe can be removed from the appliance.

After pouring coffee, return any remaining coffee in the carafe to the keep warm plate. As long as the appliance is switched on, the coffee is kept at a temperature ready for drinking. The CM640/CM641 switches off automatically after 2 hours when using the Auto Function.

If the keep warm plate is no longer needed, switch off the appliance using the on/off switch. Remove the plug from power supply if the appliance will not be used for a longer period. Note that the time settings (CM640/CM641) will not be retained.

IMPORTANT Do not swing out the filter holder or remove the carafe whilst the appliance is switched on and has water remaining in the reservoir.

Auto Brew Function - CM640/CM641

This function permits you to pre-select a switch-on time for the appliance in your absence. Operate as follows:

- Fill the appliance with the required quantities of water and ground coffee, plug the appliance into the power supply.
- Press "P" to display the auto switch-on time.
- To change the auto switch-on time, hold "P" and use "H" and "M" to change the time. When the required time is indicated release "P".
- Slide the select switch to "auto" to use auto switch-on function.
- When the auto switch-on time is reached, the coffee maker will switch on for 2 hours and then switch off automatically.
- When brewing or heating the keep warm plate, an indicator at the lower right corner of the display will be illuminated.

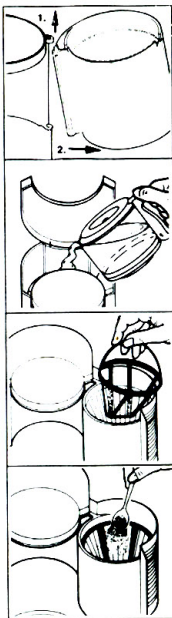

Controls

On/Off Switch - CM600/CM610/CM611/CM620/CM621

1 = On (switch glows red)

0 = Off

Strength Control - CM620/CM621

2-4 cups (full aroma for small amounts)

5-10 cups

Automatic Controls - CM640/CM641

a. 3 position switch for function selection:-

1 = On

0 = Off

Auto = Automatic Brew

b. 3 push buttons for setting clock:-

H = Hours

M = Minutes

P = Programme

Setting the Clock - CM640/CM641

This appliance has a 24 hour clock which displays the hours and minutes, but will only operate when the appliance is connected to the power supply.

To Set the Time

a. Plug in and switch on at the mains socket, display will show:-

0.00

b. Depress 'H' or 'M' to select the correct time.

Before Using Your Coffee Maker

Wash the filter holder, permanent filter, carafe and lid in hot soapy water. Rinse and dry thoroughly. Assemble onto your coffee maker.

Fill the water reservoir to the maximum level with cold water. Plug in and switch on and allow the water to flow through the appliance and discard. Then repeat. This procedure should also be followed if the coffee maker has not been used for a long time.

Using filtered water with your coffee maker will reduce limescale build up, improve the taste of your coffee and increase the life of the appliance.

IMPORTANT SAFEGUARDS

When using electrical appliances basic safety precautions should always be followed, including the following:-

1. Read all instructions
2. Do not touch the Keep Warm Plate and hot surfaces of the carafe.
3. Do not immerse appliance, cord or plug in water or other liquids.
4. Do not use if there is any visible damage to the appliance or to the supply cord.
5. Unplug the appliance from mains supply before cleaning.
6. Close supervision is necessary when any appliance is used by or near children.
7. Do not let the cord hang over the edge of table or worktop or touch hot surfaces.
8. Do not use your appliance for other than its intended use.
9. Do not use outdoors.

SAVE THESE INSTRUCTIONS

DO NOT IMMERSE THIS APPLIANCE IN WATER

Connecting to Power

Before switching on make sure that the voltage of your electricity supply is the same as that indicated on the rating plate.

IMPORTANT! (UK ONLY) The wires in the mains lead are coloured in accordance with the following code:-

GREEN AND YELLOW	EARTH
BLUE	NEUTRAL
BROWN	LIVE

As the colours of the wires in the mains lead of this appliance may not correspond with the coloured markings identifying the terminals in your plug, proceed as follows:

The wire which is coloured green and yellow must be connected to the terminal which is marked with the letter 'E' or by the 'Earth' symbol \equiv or coloured green or green and yellow.

The wire which is coloured blue must be connected to the terminal which is marked with the letter 'N' or coloured black.

The wire which is coloured brown must be connected to the terminal which is marked with the letter 'L' or coloured red.

The appliance must be protected by a 13A ASTA approved (BS1362) fuse if a 13A (BS1363) plug or a non-rewireable plug is used or if any other type of plug is used by a 15A fuse either in the plug or adaptor or at the distribution board.

WARNING - THIS APPLIANCE MUST BE EARTHED

If your appliance has been fitted with a mains lead terminated in a factory fitted plug you must comply with the following regulations:-

1. The plug fitted to the lead contains a fuse. For replacement use only a 13A ASTA approved (BS1362) fuse.
2. For non-rewireable plugs the fuse cover **MUST** be refitted when replacing the fuse. If the fuse cover is lost then the plug must not be used until a replacement can be obtained. The correct fuse cover for the plug is identified by colour and replacements may be obtained from your Kenwood Authorised Repairer (see detail under SERVICE).
3. If the socket outlets in your home are not suitable for the plug fitted then the plug should be removed. Non-rewireable plugs must be cut off and **IMMEDIATELY DESTROYED**. An electric shock hazard may arise if an unwanted non-rewireable plug is inadvertently inserted into a 13A socket outlet.
4. Fit a suitable plug to the appliance taking note of the information contained in the plug wiring instructions above.

This appliance complies with European Economic Community Radio Interference Directive 82/499/EEC.

- g. To switch off the keep warm plate before 2 hours have elapsed, slide the select switch to off. The auto switch-on mode is then no longer in use and the indicator on the display will no longer be illuminated.

Cleaning

Always remove the plug from the power supply before cleaning.

Never clean the coffee maker under running water and never immerse the appliance in water.

To clean, swing out the filter holder and remove the filter, discard used grounds. Clean the permanent filter under running water.

The filter holder can be removed for cleaning. Swing out the holder and lift it at the pivot. Tilt the holder to disengage the lower pivot then remove the holder diagonally downward.

To replace the holder insert the top pivot first then engage the lower pivot. Clean the body with a damp cloth.

Decalcifying

If you live in a hard water area, decalcify the appliance occasionally with a propriety cleaning agent. The frequency required depends on the hardness of your water and how often the appliance is used. An indication of 'furring up' is when the coffee takes much longer to brew.

CAUTION: Use the decalcifier according to the manufacturers instructions, these solutions are generally caustic.

Switch the coffee maker on and allow the agent to flow through into the carafe (without filter fitted) avoid letting the solution drip onto hotplate.

Empty the used solution and rinse the carafe well. Let the maximum amount of clean water flow through several times to avoid affecting the taste and aroma of your coffee.

Service

If the supply cord of this appliance is damaged, it must only be replaced by an authorized Kenwood repairer because special purpose tools are required.

UK only

For any repairs in or out of guarantee, servicing or selected spare parts, please contact your Kenwood Authorised Repairer in **YELLOW PAGES** under the heading of **ELECTRICAL APPLIANCE REPAIRERS** or telephone 0705 476000 extension 2800 Service Department.

Eire

Contact local repairer from advertisement in **Golden Pages**.

All Other Markets

Contact the dealer from whom you purchased your appliance.

KENWOOD LIMITED

New Lane • Havant • Hants PO9 2NH

85478/5