



Spend a little Live a lot

Great care has gone into the manufacture of this product and it should therefore provide you with years of good service when used correctly. In the event of product failure within it’s intended use over the course of the first 3 years after date of purchase, we will remedy the problem as quickly as possible once it has been brought to our attention. In the unlikely event of such an occurrence, or if you require any information about the product, please contact us via our helpline support services, details of which are to be found both in this manual and on the product itself.



PRODUCED IN CHINA FOR:
ALDI STORES LTD. PO BOX 26, ATHERSTONE
WARWICKSHIRE, CV9 2SH.

ALDI STORES (IRELAND) LTD.
PO BOX 726, NAAS, CO. KILDARE.
visit us at www.aldi.com

AFTER SALES SUPPORT

GB 01924 481053 **GB** customerservice@jaleno.com
 IRE 014968036/014963993 **IRE** kenilworthelec@eircom.net

Model: 2878 Product Code: 72513 10/2016



Spend a little Live a lot

User Manual



MILK HEATHER/FROTHER



Contents

Intended use.....	7
Residual risks.....	8
Compliance to EU Directives.....	8
Important safeguards.....	8
Instruction for use.....	12
Safety devices.....	14
Cleaning and maintenance	15
Faults and solutions.....	16
Technical Data	17
Disposal of Waste	17

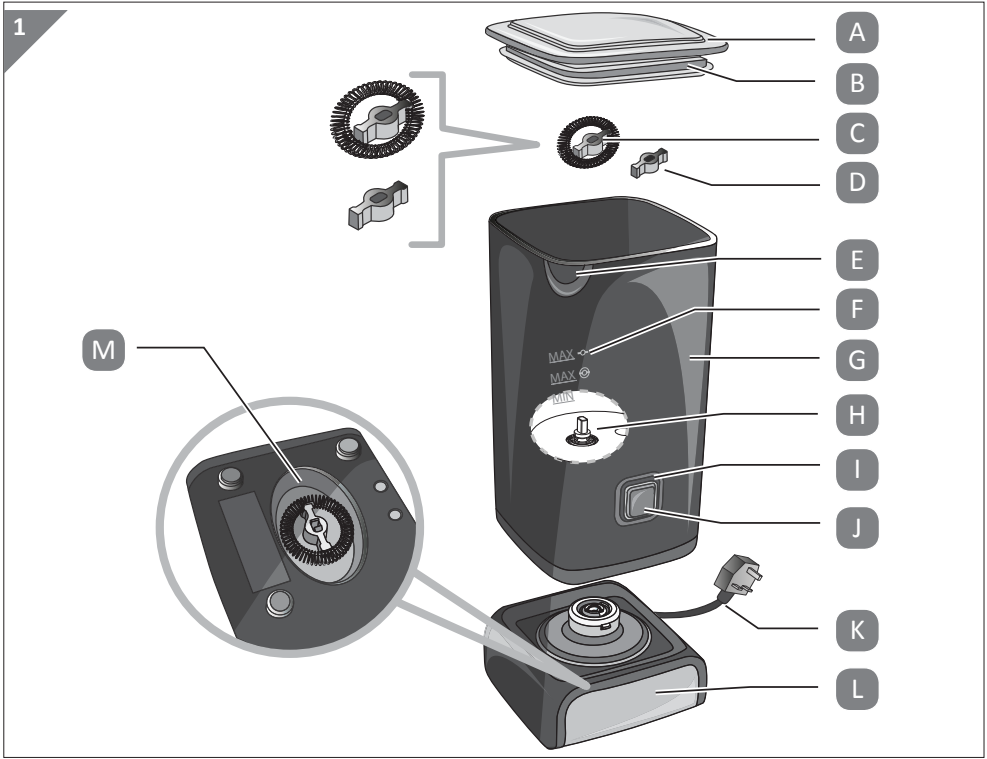

Description of the appliance

- A Lid
- B Seal ring
- C Insert for rich froth
- D Insert for light froth
- E Spout
- F MAX and MIN level
- G Container
- H Sleeve for insert
- I Operation indicator
- J On-off switch
- K Power cord + plug
- L Power supply base
- M Accessory compartment for one insert

WITH REGARDS TO THIS MANUAL

This appliance is made in conformity with appropriate European Regulations in force, to protect the user wherever possible from potential hazards. Even if you are familiar with this type of appliance, carefully read this manual before use. Only use this appliance for the purpose it is designed for in order to prevent accidents and damage. Keep this manual close by for future consultation. If you should decide to give this appliance to other people, remember to also include these instructions.

The information in this manual is marked with the following symbols and words that indicate:



Risk of injury

DANGER

Warns the user on the possible risk of serious injury



Risk of electric shock

WARNING

Warns the user on the possible risk of injury or serious property damage



Risk of burns

CAUTION

Warns the user on the possible risk of minor injury



Risk of material damage

NOTE

Warns the user on the possible risk of material damage

This manual is available in electronic format on the website.

INTENDED USE

The appliance is intended to heat and froth milk. Do not pour any other liquid or solid food in it.

This appliance is designed solely for household and similar uses such as:

- in cooking areas used by personnel of shops, offices and other professional environments,
- on farms,
- guests of hotels, motels and other residential environments,
- bed and breakfast type of environments.

The appliance is suitable for use in closed and dry places.

Only use the power supply base supplied.

Any other use of the appliance is allowed by the manufacturer who does not accept any responsibility for damages of any kind caused by improper use of the appliance itself. Improper use also results in any form of warranty being forfeited.



RESIDUAL RISKS

WARNING

RISK OF BURNS - The constructive characteristics of the appliance, covered by this publication, does not allow to protect the user from possible contact with the container and the lid during intended use and in the minutes following its switching off. Do not touch the container and the lid when it is in operation.

Risk of burns - The hot milk and steam can cause burns. Use the appliance only when the lid is firmly on the container. In particular, pay attention to the release of steam. Do not open the lid during operation.

WARNING

RISK OF INJURY - After you have turned off the appliance and unplugged it from the socket-outlet, let it rest on a stable surface and above all out of the reach of children.

COMPLIANCE TO EU DIRECTIVES

This appliance conforms to the directives 2014/35/EU, EMC 2014/30/EU, 2011/65/EU and to the regulations (EC) No. 1935/2004 of 27/10/2004 regarding material in contact with foods. To dispose of the product correctly according to European Directive 2012/19/EU, please refer to and read the provided information enclosed with the product.

IMPORTANT SAFEGUARDS

READ THESE INSTRUCTIONS BEFORE USE.

ALWAYS KEEP THESE INSTRUCTIONS.

1. We decline any responsibility resulting from misuse or any use other than those covered in this booklet.
2. We suggest you keep the original box and packaging, as our free-of-charge service does not cover any damage resulting from inadequate packaging of the product when this is sent back to an Authorised Service Centre.

3. This appliance can be used by persons who have reduced physical sensory or mental capabilities, or lack of experience and knowledge, only if they are monitored by a responsible person or if they have received and understood the instructions and dangers which may arise during the appliance use.



Danger for children

4. This appliance can be used by children aged 8 years and up if properly monitored or if you have received instructions regarding the appliance safe use and if they understand the dangers involved.
5. Children shall not play with the appliance.
6. Cleaning and user maintenance shall not be made by children without supervision.
7. Do not leave the appliance and the power cord within the reach of children under the age of 8 years if the appliance is connected to the outlet or while it is cooling.
8. Packaging elements must not be left in reach of children as they are potentially hazardous.



Danger of electric shock

9. Make sure that the voltage shown on the appliance rating plate corresponds to that of your local mains electricity supply.
10. Always connect the appliance to an earthed socket.
11. Never touch the power supply base, the plug and the power cord if your hands are wet or if you are barefoot.
12. Never leave the appliance unattended when connected to the main socket; unplug it after every use.
13. Make sure that the power cord does not come into contact with hot or sharp surfaces.



14. Do not use this appliance in conjunction with an extension cord.
15. The appliance must never be connected and put into operation with a timer or a separate remote start-up system.
16. Remove the plug from the main socket before cleaning or maintenance.
17. Do not immerse the appliance in water or other liquids.
18. The appliance must not be used if it has been dropped, if there are visible signs of damage or leaks of water. Do not use the appliance if the power cord or the plug are damaged, or if the appliance is faulty. To prevent any accident, all repairs, including the replacement of the power cord, must be carried out by an Authorised Service Centre or suitably by qualified personnel.

**Danger of burns**

19. Do not touch the lid and the container of the appliance when in operation and for several minutes after it is turned off since it could cause burns. Take the container only from the bottom and the lid only from the edge.

**Danger of damage originating from other causes**

20. Never leave the appliance unattended when it is connected to the main socket.
21. Turn on the appliance only when it is in working position.
22. Place the appliance in an adequately illuminated environment and with the power outlet easily accessible.
23. During use, rest the appliance onto a horizontal surface. The appliance must be put to rest only on its power supply base.
24. The appliance must be used and left at rest on a stable heat resistant surface.

**Danger of material damage**

25. Place the appliance at a sufficient distance from heat sources, such as electric cooking plates or stoves. Do not place the appliance on delicate surfaces.
26. When the appliance is hot, do not rest it onto the power cord. Take special care in ensuring that the power cord do not come into contact with the hot surfaces.
27. Do not pull the power cord to unplug the appliance.
28. Use only original accessories.
29. Do not expose the appliance to outdoor elements (rain, sun ...).



INSTRUCTION FOR USE

 The quantity and quality of the foam depend on many factors, including the milk fat content, the use of fresh or long-life milk, the milk temperature and brand.

To avoid that milk froths excessively, if you are using a new type of milk do not immediately fill the container up to the MAX mark, but first make a test with a smaller amount. If milk should spill, immediately turn off the appliance. Wait until it cools a little, then clean it (see “Cleaning” chapter). We got the best results with semi-skimmed milk (1.5% fat).

Starting the appliance



RISK OF ELECTRIC SHOCK - Check the state of the power cord of your appliance on a regular basis before using it, and if it is damaged, take it to the service centre closest to you to have it replaced only by specialised personnel.

- Remove all packaging materials and make sure all components are present.
- Clean the container, the inserts, the sealing ring and the lid as described in the “Cleaning” chapter.

Place the base

- Place the base on a flat and stable surface.
- Plug into the mains socket.

The appliance is ready for use.

Choose the insert and pour milk



To obtain a large amount of froth fit the insert with spiral.



Instead to warm slightly frothed milk or froth smaller amount, use the insert without spiral.

To avoid losing it, keep the insert that is not used in the compartment located at the bottom of the base.

NOTE

RISK OF MATERIAL DAMAGE - Respect the MIN and MAX marks inside the container. The sleeve in the bottom of the container must be covered by milk. In case of insufficient amount of milk, the appliance may overheat. In case of excessive amount, milk can instead overflow.

- Remove the lid of the container.
- Insert the appropriate insert into the sleeve at the bottom of the container.
- Pour the milk to the maximum level, shown by the dash at the MAX mark:



- MAX for the insert with spiral.



- MAX for the insert without spiral.

- Place the lid firmly on the container.

Froth and heat the milk

NOTE: During the first heating a slight odour may develop, which is not dangerous. Provide adequate ventilation.

- Shortly press the ON/OFF button. The operation indicator light switches on in red.
- The appliance starts heating and frothing the milk.

When ...

... the insert with spiral is used, the frothing process will have a duration of about 1.5 minutes,

... the insert without spiral, the frothing process will have a duration of about 2 minutes.

- The heating and frothing process then stops automatically.
- Then remove the container from the power supply base.

Froth the milk cold

It is also possible to froth the milk without heating it. To obtain a soft and creamy froth use only the insert with spiral.

- Press the ON/OFF switch and hold down for about 2 seconds, until the appliance starts to froth milk. The indicator light switches on in blue.
- The appliance starts to froth milk.
- After about 1 to 1.5 minutes, the milk frothing process stops automatically.
- Remove the container from the power supply base.



Stop or finishing the milk heating and frothing in advance

- Press the ON/OFF switch.
- The operation indicator light turns off.
- To continue to heat and froth, press the ON/OFF button again:
 - briefly, if you want to heat and froth
 - for a long time, if you want to froth without heating.

Turn off the appliance

To completely disconnect the appliance from the power supply after use, remove the plug from the main socket.

SAFETY DEVICES

If the appliance has been switched on empty, after about 30-40 seconds it will automatically switch off to avoid overheating. Any intervention must be carried with cold appliance.

CLEANING AND MAINTENANCE

DANGER

RISK OF ELECTRIC SHOCK - Never immerse the appliance in water or other liquids. The base, the plug and the power cord should not be exposed to moisture. These parts must also be protected against possible splashes or drops of water. Water must never penetrate in the electrical components.

WARNING

RISK OF BURNS - Always unplug the appliance before cleaning it. Let the appliance cool on its power supply base.

NOTE

RISK OF MATERIAL DAMAGE - Do not use chemical, abrasive or aggressive detergent for cleaning the appliance. Never use solvents which may damage the plastic parts.

NOTE: After each heating and frothing process immediately clean the container, in order to avoid that milk dries inside it.

- Unplug it from the main socket.
- Clean plastic parts with a damp, non-abrasive cloth and dry thoroughly with a soft cloth.
- Remove the sealing ring from the lid and remove the insert from the sleeve into the container.
- Wash the lid, seal ring and inserts with warm water and a dishwashing liquid.
- Only wash the inside of the container with warm water and dishwashing liquid.
- If necessary, clean the power supply base with a slightly damp cloth.
- Carefully dry all parts, especially the container to avoid the formation of stains.
- Re-insert the seal ring in the groove of the lid.

FAULTS AND SOLUTIONS

No operation.	Is the plug inserted in the main socket?
The heating and frothing process stops before the required time.	If, after a heating and frothing process, a new process starts immediately, this will last much less than usual.
The operation indicator light turn on in blue.	The appliance is overloaded. Unplug it from the main socket, pour a small amount of milk from the container and restart the appliance. The MAX marking should not be exceeded.
The milk is heated but not frothed.	Is the insert for frothing properly inserted into the sleeve on the bottom of the container?
The milk is heated but not frothed in a satisfactory manner.	Has the appropriate insert been used? Is there dirt on the insert or on the bottom of the container?
The appliance is unusually noisy.	Is there enough milk in the container? Is the insert properly fitted in the sleeve? Is the lid well fixed on the container?

TECHNICAL DATA

Nominal voltage:	220-240V
Nominal frequency:	50/60Hz
Nominal power:	500W
Protection Class:	I (This appliance must be earthed)

DISPOSAL OF WASTE



The product packaging is made of recyclable materials. The packaging material can be taken to public recycling collection points.



Old appliances do not belong in household waste! To comply with current legislation, old appliances, having reached the end of their useful lives, should be taken to a disposal facility where they can be sorted.

In this way, any valuable material contained in the old appliances can be recycled and the environment protected. Responsible local authorities or their waste disposal operators can provide further information.





WARRANTY CARD

Milk Heather/Frother

Your personal details:

Name _____

Address _____



Email _____

Date of purchase* _____

* We recommend you keep the receipt with this warranty card

Location of purchase _____

Description of malfunction:



Return your completed warranty card to:

Jaleno Europe Limited
 Roe Head House
 Far Common Road
 Mirfield
 West Yorkshire
 WF14 0DQ
 England

Kenilworth Electrical
 253 Harolds Cross Road,
 Dublin, Ireland
 kenilworthelec@eircom.net

AFTER SALES SUPPORT



GB 01924 481053

IRE 014968036 / 014963993



GB customerservice@jaleno.com

IRE kenilworthelec@eircom.net

MODEL: 2878, PRODUCT CODE: 72513, 10/2016

3

YEAR WARRANTY



Warranty conditions

Dear Customer,

The **ALDI warranty** offers you extensive benefits in addition to your statutory rights:

Warranty period: **3 years from date of purchase.**
6 months for wear parts and consumables under normal and proper conditions of use (e.g. rechargeable batteries).

Costs: Free repair/exchange or refund.
No transport costs.

Hotline: No additional charge for fixed network calls.

ADVICE: Please contact our service hotline by phone, e-mail or fax before sending in the device. This allows us to provide support in the event of possible operator errors.

In order to make a claim under the warranty, please send us:

- the original receipt and the warranty card properly completed.
- the product with all components included in the packaging.

The warranty does not cover damage caused by:

- **Accident or unanticipated events** (e.g. lightning, water, fire).
- **Improper use or transport.**
- **Disregard of the safety and maintenance instructions.**
- Other **improper treatment or modification.**

After the expiry of the warranty period, you still have the possibility to have your product repaired at your own expense. If the repair or the estimate of costs is not free of charge you will be informed accordingly in advance.

This warranty does not affect your statutory rights.