

Toaster  
多士炉

***Ariete***

De' Longhi Appliances Srl  
Divisione Commerciale Ariete  
Via San Quirico, 300  
50013 Campi Bisenzio (FI)  
E-Mail: [info@ariete.net](mailto:info@ariete.net)  
Internet: [www.ariete.net](http://www.ariete.net)

**199 202 250**

NUMERO UNICO

***Ariete***

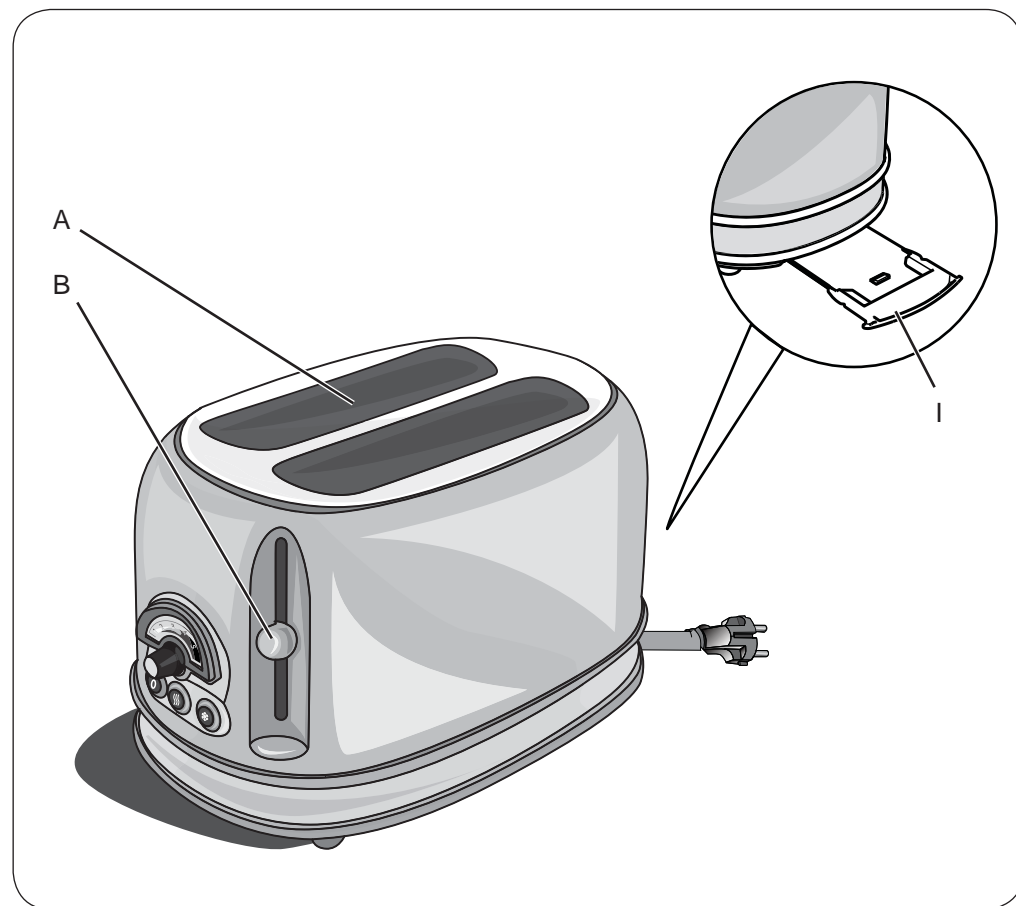

Fig. 1

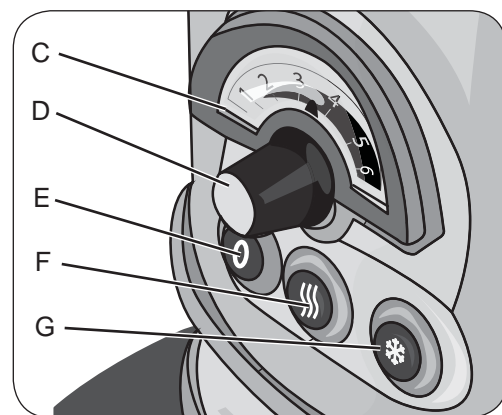

Fig. 2

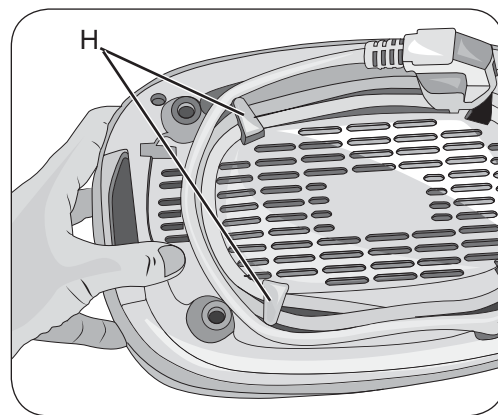

Fig. 3

## ABOUT THIS MANUAL

---

This appliance is made in conformity with appropriate European Regulations in force, to protect the user wherever possible from potential hazards. Even if you are familiar with this type of appliance, carefully read this manual before use. Only use this appliance for the purpose it is designed for in order to prevent accidents and damage. Keep this manual close by for future consultation. If you should decide to give this appliance to other people, remember to also include these instructions.

## INTENDED USE

---

The appliance must be used to defrost, heat and toast slices of bread and other dry foods of similar consistency. Any other use of the appliance is not intended by the Manufacturer who does not accept any responsibility for damages of any kind caused by improper use of the appliance itself. Improper use also results in any form of warranty being forfeited.

## IMPORTANT SAFEGUARDS

---

### READ THESE INSTRUCTIONS CAREFULLY.



- This appliance is designed only and solely for private use, and is therefore to be considered unsuitable for industrial or professional purposes.
- Do not use the appliance if the power cord or the plug are damaged, or if the appliance is faulty. All repairs, including the power cord replacement, must be carried out only by the Service Center or by authorized technicians, in order to avoid any risk.

#### Danger for children

- This appliance can be used by children aged from 8 years and above and persons with reduced physical, sensory or mental capabilities or lack of experience and knowledge if they have been given supervision or instruction concerning use of the appliance in a safe way and understand the hazards involved.
- Children shall not play with the appliance or its components.
- Always keep the appliance and the power cord out of the reach of children under the age of 8 years.
- Do not leave the packaging near children because it is potentially dangerous.

#### Danger due to electricity

- Any modifications made on this product that are not explicitly authorised by the manufacturer may lead to the forfeiture of its safety and guarantee of its use by the user.
- Before plugging the appliance into the mains socket, ensure that the voltage shown on the rating plate matches the local voltage supply.
- Always connect the appliance to an earthed socket.
- Even when the appliance is not in use, unplug it from the electrical outlet before inserting or removing individual parts or before cleaning it.
- Make sure that your hands are dry before using or adjusting the switches on the appliance, or before touching the plug and power connections.
- Do not pull the power cord to unplug the appliance.

- Do not leave the power cord against sharp edges or sharp parts.  
 **Danger of material damage**
- Do not immerse the appliance, the plug or the power cord in water or other liquids. Clean them with a damp cloth.
- Do not place the appliance on or near heat sources.
- The bread can burn, so the toaster must not be used under or near combustible materials such as curtains.
- Do not insert more than two slices for each slit.
- Do not put your hands or any type of metal (such as knives or aluminium foil) inside the toaster.
- In the event that this appliance is to be disposed of, it is suggested that the power cord is cut off. It is also recommended that all potentially dangerous components including the power cord are rendered harmless to prevent personal injury. Do not let children play with the appliance or its components.
-  For proper disposal of the product in accordance with the European Directive **2012/19/EU** please read the dedicated leaflet attached to the product.

**SAVE THESE INSTRUCTIONS FOR FUTURE REFERENCE**

## DESCRIPTION OF THE APPLIANCE

---

- A Slits
- B ON lever
- C Toasting level indicator
- D Knob for adjusting the toasting level
- E Stop button
- F Warming function button
- G Defrost function button
- H Cord storage device
- I Crumb tray

## OPERATING INSTRUCTIONS

---

**Do not use slices of bread too thin or broken.**

**Do not put too bulky foods.**



**Warning**

Do not include foods that may drip during cooking. In addition to making difficult the cleaning operations, they can cause fires. Clean the crumb tray from any food residue or crumbs before each use.



**Danger - Risk of electric shock**

Do not put forks or other utensils inside the appliance. This operation can damage the heating elements of the appliance and create a danger of electric shock.

## FIRST USE

---

At the first use it is recommended to keep the appliance on for a few minutes to eliminate the smell of "new". The appliance may give out a little smoke when used for the first time.

## HOW TO MAKE TOAST

---

- 1) Insert the slices of bread inside of the toaster slits (A).
- 2) Turn the knob (D) to set the desired toasting level
- 3) Lower the ON/OFF lever (B).
- 4) After a few minutes the toasting is completed, and the slices of bread are ejected upwards.
- 5) After use, press the button (E) to switch the appliance off.
- 6) Disconnect the power supply cable from the power point. Remove any residues from the crumb tray (I).
- 7) After use, we recommend using the cord storage (H) to wrap the cord around the appliance base. Press the button (E) to stop the toasting at any time.

## DEFROST FUNCTION

---

You can use the appliance to defrost frozen bread slices.

- 1) Insert the frozen slices of bread inside the toaster slits (A).
- 2) Turn the knob (D) to set the toasting level to position "1".
- 3) Lower the ON/OFF lever (B).
- 4) Press the button (G) to activate the defrost function. The button remains lit throughout the defrosting time.

If you want to defrost and bake bread at the same time, adjust the toasting on higher levels.

## WARMING FUNCTION

---

You can use the appliance to warm the slices of bread.

- 1) Insert the slices of bread inside of the toaster slits (A).
- 2) Lower the ON/OFF lever (B).
- 3) Press the button (F) to activate the heating function. The button remains lit throughout the warming time.

The warming time is fixed and can not be modified.

## CLEANING AND MAINTENANCE

---

Regular maintenance and cleaning preserve and maintain the appliance efficient for a longer period.



**Danger - Risk of electric shock**

All cleaning operations described below must be made with power off and the electrical plug disconnect from the power outlet.



**Danger - Risk of burns**

Each cleaning and maintenance operation should be performed when the unit is completely cooled.



**Caution - Risk of material damage**

Don't immerse the base in water. Don't use aggressive products or solvents that may damage the plastic.

Never use sharp metal tools to clean inside the appliance.

After each use of the appliance, empty and clean the crumb tray (I).

Wash the appliance using a slightly wet, non-abrasive cloth, water and few drops of a non-aggressive product.

Dry the appliance by hand.

## 关于本手册

本电器根据适用现行欧洲法规要求制造，尽量保护用户免受潜在危险伤害。即使您熟悉此类电器，也请在使用前仔细阅读本手册。本电器仅可以用于其设计用途，以防发生意外和损坏。请妥善保管本手册，以便日后查阅。如果您将此电器送给他人，请连同本手册一起转送。

## 设计用途

本电器应用于解冻、加热和烘烤面包片以及其他类似稠度的干燥食品。若本电器用于非设计用途，厂家不承担任何因电器使用不当造成的任何损失，使用不当还会导致电器保修失效。

## 重要保障措施

请仔细阅读以下指南。

- 本电器专为家用设计，因此不适用于工业或专业用途。
- 如果电源线或插头出现损坏或电器出现故障，请勿使用。所有维修（包括更换电源线）必须由服务中心或授权技术人员完成，以免出现危险。

### 儿童危险

- 8岁及以上儿童可以使用本电器，而身体、感觉或心理不健全，缺乏经验和知识人员在监护下，经过安全使用指导了解涉及危险后也可使用本电器。
- 本电器及组件不得用作儿童玩具
- 将本电器和电源线置于8岁以下儿童接触不到的地方。
- 包装不得放置在儿童附近，因为可能造成危险。

### 触电危险

- 未经制造商明确授权，用户私自改装本产品可能造成危险，产品保修自动失效。
- 将电器插入电源插座之前，请确保铭牌上标注电压与本地电源相匹配。
- 电器始终连接接地插座。
- 即使在不使用电器时，在插入或取出单个部件之前或清洁之前，请从电源插座上拔下插头。
- 仅可在双手干燥情况下使用或调整电器开关，或触摸插头和电源接线。
- 请勿通过拉扯电源线拔掉电器。
- 请勿将电源线靠近尖锐边缘或锋利部件。

### 物料损毁

- 请勿将电器、插头或电源线浸入水或其他液体中。请用湿布清洁电器。
- 请勿将电器靠近热源放置。
- 面包可能会燃烧，因此不得在可燃材料（如窗帘）下面或附近使用烤面包机。

- 炉口不得放置两片以上面包片。
- 请勿将手或任何金属（如刀或铝箔）放入烤面包机。
- 如果要处理本电器，建议切断电源线，并且建议对可能造成危险的组件（包括电源线）进行无害处理，以防止人身伤害。本电器及其组件不得用作儿童玩具。

 请根据欧洲指令2012 / 19 / EU妥善处理本产品。请阅读产品附带的专用手册。

请妥善保存手册以供将来参考。

## 电器描述

- A 炉口
- B 开关柄
- C 烘烤程度指示
- D 烘烤程度调节旋钮
- E 停止按钮
- F 加热功能键
- G 解冻功能键
- H 存线装置
- I 碎屑托盘

## 操作指南

面包切片不要太薄或破损。

不要放入过大食物。

 **警告**  
严禁放入烹饪过程中可能滴落的食物。因为除了难以清洗外，还可能引起火灾。在每次使用前，清除碎屑托盘中的食物残渣或碎屑。

 **危险—触电危险**  
严禁将叉子或其他器具放入电器内部。此操作可能会损坏电器加热元件，并导致触电。

## 初次使用

建议第一次使用时，电器保持加热状态几分钟，以消除“新电器”气味。本产品第一次使用时可能会散发少量烟雾。

## 如何制作吐司？

- 1) 将面包片插入烤面包机炉口（A）内。
- 2) 转动旋钮（D）设置所需烘烤程度。
- 3) 按下开关柄（B）。
- 4) 几分钟后，烘烤完成，面包片向上弹出。
- 5) 使用后，按下按钮（E）关闭电器。
- 6) 断开电源线与电源插座的连接。清理碎屑托盘（I）中的残留物。
- 7) 使用后，建议用存线装置（H）将电源线缠绕在电器底座上。按下按钮（E）可随时停止烘烤。



## 解冻

---

可以使用本电器对冷冻面包片进行解冻。

- 1) 将冷冻面包片插入烤面包机炉口 (A) 内。
- 2) 转动旋钮 (D) 将烘烤程度设置到位置 “1”。
- 3) 按下开关柄 (B)。
- 4) 按下按钮 (G) 激活解冻功能。在整个解冻过程中，按钮保持开着的状态。如果想同时解冻和烘烤面包，烘烤程度调至更高。

## 加热功能

---

Y 可以使用本电器对面包片进行加热。

- 1) 将面包片插入烤面包机炉口 (A) 内。
- 2) 按下开关柄 (B)。
- 3) 按下按钮 (F) 激活加热功能。在整个加热过程中，按钮保持发光。加热时间是固定的，不能修改。

## 清洁与维护

---

定期维护和清洁电器，以便提高电器效率，延长电器寿命。



危险—触电危险

必须在关闭电源后，方可进行下面所述清洁操作，电气插头必须与电源插座断开。



危险—灼伤危险

必须等电器完全冷却后，方可进行清洁和维护操作。



小心—材料损坏危险

不得将底座浸入水中。不得使用侵蚀塑料的腐蚀性产品或溶剂。

切勿使用锋利的金属工具清洁电器内部。

每次使用本产品后，清空并清洁碎屑托盘 (I)。

使用微湿非磨蚀布料，沾水及几滴非侵蚀性清洁产品清洗电器。

人工擦干电器。