



Spend a little Live a lot



Spend a little Live a lot

# User Manual

## Contents

Great care has gone into the manufacture of this product and it should therefore provide you with years of good service when used correctly. In the event of product failure within it’s intended use over the course of the first 3 years after date of purchase, we will remedy the problem as quickly as possible once it has been brought to our attention. In the unlikely event of such an occurrence, or if you require any information about the product, please contact us via our helpline support services, details of which are to be found both in this manual and on the product itself.



**PRODUCED IN CHINA FOR:**  
ALDI STORES LTD. PO BOX 26, ATHERSTONE  
WARWICKSHIRE, CV9 2SH.

ALDI STORES (IRELAND) LTD.  
PO BOX 726, NAAS, CO. KILDARE.  
visit us at [www.aldi.com](http://www.aldi.com)

## AMBIANO RETRO TOASTER



With regard to this manual.....	1
Important safeguards.....	1
Operation precautions.....	4
Instructions for use.....	4
Cleaning and maintenance .....	5
Technical data.....	6
Disposal of waste.....	6
Warranty card.....	7
Warranty conditions.....	8

### AFTER SALES SUPPORT

**GB** 01924 481053 **GB** customerservice@jaleno.com  
 **IRE** 014968036/014963993 **IRE** kenilworthelec@eircom.net

Model: 151 Product Code: 71314 07/2016



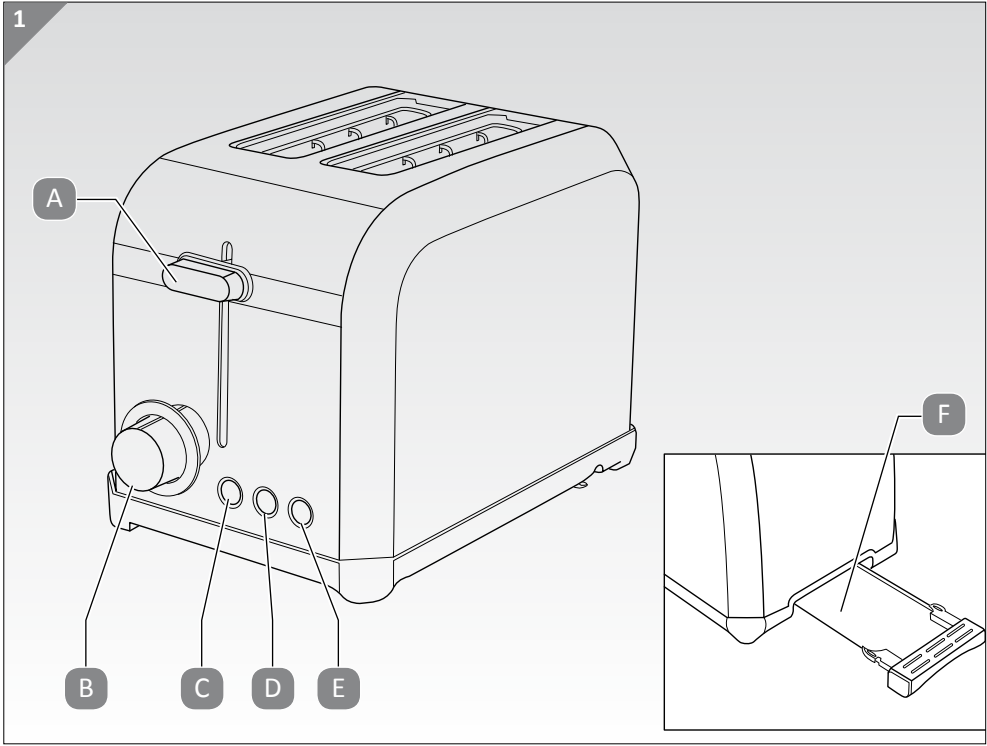

## Description of the appliance

- A ON lever
- B Toasting level adjustment knob
- C Stop button with integrated light
- D Heating button with integrated light
- E Defrosting button with integrated light
- F Crumb tray

## WITH REGARDS TO THIS MANUAL

Even if you are familiar with this type of product please read these warnings carefully and use the appliance only for the use it is designed for in order to prevent accidents and damage. Keep this manual close by for future consultation. If you should decide to give this appliance to other people, remember to also include these instructions. The information provided in this manual is marked with the following symbols indicating:



Danger for children



Danger from electricity



DANGER from other causes



IMPORTANT, possible damage to materials

This manual is available in electronic format on the website.

## IMPORTANT SAFEGUARDS

**READ THESE INSTRUCTIONS BEFORE USE.**

**ALWAYS KEEP THESE INSTRUCTIONS.**

## COMPLIANCE TO EU DIRECTIVES

This appliance conforms to the directives 2014/35/EU, EMC 2014/30/EU, 2011/65/EU and to the regulations (EC) No. 1935/2004 of 27/10/2004 regarding material in contact with foods. To dispose of the product correctly according to European Directive 2012/19/EU, please refer to and read the provided information enclosed with the product.



### **Danger for children**

1. Appliances can be used by persons with reduced physical, sensory or mental capabilities or lack of experience and knowledge if they have been given supervision or instruction concerning use of the appliance in a safe way and if they understand the hazards involved.
2. This appliance shall not be used by children. Keep the appliance and its cord out of reach of children. Children shall not play with the appliance.
3. Never allow the cord to dangle in places where it may be grabbed by a child.
4. When disposing of the appliance as waste, it must be made inoperative by cutting off the power cord. Also remember to make any potentially hazardous parts of the appliance safe including the power cord, as



there is a risk that children may use them as playthings.

5. Packaging elements must not be left in reach of children as they are potentially hazardous.



### **Danger from electricity**

6. Make sure that the voltage on the appliance rating plate corresponds to that of your local mains electricity supply.
7. Never leave the appliance unattended when connected to the power supply; unplug it after every use.
8. Make sure that the power cord does not come into contact with hot or sharp surfaces.
9. It is not recommended to use this appliance in conjunction with an extension cord.



### **Danger from other causes**

10. Always unplug the power cord from the mains supply before fitting or removing attachments or before cleaning the appliance.
11. Always make sure that your hands are thoroughly dry before using or adjusting the controls on the appliance, or before touching the power plug or power connections.
12. Toasted bread can burn; never use the toaster under or alongside flammable materials, such as curtains.
13. Always handle the appliance with care during use and never touch the hot sides. Danger of burns.
14. Do not place plates or other items on top of the toaster during use.
15. Do not place more than one slice of bread in each slot.
16. Never insert forks or other utensils inside the toaster to remove the toast; this could damage the heating elements inside the appliance.
17. Never place your hands or any other metal materials (for example, knives or tin foil) inside the toaster. Risk of electrocution.
18. Use the appliance well away from flammable liquids; do not rest it against walls, curtains or plastic parts that are not heat resistant.



19. The appliance may only be wiped clean with a damp cloth and only after unplugging it from the mains and leaving it to cool completely.
20. After use, wait for the appliance to cool completely before storing.
21. This appliance may not be operated using external timers or remote controls.

**Important, Possible damage to materials**

22. Never place the appliance on or close to sources of heat.
23. Always place the appliance on a flat, level and heat resistant surface during use.
24. Never leave the appliance exposed to the elements (rain, sun, etc....).
25. Never immerse the appliance body, plug or power cord in water or other liquids; always wipe clean with a damp cloth only.
26. To unplug the appliance, grip the plug and remove it directly from the power socket. Never pull the power cord to unplug the appliance.
27. Do not use the appliance if the power cord or plug are damaged or if the appliance itself is faulty; all repairs, including the replacement of the power cord, must be carried out exclusively by the After Sales Support centre or by authorised technicians in order to avoid all risks.
28. Do not affect the safety of the appliance by using parts that are not original or which have not been approved by the manufacturer. Risk of electrocution or injury.
29. Any changes to this product that have not been expressly authorised by the manufacturer may lead to the user's warranty being rendered null and void.



## OPERATION PRECAUTIONS

- Do not use slices of bread that are too thin or broken.
- Do not insert foods that could drip during cooking. As well as making cleaning more difficult, these foods can also become the cause of fire. It is also very important to clean any food residues or crumbs from the crumb tray (F) before each use.
- Do not insert food products that are too large by forcing them in.

### **ATTENTION**

**Do not put forks or other utensils inside the toaster to remove the bread since they could damage the heating elements of the appliance. RISK OF ELECTRIC SHOCKS.**

## INSTRUCTIONS FOR USE

- Keep the appliance on for a few minutes the first time it is used so as to get rid of the “new” odour and any residual fumes from the manufacturing process.
- Keep the original packing for future use if it should prove necessary. It is the best way to properly protect it from being damaged during transportation.  
Before using this product, be sure to carefully follow the instructions supplied in this instruction manual carefully.

### Preparing toast

### **CAUTION**

**Always allow at least 1 minute's cooling time between cycles if the toaster is being used more than once at a time.**

- Connect your toaster to a suitable positioned wall socket and switch on.
- Put the slices of bread into the bread slots of the toaster and lower the ON lever (A) until it locks into place.
- Adjust the toasting level with the knob (B). Wait a few minutes and after the toast is automatically ejected, check its toasting level. If the toast is not browned enough, select a higher toasting level. If, on the other hand, it is too dark, select a lower level.
- Press the button (E) at any time to stop the toasting process.
- Press the button (E) to turn the appliance off and disconnect the plug from the socket-outlet.

**⚠ ATTENTION**

**Note: if the appliance is not plugged in, the lever does not lock.**

**Defrosting function**

You can defrost frozen slices of bread by pressing the button (E) right after you lower the lever (A) and by setting the browning control knob (B) onto 1. If you wish to cook, rather than just defrosting, the knob will have to be set onto darker settings (i.e. 3, 4, 5, 6 or 7). The light integrated in the button will stay on as long as the defrosting function is used.

**Heating function**

Lower the on lever (A) and press the heating button (D). The light integrated in the button will stay on as long as this function is used. Please note that the heating time is fixed and cannot be changed.

**CLEANING AND MAINTENANCE****⚠ CAUTION**

**It is forbidden to disassemble the appliance or to try in any way to undertake any maintenance work on the appliance other than as described in this manual.**

**⚠ ATTENTION**

**Keeping the appliance clean and tidy will ensure you will get optimum toasting and a longer useful lifetime for your appliance.**

- Turn off the appliance by pressing the button (C) and remove the plug from the socket-outlet before you start to clean it.
- Wait for the appliance to cool down before cleaning.
- Use only a slightly dampened cloth.
- Do not immerse the appliance in water or other liquids.
- Always dry the appliance parts by hand without putting them in an oven or microwave.
- Never use sharp metal utensils for cleaning the interior of the appliance.
- Unplug the appliance and empty the crumb tray (F) after each use.
- From time to time clean the exterior of the appliance with a damp cloth and then dry. Do not use abrasive detergents since they could damage the cosmetic surfaces of the appliance.



## TECHNICAL DATA

Nominal voltage: 220-240V  
Nominal frequency: 50/60Hz  
Nominal power: 685-815W  
Protection Class: I (This appliance must be earthed.)

## DISPOSAL OF WASTE



**The product packaging is made of recyclable materials. The packaging material can be taken to public recycling collection points.**



**Old appliances do not belong in household waste!** To comply with current legislation, old appliances, having reached the end of their useful lives, should be taken to a disposal facility where they can be sorted.

In this way, any valuable material contained in the old appliances can be recycled and the environment protected. Responsible local authorities or their waste disposal operators can provide further information.







# WARRANTY CARD

## Retro Toaster

### Your personal details:

Name \_\_\_\_\_

Address \_\_\_\_\_

\_\_\_\_\_



Email \_\_\_\_\_

Date of purchase\* \_\_\_\_\_

\* We recommend you keep the receipt with this warranty card

Location of purchase \_\_\_\_\_

### Description of malfunction:



### Return your completed warranty card to:

**Jaleno Europe Limited**  
**Roe Head House**  
**Far Common Road**  
**Mirfield**  
**West Yorkshire**  
**WF14 0DQ**  
**England**

**Kenilworth Electrical**  
**253 Harolds Cross Road,**  
**Dublin, Ireland**  
**kenilworthelec@eircom.net**

### AFTER SALES SUPPORT



GB 01924 481053

IRE 014968036 / 014963993



GB customerservice@jaleno.com

IRE kenilworthelec@eircom.net

MODEL: 151 PRODUCT CODE: 71314, 07/2016

# 3

YEAR WARRANTY



## Warranty conditions

Dear Customer,

The **ALDI warranty** offers you extensive benefits in addition to your statutory rights:

**Warranty period:**           **3 years from date of purchase.**  
**6 months** for wear parts and consumables under normal and proper conditions of use (e.g. rechargeable batteries).

**Costs:**                       Free repair/exchange or refund.  
No transport costs.

**Hotline:**                   No additional charge for fixed network calls.

**ADVICE:** Please contact our service hotline by phone, e-mail or fax before sending in the device. This allows us to provide support in the event of possible operator errors.

**In order to make a claim under the warranty, please send us:**

- the original receipt and the warranty card properly completed.
- the product with all components included in the packaging.

**The warranty does not cover** damage caused by:

- **Accident or unanticipated events** (e.g. lightning, water, fire).
- **Improper use or transport.**
- **Disregard of the safety and maintenance instructions.**
- **Other improper treatment or modification.**

After the expiry of the warranty period, you still have the possibility to have your product repaired at your own expense. If the repair or the estimate of costs is not free of charge you will be informed accordingly in advance.

This warranty does not affect your statutory rights.