

# Ariete

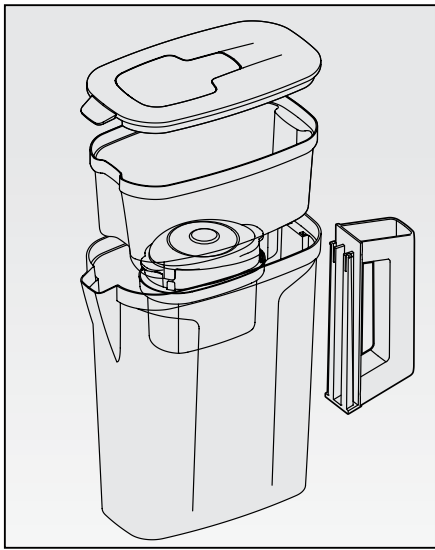

## Mod. 2803

EN

### IMPORTANT SAFEGUARDS

#### READ THESE INSTRUCTIONS BEFORE USE

1. Never place the appliance on or close to sources of heat.
2. Never leave the appliance exposed to the elements (rain, sun, etc....).
3. This appliance is not intended for use by persons (including children) with reduced physical, sensory or mental capabilities, or lack of experience and knowledge, unless they have been given supervision or instruction concerning use of the appliance by a person responsible for their safety.
4. Children should be supervised to ensure that they do not play with the appliance.
5. This appliance is designed for HOME USE ONLY and may not be used for commercial or industrial purposes.
6. Only filter cold water.
7. Consume filtered water within one to two days.
8. We recommend boiling water for use in the preparation of baby food.
9. Don't use the filter jug for any purpose other than filtering water.
10. Any changes to this product that have not been expressly authorised by the manufacturer may lead to the user's guarantee being rendered null and void.
11. Packaging must never be left within the reach of children since it is potentially dangerous.

### DO NOT THROW AWAY THESE INSTRUCTIONS

#### DESCRIPTION OF THE APPLIANCE (Fig. 1)

- A Fridge jug
- B Filter cartridge
- C Water tank
- D Spout
- E Jug lid
- F Water insertion slot
- G Removable handle

#### Before using the filter jug for the first time

- Remove all packaging from the filter jug.
- Remove the jug lid (E) and take the water tank (C) out.
- Take the filter cartridge (B) out and remove any packaging.
- Fill the filter jug with cold water and rinse.

#### Preparing the water filter cartridge

Prepare your filter cartridge (B) by carefully following all of the instructions on the packaging.

Remove the cartridge from all packaging (Fig. 2). There may be a small residue of black particles (carbon) in the bag or adhering to the cartridge body, this is normal. These particles are harmless and are washed off during the preparation process.

Shake the cartridge (B) in cold water to ensure that any trapped air bubbles are removed (Fig. 3). Some loose carbon particles may be released during this process. This is normal and does not influence performance.

Your filter cartridge is now ready for use.

#### INSTRUCTIONS FOR USE

- Insert the handle (G) into the appropriate guides on the jug (A) (Fig. 4).
- Remove the jug lid (E) and lift the water tank (C) out of the fridge jug (A).
- Place the cartridge (B) into the base of the water tank (C).
- Push the cartridge (B) towards the water tank and turn it clockwise to lock in place (Fig. 5).

**ATTENTION:** Ensure the cartridge (B) is firmly secured.

- Lower the water tank (C) until it sits inside the jug (A).
- Fill the upper vessel with cold water and allow the water to pass through the cartridge (B). Discard this water and repeat this process once more (Fig. 6). It is possible also to insert water through the special top slot (F).
- Replace the lid (E).

#### Changing the water filter cartridge

- Remove the jug lid (E).
- Lift the water tank (C) out of the jug (E).
- Hold the water tank and turn the water filter anticlockwise to release it from the water tank.
- Discard the water filter.
- Prepare and insert the new cartridge for use as described opposite.

#### Care of the System

Water is a foodstuff. We recommend using the filtered water within 2 days. In the event of the filter jug not being used for more than 48 hours, fill it twice with cold water, and discard the water before continuing use as normal. Should the system not be used for an extended period of time (for example, a holiday) we recommend that the filter is removed and placed in a clean plastic bag and stored in the fridge. This will help to maintain the filter when not in use. Before using the filter after storage, follow the preparation and fitting instructions for use as normal.

The filter should be stored out of direct sunlight and away from heat sources.

The water tank and jug lid should be washed regularly, at least every time the filter is replaced.

**IMPORTANT:** Ariete guarantees the correct operation of the appliance only when used with original Ariete Hidrogenia filters.

#### Cleaning

Wipe inside and out with a damp cloth and clean the water filter and tank. Don't use any washing-up liquid or anything that may taint the water.

Don't use harsh or abrasive cleaning agents or solvents.

#### Filter Holder Seal

Care should be taken to ensure that the seal is fitted correctly otherwise un-filtered water may leak into the filter jug. If the seal becomes dislodged during cleaning or transportation it can be easily re-fitted on to the filter holder found on the underside of the water tank.

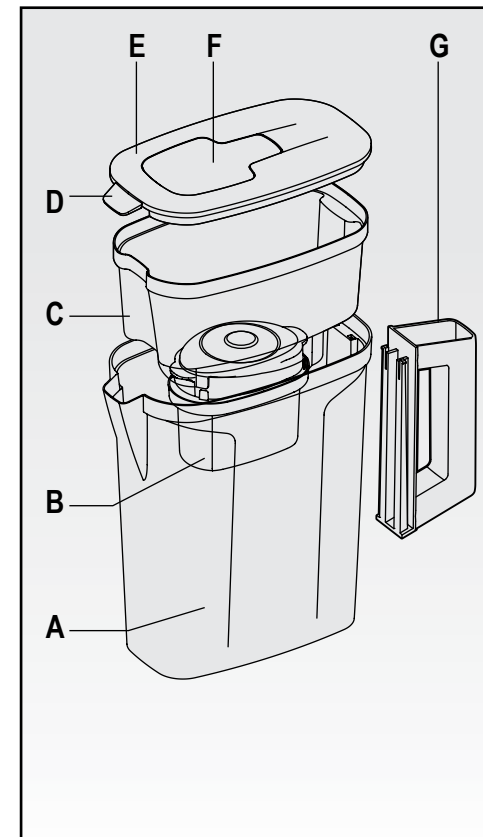

Fig. 1

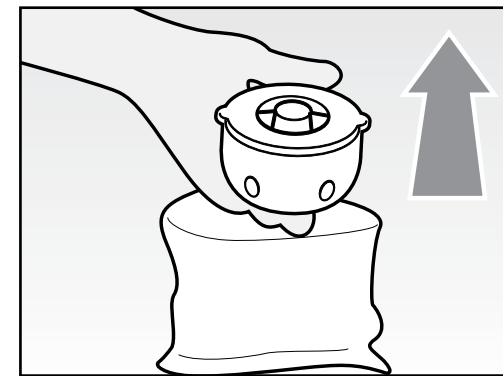

Fig. 2

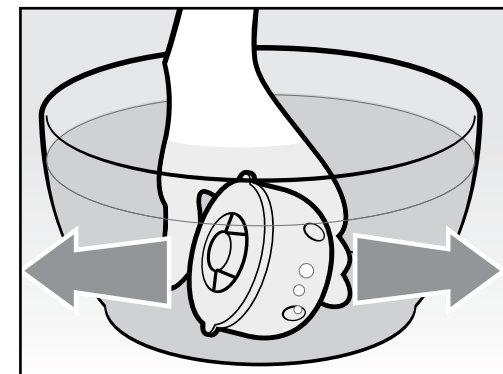

Fig. 3

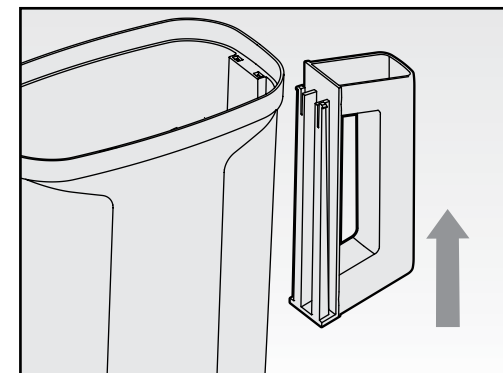

Fig. 4

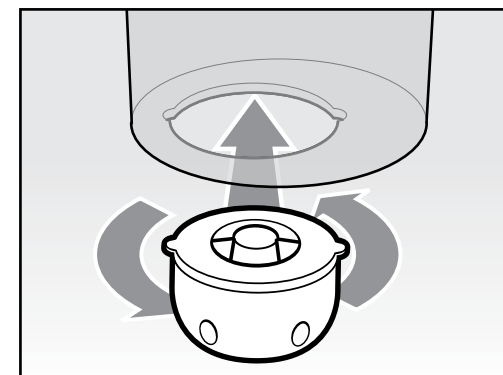

Fig. 5

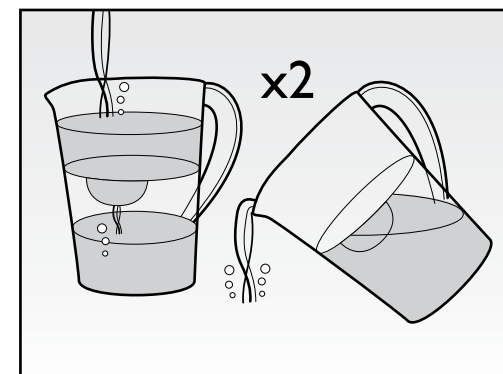

Fig. 6

重要保障措施

- 切勿将电器放在热源上或靠近热源的地方。
- 切勿将电器暴露在自然环境中（雨、太阳等……）。
- 身体或精神能力较弱或不具有相关经验和知识的人员（包括儿童）不得使用该电器，除在其安全负责人的监督或指导下使用。
- 切勿允许儿童将该电器作为玩具。
- 该电器仅供家庭使用，不得用于商业或工业用途。
- 只过滤冷水。
- 在一到两天内用完过滤水。
- 建议在准备婴儿食品时，使用开水。
- 不得将水壶用于除过滤水外的其他目的。
- 未经生产商明确许可的任何该产品改装可能会导致用户的质保无效。
- 由于包装可能存在危险，请将其放在儿童接触不到的地方。

请妥善保存此说明书

电器描述（图1）

- A 冷却水壶
- B 滤筒
- C 水箱
- D 喷嘴
- E 水壶盖子
- F 进水槽
- G 可拆卸手柄

在首次使用冷却水壶前

- 将滤水壶从包装中拿出。
- 打开水壶盖子（E）和水箱（C）。
- 拿出滤筒（B），拆掉包装。
- 在滤水壶中装水，冲洗

准备滤筒

仔细根据包装上的所有说明，准备滤筒（B）。  
拆开滤筒包装（图2）。在滤

包中或滤筒上可能会有残留的黑色小颗粒（碳），这是正常的。这些颗粒没有危害性，可在准备过程中冲洗干净。

在冷水中摇晃滤筒（B），确保消除任何其中的气泡（图3）。在这一过程中可能会出现一些松散的碳颗粒。但这是正常的，不影响整体性能。

上述操作完成后，便可使用滤筒。

使用说明

- 将手柄（G）插入水壶上适当的引导装置上（A）（图4）。
  - 拿开水壶盖子（E），和从冷却水壶（A）中拿出水箱（C）。
  - 将滤筒（B）放入水箱底部（C）。
  - 将滤筒（B）顺时针旋转后固定（图5）。
- 注意：确保滤筒（B）固定。
- 向下放入水箱（C），直到其抵达水壶内部（A）。
  - 在上容器中装入冷水，让水通过绿滤筒（B）。倒出这些水后，重复此过程（图6）。还可以在特殊顶槽中加入水（F）。
  - 重新盖上盖子（E）

更换滤筒

- 拆下水壶盖子（E）。
- 从水壶（E）中提起水箱（C）。
- 拎着水箱，逆时针旋转滤水器。
- 将滤水器从水箱中旋出。
- 准备和插入新滤筒，进行使用。

系统维护

水是一种食品。建议在2天内用完过滤水。若水壶未被使用超过48小时，倒满两次冷水，然后在继续正常使用前将水倒出。如果在一段时间（例如，假日期间）不适用系统，建议

拆除过滤器，将其放置在一个干净的塑料袋中，并储存在冰箱里。这样能够在过滤器不使用期间维持过滤器。使用存储后的过滤起之前，请按照正常准备和安装说明，保证正常使用。  
过滤器应该避免阳光直射，远离热源。  
水箱和水壶盖子应定期清洗，至少在每次更换过滤器时。

重要提示：阿里亚特仅在使用原配阿里亚特Hidrogenia过滤器的情况下对正确的电器操作进行担保。

清洁

用湿布擦拭内外部，并清洁滤水器和水箱。不要使用任何洗涤剂或任何可能污染水源的物质。  
且勿使用具有刺激性或磨洗作用的清洁剂或溶剂。

过滤器支架密封条

应小心确保密封条安装正确，否则未经过滤的水可能泄漏到滤罐中。如果密封条在清洗或运输过程中脱落，可轻易将其重新安装在水箱底部的过滤器支架上。

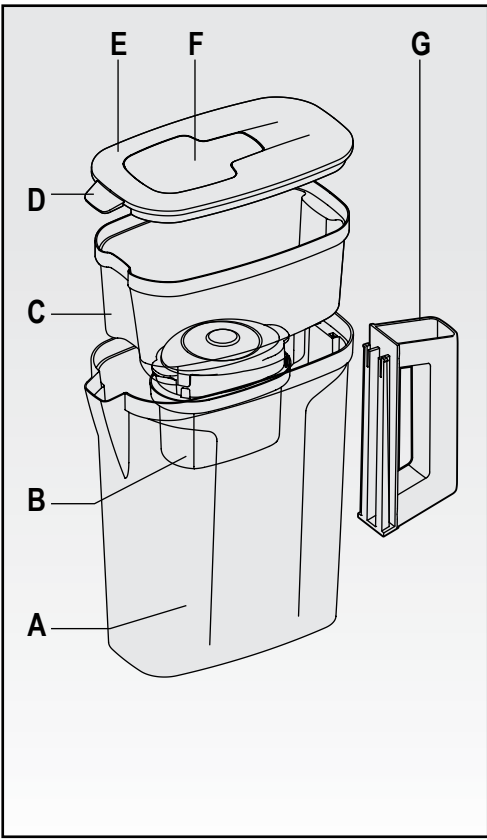

Fig. 1

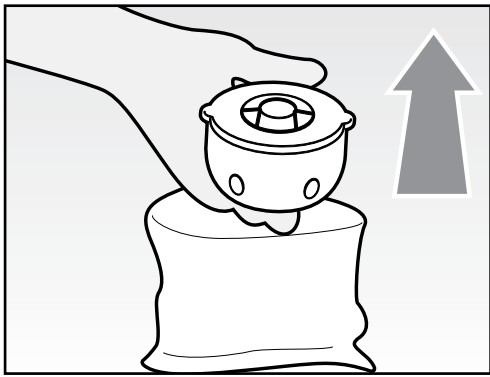

Fig. 2

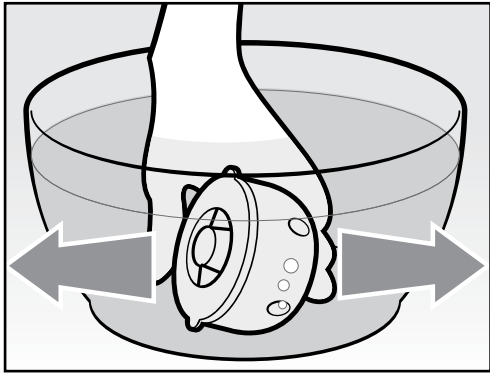

Fig. 3

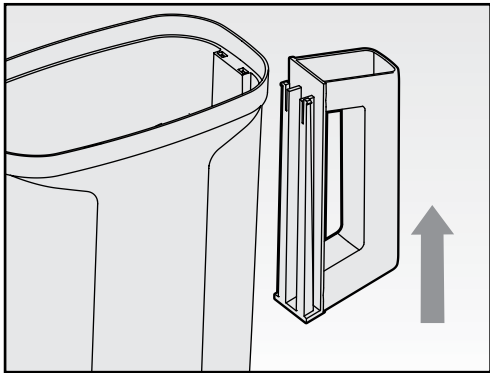

Fig. 4

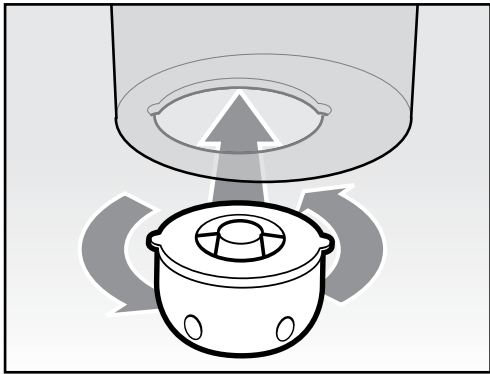

Fig. 5

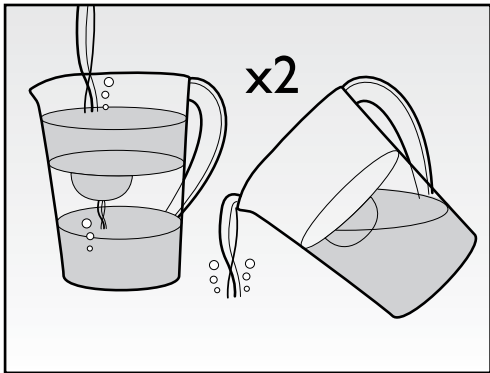

Fig. 6

199 202 250  
NUMERO UNICO

**Ariete**

De' Longhi Appliances Srl  
Divisione Commerciale Ariete  
Via San Quirico, 300  
50013 Campi Bisenzio FI - Italy  
E-Mail: info@ariete.net  
Internet: www.ariete.net