

Ariete

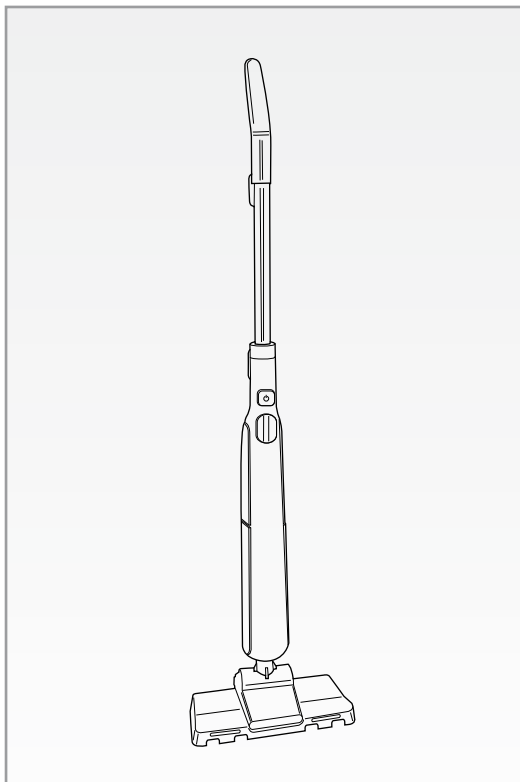

Floor steam cleaner
蒸汽拖把

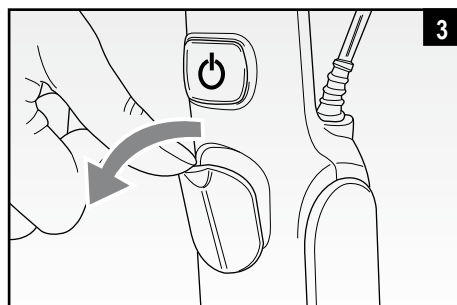

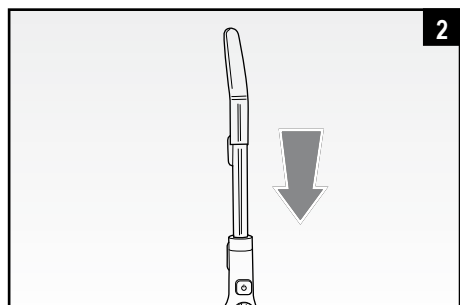
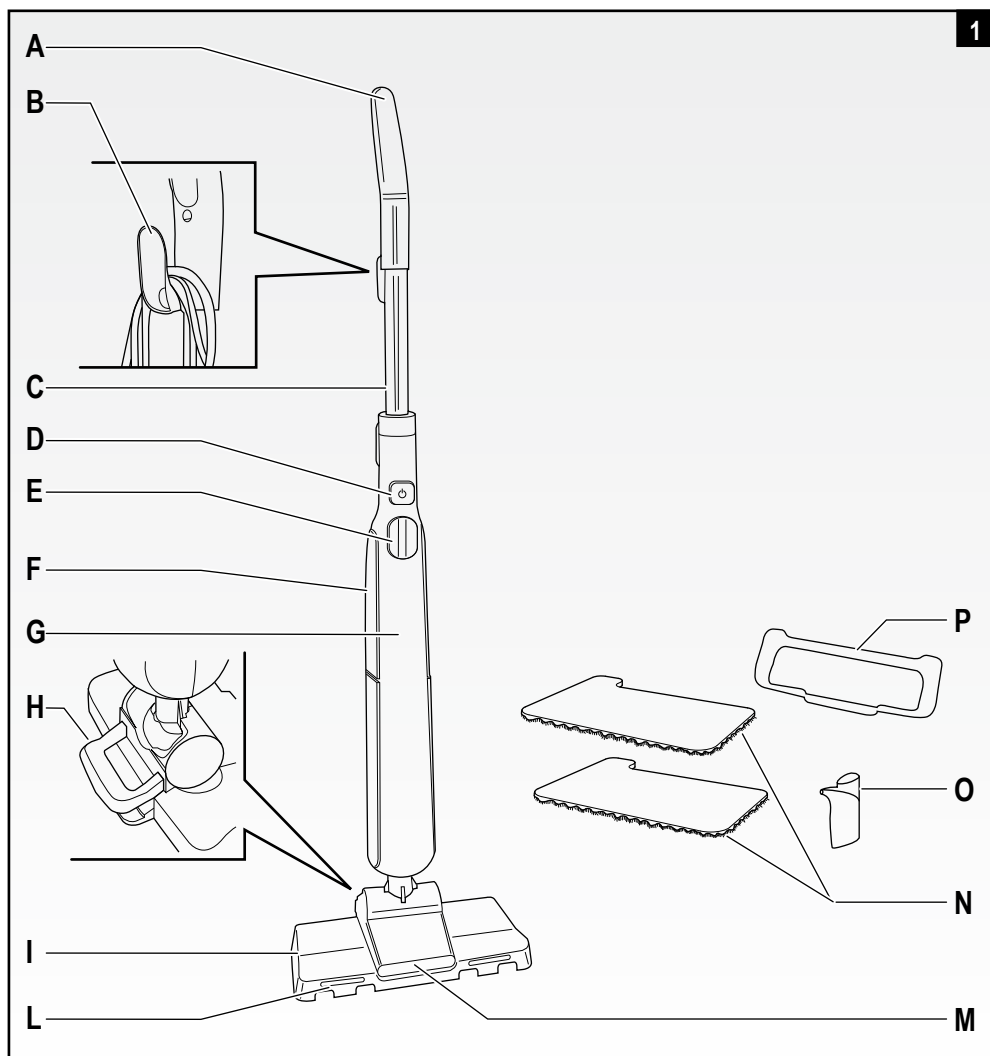
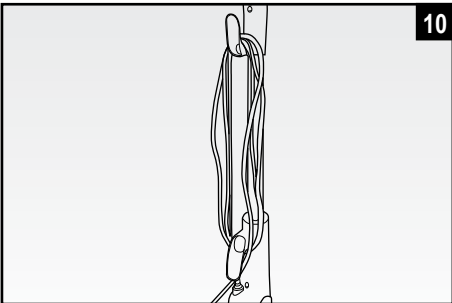
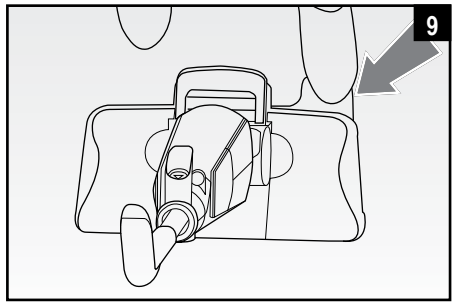
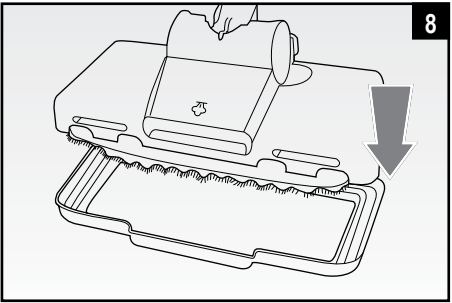
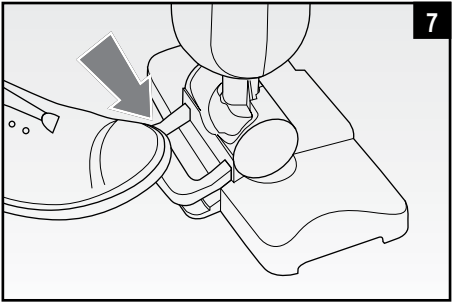
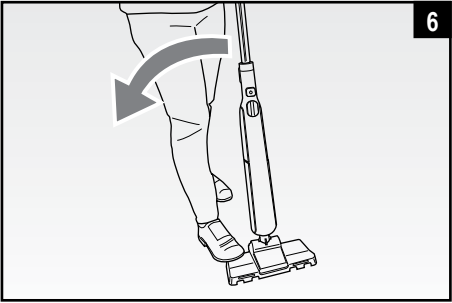
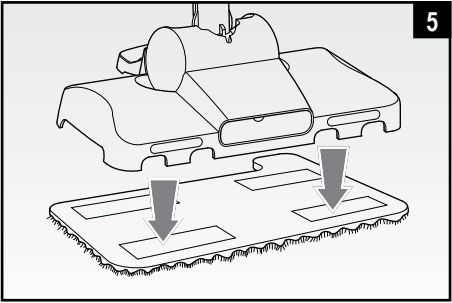
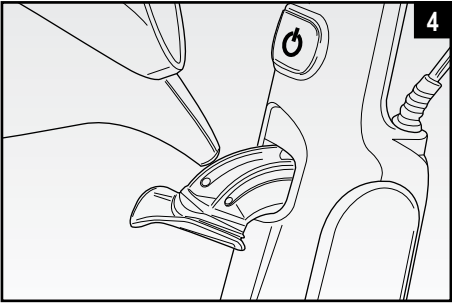

ABOUT THIS MANUAL

Even if the appliances are made in conformity with the European regulatory specifications in force and therefore all potentially hazardous parts are protected. Carefully read these warnings and use the appliance only for the use it is designed for in order to prevent accidents and damage. Keep this manual close by for future consultation. Should you decide to give this appliance to other people, remember to also include these instructions.

The information provided in this manual is marked with the following symbols indicating:



Danger to children



Warning of burns



Danger due to electricity



Warning – material damage



Danger of damage originating from other causes

INTENDED USE

The appliance is suitable for thoroughly cleaning and sanitizing floors, as marble, ceramic, stone, tiles, parquet, as well as hard-wood floors provided they are treated and impervious. Use the cloth to absorb excessive moisture. The appliance exploits active power of steam without the need of detergents and soaps.

Any other use of the appliance is not intended by the Manufacturer who does not accept any responsibility for damages of any kind caused by improper use of the appliance itself. Improper use also results in voiding of any form of warranty.

RESIDUAL RISKS



Warning!

Do not use the device on surfaces treated with wax. The wax will be removed by the action of heat and steam. Do not use on permeable floors on untreated wood. Do not leave the appliance on any kind of wooden surface for a prolonged period of time: wood might swell.

It is advisable to try the appliance on a hidden area of the domestic floor first. Otherwise, it is advisable to ask for information to the floor manufacturer about the cleaning modes.

SAFETY WARNINGS

READ THE INSTRUCTIONS CAREFULLY BEFORE USE.

- This appliance is intended for household use and similar.
- We decline any responsibility resulting from misuse or any use other than those covered in this booklet.
- We suggest you keep the original box and packaging, as our free-of-charge service does not cover any damage resulting from inadequate packaging of the product when this is sent back to an Authorised Service Centre.
- The use of attachments that are not recommended or not supplied by the appliance manufacturer might cause the risk of fire, electric shock or injury.

Danger to children

- This appliance cannot be used by people with reduced physical, sensorial or mental capabilities, with no experience and knowledge unless supervised or trained beforehand about safe use of the appliance by a person responsible for their safety.
- Make sure children do not play with the appliance.
- Keep the appliance out of reach of children when it is powered or in cooling-down phase.
- Do not leave the packaging parts near children since they are potentially dangerous.
- Prevent children from dropping the appliance by holding the power cord.
- In the event that this appliance is to be disposed of, it is advisable to cut the power chord off to make it out of use. Those parts of the appliance that could be dangerous should be rendered armless, especially for children who might use the appliance as a toy.

Warning of burns

- Do not touch the metal parts of the appliance, hot water or steam when it is in operation and for several minutes after it is turned off to prevent the risk of burns.
- Do not direct the jet of steam towards parts of the body, pets, plants or delicate objects.
- Do not leave the appliance on the ground when in operation or immediately after it is turned off. Always use the attachment for carpet cleaning for leaning the appliance.
- Never direct the jet of steam towards appliances containing electrical parts (e.g. inside ovens).
- Before removing the cloth from the steam head, disconnect the power cord from the mains socket. Wait at least 5 minutes to allow both the steam head and the cloth to cool down.



-  **IMPORTANT: burn hazard!**

Danger due to electricity

- Before plugging the appliance into the mains socket, ensure that the voltage shown on the rating plate matches the local voltage supply.
- The use of extension leads not authorised by the appliance manufacturer may cause damage and accidents.
- Always connect the appliance to an earthed socket.
- Never immerse the appliance in water or other liquids.
- Do not use the appliance if your hands are wet or if you are barefoot.
- Do not use the appliance if the power cord or the plug are damaged, or if the appliance is faulty. To prevent any accident, all repairs, including the replacement

of the power cord, must be carried out by an Authorised Service Centre or by qualified personnel.

- Do not connect any other high-power appliance (stoves, irons, radiators, etc.) to the same socket. Burn hazard.
- Do not put the hot parts of the appliance on the power cord.
- Do not disconnect the appliance by pulling the power cord.
- Do not leave the power cord against sharp edges or parts.
- Make sure the power cord does not come in contact with hot surfaces.
Do not move the appliance by pulling the power cord.
- In case of thunderstorm, disconnect the power cord from the mains socket.
- Unplug the appliance after use and before carrying out cleaning and maintenance operations.



Warning – material damage

- Do not use the appliance for cleaning raw wooden/non-impermeable floors, soft plastic, wooden objects, and leather.
- Do not use the appliance on glass surfaces.
- Do not use the appliance with the worn cloth. Risk of damage and scratches on the floor.
- Always unwind the power cord before use.
- To avoid damage to the pump, do not use the appliance with no water. Regularly check the water level in the tank.
- Do not use sparkling (carbonated) water. Do not use sparkling (carbonated) water. In case of particularly hard water (hardness above 20°f), use a mix composed by 50% tap water and 50% purified water.
- The appliance must only be cleaned with a soft, slightly dampened, cloth after having unplugged the appliance and allowed all its parts to cool down. Never use solvents that may damage the plastic parts.
- Do not pour descalers or other scented substances into the tank; otherwise, the warranty would be no longer valid.
- Always unplug the appliance before storing it. Wait for it to cool down and completely empty the tank.
- Do not expose the appliance to atmospheric agents (rain, sun, etc.).
- Any changes to this product not expressly authorized by the manufacturer may make void safety and warranty of the operator's use.
- The appliance is not to be used if it has been dropped, if there are visible sign of damage or if it is leaking.



Danger of damage originating from other causes

- Do not use the appliance in the presence of vapours given off by oil-based paints, solvents or waterproofing agents, by flammable power or other toxic or explosive vapours.
- Be very careful when using the appliance with a ladder.
- Fill up the tank with water before starting up the appliance. Before carrying out the filling operations with water, unplug the appliance.
- Turn on the appliance only when it is in working position.
- Never leave the appliance unattended when it is connected to the power supply.
- Before leaving the appliance unattended for few minutes, always place it on the attachment for carpet cleaning. Turn the appliance off and always disconnect the power cord from the main socket.
- Store the appliance indoor, in a cool and dry place.
- **ALWAYS KEEP THESE INSTRUCTIONS.**

DESCRIPTION OF THE APPLIANCE (FIG. 1)

- A - Grip
- B - Cord winder hook
- C - Handle
- D - On/Off button
- E - Water tank filling compartment
- F - Water tank
- G - Motor unit
- H - Steam dispensing lever
- I - Steam head
- L - Lighting
- M - Steam discharge hole
- N - Floor washable cloth
- O - Measuring cup
- P - Attachment for carpet cleaning

APPLIANCE ASSEMBLY

After unpacking the appliance, proceed as follows:

Insert the grip (A) in the motor unit (G), by pressing it slightly downwards until it locks in place (Fig. 2).



Warning!

Before use, make sure the appliance is assembled properly.

INSTRUCTIONS FOR USE

Totally unwind the power cord by releasing it from apposite cord winder hooks (B). Open the filling compartment (E), Fig. 3, and fill the tank (F) up to the MAX mark using the supplied measuring cup (O) - Fig. 4. Close the filling compartment (E) back without forcing.



Warning!

NEVER fill the tank beyond the MAX level. In case of particularly hard water (hardness above 20°f), use a mix composed by 50% tap water and 50% purified water



Warning!

Make sure the tank is filled enough to avoid dry running.

To protect the floor from high temperatures, it is advisable to allow the appliance to warm up/cool down on the carpet cleaning attachment.

Before use, make sure objects and surfaces to be treated are resistant or compatible with the high temperature of steam. In case of treated terracotta floors and wooden surfaces, refer to the manufacturer's instructions and test the appliance first on a concealed area of the floor or a sample.

If the appliance is left standing on the floor whilst in use, a whitish ring may form. Not to worry, as this can be removed with a normal decalcification agent or with some drops of vinegar.

Place the cloth (N) under the steam head (I) with the protrusion of fabric backwards. Put the steam head (I) on the cloth (N) so that the latter adheres to the apposite Velcro situated at the bottom of the steam head (I) (Fig. 5). Insert the plug into the socket, which must be earthed. The light integrated in the on/off button will turn on for 1 second (D).

Press the on/off button (D); the integrated indicator light will turn on, signalling the appliance is on and the internal boiler is starting to heat up. Furthermore, also the lights (L) situated at the front of the steam head (I) will go on.

After about 15 seconds, the device is ready for use.

Make sure there is no more dust on the floor.

Using the grip (A) and holding the steam head (I) with a foot, lower the handle (C) (Fig. 6); the appliance will start emitting steam. Clean the floor with a backward and forward movement.

After use, bring the handle (C) back to upright position to stop steam dispensing; press the on/off button (D) and disconnect the plug from the electric socket.



Warning!

Do not use the steam function without the cloth. The cloth can be purchased at Authorised Service Centres.

Use the appliance in well-lit rooms.



Warning!

Burn hazard! Do not turn the steam head upside-down during use to remove the cloth.

Unplug the appliance. Wait at least 5 minutes to allow both the steam head and the cloth to cool down.

To clean the stubborn dirt on the floor, it is possible to use also the front steam in addition. After having turned the appliance on and having waited the heating time of the boiler, press the rear lever (H) for dispensing steam with the foot (Fig. 7); steam will be dispensed from the apposite front hole (M) situated on the steam head (I).

After few seconds, release the lever (H), lower the handle (C) and clean the floor with a backward and forward movement.

Filling the tank during use

When the water tank is empty, the appliance will stop producing steam. No particular operation is required when there is not more water in the tank. After having disconnected the appliance, just open the compartment (E) and fill the tank (F) again with natural, fresh water. In case of particularly hard water (hardness above 20°f), use a mix composed by 50% tap water and 50% purified water.

Use of the attachment for carpet cleaning

This attachment must be used only to clean carpets and similar soft surfaces. Do not use the on hard surfaces.

Lay the carpet attachment (P) on the floor on the flat side. Make sure the cloth (N) is positioned underneath the steam head (I). Position the appliance on the attachment (P) by slightly pressing (Fig. 8). The appliance is ready for use.

After use

Disconnect the power cord from the mains socket. Empty the water tank completely by overturning the appliance to prevent the water from stagnating, which may form lime deposit.



Warning!

Wait at least 5 minutes to allow both the steam head and the cloth to cool down.

Remove the cloth to rinse it by positioning a foot on the relevant protrusion and lifting the appliance (Fig. 9).

Wrap the power cord on the hooks (B) - Fig. 10. Position the appliance on the attachment for carpet cleaning (P). Position the motor body vertically.



Warning!

To put the appliance stably in vertical position, engage the joint between the steam head and the motor unit.

Keep the appliance in a dry place out of reach of children.

CLEANING AND MAINTENANCE



Warning!

Before cleaning, always disconnect the plug from the socket. Leave the appliance to cool down for a few minutes.



Warning!

Never immerse the appliance in water or other liquids.



Warning!

Check the state of the power cable of your appliance on a regular basis before using it, and if it is damaged, take it to the service centre closest to you to have it replaced only by specialised personnel.

Do not use abrasives for cleaning the appliance.

Do not put vinegar, decalcifying products or other scented substances in the tank. Otherwise, the warranty would be no longer valid.

Appliance cleaning

Clean plastic parts with a damp, non-abrasive cloth and dry them with a dry cloth.

Clean the water tank from time to time by putting fresh water in it. Rinse and empty.

For cleaning washable cloths, refer to instructions on the labels.

Cleaning the limestone

Damage caused by limestone is not covered by warranty.

A good maintenance and regular cleaning preserve and keep the appliance effective for a longer period by significantly limiting the risks of formation of limestone deposits. If, despite this, after some time the appliance function should be compromised by the frequent use of hard/very calcareous water, proceed with descaling to eliminate malfunctioning.

Carry out cleaning once every three months. If water used is very hard and calcareous, carry out cleaning monthly.



Warning!

Do not leave the appliance unattended while operating.

Carry out cleaning of limestone in a ventilated area. During limestone cleaning, dispense steam on a resistant surface or a washable cloth. Do not breathe vapours produced during limestone cleaning.

- 1 Fill the tank with a mix of 1/3 of white vinegar and 2/3 of fresh, clean water.
- 2 Place the appliance so that the steam is not dispensed on any object or surface.
- 3 Plug in appliance. Lower the handle (C) and leave the appliance in operation for at least one minute. Lift the handle (C) and leave the appliance off for at least one minute. Repeat the procedure until steam is dispensed. Dispense steam completely until there is no more solution in the tank. Repeat the procedure, if necessary.
- 4 Disconnect plug from socket. Fill the tank with fresh, clean water. Rinse and empty.
- 5 Fill the tank with fresh, natural water.
- 6 Plug in appliance. Lower the handle (C) and dispense steam completely until there is no more water in the tank. Repeat the procedure, if necessary until there are no more limestone residues in the steam pipes.

To remove the limestone traces from the attachments, immerse them in a solution of water and vinegar. Fit the attachment onto the appliance and dispense steam.

TROUBLESHOOTING



Warning!

In case of malfunctioning and electrical faults, switch the appliance off immediately. Disconnect plug from socket. Wait for the appliance to cool down.

PROBLEMS	CAUSES	SOLUTIONS
On light turned off	Plug not inserted	Check insertion of the plug. Check there is current on the power line. Try to connect the plug to another socket. If the problem persists, contact an Authorized Service Centre.
Steam is not dispensed from nozzles	On/off button not pressed	Press the button and activate the pump.
	The device is not ready for use.	Switch the appliance on, wait 15 seconds and activate the pump.
	No water in the tank.	Fill the tank up to the level marked MAX.
	The steam dispensing holes may be clogged with limestone	Contact an Authorized Service Centre.
Sudden increase of the pump noise level	No water in the tank.	Switch the appliance off and fill water in the tank.
Water leakages from nozzles	Possible condensation residues in the steam pipes	Switch the appliance on and dispense steam completely. Place a soft cloth to avoid wetting the floor. If water continues to come out, switch the appliance off. Wait at least 5 minutes to allow both the steam head and the cloth to cool down. Try again.

关于本手册

该电器根据有效的欧洲监管规范生产，且所有可能存在危险的部件都受到保护。请仔细阅读下列警告，并仅根据该电器原使用目的进行使用，防止发生事故，造成伤害。同时，请妥善保管本手册，随身携带，方便随时进行咨询。若将此电器转交给他人，请同时转交此说明书。

本手册中的信息标记如下所示：



儿童危险



烫伤警告



触电危险



警告——物料损毁



其它原因造成的伤害危险

预期用途

电器适用于清洁、消毒地板，例如不透水的大理石、陶瓷、石头、瓷砖、镶木地板以及硬木地板。请使用抹布吸走过多的水分。本电器利用蒸汽功效清洁，无需洗涤剂与肥皂。因电器使用不当造成的任何损坏，生产商不承担任何责任。不当使用还可能导致质保失效。

残留风险



警告！

由于高温和蒸汽将会除去表面的蜡，因此切勿在含蜡表面上使用本电器。请勿在未经热处理或透水的木地板上使用本电器。木材易膨胀，因此切勿在任何类型的木质表面上长时间使用本电器。

初次使用时，请在室内地板的隐蔽处测试产品。或者，咨询地板制造商清洁步骤的相关信息。

安全警告

使用前请仔细阅读这些说明。

- 该电器仅供家用，以及类似用途。
- 对于不当使用或者用于本手册涵盖用途以外的任何其他用途而造成的问题，我们不承担任何责任。
- 由于我们的免费服务不包括退回授权服务中心过程中，因包装不当造成的任何损害，因此建议保存好原纸箱和包装。
- 切勿使用非电器生产商建议或提供的配件，否则可能导致起火、触电或人身伤害风险。

儿童危险

- 体能、感官或智力较弱者（包括儿童）或缺乏经验和知识者不适合使用本电器，除非在负责其安全的监护人的监督或指示下使用。
- 切勿允许儿童将该电器当作玩具玩耍。
- 当电器通电或冷却阶段，将电器放置在儿童接触不到的地方。
- 包装可能具有危险性，切勿置于儿童可触及处。
- 严禁儿童拉扯电源线，以致电器坠落。
- 如要处理该电器，建议先切断电源线，使其不再能使用。电器的零部件可能具有危险性，应该进行无害化处理，特别是儿童可能将电器作为玩具。

烫伤警告

- 切勿触摸电器的金属部件，电器运行时或刚刚关闭后数分钟时，小心热水或蒸汽可能会导致灼伤。



- 切勿将蒸汽喷头对准人、宠物、植物或者贵重物品。
- 在电器运行时或刚关闭后，请不要立即离开。倾斜电器时一定要使用地毯清洁附件。
- 切勿将蒸汽喷头对准含电器零件的装置（例如，烤箱内部）。
- 在取下蒸汽喷头布之前，请拔下电源线。至少静置5分钟，待蒸汽和专用抹布冷却。
-  重要提示：烫伤危险！

触电危险

- 在将电器插头插入电源插座前，确保电器铭牌上的电压与供电电压一致。
- 使用未经电器制造商授权的延长线可能会引起伤害和事故。
- 始终将电器连接到接地插座上。
- 切勿将电器浸入水中或其它液体中。
- 请勿在湿手或赤脚状况下使用本电器。
- 若电源线或插头受损，或电器故障，切勿使用该电器。任何维修工作，包括更换电源线，请联系阿里亚特授权服务中心或者专业人员，以防出现危险。
- 切勿与其他高功率电器（电热器、电熨斗、暖气管等）共用插座。超负荷用电危险。
- 切勿将电器高温部分与电源线接触。
- 切勿通过拉扯电源线关闭电器。
- 请勿将电源线靠在尖锐边缘或锋利的部件上。

- 确保电源线不会与高温表面接触。
- 切勿通过拉扯电源线移动电器。
- 若发生雷暴天气，请从插座上拔下电源线。
- 使用电器后及进行清洁和维护之前一定要拔下电器插头。



警告-物料损毁

- 切勿使用本电器清洁原木/不透水地板，软塑料，木制品和皮革。
- 切勿在玻璃表面使用本电器。
- 切勿在布料磨损的情况下使用本电器，否则会对地板造成损坏或产生刮痕。
- 使用前请务必解开电源线。
- 当水槽内水量不足时，请勿使用本电器，以免对水泵造成损害。请经常检查水槽水量。
- 切勿使用苏打（含二氧化碳的）水。若当地水质硬度较高（硬度大于20° f），建议使用纯净水。
- 请关闭电器电源，拔出电源插头，待电器冷却后再使用湿软抹布清洁电器。切勿使用可能损坏塑料部件的溶剂。
- 切勿向水槽中加入除垢剂、醋或其他芳香成分，以防损坏电器设备，致使用户质保失效。
- 存放电器前务必拔下电源线。等待电器冷却后，完全清空水槽。
- 切勿将电器暴露在自然环境中（雨、太阳等）。
- 未经制造商明确授权，对本产品的任何更改都可能导致安全电器无法使用，并且也会使用户质保失效。
- 如果电器跌落，有明显的损坏迹象或正漏水，请勿再使用。



其它原因造成的伤害危险

- 切勿在油基油漆、溶剂或防水剂蒸发，易燃电源或其他有毒或爆炸性烟雾存在的情况下也使用本电器。
- 在楼梯上使用时，请注意安全。
- 使用前请向水槽注水。注水前请确保电器未接通电源。
- 本电器仅限在适宜的工作位置上使用。
- 电器连接电源时，切勿离开。
- 需要离开电器几分钟之前，一定要将它放置在地毯清洁附件上。关闭电器，始终从主插座上断开电源线。
- 请将本电器存放于干燥、阴凉的室内环境中。
- 请妥善保管本说明书。

电器描述 (图1)

- A - 手柄
- B - 电源线收理架
- C - 把手
- D - 开/关按钮
- E - 加水口
- F - 水槽
- G - 电机组件
- H - 蒸汽分配杆
- I - 蒸汽喷头
- L - 灯
- M - 蒸汽排放孔
- N - 可清洗清洁布
- O - 量杯
- P - 地毯清洁附件

组装电器

从包装箱中取出电器，然后请按以下步骤操作：
将手柄（A）插入电机组件（G），轻轻的向下按压直到锁住（图2）

 **警告!**
使用之前，确保电器组装正确。

使用说明

从电源线收理架上（B）上解开电源线，打开加水口（E），图3，用提供的量杯（O）向水槽内（F）加水加到最大水位-图4，轻轻的关闭加水口。

 **警告!**
向水槽内加水不要超过最大水位。如果水质特硬（硬度超过20° f），请使用纯净水。

 **警告!**
确保水箱的水充足，以免干烧。

为了保护地板不受高温的影响，建议电器在地毯清洁附件上加热/冷却。
使用之前，确保要处理的物体和表面耐高温或与高温蒸汽相融。如果是经过处理的赤陶地板和木质表面，请参考制造商的说明，首先在地板隐蔽区或样品上测试机器。
如果使用中将电器放置在地板上，可能会形成一个白环，不用担心，可以用普通的脱钙剂或几滴醋即可清除。

将清洁布（N）放置在蒸汽喷头（I）上，将拖布的突出部分向后。用蒸汽喷头（I）压住清洁布（N），使清洁布吸附在蒸汽喷头底部尼龙塔扣合适的位置上。（图5）
一定将插头插入接地插座，开关按钮上的灯将开启1秒钟（D）。
按压开关按钮（D），开关指示灯打开，表示电器开启，内部锅炉开始加热。而且，位于蒸汽喷头前面的灯（L）也会亮起，大约15秒钟后，设备就可以使用了。
确保地板上不再有灰尘。
握住手柄（A），用脚踩住蒸汽喷头（I），调整把手（C）（图6）角度；电器开始喷出

蒸汽，前后移动电器来清洁地板。

使用后，将把手（C）调整回垂直的位置可停止蒸汽分发。按压开关按钮（D），从电源插座上拔掉插头，结束使用。

警告！

没有清洁布不可使用蒸汽功能。可以从授权服务中心购买清洁布，在光线充足的房间使用本电器。

警告！

烫伤风险！使用中请勿将蒸汽喷头倒置来移除清洁布。

拔掉电器插头，至少等待 5 分钟让蒸汽喷头和清洁布冷却下来。

清除地板上的顽固污渍，还可以使用蒸汽喷头前端的蒸汽。开启电器后需要等待锅炉的加热时间，用脚按压后面的杆（H）喷出蒸汽（图7），蒸汽会从蒸汽喷头前面的孔里喷出。几秒钟后，松开蒸汽分发杆（H），降低把手（C），前后移动拖把来清洁地面。

使用中向水箱加水的方法

当水槽是空的，电器会停止产生蒸汽。当水槽没水时不需要特殊操作，拔掉电器插头，打开加水口（E），向水槽内（F）加入纯净水。

使用地毯清洁附件的方法

此附件只能用于清洁地毯或类似的柔软表面，切勿在坚硬的表面使用。

将地毯附件（P）放置在平坦的地板上，确保清洁布（N）粘贴在蒸汽喷头下面，将附件（P）安装在蒸汽喷头上，轻轻按压即可，电器可以使用了。

使用后

从主插座上拔下电源线，将电器翻过来，将水箱的水全部排空，防止水淤塞，形成石灰沉淀。

警告！



至少等待5分钟让蒸汽喷头及清洁布都冷却下来。

用脚压住清洁布突起的部分，提起机器，移除清洁布，冲洗干净（图9）。

把电源线缠绕在收理架上（B）图10。将设备放置在地毯清洁附件（P）上，将电器垂直放置

警告！



要使设备稳定的垂直放置，必须使蒸汽喷头和电机组件连接牢固。

请将电器放置在一个干燥儿童接触不到的地方。

清洁与维护

警告！



在清洁电器之前，一定要从插座上拔下插头，让电器冷却几分钟。

警告！



请勿将电器放入水中或其它液体中。

警告！



使用本电器之前，应定期检查电源线状况，如果电源线受损，把它带到离你最近的服务中心，由专业的人员来更换。

切勿使用具有磨砂作用产品清洗本电器。

切勿向水槽中加入除垢剂、醋或其他芳香成分，以防损坏电器设备，致使用户质保失效。

电器清洁

使用不具磨砂性质的湿布清洁塑料部分，并用干布擦干。

时不时的用淡水清洗水箱并排空。

关于清洗清洁布，请按照标签上面的说明来操作。

清理石灰沉淀

如因石灰堵塞产生的损坏，我们将不提供保修服务。

良好的维护和定期清洁能够长期保持和维持电器高效工作，大大降低了结垢风险。尽管如此，由于持续使用硬度较高的水，电器功能仍会遭到损害，此时可以执行除垢操作以消除故障。

每三个月定期清理一次。如果用水硬度较高，请每个月清理一次。



警告！

电器运行时，切勿离开。

请在通风房间内进行除垢操作。清洁石灰水垢时，使用蒸汽处理耐热表面或可洗衣物。请勿吸入除垢过程中产生的蒸汽。

- 1 将1/3的白醋与2/3干净的水混合液倒入水箱中。
- 2 放置好电器，确保蒸汽喷头不会喷向任何物体或表面。
- 3 将电源插入插座。降低把手（C）让电器先运行至少一分钟。提起把手（C）关闭电器至少一分钟。重复以上操作，直到有蒸汽喷出。让所有蒸汽排出，直至水槽内的溶液耗光。如果有需要的话，重复以上操作。
- 4 拔下电源插头，注入新鲜清水，冲洗并清空水槽。
- 5 向水箱内加入纯净水。
- 6 插入电器插头，降低把手（C）并喷出蒸汽直到水箱内的水全部耗光。重复以上步骤，如有必要直到蒸汽管内不再有石灰石残留物。

清除附件的石灰痕迹，将附件浸泡在水和醋的溶液里，将附件安装在电器上，并喷出蒸汽。

故障排除



警告!

在操作故障和电气故障情况下，请立即关闭电器。拔出电源插头，待电器冷却。

问题	原因	解决办法
指示灯不亮	未接通电源	检查电器是否正确连接电源。检查电源线是否有电。尝试将电源线插入另一个接地插座。如果问题仍未解决，请联系授权服务中心。
喷嘴无法排除蒸汽	没有按压蒸汽按钮	按下按钮，激活水泵。
	电器未进入准备状态	打开电器，等待15秒并激活水泵
	水槽内水不充足	将水箱加到最大刻度
	蒸汽出气口可能被水垢堵住	联系授权的服务中心
水泵的噪音突然增大	水槽内水不充足.	关掉电器，向水槽内注水
喷嘴漏水	可能是蒸汽管内有冷凝残留	打开电器，完全释放蒸汽，放置一块软布以避免弄湿地面，如果水继续流出，关闭电器。等待5分钟，让蒸汽喷头和软布都冷却下来，再试一次。



Ariete

De' Longhi Appliances Srl
Divisione Commerciale Ariete
Via San Quirico, 300
50013 Campi Bisenzio FI - Italy
E-Mail: info@ariete.net
Internet: www.ariete.net