

KENWOOD

Type PEM13

instructions for use

English

3 - 14

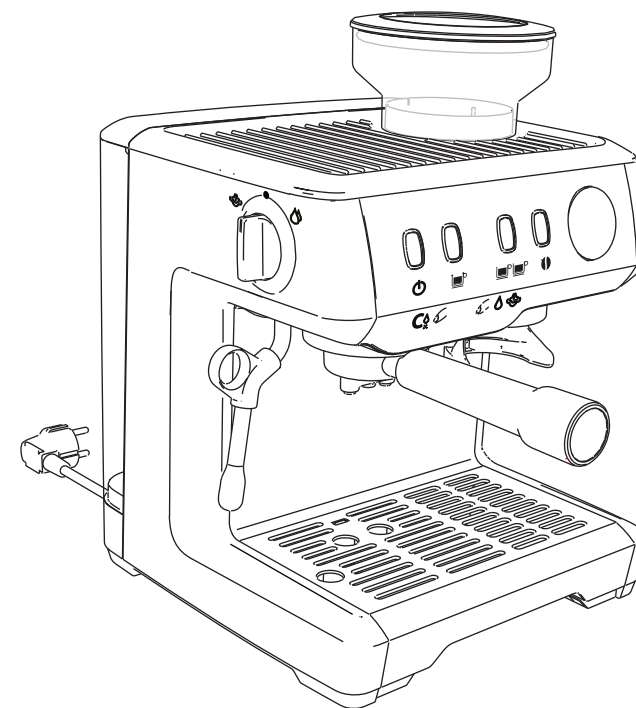

4075104500 - REV.0 11/12/2020



Kenwood Ltd

New Lane
Havant
Hampshire
PO9 2NH

kenwoodworld.com

© Kenwood Ltd 2018

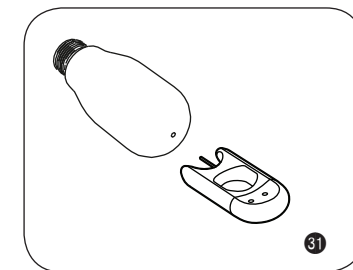
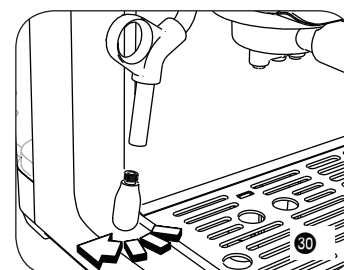
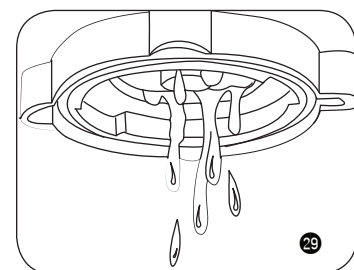
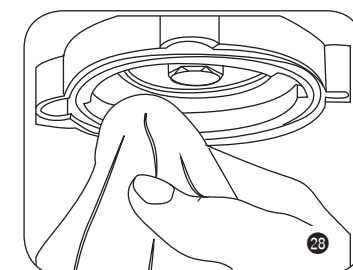
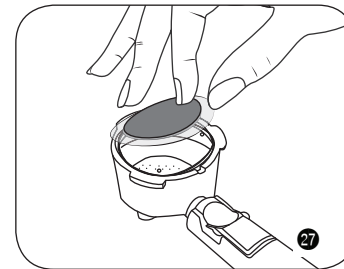
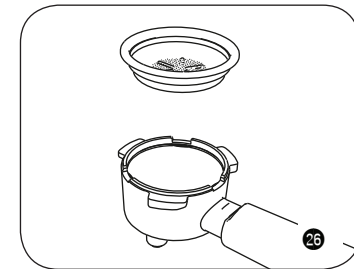
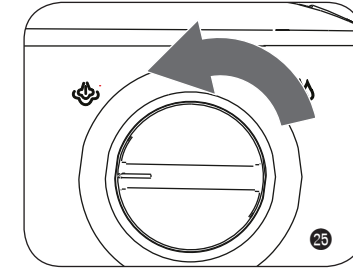
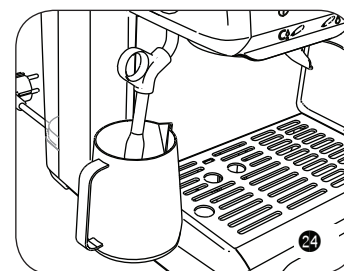
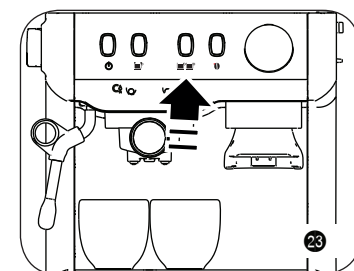
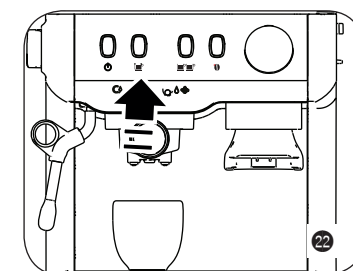
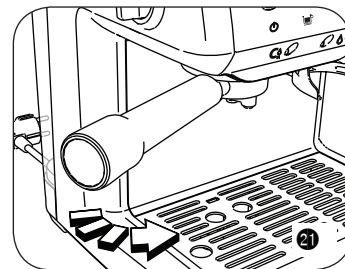
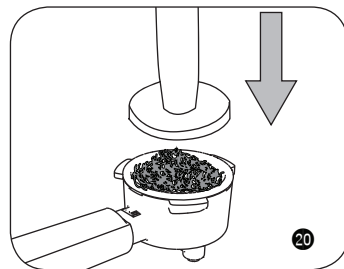
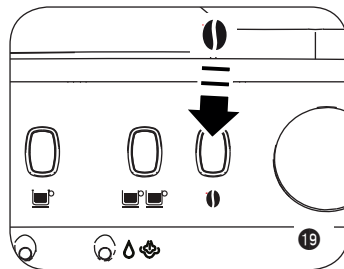
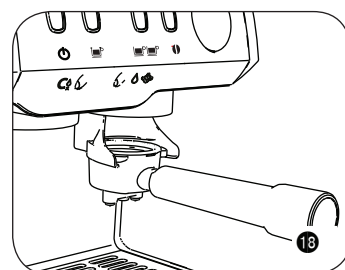
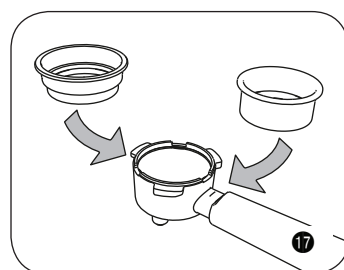
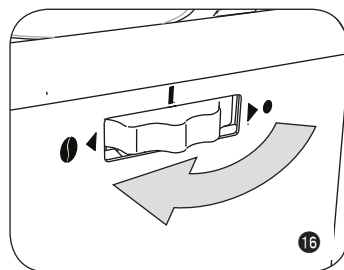
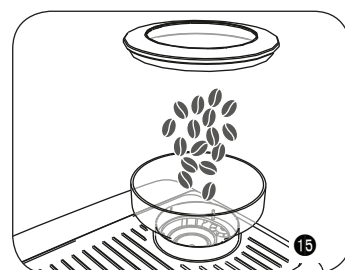
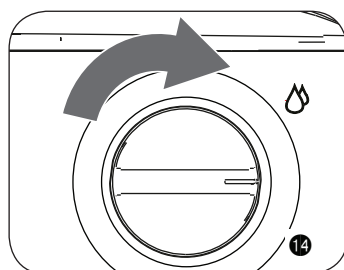
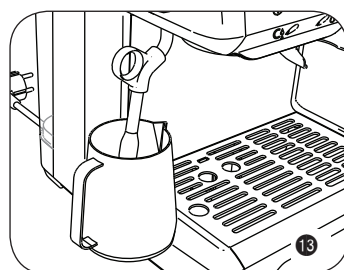
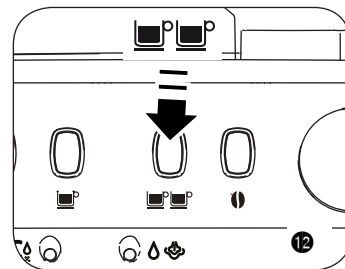
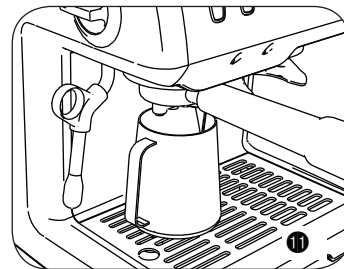
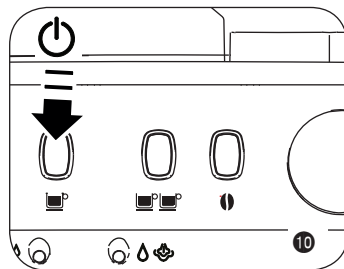
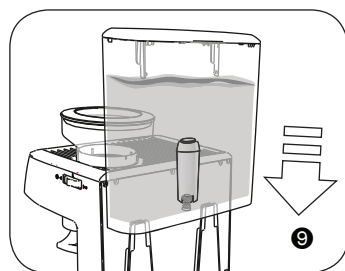
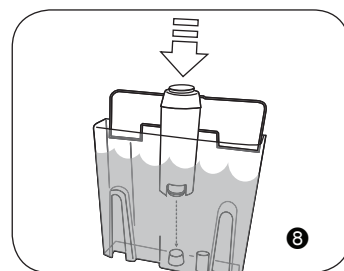
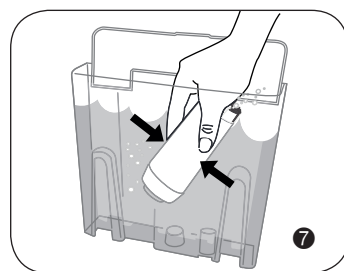
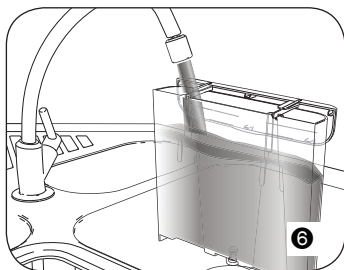
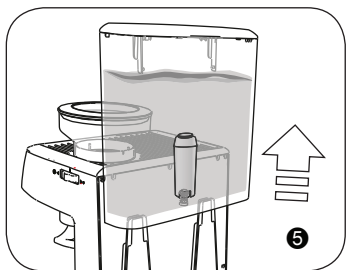
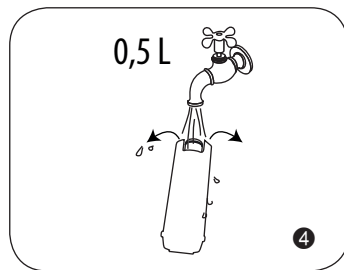
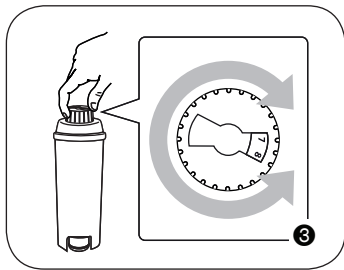
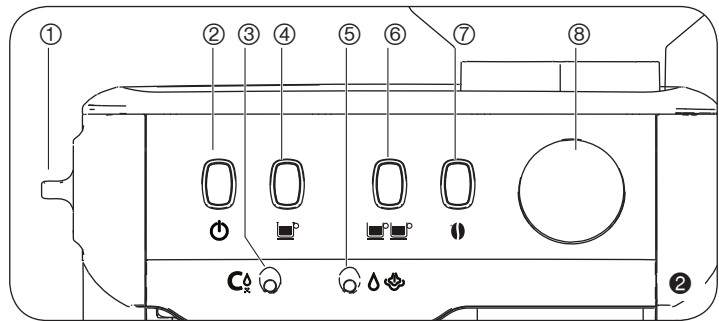
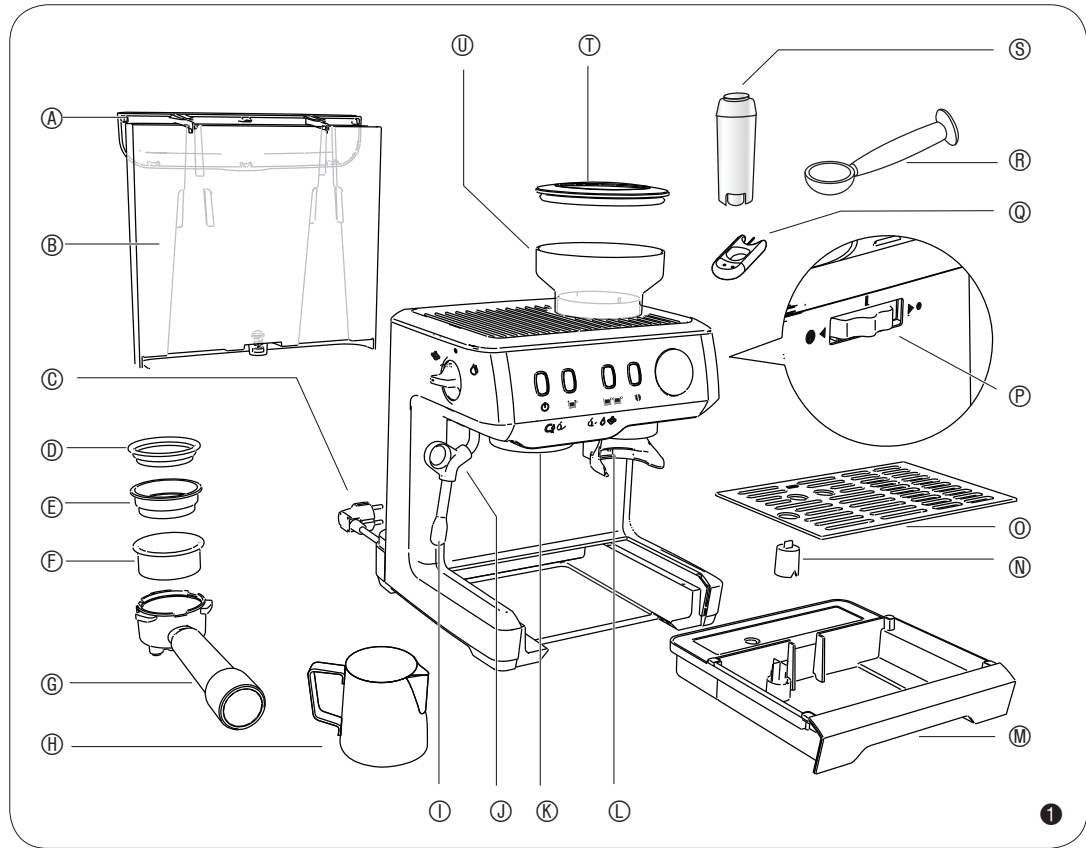

English

Please refer to the first page, where you will find illustrations

With regard to this manual

This appliance is made in conformity with appropriate European Regulations in force, to protect the user wherever possible from potential hazards. Even if you are familiar with this type of appliance, carefully read this manual before use. Only use this appliance for the purpose it is designed for in order to prevent accidents and damage. Keep this manual close by for future consultation. Should you decide to give this appliance to other people, please remember to also include these instructions.

Intended use

The appliance can be used to prepare coffees or cappuccinos. It is also possible to make teas or infusions through the hot water distribution function.

This appliance must not be used for commercial or industrial purposes.

Any other use of the appliance is not intended by the Manufacturer who does not accept any responsibility for damages of any kind caused by improper use of the appliance itself. Improper use also results in any form of warranty being forfeited.

Residual risks

The constructive characteristics of the appliance, covered by this publication, do not allow to protect the user from direct jet of steam or hot water.

- **Burn Hazards. When hot water and steam are dispensed, do not direct the jets towards others or towards yourself. Hold only the plastic part of the tube.**
- **Use only containers made of material “for foods”.**

Safety warnings

Read these instructions carefully.

- The appliance is designed for home use or similar, such as:
 - in cooking areas used by personnel of shops, offices and other professional environments
 - on farms
 - hotels, motels, bed and breakfasts and other types of residential structures (for use by its guests).
- We decline any responsibility resulting from misuse or any use other than those covered in this booklet.
- We suggest you keep the original box and packaging, as our free-of-charge service does not cover any damage resulting from inadequate packaging of the product when this is sent back to an Authorised Service Centre.
- This appliance can be used by children aged from 8 years and above and persons with reduced physical, sensory or mental capabilities or lack of experience and knowledge if they have been given supervision or instruction concerning use of the appliance in a safe way and understand the hazards involved.
- Children shall not play with the appliance or its components.
- Cleaning and user maintenance shall not be made by children without supervision.
- Do not leave the packaging near children because it is potentially dangerous.
- In the event that this appliance is to be disposed of, it is suggested that the power cord is cut off. It is also recommended that all potentially dangerous components including the power cord are rendered harmless

to prevent personal injury. Do not let children play with the appliance or its components.

- Keep the needle for the steam nozzle cleaning out of the reach of children and store it in a safe place: danger of swallowing and injury.
- Do not leave the power cord within the reach of children under the age of 8 years.
- Before connecting the appliance to the mains check that the voltage shown on the rating plate located underneath the machine corresponds to the voltage of the local mains.
- The use of extensions not approved by the manufacturer can result in damage to property and personal injury.
- Before filling the tank with water, unplug the appliance from the power outlet.
- If the power cord is damaged, it must be replaced by the manufacturer or by its Technical Assistance Service or by a similarly qualified person in order to avoid any hazard.
- Never put live parts into contact with water: It can cause a short circuit!
- Remove the plug from the power outlet before cleaning or maintenance.
- Do not immerse the appliance in water or other liquids.
- Always turn off the power and unplug the power cord plug from the power outlet before filling the tank with water.
- Do not lift the appliance by grasping its water tank or its tray, but only by grasping its body.
- Choose an adequately illuminated and clean room with easily accessible power outlet.
- Avoid pouring an excessive amount of water into the tank.
- Never leave the appliance unattended when it is connected to the power supply.
- The appliance must be used and left at rest on a stable surface.
- The appliance must not be used if it has been dropped, if there are visible signs of damage or leaks of water. Do not use the appliance if the power cord or the plug are damaged, or if the appliance is faulty. To prevent any accident, all repairs, including the replacement of the power cord, must be carried out by an Authorised Service Centre or by suitably qualified personnel.
- Never direct steam or hot water towards parts of the body; handle the steam pipe with care: Burns hazard!
- The external metallic parts of the appliance and the filter holder must not be touched with the equipment in operation, as it could cause burns.
- If water does not come out of the filter holder, it may be because the filter is clogged. In this case, remove and disconnect the filter slowly because

any remaining pressure can cause spillage or splashing. Then clean as explained in the relevant paragraph.

- Place the machine on a steady surface where it can not be overturned.
- Do not use the machine without water because in this case the pump will burn.
- Never fill the water tank with hot or boiling water.
- Do not place the machine on very hot surfaces or near open flames to prevent the body from being damaged.
- The cable must not touch the hot parts of the machine.
- Do not use sparkling (carbonated) water.
- Never put substances other than coffee powder in the filter. This could cause serious damage.
- Never adjust the grinding level while the coffee grinder is on; do not insert coffee powder into the coffee grinder, but only coffee beans.
- Do not let the appliance exposed to temperatures lower than 0°C, as water deposits into the boiler might get frozen and cause damage to the appliance.
- Do not use the appliance outdoors.
- Do not leave the appliance exposed to weathering (rain, sun, etc...).
- After disconnecting the power plug and after the hot parts have cooled, the appliance must be cleaned only with a non-abrasive cloth slightly moistened by adding a few drops of mild, non-aggressive detergent (never use solvents that damage plastic).
- **Save these instructions for future reference.**

Description of the appliance

- Ⓐ Tank lid
- Ⓑ Water tank
- Ⓒ Power cord
- Ⓓ Pod filter
- Ⓔ 1 cup filter
- Ⓕ 2 cup filter
- Ⓖ Filter holder
- Ⓗ Milk container
- Ⓘ Steam nozzle
- Ⓝ Steam/hot water pipe
- Ⓚ Filter holder seat
- Ⓛ Coffee grinder
- Ⓜ Drip tray
- Ⓝ Float
- Ⓞ Cup-resting grill
- Ⓟ Bezel for adjusting the grinding level
- Ⓠ Needle for the steam nozzle cleaning
- Ⓡ Coffee presser
- Ⓢ Water softener filter Delonghi
- Ⓣ Lid of the coffee beans container
- Ⓤ Coffee beans container

- ① Steam/hot water distribution knob
- ② On/Off button with operation indicator (⏻)
- ③ Descaling control indicator (C)
- ④ Coffee distribution button for 1 cup with indicator (☞)
- ⑤ Steam/hot water function indicator (☞)
- ⑥ Coffee distribution button for 2 cups with indicator (☞☞)
- ⑦ Coffee grinding button with operation indicator (⏻)
- ⑧ Manometer

Identification data

In the label located under the support base of the machine there is the following identification data of the machine:

- manufacturer and CE marking
- model (Mod.)
- serial number (SN)
- electrical supply voltage (V) and frequency (Hz)
- electrical power consumption (W)
- assistance toll-free phone number

When ordering at Authorized Service Centers, indicate the model and serial number.

Instructions for use

Starting the appliance

- 1 Remove the packaging materials and make sure all components are present.
- 2 Place the appliance on a flat and stable surface.
- 3 Wash the pod filter, the 1 cup filter, the 2 cups filter and the lid of the coffee beans container.

Installing the water softener filter

- 1 Remove the water softener filter from its box.
- 2 Turn the date disk so as to display the next two months of use ③.

Important

- The water softener filter has a lifetime of two months if the appliance is used normally. If the appliance is not used regularly and the water softener filter is installed, the latter

has a lifetime of three weeks at the most.

- Only use Kenwood "Water filter" filters, available at authorised Assistance Centres.
- 1 To activate the water softener filter, let tap water run into the hole on the filter until water comes out of lateral openings. Let at least 500 ml of water run through ④.
 - 2 Remove the water tank from the appliance ⑤.
 - 3 Fill the tank with cool tap water up to the MAX level.
 - 4 Insert the water softener filter in the water tank.
 - 5 Totally plunge the water softener filter into water for about ten seconds.
 - 6 Tilt the filter so as to remove air bubbles.
 - 7 Slightly squeeze the water softener filter while it is plunged into water so as to remove the remaining air it contains ⑦.
 - 8 Place the filter in its seat on the bottom of the tank ⑧.
 - 9 Properly press the filter.

First start-up

- 1 Check that the domestic mains voltage is the same as the voltage indicated on the label of the device.
- 2 After filling the water tank until the MAX level, install the tank in its seat ⑨. Properly install the tank in its seat for the proper operation of the appliance.
It is also possible to fill in the tank from above, by pouring water in the specific compartment after lifting the lid ⑥.
- 3 Insert the plug into a power outlet.
- 4 Install the filter holder in its seat without inserting any filter.
- 5 Press the ON/OFF button (⏻). The ON/OFF button light starts blinking. When the appliance reaches the right temperature for distributing coffee, button indicators (☞☞), (☞☞), (⏻) turn on and steady.
- If the hydraulic circuit of the boiler has run out of water, all indicators will simultaneously flash. To restore the appliance operation, read paragraph "Filling the water tank during use".
- 6 Turn off the appliance to refill the circuit.
- 7 Fill the tank with cool tap water.
- 8 Turn on the appliance again. Wait for the appliance to be ready, when all button indicators are on.
- 9 Turn the steam pipe inwards and direct it towards the drip tray.
- 10 Turn the steam/hot water distributing knob to the right, in the water position (☞) ⑭.

Important

- During the heating process, the appliance always distributes hot water through the filter holder seat (around 60 ml).
 - Make sure the steam/hot water distribution knob is in the central position (●), otherwise the boiler will not start heating up. If this is not the case, the operation indicator (⏻) will rapidly flash.
- 11 Place the provided milk container under the filter holder ⑪.
 - 12 Press the coffee distributing button for 2 cups (☞☞) ⑫.
Wait until water runs through the filter holder seat.
 - 13 Place the milk container under the steam/hot water pipe ⑬.
 - 14 Turn the steam/hot water distributing knob to the right, in the water position (☞).
 - 15 Wait until hot water runs through the steam pipe. Stop distributing hot water by turning the steam/hot water distributing knob to the central position (●).
Repeat the procedure until consuming all the water into the tank.
Now the appliance is ready to start distributing coffee.

Important

- Repeat the operation each time the appliance has not been used for a few days.
If the tank remains without water, you will notice a vibration and a louder noise. The button indicators (☐^P), (☐^P☐^P), (●) are flashing. To restore the appliance operation, read paragraph "Filling the water tank during use".

How to make coffee

- Check the tank water level (B).
- Check the tank is properly installed in its seat.
- Insert the desired filter into the filter holder (G): it is possible to choose the 1 cup filter (E) or the 2 cups filter (F).
- Insert coffee beans into the specific container (15).
Do not use an excessive amount of coffee beans. The lid of the coffee beans container must be properly installed on the container.

Important

- By using a smaller quantity of coffee beans at a time, coffee will always be fresh.

Adjusting the grinding level

The coffee grinding size might differ depending on the desired grinding level.

The grinding level affects coffee taste as well as the quality of the cream. Try changing this parameter to find the coffee taste you like the most.

A scale ranging from 1 to 11 is placed on the bezel for adjusting the grinding level. Higher numbers indicate a coarser grinding. Lower numbers indicate a finer grinding. Try making coffee after selecting a grinding level equal to 8. Then change the grinding level to find the coffee taste you like the most.

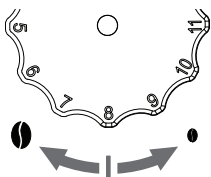

- Turn the bezel for adjusting the grinding level (P) on the left for a coarse grinding (☐^P), or turn it on the right for a fine grinding (☐^P☐^P) (16).

Important

- Ground coffee with the chosen grinding level is not immediately distributed due to residual coffee powder stuck into the duct. Distribute ground coffee for a few times before adjusting the grinding level again.
- Do not activate the grinder without having placed the lid on the bean container first. Keep fingers, hands, hair, clothing, jewellery and tools away from the bean container during use.**
- This operation must be carried out while the coffee grinder is on, so as to make it easier to turn the bezel for adjusting the grinding level.**

Adjust the quantity of ground coffee for 1 or 2 cups

You can adjust the quantity of coffee powder to be placed into the filter (operation time of the coffee grinder).

The quantity of ground coffee affects coffee taste as well as

the quality of the cream. Try changing this parameter to find the coffee taste you like the most.

Each time you press the grinding button (●), coffee powder will come out of the coffee grinder.

- Before starting the grinding process, install the filter holder (G) under the coffee grinder (18).
- Press the grinding button once to grind coffee for 1 cup.
- Press the grinding button twice in a row to grind coffee for 2 cups.
- To select the amount of coffee to be ground, press and hold the grinding button (●) for the needed time.
The length of time spent pressing the button corresponds to the new grinding time. To select the amount of ground coffee for 1 cup, press and hold the grinding button once. To select the amount of ground coffee for 2 cups, press the grinding button twice in a row and hold.

Important

- Press the button twice in a row with a time frame lower than 1.5 seconds.
To stop selecting the amount of ground coffee any time, press the grinding button (●).
- The grinding level adjustment defines the amount of distributed coffee. Each time after adjusting the grinding level, the amount of ground coffee for 1 or 2 cups must be also adjusted.
Boiler heating and the dispensing function are cut out while the coffee grinder is operating.

Adjust the quantity of distributed water for 1 or 2 cups

You can adjust the quantity of water to be distributed for 1 or 2 cups (distribution time for the hot water through the filter holder).

The quantity of water being distributed affects coffee taste as well as the quality of the cream. Try changing this parameter to find the coffee taste you like the most.

Important

- The quantity of water to be distributed for 1 or 2 cups must be adjusted while coffee is being distributed.
- To select the quantity of water to be distributed for 1 cup, press and hold the button (☐^P) for the needed time.
The length of time spent pressing the button will set the quantity of water to be distributed for 1 cup of coffee.
- To select the quantity of water to be distributed for 2 cups, press and hold the button (☐^P☐^P) for the needed time.
The length of time spent pressing the button will set the quantity of water to be distributed for 2 cups of coffee.

Manometer operation

This appliance is provided with a manometer (B) indicating if the parameters of water quantity, coffee quantity and grinding level are properly balanced so as to obtain an optimal coffee distribution.

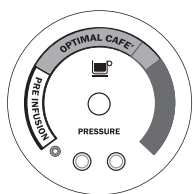

Pre infusion

The first stage of the coffee distribution process corresponds to a pre infusion of coffee powder. The appliance is working at low pressure. The manometer needle must stay in the PRE INFUSION area.

Optimal café

Water pressure gradually increases. During the whole distribution process, the needle must stay in the OPTIMAL CAFÉ area. Coffee will thus be made with the ideal pressure.

Too watery coffee

If, during coffee distribution, the manometer needle stays in the PRE INFUSION area, coffee is being distributed with a low pressure. This occurs when water runs too quickly through coffee powder. Coffee is watery, with little cream and a bland taste. This might be due to a too coarse grinding, to an insufficient quantity of coffee in the filter holder or to the fact that coffee powder has not been properly pressed.

Too strong coffee

If, during coffee distribution, the manometer needle exceeds the optimal distribution area and stays in the red area, coffee is being distributed with a too high pressure. This occurs when water fails to run through coffee powder. Coffee is strong, with little cream and a bitter taste. This might be due to a too fine grinding, to an excessive quantity of coffee in the filter holder or to the fact that coffee powder has been excessively pressed.

For a good espresso, taste shall have a perfect balance among sweetness, sourness and bitterness. Coffee taste is based on several factors, such as the kind of coffee beans, the toasting level, the freshness, the grinding level, the quantity of ground coffee and the pressing level of coffee powder into the filter. Give it a try by adjusting these factors so as to find the taste you like the most. In any case, please follow indications given about the manometer operation.

Extracting coffee

- 1 Choose the filter for 1 or 2 cups depending on the quantity of coffee you wish to prepare.
- 2 Insert the filter into the filter holder 17.
- 3 Place the filter holder under the coffee grinder 18.
- 4 Insert the filter holder flaps into the specific support under the coffee grinder.
If needed, adjust the grinding level.
- 5 Press the grinding button (I) once to grind coffee for 1 cup.
- 6 Press the grinding button (I) twice in a row to grind coffee for 2 cups.

Important

- Ground coffee into the filter holder will then need to be pressed by using the coffee presser 20.
- 7 Press the coffee distributing button for 1 cup (I^P).
Removing coffee residues from the filter holder seat and cleaning the boiler circuit will only require a few seconds of time.
 - 8 Press the button again to stop distributing water.
 - 9 Insert the filter holder into its seat 21.
 - **Tighten the filter holder while making sure you have hooked it properly onto the flange 21.**
 - **If too much ground coffee is put inside the filter, turning the filter holder may prove difficult and/or you may get leaks from the filter holder when the coffee is being dispensed.**
To make the first coffee at the proper hot temperature, fasten the filter holder to its seat keeping the filter installed (without introducing ground coffee).
Distribute 1 cup of coffee so that hot water can clean and heat up the filter. This will not be necessary for the following coffees.
When the appliance reaches the right temperature for distributing coffee, button indicators (I^P), (I^PI^P), (I) turn on and steady.
 - 10 Press the coffee distribution button (I^P) to distribute 1 cup of coffee, or press the coffee distribution button (I^PI^P) to distribute 2 cups of coffee.

Important

- Make sure the manometer needle is in the PRE INFUSION area when starting the distribution process and then moves to the OPTIMAL CAFÉ area while coffee is being distributed into the cup. Read paragraph "Manometer functioning".
To stop distributing coffee before the process is over, press the coffee distribution button again.
- **As for professional coffee makers, never remove the filter holder while extracting coffee.**
- **Wait about ten seconds after the coffee has been dispensed before removing the filter holder; to remove the filter holder slowly rotate it from right to left in order to avoid splashes or sprays of water or coffee.**

When the appliance is in stand-by mode, the button indicators (I^P), (I^PI^P), (I) are on and steady. When warming up, your appliance may release small puffs of steam from the filter holder; this is perfectly normal.

Removing the filter

- 1 Remove the filter from the filter holder by means of the handle of a teaspoon.
- 2 Lift the edge of the filter.
- 3 Remove the filter.

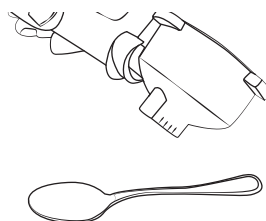

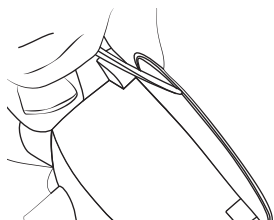
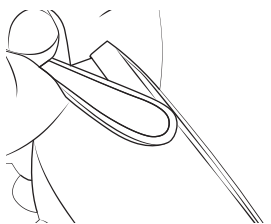

Auto-off function

This coffee machine is equipped with an automatic switch-off system in respect of the new regulations on energy consumption. The appliance turns off when not in use for 30 minutes.

To prepare a new coffee, turn on the appliance again by pressing the On/Off button (⏻). When the appliance reaches the right temperature for distributing coffee, button indicators (☐P), (☐P☐P), (●) turn on and steady.

Filling the water tank during use

Always check the tank water level. If the tank remains without water, you will notice a vibration and a louder noise. The button indicators (☐P), (☐P☐P), (●) are flashing.

- 1 Turn off and unplug the appliance.
- 2 Remove the filter holder.
- 3 Fill in the tank until reaching the indicated level, then turn on the appliance again.
When the appliance reaches the right temperature for distributing coffee, button indicators (☐P), (☐P☐P), (●) turn on and steady.
- 4 Place the milk container under the steam/hot water pipe 13.
- 5 Turn the steam/hot water distributing knob to the right, in the water position (♂). The steam/hot water function indicator (♂♂) turns on and steady. Distribute hot water until the circuit is refilled and water starts normally running through the steam/hot water pipe.
- 6 Turn the steam/hot water distributing knob to the central position (●) again.
The appliance will restore proper operation.

How to make coffee with a pod

To make coffee with a pod, use the specific pod filter 27 supplied as follows:

- 1 Place the pod in the filter ring 27.
- 2 Insert the pod into the filter. The pod must be well centred and placed inside the filter.
- 3 Now it is possible to put the filter holder in its seat. Tighten the filter holder making sure it is securely fitted to the flange 21.
- 4 After making coffee, the pod might get stuck in the filter holder seat while removing the filter holder.

- 5 To remove it, slightly tilt the filter holder so as to let the pod fall into it.
To always have a good coffee, you must purchase pods that show the E.S.E. compatibility mark.

Important

- If the pod is not inserted well, or if the filter holder is not tightened firmly, a few drops of water could leak from the filter holder.

How to make a cappuccino

In order to make a perfect professional cappuccino, proceed as follows: prepare coffee first, then froth the milk and pour it into coffee.

Important

- Before using the steam/hot water pipe, make sure the filter holder has been removed from its seat.
- If small puffs of steam come out of the filter holder coupling seat, this phenomenon is to be considered absolutely normal.
- **Danger of burns. Only touch the steam/hot water pipe on the rubber part.**
 - 1 Place the steam/hot water pipe into a container 24.
 - 2 Turn the steam/hot water distributing knob 1 to the left, in the steam position (♂). The steam/hot water function indicator (♂♂) flashes, thus indicating steam is being emitted. First a small quantity of water will come out, then a strong steam jet.
 - 3 Stop distributing steam by turning the steam/hot water distributing knob 1 to the central position (●).
 - 4 Place the steam/hot water pipe into the container with milk to be frothed.
 - 5 Gradually turn the steam/hot water distributing knob to the left, in the steam position (♂).
 - 6 Deeply introduce the steam/hot water pipe into milk: in a few minutes a thick and creamy froth will appear.
 - 7 Stop distributing steam by turning the steam/hot water distributing knob 1 to the central position (●). The steam/hot water function indicator (♂♂) will turn off.
- **Important**
 - After each use, distribute steam for a few seconds so as to free the steam nozzle from any milk residue.

Making further cups of coffee

No specific operation needs to be carried out to start distributing coffee after distributing steam. The appliance is provided with an electronic system which makes it possible to always distribute coffee at the optimal temperature. When pressing the coffee distribution button (1 cup or 2 cups), the corresponding indicator starts flashing for the time needed for the boiler to cool down. When the indicator is on and steady, coffee is automatically distributed.

How to distribute hot water

- 1 Place the milk container under the steam/hot water pipe 13.
- 2 Turn the steam/hot water distributing knob to the right, in the water position (♂).
- 3 The steam/hot water function indicator (♂♂) turns on and steady, thus indicating hot water is being emitted.
Water will start running through the steam/hot water pipe.

- 4 Stop distributing water by turning the steam/hot water distributing knob to the central position (●). The steam/hot water function indicator (☞) will turn off.





Useful tips for obtaining a good italian espresso

The grinding level, the quantity of ground coffee, the pressing of coffee into the filter holder and the time spent extracting water affect coffee taste, making it more or less strong, as well as the quality of the cream. Try changing one of these parameters to find the coffee taste you like the most.

When selecting a finer grinding, remember to introduce a larger quantity of coffee into the filter holder and not to excessively press using the coffee presser, otherwise coffee might get watery. Conversely, a coarser grinding requires a smaller quantity of coffee used into the filter holder which should be more pressed with the coffee presser. The ground coffee in the filter holder must be pressed slightly. Store coffee beans into a closed container, in a cool environment protecting it from moisture. If possible, vacuum seal coffee. Buy coffee in small quantities so as to always have it fresh to be ground.

	Grinding	Measuring out coffee	Using the presser	Water distributing time
Strong coffee. Bitter taste. Small quantity	Too fine grinding	Too much coffee powder into the filter holder	Coffee is too pressed into the filter	More than 20 seconds (☞P) More than 30 seconds (☞P☞P)
Balanced coffee	optimal	8-10 g (1 cup) 15-18 g (2 cups)	well pressed	13-18 seconds (☞P) 20-30 seconds (☞P☞P)
Watery coffee	Too coarse grinding	Too little coffee powder into the filter holder	Coffee is not pressed enough	Less than 10 seconds (☞P) Less than 20 seconds (☞P☞P)

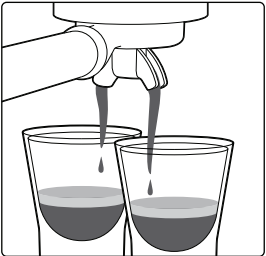
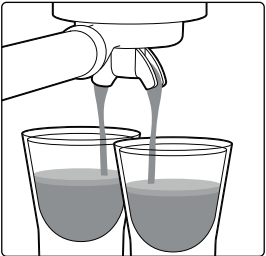
When distributing coffee, the manometer needle shall stay in the OPTIMAL CAFÈ area.
Read paragraph “Manometer functioning”.

		
Pressure OK	Low pressure	High pressure
Coffee is distributed after 4-7 seconds Distribution is slow and temperature is hot Cream has a brown colour and a rich texture Coffee has a dark brown colour	Coffee is distributed after 1-3 seconds Distribution is fast and watery Cream has a lighter colour and a fine texture Coffee has a light brown colour, the taste is bitter and light	Coffee is distributed after 7-8 seconds Distribution is slow and incomplete Cream is darker or absent Coffee has a dark brown colour, the taste is bitter and scorched
		
After distributing coffee, let water run through the filter holder seat while the filter holder is not installed, so as to clean the internal circuit and avoid scale formation.	Select a finer grind size. Increase the quantity of coffee powder to be ground. Press coffee harder into the filter	Select a coarser grind size. Reduce the quantity of coffee powder to be ground. Press the coffee inside the filter using less pressure

Maintenance of the appliance

Unlocking the coffee grinder

In the event the coffee grinder gets blocked, this might be due to impurities among coffee beans which have caused the grinder to get blocked.

- 1 Turn off the appliance to unlock the coffee grinder.
- 2 Remove residual coffee powder from the filter holder.
- 3 Turn the bezel for adjusting the grinding level to the left (ⓘ ⓘ) in order to select the coarsest grinding level (ⓘ, ⓘ, ⓘ), ⓘ. Impurities having caused the appliance to block will thus fall into the compartment for coffee powder.
- 4 Turn on the appliance.
- 5 Place a container under the coffee grinder.
- 6 Press the coffee grinding button (ⓘ) once.
Let ground coffee fall into the container. Throw away the ground coffee to remove impurities.
- 7 Restore the proper grinding level.
Now go on preparing coffee.
If the coffee grinder fails to start again and remains blocked, press the On/Off button (ⓘ) to turn off the appliance. Repeatedly turn the adjusting bezel ⓘ left and right ⓘ. Try starting the coffee grinder again.
If the operation is not successful after several attempts, contact the closest Authorised Service Centre.

Cleaning the appliance

- **Regular maintenance and cleaning preserve and maintain the appliance efficient for a longer period. Never wash the appliance components in the dishwasher. Do not use direct jets of water.**

Cleaning filters containing coffee powder

Make sure the filter holes are not clogged.

- 1 Let hot water run through the filter holder in place, without inserting coffee powder, to remove possible coffee residues or impurities.
- **Remove and disconnect the filter holder slowly because any remaining pressure could cause splashes or sprays.**
It is recommended to clean the filters about every 3 months, using filter cleaning tablets available on the market as follows:
 - 2 Place a cleaning tablet into the filter (without coffee).
 - 3 Fasten the filter holder to its seat.
 - 4 Press the 2 cups coffee button (ⓘ ⓘ) to start distribution.
 - 5 Let the tablet work for at least 15 minutes.
 - 6 Press the coffee button again to stop distribution.
 - 7 Repeat water distribution. Let it rest for a minute. Repeat the procedure for 5 cleaning cycles.
 - 8 Remove the filter holder from its seat, remove the filter from the filter holder and rinse all components well under running water.
 - 9 Press the On/Off button (ⓘ) to turn off the appliance, unplug the cord from the outlet, then clean the internal parts with a soft sponge so as to remove any detergent residue ⓘ.Repeat the operation for all filters.
If the coffee machine is used daily, it is recommended to carry out the cleaning operation at least every three months.

Cleaning of components

Wash the milk container, the filter holder and the three filters using soap and water. Rinse and dry all parts thoroughly.

Cleaning the filter holder seat

With use, it may occur that in the filter holder seat there is a sedimentation of coffee grounds, which can be removed with a toothpick, a sponge ⓘ, or letting water run through without installing the filter holder ⓘ.

- **The filter holder is not dishwasher-safe.**

Cleaning the steam/hot water pipe

- **The procedure must be carried out when the steam/hot water pipe is cooled down to avoid burns.**

- 1 Remove the nozzle from the steam pipe ⓘ and rinse it under running water. You can clean the steam/hot water pipe by using a non-abrasive cloth.
- 2 Fasten the steam nozzle until it is locked in place.
If needed, clean the hole of the steam nozzle by using the provided needle ⓘ. After each use, dispense steam for a few seconds to clear the outlet from any residues.

Tank cleaning

- **This cleaning operation must be carried out with the appliance off and with the plug disconnected from the outlet.**

It is advisable to periodically clean inside the tank with a sponge or damp cloth.

Grill and drip tray cleaning

- **This cleaning operation must be carried out with the appliance off and with the plug disconnected from the outlet.**

Remember to occasionally empty the drip tray.

The drip tray is provided with a float ⓘ. When the float is visible from the cup-resting grill, the drip tray is full and needs to be emptied.

- 1 Remove the cup resting grill ⓘ.
- 2 Remove the drip tray ⓘ from the appliance, empty it and rinse it under running water.
- 3 Also wash the cup grill.

Cleaning the machine body

- **This cleaning operation must be carried out when the appliance's hot parts have cooled down to room temperature.**
- **Clean the fixed parts of the machine using a damp non-abrasive cloth to avoid damaging the body.**



Descaling

Good maintenance and regular cleaning preserve and keep the appliance operating efficiently for a longer period, greatly reducing the risk of scale formation into the appliance. Despite this, should the appliance operation be compromised after some time, due to frequent use of hard and very calcareous water, it is possible to descale the appliance in order to remove dysfunctions. The product can be easily found at Technical Assistance centres.
For this purpose, only use a citric acid-based descaling product.

Important

- The Manufacturer does not accept any responsibility for damage to internal components caused by the use of non-conforming products due to the presence of chemical additives.

When the descaling control indicator () turns on, an anti-limescale cleaning must be carried out. Follow the steps below:

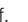
- 1 Press the on/off button () to switch off the appliance.
- 2 Unplug it from the socket-outlet.
- 3 Remove the filter holder from its seat.
- 4 Remove the water softener filter from the water tank.
- 5 Fill the water tank with fresh water until reaching the MAX level.
- 6 Pour the descaling product into water.
- 7 Place a container under the filter holder seat, which shall be larger enough to collect the water of the tank.
- 8 Place the steam/hot water pipe into the container.
- 9 Simultaneously press the coffee distribution buttons for 1 and 2 cups, then press the On/Off button for about 3 seconds.
The descaling process begins and the solution into the tank starts running through the filter holder seat and through the steam/hot water pipe. During the descaling stage, the indicators of the coffee distribution buttons for 1 and 2 cups are flashing.
Limescale deposits will thus be removed from the internal circuit of the appliance.
After several washing cycles and breaks, the descaling process is over. The indicators of the coffee distribution buttons for 1 and 2 cups turn off.
- 10 Clean the water tank from the remaining solution.
- 11 Rinse the water tank.
- 12 Fill the water tank with fresh water.
Simultaneously press the coffee distribution buttons for 1 and 2 cups for about 3 seconds. The rinsing stage begins and water into the tank starts running through the filter holder seat and through the steam/hot water pipe. During the rinsing stage, the indicators of the coffee distribution buttons for 1 and 2 cups are flashing.
After several washing cycles and breaks, the rinsing process is over. The appliance switches off.
- 13 Fill the water tank with fresh water.
- 14 Press the power button () to switch on the appliance. The descaling control indicator () is off.

Important

- If the descaling control indicator keeps flashing, repeat the descaling process.

Service and customer care

- If you experience any problems with the operation of your appliance, before requesting assistance visit www.kenwoodworld.com.
- Please note that your product is covered by a warranty, which complies with all legal provisions concerning any existing warranty and consumer rights in the country where the product was purchased.
- If your Kenwood product malfunctions or you find any defects, please send it or bring it to an authorised KENWOOD Service Centre. To find up-to-date details of your nearest authorised KENWOOD Service centre, visit www.kenwoodworld.com or the website specific to your Country.
- Made in China.



IMPORTANT INFORMATION FOR CORRECT DISPOSAL OF THE PRODUCT IN ACCORDANCE WITH THE EUROPEAN DIRECTIVE ON WASTE ELECTRICAL AND ELECTRONIC EQUIPMENT (WEEE)

At the end of its working life, the product must not be disposed of as urban waste.

It must be taken to a special local authority differentiated waste collection centre or to a dealer providing this service. Disposing of a household appliance separately avoids possible negative consequences for the environment and health deriving from inappropriate disposal and enables the constituent materials to be recovered to obtain significant savings in energy and resources. As a reminder of the need to dispose of household appliances separately, the product is marked with a crossed-out wheeled dustbin.

Setting the machine out of service

When setting the appliance out of service, unplug the power cord from the outlet, empty the water tank as well as the drip tray and clean it (read paragraph "Cleaning the appliance").

In case of scrapping it is necessary to provide for the separation of the various materials used in the construction of the machine and dispose of them according to their composition and the provisions of law in force in the country of use.

TROUBLESHOOTING

- **In case of dysfunctions, immediately turn off the appliance and unplug the power cord from the outlet.**

PROBLEMS	CAUSES	REMEDIES
The appliance is not distributing hot water	Air has probably entered the circuit and deactivated the pump.	Make sure the tank is properly inserted and that the water is not below the minimum level. Repeat the operations described in the "Preliminary phases for use" paragraph.
	The steam nozzle hole is clogged.	Remove possible scale deposits from the steam nozzle hole by using the provided needle.
The machine does not dispense steam.	There is little water and the pump does not suck.	Check that the water level in the tank is correct. If necessary, fill it with cool tap water.
	The steam exit hole on the dispenser wand is clogged.	Remove possible scale deposits from the distribution spout hole by using the provided needle.
Steam overflowing from the edges of the filter ring.	Coffee is being distributed while the steam function is enabled. Make sure the steam/hot water distributing knob is in the central position (●).	Stop the coffee delivery. Turn the steam/hot water distributing knob to the central position to disable the steam function. Wait for button indicators (☐P), (☐P☐P), (●●) to turn on and steady before making another coffee.
Coffee overflowing from the filter edges.	Probably too much ground coffee has been put into the filter holder that has prevented to fully tighten the filter holder in its housing.	Remove and disconnect the filter holder slowly because any remaining pressure could cause splashes or sprays. Clean the coupling seat with a sponge 29. Reduce the amount of ground coffee and repeat the procedure. Read paragraph "Adjusting the quantity of ground coffee for 1 or 2 cups".
	Ground coffee has remained on the filter holder connection seat.	Clean the gasket again with a sponge 29.
	The spouts of the filter containing coffee powder are clogged.	Remove and disconnect the filter holder slowly because any remaining pressure could cause splashes or sprays. Clean the filter spouts by means of a brush or the provided needle. Clean the filter as described in paragraph "Cleaning filters containing coffee powder"
The coffee is too watery and cold.	Coffee grinding is too coarse.	To obtain a more concentrated and hotter coffee, you must use a more finely grounded blend. Try using a finer grinding level.
	If this is the first coffee you are making, the filter might be cold.	Try heating up the filter before making coffee, as described in paragraph "How to make coffee".
The coffee grinder is blocked or noisy.	Impurities are probably mixed with the coffee beans.	Press the grinding button (●●) to stop the grinding process. Read paragraph "Unlocking the coffee grinder".
When the appliance is on, the On/Off button indicator rapidly flashes	The steam/hot water distributing knob is not in the central position (●).	Turn the steam/hot water distributing knob to the central position (●). The appliance will restore proper operation.
Excessive amount of distributed coffee	The amount of distributed coffee for 1 or 2 cups has not been properly adjusted	Reduce the amount of distributed coffee. Read paragraph "Adjusting the quantity of distributed water for 1 or 2 cups"
Excessive amount of ground coffee in the filter	The amount of ground coffee for 1 or 2 cups has not been properly adjusted	Reduce the amount of ground coffee. Read paragraph "Adjusting the quantity of ground coffee for 1 or 2 cups"
During steam distribution, the appliance makes noise	The noise is due to the water pump which is working at higher pressures during steam distribution.	No intervention needed. Proper operation.

PROBLEMS	CAUSES	REMEDIES
During coffee distribution, the appliance makes an unusual noise	There is little water and the pump does not suck.	Check the tank water level is correct. If needed, fill the water tank with fresh water until reaching the MAX level.
The appliance is not distributing hot water and steam	The steam nozzle hole is clogged	Remove possible scale deposits from the distribution spout hole by using the provided needle ❸1.
Milk is not frothed enough	Not enough steam.	Remove possible scale deposits from the distribution spout hole by using the provided needle ❸1.
The appliance has stopped working	The internal protection of the grinder electric motor has started	Turn off the appliance and let it cool down for about 60 minutes.
The coffee grinder is blocked or makes a loud noise	Impurities among coffee beans have caused the grinder to get blocked.	Unlock the coffee grinder as described in paragraph "Adjusting the grinding level".
Coffee is not dispensed or is dispensed too slowly.	The perforated disc located in the coupling seat of the filter holder has the holes clogged.	Operate the machine without the filter holder making water flow. If water keeps running unevenly through the holes, carry out the anti-limescale cleaning as described in paragraph "Descaling".
	The spouts of the filter containing coffee powder are clogged.	Remove and disconnect the filter holder slowly because any remaining pressure could cause splashes or sprays. Clean the filter spouts by means of a brush or the provided needle. Clean the filter as described in paragraph "Cleaning filters containing coffee powder"
	Coffee grinding is too fine.	Try using a coarser grinding level.
	Coffee powder is too pressed.	Press the coffee inside the filter using less pressure.
	The amount of distributed water is scarce	Try increasing the amount of distributed water. Read paragraph "Adjusting the quantity of distributed water for 1 or 2 cups"
	The tank is not fully inserted.	Fit the tank correctly push it completely down.
	There is little water and the pump does not suck.	Check the tank water level is correct. If needed, fill the water tank with fresh water until reaching the MAX level.
	Empty water tank	Fill the tank up to the level marked MAX with fresh water.