

KEN

cleaning

- Always switch off and unplug before removing the blades and cleaning.
- Never let the power unit, recharger, cord or plugs get wet.
- Handle the blades with care - they are extremely sharp.

power unit

- Wipe with a damp cloth, then dry.

slicing blades

- Separate the blades. Wash by hand, then dry thoroughly.
- After use replace the plastic blade cover over the blades.

service and customer care

- If the cord is damaged it must, for safety reasons, be replaced by Kenwood or an authorised Kenwood repairer.

If you need help with:

- using your slicing knife or servicing, spare parts or repairs
Contact the shop where you bought your machine.

Questo apparecchio è conforme alla direttiva 2004/108/CE sulla Compatibilità Elettromagnetica, ed al regolamento (EC) No. 1935/2004 del 27/10/2004 sui materiali in contatto con alimenti.

This appliance conforms to EC directive 2004/108/EC on Electromagnetic Compatibility and EC regulation no. 1935/2004 of 27/10/2004 on materials intended for contact with food.

19140/1

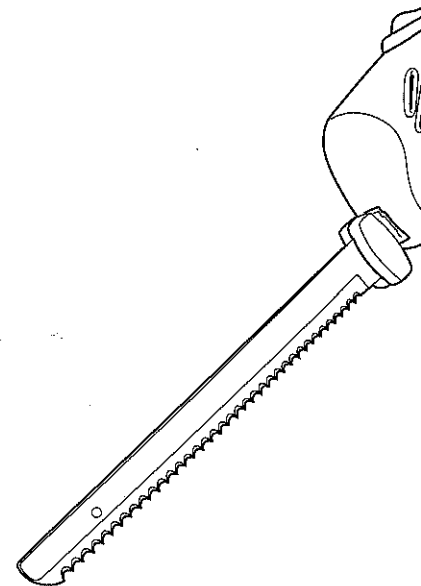

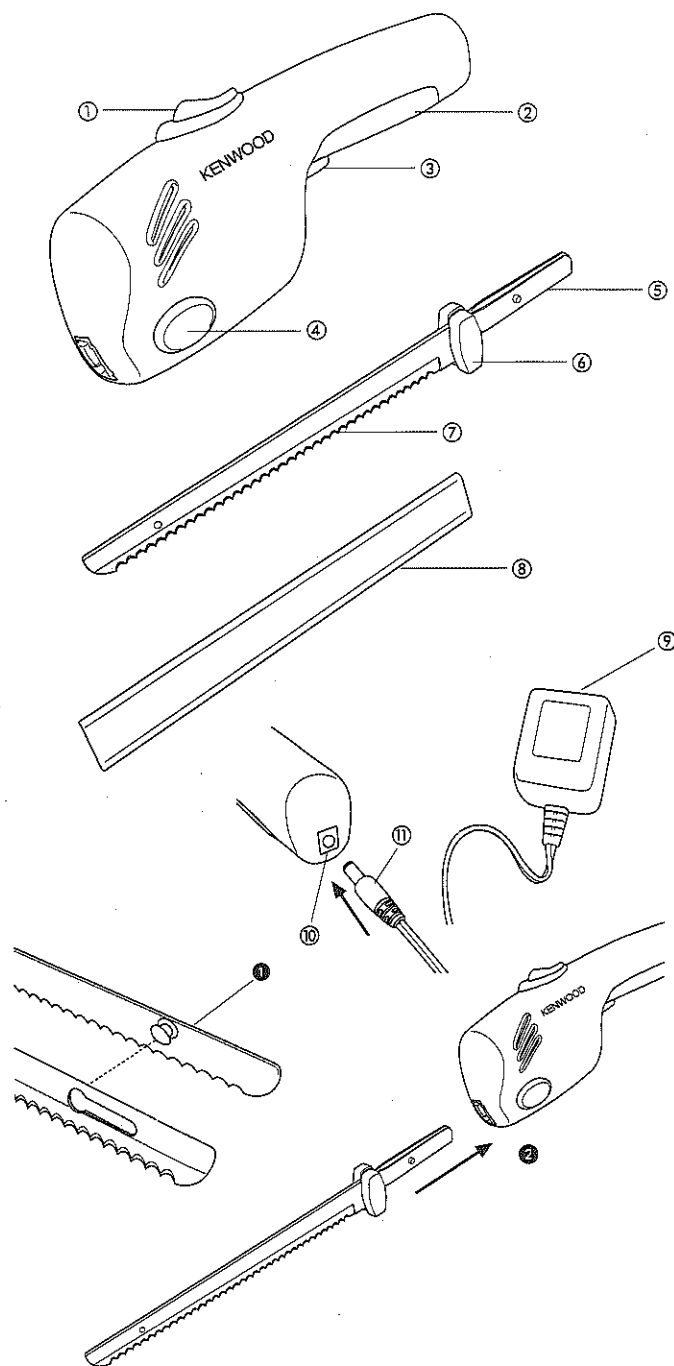

safety

- Always switch off and unplug before inserting or removing the blades and before cleaning.
- The blades are sharp, handle with care. Hold the blades by their handles away from the cutting edge, both when handling and cleaning.
- During slicing keep hands etc and utensils well away from the cutting blades.
- Do not use if there is any visible damage to the appliance.
- Never use an unauthorised attachment.
- Don't let children play with this appliance.
- Never leave the appliance unattended when connected to the power supply.
- Never use a damaged appliance. Get it checked or repaired: see 'service'.
- This appliance is not intended for use by young children or infirm persons.
- Don't let excess cord hang over the edge of a table or worktop or touch hot surfaces.
- Never misuse your slicing knife and only use it for its intended domestic use.
- Never let the power unit, recharger, cord or plugs get wet.
- Never exert excessive force when slicing food.
- Never attempt to slice frozen food, bones, food containing stones or seeds, food in wrappers such as aluminium foil or plastic film, or other hard food.

before plugging in

- Make sure your electricity supply is the same as the one shown on the recharger, underside of your appliance.
- This appliance complies with European Economic Community Directive 89/336/EEC

before using for the first time

1. Remove all packaging including the plastic blade cover from the blades. The blade cover should be retained and refitted when not in use.
2. Wash the parts: see 'cleaning'
3. Fully charge the battery (see below)

charging the battery

- Your Kenwood KN500 has a battery which uses advanced technology so that it is easy to fully recharge before each use and it will not develop a memory after several recharges.
- The KN500 is delivered with the battery not fully charged and before the first use it is necessary to fully charge the battery.
- Use only the recharger supplied with the knife.
- Plug the recharger into the power supply.
- With the knife On/Off switch in the 'Off' position, put the small plug from the recharger into the charging socket at the end of the knife handle.
- The green light beside the charging socket will come on and will remain on all the time the knife is plugged into the recharger and the power is turned on.

- The first time the knife is charged it should be charged for 12 hours.
- For best performance, charge the knife for 2-3 hours each time before intended use.

key

- ① on/off switch
- ② knife body
- ③ safety switch
- ④ eject buttons
- ⑤ blade handles
- ⑥ finger grips
- ⑦ interlocking blades
- ⑧ blade cover
- ⑨ recharger
- ⑩ charging socket
- ⑪ recharger plug

to use the slicing knife

Your knife is suitable for slicing a variety of foods including cooked meat, cooked poultry, bread, cakes, sandwiches, fruit and vegetables.

1. Make sure the On/Off switch is in the 'Off' position.
 2. Hold the blades by their handles and interlock together ⑤. With the cutting edge facing downwards insert the blades into the knife body and push into place ②.
 3. Put the On/Off switch to 'On'.
 4. With the food on a suitable cutting surface, place the blades onto the food. Operate the cutting blades by pressing the safety switch. (Releasing the switch stops the cutting blades.) Allow the knife to cut through the food.
- Use the knife by holding it in place, do not use a cutting motion. The knife will cut automatically as required either vertically or at an angle.

When using the slicing knife the blades should always be directed away from the operator.

5. After use, put the On/Off switch to 'Off'.
6. Press the eject button and withdraw the blades from the knife body.

hint

- When slicing poultry, cut almost to the bone but go no further, then separate the meat from the bone manually.
- The blades are self sharpening by friction and should not be manually sharpened.