

Ariete

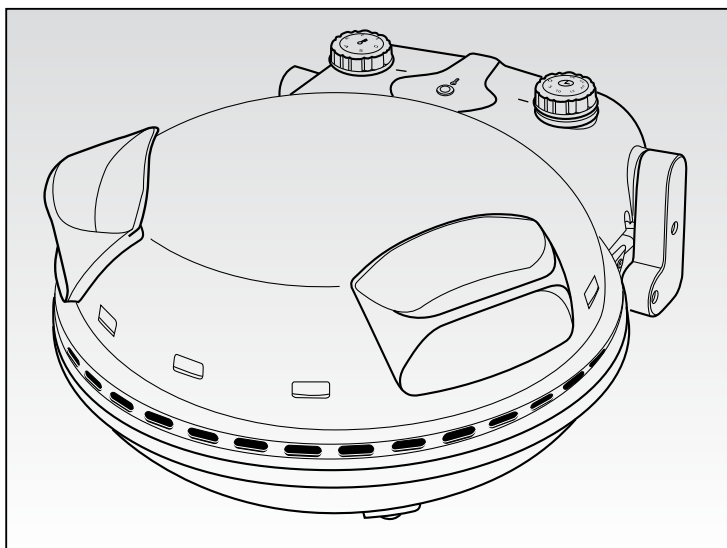

Pizza maker

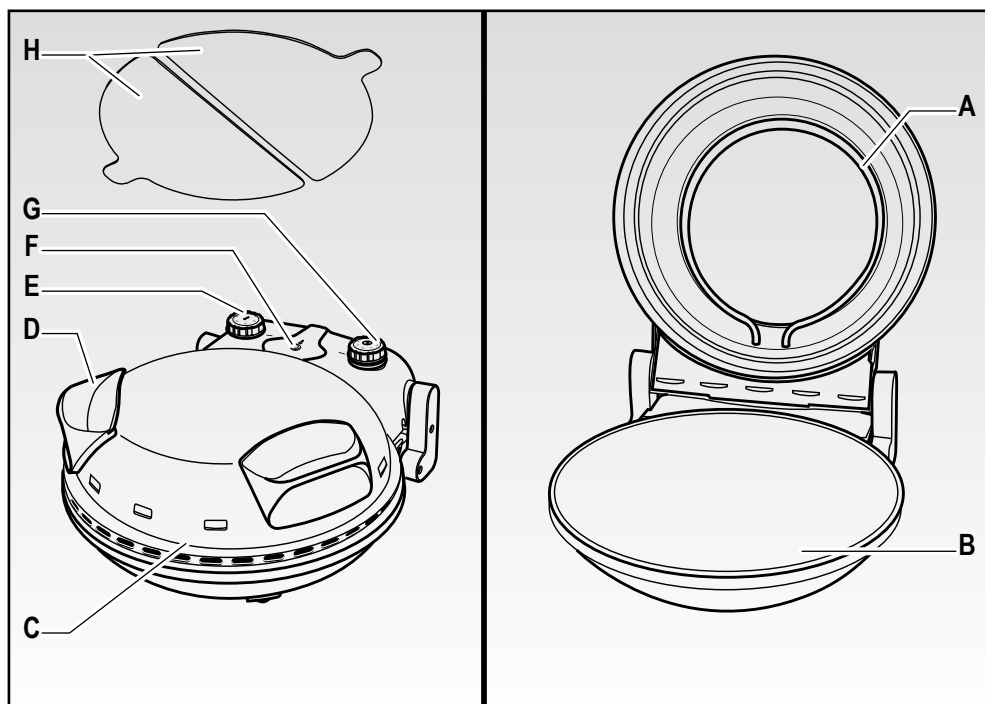

Fig. 1

APPLIANCE DESCRIPTION

- A Heater
- B Baking stone plate
- C Appliance body
- D Handles
- E Power on and temperature dial
- F Temperature light
- G Timer dial
- H Spatula

IMPORTANT SAFEGUARDS

READ THESE INSTRUCTIONS BEFORE USE.

The necessary precautions must be taken when using electrical appliances, and these include the following:

1. Make sure that the voltage on the appliance rating plate corresponds to that of the mains electricity.
2. Never leave the appliance unattended when connected to the power supply; unplug it after every use.
3. Never place the appliance on or close to sources of heat.
4. Always place the appliance on a flat, level surface during use.
5. Never leave the appliance exposed to the elements (rain, sun, etc....).
6. Make sure that the power cord does not come into contact with hot surfaces.
7. This appliance can be used by children aged from 8 years and above and persons with reduced physical, sensory or mental capabilities or lack of experience and knowledge if they have been given supervision or instruction concerning use of the appliance in a safe way and understand the hazards involved. Children shall not play with the appliance. Cleaning and maintenance shall be made by children aged from 8 years and under surveillance.
8. Keep the appliance and the power cord out of reach of children under 8 years of age.
9. NEVER PLACE THE APPLIANCE BODY, PLUG OR POWER CORD IN WATER OR OTHER LIQUIDS; ALWAYS WIPE CLEAN WITH A DAMP CLOTH.
10. ALWAYS UNPLUG THE POWER CORD FROM THE ELECTRICITY MAINS BEFORE FITTING OR REMOVING SINGLE ATTACHMENTS OR BEFORE CLEANING THE APPLIANCE.
11. Always make sure that your hands are thoroughly dry before using or adjusting the switches on the appliance, or before touching the power plug or power connections.
12. To unplug the appliance, grip the plug and remove it directly from the power socket. Never pull the power cord to unplug the appliance.
13. For safety reasons, your appliance must be connected to an earthed socket according to the electrical regulations in force. AVOID THE USE OF ANY ELECTRICAL DEVICES THAT DO NOT CONFORM TO THE NORMS.
14. Do not move the appliance while it is operating.
15. Do not let the electrical cord hang over the edge of a table or work surface. Avoid contact with hot surfaces.

16. Do not touch the cooking surface when the oven is in use and as long as it remains hot after being switched off.
17. During the initial operating cycles the oven will smoke. This is absolutely normal and will disappear after it has been used for some time.
18. Do not place the appliance on/near to sources of heat or electrical parts. Do not position it on other appliances.
19. Do not cover the insides of the oven with aluminium foil.
20. Only use the oven to cook or heat foods.
21. Do not place cloths or plates on the appliance.
22. Do not use the oven in kitchen units or built into furniture.
23. Do not use the appliance near to walls or curtains.
24. After use, switch off, before moving or cleaning it.
25. **The outer surfaces of the appliance can become very hot while it is operating.**
26. **WARNING – Place the oven on a work top capable of withstanding temperatures of at least 90°C, taking care that there is nothing on it to prevent the passage of air.**
27.  **WARNING – Danger of burns. Do not touch the hot surfaces while the oven is in use.**
28. This product is not to be intended to operate by means of an external timer or separate remote-control system.
29. Never use the appliance if the power cord or plug are damaged or if the appliance itself is faulty; in this case, take it to your nearest Authorised Assistance Centre.
30. To prevent any risks, if the power cord is damaged, it must be replaced by the manufacturer, its Technical Assistance Service or a similarly qualified person.
31. This appliance is designed for HOME USE ONLY and may not be used for commercial or industrial purposes.
32. This appliance conforms to the directives 2014/35/EU and EMC 2014/30/EU, and to the regulations (EC) No. 1935/2004 of 27/10/2004 regarding material in contact with foods.
33. Any changes to this product, including the thermostat setting modification, may compromise the safety use of the product and lead to the user's guarantee being rendered null.
34. In the event that you decide to dispose of the appliance, we advise you to make it inoperative by cutting off the power cord. We also recommend that any parts that could be dangerous be rendered harmless, especially for children, who may

play with the appliance or its parts.

35. Packaging must never be left within the reach of children since it is potentially dangerous.
36. This appliance is intended to be attended during the usage. In case of fault of the appliance, switch off the power plug.
37. Do not use extension cords but plug the appliance always directly to the power socket.

DO NOT THROW AWAY THESE INSTRUCTIONS

HOW TO OPERATE

WARNING:

Before use, check the baking plate is clean and free of dust streaks. If need be, clean using a damp cloth.

It is recommended to clean the heating element and the base before starting heating up and proceed with cooking to remove any small dust residues that have formed in the cooling and rest stage of the product.

While using for the first time, a very small amount of smoke may come out; this is just caused by the warming up of some components.

- Plug in appliance.
- Switch the pizza oven on and set the required temperature level, according to your needs, using the dial (E): The related light (F) goes on indicating starting of the pre-heating phase.
- Set baking time by rotating the timer dial (G).
- After few minutes, the light turns off and the appliance is ready for use.
- Raise then the upper part of the appliance using both hands with both handles (D) and place the pizza or any other food to be baked on the baking stone plate (B) by using also suitable oven gloves.
- Close appliance upper part.
- "Timer" sends out a signal after every baking cycle. Rotate the temperature dial (E) to "0" and disconnect the plug from the socket.

W

ARNING:

THE TIMER DOES NOT SWITCH ON AND OFF THE OVEN! It is therefore important to check the appliance after the time set has elapsed. To switch the appliance off, set the temperature dial to "0" and unplug it.

Make sure appliance is properly closed during baking phase and that food inside isn't in contact with the upper heater.

DO not open lid during baking to avoid heat dispersion and a probable lengthening of baking time.

Prevent the condiment used for pizza (oil, cheese, tomato, mozzarella, etc.) from falling onto the baking stone (B), in order to avoid absorption as well as unpleasant smoke emissions and smells.

In case fresh pasta is used for pizza making, cover in flour the surface where pasta is made to prevent it from sticking to the baking stone during baking phase.

On the baking stone plate there is a special treatment that ensures an easy washability. Owing use, the surface treatment might tend to change its colour into a darker hue and to show cracks. This does not jeopardize the operation of the oven or the cooking quality.

PREPARATION AND BAKING TIME

WARNING:

For the best pizza baking results, it is recommended to pre-heat the oven at the highest temperature for about 10 minutes.

FROZEN PIZZA

- Bake for 2-3 minutes (anyhow, follow times indicated on package).
- It is recommended to take pizza out of freezer 20-30 minutes before putting it in the oven (anyhow, follow instructions on package).

BOXED PIZZA (TO BE KNEADED)

- Bake for 4-5 minutes.
- Refer to instructions on package.

PIZZA MADE WITH RECIPE

- Refer to instructions of the recipe.

CLEANING AND MAINTENANCE

WARNING:

Only clean the oven after first making sure that it is unplugged from the power mains and that it has cooled down completely.

- Remove cooking residues with a spatula.
- Avoid the use of abrasive products or any other detergents.
- The baking stone plate tends to change its colour into a darker hue, to show spots and small cracks owing use. This does not jeopardize the operation of the oven or the cooking quality.
- Wipe the outer surfaces of the appliance with a damp cloth. The baking stone plate (B) can also be cleaned with a damp cloth.

CLEANING THE STONE (B) WITH BAKING SODA

Baking soda is a natural and effective remedy for removing the stubborn stains and residues and is an excellent ally for cleaning the pizza oven stone (B). Anyway, after such process, some rings might remain on the stone; this is normal.

The cleaning procedure must be carried out on the cold stone, therefore the product must be unplugged.

- Open the upper lid of the product.
- Remove food residues from the stone (B) with a spatula.
- Dampen the stone (B) with a sponge soaked in water.
- Put 1 or 2 tbsp of baking soda in the middle of the stone (B).
- Sprinkle the baking soda on the stone (B), especially on dark stains, using a sponge.
- A paste of water and baking soda will form on the stone (B).
- Leave it work for about 5 minutes.
- Clean and wipe the stone (B) with the sponge.
- Remove the residues and the baking soda from the stone (B).
- Allow to dry.



IMPORTANT INFORMATION FOR CORRECT DISPOSAL OF THE PRODUCT IN ACCORDANCE WITH EC DIRECTIVE 19/2012/UE.

At the end of its working life, the product must not be disposed of as urban waste.

It must be taken to a special local authority differentiated waste collection centre or to a dealer providing this service.

Disposing of a household appliance separately avoids possible negative consequences for the environment and health deriving from inappropriate disposal and enables the constituent materials to be recovered to obtain significant savings in energy and resources. As a reminder of the need to dispose of household appliances separately, the product is marked with a crossed-out wheeled dustbin.

WARRANTY

**PLEASE AFFIX YOUR RECEIPT/PROOF OF PURCHASE HERE.
IN THE EVENT OF A CLAIM UNDER THIS WARRANTY THE AFORESAID RECEIPT/PROOF OF
PURCHASE MUST BE PRODUCED TOGETHER WITH THIS WARRANTY.**

Model number	(Lot number:)
Product name	
Date of purchase	
Place of purchase	

1. The party selling the product ("the seller") to the original purchaser of this product ("the customer") hereby warrants that this product will be of good quality and, in good working order and, free of defects and suitable for its intended purpose under normal household use, for a period of 1 (one) year from the date of purchase ("warranty period") of this product.
2. In the event that the warranty period has not lapsed and the product is not of a good quality, or in good working order or, is defective or is not suitable for its intended purpose under normal household use, the customer may, subject to paragraph 3 below, return the product to the seller and have the following options available:
 - 2.1 Within the first 6 (six) months of the warranty: to receive a refund of the actual price paid or exchange the product for the same or similar product of the same purchased value;
 - 2.2 Within the second 6 (six) months of the warranty: to have the product exchanged for the same or similar product of the same purchased value.
3. The seller will not replace the product or refund the customer in terms of this warranty if the product:
 - 3.1 has been altered contrary to the instructions provided in the product manual;
 - 3.2 has been misused, abused or tampered with;
 - 3.3 is defective or not in working order due to ordinary wear and tear;
 - 3.4 is damaged resulting from the customer's gross negligence, recklessness, malicious behavior or criminal conduct;
 - 3.5 has been utilised for commercial use.

4. This warranty applies only to the product that has been purchased from the seller and not to any expendables attached to or installed on the product by the customer.
5. Any claim in terms of this warranty must be supported by the original proof of purchase.
6. Note that the exchange item will only carry the balance of the warranty period as from the original date of purchase.
7. Spares:
Selected spares can be purchased from:

ServiceTec
10 Saddle Drive
Woodmead Office Park
Woodmead

Email: spares.za@delonghigroup.com
Tel: +27 11 474 0153



Ariete

De' Longhi Appliances Srl
Divisione Commerciale Ariete
Via San Quirico, 300
50013 Campi Bisenzio FI - Italy
E-Mail: info@ariete.net
Internet: www.ariete.net