

ESAM40XY - ESAM42XY

BEAN TO CUP ESPRESSO AND
CAPPUCCINO MACHINE
Instructions for Use

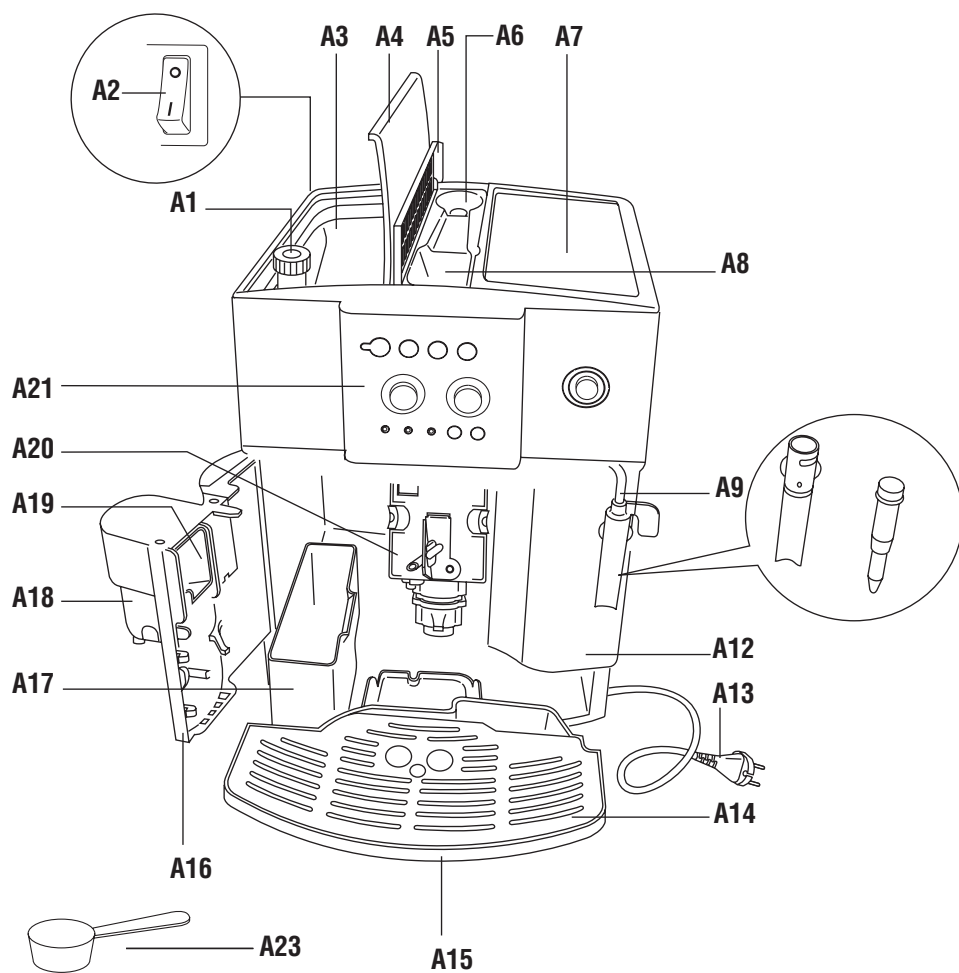

DeLonghi

A

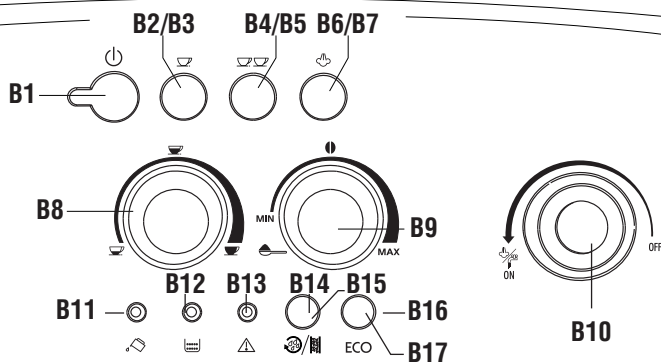
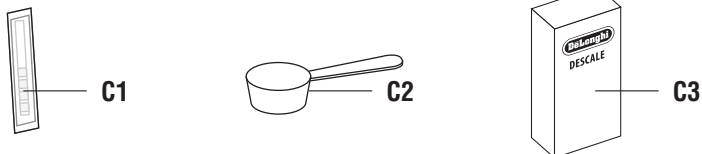

B**C**

CONTENTS

1. INTRODUCTION.....	5
1.1 Letters in brackets.....	5
1.2 Troubleshooting and repairs.....	5
2. DESCRIPTION.....	5
2.1 Description of the appliance	5
2.2 Description of the control panel	5
2.3 Description of the control panel	5
3. SETTING UP THE APPLIANCE	5
4. TURNING THE MACHINE ON	6
5. TURNING THE APPLIANCE OFF	6
6. AUTO-OFF	7
7. SETTING THE TEMPERATURE.....	7
8. ENERGY SAVING.....	7
9. MAKING COFFEE.....	7
9.1 Selecting the coffee taste	7
9.2 Selecting the quantity of coffee in the cup	7
9.3 Adjusting the coffee mill	8
9.4 Tips for a hotter coffee.....	8
9.5 Making coffee using coffee beans	8
9.6 Making coffee using pre-ground coffee	9
10. MAKING CAPPUCCINO	9
10.1 Cleaning the cappuccino maker after use	10
11. HOT WATER	10
12. CLEANING.....	11
12.1 Cleaning the machine	11
12.2 Cleaning the internal circuit	11
12.3 Cleaning the coffee grounds container	11
12.4 Cleaning the drip tray.....	11
12.5 Cleaning the inside of the machine	12
12.6 Cleaning the water tank	12
12.7 Cleaning the coffee spouts	12
12.8 Cleaning the pre-ground coffee funnel	12
12.9 Cleaning the infuser	12
13. DESCALING.....	13
14. SETTING WATER HARDNESS	14
14.1 Measuring water hardness	14
14.2 Setting water hardness	14
15. TECHNICAL DATA.....	14
16. MEANING OF INDICATOR LIGHTS DURING NORMAL OPERATION.....	15
17. MEANING OF THE ALARM INDICATORS.....	16
18. TROUBLESHOOTING	17

1. INTRODUCTION

Thank you for choosing this bean to cup espresso and cappuccino machine.

We hope you enjoy using your new appliance. Take a few minutes to read this Instruction for Use. This will avoid all risks and damage to the appliance.

1.1 Letters in brackets

The letters in brackets refer to the legend in the description of the appliance on pages 2-3.

1.2 Troubleshooting and repairs

In the event of problems, first try and resolve them by reading the information given in sections "17. meaning of the alarm indicators" and "18. Troubleshooting".

If this does not resolve the problem or you require further information, you should consult customer services by calling the number given on the annexed "Customer Service" sheet.

If your country is not among those listed on the sheet, call the number given in the guarantee. If repairs are required, contact De'Longhi customer services only. The addresses are given in the guarantee certificate provided with the machine.

2. DESCRIPTION

2.1 Description of the appliance









(page 2 - A)

- A1. Grinding adjustment dial
- A2. Main switch (on back of machine)
- A3. Beans container
- A4. Beans container lid
- A5. Pre-ground coffee funnel lid
- A6. Compartment for measure
- A7. Cup shelf
- A8. Pre-ground coffee funnel
- A9. Steam spout
- A10. Cappuccino maker (removable)
- A11. Steam nozzle (removable)
- A12. Water tank
- A13. Power cord
- A14. Cup tray
- A15. Drip tray
- A16. Infuser door
- A17. Coffee grounds container
- A18. Coffee spouts (adjustable height)
- A19. Coffee guide
- A20. Infuser

2.2 Description of the control panel

(page 3 - B)

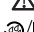
- B1.  button: turns the appliance on and off (standby).
- B2. 1 cup and coffee temperature OK light

- B3.  button: to make 1 cup of coffee
- B4. 2 cups and coffee temperature OK light
- B5.  button: to make 2 cups of coffee
- B6. Steam and steam temperature OK light
- B7.  button: to select the steam function
- B8. Quantity selection dial (short, standard or long)
- B9. Coffee taste (mild, standard or strong coffee) or pre-ground coffee  selection dial.
- B10. Steam/hot water dial
- B11.  light: no water or water tank absent
- B12.  light: grounds container full or absent
- B13.  light: general alarm
- B14.  button: to select rinsing or descaling
- B15. Descale light
- B16. ECO button to select energy saving mode
- B17. Energy saving mode light

2.3 Description of the control panel

(page 3 - C)

- C1. Indicator paper
- C2. Pre-ground coffee measure
- C3. Descaler

3. SETTING UP THE APPLIANCE

Please note:

- The first time you use the appliance, rinse with hot water all removable accessories which may come into contact with water or milk.
- Possible traces of coffee in the mill are the result of operating tests performed on the appliance before sale, proof of the meticulous care and attention we invest in our products.
- You should customise water hardness as soon as possible following the instructions in section "14. Setting water hardness".

1. Remove the water tank (A12), fill to the MAX line with cold water then replace in the appliance (fig. 1).

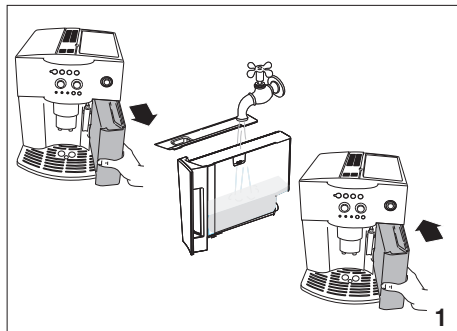

- Turn the cappuccino maker (A10) outwards and place a container with a minimum capacity of 100 ml underneath (fig. 2).

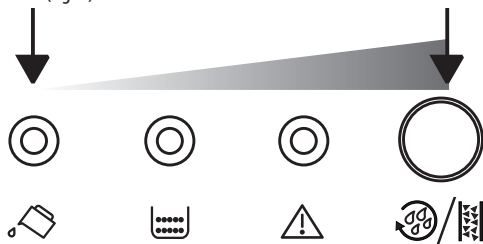

- Plug the appliance into the mains socket and place the main switch (A2) on the back of the appliance in the **I** position (fig. 3).
- The ☕ (B2), ☕☕ (B4), and 🔌 (B6) lights flash simultaneously.
- Turn the steam dial (B10) clockwise as far as it will go, to the **I** position (fig. 4): water will now flow from the cappuccino maker (the machine becomes noisy at this point, which is normal).

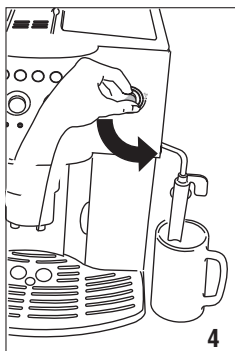

- Wait for delivery of hot water to stop automatically. The ☕☕☕ and 🔌 lights flash to indicate that you must close the steam tap by turning the steam dial to the **0** position.
- Turn the steam knob to the **0** position. The appliance goes off automatically.

To use the machine, it must be turned on.

Please note:

When used for the first time, 4-5 cups of coffee or 4-5 cappuccinos need to be made before the machine starts to give satisfactory results.

4. TURNING THE MACHINE ON

Please note:

Before turning the appliance on, make sure the main switch (A2) on the back of the appliance is in the **I** position (fig. 3). Make sure the steam/hot water dial (B10) is in the **0** position. Each time the appliance is turned on, it performs an automatic preheat and rinse cycle which cannot be interrupted. The appliance is ready for use only after completion of this cycle.

Danger of scalding!

During rinsing, a little hot water comes out of the coffee spouts (A18) and is collected in the drip tray (A15) underneath. Avoid contact with splashes of water.

- To turn the machine on, press the ⏻ button (B1) (fig. 5): the ☕ (B2) and ☕☕☕ (B4) lights flash while the appliance is heating up and performing an automatic rinse cycle. This heats the boiler, and with hot water also circulating through the internal circuits, these will be advantageously warmed up as well.

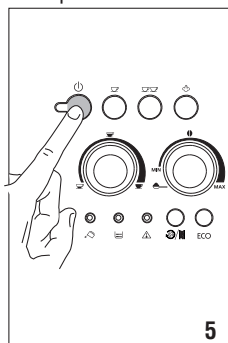

When the ☕ and ☕☕☕ lights remain on steadily, the appliance is up to temperature.

5. TURNING THE APPLIANCE OFF

Each time the appliance is turned off, it performs an automatic rinse cycle which cannot be interrupted.

Danger of scalding!

During rinsing, a little hot water flows from the coffee spouts (A18). Avoid contact with splashes of water.

To turn the appliance off, press the ⏻ button (fig. 4). The appliance performs a rinse cycle then shuts off.

Please note:

If the machine will not be used for an extended period, set the main switch (A2) to the **0** position (fig. 6).

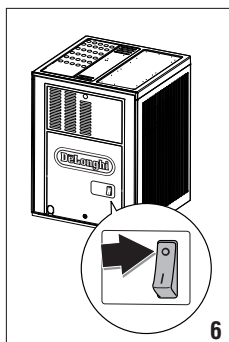

6

Important!

To avoid damaging the appliance, never place the main switch (fig. 6) in the **0** position while the appliance is on.

6. AUTO-OFF

The period of time can be changed so that the appliance switches off after being idle for 15 or 30 minutes, or after 1, 2 or 3 hours.

1. With the machine off but the main switch (A2) in the **I** position (fig. 3), press and hold the ECO button (B16) until the indicators at the bottom of the control panel light up (see image after point 2).
2. Select the required period of time (15 or 30 minutes or 1, 2 or 3 hours) by pressing the  (B7) button; (see the light/time table below).

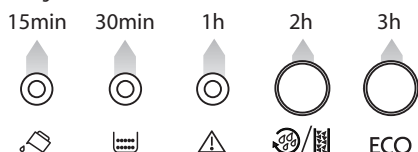



3. Press the ECO button to confirm the selection. Auto-off is now programmed.

Please note:

To disconnect the appliance completely, set the main switch at the back to the **0** position (fig. 6).

7. SETTING THE TEMPERATURE

To change the temperature of the water used to make the coffee, proceed as follows:

1. With the appliance off and the main switch (A2) in the **I** position (fig. 3), press the  (B2) button and hold it down until the lights on the control panel come on;
2. Press the  (B4) button to select the required temperature:

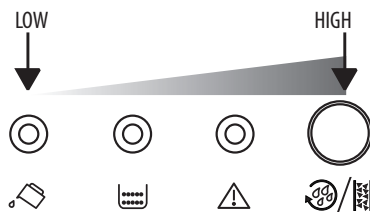

3. Press the  button to confirm the selection. The indicators go out.

8. ENERGY SAVING

Use this function to enable or disable energy saving. When enabled, the function reduces energy consumption in compliance with current European regulations.

Energy saving mode is active when the ECO (B17) light is on.

To enable or disable the function, press the ECO button (B16).

Please note:

When in energy saving mode, a few seconds may elapse before the first coffee is delivered as the appliance must heat up again.

9. MAKING COFFEE

9.1 Selecting the coffee taste

Turn the coffee taste selection dial (B9) to set the required taste. Turning clockwise increases the quantity of coffee beans that will be ground by the machine and consequently the strength of the coffee.

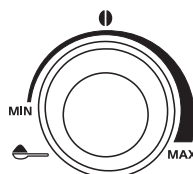

Please note:

- The first time you use the appliance, you will need to make a number of coffees to identify the correct dial position through trial and error.
- Make sure not to turn the knob too far clockwise, otherwise the coffee may be delivered too slowly (a drop at a time), particularly when making two cups of coffee.

9.2 Selecting the quantity of coffee in the cup

Adjust the coffee quantity selection dial (B8) to set the required quantity.



Turning it clockwise increases the amount of coffee obtained.

Please note:

Using the machine for the first time, you will need to make a number of coffees to identify the correct dial position by trial and error.

9.3 Adjusting the coffee mill

The coffee mill is factory-set in such a way that the coffee will be delivered correctly and should not require regulating initially. However, if after making the first few coffees you find that the coffee is either too weak and not creamy enough or delivery is too slow (a drop at a time), this can be corrected by adjusting the grinding adjustment dial (A1) (fig. 7).

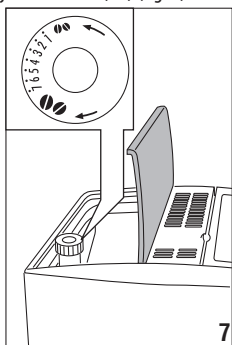

Please note:

The grinding adjustment dial must only be turned when the coffee mill is in operation.

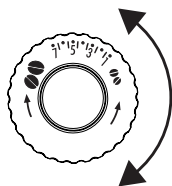

To obtain delivery not a drop at a time, turn one click clockwise towards "7". For fuller bodied creamier coffee, turn one click anticlockwise towards "1" (do not turn more than one click at a time otherwise the coffee could be delivered a drop at a time). These

adjustments will only be evident after at least 2 cups of coffee have been delivered. If this adjustment does not produce the desired result, turn the dial another click.

9.4 Tips for a hotter coffee

For hotter coffee, proceed as follows:

- before delivering the coffee, perform a rinse cycle by pressing the ☼/☼ (B14) button. Hot water is delivered from the spout, heating the internal circuits of the appliance and thus raising the coffee temperature;
- warm the cups with hot water (using the hot water function - "11. Hot water").

9.5 Making coffee using coffee beans

Important!

Do not use caramelised or candied coffee beans as they could stick to the coffee mill and render it unserviceable.

1. Fill the container (A3) with coffee beans (fig. 8).

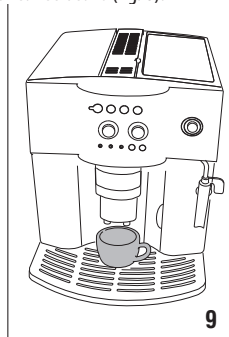

2. Place under the coffee spouts (A18):
 - 1 cup if you want 1 coffee (fig. 9);
 - 2 cups, if you want 2 coffees.
3. Lower the spouts as near as possible to the cup. This makes a creamier coffee (fig. 10).

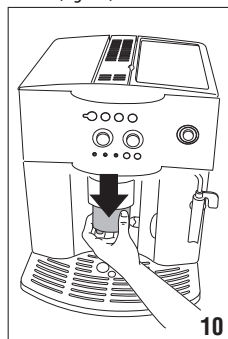

4. Press the button corresponding to the number of coffees required (1 cup ☼ (B3) or 2 cups ☼☼ (B5), figs. 11 and 12).

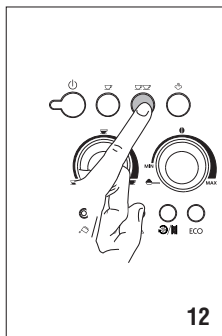
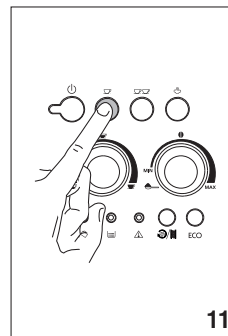

- Preparation begins and the ☞ (B2) or ☞☞ (B4) light stays on until delivery is complete.

Please note:

- While the machine is making coffee, delivery can be interrupted at any moment by pressing one of the two coffee buttons (☞ or ☞☞).
- At the end of delivery, to increase the quantity of coffee in the cup, within 3 seconds, just press and hold one of the coffee buttons (☞ or ☞☞).

Once the coffee has been made, the appliance is ready to make the next beverage.

Please note:

For hotter coffee, see section "9.4 Tips for a hotter coffee".

Important!

- If the coffee is delivered a drop at a time, too weak and not creamy enough or too cold, read the tips in section "18. Troubleshooting".
- Lights may light up on the touch screen during use. Their meaning is given in section "17. meaning of the alarm indicators".

9.6 Making coffee using pre-ground coffee

Important!

- Never add pre-ground coffee when the machine is off, as it could infiltrate and soil the inner workings. This could damage the machine.
- Never use more than 1 level measure (C2) as it could soil the inside of the coffee machine or block the funnel.

Please note:

When using pre-ground coffee, only one cup can be made at a time.



- Turn the coffee taste selection dial (B9) anticlockwise as far as it will go, to the ☞ position.
- Make sure the funnel is not blocked, then add one level measure of pre-ground coffee (fig. 13).

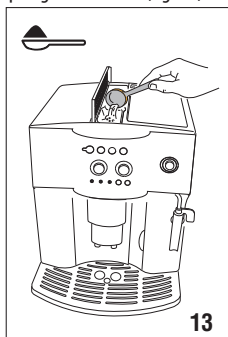

13

- Place a cup under the coffee spouts (A18).
- Press the 1 cup button ☞ (B3) (fig. 11).
- Preparation begins and can be interrupted at any moment by pressing one of the two coffee buttons ☞ or ☞☞ (B5)).

To deactivate the pre-ground coffee function, turn the knob to one of the other positions.

Please note:

A few seconds may elapse between energy saving mode and delivery of the first coffee.

10. MAKING CAPPUCCINO

Important! Danger of scalding

During preparation, steam is given off. Take care to avoid scalds.

- When preparing cappuccino, make the coffee in a large cup;
- Fill a container with about 100 grams of milk for each cappuccino to be made. When choosing the appropriate size of container, remember that the milk doubles or triples in volume;

Please note:

For a richer and denser froth, use skimmed or partially skimmed milk from the refrigerator (about 5°C). To avoid producing milk with poor froth or large bubbles, always clean the cappuccino maker as described in the section "10.1 Cleaning the cappuccino maker after use".

- Press the ☞ button (B7). The corresponding light (B6) flashes, indicating that the appliance is heating up;
- Turn the cappuccino maker (A10) outwards and immerse in the container of milk (fig. 14);

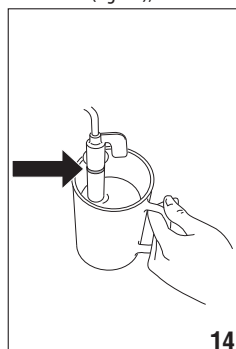

14

- When the ☞ indicator stops flashing and remains steadily on, turn the steam dial (B10) to the I position. Steam is delivered from the cappuccino maker, giving the milk a creamy frothy appearance and making it more voluminous;







- For a creamier froth, swirl the container slowly, moving it from the bottom upwards. (Steam should not be generated by the machine for more than 3 minutes continuously).
- When you have obtained the required froth, stop steam delivery by turning the steam dial back to the **0** position.

Important! Danger of scalding

Always turn the steam dial to the **0** position before removing the container with the frothed milk to avoid burns caused by splashes of boiling milk.

- Add the milk froth to the cup of coffee prepared previously. The cappuccino is ready. Sweeten to taste and, if desired, sprinkle the froth with a little cocoa powder.

Please note:

- If immediately after making cappuccino and deactivating the steam function by pressing the  steam button you press the  (B3) or  button (B5) because you want to make another coffee, the coffee maker will be too hot (the  and  lights flash to indicate an unsuitable temperature). You must wait about ten minutes for the appliance too cool down sufficiently.
- To cool it down more quickly, after deactivating the steam function, open the steam knob and let the water flow out of the cappuccino maker into a container until the  and  lights stop flashing.

Danger of scalding!

Avoid contact with splashes of water.

10.1 Cleaning the cappuccino maker after use

Clean the cappuccino maker (A10) each time you use it to avoid the build-up of milk residues or blockages.

Important! Danger of scalding!

When cleaning the cappuccino maker, a little hot water is delivered. Avoid contact with splashes of water.

- Deliver a little water for a few seconds by rotating the steam dial (B10) to the **I** position. Then turn the steam dial to the **0** position to stop the flow of hot water.
- Wait a few minutes for the cappuccino maker to cool down, then grip the handle of the cappuccino maker tube firmly in one hand, and with the other, rotate the cappuccino maker anticlockwise (fig. 15) and remove by pulling downwards (fig. 16).

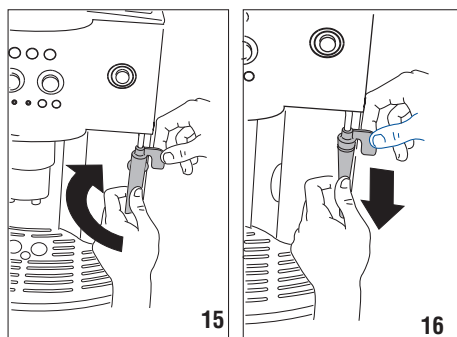

- Wash all parts of the cappuccino maker thoroughly with a sponge and warm water.
- Make sure the holes shown by the arrows in fig. 17 are not blocked. If necessary, clean with a pin.

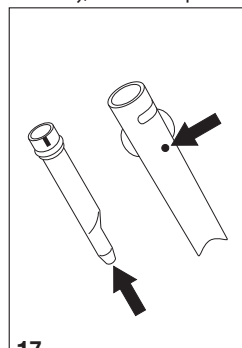



- Wash all parts of the cappuccino maker thoroughly with a sponge and warm water.
- Reinsert the nozzle (A11) and replace the cappuccino maker on the nozzle, turning it and pushing it upwards until it is attached.

11. HOT WATER

Important! Danger of scalding!

Never leave the machine unattended while delivering hot water. Stop delivery of hot water as described below when the cup is full. The cappuccino maker becomes hot when in use and must be held by the handle only.

- Place a container under the cappuccino maker (A10) (as close as possible to avoid splashes).
- Check that the  (B3) and  (B5) lights are on steadily.
- Turn the steam knob (B10) a half turn anticlockwise as far as it will go. Delivery begins.
- Stop by turning the steam knob to the **0** position.

Please note:

- If "Energy Saving" mode is active, there may be a few seconds pause before hot water is delivered.
- To produce steam immediately after preparing hot water, you should open the steam dial for a few seconds to empty the water circuits.

12. CLEANING

12.1 Cleaning the machine

The following parts of the machine must be cleaned regularly:

- the appliance's internal circuit,
- coffee grounds container (A17),
- drip tray (A15),
- water tank (A12),
- coffee spouts (A18),
- pre-ground coffee funnel (A8),
- inside of the machine, accessible after opening the infuser door (A16),
- Infuser (A20).

Important!

- Do not use solvents, abrasive detergents or alcohol to clean the coffee machine. With De'Longhi superautomatic coffee machines, no chemical products are required for cleaning purposes. The descaler recommended by De'Longhi is made from natural and completely biodegradable substances.
- None of the components can be washed in a dishwasher.
- Do not use metal objects to remove encrustations or coffee deposits as they could scratch metal or plastic surfaces.

12.2 Cleaning the internal circuit

If the appliance is not used for more than 3/4 days, before using it again, we strongly recommend switching it on and:

- 2/3 rinse cycles by pressing  (B14);
- delivering hot water for a few seconds (section "11. Hot water").

Please note:

Water may find its way into the grounds container (A17) during the above rinse procedure: this is quite normal.

12.3 Cleaning the coffee grounds container

When the  light (B12) flashes, the coffee grounds container (A17) needs emptying. If the grounds container is not cleaned, the indicator will continue to flash and the machine cannot be used to make coffee.

To clean (with the machine on):

- Open the service door (A16) on the front of the appliance, extract the drip tray (A15) (fig. 18), empty and clean.

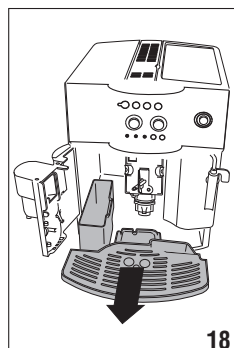

- Empty the grounds container (A17) and clean thoroughly to remove all residues left on the bottom.

Important!

When removing the drip tray, the grounds container must be emptied, even if it contains few grounds.

If this is not done, when you make the next coffees, the grounds container will fill up more than expected and clog the machine.

12.4 Cleaning the drip tray

Important!

If the drip tray (A15) is not emptied regularly, the water could overflow from the edge and seep inside or around the machine. This could damage the machine, the surface it rests on or the surrounding area.

The drip tray is fitted with a level indicator (red) showing the amount of water it contains (fig. 19).

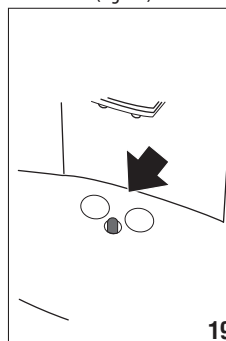

Before the indicator protrudes from the cup tray (A14), the drip tray must be emptied and cleaned.

To remove the drip tray:

1. Remove the drip tray and grounds container (A17) (fig. 18);
2. Empty the drip tray and grounds container and wash them;
3. Replace the drip tray and grounds container.

12.5 Cleaning the inside of the machine

Danger of electric shock!

Before cleaning internal parts, the machine must be turned off (see section "5. Turning the appliance off") and unplugged from the mains power supply. Never immerse the machine in water.

1. Check regularly (about once a week) that the inside of the appliance (accessible after removing the drip tray) is not dirty. If necessary, remove coffee deposits with a brush and a sponge.
2. Remove all residues with a vacuum cleaner (fig. 20).

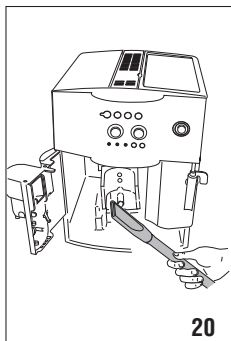

12.6 Cleaning the water tank

1. Clean the water tank (A12) regularly (about once a month and whenever you replace the water softener filter (if provided) with a damp cloth and a little mild washing up liquid.
2. Fill the tank with fresh water and put back in the appliance.

12.7 Cleaning the coffee spouts

1. Clean the coffee spouts (A18) with a sponge or cloth (fig. 21).

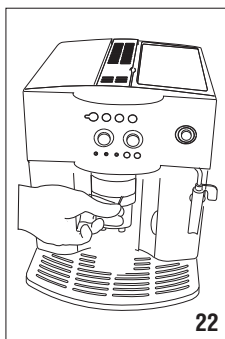
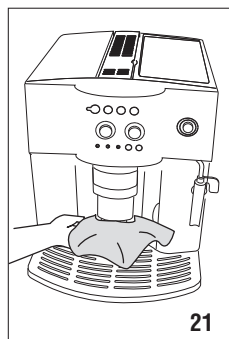

2. Check the holes in the coffee spouts are not blocked. If necessary, remove coffee deposits with a toothpick (fig. 22).

12.8 Cleaning the pre-ground coffee funnel

Check periodically (about once a month) that the pre-ground coffee funnel (A8) is not blocked. If necessary, remove coffee deposits with a brush.

12.9 Cleaning the infuser

The infuser (A20) must be cleaned at least once a month.

Important!

The infuser cannot be removed when the machine is on.

1. Make sure the machine has run the shutdown procedure correctly (see "5. Turning the appliance off").
2. Open the service door (A16).
3. Remove the drip tray (A15) and coffee grounds container (A17) (fig. 18);
4. Press the two red release buttons inwards and at the same time pull the infuser outwards (fig. 23).

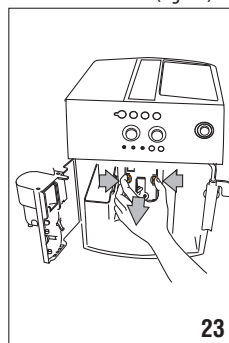

Important!

RINSE WITH WATER ONLY

NO DETERGENTS - NO DISH WASHER

Clean the infuser without using washing up liquid as it could be damaged.

5. Soak the infuser in water for about 5 minutes, then rinse under the tap.
6. After cleaning, replace the infuser by sliding it onto the internal support and pin at the bottom (fig. 24), then push the PUSH symbol fully in until it clicks into place.

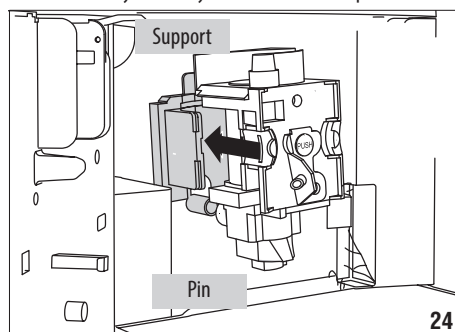

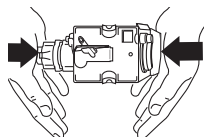
Please note!

If the infuser is difficult to insert, before insertion, squeeze the two levers shown in the figure to make it smaller.

- Once inserted, make sure the two red buttons have snapped out (fig. 25).

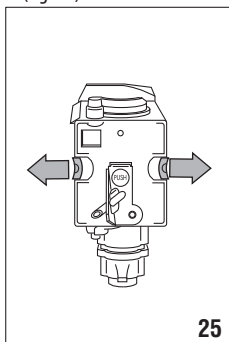

- Replace the drip tray and grounds container.
- Close the service door.

13. DESCALING

Descalc the appliance when the light on the panel flashes.

Important!

- Before use, read the instructions and the labelling on the descaler pack.
- Use De'Longhi descaler only. Using unsuitable descaler products and/or performing the descale procedure incorrectly could give rise to faults not covered by the manufacturer's guarantee.
- Descaler could damage delicate surfaces. If the product is accidentally spilt, dry immediately.

To descale	
Descaler	De'Longhi descaler
Container	Recommended capacity: 1.7
Time	~45min

- Turn the appliance on and wait until it is ready for use.
- Empty the water tank (A12).
- Pour the descaler (C3) into the water tank (corresponding to a 100ml pack) (fig. 26), then add 1 litre of water (fig. 27).

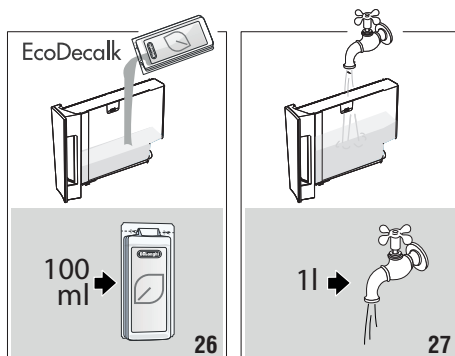

- Place an empty container with a minimum capacity of 1.7 litres under the cappuccino maker (A10) (fig. 28).

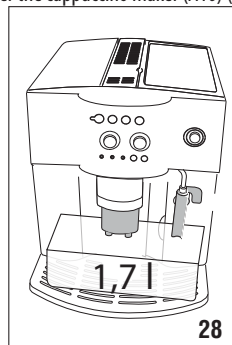

- Wait for the (B2) and (B4) lights to come on steadily.

Important! Danger of scalding!

Hot water containing acid flows from the cappuccino maker. Avoid contact with splashes of water.

- Press and hold the button (B14) for at least 5 seconds to confirm that you have added the solution and begin the descaling procedure. The light in the button remains on steadily to indicate that the descaling programme has begun. The (B7) lights flash simultaneously telling you to turn the steam dial (B10) to the I position (coffee cannot be made).
- Turn the steam knob a half turn anticlockwise to the I position. The descaler solution flows out of the cappuccino maker into the underlying container. The descale programme automatically performs a series of rinses and pauses to remove limescale deposits from inside the machine.

After about 30 minutes the water tank is empty: The light (B11) comes on and the (B7) lights alternate; turn the steam dial clockwise as far as it will go to the 0 position.

The appliance is now ready to be rinsed out with clean water.

8. Empty the container used to collect the descaler solution and replace it empty under the cappuccino maker.
9. Remove the water tank, empty, rinse under running water, fill with clean water and replace. The , and lights flash simultaneously.
10. Turn the steam knob a half turn anticlockwise to the I position. Hot water comes out of the cappuccino maker. When the water tank is completely empty, the light goes off, the light comes on and the lights flash.
11. Turn the knob to the 0 position, fill the water tank again and the appliance goes off automatically.

To use the appliance, turn it on by pressing the button.

Please note!

If the descaling cycle is not completed correctly (e.g. no electricity) it is advisable to repeat the cycle.

14. SETTING WATER HARDNESS

The light (B15) comes on after a period of time established according to water hardness.

The machine can also be programmed according to the hardness of the mains water in the various regions so that the machine needs to be descaled less often.

14.1 Measuring water hardness

1. Remove the "TOTAL HARDNESS TEST" indicator paper (C1) from its pack (attached to the English instructions).
2. Immerse the paper completely in a glass of water for one second.
3. Remove the paper from the water and shake lightly. After about a minute, 1, 2, 3, or 4 red squares form, depending on the hardness of the water. Each square corresponds to one level.

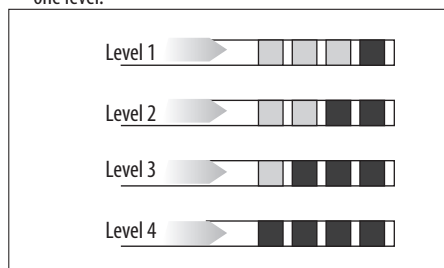

14.2 Setting water hardness

1. Make sure the appliance is off (but connected to the mains electricity supply and with the main switch in the I position);

2. Press and hold the button (B14) for at least 6 seconds. The lights (B11) (B12) (B13) (B14) come on together;
3. Press the ECO button (B16) to set the actual water hardness (as measured by the indicator paper).

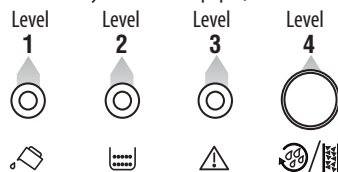









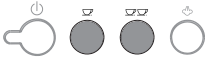

4. Press the button to exit the menu
The machine is now reprogrammed with the new water hardness setting.





















15. TECHNICAL DATA









Voltage:	220-240 V~ 50/60 Hz max. 10 A
Absorbed power:	1450 W
Pressure:	1.5MPa (15 bars)
Water tank capacity:	1.7 L
Size: LxHxD:	280x364x400 mm
Cord length:	1500 mm
Weight:	10.8 kg

16. MEANING OF INDICATOR LIGHTS DURING NORMAL OPERATION

INDICATORS	DESCRIPTION	MEANING
1 	Indicators flashing	The machine is not ready to make coffee (the water has not yet reached the ideal temperature). Wait for the indicators to light up permanently before making coffee
2 	Indicators permanently alight	The appliance is at the right temperature and ready to make coffee.
3 	Indicator permanently alight	The appliance is delivering one cup of coffee
4 	Indicator permanently alight	The appliance is delivering two cups of coffee
5 	Steam indicator flashing	The appliance is heating up to the ideal temperature to produce steam. Wait for the light to remain on steadily before turning the steam knob (B10)
6 	Steam indicator permanently alight	The appliance is ready to deliver steam
7 	Indicators flashing alternately	The appliance is turning off (see section "5. Turning the appliance off")
8 	Indicators flashing	You must turn the steam dial to position I
9 	Indicators flashing alternately	You must turn the steam dial to position 0.
10 	Indicator permanently alight	The appliance is in energy saving mode
11 	Indicator permanently alight	The automatic descaling programme is underway

17. MEANING OF THE ALARM INDICATORS

INDICATORS	DESCRIPTION	MEANING	WHAT TO DO
1     	Indicator permanently alight	Insufficient water in tank (A12) or tank not correctly in place	Fill the tank with water and/or insert it correctly, pushing it as far as it will go until it clicks into place
		The tank is dirty and/or clogged	Rinse or descale the tank
2     	Indicator flashing	The grinding is too fine and the coffee emerges too slowly	Repeat coffee delivery and turn the grinding adjustment dial (fig. 10) one click clockwise towards "7" while the coffee mill is in operation. If after making at least 2 coffees delivery is still too slow, repeat the correction procedure, turning the grinding adjustment dial another click (see section "9.3 Adjusting the coffee mill").
		The coffee maker is not able to make coffee	If the problem persists, turn the steam dial (B10) to the I position and let some water run from the cappuccino maker (A10).
3     	Indicator permanently alight	The grounds container (A17) is full or missing	Empty the grounds container and drip tray (A15), clean and replace (fig. 18). Important: when removing the drip tray, the grounds container MUST be emptied, even if it contains few grounds. If this is not done, it can happen that when the next coffees are made, the grounds container will fill up more than expected and clog the machine.
4     	Indicator flashing	The pre-ground coffee function  has been selected without placing any pre-ground coffee in the funnel (A8)	Place pre-ground coffee in the funnel or deselect the "pre-ground" function
		The coffee beans have run out	Fill the beans container (A3)
		If the coffee mill is very noisy, this means a small stone in the coffee beans has caused a blockage	Contact Customer Services
→			

INDICATORS	DESCRIPTION	MEANING	WHAT TO DO
5 	Indicator flashing	The machine must be descaled	The descaling procedure described in the section "Descaling" needs to be performed as soon as possible
6 	There is an unusual noise and the indicators flash alternately	The infuser has not been replaced after cleaning	Leave the service door (A16) closed and the infuser (A20) out of the coffee maker. Press the  (B3) and  (B5) buttons together until the four indicators go off. You cannot open the service door and insert the infuser until all four lights are out.
7 	Indicators flashing alternately	The coffee maker has just been turned on, the infuser (A20) is not inserted correctly and the service door (A16) is not correctly closed	Press the word PUSH on the infuser until it clicks into place. Make sure the two red buttons have snapped out. Close the service door and turn the appliance on again
8 	Indicators flashing	The pre-ground coffee funnel (A8) is clogged	Empty the funnel with the help of a brush as described in section "12.8 Cleaning the pre-ground coffee funnel"
9 	Indicator permanently alight	The infuser (A20) has not been replaced after cleaning.	Insert the infuser as described in section "12.9 Cleaning the infuser"
		The inside of the machine is very dirty	Clean the appliance thoroughly
10 	Indicator flashing	The service door (A16) is open	If you cannot close the door, make sure the infuser (A20) is correctly inserted
11 	Indicators flashing alternately	The coffee maker has been switched on with the steam knob in the open position	Turn the steam knob clockwise until delivery stops

18. TROUBLESHOOTING

Below is a list of some of the possible malfunctions.

If the problem cannot be resolved as described, contact customer services.

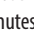
PROBLEM	POSSIBLE CAUSE	REMEDY
The coffee is not hot	The cups were not preheated.	Warm the cups by rinsing them with hot water (Please note: you can use the hot water function).
	The infuser (A20) has cooled down because 2/3 minutes have elapsed since the last coffee was made.	Before making coffee, heat the infuser by pressing the  button (B14).
→		

PROBLEM	POSSIBLE CAUSE	REMEDY
The coffee is weak or not creamy enough	The coffee is ground too coarsely.	Turn the grinding adjustment dial (A1) one click anticlockwise towards "1" while the coffee mill is in operation (fig. 7). Continue one click at a time until coffee delivery is satisfactory. The effect is only visible after delivering 2 coffees (see section "9.3 Adjusting the coffee mill").
	The coffee is unsuitable.	Use coffee for espresso machines.
The coffee emerges too slowly or drop-by-drop.	The coffee is ground too finely.	Turn the grinding adjustment dial one click clockwise towards "7" while the coffee mill is in operation (fig. 7). Continue one click at a time until coffee delivery is satisfactory. The effect is only visible after delivering 2 coffees (see section "9.3 Adjusting the coffee mill").
Coffee does not come out of one or both of the spouts (A18)	The spouts are blocked.	Clean the spouts with a toothpick.
The coffee does not come out of the spouts (A18), but from around the service door (A16)	The holes in the spouts are clogged with dry coffee dust.	Clean the spouts with a toothpick, sponge or hard bristled kitchen brush.
	The coffee guide (A19) inside the service door is blocked and cannot swing.	Clean the coffee guide thoroughly, particularly near the hinges.
The frothed milk has large bubbles	The milk is not cold enough or is not semi-skimmed.	Ideally, use skimmed or semi-skimmed milk from the refrigerator (about 5°C). If the result is still not as desired, try changing the brand of milk.
The milk is not frothed	Cappuccino maker (A10) dirty.	Clean as described in section "10.1 Cleaning the cappuccino maker after use".
The flow of steam stops	A safety device shuts off the steam after 3 minutes.	Wait, then enable the steam function again.
The appliance does not come on	It is not plugged into the mains socket.	Plug into the mains socket.
	The main switch (A2) is not turned on.	Place the main switch in the I position (fig. 3).
When the Steam/hot water dial (B10) is turned to the I position, steam/hot water is not delivered from the cappuccino maker	The holes in the cappuccino maker (A10) and/or steam connection nozzle (A11) are blocked.	Clean the cappuccino maker as described in section "10.1 Cleaning the cappuccino maker after use".
The infuser (A20) cannot be removed for cleaning	The machine is on or has not completed the shutdown procedure.	The infuser can only be removed when the appliance has been turned off correctly (see section "5. Turning the appliance off").

Register Now 
www.delonghi.com/register

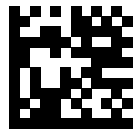

De'Longhi Appliances via Seitz, 47 31100 Treviso, Italy www.delonghi.com

5713225351_03_0221