

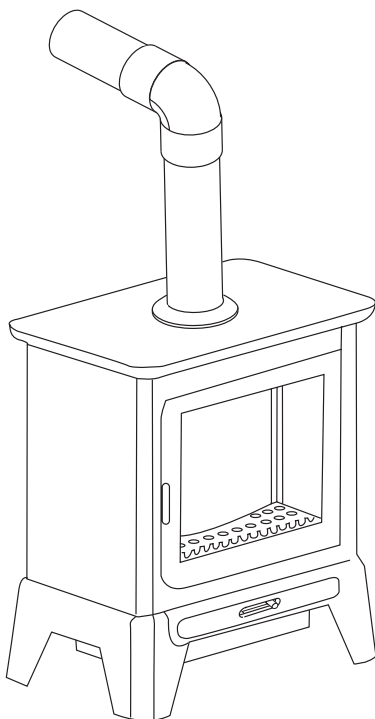

INSTRUCTIONS ELECTRIC STOVE



Proudly distributed by
De'Longhi New Zealand Limited
25 Carbine Road
Mt Wellington
Auckland, New Zealand

PO Box 58-056
Greenmount
Manukau 2141
Auckland, New Zealand
Customer Service Ph: 0508 200 300
Fax: 0508 200 301
e-mail: delonghi@delonghi.co.nz

Australia

Po Box 4156
MILPERRA BC NSW 1891
Customer Service Ph: 1800 126659
Fax: 1800 706932
e-mail: delonghi@delonghi.com.au

Description of appliance

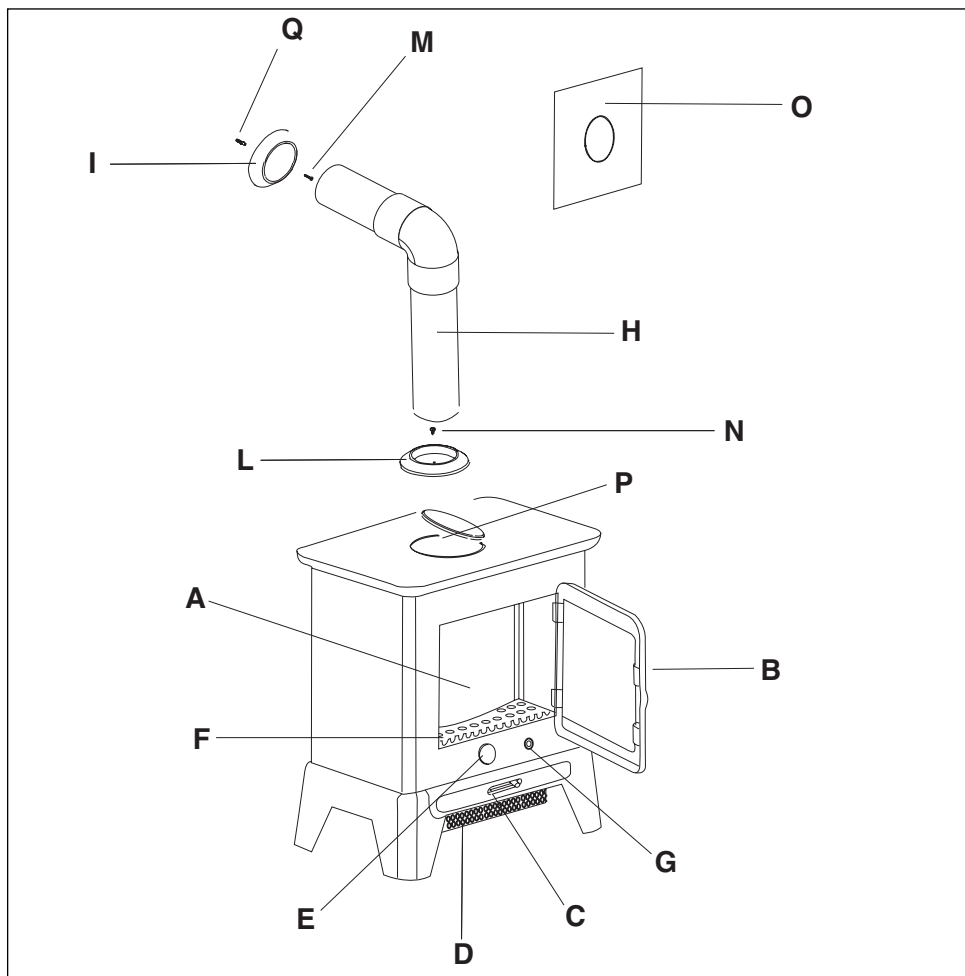

DESCRIPTION OF APPLIANCE

- | | |
|---|---------------------------------------|
| A) Fire effect shield | H) Decorative flue |
| B) Door | I) Wall flange marked "wall" |
| C) Function slider | L) Stove flange marked "stove" |
| D) Hot air output grille | M) Wall screw |
| E) Thermostat dial | N) Stove screw |
| F) Coal/pebbles/logs support shelf | O) Drilling template |
| G) Flame effect dimmer | P) Hole cover |
| | Q) Fixing plug |

Thank you for choosing this De'Longhi heater. To get the very best out of your new heater it is advisable to read these instructions before using it. This will ensure that you gain optimum results and use the appliance safely.

General instructions

Your stove is designed for use throughout your living area, such as against a wall or in a corner, to add instant warmth and ambiance.

Position the fire so that the plug socket is accessible.

Always ensure there is sufficient airflow, otherwise the operation of the stove will be compromised.

Placing the pebbles/coal/logs

Depending on which stove you have purchased you will find pebbles, coal or logs packed with your stove. Once the stove is placed in your chosen location, unpack the pebbles/coal/logs from the accessory box and arrange inside the stove on the support shelf (F).

Arrange the pebbles/coal/logs as you wish using as many as you require. If your stove has pebbles, we suggest spreading the smaller ones across the shelf as a base. The 3 large pebbles should then be placed on top with the medium ones used to fill any gaps where light could escape.

Operating the stove

The stove is controlled by the function slider.

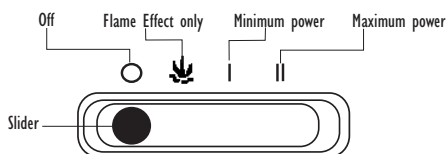

Turning on the Flame Effect

The fire effect can be on whether or not the heating is on ( position).

Heat Levels

For minimum heat, set the slider on the minimum power position I.

For maximum heat, set the slider on the maximum power position II.

Adjusting the thermostat

When the room has reached the required temperature, turn the thermostat dial (E) slowly until a "click" is heard and no further. This temperature will be regulated automatically and kept constant by the thermostat.

Automatic Safety Cut Out

This heater is fitted with an automatic cut out device to prevent any damage due to overheating. The heater will automatically cut out if the airflow is obstructed. To reset the stove, disconnect the plug from the power socket for a few minutes, remove the cause of obstruction and allow a suitable cooling period before plugging it in again.

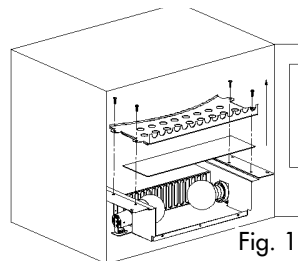

Fig. 1

Flame effect dimmer

The appliance has a fire effect intensity regulator enabling the flame light to be increased or reduced.

Noise

As with all fan driven appliances the stove will make some noise due to the movements of air occurring, this is perfectly normal.

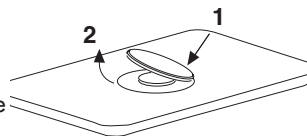

fig. 2

Installing the flue

If you want to install the flue, proceed as follows:

- remove the hole cover by pressing on one side only (fig. 2).
- fit the stove flange (L) in the hole and screw on with the stove screw supplied (fig. 3).
- decide where you want to install the appliance.
- fit the longest part of the pipe on the flange stove (fig. 4).
- move the stove near the wall and place the drilling template between the pipe and the wall to establish the correct position for the hole in the wall.
- fix the drilling template with adhesive tape or a suitable alternative (fig. 5).
- Move the stove out of the way and drill the wall with a 6mm dia. masonry drill bit to the depth required.
- fix the wall flange (I) to the wall with the wall screw and fixing plug supplied. Put the stove back in position and fit the flue onto the flange.

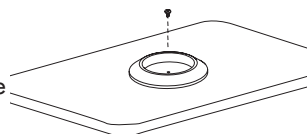

fig. 3

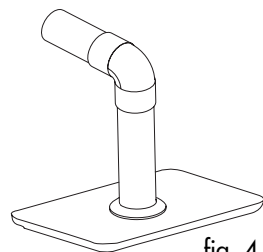

fig. 4

Maintenance

Before any maintenance/cleaning is undertaken always disconnect the stove from the power supply and allow to cool down.

Replacing light bulbs

Tools required: correct screwdriver (not included in the box).

Remove the coal, pebbles, or logs from the internal support shelf, then remove the support by removing the screw provided as shown in fig. 1. The light bulbs must be replaced only with 40W 220-240V screw type E27. Please note that replacement bulbs are not covered by the guarantee of the product.

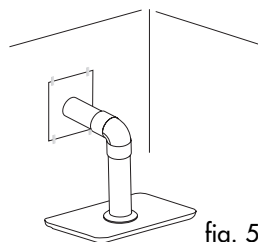

fig. 5

Cleaning

The stove can be cleaned with a soft damp cloth. Do not use metal polish or harsh scouring agents.

Service and Customer Care

- If the cord is damaged it must, for safety reasons, be repaired by De'Longhi or an authorised De'Longhi repairer.
- Please refer to the enclosed guarantee leaflet for service and assistance details.

SAFETY WARNINGS

- Do not use the stove in a bathroom or in the vicinity of bathtubs, washbasins, showers or swimming pools.
- Do not use the stove to dry your laundry. Never obstruct the intake and outlet grilles (danger of overheating).
- Never install the stove directly underneath a fixed mains socket.
- If the supply cord is damaged, it must be replaced by the manufacturer or its service agent or a similarly qualified person in order to avoid a hazard. Please refer to enclosed guarantee leaflet for details.
- The use of an extension lead is not recommended, however if it is necessary then carefully follow the extension lead's instructions, and most importantly ensure that the extension lead is correctly rated in accordance with the appliance being used and NEVER overloaded.
- In order to avoid any danger caused by accidental resetting of the safety system, this appliance must not be powered through an external timer.
- Do not use the fire in rooms which have an area as small as 4m²
- As with any electrical stove, whilst the instructions aim to cover as many eventualities as possible, caution and common sense should be applied when operating your appliance, particularly in the vicinity of small children.
- Particular caution should be applied to ensure that young children do not play with or swallow any pebbles or coal.
- Should you wish to connect the fire to a fused spur, this must be carried out by a competent electrician in accordance with the IEE wiring regulations.
- This appliance is not intended for use by persons (including children) with reduced physical, sensory or mental capabilities, or lack of experience and knowledge, unless they have been given supervision or instruction concerning the use of the appliance by a person responsible for their safety. Children should be supervised to ensure that they do not play with the appliance
- The front face of the heater must be positioned at least 50 cm from furniture, walls, curtains, or other objects.



WARNING: In order to avoid overheating, never under any circumstances cover the appliances during operation, as this would lead to dangerous overheating.

PROBLEM SOLVING

No power to the fire	Check the wall socket, plug and fuse
No Illumination/ flame effect	Check that fire is switched on. Check that the bulbs are working.
Heater cuts out/ poor or no flame effect	Check that airflow around the stove is not obstructed or the product is covered in any way.

