

Ariete



Steam mop



Ariete

De' Longhi Appliances Srl
Divisione Commerciale Ariete
Via San Quirico, 300
50013 Campi Bisenzio (FI)
E-Mail: info@ariete.net
Internet: www.ariete.net



4175

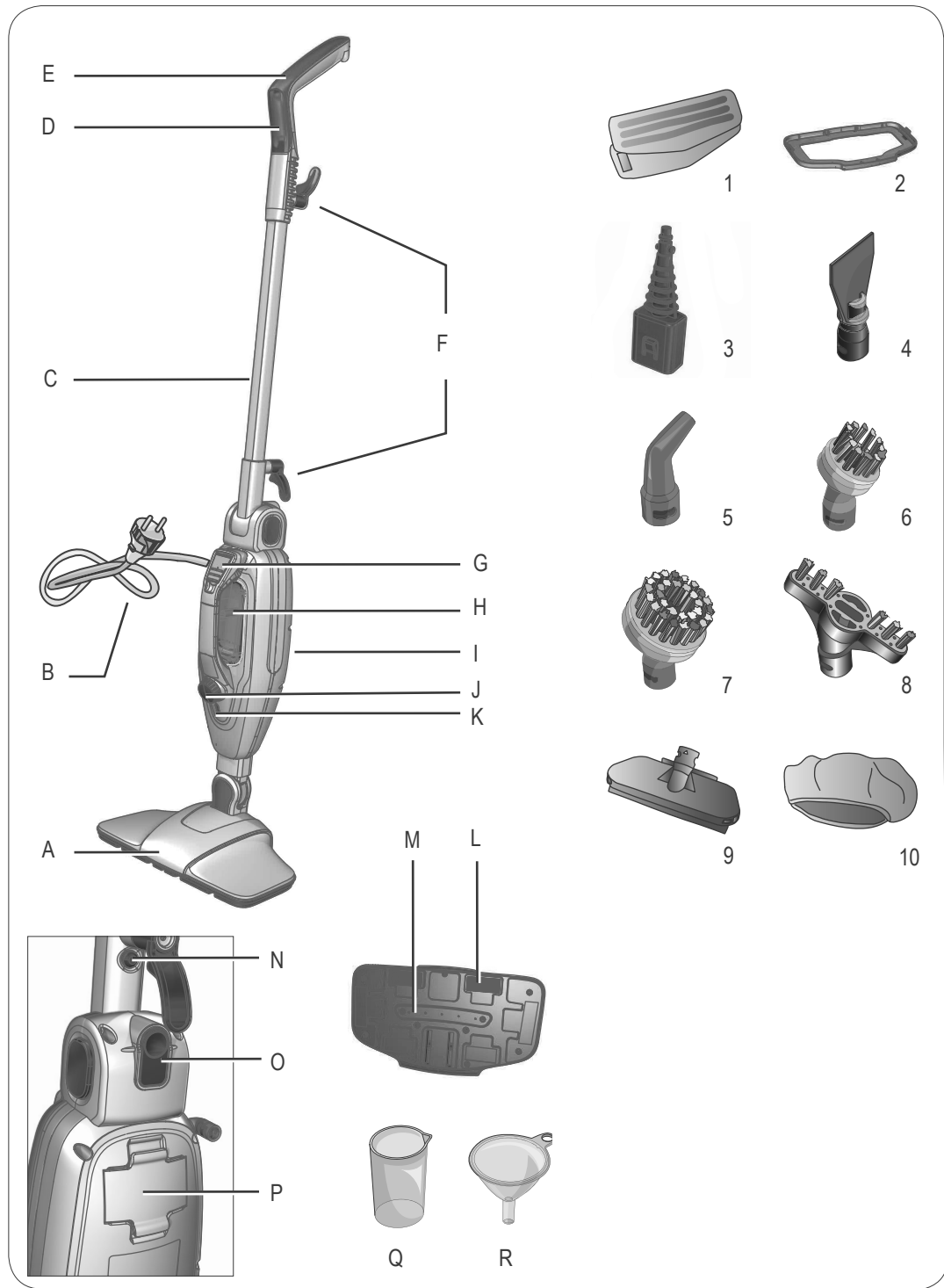

Fig. 1

DESCRIPTION OF THE APPLIANCE

- | | |
|----------------------|-----------------------------------|
| A Steam head | J Steam adjustment knob |
| B Power cord + plug | K Power-on indicator |
| C Rod | L Washable cloth velcro couplings |
| D Grip | M Steam spouts |
| E Handle | N Rod release button |
| F Cord storage hooks | O Folding rod activation button |
| G Water tank cap | P Filter |
| H Water tank | Q Measuring cup |
| I Appliance body | R Funnel |

DESCRIPTION OF THE ACCESSORIES

- 1 Washable cloths
- 2 Accessory for carpets
- 3 Extension/nozzle
- 4 Spatula
- 5 Tilted attachment nozzle
- 6 Small round brush
- 7 Round large brush
- 8 Brush for grout joints
- 9 Squeegee/accessory for fabrics
- 10 Cloth for fabrics

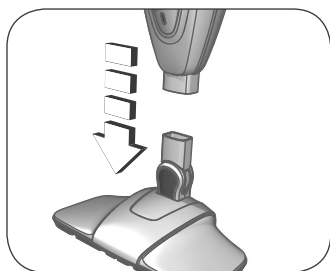

Fig. 2

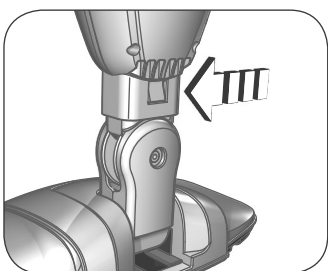

Fig. 3

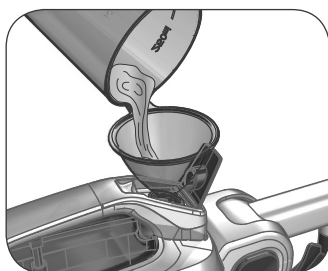

Fig. 4

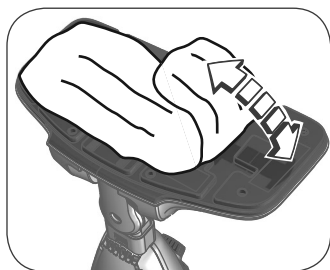

Fig. 5

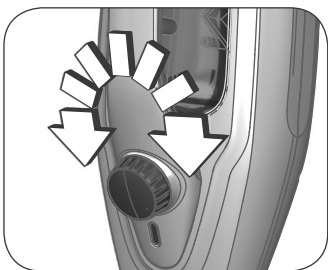

Fig. 6

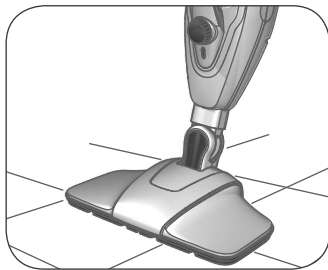

Fig. 7

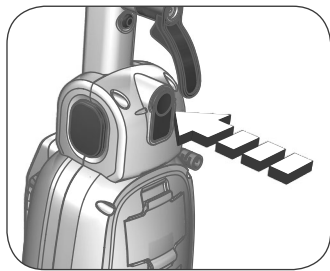

Fig. 8

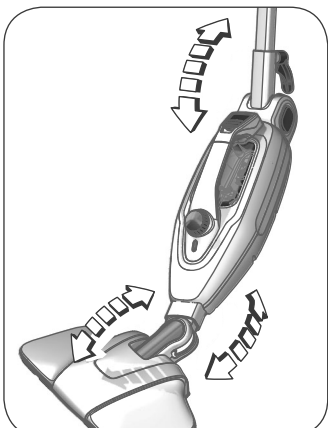

Fig. 9

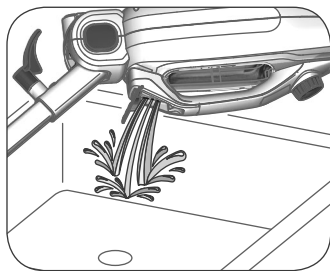

Fig. 10

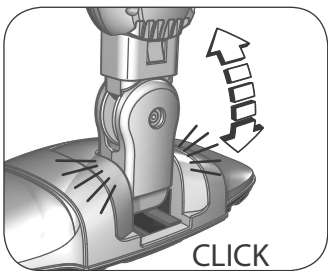

Fig. 11

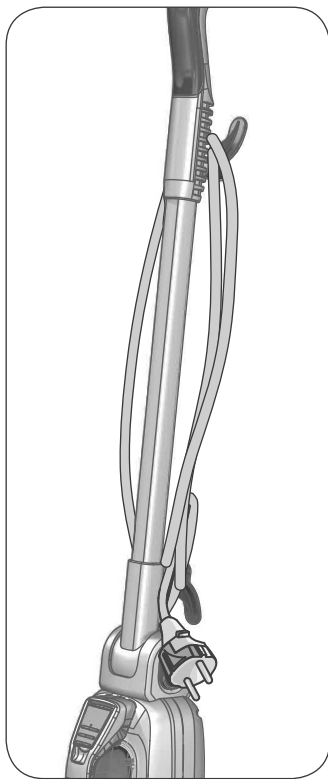

Fig. 12

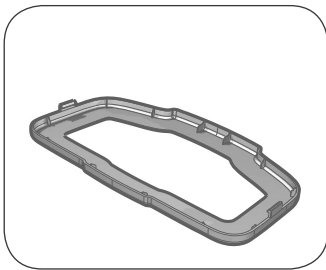

Fig. 13

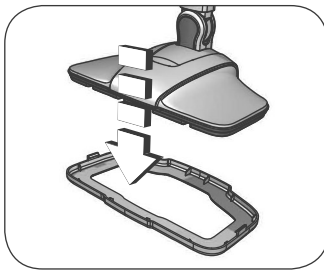

Fig. 14

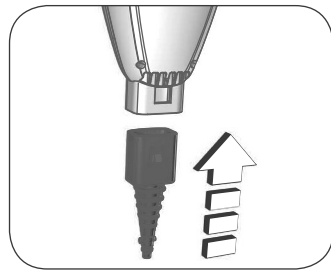

Fig. 15

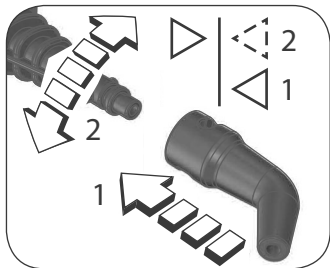

Fig. 16

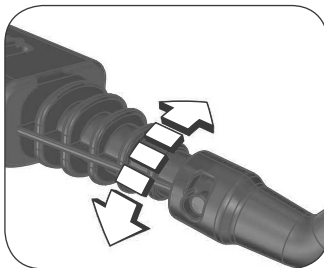

Fig. 17

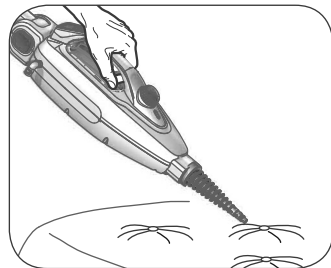

Fig. 18

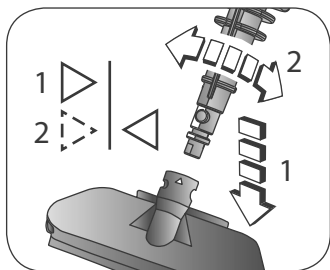

Fig. 19

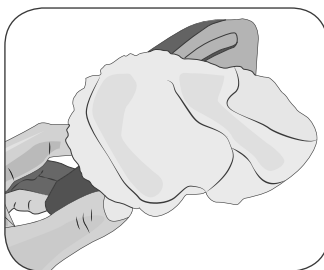

Fig. 20

WITH REGARD TO THIS MANUAL

This appliance is made in conformity with appropriate European Regulations in force, to protect the user wherever possible from potential hazards. Even if you are familiar with this type of appliance, carefully read this manual before use. Only use this appliance for the purpose it is designed for in order to prevent accidents and damage. Keep this manual close by for future consultation. If you should decide to give this appliance to other people, remember to also include these instructions. The information provided in this manual is marked with the following symbols indicating:



Danger to children



Danger of burns



Risk of electric shock



Warning – may damage appliance



Danger of damage originating from other causes

INTENDED USE

The appliance can be used to mop and sanitize thoroughly different types of surfaces, such as marble, ceramic, stone, tiles, parquet, and hardwood floors provided that they are treated and waterproof. The cloth absorbs excess moisture. The appliance can be used also to clean, together with the provided accessories, the surfaces where the most stubborn dirt has settled and to treat fabrics, such as carpets, curtains and other soft surfaces.

The appliances uses the active power of steam without the help of detergents and soaps.

This appliance is designed only and solely for private use, and is therefore to be considered unsuitable for industrial or professional purposes. Any other use of the appliance is not intended by the Manufacturer who does not accept any responsibility for damages of any kind caused by improper use of the appliance itself. Improper use also results in any form of warranty being forfeited.

SAFETY WARNINGS

READ THESE INSTRUCTIONS CAREFULLY.

- This appliance is designed only for private use, and is therefore to be considered unsuitable for commercial or industrial purposes.
- We decline any responsibility resulting from misuse or any use other than those covered in this booklet.
- We suggest you keep the original box and packaging, as our free-of-charge service does not cover any damage resulting from inadequate packaging of the product when this is sent back to an Authorised Service Centre.
- Using accessories not recommended or not supplied by the manufacturer of the appliance may entail risks of fire, electric shock or injuries to people.



Danger of children

- This appliance can be used by children older than 8 years and persons who have reduced physical sensory or mental capabilities, or lack of experience and

knowledge, only if they are monitored by a responsible person or if they have received and understood the instructions and dangers which may arise during the appliance use.

- Children shall not play with the appliance or its components.
- Always keep the appliance and the power cord out of the reach of children when the appliance is connected to the power supply and also during the cooling phase after use.
- Cleaning and user maintenance shall not be made by children unless they are aged from 8 years and above and supervised.
- Position the appliance so that children cannot reach the hot parts.
- Do not leave the packaging near children because it is potentially dangerous.
- Do not leave the power cord in a place where it could be grasped by a child.
- In the event that this appliance is to be disposed of, it is suggested that the power cord is cut off. It is also recommended that all potentially dangerous components including the power cord are rendered harmless to prevent personal injury. Do not let children play with the appliance or its components.



Danger of burns

- Do not touch the metal parts, hot water or steam when the appliance is operational and in the minutes following its shut-down since this might cause burns.
-
- Never direct the steam jet towards body parts, pets, plants or towards delicate objects.
 - Never direct the steam jet towards equipment containing electrical components (for example inside ovens).
 - Before removing the cloth from the steam head, unplug the power cord from the power outlet. Wait at least 5 minutes until the steam head and the cloth are well cooled.
 - When the appliance is not in use, unplug it from the power outlet and let it cool down before inserting or removing individual parts or before carrying out cleaning operations.



Risk of electric shock

- Before connecting the appliance to the power supply, check that the voltage shown on the rating plate matches the local voltage supply.
- Always connect the appliance to an earthed socket.
- The use of extensions not approved by the manufacturer can result in damage to property and personal injury.
- Do not use extension cords or power outlets featuring an inadequate current load capacity.
- Do not immerse the appliance in water or other liquids.
- Do not use the appliance with wet hands or barefoot.

- Do not use the appliance if the power cord or the plug are damaged, or if the appliance is faulty. To prevent any accident, all repairs, including the replacement of the power cord, must be carried out by an Authorised Service Centre or by suitably qualified personnel.
- The appliance must not be used if it has been dropped, if there are visible signs of damage or leaks of water.
- Do not connect any other high-power equipment (such as stoves, irons, radiators) to the same power outlet. Danger of electric overload.
- Do not set the hot parts of the appliance on the power cord.
- Never pull the power cord or the appliance to disconnect the plug from the power socket.
- Do not leave the power cord against sharp parts.
- Make sure that the power cord does not come into contact with hot surfaces.
- In case of storm, unplug the power cord from the power outlet.
- Never wrap the cord around your hand when the appliance is connected to the mains.



Warning – may damage appliance

- Before using the appliance, make sure that the objects, the surfaces and the fabrics to be treated are resistant to or compatible with the steam high temperature. In case of treated cotto tile or wood surfaces, delicate fabrics (such as leather, silk or velvet) or synthetic fabrics, try to use the appliance before on a hidden area or a sample or ask for information about the correct cleaning methods to the manufacturer.
- Do not use the squeegee if the surface to be treated is cold. Any thermal shock could cause it to break. In seasons with particularly low temperatures, pre-heat the glass using a jet of steam over the entire surface to be treated from a distance of about 40 cm.
- Do not use the appliance on wax-treated surfaces. The wax will be removed by the heat and steam action.
- Do not use the appliance on permeable surfaces or made of untreated wood.
- Do not leave the appliance turned on for a long time on any type of wooden surface: the wood could swell.
- On the first use or after a long period of non-use, direct the steam jet into a container to remove the excess water.
- Do not use the steam head on glass surfaces.
- Do not use the appliance without the cloth or if the cloth is worn-out. Danger of damage and scratch to surfaces.
- Always unwind the power cord before use.
- Do not use the appliance without water, since the pump might get damaged. Check the water level in the tank on a regular basis.

- Do not use sparkling (carbonated) water. If the tap water is particularly hard (higher than 20°F), use a mixture of 50% tap water and 50% demineralized water.
- Never use solvents which may damage the plastic parts.
- Do not pour into the tank descaling agents, additives or other perfuming substances. Penalty the end of warranty.
- Before storing the appliance, always unplug the power cord from the power outlet. Wait until the appliance has cooled down and completely empty the water tank.
- Do not leave the appliance exposed to weathering (such as rain or sun).
- Do not use the appliance outdoors.
- Any modification made on this product that is not explicitly authorised by the manufacturer may lead to the forfeiture of its safe use and may void the warranty.
- Do not disassemble the appliance. There are no internal parts to use or clean.



Danger of damage originating from other causes

- Do not use the appliance in the presence of vapours given off by oil-based paints, solvents or waterproofing agents, or by flammable dusts or other toxic or explosive vapours.
- Be particularly careful when using the appliance with the aid of a ladder.
- Before filling the water tank, unplug the appliance from the power socket.
- Turn on the appliance only when it is in working position.
- Never leave the appliance unattended when it is connected to the power supply.
- If the appliance is left unused, also for a short period of time, turn it off and always unplug the power cord from the power socket.
- Store the appliance indoors in a cool and dry place.

• SAVE THESE INSTRUCTIONS FOR FUTURE REFERENCE.

Identification data

On the label under the base of the appliance are reported the following identifications data of the appliance:

- manufacturer and CE marking
- model (Mod.)
- serial number (SN)
- electrical supply voltage (V) and frequency (Hz)
- electrical power consumption (W)
- assistance toll-free phone number

When ordering at Authorized Service Centers, indicate the model and serial number.

ASSEMBLING THE APPLIANCE

Remove the packaging materials from the appliance.

Assemble the rod (C) on the appliance body (I).

Install the appliance body (I) on the steam head (A) (Fig. 2). The appliance is properly assembled when you hear a “click” sound (Fig. 3).

INSTRUCTIONS FOR USE

- 1 Totally unwind the power cord.
- 2 Open the water tank cap (G).
- 3 Use the provided measuring cup (Q) and funnel (R) to fill the water tank (H) with 350 ml of fresh still water, corresponding to one and a half measuring cup (Fig. 4).



Warning!

Fill the tank sufficiently in order to avoid dry-running.

NEVER fill the tank beyond 350 ml.

If the tap water is particularly hard (higher than 20°F), use a mixture of 50% tap water and 50% demineralized water. To extend the life of the product we recommend, only use demineralised water.

- 4 Close the water tank cap.
- 5 Fasten the washable cloth (1) to the velcro couplings (L) located under the steam head (Fig. 5).



Warning!

Do not use the appliance without the cloth or if the cloth is worn-out.

Before using the appliance, make sure that the objects, the surfaces and the fabrics to be treated are resistant to or compatible with the steam high temperature. In case of treated cotto tile or wood surfaces, delicate fabrics (such as leather, silk or velvet) or synthetic fabrics, try to use the appliance before on a hidden area or a sample or ask for information about the correct cleaning methods to the manufacturer.

- 6 Connect the plug into the socket. The power-on indicator (K) will automatically light up, indicating that the appliance is turned on and that the boiler starts heating. After a few seconds steam will start to come out from the steam head.
- 7 Turn the steam adjustment knob (J) according to the desired amount of steam (Fig. 6).

For the most delicate surfaces, such as parquet, wood or laminate, adjust the steam emission to a lower level. For the surfaces requiring a deep cleaning such as marble, tiles or stone, adjust the steam emission to a higher level.

Before using the appliance, make sure that the floor is free from any dust residue.

- 8 Pass the appliance on the floor (Fig. 7).



Warning!

Use the appliance in well-lit rooms.

If you leave the appliance still on the floor during operation, a whitish ring may appear. The ring can be removed using a common descaling product or with a few drops of vinegar.

To make it easier to clean hard-to-reach areas, such as under furniture, the appliance can be used horizontally.

9 Press the folding rod activation button (O) (Fig. 8).

10 Tilt the rod and pass the appliance on the floor (Fig. 9).

Hold the steam head (A) steady with one foot and manually put the rod (C) in vertical position until you hear a “click” sound to go back to using the appliance vertically.

The appliance constantly produces steam, until consuming all the water in the tank. A full tank corresponds to about 15-18 minutes of continuous steam. In the event the water tank is empty, the appliance will emit a vibration and a loud noise. The power-on light (K) will start to flash. In this case, you must refill the water tank to avoid burning the appliance pump.



Warning!

Do not turn the steam head upside-down during use to remove the cloth. Danger of burns.

Before removing the cloth from the steam head, unplug the power cord from the power outlet.

Wait at least 5 minutes until the steam head and the cloth are well cooled.

You can remove the cloth during use to rinse it.

- Turn the steam adjustment knob (J) to “0”.
- Unplug the power cord from the power socket.
- Unfasten the washable cloth (1) from the velcro couplings (L) located under the steam head (Fig. 5).

Filling the boiler during use

The water tank can be filled during use in case it runs out of water.

- 1 Turn the steam adjustment knob (J) to “0”.
- 2 Unplug the power cord from the power socket.
- 3 Open the water tank cap (G).
- 4 Use the provided measuring cup (Q) and funnel (R) to fill the water tank (H) with 350 ml of fresh still water, corresponding to one and a half measuring cup (Fig. 4).
- 5 Close the water tank cap.

After use

- 1 Turn the steam adjustment knob (J) to “0”.
- 2 Unplug the power cord from the power socket.
- 3 Empty the water tank completely so as to prevent the water from stagnating, which may form lime deposit (Fig. 10).

To remove any water residue from the tank, follow the steps below:

- Connect the plug into the socket. The power-on indicator (K) will automatically light up.
- Turn the steam adjustment knob (J) clockwise.
- Deliver steam until consuming all the water in the tank.



Warning!

Before removing the cloth from the steam head, unplug the power cord from the power outlet.

Wait at least 5 minutes until the steam head and the cloth are well cooled.

- 4 Unfasten the washable cloth (1) from the velcro couplings (L) located under the steam head (Fig. 5).
- 5 Tilt the appliance forward until you hear a “click” sound to lock the junction on the steam head (Fig. 11).

- 6 Wind up the power cord on the two cord storage hooks (F) (Fig. 12).
- 7 Leave the unit at rest, in vertical position.



Warning!

Lock the junction on the steam head until the appliance is steady in vertical position.

- 8 Put the appliance in a dry place and out of the reach of children.

USING THE ACCESSORIES

To make the use of the accessories easier, press the rod release button (N) and remove the rod from the body appliance. In doing so, the appliance can be used easily in narrow areas thanks to the handle located on the body appliance.



Warning!

Unplug the power cord from the power outlet and wait until the appliance has completely cooled down before installing or removing the accessories.

Accessory for carpets (2)



This accessory is especially useful for cleaning carpets and similar soft surfaces.

- 1 Place the accessory for carpets on the steam head without fastening the cloth, with the flat part touching the floor (Fig. 13).
- 2 Gently push the steam head to insert it into the accessory for carpets (Fig. 14).
- 3 After use, push the accessory for carpets using your foot to remove it.



Warning!

Do not use the accessory for carpets on hard surfaces.

Extension/nozzle (3) and other accessories

In order to use the smaller accessories, remove the steam head (A) and employ the extension/nozzle (3).



- 1 Slightly apply pressure to pull out the steam head from the body appliance.
- 2 Install the extension/nozzle (3) on the joint of the body appliance (I). The appliance is properly assembled when you hear a "click" sound (Fig. 15).
- 3 Insert one of the accessories on the end side of the extension/nozzle (Fig. 16). Smaller accessories can be installed on the extension/nozzle only in one direction.
- 4 Turn the accessory until the arrow symbol shown on the accessory is aligned with the arrow symbol shown on the extension/nozzle (Fig. 17).
- 5 Pass the appliance in the desired areas (Fig. 18).

The appliance is equipped with various accessories to be used together with the extension/nozzle:



Extension/nozzle (3)

This accessory helps with cleaning thoroughly all the surfaces where the most stubborn dirt settles, such as sinks, gas stoves, hoods and all those hard-to-reach areas.

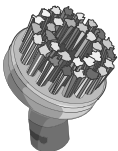
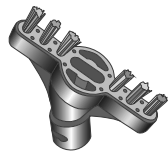
	Spatula (4)	This accessory is ideal to scrape and remove dirt and grease residues from surfaces.
	Tilted attachment nozzle (5)	This accessory helps with sanitizing and cleaning easily and quickly the hard-to-reach areas, such as radiators, shutters and bathroom fixtures.
	Small round brush (6)	These accessories help with removing the most stubborn deposits, such as those which build up on stoves or on cooker grills. These accessories can be used also to clean and remove lime-scale residues from bathroom fixtures, sinks, showers or bathtubs.
	Large round brush (7)	
	Brush for grout joints (8)	This accessory is especially useful to clean the spaces between tiles, both smooth and rough.

Squeegee/accessory for fabrics (9) and cloth for fabrics (10)

- 1 Slightly apply pressure to pull out the steam head from the body appliance.
- 2 Install the extension/nozzle (3) on the joint of the body appliance (1).
- 3 Insert the squeegee/accessory for fabrics (9) on the end side of the extension/nozzle. The appliance is properly assembled when you hear a “click” sound (Fig. 19).

	Squeegee/accessory for fabrics (9)	This accessory is particularly useful for cleaning windows, mirrors, shower boxes.
--	------------------------------------	--

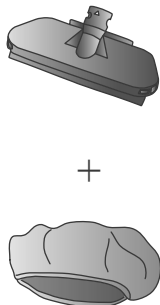
	<p>Squeegee/accessory for fabrics (9) + cloth for fabrics (10)</p>	<p>This accessory is particularly useful to remove wrinkles from sofas, tablecloths and clothes.</p>
---	--	--

Stick the cloth for fabrics (10) around the squeegee/accessory for fabrics (9) to use the squeegee as an accessory for fabrics (Fig. 20).

CLEANING AND MAINTENANCE



Warning!

Before carrying out any cleaning operation, unplug the power cord from the power outlet and wait until the appliance has completely cooled down.



Warning!

Never immerse the appliance in water or other liquids.



Warning!

Do not use abrasive detergents.

Do not pour into the tank descaling agents, additives or other perfuming substances. Penalty the end of warranty.

Cleaning the appliance

After each use, unplug the power cord from the power outlet and completely empty the water tank so as to avoid that water stagnation may favour scale deposits formation.

Clean plastic parts with a damp, non-abrasive cloth and dry them with a dry cloth.

Follow the instructions on the label to clean the washable cloth.

The filter (P) helps with removing impurities in the water. It is recommended to replace it once a year, according to the frequency of use of the appliance.

Wash the filter under running water.

After having washed or replaced it, make sure that the filter (P) has been properly installed into its seat. Otherwise, the appliance is not delivering steam.

Regular cleaning maintains the appliance efficient for a longer period of time, significantly reducing possible limescale formation.

Limestone cleaning

Damage caused by limescale is not covered by warranty.

Carry out the limescale cleaning operation once every 3 months. Carry out the limescale cleaning operation once a month if the water used is very hard and calcareous.

In case of appliance malfunction due to the frequent use of hard and calcareous water, carry out the limescale cleaning procedure.



Warning!

Carry out the scale cleaning operation in a ventilated room.

When cleaning the limescale, apply steam to a resistant surface or on a washable cloth.

Do not inhale the vapours emitted during the limescale cleaning process.

- 1 Unplug the power cord from the power socket.
- 2 Open the water tank cap (G).
- 3 Fill the tank with a mixture of 1/3 white vinegar and 2/3 of fresh, clean water.
- 4 Place the appliance so that the steam is not dispensed on any object or surface.
- 5 Connect the plug into the socket. The power-on indicator (K) will automatically light up, indicating that the appliance is turned on and that the boiler starts heating.
- 6 Leave the appliance into operation for at least one minute.
- 7 Turn the steam adjustment knob (J) to "0".
- 8 Leave off the appliance for a minute.

Repeat until the release of steam is noticed.

Let the all the steam come out until there is no more solution in the tank. If necessary, repeat the operation.

- 9 Unplug the power cord from the power socket.
- 10 Fill the tank with fresh, clean water. Rinse and empty.
- 11 Use the provided measuring cup (Q) and funnel (R) to fill the water tank (H) with 350 ml of fresh still water, corresponding to one and a half measuring cup (Fig. 4).
- 12 Connect the plug into the socket. The power-on indicator (K) will automatically light up.
- 13 Turn the steam adjustment knob (J) clockwise.
- 14 Deliver steam until consuming all the water in the tank.

If necessary, repeat the operation until no more limescale residue can be seen from the steam ducts.

Immerse the accessories in a solution with water and vinegar to remove any limescale residue.

Fit the accessory on the appliance and dispense steam.

TROUBLESHOOTING



Warning!

Immediately switch off the appliance in case of operational faults and electrical failures. Unplug the power cord from the power socket. Wait for the appliance to cool down.

PROBLEMS	CAUSES	REMEDIES
Power indicator light off.	Not plugged in.	Check that the plug has been properly inserted into the power socket. Check that there is current on the power supply line. Try to connect the plug to another power socket. If the problem continues, contact an Authorised Service Centre.
No steam comes out of the nozzles.	The appliance is not ready for use.	Wait a few seconds to allow the steam preparation.
	Water shortage in tank.	Use the provided measuring cup (Q) and funnel (R) to fill the water tank (H) with 350 ml of fresh still water, corresponding to one and a half measuring cup (Fig. 4).
	The steam outlet holes may be clogged with limescale.	Clean the limestone. If the problem continues, contact an Authorised Service Centre.
	The filter (P) is not properly installed into its seat.	Make sure that the filter is properly installed into its seat. If the problem continues, contact an Authorised Service Centre.
Unexpected increase of the noise level of the pump.	Water shortage in tank.	Turn off the appliance. Use the provided measuring cup (Q) and funnel (R) to fill the water tank (H) with 350 ml of fresh still water, corresponding to one and a half measuring cup (Fig. 4).
Water leakage from the nozzles.	Possible condensation residue in the steam duct.	Turn the steam dispensing knob until you see the steam coming out. Place a soft cloth under the steam head to avoid wetting the floor. If water continues to come out, turn off the appliance. Wait at least 5 minutes until the steam head and the cloth are well cooled. Try again. If the problem continues, contact an Authorised Service Centre.

IMPORTANT INFORMATION FOR CORRECT DISPOSAL OF THE PRODUCT IN ACCORDANCE WITH EC DIRECTIVE 2021/19/UE



At the end of its working life, the product must be not disposed of as urban waste.

It must be taken to a special local authority differentiated waste collection centre or to a dealer providing this service.

Disposing of a household appliance separately avoids possible negative consequences for the environment and health deriving from inappropriate disposal and enables the constituent materials to be recovered to obtain significant savings in energy and resources. As a reminder of the need to dispose of household appliances separately, the product is marked with a crossed-out wheeled dustbin.

WARRANTY

PLEASE AFFIX YOUR RECEIPT/PROOF OF PURCHASE HERE.

IN THE EVENT OF A CLAIM UNDER THIS WARRANTY THE AFORESAID RECEIPT/PROOF OF PURCHASE MUST BE PRODUCED TOGETHER WITH THIS WARRANTY.

Mode number	(Lot number:)
Product name	
Date of purchase	
Place of purchase	

1. The party selling the product ("the seller") to the original purchaser of this product ("the customer") hereby warrants that this product will be of good quality and, in good working order and, free of defects and suitable for its intended purpose under normal household use, for a period of 1 (one) year from the date of purchase ("warranty period") of this product.
2. In the event that the warranty period has not lapsed and the product is not of a good quality, or in good working order or, is defective or is not suitable for its intended purpose under normal household use, the customer may, subject to paragraph 3 below, return the product to the seller and have the following options available:
 - 2.1 Within the first 6 (six) months of the warranty: to receive a refund of the actual price paid or exchange the product for the same or similar product of the same purchased value;
 - 2.2 Within the second 6 (six) months of the warranty: to have the product exchanged for the same or similar product of the same purchased value.
3. The seller will not replace the product or refund the customer in terms of this warranty if the product:
 - 3.1 has been altered contrary to the instructions provided in the product manual;
 - 3.2 has been misused, abused or tampered with;
 - 3.3 is defective or not in working order due to ordinary wear and tear;
 - 3.4 is damaged resulting from the customer's gross negligence, recklessness, malicious behavior or criminal conduct;
 - 3.5 has been utilised for commercial use.
4. This warranty applies only to the product that has been purchased from the seller and not to any expendables attached to or installed on the product by the customer.

5. Any claim in terms of this warranty must be supported by the original proof of purchase.
6. Note that the exchange item will only carry the balance of the warranty period as from the original date of purchase.
7. Spares:

Selected spares can be purchased from:

ServiceTec
10 Saddle Drive
Woodmead Office Park
Woodmead

Email: spares.za@delonghigroup.com
Tel: +27 11 474 0153