

Ariete



Vacuum cleaner



Ariete

De' Longhi Appliances Srl
Divisione Commerciale Ariete
Via San Quirico, 300
50013 Campi Bisenzio (FI)
E-Mail: info@ariete.net
Internet: www.ariete.net

CE

2757

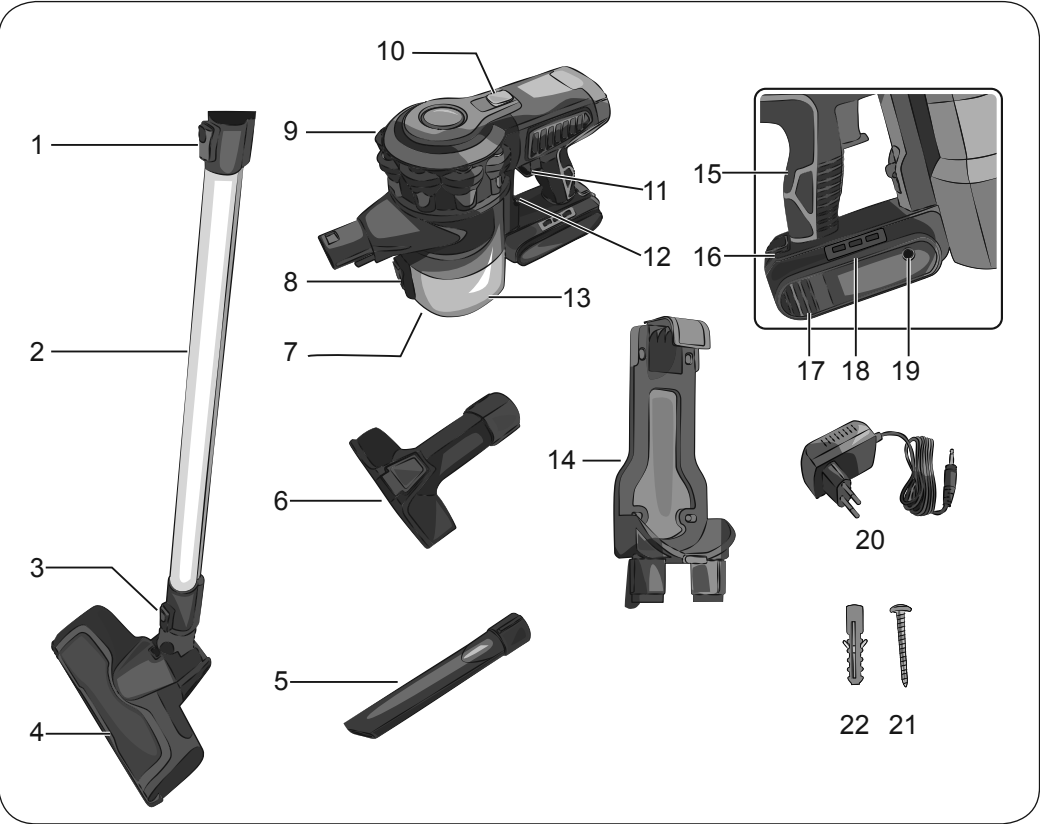

Fig. A

DESCRIPTION OF THE APPLIANCE

- | | |
|--|---|
| 1 Motor body release button | 12 Unlocking button of the dust collector |
| 2 Tube | 13 Dust collector |
| 3 Brush release button | 14 Wall bracket |
| 4 Motorized brush with bristles roller | 15 Handle |
| 5 Nozzle | 16 Battery release button |
| 6 Fabric brush | 17 Removable battery |
| 7 Dust collector door | 18 Charge indicator |
| 8 Dust collector door release button | 19 Charger access |
| 9 Motor body | 20 Charger |
| 10 Speed control button | 21 Screws (x 2) |
| 11 ON/OFF button | 22 Wall plugs (x 2) |

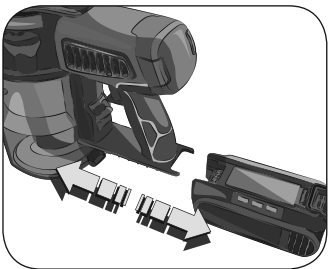

Fig. B

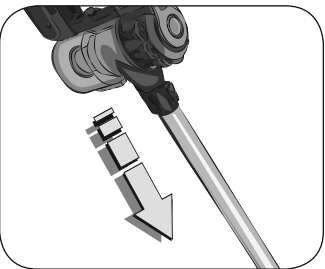

Fig. C

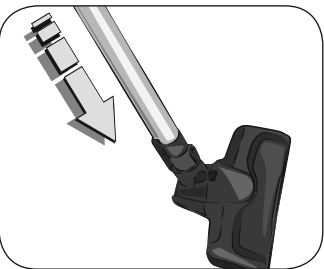

Fig. D

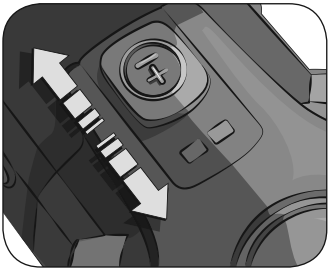

Fig. E

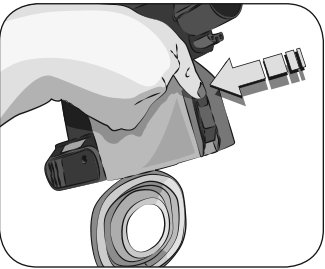

Fig. F



Fig. G

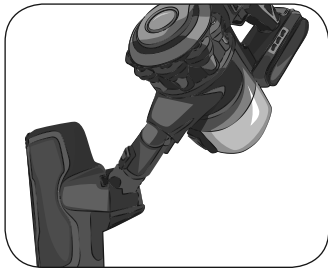

Fig. H

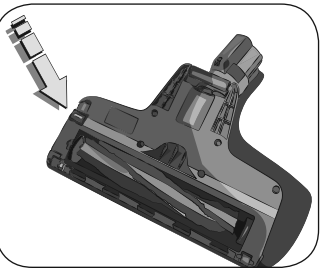

Fig. I

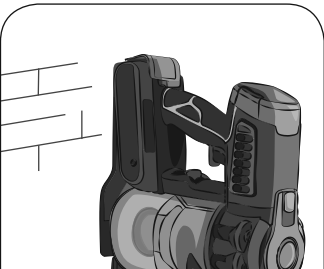

Fig. L

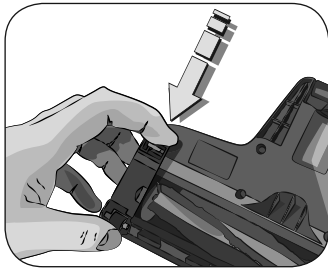

Fig. J

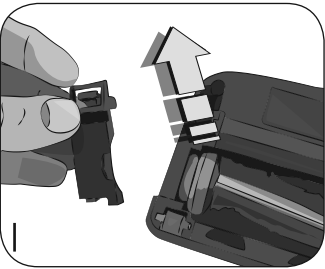

Fig. K

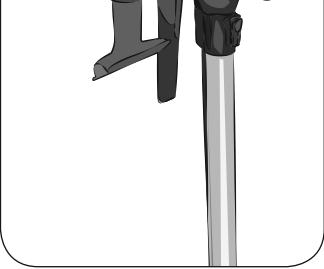

Fig. O

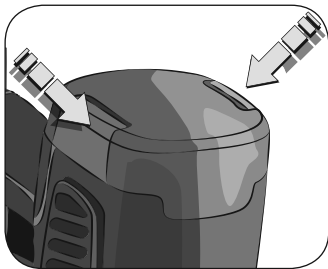

Fig. M

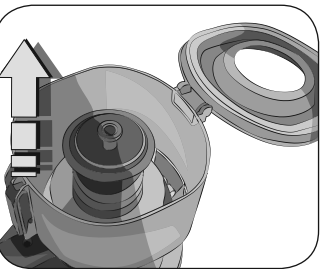

Fig. N

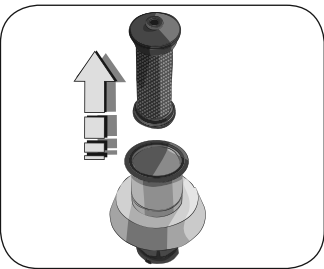

Fig. O

WITH REGARD TO THIS MANUAL

This appliance is made in conformity with appropriate European Regulations in force, to protect the user wherever possible from potential hazards. Even if you are familiar with this type of appliance, carefully read this manual before use. Only use this appliance for the purpose it is designed for in order to prevent accidents and damage. Keep this manual close by for future consultation. If you should decide to give this appliance to other people, remember to also include these instructions.

The information provided in this manual is marked with the following symbols indicating:



Danger for children



Danger due to electricity



Danger of damage originating from other causes



Warning of burns



Warning – material damage

INTENDED USE

This appliance is designed only and solely for private use, and is therefore to be considered unsuitable for industrial or professional purposes. You can use the appliance to remove the dust for the surfaces. Do not collect hot ashes, liquids, big glass pieces, rubble, pointy or sharp objects. No other use of the appliance is contemplated by the manufacturer, which is exempt from any liability for all types of damages caused by improper use of the appliance. Improper use also results in any form of warranty being forfeited.

IMPORTANT SAFEGUARDS

READ THESE INSTRUCTIONS CAREFULLY.

- In the event of a leaking battery, do not use the appliance and take it to the nearest authorised Service Centre to replace batteries.
- The appliance is **ONLY INTENDED FOR DOMESTIC USE** and shall not be used for commercial or industrial purposes.
- Do not collect hot ashes, liquids, big glass pieces, rubble, pointy or sharp objects.
- Do not use the appliance without the filters or if the filters are damaged.
- We decline any responsibility resulting from misuse or any use other than those covered in this booklet.
- We suggest you keep the original box and packaging, as our free-of-charge service does not cover any damage resulting from inadequate packaging of the product when this is sent back to an Authorised Service Centre.



Danger for children

- This appliance can be used by children aged from 8 years and above and persons with reduced physical, sensory or mental capabilities or lack of experience and knowledge if they have been given supervision or instruction concerning use of the appliance in a safe way and understand the hazards involved.
- Cleaning and user maintenance shall not be made by children unless they are aged from 8 years and above and supervised.
- Children must be supervised at all times to ensure they do not play with the appliance.

- Do not leave the packaging near children because it is potentially dangerous.
- In the event that this appliance is to be disposed of, it is suggested that the power cord is cut off. It is also recommended that all potentially dangerous components including the power cord are rendered harmless to prevent personal injury. Do not let children play with the appliance or its components.



Danger due to electricity

- Always keep the appliance and the power cord out of the reach of children under the age of 8 years.
- Do not let the power cord of the charger hang in a place where it could be grasped by a child.
- Before plugging the appliance into the mains socket, ensure that the voltage shown on the rating plate placed on the charger matches the local voltage supply.
- The use of extensions not approved by the manufacturer can result in damage to property and personal injury.
- Never put live parts into contact with water: It can cause a short circuit!
- The appliance must not be power supplied by external timers or separate remote-controlled systems.
- During the charge choose an adequately illuminated and clean room with easily accessible power outlet.
- Unplug the appliance when it is not being used and before all maintenance and cleaning operations.
- Do not immerse the appliance in water or other liquids.
- Make sure that your hands are dry before using or adjusting the switches on the appliance, or before touching the plug and power connections.



Danger of damage originating from other causes

- Never leave the appliance unattended when it is connected to the power supply.
- The appliance is not to be used if it has been dropped, if there are visible sign of damage. Do not use the appliance if the power cord or the plug are damaged, or if the appliance is faulty. To prevent any accident, all repairs, including the replacement of the power cord, must be carried out by an Authorised Service Centre or by suitably qualified personnel.
- Do not insert any objects into the openings of the appliance and avoid that any objects obstruct the air flow.
- Keep the openings free of dust, lint, hair, etc.
- Do not use the appliance without the filter.
- Do not collect very hot objects or objects that are smoking or burning such as cigarettes, matches or ashes that are still hot.
- Do not pick up flammable or combustible material (volatile liquids, such as gasoline, kerosene, etc) nor use the appliance in the presence of water.

- Do not use the appliance in closed environments and in the presence of fumes given off by oil-based paints, solvents or waterproofing agents, or by flammable power or other toxic or explosive fumes.
- Do not pick up toxic material (chlorine bleach, ammonia, drain cleaner, acids, etc).



Warning – material damage

- The appliance must be left at rest on a stable surface.
- If the appliance is turned upside down the dust and the dirt can fall out. Make sure that the appliance won't be turned upside down during use.
- Before cleaning shiny surfaces, as parquet or linoleum, check that the brush and its bristles are free from materials that could damage the floor.
- To avoid damaging the floor. Do not insist with the brush on the same area on the delicate surfaces.
- On the waxed surfaces the brush movement can create rings. If this happens clean with a damp cloth, polish with wax and wait for it to dry.
- Do not place the appliance or the charger on very hot surfaces or near open flames to prevent the body from being damaged.
- The cable of the charger must not touch the hot parts of the appliance.
- Do not use the appliance outdoors.
- Do not put the appliance or the charger near or over hot electric stoves or burners or near a microwave oven.
- Do not leave the appliance and the charger exposed to weathering (rain, sun, etc).

• SAVE THESE INSTRUCTIONS FOR FUTURE REFERENCE

Identification data

On the label under the base of the appliance are reported the following identifications data of the appliance:

- manufacturer and CE marking
- model (Mod.)
- serial number (SN)
- electrical supply voltage (V) and frequency (Hz)
- electrical power consumption (W)
- assistance toll-free phone number

When ordering at Authorized Service Centers, indicate the model and serial number.

HOW TO CHARGE THE BATTERY

Before connecting the charger to the electric grid check that the voltage reported on the label under the charger corresponds to that of the local grid.

This appliance can be charged only with the provided charger.



Warning!

Before using the appliance for the first time charge it completely.

The battery must be recharged with the battery disconnected from the body of the appliance.

Remove the packaging materials from inside and outside of the appliance. Remove all the stickers. Place the motor body on an horizontal surface.

Press the release button (16) to remove the battery from the body of the appliance (Fig. B).

Plug the charger cable into the input (19) on the battery (17).

Plug in the charger.

The charge indicator (18) turns on in blue colour and blinks. When the charge indicator comes to a steady light, the battery is completely charged.

Disconnect the charger from the socket. Unplug the charger from the battery.

Place the battery into the body of the appliance (Fig. B) and check it is correctly locked into place.

INSTRUCTIONS FOR USE

Grab the motor body (9) by the handle (15).

Assemble the tube (2) on the motor body until you hear the click of the release button of the motor body (1) (Fig. C).

Assemble the tube on the brush (4) until you hear the click of the release button of the brush (3) (Fig. D).



Warning!

Appliance fall danger. The appliance, once that it is assembled, cannot stand on the brush in vertical position.

Press the ON/OFF button (11).

Press the speed control button (10) to select the desired speed (Fig. E). Two speeds are available: when the appliance is turned on, the speed is set to the minimum level. To switch to maximum speed, press the speed control button (10).



Warning!

Switch the appliance off immediately in the event that something gets trapped inside the brush, such as a piece of cloth, the fringes of a carpet, etc. Before turning on the appliance again, remove anything that caused the obstruction of the aspiration ducts.

When the dust reaches the MAX lever you need to empty the dust collector (13).

Press the ON/OFF button (11) for 2-3 seconds to turn off the appliance.

Press the release button of the motor body (1). Disassemble the tube.

Take the motor body on a trash bin. Press the release button of the dust collector lid (Fig. F). Empty all the dust (Fig. G).

Close the dust collector lid.

When the last remaining bar of the battery charge indicator starts flashing, the battery is low and shall be recharged.

The appliance can be used with the tube and the brush or with the brush built directly on the motor body (Fig. H).

USING THE ACCESSORIES

The appliance is equipped with various accessories:

- A brush with bristles roller (4), particularly suitable for deep cleaning of rugs, carpets and floors.
- A fabric brush (6), particularly suitable to vacuum dirt from fabrics, sofas, but also horizontal surfaces.

- A crevice nozzle (5), particularly suitable to vacuum in the most hidden corners and narrow slots. The accessories can be built on the tube to reach the highest points.
- The accessories can be built directly on the motor body to clean the windows and the interior of the car.

AFTER USING

Press the ON/OFF button (11) for 2-3 seconds to turn off the appliance. Empty the dust collector.

Disassemble the motor body from the tube.

Put the appliance in a dry place and away from the reach of children.

Alternatively, use the wall mount to fasten the appliance to the wall. The wall bracket (14) is supplied with screws (21) and wall plugs (22).

Place the wall mount against the wall. Adjust the height of the wall mount according to the height of the appliance. Using a pencil, make marks on the wall in line with the three holes of the wall mount. Remove the wall mount. Drill the wall in line with the marks. Insert the supplied wall plugs (22) into the holes.

Place the wall mount on the wall keeping the holes in line with wall plugs. Insert the supplied screws (21) into the holes. Tighten the screws with a screwdriver.

Fasten the appliance to the wall mount (Fig. L).

APPLIANCE CLEANING



Warning!

All cleaning operations described below must be carried out with the appliance off and with the plug disconnected from the outlet. Never immerse the motor body and the charger in water or other liquids. Do not use direct jets of water.



Warning!

Regular maintenance and cleaning preserve and maintain the appliance efficient for a longer period.

The dirt enters the dust collector (13).

The air is then cleaned by a fabric filter. The fabric filter is in turn placed into a primary metal filter. Both filters are located inside the dust collector.

In addition there is a HEPA air outlet filter, located in the upper part of the motor body.



Fabric filter



Metal filter

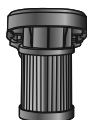

HEPA air outlet filter



Warning!

Never use the appliance without a filter or with a damaged filter. The aspired dust could go inside the appliance and damage the motor.

Appliance body cleaning



Warning!

Clean the fixed parts of the appliance using a non-abrasive damp cloth to prevent damaging the body.

Cleaning the motorized brush with bristles roller

Do not lubricate or grease the rotating parts to avoid that hair and lint gets stuck.

The bristles roller (4) can be removed from its seat to clean the bristles.

Remove the brush (4) from the tube. Press the brush release button (3).

Turn the brush upside-down. There is a locking hook on one side of the brush (Fig. I).

Lift the locking hook (Fig. J).

Lift the bristles roller on the locking hook side (Fig. K). Remove the bristles roller completely.

Clean the bristles from the dirt.

To reassemble the bristles roller in the motorized brush, first insert the side opposite the locking hook.

Lower the roller on the side of the locking hook and insert the motorized brush support vertically into its seat.

Reinsert the locking hook.

HEPA air outlet filter cleaning

The HEPA air outlet filter, located in the upper part of the motor body. It can be removed by pressing the side buttons (Fig. M).

The Hepa filter is a high efficiency filter which removes the impurities and filters particles and bacteria.

Often change the Hepa filter (every 4-6 months) to avoid the circulation of the bacteria in the air.



Warning!

Wash the air outlet filter only with clean water without soap or detergent.

Wait until the air outlet filter is completely dry before inserting it into its seat.

Cleaning the fabric filter and metal filter

Take the motor body on a trash bin. Press the release lever of the dust collector door. Remove all the dust.

Press the release button of the dust collector. Remove the dust collector from the motor body.

Remove the filters from the dust collector (Fig. N-O). The fabric filter can be easily removed from the tank even without opening the dust collector.

Correctly clean the filters by removing dirt or washing them.



Warning!

Only wash the filters with clean water without soap or detergents.

Wait until the filters are completely dry before inserting them into the housing.

Insert the metal filter into the dust collector.

Insert the fabric filter into the metal filter.

Insert the dust collector on the motor body. Press slightly till you will hear the locking click.

SETTING THE MACHINE OUT OF SERVICE

In the case of decommissioning of the appliance, it must be electrically disconnected. Empty the dust collector.

In case of scrapping you will be required to separate the various materials used in the construction of the appliance and dispose of them according to their composition and to the applicable laws in the country of use.

TECHNICAL DATA

Charger data	
Manufacturer	Shenzhen Chanzeho Technology Co., Ltd. 2 Floor Building No.2 & Room 302, Building No.1, No.60 Longteng Road, Longtian Community, Longtian Town, Pingshan District, 518118 Shenzhen, CHINA
Model	CZH013270050EUWP
Input voltage	100-240 V
Input AC frequency	50/60 Hz
Output voltage	27.0 Vdc
Output current	0.5 A
Output power	13.5 W
Average active efficiency	84.0 %
Efficiency at low load (10%)	77.0 %
No-load power consumption	0.09W

Charger data	
Manufacturer	Dongguan City GangQi Electronic Co. Ltd. Privately Operated Industrial District, ShiYong, 532600 Hengli Town, Dongguan Guangdong, CHINA 914419007929512928
Model	GQ18-270050-AG
Input voltage	100-240 V
Input AC frequency	50/60 Hz
Output voltage	27.0 Vdc
Output current	0.5 A
Output power	13.5 W
Average active efficiency	85.48%
Efficiency at low load (10%)	77.54%
No-load power consumption	0.09W

IMPORTANT INFORMATION FOR CORRECT DISPOSAL OF THE PRODUCT IN ACCORDANCE WITH EC DIRECTIVE 2021/19/UE



At the end of its working life, the product must be not disposed of as urban waste.

It must be taken to a special local authority differentiated waste collection centre or to a dealer providing this service.

Disposing of a household appliance separately avoids possible negative consequences for the environment and health deriving from inappropriate disposal and enables the constituent materials to be recovered to obtain significant savings in energy and resources. As a reminder of the need to dispose of household appliances separately, the product is marked with a crossed-out wheeled dustbin.

WARRANTY

PLEASE AFFIX YOUR RECEIPT/PROOF OF PURCHASE HERE.

IN THE EVENT OF A CLAIM UNDER THIS WARRANTY THE AFORESAID RECEIPT/PROOF OF PURCHASE MUST BE PRODUCED TOGETHER WITH THIS WARRANTY.

Mode number	(Lot number:)
Product name	
Date of purchase	
Place of purchase	

1. The party selling the product ("the seller") to the original purchaser of this product ("the customer") hereby warrants that this product will be of good quality and, in good working order and, free of defects and suitable for its intended purpose under normal household use, for a period of 1 (one) year from the date of purchase ("warranty period") of this product.
2. In the event that the warranty period has not lapsed and the product is not of a good quality, or in good working order or, is defective or is not suitable for its intended purpose under normal household use, the customer may, subject to paragraph 3 below, return the product to the seller and have the following options available:
 - 2.1 Within the first 6 (six) months of the warranty: to receive a refund of the actual price paid or exchange the product for the same or similar product of the same purchased value;
 - 2.2 Within the second 6 (six) months of the warranty: to have the product exchanged for the same or similar product of the same purchased value.
3. The seller will not replace the product or refund the customer in terms of this warranty if the product:
 - 3.1 has been altered contrary to the instructions provided in the product manual;
 - 3.2 has been misused, abused or tampered with;
 - 3.3 is defective or not in working order due to ordinary wear and tear;
 - 3.4 is damaged resulting from the customer's gross negligence, recklessness, malicious behavior or criminal conduct;
 - 3.5 has been utilised for commercial use.
4. This warranty applies only to the product that has been purchased from the seller and not to any expendables attached to or installed on the product by the customer.

5. Any claim in terms of this warranty must be supported by the original proof of purchase.
6. Note that the exchange item will only carry the balance of the warranty period as from the original date of purchase.
7. Spares:

Selected spares can be purchased from:

ServiceTec
10 Saddle Drive
Woodmead Office Park
Woodmead

Email: spares.za@delonghigroup.com
Tel: +27 11 474 0153