



ELECTRIC PANEL HEATER

Instructions for use

Proudly distributed by

De'Longhi

25 CARBINE ROAD

MT WELLINGTON

PO BOX 58056

GREENMOUNT

Auckland, New Zealand

Customer Service Ph: (09) 915 7273

Fax: (09) 915 7280

e-mail: delonghi@delonghi.co.nz

Australia

P.O.Box 597

Riverwood NSW 2210

Customer Service Ph: 1800 126659

Fax: 1800 706932

e-mail: delonghi@delonghi.com.au

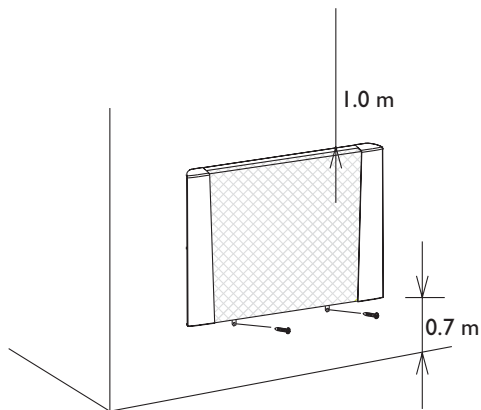

fig.1

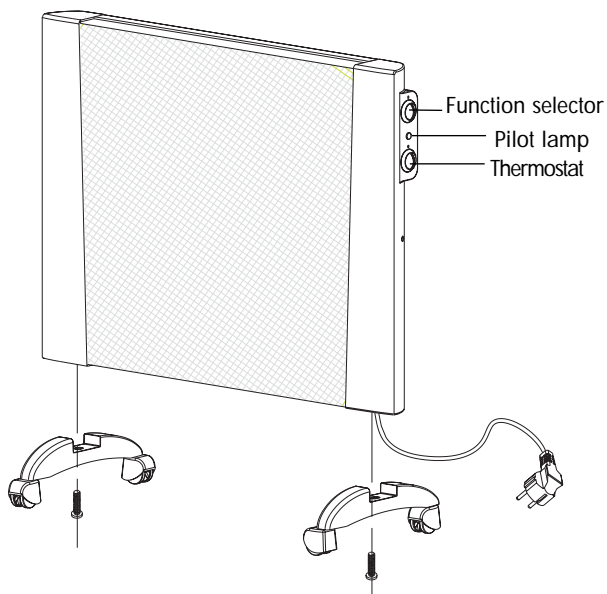

fig.2

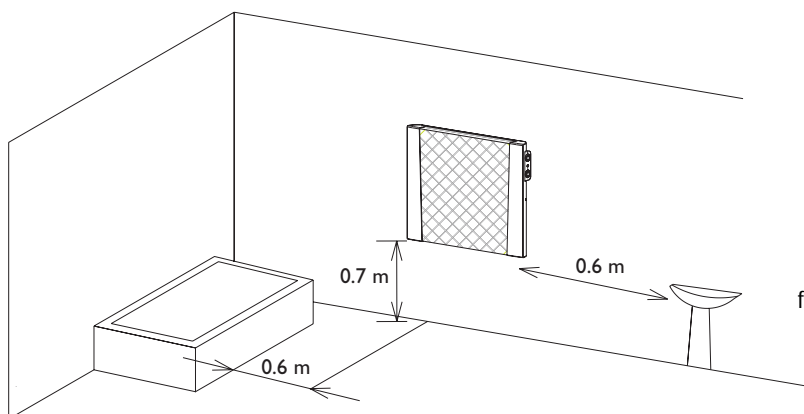

fig.3

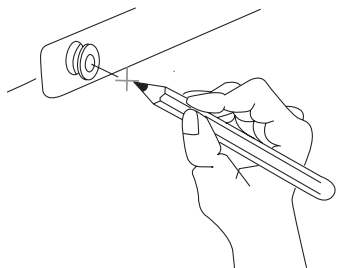

fig.4

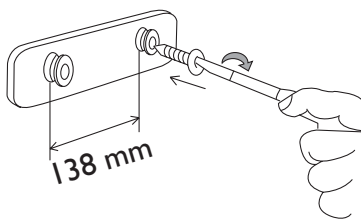

fig.5

HOW TO USE YOUR ELECTRIC PANEL HEATER

Thank you for choosing this Dè Longhi heater. Please read this instruction booklet carefully before using this heater. By doing so, you will obtain optimum results with maximum safety.

1. General instructions

Remove the heater from the packaging. Check that neither the heater nor the power cable has been damaged during transport. Do not operate the heater if damaged. Your heater is suitable for either free-standing or wall mounting usage. Do not assemble the feet if wall mounting.

2. Electrical connection

- Before plugging the appliance into the mains, check that your supply voltage is the same as that shown on the rating plate of the appliance and that the electric installation is suitable to the power shown on the rating plate.
- If using more than one appliance at a time, it is important to ensure that the power supply is adequate to cope with the power requirements.
- This appliance complies with EEC Directive 89/336 relating to electromagnetic compatibility.

3. Free standing operation

To fit the feet to the appliance, proceed as follows:

Fix the foot with the relevant screws, as shown in fig.2.

4. Installation wall-mounting

To wall-mount, proceed as follows:

Drill holes in the wall, as shown in Fig.1, paying particular attention to the minimum distances indicated.

When the appliance is used in bathroom, remember to position it outside the areas in which the presence of water may represent a source of danger (fig.3).

The wall mounting kit should contain:

1 support

4 x Screws

4 x Wall plugs (\varnothing 6 x 30)

1. Select position for siting the heater ensuring that:

a. It is not located directly below a power socket outlet.

b. The plug and power outlet can be easily reached after installation.

c. No electric cables or other tubes could be damaged.

d. Keep away from curtains or inflammable materials. Also note the minimum undermentioned distances:

2. Before drilling the wall, mark out a template following carefully the dimensions as shown in fig.4.

3. For solid brick block walls, use a 6 mm masonry drill and drill according to the marks you have made and then insert the wall plugs provided.

(For plasterboard we suggest, locating the studding and using No 6 woodscrews directly into the wood, or special plasterboard fixings. For other wall types please seek specialist advice).

4. Fix the support by means of the 2 screws provided. (fig.5).

5. Hang the heater on the support.

6. Mark out the 2 lower fixing points (see fig.1). Remove the appliance, drill the lower holes and insert the wall plugs. Now, you can hang the heater to the support and fix the lower part of the appliance with the 2 remaining screws.

5. Functioning and use. (Two power levels model)

- Turn the thermostat knob in a clockwise direction until it reaches the 6 setting.
- **Minimum power:** turn the function knob to setting 1 (the pilot light will come on).
- **Maximum power:** turn the function knob to setting 2.
- **Switching off:** turn the function knob to setting "0".

6. Functioning and use. (One power level models)

- Turn the thermostat knob in a clockwise direction until it reaches the 6 setting.
- Turn the function knob to setting **1** (the pilot light will come on).
- **Switching off:** turn the function knob to the “0” setting.

7. Adjusting the thermostat (both models)

The switches and thermostat should be maintained until the desired room temperature has been reached. Now move the thermostat back gradually until the red pilot lamps go out (or until you hear a ‘click’). The thermostat can then remain at this setting.

8. Maintenance

Before carrying out any maintenance, unplug the heater from the mains and wait for it to cool. The heater requires no particular maintenance. It is sufficient to remove the dust with a soft, dry cloth. Never use abrasive powders or solvents. If necessary remove concentrated areas of dirt with a vacuum cleaner.

9. Warnings

- Do not use the heater in the vicinity of bathtubs, washbasins, showers or swimming pools.
- Never use the heater to dry laundry.
- Never place the power cable on top of the heater while it is hot.
- Only use the heater in an upright position.
- If the supply cord is damaged, it must be replaced by the manufacturer, its service agent or similarly qualified persons in order to avoid a hazard.
- We recommend that you not place the heater in a draught, because strong draughts of air may adversely affect the equipment's operational efficiency.
- **IMPORTANT:** Never for any reason cover the appliance during operation as this could lead to dangerous overheating.
- The use of an extension lead is not recommended, as overheating of the extension lead may occur during the operation of the heater.
- As with any electrical appliance, whilst the instructions aim to cover as many eventualities as possible, caution and common sense should be applied when operating your appliance, particularly in the vicinity of young children.
- The appliance is not intended for use by young children or infirm person without supervision.
- Young children should be supervised to ensure that they do not play with the appliance.
- Position the appliance so that the plug and the outlet can be easily reached even after installation.
- Do not use the appliance in rooms less than 4 m² in area.

The appliance is fitted with a tilt-switch which turns the appliance off if it should fall over.

To restart the appliance, simply place it upright again.

The appliance is fitted with a **safety device** which will switch the appliance off in case of **accidental overheating**. To reset, disconnect the plug from the power socket for a few minutes, remove the cause of overheating then plug the appliance in again.



WARNING: In order to avoid overheating, never under any circumstances cover the appliances during operation, as this would lead to dangerous overheating.

CAUTION: In order to avoid a hazard due to inadvertent resetting of the thermal cutout, this appliance must not be supplied through an external switching device, such as a timer, or connected to a circuit that is regularly switched on and off by the utility.

