

Type STP85

instructions for use

2075105800 - REV.0 29/10/2024

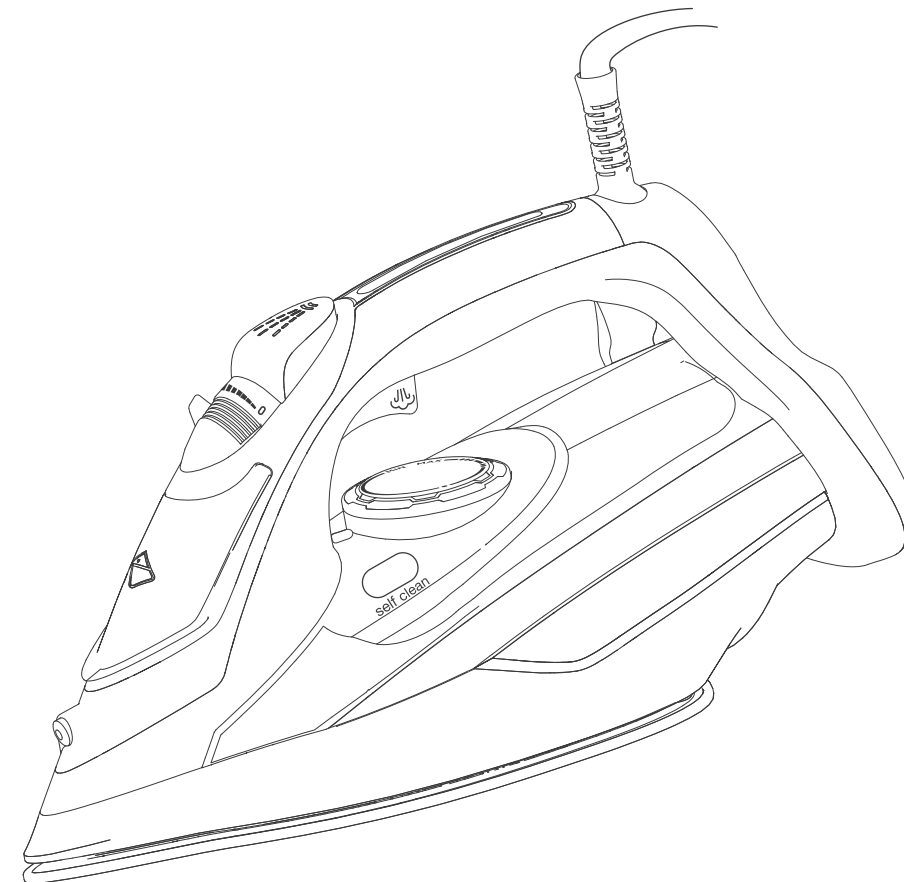

De'Longhi Kenwood MEIA FZE

1209, JAFZA VIEW 18,
DOWNTOWN JEBEL ALI FREE ZONE,
DUBAI
United Arab Emirates

kenwoodworld.com

© Kenwood Ltd 2018

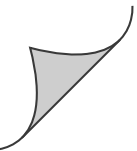

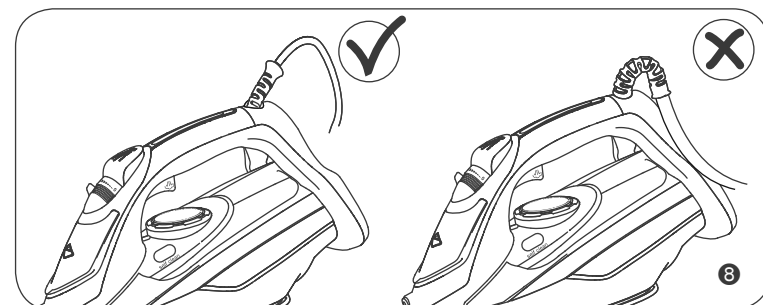
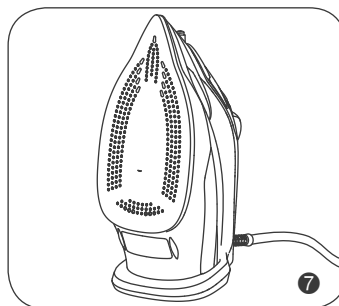
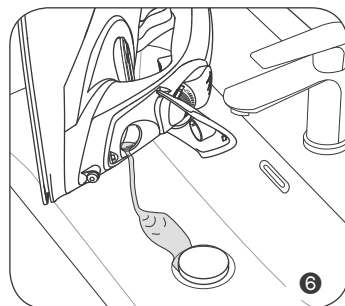
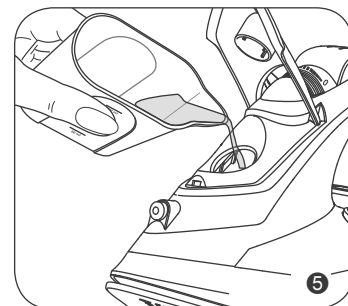
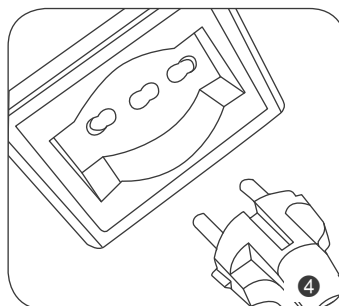
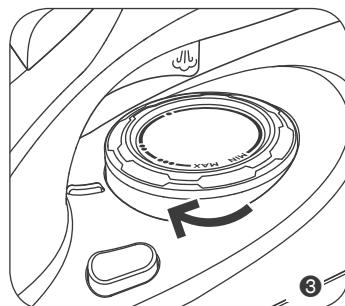
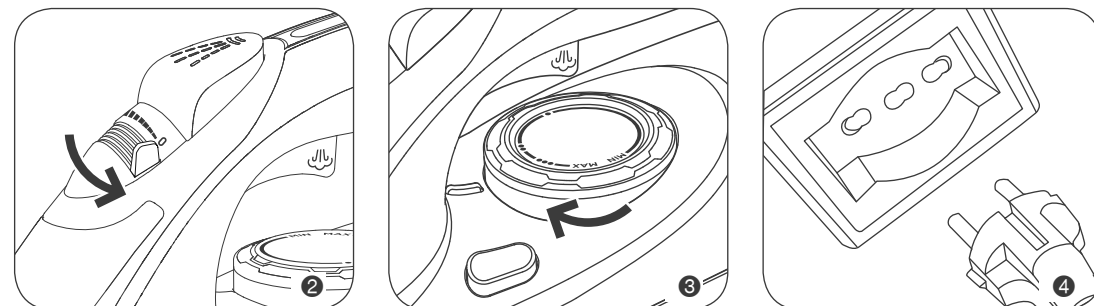
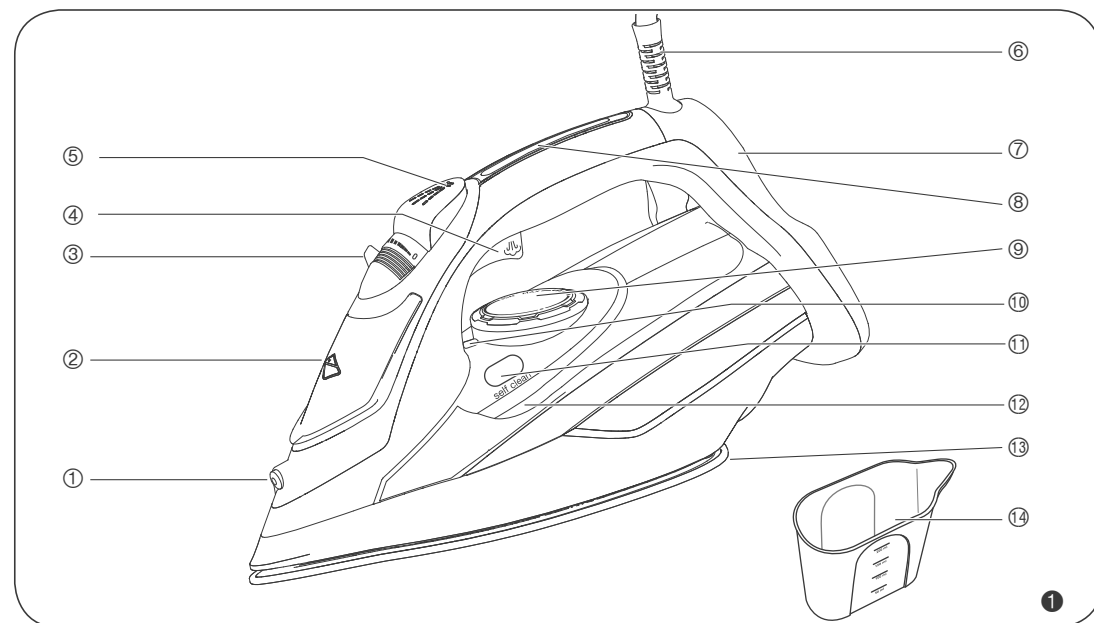

With regard to this manual

- This appliance is made in conformity with appropriate European Regulations in force, to protect the user wherever possible from potential hazards. Even if you are familiar with this type of appliance, carefully read this manual before use. Only use this appliance for the purpose it is designed for in order to prevent accidents and damage. Keep this manual close by for future consultation. Should you decide to give this appliance to other people, please remember to also include these instructions.

Intended use

- You can use this appliance to iron any type of garment, curtains and fabrics either dry or with steam and even in vertical position, following the instructions found on the label. Fabrics shall be ironed on a stable surface both to support the fabrics and to set down the iron when changing garments.
- Any other use of the appliance is not intended by the Manufacturer who does not accept any responsibility for damages of any kind caused by improper use of the appliance. Any improper use of the appliance will also void the warranty.

Safety warnings

Read these instructions carefully.

- This appliance has been designed for private use only, and is therefore to be considered unsuitable for commercial or industrial purposes.
- We suggest you keep the original packaging, as free assistance service is not provided for any damage resulting from improper packaging of the product when this is sent back to an authorised Service Centre.
- Using accessories not recommended or not supplied by the manufacturer of the appliance may entail risks of fire, electric shock or injuries to people.
- This appliance is not intended for use by persons (including children) with reduced physical, sensory or mental capabilities, or lack of experience and knowledge, unless they have been given supervision or instruction concerning use of the appliance by a person responsible for their safety.
- Children should be supervised to ensure that they do not play with the appliance.
- Cleaning and maintenance shall not be made by children unless they are at least 8 years old and supervised.
- Do not leave the iron and the power cord within the reach of children under the age of 8, if the iron is connected to the outlet or while it is cooling down.
- Do not leave the packaging near children because it is potentially dangerous.
- In the event this appliance shall be disposed of, it is suggested to cut off the power cord.
- It is also recommended to make harmless those parts of the appliance which are likely to constitute a danger, especially for children who could use the appliance as a game.
- The use of extension cords which are not approved by the manufacturer can cause material damages and personal injuries.

English

Please refer to the first page, where you will find illustrations

- If the power cord is damaged, it shall be replaced by the Manufacturer, by its Technical Assistance Service or by a similarly qualified person in order to avoid any hazard.
- Never put live parts in contact with water: a short circuit may occur!
- Do not plunge the appliance in water or other liquids.
- Do not start ironing if your hands are wet or if you are barefoot.
- Turn on the appliance only when it is in working position.
- Fill up the tank with water before starting up the appliance. Make sure the appliance is unplugged from the power supply before filling the tank with water.
- When filling the water tank, always use the measuring tool provided. Never place the iron directly underneath the tap.
- After filling the tank, close the lid making sure it is perfectly closed.
- When used for the first time, the appliance may give out a little smoke: there is no need to worry. This transitory effect is perfectly normal, as some parts have been lightly lubricated, and will disappear after a short time.
- During use, place the appliance on a horizontal and well lit up surface.
- Never leave the appliance unattended when it is plugged in.
- The appliance shall be used and rested on a horizontal and steady surface.
- When placing the iron on its rest, make sure the supporting surface is stable.
- When you have to leave for even a short period of time, turn off the appliance, store it on its rest and always unplug the electric power cord.
- Never try to iron garments while being worn.
- Do not touch the metal parts of the iron when in operation and for several minutes after it is turned off, since it could cause burns.
- Do not aim the steam jet towards parts of the body or pets.
- Remove any labels and protections from the soleplate before using the appliance for the first time.
- Always unwind the power cord before use.
- The use of extension cords which are not approved by the manufacturer can cause damage and personal injuries.
- Do not use sparkling (carbonated) water. If your water supply is very limestone, we suggest you use demineralised water instead.
- Do not let the iron touch the power cord when it is hot.
- Do not bend the power cord protection when the power cord is wound around the iron: the power cord might break over time.
- Do not pull the power cord to unplug the appliance.
- Do not pour vinegar, descaling products or other scented substances into the tank. Otherwise, the warranty may be revoked.

- The appliance shall only be cleaned with a non-abrasive, slightly dampened cloth after unplugging the appliance and all its parts cool down. Never use solvents, as they may damage the plastic parts.
- Do not wind the power cord around the soleplate when the iron is hot.
- Do not put the soleplate in contact with metal surfaces.
- Before filling the tank with water, or before emptying the tank, always turn off the appliance by turning the temperature control knob to “MIN” and unplug the power cord from the power outlet.
- Do not leave the appliance exposed to weathering (rain, sun, etc).
- The appliance shall not be used if it has been dropped or if there are visible signs of damage. Do not use the appliance if the power cord or the plug are damaged, or if the appliance is faulty. All repairs, including the power cord replacement, shall be carried out only by authorized Service Centres or technicians, in order to prevent any risk.
- **Save these instructions for future reference.**

Description of the appliance

- ① Spray nozzle
- ② Water tank filling lid
- ③ Steam adjustment selector
- ④ Steam supply button
- ⑤ Spray button
- ⑥ Power cord protection
- ⑦ Iron rest
- ⑧ Iron temperature indicator light
- ⑨ Temperature control knob
- ⑩ Reference mark to set temperature
- ⑪ Self-cleaning button
- ⑫ Tank
- ⑬ Soleplate
- ⑭ Measuring tool

Instructions for use

Important

- When using the iron for the first time, try it on an old piece of cloth to test the soleplate and the water tank are perfectly clean.

Filling the tank

- Make sure the appliance is unplugged from the power supply before filling the tank with water.**

- Set the steam adjustment selector ③ to the symbol (0) ②.
- Hold the iron horizontally.
- Open the water tank filling lid ② by pulling it upwards.
- Fill the tank with tap water using the measuring tool ⑭ provided ⑤, until reaching the maximum level.
- Close the water tank filling ②.

Important

- NEVER exceed the MAX level when filling the tank.
- Do not pour vinegar, descaling products or other scented substances into the tank. Otherwise, the warranty may be revoked.
- If you need to add water while ironing, always turn off the appliance and unplug the power cord from the power outlet before filling the tank with water.

Appliance start-up

Important





- When using the iron for the first time, some white powder may leak from the soleplate. This effect is normal and will disappear after delivering a few steam shots.
- When using the iron for the first time, you may notice a delay in steam formation. This is normal and is due to water starting to circulate into the iron. You may need to press the steam and spray buttons several times for their proper operation.

- Place the iron upright on the iron rest ⑦.
- Plug the power cord into the power outlet. The temperature indicator light ⑧ turns on.
- To select the desired temperature, turn the temperature control knob ⑨ ③, until it is aligned with the reference mark ⑩ on the iron.
 - When the appliance reaches the selected temperature, the temperature indicator light ⑧ turns off (while ironing, the temperature indicator light turns on and off periodically, indicating the action of the iron which maintains the proper temperature).
 - Follow the instructions shown on the label of the item to be ironed, in order to match the dots on the iron with those reported on the label.

Suggestions

Important

- In order not to compromise the non-stick layer, do not pass the iron soleplate over zippers or other hard material objects.
 - Divide the articles to be ironed according to the material type: wool with wool, cotton with cotton, etc.
 - Since the heating of the iron plate occurs much faster than its cooling, it is advisable to start ironing all fabrics that require lower temperatures and then switch to ironing those fabrics that progressively require higher temperatures. If the fabric is made up of more types of fibres, always set the temperature based on the fibre requiring less heat. For example, if the material is made up of 70% synthetics and 30% cotton, set the temperature control to position (•) (see table) without steam, that is, the temperature for synthetic fabrics.
 - If you do not know the composition of the article to be ironed, choose a part of the article which will not be seen. Do a test ironing on this part to establish the appropriate temperature (always start with a relatively low temperature and work up until the ideal temperature is reached). Pure (100%) wool articles can be ironed with the iron set to one of the steam positions.
 - To prevent pure wool, silk and synthetic materials from becoming shiny, we recommend ironing them inside out. For other materials, especially velvet, which can become shiny very easily, cover them with a cloth and iron in one direction only, applying a light pressure. The iron must be kept constantly moving over the fabric.
-  • This symbol on the label indicates that the article cannot be ironed! (For example chlorofibre, elastodiene).

| Label ironing instructions | Fabric type | Thermostat |
|---|--|------------|
|  | Synthetic, nylon, acrylics, polyester, rayon | • |
|  | Wool, silk fabrics | •• |
|  | Cotton, linen | ••• |
|  | The mark on the label means do not iron | |

Steam ironing

- Steam ironing is only possible at high temperatures.
 - Make sure there is enough water inside the tank.
- 1 Place the iron upright on the iron rest ⑦.
 - 2 Plug the power cord into the power outlet.
 - 3 Set the temperature control knob ⑨ to the (••) position or higher.
 - 4 When the temperature indicator light ⑧ turns off, move the steam adjustment selector ③ to the desired position.
- To get maximum steam supply, set the selector to the symbol (☁).
 - When setting the selector to the symbol (0), steam is not supplied ②.

Important

- This model is equipped with an anti-drip system that automatically prevents the passage of water from the tank to the soleplate holes. The anti-drip system automatically disables the steam function if the iron temperature is too low.

Steam boost

The steam boost function allows the user to remove the toughest wrinkles.

- Make sure that the temperature is set to (••) or a higher level and that there is water in the tank.
 - Set the steam adjustment selector ③ to the symbol (☁) and press the steam supply button ④.
- Do not press the steam button for more than 5 seconds to avoid water leakage from the soleplate.

Spray button

- Steam ironing is possible at any temperature.
- Make sure there is enough water inside the tank.
- To activate this function, it may be necessary to repeatedly press the spray button ⑤.

Auto-off function

- If the appliance is on but not in use, the auto-off function activates to protect the iron and save electricity.
- If the iron is left in vertical position, it turns off after 8 minutes.
- If the iron is left in horizontal position, it turns off after 30 seconds.
- When the auto-off function is activated, the iron temperature indicator light is on.
- To resume the appliance operation, move the iron. The temperature indicator light ⑧ turns off.

Dry ironing

- 1 Plug the power cord into the power outlet.
- 2 Set the steam adjustment selector ③ to the symbol (0).
- 3 Set the temperature control knob ⑨ according to the type of fabric to be ironed. Wait a few minutes, until the soleplate reaches the set temperature.

Important

- Avoid filling the water tank during dry ironing.
- Do not fill the water tank after use. Wait a few minutes and let the soleplate cool down.

After ironing

- 1 Turn the temperature control knob ⑨ to "MIN".
 - 2 Unplug the power cord from the power outlet.
 - 3 Place the iron in vertical position and let it cool down.
 - 4 Empty the tank: open the water tank filling lid ②, turn the iron upside-down and let water drain ⑥.
- **Let the iron cool down before emptying the tank. Danger of burns.**
- 5 Wind the power cord around the iron without tightening too much ⑧.
 - 6 Store the iron in vertical position ⑦.

Cleaning and maintenance

- **Before cleaning the iron, ensure it is disconnected from the power supply and has completely cooled down.**
- **Never plunge the appliance in water or other liquids.**
- **Check the condition of the power cable of your appliance on a regular basis before using it and, if it is damaged, take it to the service centre closest to you to have it replaced only by specialised personnel.**

Self-cleaning system

- It is recommended to carry out this operation once or twice a month to extend the life of the iron.
- 1 Half fill the water tank using the measuring tool ⑭ provided ⑤.
 - 2 Place the iron on a stable surface, upright on the iron rest ⑦.
 - 3 Plug the power cord into the power outlet.
 - 4 Make sure the steam adjustment selector is set to the symbol (0).
 - 5 Turn the temperature control knob to "MAX".
- Let the iron heat up until the indicator light ⑧ turns off a second time.
- 6 Turn the temperature control knob to "MIN".
 - 7 Unplug the iron and hold it horizontally over a sink.
 - 8 Set the steam adjustment selector ③ to the symbol (☁).
 - 9 Press the self-cleaning button ⑪ and keep the iron in horizontal position.
- Steam and boiling water will come out of the holes of the soleplate. They will thus remove lime deposits and impurities that have accumulated inside the tank.
- 9 Gently move the iron back and forth until the tank is completely empty.
 - 10 At the end of the self-cleaning procedure, set the steam adjustment selector back to the symbol (0) and turn the temperature control knob to "MIN".
 - 11 Place the iron upright on its rest and wait for the soleplate to cool down completely.
- Make sure the soleplate is completely dry before storing the iron.
- ### Important
- Before using the iron again, try it on an old piece of cloth to make sure that the soleplate and the tank are clean, as well as to allow the vaporization of residual water.

Anti-calc system

The appliance is equipped with a resin filter inside the water tank to avoid the formation of limescale in the soleplate. The resin filter is permanent and must not be replaced.

Important

- Only use tap water. Distilled and demineralized water makes the anti-calc system ineffective.

Cleaning the soleplate and the external surface

- **Do not use abrasive agents to clean the soleplate.**
- **Keep the soleplate smooth: avoid contact with metal objects.**
- Any deposits and other residual material on the soleplate can be removed using a cloth soaked in a water and vinegar solution.
- Clean plastic parts using a damp, non-abrasive cloth and dry them with a dry cloth.
- Failure to comply with such rules will cause the warranty to be void.

Service and customer care

- If you experience any problems with the operation of your appliance, before requesting assistance visit www.kenwoodworld.com.
- Please note that your product is covered by a warranty, which complies with all legal provisions concerning any existing warranty and consumer rights in the country where the product was purchased.
- If your Kenwood product malfunctions or you find any defects, please send it or bring it to an authorised KENWOOD Service Centre. To find up-to-date details of your nearest authorised KENWOOD Service centre, visit www.kenwoodworld.com or the website specific to your Country.
- Made in China.



IMPORTANT INFORMATION FOR CORRECT DISPOSAL OF THE PRODUCT IN ACCORDANCE WITH THE EUROPEAN DIRECTIVE ON WASTE ELECTRICAL AND ELECTRONIC EQUIPMENT (WEEE)

At the end of its working life, the product shall not be disposed of as urban waste. It shall be taken to a special local authority differentiated waste collection centre or to a dealer providing this service. Disposing of a household appliance separately avoids possible negative consequences for the environment and health deriving from inappropriate disposal and enables the constituent materials to be recovered to obtain significant savings in energy and resources. As a reminder of the need to dispose of household appliances separately, the product is marked with a crossed-out wheeled dustbin.