

GRINDER

KG 30/39



Living innovation

Description of Appliance

The following terms are used throughout the instruction manual

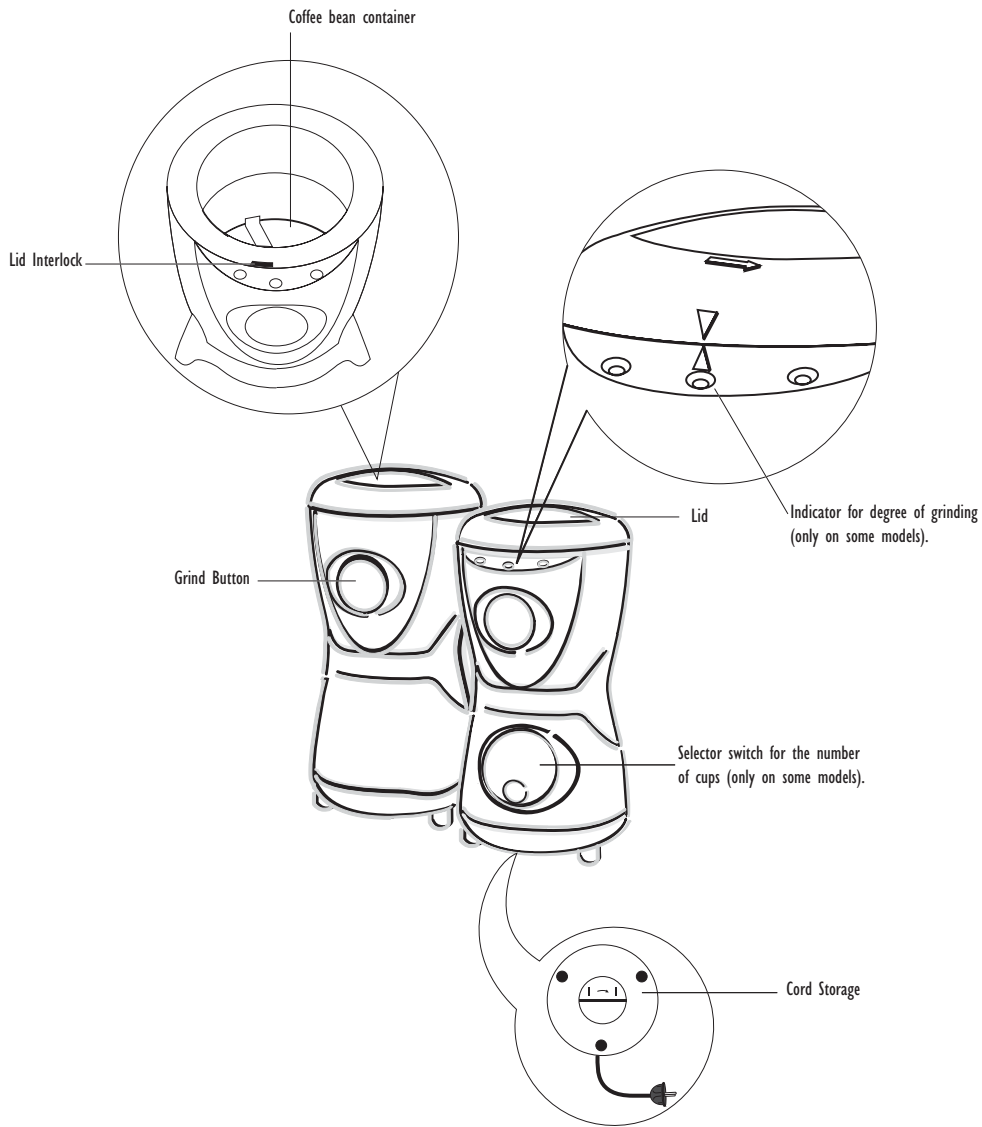

Thank you for choosing this coffee grinder. To get the best results it is advisable to read these instructions before using the appliance. This is the only way to ensure optimum results and maximum safety.

USING THE COFFEE GRINDER

- Place the appliance on a flat surface.
- Turn the lid in a clockwise direction and remove (fig. 1). Fill the container with the desired amount of coffee beans (fig. 2). (approx. 1 tbsp per cup).
- Secure the lid back in place until the arrows on the lid and appliance are lined up (fig. 3). The appliance can only be switched on when the lid is correctly closed.
- Pull out the length of cord required and plug into the socket.
- Models provided with the selection knob, turn to the number of cups you wish to grind (fig. 4). However, this is a reference the amount will change depending on individual taste, the type and roasting of the coffee beans and the consistency of grinding selected.
- Press the GRIND button to start the coffee grinder (fig. 5) and keep it pressed until the right consistency is obtained.
- Models with indicator light showing the consistency of grinding - coarse, medium, fine - press the GRIND button and release when the indicator lights up relative to the required consistency of grind.

Remember that when the GRIND button is released, even for a second, the appliance zeroes and will start grinding again as if there were whole beans inside.

RECOMMENDATIONS FOR USE

- Always keep the lid of the coffee bean container tightly closed to keep in all the flavour and aroma of the coffee beans.
- Only grind the amount of coffee required.
- Do not overfill the coffee bean container.
As an indication, calculate a tablespoon of coffee beans per cup (e.g. 4 spoonfuls of coffee beans for 4 cups). The ideal amount depends on individual taste and will be discovered through the continued use of the machine.
- For models with indicators lights showing the consistency of grinding remember that:
COARSE grinding is ideal for drip coffee makers and percolator;
MEDIUM is ideal for mocha coffeepot;
FINE is ideal for espresso coffee makers.
- Leave at least one minute between one grind and the next, to avoid the appliance overheating.

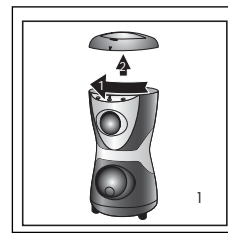

fig.1

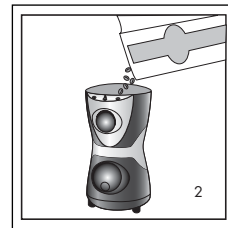

fig.2

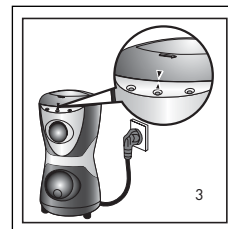

fig.3

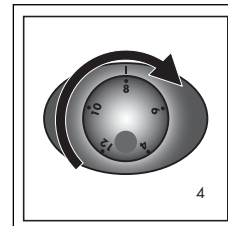

fig.4

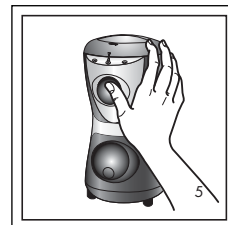

fig.5

- To ensure you always have fresh coffee, always clean the appliance after each use, especially if coffee is ground after grinding other products (e.g. sugar). However it is not advisable to grind oily beans (e.g. peanuts) or products that are too hard (e.g. rice).

CLEANING

- Take the plug out of the socket.
- Do not immerse the appliance in water.
- Wash the lid with mild detergent and water, then rinse it carefully and dry.
- Use a soft damp cloth to clean the outside of the coffee bean container, the blades and the outside of the appliance.
- Use a small brush to remove any coffee grinds left inside the mechanism.
- Before putting the appliance away, use the automatic cord rewind to store it away.

IMPORTANT SAFETY MEASURES

- Before plugging in, make sure that the voltage of your electricity supply is the same as that indicated on the specification plate.
- Clean the appliance only with a dry or slightly dampened cloth.
- Should the appliance break or not function correctly, turn it off and do not tamper with it. For any repairs, contact a Service Centre authorised by the manufacturer and request the use of original parts. Failure to respect the above could compromise the safety of the appliance.
- This appliance should only be used for its intended purpose.
- The manufacturer cannot be held responsible for any damage caused through incorrect, wrong or unreasonable use. In these cases, the guarantee rights are null and void.
- Do not use the appliance if the supply cord is damaged.
- Never remove the plug from the socket by pulling the cord, or with wet hands.
- Children are not able to recognise the dangers connected with the use of electrical appliances: never leave children unsupervised near the appliance.
- Do not immerse the appliance in water.
- Attention: before cleaning, remove the plug.
- Do not let the supply cord hang over the edge of the table or worktop, or touch hot surfaces.

Electrical requirements

Before using this appliance ensure that the voltage indicated on the product corresponds with the main voltage in your home, if you are in any doubt about your supply contact your local electricity company.

The flexible mains lead is supplied connected to a B.S. 1363 fused plug having a fuse of 13 amp capacity. Should this plug not fit the socket outlets in your home, it should be cut off and replaced with a suitable plug, following the procedure outlined below.

Note: Such a plug cannot be used for any other appliance and should therefore be properly disposed of and not left where children might find it and plug it into a supply socket - with the obvious consequent danger.

N.B. We recommend the use of good quality plugs and wall sockets that can be switched off when the machine is not in use.

important: the wires in the mains lead fitted to this appliance are coloured in accordance with the following code:

| | |
|------------------|---------|
| GREEN AND YELLOW | EARTH |
| BLUE | NEUTRAL |
| BROWN | LIVE |

As the colours of the wires in the mains lead of this appliance may not correspond with the coloured markings identifying the terminals in your plug, proceed as follows:

The wire which is coloured green and yellow must be connected to the terminal in the plug which is marked with the letter E or by the earth symbol  or coloured green or green and yellow.

The wire which is coloured blue must be connected to the terminal which is marked with the letter N or coloured black.

The wire which is coloured brown must be connected to the terminal which is marked with the letter L or coloured red.

When wiring the plug, ensure that all strands of wire are securely retained in each terminal. Do not forget to tighten the mains lead clamp on the plug. If your electricity supply point has only two pin socket outlets, or if you are in doubt, consult a qualified electrician.

Should the mains lead ever require replacement, it is essential that this operation be carried out by a qualified electrician and should only be replaced with a flexible cord of the same size.

After replacement of a fuse in the plug, the fuse cover must be refitted. If the fuse cover is lost, the plug must not be used until a replacement cover is obtained. The colour of the correct replacement fuse cover is that of the coloured insert in the base of the fuse recess or elsewhere on the plug. Always state this colour when ordering a replacement fuse cover.

Only 13amp replacement fuses which are approved to B.S. 1362 should be fitted.

This appliance conforms to the Norms EN 55014 regarding the suppression of radio interference.

warning - this appliance must be earthed

