

Type TCP31

Instructions for use

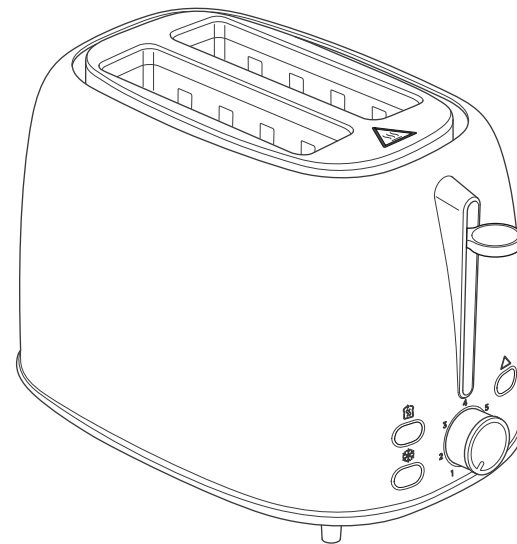

6375102800 - REV.0 21/03/2025

Kenwood Ltd

New Lane
Havant
Hampshire
PO9 2NH

kenwoodworld.com

© Kenwood Ltd 2018



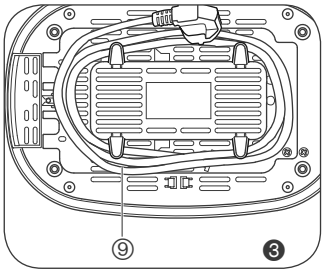
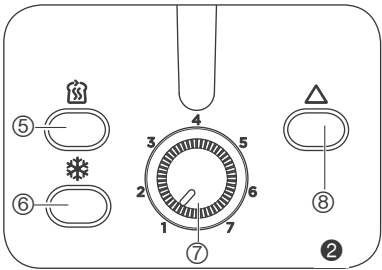
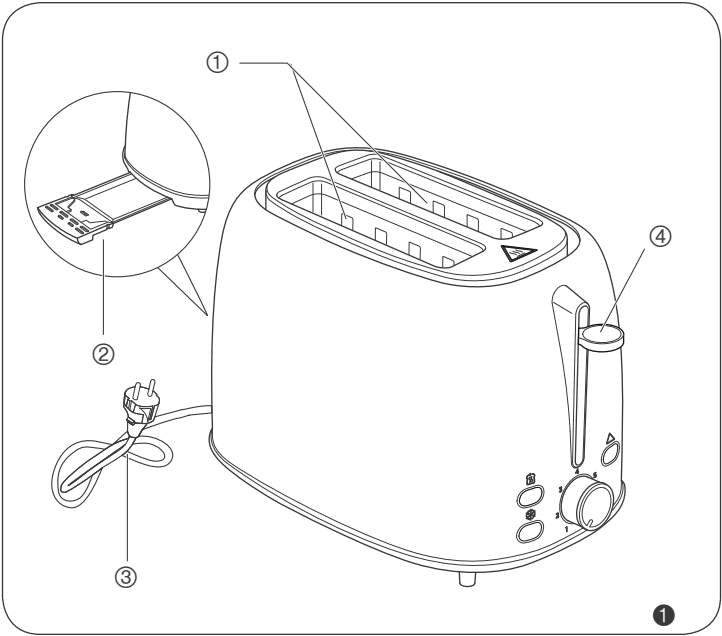

Preliminary operations

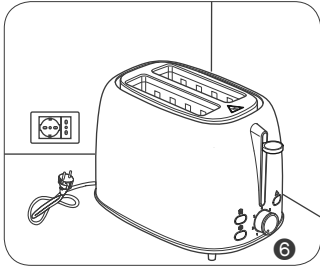
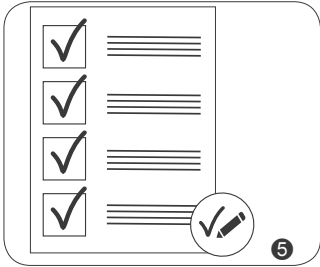
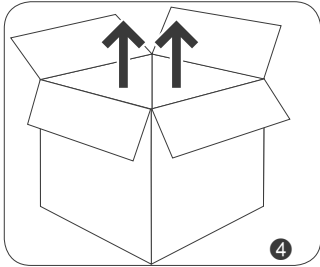

Use

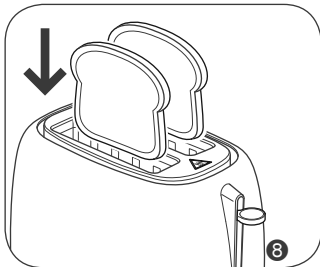
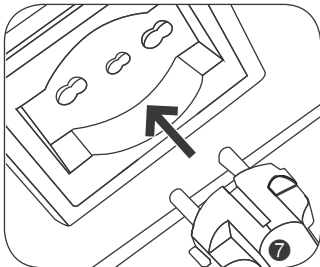

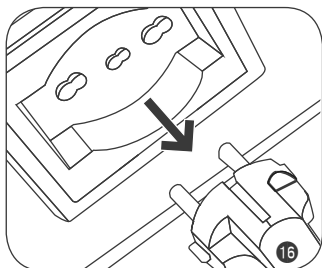
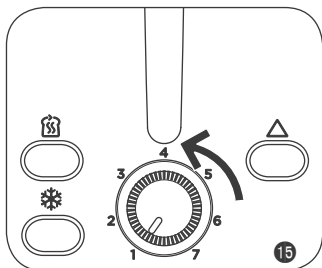
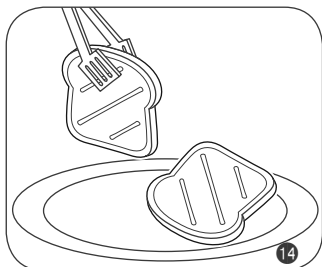
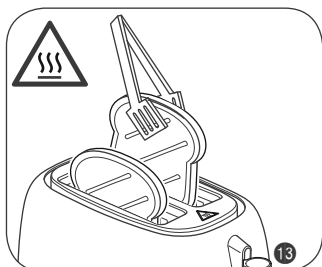
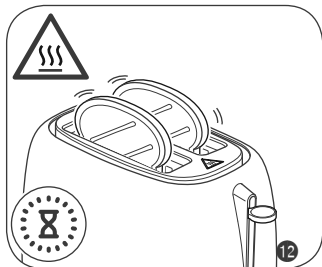
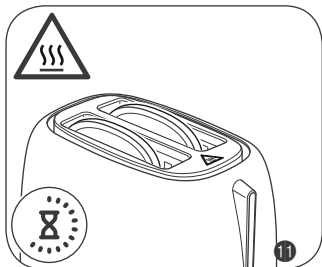
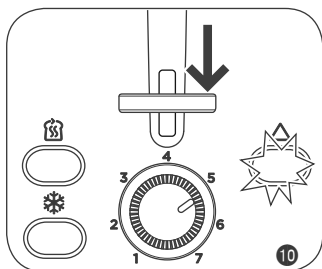
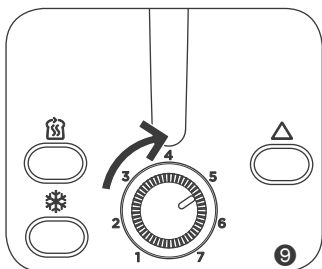



Heating Function

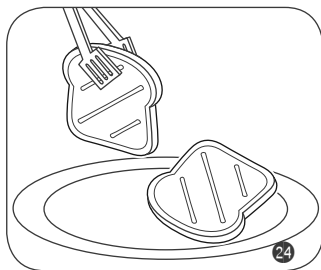
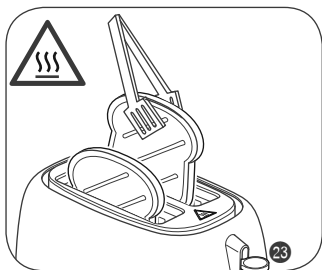
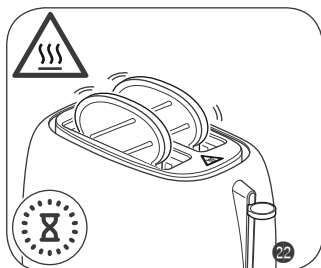
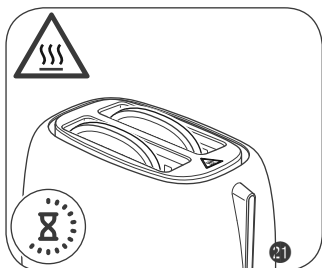
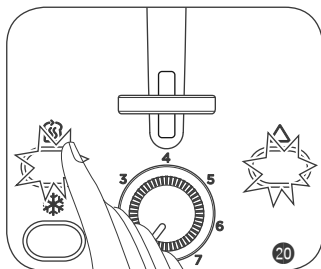
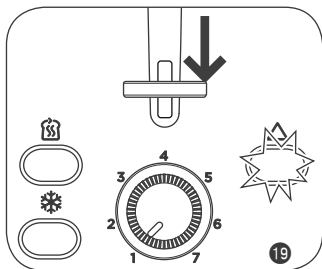
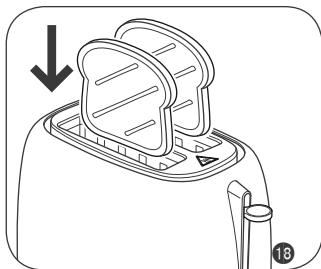
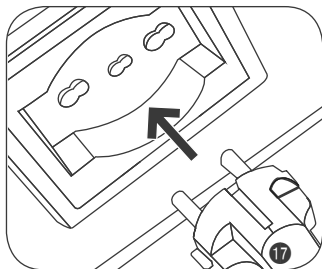

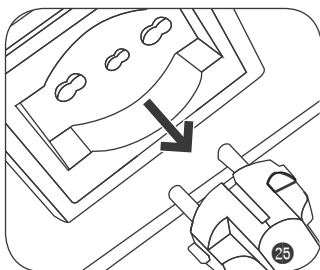

Defrost function

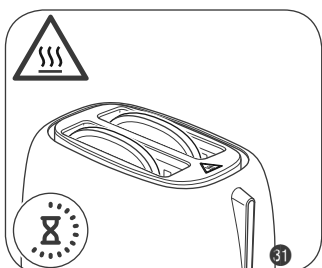
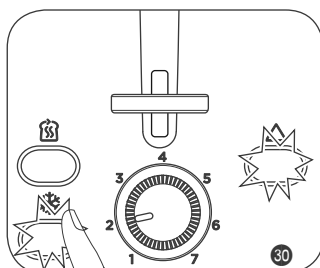
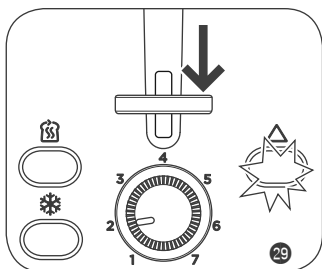
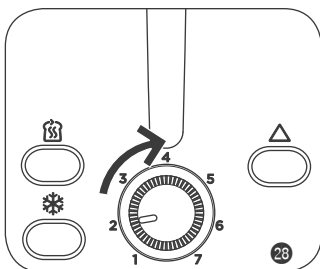
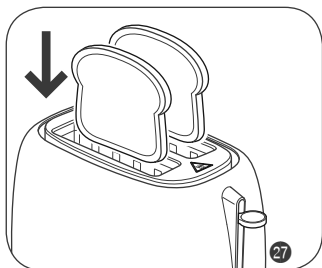
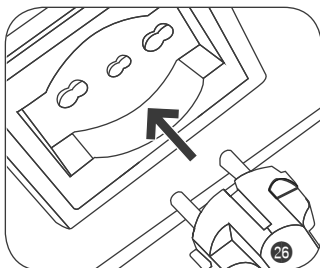

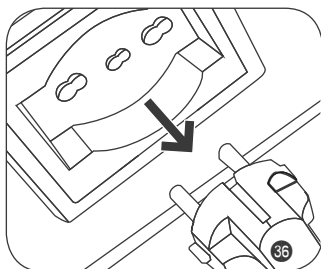
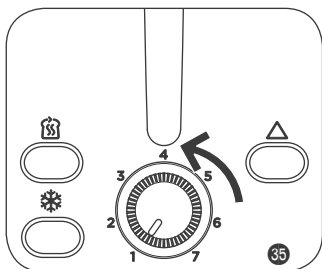
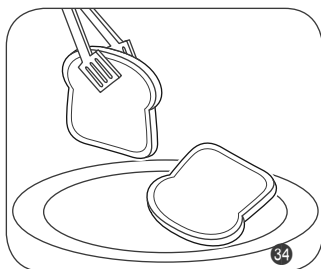
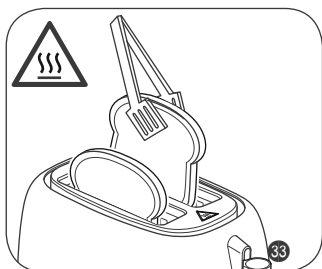
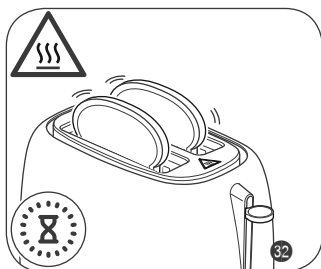



Cleaning and maintenance

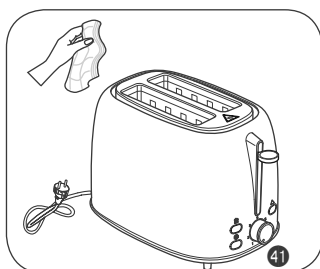
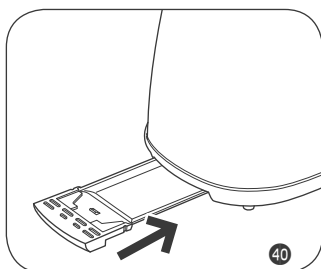
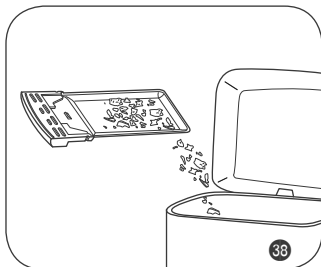
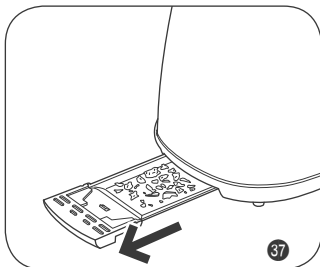

English

Please refer to the first page, where you will find illustrations

Safety warnings

Read the instructions carefully before use.

- The appliance has been manufactured in compliance with the specific European Standards in force and all the parts potentially dangerous to the user are protected. Read this manual carefully before use. Use the appliance only for its intended use to avoid possible injury and damage. Keep this manual handy for future reference. Should you decide to give this appliance to other people, remember to include these instructions as well.
- The appliance has been designed to be used for household purposes or similar, such as:
 - in cooking areas reserved for shop staff, offices and other professional environments
 - on farms
 - hotels, motels, bed & breakfasts and other residential facilities (for use by guests).
- The manufacturer declines any responsibility for misuse or for any use other than those specified in this manual. Improper use also results in voiding any form of warranty.
- We suggest keeping the original packaging, as free assistance is not provided for failures resulting from inadequate packaging of the product at the time of shipping to an authorized Service Centre.
- In order not to compromise the safety of the appliance, use only original spare parts and attachments authorized by the Manufacturer.

- The appliance complies with the Regulation (EC) No. 1935/2004 of 27/10/2004 concerning the materials intended to come into contact with food products.
- Do not leave the packaging near children as it is a potential source of danger.
- The appliance can be used by children over 8 years of age and by people with reduced physical, sensory or mental capacities, or who lack experience or knowledge, only if they are supervised by a responsible person or if they have received and understood the instructions and the existing dangers when using the appliance.
- Children shall not play with the appliance.
- Always keep the appliance and the power cord out of the reach of children under the age of 8.
- Do not let the power cord hang in a place where it could be grasped by a child.
- Position the appliance so that children cannot reach the hot parts.
- Cleaning and maintenance by the user shall not be carried out by children unless they are older than 8 years and are supervised during the operation.
- If you decide to dispose of this appliance as waste, it is recommended to make it inoperative by cutting the power cord. It is also recommended that all potentially dangerous components of the appliance, especially for children who could use the appliance as a game, are rendered harmless.
- Before connecting the appliance to the power supply, check that the voltage

shown on the identification plate under the appliance matches the local voltage supply.

- The use of extension cords not authorized by the manufacturer can lead to damages and accidents.
- Always connect the appliance to an earthed socket.
- Do not connect any other high-power equipment (such as stoves, irons, radiators) to the same power outlet. Danger of electric overload.
- Do not leave the appliance unattended while connected to the power supply.
- Do not put live parts in contact with water: risk of short circuit and/or electric shock.
- Never immerse the appliance, plug or power cord in water or other liquids.
- Do not use the appliance if your hands are wet or if you are barefoot.
- Do not leave the power cord against sharp parts or sharp edges.
- The power cord shall not touch hot surfaces.
- Never pull the power cord or the appliance to disconnect the plug from the power outlet.
- Always unplug the appliance before inserting or removing individual components.
- If the appliance is left unused, also for a short period of time, turn it off and always unplug the power cord from the power outlet.
- Do not place the appliance on very hot surfaces or near open flames to prevent the coating from being damaged.
- Do not place the appliance near flammable materials (such as fabrics, curtains).
- Do not place the appliance or the power

- cord near or over hot electric or gas stoves, or near a microwave or electric oven.
- Do not place the appliance near or on damp surfaces (such as a sink).
 - The appliance must not be powered by external timers or separate remote-controlled systems.
 - If the appliance produces smoke during operation, immediately unplug the appliance from the power outlet. Contact the nearest authorized technical service centre to solve the problem.
 - Do not use the appliance outdoors.
 - The appliance shall be used and left at rest on a stable surface.
 - Do not leave the appliance exposed to weathering (such as rain or sun).
 - Place the appliance in an environment that is sufficiently lit, clean and where the power outlet is easily accessible.
 - Place the appliance on a stable and dry surface.
 - Never place objects on the appliance.
 - In order to lift the appliance, hold it by the body.
 - The appliance must not be used if it has been dropped or if there are visible signs of damage. Do not use the appliance if the power cord or plug are damaged or if the appliance is faulty. All repairs, including the power cord replacement, shall be carried out only by authorized Service Centre or technicians, in order to prevent any risk.
 - **Always keep these instructions for future reference.**

Safety warnings during use

- The appliance must be used to defrost, heat and toast slices of bread and other dry foods of similar consistency. Any other use of the appliance is not intended by the Manufacturer, which is exempt from any liability for damage of any kind, generated by improper use of the appliance. Improper use also results in voiding any form of warranty.
- Fully unwind the power cord before use.
- Do not put your hands or any type of metal (such as knives or aluminium foil) inside the toaster.
- Do not insert foods that may drip during cooking. Besides making cleaning difficult, they can cause fires.
- Do not insert forks or other utensils into the appliance. This operation can damage the heating elements of the appliance and create a danger of electric shock.
- Do not insert more than two slices for each slit.
- Do not use the appliance without the crumb tray.
-  Warning: hot surface.
- Danger of burns: do not touch the upper edges of the appliance during use.
- Do not use a knife or other object to pull the toast out of the slit. Disconnect the power cord and allow the appliance to cool down. Carefully remove the toast.
- Clean the crumb tray from any food residue or crumbs after each use.

- After use, allow the appliance to cool down before wrapping the power cord around its base and storing it.

Description of the appliance

- ① Slits
- ② Crumb tray
- ③ Power cord
- ④ ON/OFF lever
- ⑤ Heating function button
- ⑥ Defrost function button
- ⑦ Knob for adjusting the toasting level
- ⑧ Stop button
- ⑨ Cord storage device

Identification data

The following identification data of the appliance are reported on the data plate under the base of the appliance:

- manufacturer and CE marking
- model [Mod.]
- serial number [SN]
- power supply voltage [V] and frequency [Hz]
- electrical power consumption [W]

In any requests to authorized Service Centres, specify model and serial number.

Power consumption in off mode: 0,0 W

How to use the appliance

When using the appliance for the first time, you may notice the release of a slight smell and a little smoke: this is to be considered perfectly normal because some parts have been slightly lubricated, it will stop occurring after a short time.

When using the appliance for the first time, turn the knob for adjusting the toasting level ⑦ to the "3" position.

How to make toast

Important

- Do not use slices of bread too thin or broken.
- Do not insert foods that are too bulky.
- If the appliance is not plugged and turned on, the ON/OFF lever will not click into place. Do not press any button to make toast: choose the toasting level and lower the ON/OFF lever.

After a few minutes, according to the selected toasting level, toasting is ready and the ON/OFF lever automatically moves upwards. Bread slices are expelled upwards.

If the toast is not brown enough, select a higher toasting level. If the toast is overdone, select a lower toasting level.

Press the stop button (Δ) to stop toasting any time.

Defrost function

You can use the appliance to defrost frozen bread slices. If you want to defrost and toast bread at the same time, adjust the toasting on higher levels.

- 1 Insert the frozen slices of bread inside the toaster slits ①.
- 2 Turn the knob for adjusting the toasting level ⑦ to set the desired toasting level.
- 3 Pull down the ON/OFF lever ④ until it locks into position.
- 4 Press the defrost function button (❄) to activate the defrost function. The button remains lit throughout the defrosting time.

Heating function

You can use the appliance to heat bread slices that have already been toasted.

- 1 Insert the slices of bread inside the toaster slits ①.
- 2 Pull down the ON/OFF lever ④ until it locks into position.
- 3 Press the heating function button (🔥) to activate the heating function. The button remains lit throughout the heating time.
The heating time is fixed and cannot be changed.

⚠ Safety warnings during cleaning and maintenance

- Regular and daily cleaning maintains the appliance efficient and extends the life of the appliance.
- Cleaning and maintenance operations shall be carried out when the appliance is off and unplugged from the power outlet.
- Unplug the appliance from the power outlet and wait for the hot parts to cool down before carrying out any cleaning and maintenance operations.
- After unplugging the appliance and when hot parts have cooled down, only clean the appliance using a damp, non-abrasive cloth and a few drops of mild, non-aggressive detergent. Never use solvents that damage plastic parts.
- Never use sharp and metal tools to clean the inside of the appliance.

After each use of the appliance, empty and clean the crumb tray ②.

Service and customer care

- If you experience any problems with the operation of your appliance, before requesting assistance visit www.kenwoodworld.com.
- Please note that your product is covered by a warranty, which complies with all legal provisions concerning any existing warranty and consumer rights in the country where the product was purchased.
- If your Kenwood product malfunctions or you find any defects, please send it or bring it to an authorised KENWOOD Service Centre. To find up-to-date details of your nearest authorised KENWOOD Service centre, visit www.kenwoodworld.com or the website specific to your Country.



IMPORTANT INFORMATION FOR CORRECT DISPOSAL OF THE PRODUCT IN ACCORDANCE WITH THE EUROPEAN DIRECTIVE ON WASTE ELECTRICAL AND ELECTRONIC EQUIPMENT (WEEE)

At the end of its working life, the product shall not be disposed of as urban waste. It shall be taken to a special local authority differentiated waste collection centre or to a dealer providing this service. Disposing of a household appliance separately avoids possible negative consequences for the environment and health deriving from inappropriate disposal and enables the constituent materials to be recovered to obtain significant savings in energy and resources. As a reminder of the need to dispose of household appliances separately, the product is marked with a crossed-out wheeled dustbin.