

## Type ZJP31

Instructions for use

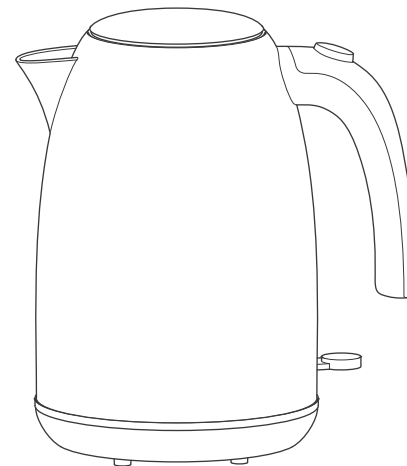

6365102500 - REV.0 21/03/2025

### Kenwood Ltd

New Lane  
Havant  
Hampshire  
PO9 2NH

[kenwoodworld.com](http://kenwoodworld.com)

© Kenwood Ltd 2018



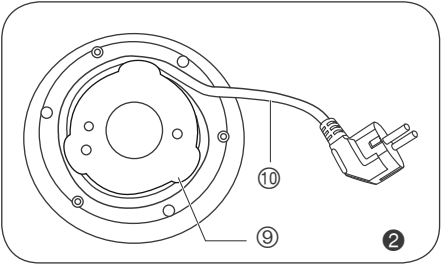
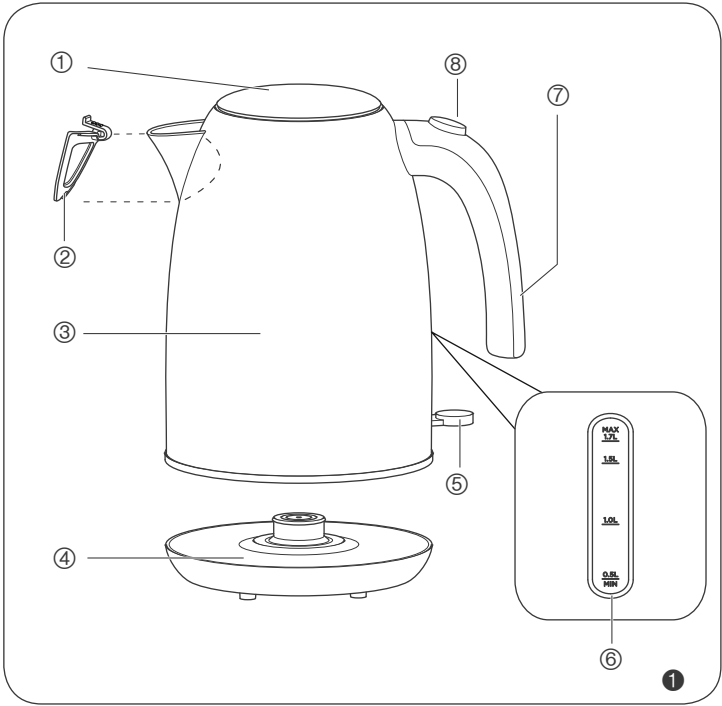

Preliminary operations

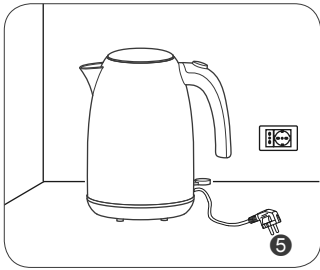
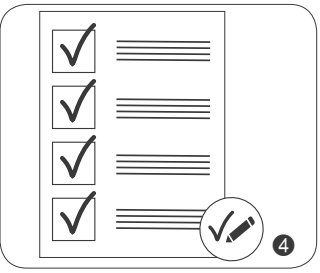
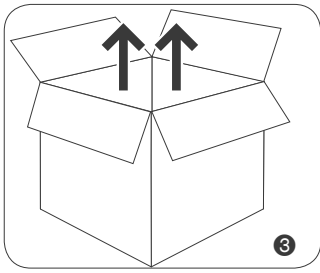

Use

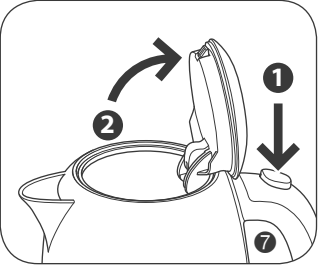
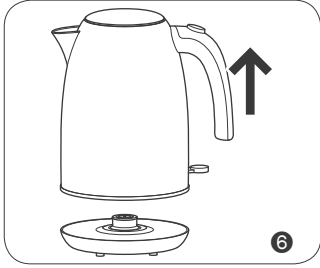

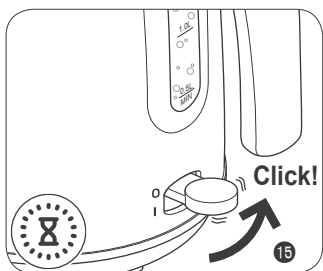
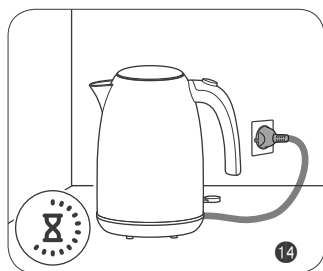
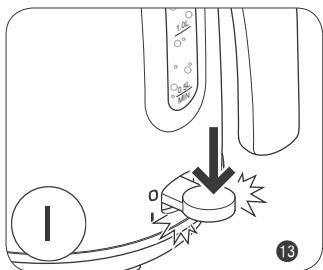
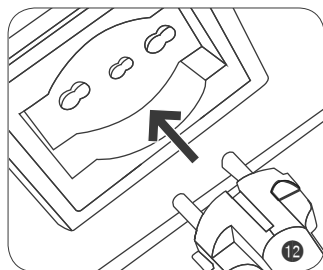
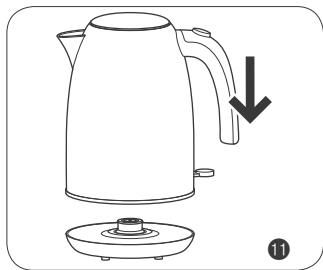
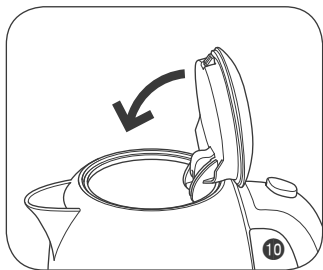
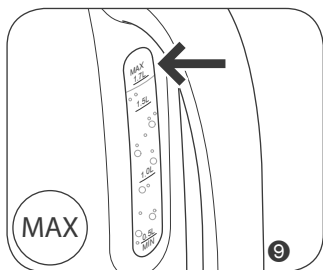
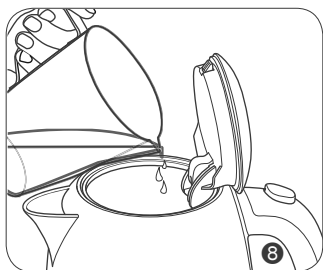

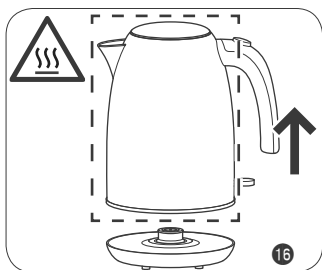

## Cleaning and maintenance

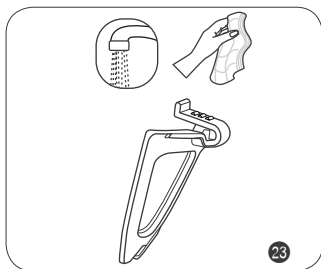
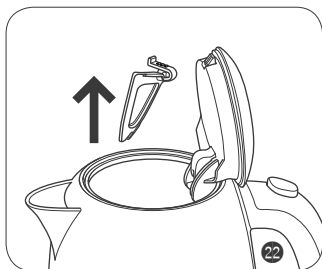
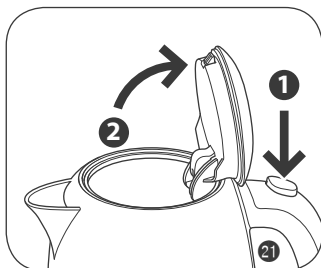
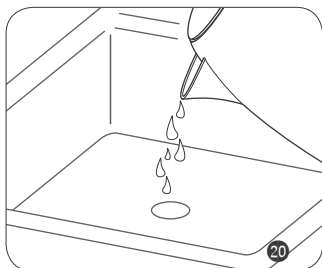
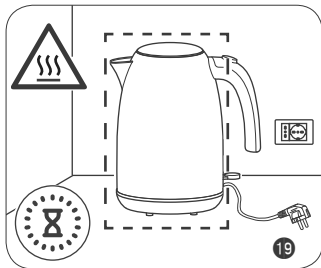
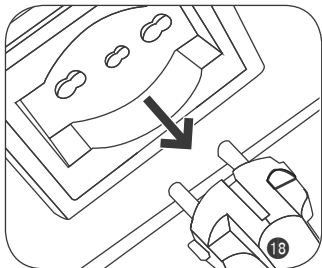

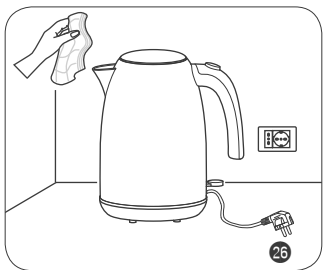
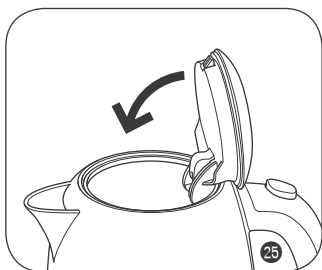
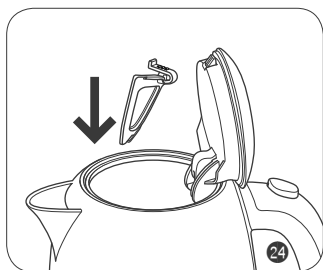

# English

**Please refer to the first page, where you will find illustrations**

Safety warnings

## **Read the instructions carefully before use.**

- The appliance has been manufactured in compliance with the specific European Standards in force and all the parts potentially dangerous to the user are protected. Read this manual carefully before use. Use the appliance only for its intended use to avoid possible injury and damage. Keep this manual handy for future reference. Should you decide to give this appliance to other people, remember to include these instructions as well.
- The appliance has been designed to be used for household purposes or similar, such as:
  - in cooking areas reserved for shop staff, offices and other professional environments
  - on farms
  - guests of hotels, motels and other residential environments;
  - hotels, motels, bed & breakfasts and other residential facilities (for use by guests).
- Do not use the appliance for purposes other than those described in this manual. The manufacturer declines any responsibility for misuse or for any use other than those specified in this manual. Improper use also results in voiding any form of warranty.
- We suggest keeping the original packaging, as free assistance is not provided for failures resulting from inadequate packaging of the product at the time of shipping to an authorized Service Centre.

- In order not to compromise the safety of the appliance, use only original spare parts and accessories authorized by the manufacturer.
- The appliance complies with the Regulation (EC) No. 1935/2004 of 27/10/2004 concerning the materials intended to come into contact with food products.
- Do not leave the packaging near children as it is a potential source of danger.
- The appliance can be used by children over 8 years of age and by people with reduced physical, sensory or mental capacities, or who lack experience or knowledge, only if they are supervised by a responsible person or if they have received and understood the instructions and the existing dangers when using the appliance.
- Do not spill liquids on the power base of the appliance.
- Do not touch the hot parts of the appliance after use or in the minutes after it is turned off; wait for the hot parts to cool down.
- Cleaning and maintenance by the user shall not be carried out by children unless they are older than 8 years and are supervised during the operation. Always keep the appliance and the power cord out of the reach of children under the age of 8.
- Children shall not play with the appliance.
- Position the appliance so that children cannot reach the hot parts.
- If you decide to dispose of this appliance as waste, it is recommended to make it inoperative by cutting the power cord. It is also recommended that all potentially dangerous

components of the appliance, especially for children who could use the appliance as a game, are rendered harmless.

- Before connecting the appliance to the power supply, check that the voltage shown on the identification plate under the appliance matches the local voltage supply.
- The use of extension cords not authorized by the manufacturer can lead to damages and accidents.
- Always connect the appliance to an earthed socket.
- Do not connect any other high-power equipment (such as stoves, irons, radiators) to the same power outlet. Danger of electric overload.
- Do not leave the appliance unattended while connected to the power supply.
- Do not put live parts in contact with water: risk of short circuit and/or electric shock.
-  • Do not immerse the appliance in water or other liquids.
- Do not use the appliance if your hands are wet or if you are barefoot.
- Do not leave the power cord against sharp parts or sharp edges.
- The power cord shall not touch hot surfaces.
- Never pull the power cord or the appliance to disconnect the plug from the power outlet.
- Always unplug the appliance before inserting or removing individual components.
- If the appliance is left unused, also for a short period of time, turn it off and always unplug the power cord from the power outlet.

- Do not place the appliance on very hot surfaces or near open flames to prevent the coating from being damaged.
- Do not place the appliance near flammable materials (such as fabrics, curtains).
- Do not place the appliance or the power cord near or over hot electric or gas stoves, or near a microwave or electric oven.
- Do not place the appliance near or on damp surfaces (such as a sink).
- The appliance must not be powered by external timers or separate remote-controlled systems.
- Do not use the appliance outdoors.
- The appliance shall be used and left at rest on a stable surface.
- Do not use the appliance on an inclined surface.
- Do not leave the appliance exposed to weathering (such as rain or sun).
- Place the appliance in an environment that is sufficiently lit, clean and where the power outlet is easily accessible.
- The appliance must not be used if it has been dropped or if there are visible signs of damage. Do not use the appliance if the power cord or plug are damaged or if the appliance is faulty. All repairs, including the power cord replacement, shall be carried out only by authorized Service Centre or technicians, in order to prevent any risk.
- **Always keep these instructions for future reference.**

## Safety warnings during use

- You can use the appliance for boiling water only. Any other use of the appliance is not intended by the Manufacturer, which is exempt from any liability for damage of any kind, generated by improper use of the appliance. Improper use also results in voiding any form of warranty.
- Fully unwind the power cord before use.
- Before connecting or disconnecting the appliance from the electrical outlet, check that the ON/OFF lever is upward in the off position.
- Always turn off the appliance and unplug the power cord from the electrical outlet before filling the kettle with water.
- The water filling and emptying operations must be performed with the kettle separated from the power supply base.
- Never exceed the MAX level when filling the appliance.
- Never fill the appliance beyond the maximum limit; there is a risk of boiling water spilling out.
- Do not use sparkling water (with added carbon dioxide).
- Never fill the appliance with hot or boiling water.
- Do not operate the appliance dry, without water.
- Make sure the lid is correctly placed on the kettle before turning on the appliance.
- Use only the supplied power base: keep the base clean and dry.
-  Warning: hot surface.

- The appliance heats up during use. Avoid contact with the kettle.
- Do not open the lid of the kettle while the water is boiling.
- Do not touch hot surfaces. Use pot holders or tea towels.
- Make sure that the appliance is turned off before removing the kettle from the power base.
- When preparing the beverages and during cleaning operations, be careful to avoid coming in contact with hot water; danger of burns.
- Lift the kettle by its handle.

## Description of the appliance

- ① Lid
- ② Scale filter
- ③ Body of the appliance
- ④ Power base
- ⑤ ON/OFF lever + Operation indicator light
- ⑥ MAX water level indicator
- ⑦ Handle
- ⑧ Lid opening button
- ⑨ Cord storage device
- ⑩ Power cord

### Identification data

The following identification data of the appliance are reported on the data plate under the base of the appliance:

- manufacturer and CE marking
  - model [Mod.]
  - serial number [SN]
  - power supply voltage [V] and frequency [Hz]
  - electrical power consumption [W]
- In any requests to authorized Service Centres, specify model and serial number.

**Stand-by consumption: 0,4W.**

## How to use the appliance

### Important

- When turning on the appliance for the first time, fill the appliance with water and let water boil. Empty and rinse the kettle. Repeat the operation two or three times.
- The cable must not touch the hot parts of the appliance.

If you want to heat water without reaching boiling point, raise the ON/OFF lever ⑤ to position (O) and turn off the appliance.

After each use, empty any remaining water from the kettle. Before boiling water again, wait a few seconds to allow the power device to reset.

**Drops of water under the kettle are completely normal: it is just condensation.**



### Overheating protection function

The appliance is equipped with a overheating protection function. The appliance automatically shuts off when used without water or with an insufficient amount of water. Allow the appliance to cool down for at least 10 minutes.

## Safety warnings during cleaning and maintenance

- Regular and daily cleaning maintains the appliance efficient and extends the life of the appliance.
- Cleaning and maintenance operations shall be carried out when the appliance is off and unplugged from the power outlet.
- Unplug the appliance from the power outlet and wait for the hot parts to cool down before carrying out any cleaning and maintenance operations.
- After unplugging the appliance and when hot parts have cooled down, only clean the appliance using a damp, non-abrasive cloth and a few drops of mild, non-aggressive detergent. Never use solvents that damage plastic parts.
- Never wash the appliance components in the dishwasher. Do not use direct jets of water.

### **The filter**

- 1 Open the lid.
- 2 Lift the filter out away from the spout area .
- 3 Either rinse under the tap or use a soft brush .
- 4 Place the filter back in the spout area and push down to secure it .

malfunction. Use a citric acid-based descaling product. This product can be easily found at an authorized Service Centre.

**The Manufacturer bears no liability for damage to internal components of the appliance caused by the use of non-compliant products due to the presence of chemical additives.**

## Removing lime

Regular maintenance and cleaning preserve and keep the appliance efficient for a longer period of time, as well as significantly reduce possible limescale deposits in the appliance. Should the appliance's functionality be compromised after some time due to frequent use of hard and very calcareous water, carry out the decalcification of the appliance in order to eliminate the

The kettle is equipped with a limescale filter, located directly behind the spout.

Remove the limescale filter for cleaning operations.

Follow the instructions in the instruction sheet of the descaling product.

## Service and customer care

- If you experience any problems with the operation of your appliance, before requesting assistance visit [www.kenwoodworld.com](http://www.kenwoodworld.com).
- Please note that your product is covered by a warranty, which complies with all legal provisions concerning any existing warranty and consumer rights in the country where the product was purchased.
- If your Kenwood product malfunctions or you find any defects, please send it or bring it to an authorised KENWOOD Service Centre. To find up-to-date details of your nearest authorised KENWOOD Service centre, visit [www.kenwoodworld.com](http://www.kenwoodworld.com) or the website specific to your Country.



### **IMPORTANT INFORMATION FOR CORRECT DISPOSAL OF THE PRODUCT IN ACCORDANCE WITH THE EUROPEAN DIRECTIVE ON WASTE ELECTRICAL AND ELECTRONIC EQUIPMENT (WEEE)**

At the end of its working life, the product shall not be disposed of as urban waste.

It shall be taken to a special local authority differentiated waste collection centre or to a dealer providing this service.

Disposing of a household appliance separately avoids possible negative consequences for the environment and health deriving from inappropriate disposal and enables the constituent materials to be recovered to obtain significant savings in energy and resources. As a reminder of the need to dispose of household appliances separately, the product is marked with a crossed-out wheeled dustbin.