

# KENWOOD

## Type BLM80

### Instrucțiuni

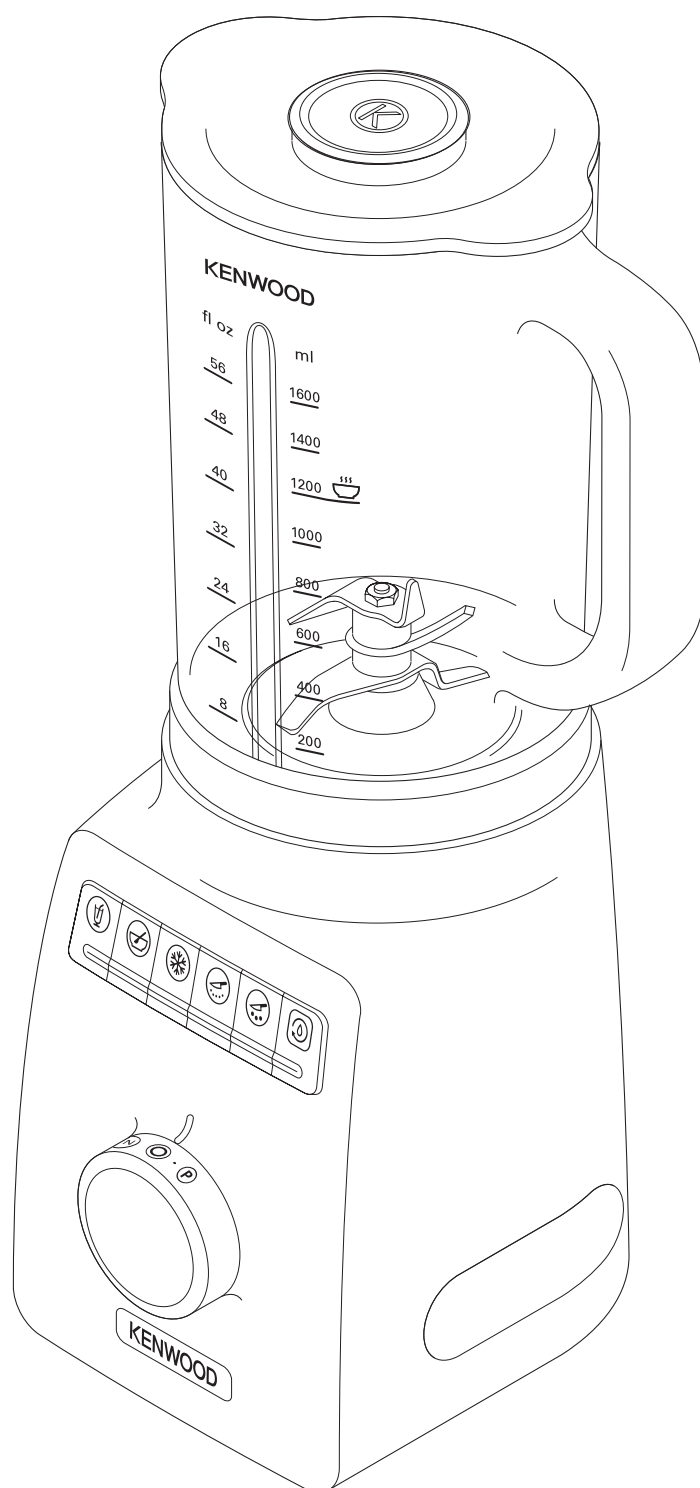



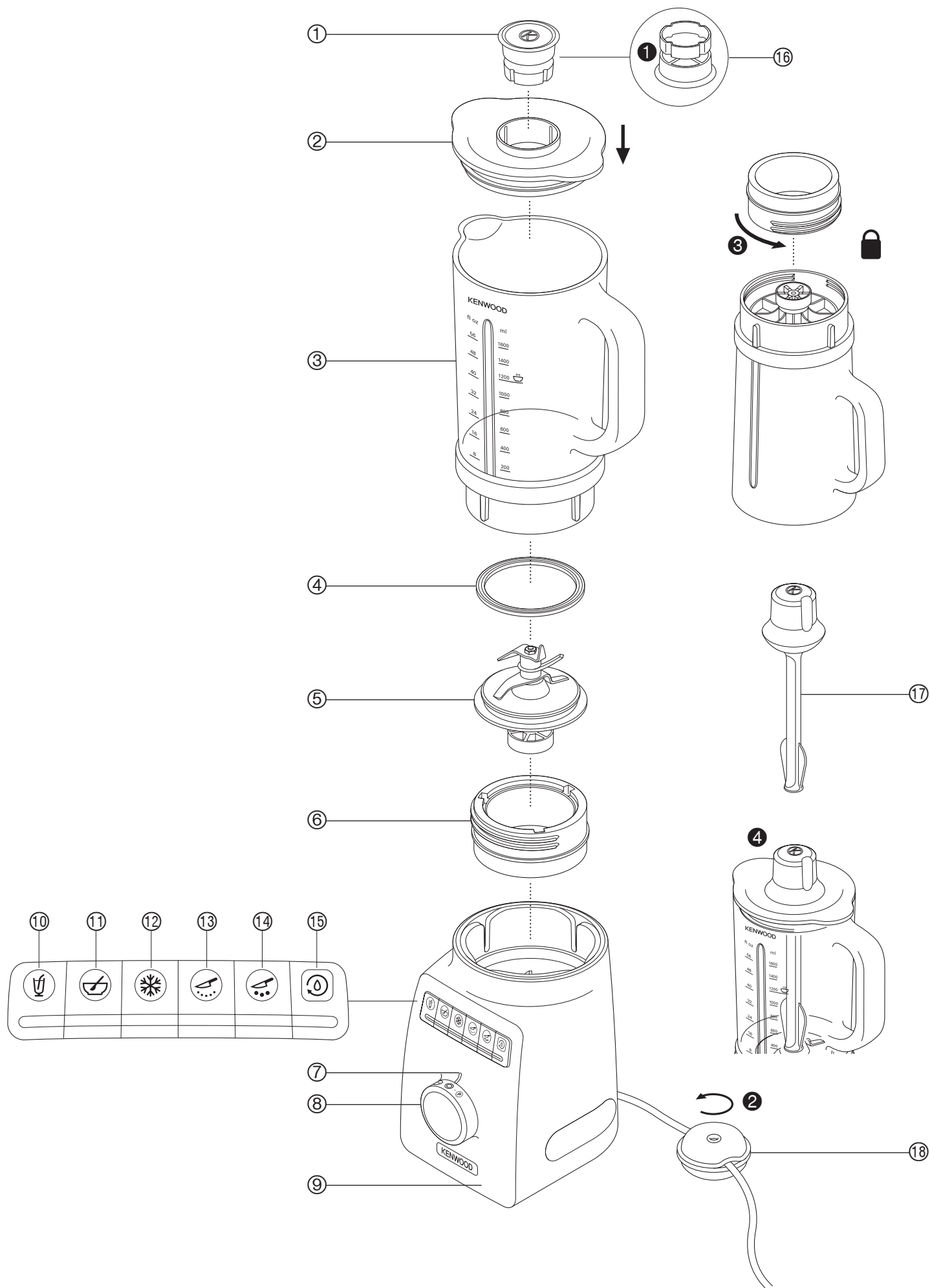

Your Blend-X blender has 6 pre-set programmes available for all core blending tasks plus the flexibility of variable speed and pulse for total control. Each programme has been set to provide the perfect consistency every time, whether its puréeing ingredients for soups, crushing ice for cocktails, blending breakfast smoothies, grinding coffee or preparing salsa.

#### **before using your Kenwood appliance**

- Read these instructions carefully and retain for future reference.
- Remove all packaging and any labels.
- Wash the parts: see 'care and cleaning'.

## Safety



### **IMPORTANT: HOT BLENDING INSTRUCTIONS**

To minimise the possibility of scalding when blending hot ingredients keep hands and other exposed skin away from the lid to prevent possible burns. The following precautions must be observed:

- **CAUTION: Blending very hot ingredients may result in hot liquid and steam being forced suddenly past the lid or filler cap ①.**
- **We recommend that hot ingredients are allowed to cool before blending.**
- **NEVER** exceed 1200ml / 5 cups capacity if processing hot liquids, such as soups (refer to the markings on the goblet).
- **ALWAYS** use the pre-set "Soup" program ⑪ for blending hot liquids and **NEVER** use the pulse setting.
- Liquids which tend to foam such as milk, should be limited to a maximum capacity of 1000ml/4 cups.
- Take care when handling the blender as the goblet and its contents will be very hot.
- Take particular care when removing the lid. The lid is designed to be a tight fit to prevent leakage. If necessary protect your hands with a cloth or oven gloves when handling.
- Ensure the goblet is securely attached to the base and when removing from the appliance, guide the base and ensure it is removed together with the goblet.
- Ensure that the lid and filler cap are securely in place before **every** blending operation.
- Always ensure that the vents in the filler cap are clear before **every** blending operation ⑫.
- When fitting the lid to the goblet always ensure that the lid and goblet rim are clean and dry to ensure a good seal and prevent spillage.

## Safety

- If the cord is damaged it must, for safety reasons, be replaced by KENWOOD or an authorised KENWOOD repairer.
- Switch off and unplug:
  - before fitting or removing parts;
  - when not in use;
  - before cleaning.
- **Never fit the blade unit to the power unit without the blender goblet fitted.**
- **Ensure the cord is fully unwound from the cord storage device ⑱ before using the blender.**
- Always unplug the appliance before putting your hands or utensils in the goblet.
- The blender lid must be fitted when using the stir stick in the goblet.
- Only use the stir stick ⑰ for processing cold ingredients. **DO NOT** use when processing hot liquids.

- Always take care when handling the blade assembly and avoid touching the cutting edge of the blades when cleaning.
- Only operate the blender with the lid in place.
- Only use the goblet with the blade assembly supplied.
- Never let the power unit, cord or plug get wet.
- Never use a damaged appliance. Get it checked or repaired: see 'service and customer care'.
- Never use an unauthorised attachment.
- **SCALD RISK:** Hot ingredients should be allowed to cool to room temperature before blending.
- Never leave the appliance unattended when it is operating.
- When removing the blender from the power unit:
  - wait until the blades have completely stopped;
  - don't accidentally unscrew the goblet from the blade assembly.
- Never run the blender empty.
- Never blend more than the maximum capacity stated in the recommended speed chart.
- To ensure long life of your blender, do not run it for longer than 3 minutes.
- Smoothie recipes - never blend frozen ingredients that have formed a solid mass during freezing, break it up before adding to the goblet.
- Children should be supervised to ensure that they do not play with the appliance.
- This appliance shall not be used by children. Keep the appliance and its cord out of reach of children.
- Do not process hard spices such as Nutmeg or Turmeric root as they may damage the blade.
- Don't use the blender as a storage container. Keep it empty before and after use.
- Always use the blender on a secure, dry level surface.
- Never place this appliance on or near a hot gas or electric burner or where it could touch a heated appliance.
- **Important** - The skirt on the base of the goblet is fitted during manufacture and no attempt should be made to remove it.
- Misuse of your blender can result in injury.
- Appliances can be used by persons with reduced physical, sensory or mental capabilities or lack of experience and knowledge if they have been given supervision or instruction concerning use of the appliance in a safe way and if they understand the hazards involved.
- Only use the appliance for its intended domestic use. Kenwood will not accept any liability if the appliance is subject to improper use, or failure to comply with these instructions.

#### **Before plugging in**

- Make sure your electricity supply is the same as the one shown on the underside of the appliance.
- **WARNING: THIS APPLIANCE MUST BE EARTHED.**

- This appliance conforms to EC Regulation 1935/2004 on materials and articles intended to come into contact with food.

## Key

- ① Filler cap
- ② Lid
- ③ Goblet
- ④ Sealing ring
- ⑤ Blade unit
- ⑥ Blade base
- ⑦ Power On indicator
- ⑧ Speed + pulse control
- ⑨ Power unit
- ⑩ Drinks programme button
- ⑪ Soups programme button
- ⑫ Ice crush programme button
- ⑬ Fine chop programme button
- ⑭ Coarse chop programme button
- ⑮ Rinse programme button
- ⑯ Vents
- ⑰ Stir stick
- ⑱ Cord storage device

## to use your blender

- 1 Fit the sealing ring ④ into the blade unit ⑤ - ensuring the seal is located correctly in the grooved area. Then fit the blade unit into the goblet ③.

- **Leaking will occur if the seal is damaged or incorrectly fitted.**

- 2 Screw the blade base ⑥ onto the goblet - ensuring the blade assembly is fully tightened. Refer to the graphics on the side of the blade base as follows:

 - unlocked position

 - locked position

- 3 Put your ingredients into the goblet.
- 4 Fit the filler cap to the lid and push down to secure.
- 5 Fit the lid by pushing down until secure.
- 6 Place the blender onto the power unit.

- **Ensure the cord is fully unwound from the cord storage device before using the blender.**

- **The appliance will not work if the blender is incorrectly fitted.**

- 7 Plug in and the Power On indicator ⑦ will light up.  
Note: The Power On indicator will flash if the goblet is not fitted to the power unit. Select a speed (refer to the recommended speed chart).

- 8 Choose one of the following options:

- Programme buttons:- Turn the speed control to the 'On' position and all the buttons will light up. Press the required programme button and the lights on the other buttons will go out and the programme will start. The blender will switch off automatically at the end of the programme time. If you wish to stop before the programme time has elapsed, press the selected programme button again.
- Manually selected a speed by turning the speed control until the required speed is reached. At the end of blending return the speed control to "O" before removing the blender.

- **Do not remove the goblet until the blades have stopped rotating and the speed control is in the 'O' position.**
- (P) Pulse - operates the motor in a start/stop action. The pulse will operate for as long as it is held in position.





**Refer to the troubleshooting section if you experience any problems with the operation of the blender.**

## To use the stir stick

- 1 Fit the lid to the goblet and remove the filler cap. DO NOT use the stir stick in the goblet without the lid fitted.
- 2 Insert the stir stick ④ and move it round the goblet slowly whilst the motor is operating.
- 3 Use the stir stick to help move ingredients around the goblet and prevent clogging during processing.

## Hints

- To blend dry ingredients - cut into pieces, remove the filler cap, then with the machine running, drop the pieces down one by one. Keep your hand over the opening. For best results empty regularly.
- When making mayonnaise, put all the ingredients, except the oil, into the blender. Remove the filler cap. Then, with the appliance running, add the oil slowly through the hole in the lid.
- Thick mixtures, e.g. pâtés and dips, may need scraping down. If the mixture is difficult to process, add more liquid and use the stir stick supplied.

Recommended Usage Chart (Programme buttons)				
Programme Button		Usage/Food Items	Max. Recommended Quantity	Programme Time
	Drinks	Cold Liquids Drinks & Cocktails	Max 1.6 litres	60 secs
		Milkshakes and milk based drinks	Max 1.2 litres	
		Smoothies Place the fresh fruit and liquid ingredients in first (includes yoghurt, milk and fruit juices). Then add ice or frozen ingredients (includes frozen fruit, ice or ice cream)	1 litre Liquid	
	Soups	Stock based soups 1.2 litre	1.2 litres	30 secs
		Soups using milk 1 litre	1 litre	
		<b>DO NOT</b> use the stir stick when processing hot liquids. <b>We recommend that hot ingredients are allowed to cool before blending.</b> <b>However should you wish to process hot ingredients please read the Hot Blending Safety instructions.</b>		
	Ice Crush	Ice crushing - Automatic pulsing action. A change in speed will be noted - this is normal. Freeze fruit juice in ice trays for Slushie type drinks	300g (14 ice cubes)	30 secs
		Sorbet recipes 40g sugar 250g Frozen fruit 1 egg white Use the stir stick	350g	30 secs X 2
		Instant Ice Cream 100g sugar 300g Frozen mixed berries 150g whipping cream Use the stir stick	600g	30 secs X 2
	Fine Chop	Use for chopping nuts, breadcrumbs and similar dry ingredients. Grinding Coffee Beans and Spices.		30 secs
		Coffee Beans	200g	For best results manually stop the program when you have achieved the desired result.
		Almonds	200g	
		Spices such as black peppercorns, 200g cardamon seeds, cumin seeds, coriander seeds, fennel seeds. <b>Hints</b> <ul style="list-style-type: none"><li>For optimum performance when processing spices we recommend that you do not process more than 200g at a time.</li><li>Whole spices retain their flavour for a much longer time than ground spices so it is best to grind a small quantity fresh at a time to retain the flavour.</li><li>To release the maximum flavour and essential oils whole spices are best roasted prior to milling.</li></ul>	200g	

Recommended Usage Chart (Programme buttons)				
Programme Button		Usage/Food Items	Max. Recommended Quantity	Programme Time
	Coarse Chop	Raw vegetables (such as onion, leeks, carrots, celery)	250g	10 secs
		Salsa 200g onion cut into quarters 1 red chilli cut in half ½ red pepper few coriander leaves 1 plum tomato	350g	10 secs
	Rinse	Use to rinse the goblet before taking apart for cleaning. For best results always take the blender apart for cleaning and dry thoroughly before re-assembling.	500mls warm water Max	30 secs

Processing times stated are for guidance only and will vary depending on the exact recipe used, ingredients being processed and personal preference. Stop the processing when the desired result has been achieved.

Recommended Usage Chart (Manual Control)			
Usage/Food items	Recommended Qty	Speed	Time
Mayonnaise	Max 3 egg mix	Max	60 secs
Caesar Dressing	Max 200g	Mid	70 secs
Vegetable Purees /Baby Food	300g	Min - Mid	60 secs
Fruit Purees	200g - 500g	Max	30 secs
Batter mixes	Max 1 litre	Max	15 secs
Uncooked meat (Lean Beef, Pork and Lamb) Lean Beef cut into 2 cm cubes	150g	Max	5 secs

Processing times stated are for guidance only and will vary depending on the exact recipe used, ingredients being processed and personal preference. Stop the processing when the desired result has been achieved.

## Care and cleaning

- Always switch off, unplug and dismantle before cleaning.
- Empty the goblet before unscrewing it from the blade unit.
- Don't immerse the blade unit in water.
- The goblet can be washed in your dishwasher.

### Power unit

- Wipe with a damp cloth, then dry.
- Don't immerse the power unit in water.
- Wind excess cord into the cord storage device

### Blade assembly

1 Unscrew the base from the goblet by turning in a clockwise direction. Refer to the graphics on the side of the base.

- unlocked position

- locked position

2 Then lift out the blade unit.

- **Care should be taken when removing the blade unit from the base.**

3 Remove and wash the sealing ring.

4 Don't touch the sharp blades – brush them clean using hot soapy water, then rinse thoroughly under the tap. **Don't immerse the blade unit in water. DO NOT DISHWASH.**

5 Leave to dry upside down.

### Other parts

Wash by hand, then dry.



## Service and customer care

- If you experience any problems with the operation of your appliance, before requesting assistance refer to the “troubleshooting guide” section in the manual or visit [www.kenwoodworld.com](http://www.kenwoodworld.com).
- Please note that your product is covered by a warranty, which complies with all legal provisions concerning any existing warranty and consumer rights in the country where the product was purchased.
- If your Kenwood product malfunctions or you find any defects, please send it or bring it to an authorised KENWOOD Service Centre. To find up to date details of your nearest authorised KENWOOD Service centre visit [www.kenwoodworld.com](http://www.kenwoodworld.com) or the website specific to your Country.
- Designed and engineered by Kenwood in the UK.
- Made in China.



### **IMPORTANT INFORMATION FOR CORRECT DISPOSAL OF THE PRODUCT IN ACCORDANCE WITH THE EUROPEAN DIRECTIVE ON WASTE ELECTRICAL AND ELECTRONIC EQUIPMENT (WEEE)**

At the end of its working life, the product must not be disposed of as urban waste.

It must be taken to a special local authority differentiated waste collection centre or to a dealer providing this service.

Disposing of a household appliance separately avoids possible negative consequences for the environment and health deriving from inappropriate disposal and enables the constituent materials to be recovered to obtain significant savings in energy and resources. As a reminder of the need to dispose of household appliances separately, the product is marked with a crossed-out wheeled dustbin.

## Troubleshooting guide

Problem	Cause	Solution
The Blender will not operate.	No Power/Power On Light not illuminated. Goblet removed from power unit without turning the speed control to "O".  Blender not assembled correctly.	Check blender plugged in.  The power unit will not operate until the speed control is turned to "on" and a speed is reselected.  Check blade unit is fully tightened to the goblet.
Power on light flashing rapidly.	The lights will flash under the following circumstances:-  The power unit is plugged in but the goblet is not fitted to the power unit.  The goblet is removed from the power unit without turning the speed control to "O".	Fit the goblet.  The power unit will not operate until the speed control is turned to "O" and a speed is reselected.
Power On Light flashing slowly.	The blender has been left plugged in for more than 15 minutes and has gone into standby mode.	Turn the speed control on and then off or press a program button to reset.
Blender not operating but Power On and programme button lights on.	Goblet fitted and speed control turned to "on" but speed or programme not selected.	Either select a speed manually or press one of the programme buttons.
Programme lights flashing	The lights will flash under the following circumstances:-  The power unit is plugged in but the goblet is not fitted to the power unit.  The goblet is removed from the power unit without turning the speed control to "O".	Fit the goblet.  Turn the speed control to "O" and reselected a speed.
Programme buttons not operating	Programme buttons will not operate unless the speed control is turned to the "on" position first.	Turn the speed control to "on" and select the required programme.
Blender leaking from blade assembly.	Seal missing. Seal incorrectly fitted. Seal damaged.	Check seal is fitted correctly and not damaged. To obtain a replacement seal see "service & customer care".
Blender seal missing from blade unit when removed from packaging.	The seal is packed pre-fitted to the blade unit.	Unscrew goblet and check that seal is fitted to blade unit. To obtain a replacement seal see "service & customer care".
Blender stops or slows during processing.	Overload protection operated. Blender overloaded or overheated during operation.  Maximum capacity exceeded.	Switch off, unplug for 5 seconds. Then plug back in. If blender does not operate then leave to cool for 15 minutes before plugging back in.  Refer to the speed chart for maximum capacities to process.
If none of the above solve the problem see "Service & Customer Care".		



**Kenwood Ltd**

New Lane  
Havant  
Hampshire  
PO9 2NH

[kenwoodworld.com](http://kenwoodworld.com)

© Copyright 2019 Kenwood Limited. All rights reserved



141156/1